

Lando Pendant Light Installation Instructions

Code	Description
5510366	Lando 6 Ring - Black
5510367	Lando 6 Ring - Gold

Important Safety Issues:

- This product must be installed by a professional, licensed electrician according to AS/NZ 3000.
- Ensure power supply is switched off before installation.
- Modifications of this product will void any warranty.
- Vencha Lighting does not take responsibility for wrong installation or incorrect use.

Notice: Rings 4-5-6 are pre-connected, Rings 1-2-3 require connecting and installing.

Steps for Installation:

1. Turn off power, make sure circuit is free of voltage.
2. Undo screws from fitting, remove base plate from fitting.
3. Install base plate in desired location using appropriate screws for application.
4. Connect power cables to terminal inside fitting.
5. Connect power to rings 1-2-3 through marked holes or following diagram attached. Connect to 1A, 2A, 3A.
6. Install rings 1-2-3 & baseplate (refer to step 8.) through marked holes or following diagram attached.
7. Adjust cable lengths of each ring to achieve desired height.
8. Reattached fitting to baseplate, tighten screws making sure fitting is secure.
9. Turn power back on and test fitting operates correctly.
10. Select light colour on 3CCT light switches. There are two 3CCT switches that need to be adjusted.

Notice: Power must be turned off when changing 3CCT switches.

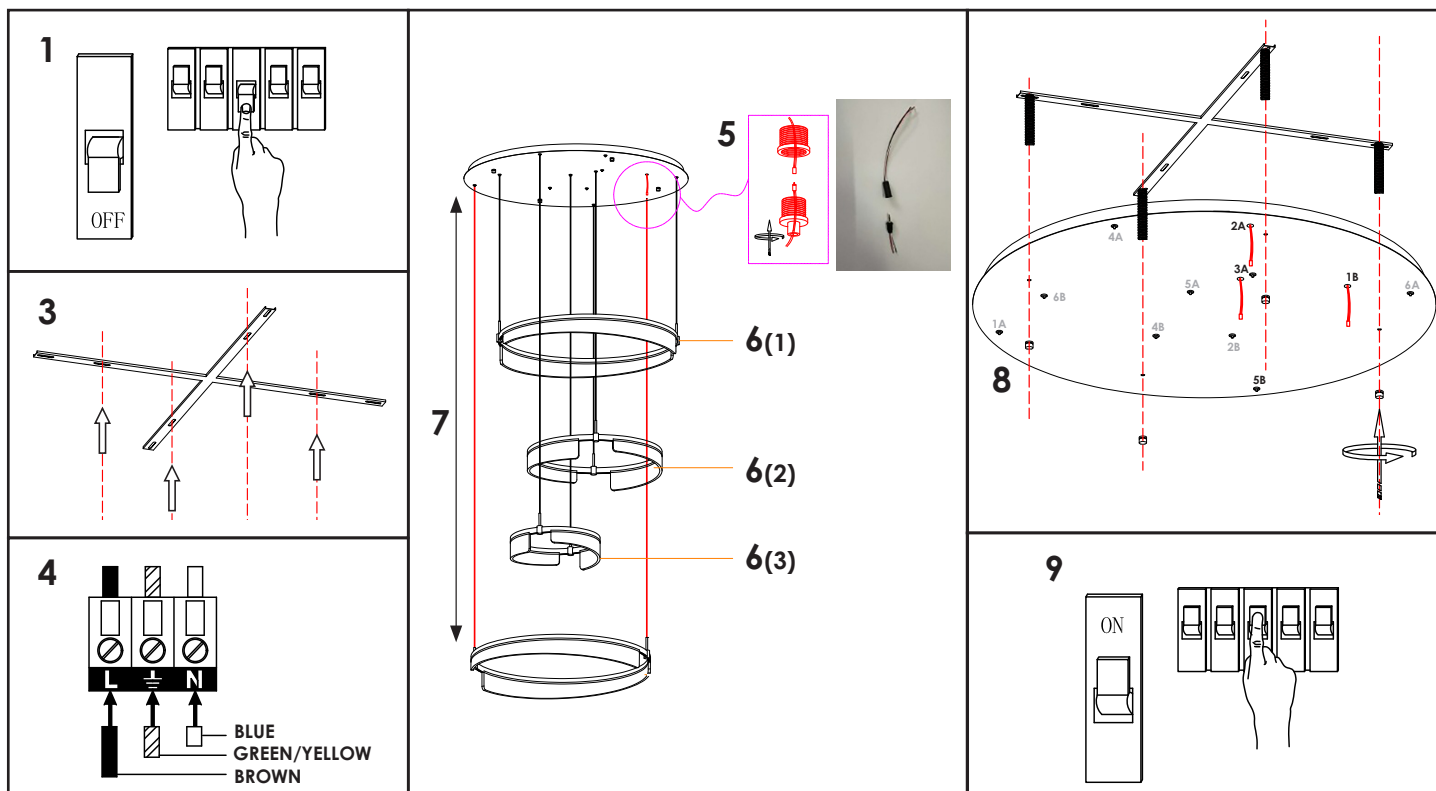
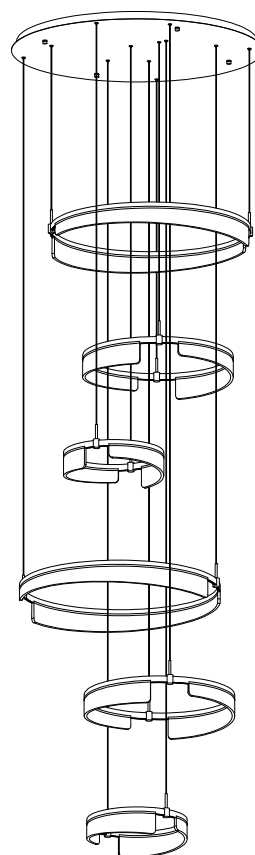

Lando Pendant Light Installation Instructions

Code	Description
5510366	Lando 6 Ring - Black
5510367	Lando 6 Ring - Gold

Important Safety Issues:

- This product must be installed by a professional, licensed electrician according to AS/NZ 3000.
- Ensure power supply is switched off before installation.
- Modifications of this product will void any warranty.
- Vencha Lighting does not take responsibility for wrong installation or incorrect use.

Notice: Rings 4-5-6 are pre-connected, Rings 1-2-3 require connecting and installing.

