

INSTALLATION INSTRUCTIONS

Installation: Before installation, please make sure the power is off.

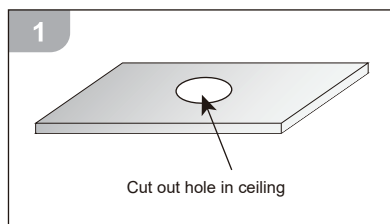

1. Cut out 90mm hole in the ceiling. Ensure there is sufficient clearance in the area where you will position the fitting.

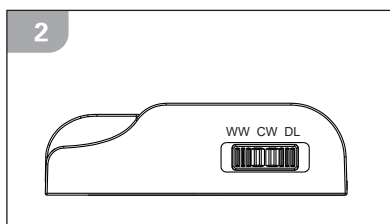

2. Choose the preferred colour temperature via switch on the driver.

Left	WW/3000K
Middle	CW/4000K
Right	DL/5700k

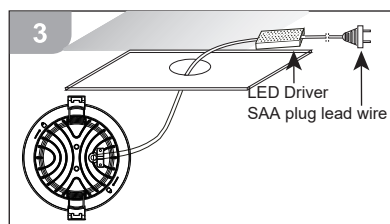

3. Connect fitting to the mains via power plug.

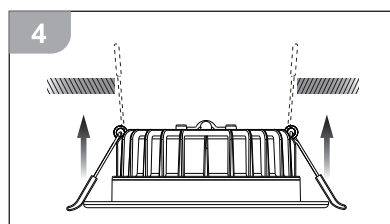

4. Fit the fixture in the ceiling by lifting the springs clips upwards

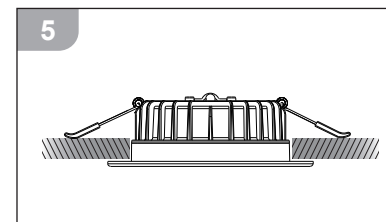

5. Once in place the clips should spring down against the top of the ceiling and support the fitting.

IC-4. IC-F ABUTTED & COVERED:

This downlight kit is tested to AS/NZS 60598.2. 2:2001 IC-F standards & AS/NZS 60598.2.2:2016 IC-4 standards. Loose fill insulation and building structural member are permitted to abut or cover this luminaire.

CAUTION!



Electrical products must not be thrown out with domestic waste. They must be taken to a communal collecting point for environmentally friendly disposal in accordance with local regulations. Contact your local authorities or stockist for advice on recycling. The packaging material is recyclable. Dispose of the packaging in an environmentally friendly manner and make it available for the recyclable material collection service

PLUTO

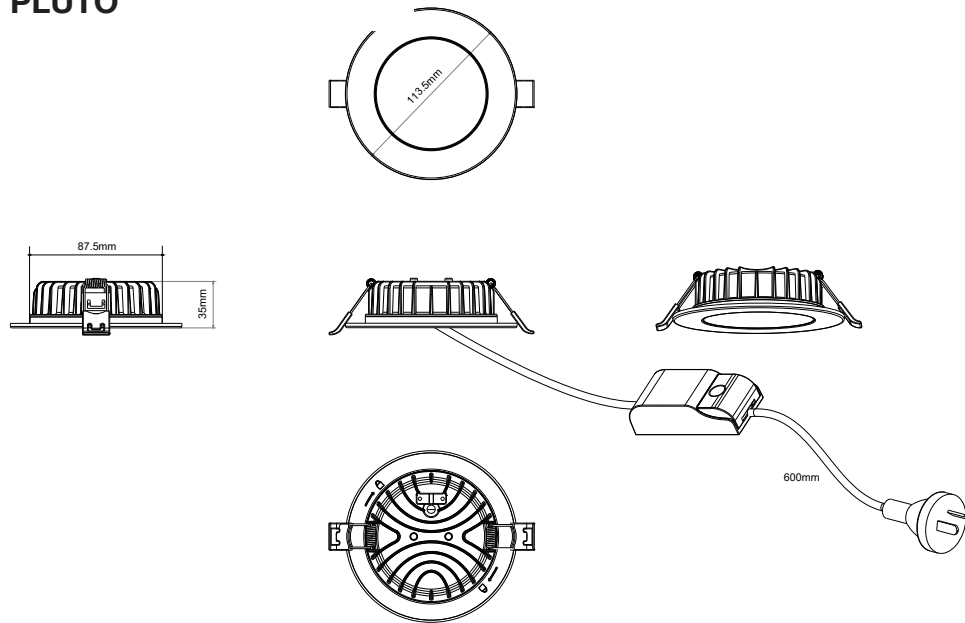

NEPTUNE

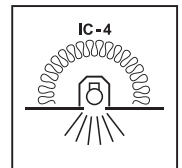
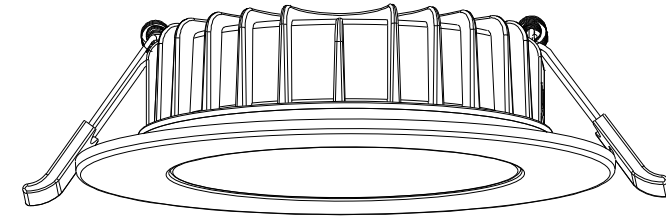
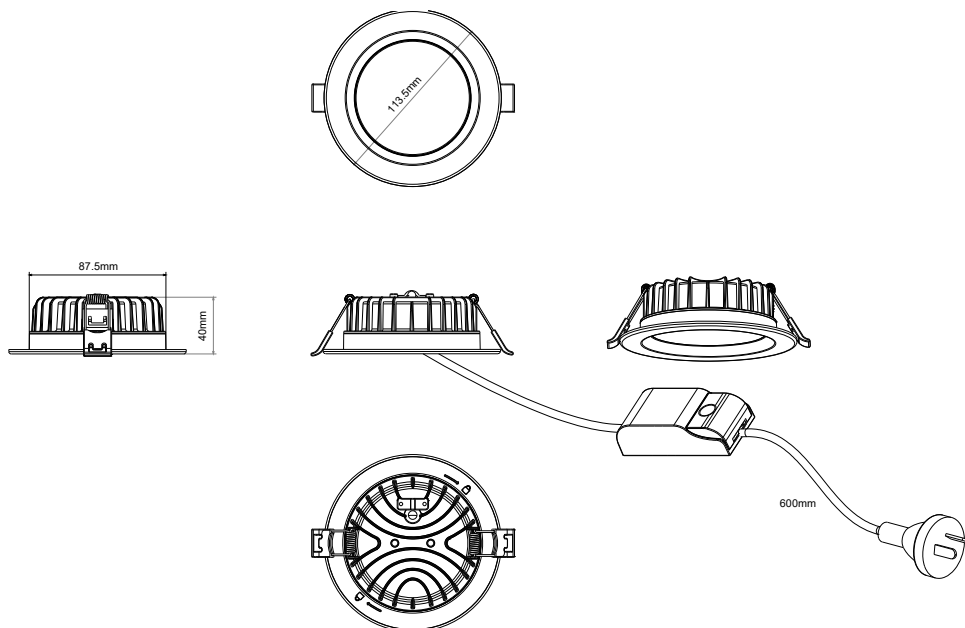

SPECIFICATIONS:

Rated Voltage: 220-240V~, 50/60Hz

Model No.	Wattage	Faceplate	Colour Temperature	Lumen	IP Rating	Cutout
5504020	12W	Flat white	3000K/4000K/5700K	900/950/1000lm	IP44	90mm
5504021	12W	Flat black	3000K/4000K/5700K	900/950/1000lm	IP44	90mm
5504022	12W	Flat satin chrome	3000K/4000K/5700K	900/950/1000lm	IP44	90mm
5504023	12W	Flat antique brass	3000K/4000K/5700K	900/950/1000lm	IP44	90mm
5504024	12W	Recessed white	3000K/4000K/5700K	900/950/1000lm	IP44	90mm

TESTED & RECOMMENDED DIMMERS

Dimmer Brands	Code	
DIGINET	MMDM/RT	✓
DIGINET	MEDM	✓
Clipsal	32ELED	✓
Clipsal-Trailing Edge	32E450TM	✓

May work with other untested dimmers and please check with a licenced electrician for Min and Max dimmer load.