

E Series Enclosures



Eaton's E Series offers a rugged, durable platform with exceptional value for network, server and telecommunication applications. E Series is vendor neutral and guaranteed to accommodate all TIA/EIA 310-D equipment, making it ideal for small to medium data centres.

Features:

- Lightweight but sturdy bolted design provides a generous static and dynamic weight capacity
- Exceeds major IT equipment air flow requirements
- Depth adjustable 19" vertical mounting rails in 6.35mm increments
- "U" numbers printed on rails
- Quick release and field reversible doors
- 42U x 600W cabinet with castors fits through standard doorway
- Two piece lockable side panels provide easy access to interior
- Available in flat-pack for convenient delivery
- Quick assembly time, approximately 30 minutes

Standards & Materials:

- Standard: EIA-310D, IEC-60297-2
- Material: high-grade cold and hot rolled steel/all materials RoHS compliant
- Finishing: 5 stage iron phosphate pre-treatment followed by tough scratch resistant powder coat paint
- Colour: Black, low gloss textured

Data Centre Racks

Standard Models

Description	Rack Units	Width	Depth	Height*	Part Number
27U, 600W, 1000D, Assembled, with castors	27	600	1063	1310	ESR61027
42U, 600W, 1000D, Assembled, with castors	42	600	1063	1980	ESR61042
42U, 800W, 1000D, Assembled, with castors	42	800	1090	1980	ESR81042
27U, 600W, 1000D, Flat Packed, Unassembled - No castors	27	990 [~]	1330 [~]	440 [~]	ER61027-FP
42U, 600W, 1000D, Flat Packed, Unassembled - No castors	42	990 [~]	2040 [~]	440 [~]	ER61042-FP

*Height including castors on assembled units

[~] Package dimensions

Features & Specifications

Features	ESR61027	ER61027-FP	ESR61042	ER61042-FP	ESR81042
Vendor neutral, compatible with all 19" standard IT equipment.	•	•	•	•	•
Depth adjustable 19" vertical mounting rails	•	•	•	•	•
"U" numbers printed on rails	•	•	•	•	•
Quick release and field reversible doors	•	•	•	•	•
Split rear "barn style" doors	•	•	•	•	•
Two piece locking side panels			•	•	•
Leveling feet included	•	•	•	•	•
Anti-tip/bolt down brackets (front & rear)	•		•		•
ePDU/accessory mounting rails x 2			•	•	•
Quick assembly time ~ 30 minutes		•		•	
Specifications	ESR61027	ER61027-FP	ESR61042	ER61042-FP	ESR81042
Static load rating: 1,200 kg	•	•	•	•	
Static load rating: 1,000 kg					•
71% airflow perforated doors	•	•	•	•	•

Accessories

Accessories	Dimensions	Part Number
2U Cable Management Panel	2U x 600 x 100	ERA001
1U Cable Management Panel	1U x 600 x 100	ERA002
ER61042 Castor Kit	NA	ERA003
Document Wallet	250 x 250	ERA004
Hardware Bag (50 x M6 Screws, 50 x Cage Nuts, 50 x Plastic Washers)	NA	ERA005
Light Equipment Shelf	2U x 600 x 330	ERA006
Vented Fixed Shelf	1U x 600 x 700	ERA007
Telescopic Shelf	1U x 600 x 700	ERA008
Enclosure Anti-tip/bolt down brackets	NA	ERA009
Enclosure baying kit	NA	ERA010
Environmental Rack Monitor	134W x 27H x 86D	ERM



Powering Business Worldwide

Data Centre Racks

42RU x 600mm Dimensions

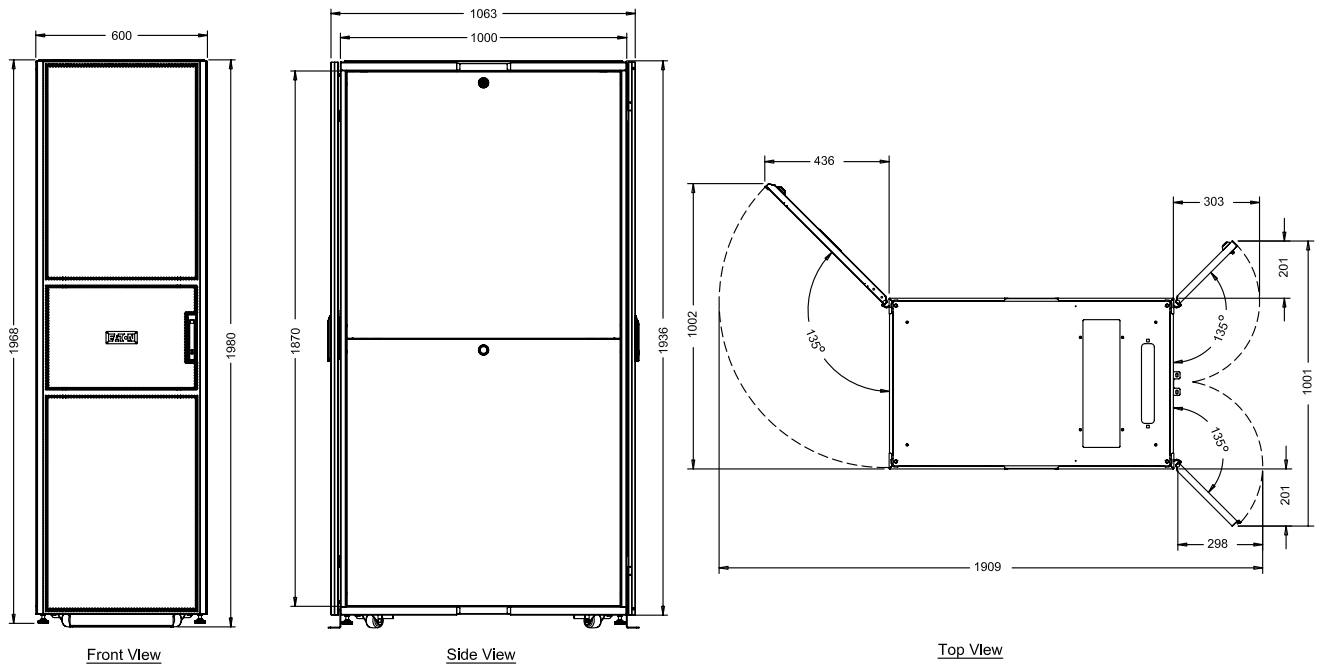

42RU x 800mm Dimensions

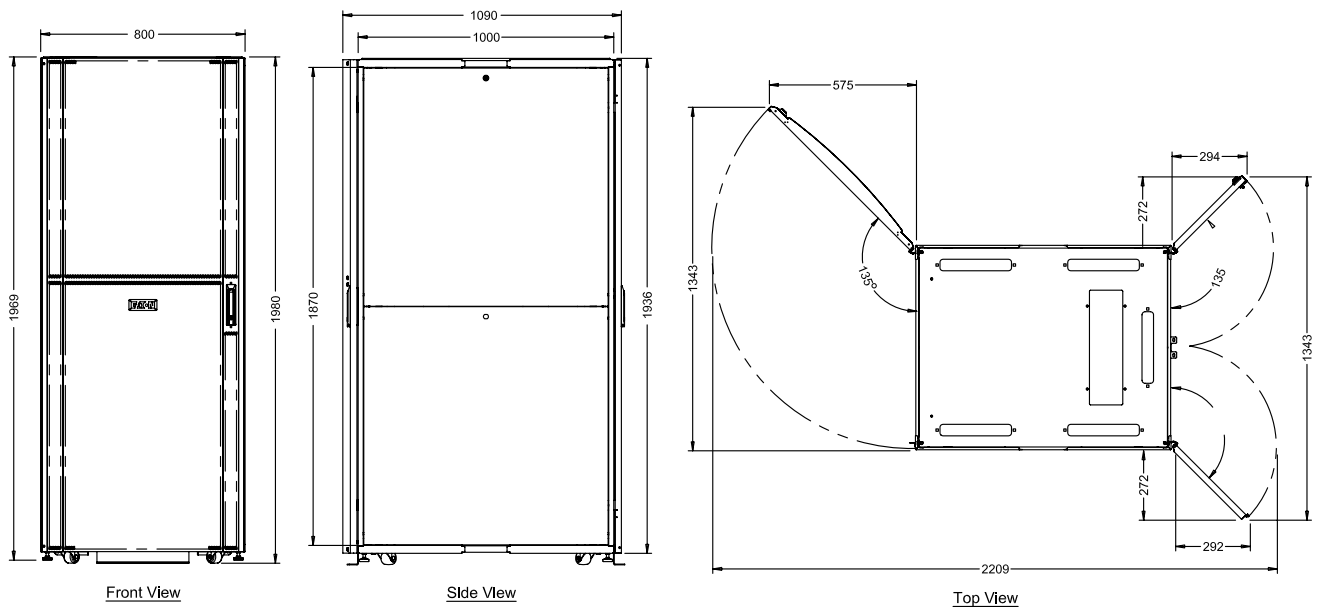

Data Centre Racks

27RU x 600mm Dimensions

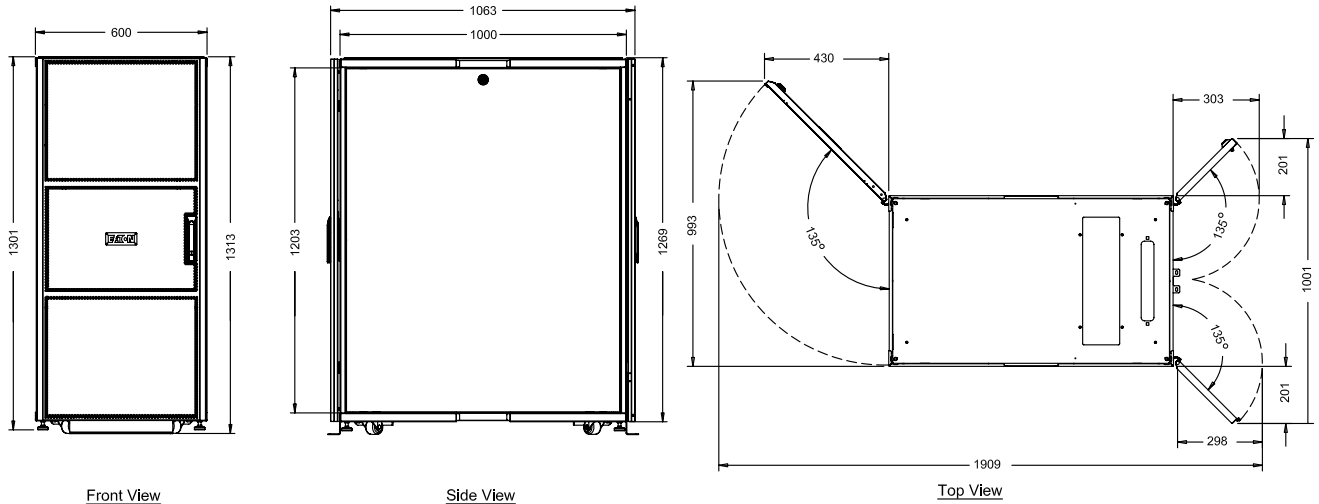

Eaton ePDU

Enclosure Power Distribution Units

With today's changing technology and the demand for reliability, data centre professionals need sophisticated equipment to monitor consumption at a server level as well as at the data centre level to understand and control what is happening within their infrastructure.

Wide choice of models

Eaton ePDUs feature the broadest portfolio in the industry across all power densities and technologies to satisfy the needs of every data centre. This complete suite of power products is designed specifically to help data centre IT managers understand their rapidly escalating power requirements.

The ePDU family includes models with a variety of power inputs and outputs to fit your power requirements. You can select from IEC (C13 & C19) and local Australian output sockets, EN 60309, IEC (C14 & C20).



The ePDU range includes an extensive range of vertical Zero U products that do not occupy server space in racks as well as 1U and 2U formats. Environmental Monitoring options are also available.

From single to dual corded, four technology options, the broadest power range and the ability to manufacture ePDUs with custom arrangement of outlets (number and type), Eaton ePDUs are distinguished for their quality, dependability and versatility. All products are designed for the specific application with an emphasis on safety and reliability.

EATON
Powering Business Worldwide

New Zealand Distributor



7 Glover Street, Ngauranga, Wellington
59 Maurice Road, Penrose, Auckland
PO Box 13-432, Johnsonville, Wellington
0800 UPS POWER (0800 877 769)
sales@upspower.co.nz
www.upspower.co.nz

