

VF150/N

CAST IRON VORTEX SUBMERSIBLE DRAINAGE PUMPS

VF150/N is designed for clear or grey water containing some soft solids. Typical applications include dewatering pits, drainage, water features and low-lying areas prone to flooding.



VF150

VF150N

KEY FEATURES

- Vortex impeller
- 15mm soft solids passable
- Strong durable cast iron pump body
- Lip seal and dual mechanical seal
- VF150N with vertical float ideal for narrow pit installation
- Moisture sealed cable inlet

APPLICATIONS

- Disposal of wastewater, septic effluent water and grey water of a neutral pH.
- Dewatering (clear and grey water).
- Water treatment circulation.

PUMP INFORMATION

Vertical, single-stage, submersible pump capable of pumping soft solids up to 15mm in diameter. Polycarbonate vortex impeller with cast iron casing, feet and 1¼" BSP (female) discharge port. 304SS motor casing.

Pump casing: Cast iron
Impeller: Polycarbonate
Motor shaft: 304SS
Mechanical seal: Carbon ceramic mechanical seal & lip seal
IP Rating: IP68

OPERATING CONDITIONS

Drainage pump for the disposal of wastewater, including rainwater, septic effluent water and grey water of neutral pH containing soft particles up to 15mm diameter. Install pump vertically (hose connection possible).

Fluid: Water
Max water temperature: 40°C
Min water temperature: 1°C
Maximum submergence: 6m
Max fine solid concentration: 1%
Suitable pH range: 5 - 9

ELECTRICAL DATA

Product Code	Type of current	Voltage ± 10%	Frequency Hz	Motor rating kW		RPM min	Starting Current	Run Current	Motor protection	Insulation class	Cable length
				P1	P2						
VF150/N	1-phase	230	50	0.35	.18	2850	9.5 A	1.75 A	Yes	F	10 m

DIMENSIONS

Product Code	Dimension L x W x H	Weight approx.	Packed L x W x H	Packed weight	Discharge branch	Free passage	Continuous operating temperature range
VF150	122 x 165 x 357 mm	9kg	200 x 200 x 380 mm	10kg	1¼" BSP (female)	15 mm	1° - 40°
VF150N	122 x 260 x 357 mm	9.2kg	260 x 170 x 375 mm	9.9kg	1¼" BSP (female)	15 mm	1° - 40°

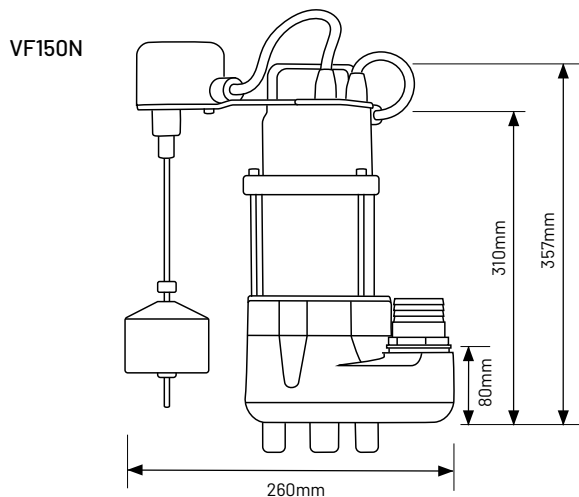
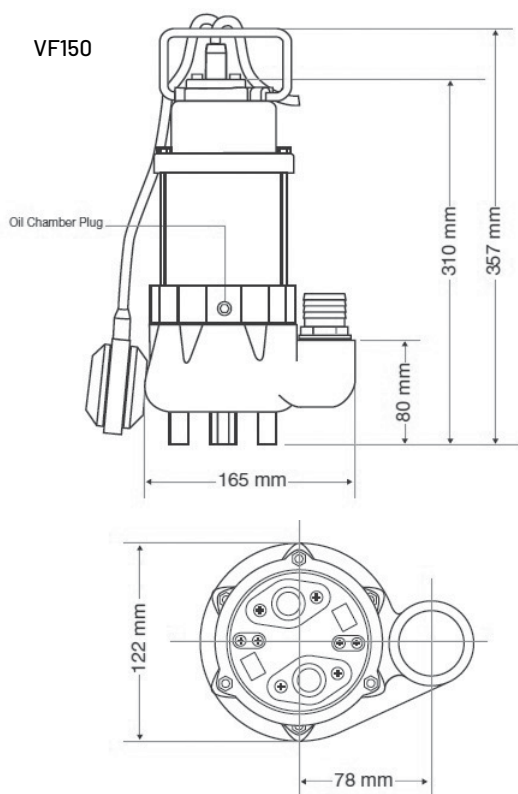

PUMP LEVEL

	VF150	VF150N
PUMP ON LEVEL	500 mm	96 mm (min)
PUMP OFF LEVEL	75 mm	70 mm

PERFORMANCE

Type	Delivery head H [m]	1	2	3	4	5	6
VF150/N	Flow rate capacity [lpm]	-	128	106	78	47	19

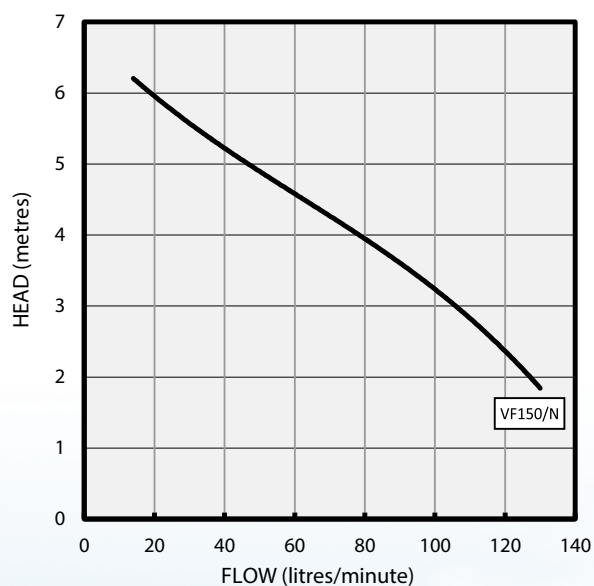

1-21 Monash Drive | Dandenong South, VIC 3175 | Australia | 1300 137 344 | pentair.com.au

Information contained here-in remains the property of Pentair Australia Pty Ltd under Australian copyright law. Content may not be reproduced or transmitted without our prior written permission.

© 2024 Pentair. All rights reserved. This document is subject to change without notice.