

Stareast International Pty Ltd



Professional & High Quality

HVAC Tools and Equipment

Distributed by: Stareast International Pty. Ltd.

45 BRYANT ST, PADSTOW NSW 2211

Office Number: 02 9792 5988 (international number +61 2 9792 5988)

Fax Number: 02 9792 5944 (international number +61 2 9792 5944)

Opening Hours Sales Counter:

7:45am - 5pm Monday-Friday & 8:30am - 1pm Saturday

Email: sales@stareast.com.au

Website: www.stareast.com.au



Black Diamond® Series

The conception of the Black Diamond® Series began with a goal in mind - to bring innovation to the industry. With our constant drive to develop new and unique products, we now have a complete lineup of tubing tools and testing equipment that leads the industry in innovation.

Every Black Diamond® product contains at least one unique patent. This design intent, combined with our focus on core values such as product quality and craftsmanship, enables us to deliver quality service to our customers time after time.

Progress demands innovation. To remain on the forefront of the industry, we will continue to focus our efforts in research and development, while maintaining our strict standards of quality control and customer service.

CONTENTS

Tube Cutters *Series*

• P1~P6

Flaring Tool & Tube Expander *Series*

• P7~P12

Tube Bender *Series*

• P13~P18

Manifold Gauge *Series*

• P19~P26

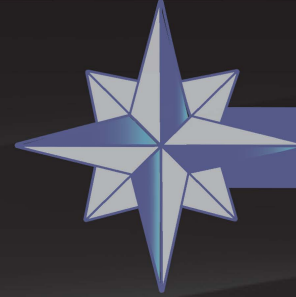

Stareast International Pty Ltd

Tube Cutter Series

Distributed by: Stareast International Pty. Ltd.

45 BRYANT ST, PADSTOW NSW 2211

Office Number: 02 9792 5988 (international number +61 2 9792 5988)

Fax Number: 02 9792 5944 (international number +61 2 9792 5944)

Opening Hours Sales Counter:

7:45am - 5pm Monday-Friday & 8:30am - 1pm Saturday

Email: sales@stareast.com.au

Website: www.stareast.com.au





Patented Tube Cutters

Smart Spring Tube Cutter

Our innovative spring mechanism improves the functionality of a tube cutter. The addition of a spring acts as a damper to absorb the excess pressure from the blade, reducing the chance of damaging the tubing material. At the same time, the spring applies a constant gripping force to the tube and maintains the contact between the blade and the tube. This allows the user to keep cutting a tube without retightening the cutter. Another unique feature of the spring mechanism is that the spring will adapt to the shape of the tube. Tubes that are not perfectly round or have indents can still be cut with our spring tube cutter.



Automatic Cutting

Spring pressure advances the blade when cutting, so there is no need to retighten the cutter.

Super Thin Blade

Produces a clean cut across the tube that results in minimal burr.

Can cut slightly deformed tubes

Spring acts as a suspension system. The blade will adjust to the shape of the tube, and the user can continue the cutting motion even if the tube is not perfectly round.

Aluminum Alloy Body

Lightweight and durable.

High Quality Handle

Wrapped in Thermoplastic Rubber (TPR). Smooth spinning, durable, non-slip, and easy to grip.



Medium Tube Cutter

Our iconic medium tube cutter is the world's first-ever spring-loaded tube cutter. Its overall size makes it a very good choice for most working conditions. The signature Black Diamond TPR handle is extremely comfortable to the touch, easy to grip, and smooth to turn.

Model No.	Range (O.D.)	Blade	Replacement Blade	Application	Replacement Blade Model No.
11217	1/8" – 1-1/4" (4-32 mm)	Nickel Plated	No	Copper and aluminum tubes	11001
11287			Yes		
11218		Titanium Finish	No		11002
11288			Yes		



Mini Tube Cutter

Our smallest tube cutter. Handy in working conditions where there is limited space. Dimensions: 49 X 37 X 18 mm.

Model No.	Range (O.D.)	Blade	Replacement Blade	Application	Replacement Blade Model No.
11111	1/8" – 5/8" (4-16 mm)	Nickel Plated	No	Copper and aluminum tubes	11009
11112		Titanium Finish	Yes		11010



Small Tube Cutter

Slightly larger than the Mini Tube Cutter. The small tube cutter can be combined with our Ratchet Handle for use in tight spaces. Dimensions: 78 X 42 X 28 mm.

Model No.	Range (O.D.)	Blade	Replacement Blade	Application	Replacement Blade Model No.
11115	1/8" – 7/8" (4-22 mm)	Nickel Plated	No	Copper and aluminum tubes	11001
11165			Yes		
11116		Titanium Finish	No		11002
11166			Yes		



Reversed Small Tube Cutter

More ergonomic version of our small tube cutter. The reversed design of the blade makes it easier to hold the cutter and the tube together while turning the handles.

Model No.	Range (O.D.)	Blade	Replacement Blade	Application	Replacement Blade Model No.
11117	1/8" – 7/8" (4-22 mm)	Nickel Plated	No	Copper and aluminum tubes	11001
11167			Yes		
11118		Titanium Finish	No		11002
11168			Yes		





Patented | Tube Cutters



Ratchet Handle (Includes a Small Tube Cutter)

The ratchet handle attachment for the small tube cutter is a solution for tight work spaces that are hard to maneuver around. The spring mechanism in the tube cutter will ensure the blade is always cutting the tube. This eliminates the need to remove the ratchet handle to tighten the tube cutter. The small tube cutter can be removed from the ratchet handle to be used on its own.

Model No.	Range (O.D.)	Blade	Cutter Model	Application	Replacement Blade Model No.
11195	1/8" – 7/8" (4-22 mm)	Nickel Plated	11115	Copper and aluminum tubes	11001
11197			11117		
11196		Titanium Finish	11116		11002
11198			11118		



Medium-Large Tube Cutter

A larger version of the Medium Tube Cutter.

Model No.	Range (O.D.)	Blade	Replacement Blade	Application	Replacement Blade Model No.
11311	1/8" – 1-5/8" (4-42 mm)	Nickel Plated	No	Copper and aluminum tubes	11005
11381			Yes		
11312		Titanium Finish	No		11006
11382			Yes		



Large Tube Cutter

Quick advance and quick release design allows the user to quickly adjust the size of the Large Tube Cutter. Models 11518 and 11588 are equipped with a ball bearing blade in titanium finish.

Model No.	Range (O.D.)	Blade	Replacement Blade	Application	Replacement Blade Model No.
11517	3/8" – 2-5/8" (10-66 mm)	Nickel Plated	No	Copper and aluminum tubes	11003
11587			Yes		
11518		Titanium Finish (with Ball Bearing)	No		11004
11588			Yes		



Heavy Duty Tube Cutter

Our flagship cutter. Has 6 ball bearing rollers and a ball bearing blade in titanium finish. The tube cutter is also outfitted with a dual spring design. This creates an extremely smooth cutting motion and can cut stainless steel tubes up to 3mm in thickness.



Model No.	Range (O.D.)	Blade	Replacement Blade	Application	Replacement Blade Model No.
11318	1/4" – 1-1/4" (6-32mm)	Titanium Finish (with Ball Bearing)	No	Copper and aluminum tubes. Stainless steel tubes up to 3mm thick	11008
11388			Yes		



Medium Duty Tube Cutter

Uses the same dual spring design as our flagship cutter. The medium duty cutter uses regular rollers and can cut stainless steel tubes up to 2mm in thickness.

Model No.	Range (O.D.)	Blade	Replacement Blade	Application	Replacement Blade Model No.
11211	1/8" – 1-1/4" (4-32 mm)	Nickel Plated	No	Copper and aluminum tubes. Stainless steel tubes up to 2mm thick.	11005
11281			Yes		
11212		Titanium Finish	No		11006
11282			Yes		



Replacement Blades

Model No.	Material and Finish	Outer Diameter	Model No.	Material and Finish	Outer Diameter
11001	Nickel Plated	Ø 17.5 mm	11003	Nickel Plated	Ø 23mm
11002	Titanium Finish		11004	Titanium Finish With Ball Bearing	

Model No.	Material and Finish	Outer Diameter	Model No.	Material and Finish	Outer Diameter
11005	Nickel Plated	Ø 19.8 mm	11009	Nickel Plated	Ø 15.2 mm
11006	Titanium Finish		11010	Titanium Finish	

Model No.	Material and Finish	Outer Diameter
11008	Titanium Finish With Ball Bearing	Ø 25mm



Stareast International Pty Ltd

Flaring Tool & Tube Expander Series

Distributed by: Stareast International Pty. Ltd.

45 BRYANT ST, PADSTOW NSW 2211

Office Number: 02 9792 5988 (international number +61 2 9792 5988)

Fax Number: 02 9792 5944 (international number +61 2 9792 5944)

Opening Hours Sales Counter:

7:45am - 5pm Monday-Friday & 8:30am - 1pm Saturday

Email: sales@stareast.com.au

Website: www.stareast.com.au





Patented Flaring Tool

Drill Powered Flaring Tool

Drill Powered Flaring Tool has a cutting-edge design that allows the user to use an electric drill to flare a copper tube. The yoke and the flaring bar are constructed out of a high grade aluminum alloy, reducing the overall weight and making it incredibly easy to carry around and use. With the Dual Clutch design, the internal clutch is automatically released when the flare is completed to prevent over-flaring. The clutch will also release when the flaring cone is fully retracted. To ensure that a quality flare can be made consistently, the Indexing Mechanism and the Tube Positioning Plate allow the user to quickly set up the tube in the optimal position every time.



Drill Adapter

Manual operation when used with the included handle.

Remove the handle to reveal the drill bit adapter for drill powered operation.

Dual Clutch Design

Clutch releases when the flare is complete to prevent over-flaring.

Clutch releases when the flaring cone is fully retracted.

Lightweight Aluminum

High grade aluminum alloy allows for a strong and lightweight structure.

Indexing Mechanism

Provides quick and accurate feedback when switching between different hole positions on the flaring bar.

Tube Positioning Plate

Ensures the tube is set at the correct position for all sizes.



Drill Powered Flaring Tool

An innovative flaring tool that can be used with an electric drill to flare a copper tube.



● Drill Adapter

Model No.	Measurement	Bar Type	Flare Sizes
15545	Imperial	5 Holes	1/4", 3/8", 1/2", 5/8", 3/4"
15546		6 Holes	1/4", 5/16", 3/8", 1/2", 5/8", 3/4"
15577	Metric	7 Holes	6mm, 8mm, 10mm, 12mm, 15mm, 16mm, 18mm

Eccentric Cone Flaring Tool

A lightweight manual flaring tool made of high-grade aluminum alloy. Has an internal clutch that automatically releases when the flare is complete to prevent over-flaring.



● Indexing Mechanism

● Tube Positioning Plate

● Clutch Design

Model No.	Measurement	Bar Type	Flare Sizes
14545	Imperial	5 Holes	1/4", 3/8", 1/2", 5/8", 3/4"
14546		6 Holes	1/4", 5/16", 3/8", 1/2", 5/8", 3/4"
14577	Metric	7 Holes	6mm, 8mm, 10mm, 12mm, 15mm, 16mm, 18mm

2-in-1 Flaring / Swaging Tool

Patented 2-in-1 design that can be used to flare or swage a tube. The Diamond Flaring Cone deburrs and polishes the tube during the flaring process, creating an exceptional surface finishing when the flare is complete. The Quick Coupler fitting allows the user to quickly switch out the flaring cone and the swaging heads.



● Diamond Flaring Cone



● Quick Coupler

Model No.	Measurement	Bar Type	Flare/Swage Sizes
14345	Imperial	5 Holes	1/4", 3/8", 1/2", 5/8", 3/4"
14346		6 Holes	1/4", 5/16", 3/8", 1/2", 5/8", 3/4"
14377	Metric	6 Holes	6mm, 8mm, 10mm, 12mm, 16mm, 18mm



Patented Tube Expander Set

Multi-Size Tube Expander Set

The Multi-Size Tube Expander Set comes with our patented industry's first 1/4" expander head. For a compact and lightweight design, the expander body and expander heads are constructed out of a high-grade aluminum alloy. The TPR-wrapped handles provide an ergonomic grip for the user. Each expander head contains six expander blades that are machined to precision to ensure that users can achieve a consistent result each time they use the tool.

Lightweight Aluminum Body

Ergonomic TPR Handle

Patented 1/4" Expander Head



Multi-Size Tube Expander Set

The expander heads are color-coded differently for each size. Patented 1/4" expander head.

Model No.	Measurement	Expander Heads	Expander Head Sizes
13800	Imperial	8	1/4", 3/8", 1/2", 5/8", 3/4", 7/8", 1", 1-1/8"
13700	Metric	8	6mm, 8mm, 10mm, 12mm, 15mm, 16mm, 18mm, 22mm

Additional Expander Heads

Imperial Sizing

Model No.	Expander Head Sizes
13120	1-1/4"
13122	1-3/8"
13124	1-1/2"
13126	1-5/8"

Metric Sizing

Model No.	Expander Head Sizes
13231	31 mm
13235	35 mm
13237	37 mm
13241	41 mm



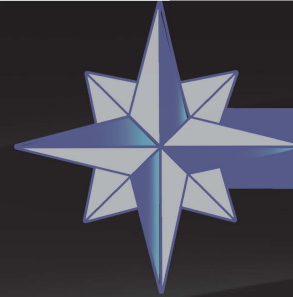

Stareast International Pty Ltd

Tube Bender Series

Distributed by: Stareast International Pty. Ltd.

45 BRYANT ST, PADSTOW NSW 2211

Office Number: 02 9792 5988 (international number +61 2 9792 5988)

Fax Number: 02 9792 5944 (international number +61 2 9792 5944)

Opening Hours Sales Counter:

7:45am - 5pm Monday-Friday & 8:30am - 1pm Saturday

Email: sales@stareast.com.au

Website: www.stareast.com.au





Patented Tube Benders

Multi-Size Tube Bender Set

Our multi-size tube bender set is an all-in-one solution for tube bending. The patented 90° Angle Indicator lets the user clearly see when the tube has reached 90°. For situations when the tube needs to be bent in the opposite direction, the Reverse Bending Adapter can be attached to switch the bending direction. The color-coded aluminum mandrels do not deform during the bending process, so the tube material will not be damaged and will retain its roundness. For convenience, the Indexing Bending Block and the Adjustable Support Arm allows the user to quickly adjust for different sizes without having to remove any parts.

Reverse Bending Adapter

Attach the adapters to reverse the tube bending direction.

Aluminum Alloy

Lightweight and Durable.

Patented 90° Indicator

Quickly and accurately shows when the tube is bent to a 90° angle.

Indexing Bending Block

Switch between different sizes quickly and efficiently.

Patented Adjustable Support Arm

Adjust to different size tubes by sliding the bending blocks to the marked location.

Multi-Size Tube Bender Set

Has one multi-sized support arm for quick adjustments between different tube sizes.



● Patented 90° Indicator



● Lightweight Reverse Bending Adapter



● Patented Adjustable Multi-Sized Support Arm

Model No.	Measurement	Mandrels	Mandrel Sizes
12755	Imperial	5	1/4", 5/16", 3/8", 1/2", 5/8"
12766		6	1/4", 5/16", 3/8", 1/2", 5/8", 3/4"
12777		7	1/4", 5/16", 3/8", 1/2", 5/8", 3/4", 7/8"
12655	Metric	5	6mm, 8mm, 10mm, 12mm, 15mm
12666		6	6mm, 8mm, 10mm, 12mm, 15mm, 18mm
12677		7	6mm, 8mm, 10mm, 12mm, 15mm, 18mm, 22mm

Multi-Size Tube Bender Set

Models 12999 and 12888 do not have the Adjustable Support Arm feature. Instead, these models come with 2 separate support arms that have to be swapped depending on tube sizes.



● Patented 90° Indicator



● Lightweight Reverse Bending Adapter

Model No.	Measurement	Mandrels	Mandrel Sizes
12999	Imperial	7	1/4", 5/16", 3/8", 1/2", 5/8", 3/4", 7/8"
12888	Metric	7	6mm, 8mm, 10mm, 12mm, 15mm, 18mm, 22mm



Patented Tube Benders

Quick Action Tube Bender - Lever Type

Traditional lever type tube benders are difficult to use when attempting to bend a tube past 90° and often require the use of a vice for extra leverage. Our Quick Action Tube Bender has a patented dual hinge design that makes it very easy to bend a tube to 180° without the help of any other tools. With the dual hinge mechanism, the user can first bend a tube to 90°, then reset the handle position using the second hinge. This creates extra leverage, and the user can then easily make the second bend to 180°.

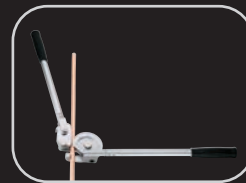

● **Step 1**
Insert the correct size tube and bend to 90°.

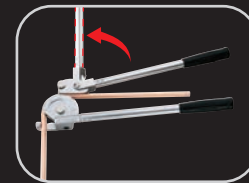

● **Step 2**
Lift the handle upwards to reset the handle position and create extra leverage.

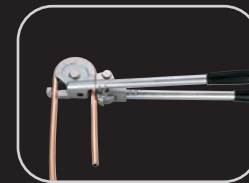

● **Step 3**
Bend the tube to 180°.

Aluminum Mandrel

Lightweight and Durable.

Ergonomic TPR Handle

Comfortable and ergonomic handle grips.

Patented Dual Hinge Design

The second hinge resets the handle position to create extra leverage, making the second bend to 180° very easy.



Quick Action Tube Bender

Dual Hinge design creates extra leverage to let the user easily bend a tube to 180°.



Imperial Sizing

Model No.	Tube O.D.
12106	3/8"
12108	1/2"
12110	5/8"
12112	3/4"
12114	7/8"

Metric Sizing

Model No.	Tube O.D.
12210	10 mm
12212	12 mm
12216	16 mm
12219	19 mm
12222	22 mm

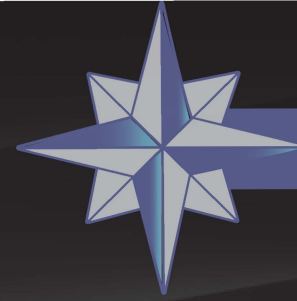

Stareast International Pty Ltd

Manifold Gauge Series

Distributed by: Stareast International Pty. Ltd.

45 BRYANT ST, PADSTOW NSW 2211

Office Number: 02 9792 5988 (international number +61 2 9792 5988)

Fax Number: 02 9792 5944 (international number +61 2 9792 5944)

Opening Hours Sales Counter:

7:45am - 5pm Monday-Friday & 8:30am - 1pm Saturday

Email: sales@stareast.com.au

Website: www.stareast.com.au





Patented | Manifold Gauges

Our manifold gauges are drop forged with a high-grade aluminum alloy. This reduces the weight while maintaining a durable structure. The patented magnetic buckle provides a convenient 2-in-1 method to hang the manifold while working. For magnetic surfaces, the magnet part of the buckle can be used to quickly secure the manifold gauge. For non-magnetic surfaces, the hook part of the buckle can be used instead. The large 80mm gauges provide clear and precise readings for the technician to see. Additionally, the 4X O-Ring design creates a leak-proof seal.

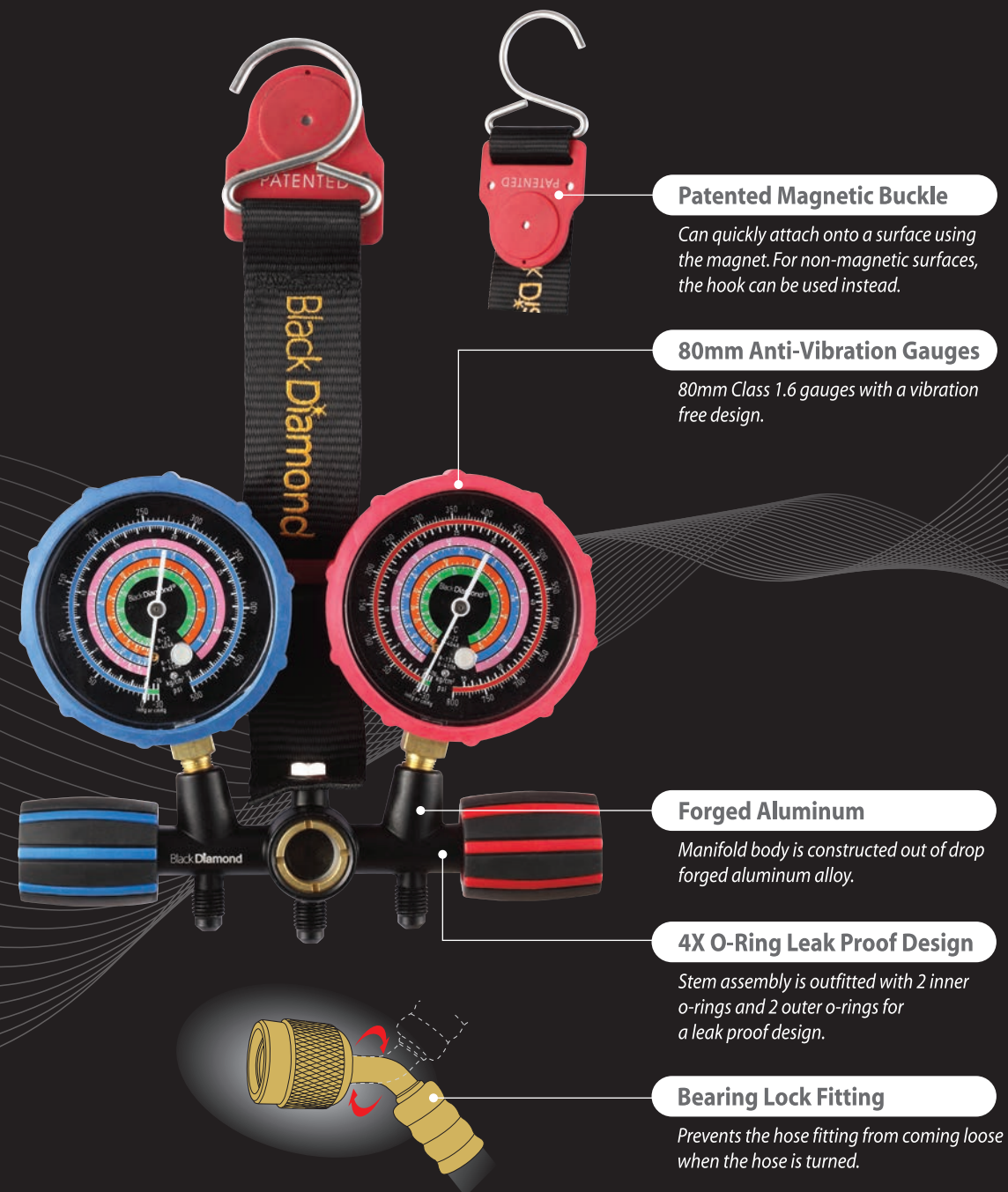

Manifold Gauge | R410 | R32 |

Model No.	Refrigerant Scale	Pressure Rating	Sight Glass	Hose Length	Gauge Fitting	Hose Fitting
27453	R410A, R32	800/4000psi	Yes	3"	Low & High Side: 1/4"	Straight End: 1/4"
27455				5"		
27456				6"		
27463			No	3"	Service Port: 1/4"	45° End: Low & High Side - 5/16" Service Hose - 1/4"
27465				5"		
27466				6"		
27553			Yes	3"	Low & High Side: 5/16"	Straight End: 5/16"
27555				5"		
27556				6"		
27563			No	3"	Service Port: 5/16"	45° End: 5/16"
27565				5"		
27566				6"		

Manifold Gauge | R22 | R134A | R404A | R410A |

Includes 2 pcs CB-R410-V adapter (1/4" Male X 5/16" Female with auto shut-off valve) and 1 pc CB-R410-04 adapter (1/4" Male X 5/16" Female).

Model No.	Refrigerant Scale	Pressure Rating	Sight Glass	Hose Length	Gauge Fitting	Hose Fitting	Converter
27853	R22 R134A R404A R410A	800/4000psi	Yes	3"	Low & High Side: 1/4"	Straight End: 1/4"	Includes: 2 pcs CB-R410-V 1 pc CB-R410-04
27855				5"			
27856				6"			
27863			No	3"	Service Port: 1/4"		
27865				5"			
27866				6"			

Manifold Gauge | R12 | R22 | R134A | R404A |

Includes 1 pc QC-MH4 and 1 pc QC-ML4 quick coupler (1/4" Male hose connection).

Model No.	Refrigerant Scale	Pressure Rating	Sight Glass	Hose Length	Gauge Fitting	Hose Fitting	Quick Coupler
27953	R12 R22 R134A R404A	600/3000psi	Yes	3"	Low & High Side: 1/4"	Straight End: 1/4"	Includes: 1 pc QC-MH4 1 pc QC-ML4
27955				5"			
27956				6"			
27963			No	3"	Service Port: 1/4"	45° End: 1/4"	
27965				5"			
27966				6"			



Patented | Manifold Gauges



Ball Valve Manifold Gauge | 90mm | R410A | R32 |

Ball valve design with compact 50 mm gauges. Manifold body is 90 mm long.

Model No.	Refrigerant Scale	Pressure Rating	Hose Length	Gauge Fitting	Hose Fitting
29473	R410A R32	800/4000psi	3"	Low & High Side: 1/4" Service Port: 1/4"	Straight End: 1/4" 45° End: Low & High Side - 5/16" Service Hose - 1/4"
29475			5"		
29476			6"		
29573			3"	Low & High Side: 5/16" Service Port: 5/16"	Straight End: 5/16" 45° End: 5/16"
29575			5"		
29576			6"		



Ball Valve Manifold Gauge | 120mm | R410A | R32 |

Ball valve design with large 80 mm gauges. Manifold body is 120 mm long.

Model No.	Refrigerant Scale	Pressure Rating	Hose Length	Gauge Fitting	Hose Fitting
29483	R410A R32	800/4000psi	3"	Low & High Side: 1/4" Service Port: 1/4"	Straight End: 1/4" 45° End: Low & High Side - 5/16" Service Hose - 1/4"
29485			5"		
29486			6"		
29583			3"	Low & High Side: 5/16" Service Port: 5/16"	Straight End: 5/16" 45° End: 5/16"
29585			5"		
29586			6"		

Ball Valve Manifold Gauge | 120mm | R22 | R134A | R404A | R410A |

Includes 2 pcs CB-R410-V adapter (1/4" Male X 5/16" Female with auto shut-off valve) and 1 pc CB-R410-04 adapter (1/4" Male X 5/16" Female).

Model No.	Refrigerant Scale	Pressure Rating	Hose Length	Gauge Fitting	Hose Fitting	Converter
29883	R22 R134A R404A R410A	800/4000psi	3"	Low & High Side: 1/4" Service Port: 1/4"	Straight End: 1/4" 45° End: 1/4"	Includes: 2 pcs CB-R410-V 1 pc CB-R410-04
29885			5"			
29886			6"			

Ball Valve Manifold Gauge | 120mm | R12 | R22 | R134A | R404A |

Includes 1 pc QC-MH4 and 1 pc QC-ML4 quick coupler (1/4" Male hose connection).

Model No.	Refrigerant Scale	Pressure Rating	Hose Length	Gauge Fitting	Hose Fitting	Converter
29983	R12 R22 R134A R404A	600/3000psi	3"	Low & High Side: 1/4" Service Port: 1/4"	Straight End: 1/4" 45° End: 1/4"	Includes: 1 pc QC-MH4 1 pc QC-ML4
29985			5"			
29986			6"			



Single Gauge Manifold | Low Pressure | R410A | R32 |

Single gauge design with a large 80mm vibration free gauge. Gauge boots included.

Model No.	Refrigerant Scale	Pressure Rating	Hose Length	Gauge Fitting	Hose Fitting
20413	R410A R32	800/4000psi	3"	Low Side: 1/4" Service Port: 1/4"	Straight End: 1/4" 45° End: Low Side - 5/16" Service Hose - 1/4"
20415			5"		
20416			6"		
20513			3"	Low Side: 5/16" Service Port: 5/16"	Straight End: 5/16" 45° End: 5/16"
20515			5"		
20516			6"		

Single Gauge Manifold | Low Pressure | R22 | R134A | R404A | R410A |

Includes 1 pc CB-R410-V adapter (1/4" Male X 5/16" Female with auto shut-off valve) and 1 pc CB-R410-04 adapter (1/4" Male X 5/16" Female).

Model No.	Refrigerant Scale	Pressure Rating	Hose Length	Gauge Fitting	Hose Fitting	Converter
20813	R22 R134A R404A R410A	800/4000psi	3"	Low Side: 1/4" Service Port: 1/4"	Straight End: 1/4" 45° End: 1/4"	Includes: 1 pc CB-R410-V 1 pc CB-R410-04
20815			5"			
20816			6"			

Single Gauge Manifold | High Pressure | R410 | R32 |

Single gauge design with a large 80mm vibration free gauge. Gauge boots included.

Model No.	Refrigerant Scale	Pressure Rating	Hose Length	Gauge Fitting	Hose Fitting
20423	R410A R32	800/4000psi	3"	High Side:1/4" Service Port:1/4"	Straight End: 1/4" 45° End: High Side - 5/16" Service Hose - 1/4"
20425			5"		
20426			6"		
20523			3"	High Side: 5/16" Service Port: 5/16"	Straight End: 5/16" 45° End: 5/16"
20525			5"		
20526			6"		

Single Gauge Manifold | High Pressure | R22 | R134A | R404A | R410A |

Includes 1 pc CB-R410-V adapter (1/4" Male X 5/16" Female with auto shut-off valve) and 1 pc CB-R410-04 adapter (1/4" Male X 5/16" Female).

Model No.	Refrigerant Scale	Pressure Rating	Hose Length	Gauge Fitting	Hose Fitting	Converter
20823	R22 R134A R404A R410A	800/4000psi	3"	High Side: 1/4" Service Port: 1/4"	Straight End: 1/4" 45° End: 1/4"	Includes: 1 pc CB-R410-V 1 pc CB-R410-04
20825			5"			
20826			6"			





Refrigerant Hoses | 600/3000psi |

All Black Diamond hoses have a patented Bearing Lock Fitting design. This design prevents the hose fittings from coming loose when the hoses are turned, preventing an accidental leak.

Model No.	Pressure Rating	Hose Length	Hose Fitting
23333	600/3000psi	3"	Straight End: 1/4"
23335		5"	
23336		6"	45° End: 1/4"

Refrigerant Hoses | 800/4000psi |

All Black Diamond hoses have a patented Bearing Lock Fitting design. This design prevents the hose fittings from coming loose when the hoses are turned, preventing an accidental leak.

Model No.	Pressure Rating	Hose Length	Hose Fitting
23433	800/4000psi	3"	Straight End: 1/4" 45° End: Low & High Side - 5/16" Service Hose - 1/4"
23435		5"	
23436		6"	
23533		3"	Straight End: 5/16" 45° End: 5/16"
23535		5"	
23536		6"	

Conversion Adapters

QC-MH4 Quick Coupler

Quick coupler for automotive A/C high pressure port. 1/4" male fitting for hose connection.

QC-ML4 Quick Coupler

Quick coupler for automotive A/C low pressure port. 1/4" male fitting for hose connection.

CB-R410-V

1/4" Male X 5/16" Female fitting with auto shut-off valve.

CB-R410-04

1/4" Male X 5/16" Female fitting.

Our Refrigerant Leak Detector uses state-of-the-art technology to quickly and accurately detect leak points in a system. The microprocessor is outfitted with an advanced signal processing unit. The infrared gas sensor has three sensitivity levels and an ambient concentration reset function that the user can adjust with to fit any working condition.



● **Advanced Digital Processing Unit**
Advanced microprocessor provides quick and accurate readings.

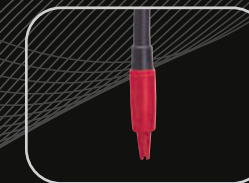

● **Infrared Sensor**
Accurate sensor with three sensitivity levels.

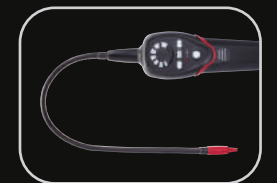

● **Stainless Steel Probe**
15.5" (40cm) flexible probe allows the user to detect leaks in hard to reach areas or tight spaces.

Model No.	Probe Length	Operating Temperature	Dimensions	Weight
26388	40cm (15.5")	0-40°C (32-104°F)	254 X 71 X 54 mm	420g

- Detects all current refrigerants
- Advanced Digital Signal Processing (DSP) Microprocessor
- Infrared Gas Sensor
- Multi-Color Display Interface

- Ambient Concentration Reset Function
- Three Sensitivity Levels: High-Med-Low
- 15.5" (40cm) Flexible Stainless Steel Probe
- Carrying Case Included

