



SGDC100-S Installation Instructions

177

10

		Ø4.2		M5
		Ø2.5		

- for EN2
- for EN3
- for EN4

FOLD HERE

ATTENTION: SPEED ADJUSTMENT VALVES ARE IN CLOSED POSITION AT FACTORY. PLEASE PROPERLY MAKE ADJUSTMENT FOLLOWING TO THE DIRECTION SHOWN WHEN INSTALLING. DO NOT ADJUST THE VALVES FOR MORE THAN 3 TURNS.

65

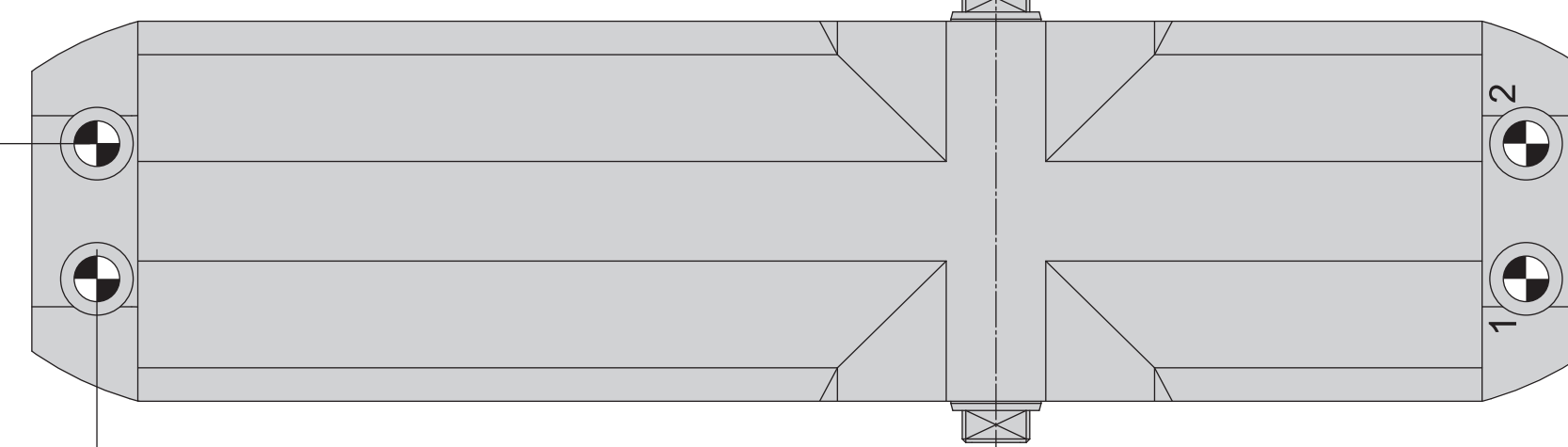

Parallel Fixing (66)

Power size	Max. Door width	Max. Door opening
EN3	950mm	160°

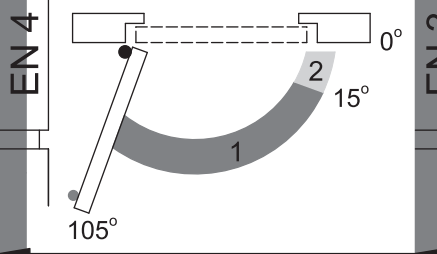
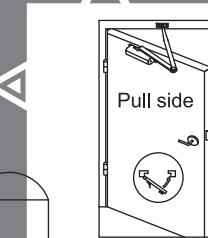

Power size	Max. Door opening
EN2	180°
EN3	180°
EN4	105°

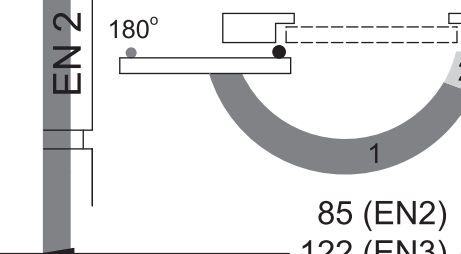
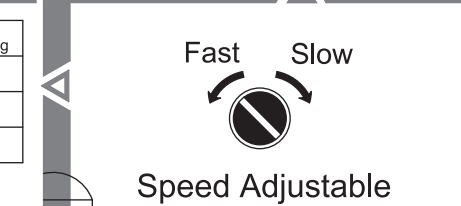

216(EN3)

102.5(EN4)

115(EN2)

45

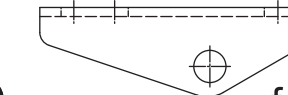

for EN 2/3

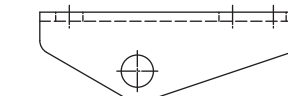

for EN 4

26

48

19

85 (EN2)

122 (EN3)

176 (EN4)

202

MAKE SURE YOU PRINT TEMPLATE TO SCALE



77

FOLD HERE

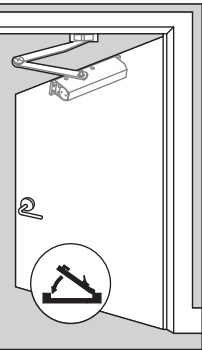

HINGE CENTRE

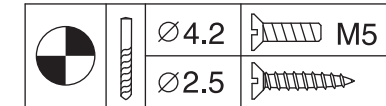

ATTENTION: SPEED ADJUSTMENT VALVES ARE IN CLOSED POSITION AT FACTORY. PLEASE PROPERLY MAKE ADJUSTMENT FOLLOWING TO THE DIRECTION SHOWN WHEN INSTALLING. DO NOT ADJUST THE VALVES FOR MORE THAN 3 TURNS.

Power size	Max. Door width	Max. Door opening
EN3	950mm	160°

Parallel Fixing (66)

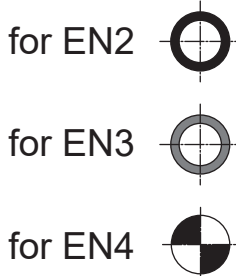
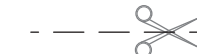

Power size	Max. Door opening
EN2	180°
EN3	180°
EN4	105°

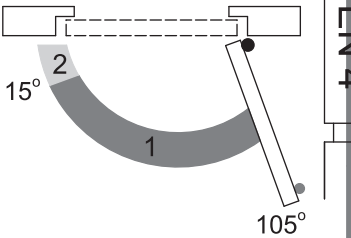
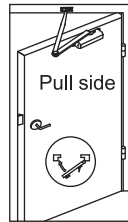

Fast Slow

Speed Adjustable

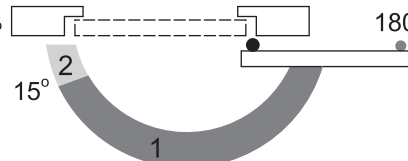

85 (EN2)
122 (EN3)
176 (EN4)

MAKE SURE YOU PRINT TEMPLATE TO SCALE

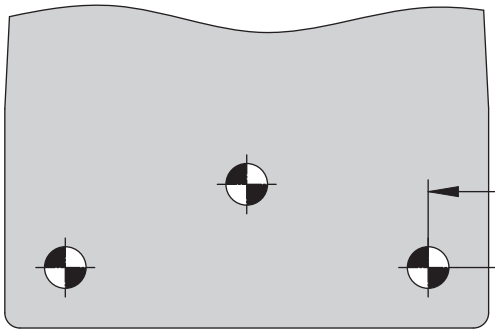
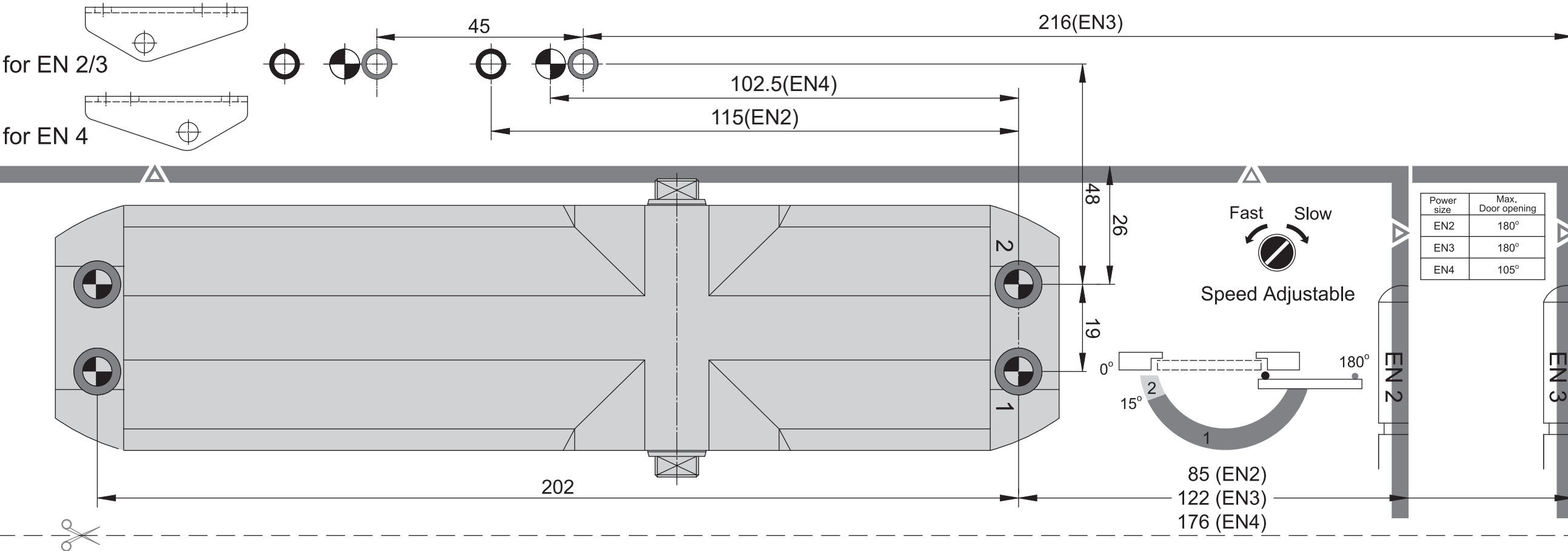

10