



Smart Door Lock

Art. **ELEV64**



Fingerprint



Digital
Password



APP



Key



Remote
Authorization



Smart Alarm



Battery
Powered



Emergency
Power Supply



Powerful
CPU



Easy
Installation

Contents of box

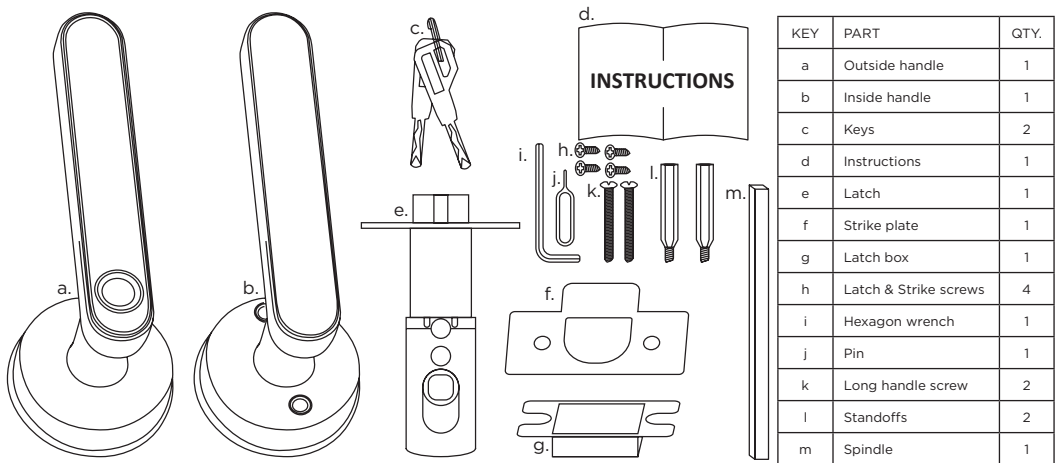

PLEASE READ ALL DIRECTIONS BEFORE STARTING INSTALLATION

Lock component overview

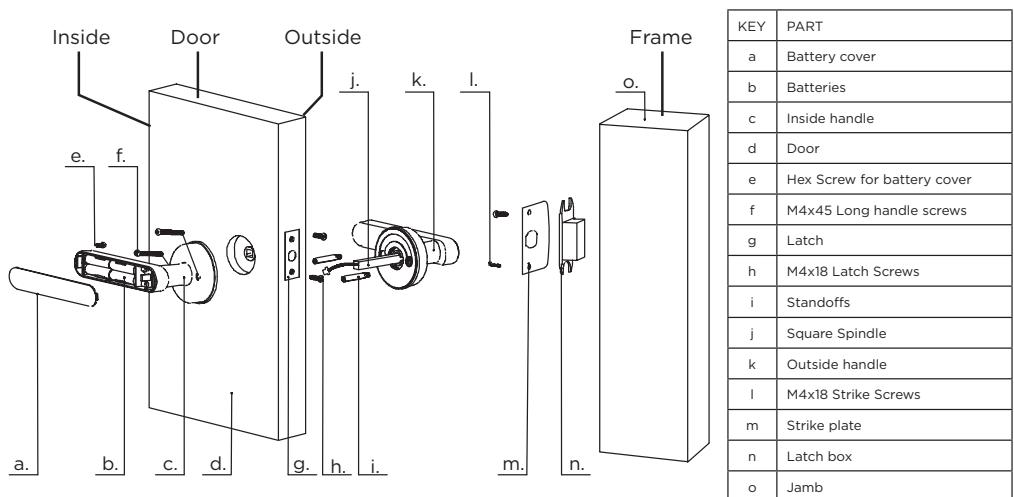

Factory default settings

Factory default: Any fingerprint can open the door

Factory default code : #123456#

Unlock by code:

1. Touch the # key to wake up the system;
2. Input code & Press #



LOCKTON
E-Series

Art. **ELEV64**

Preparing the door / Installing the Latch & strike

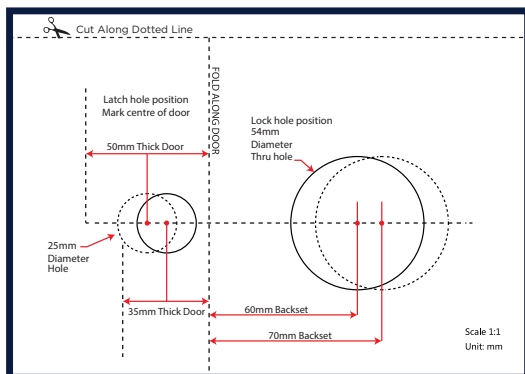
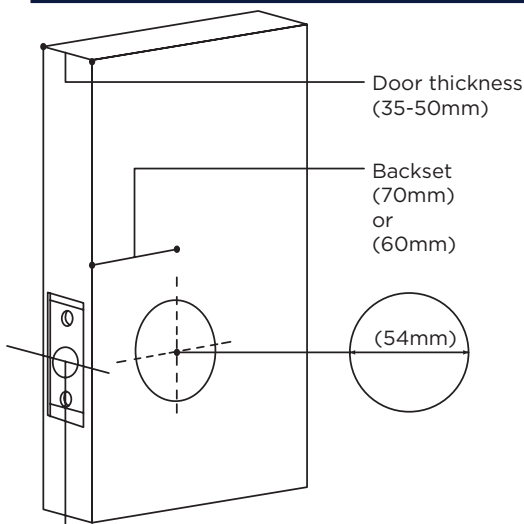

DRILL TEMPLATE AT BACK OF BOOK

1. MARK DOOR

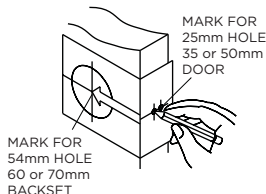

Start approximately 914mm from floor. Fold and apply template to edge of door and mark center of door edge as indicated on template. Mark center hole on door face through guide on template.

2. DRILL HOLES

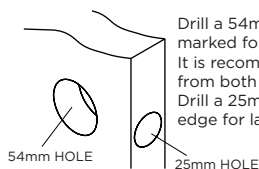

Drill a 54mm hole through door face as marked for lockset. It is recommended that holes be drilled from both sides to prevent splitting. Drill a 25mm hole in center of door edge for latch.

3. INSTALL LATCH

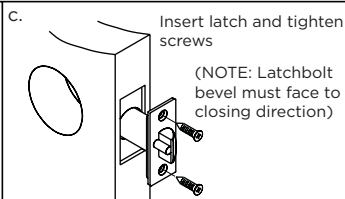
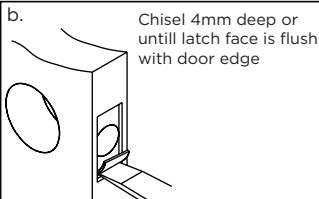
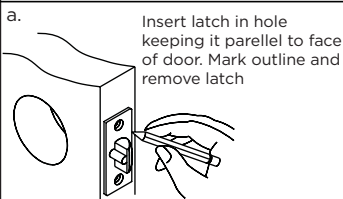

4. INSTALL STRIKE

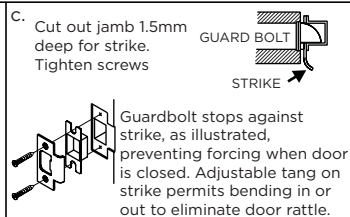
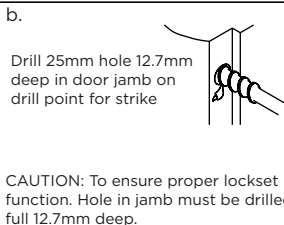
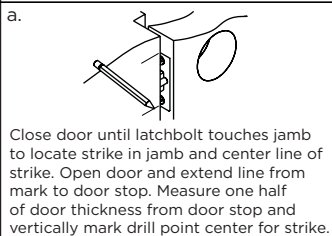

Detailed step-by-step Installation guide

1. Install the Latch



Push the latch into the Latch hole & install the two M4 x 18 Latch screws

2. Install outside handle



Secure the two standoffs into the outside handle

3. Install spindle



Put the power cord of the outside handle through the square spindle.

4. Install outside handle in latch



The square spindle passes through the square hole of the latch, Secure the handle.

5. Install the inside handle



Loosen the screw on the rear cover plate on the inside handle with a hex wrench and remove the battery cover.

6. Install outside power cord



Put one end of the power cord through the center hole of the outside handle.

7. Install long handle screws



Align the square spindle & install long handle screws to mount the inside handle to the outside handle

9. Install inside cover plate



Replace the battery cover and tighten the hex screw

8. Install the power cord & batteries

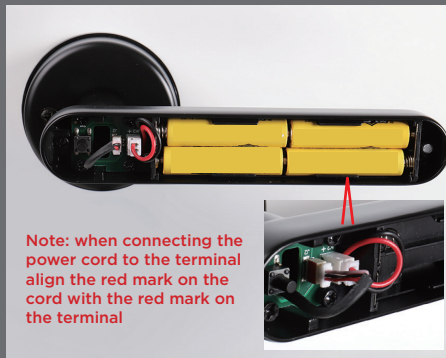

Note: when connecting the power cord to the terminal align the red mark on the cord with the red mark on the terminal

Plug in the power cord and install the batteries

10. Complete and test



After installation, check operation of handle before shutting the door

**TURN OVER FOR →
MOBILE APP SET UP**

Set up through mobile APP



 Fingerprint open the door

 Password open the door

 App open door

 Key to open the door

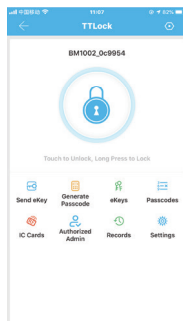

Google Play



App Store

The software(iOS version) can be downloaded from the App store, and the Android version can be downloaded from the application store of Google Play.

Registration and Login By App

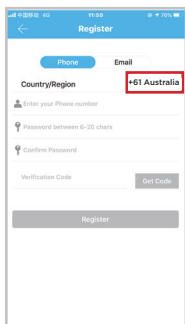
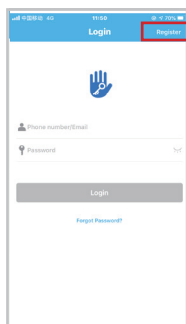

TTLock users can use their phone number or email to register their account. Currently, when users are registering their account, the verification code will be sent to the mobile phone or the email address. After the verification is passed, the registration is successful, and then the page will jump directly to the home page.

Main Interface Page

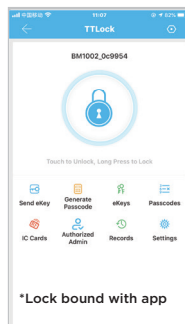
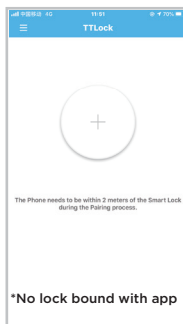

There is no lock or key data in the user's account, when TTLock App is used for the first time. The user can add a lock in the front page. If a lock is already added in the account, the lock information will be displayed. See below how to add a lock.

Add Lock By App

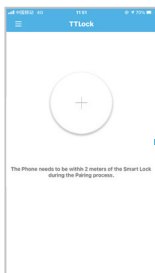

Add a lock

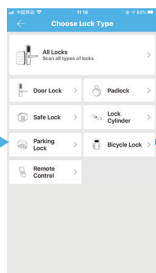

Select
"Door Lock"

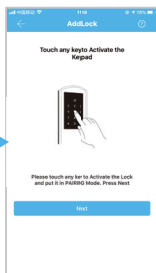

Light up
Touch Screen
by pressing #

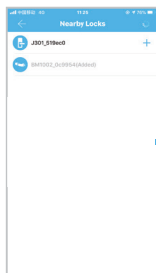

Select Lock



Input Lock
name

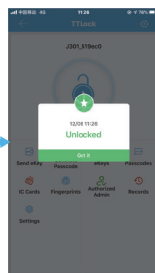

Operation
Successfull

*After adding the lock successfully, the user has the highest authority of the lock, which is the administrator of the lock.

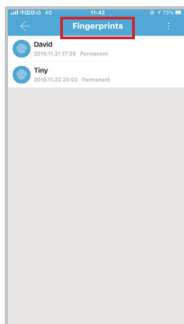
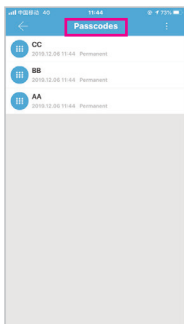
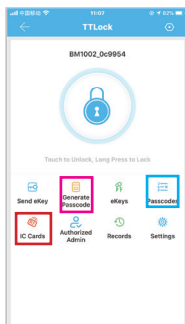

Registration and Login By App

In the main interface of the TTLock App, select **Generate Passcodes** to add users & pin codes for limited time or permanent access. Passcodes can be changed at anytime by selecting **Passcodes** on the main interface.

Fingerprints can be added & Deleted through the **Fingerprint** selection to add users & pin codes for limited time or permanent access on the TTLock main interface.

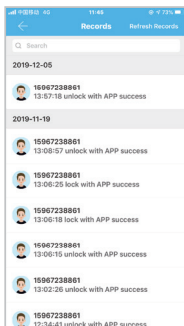
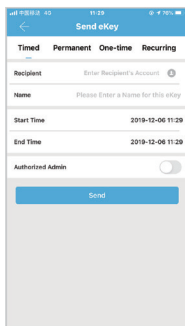

Send E-Key By App

The user can send a bluetooth key to others, and has the right to select a limited time, permanent or one-time Bluetooth key. The key is sent to the recipient's mobile phone or email and the recipient will get the key and authority of the lock in the TTLock App.

Administrators can manage all the keys they send out, including clearing keys, resetting keys, sending keys, adjusting the time limit of the keys, and viewing the access records.

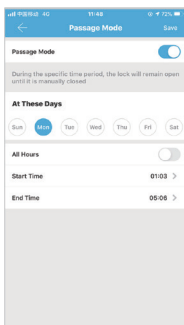
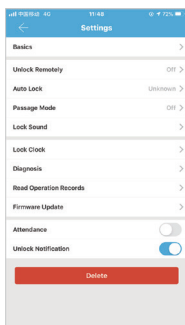

Passage Mode

In the main interface of the app, select Settings then passage mode to set the date, start time & end time of the passage mode. After the passage mode is activated, everyone can directly unlock the door without any access permission during the time & date's selected. The passage mode can be turned off in Settings.

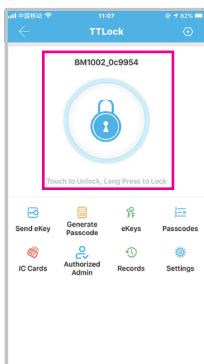

Unlock & Lock Using the App

On the main interface screen Bound Locks Can be easily Unlocked or Locked by pressing the Large Padlock icon.

If more than one lock is bound hit the back arrow in the Top Left corner to view & Select the required Lock.

Optional gateway set up - For Remote WiFi Controlling

The **ELEV64** in it's primary condition is controlled by Bluetooth requiring the user to be within proximity of the bound locks to Change Passcodes, Add Fingerprints, Review audit trails & Create Temporary Passkeys etc. To Manage these lock functions remotely anywhere, the Art. Id: G2-GATE can be purchased separately.

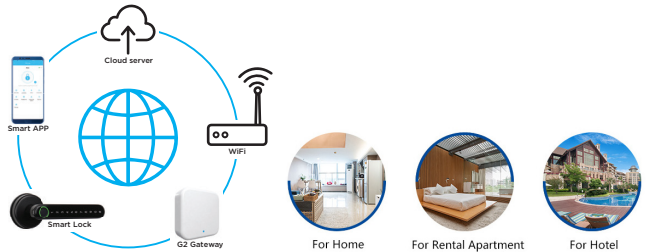

GATEWAY G2

Model : G2
Dimensions : 70mm x 70mm x 26mm
Network : WiFi 2.4G
IEEE standard : 802.11 b/g/n
Power interface : Type-C USB
Power input : 5V/500mA

Light Status



When the Gateway is powered on:

- Flashing Red/Blue lights:
• Stand-by mode - Ready to Pair
- Blue light: Normal mode
- Red light: Network failure

1

Open the APP



2

Touch the "≡" icon on the top left of the screen

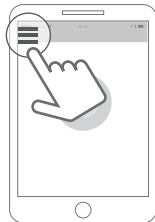

3

Select [Gateway]

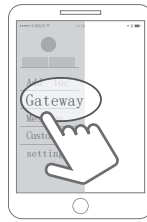

4

Select G2

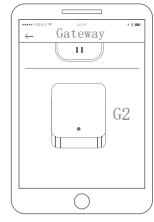

5

Plug in the Gateway and power it on

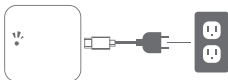

6

While the light is flashing in red and blue, press "+" sign



7

Add Gateway



8

Select the network and input your WiFi password

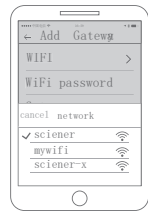



Cut Along Dotted Line

Fitting template

FOLD ALONG DOOR

Latch hole position
Mark centre of door

50mm Thick Door

25mm
Diameter
Hole

35mm Thick Door

Lock hole position
54mm
Diameter
Thru hole

60mm Backset

70mm Backset

Scale 1:1
Unit: mm

BACK OF TEMPLATE



LOCKTON

E - S e r i e s