

JMA[®]

USER MANUAL

BT MULTIUSER

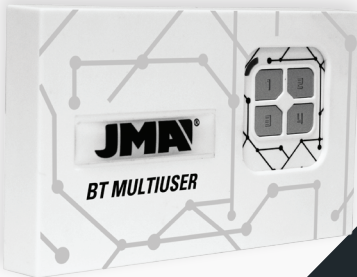

1 SYSTEM START-UP

Starting with an M-BT remote control onto which an original remote control has already been copied (see M-BT Remote Control Copy Manual), follow the steps below to start the BT Multiuser system:

1. Insert the batteries into the BT Multiuser Box
2. Insert the M-BT remote control into the BT Multiuser Box, connecting the power cable.
3. Download the JMARemotesUSER app and open it.

NOTE: When using an M-BT remote control purchased previously (black) for use with the BT Multiuser Box, **it will need to be updated** to maintain compatibility with the new Multiuser system. The update process is described in Section 4 and should be completed wherever the M-BT remote control or BT Multiuser Box adapter was purchased.

JMARemotesUser



Google Play



App Store



2 USING THE APP

2.1 Registration and Log In

The first time you open the BT Multiuser app, you will need to register.

Registration allows you to save the remote controls linked to the system and configure the open buttons in a database. This means you will always have access to your configurations regardless of the terminal on which the application is installed in the future.

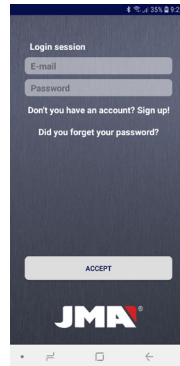

2.2 Linking Remote Controls and Open Button Configuration

Once the user has registered and logged in, the "Home" page will display 4 open buttons and a lower button marked "Edit Buttons".



Any open button from any linked remote control can be configured onto the 4 buttons on the screen.

Click "Edit Buttons" to access a screen showing all the remote controls that have been linked to the account.

If no remote controls have been linked or you wish to link a new one, click the "Link New Remote Control" button.

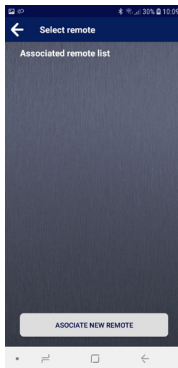

A new screen will open instructing you to press the 4 physical buttons on the M-BT remote control to begin the linking process. You need to hold the 4 buttons at the same time until the green LED on the M-BT remote control starts to flash. If it does not start to flash, it may be the case that the remote control has no free licences. See LICENCES under Section 3.



When the M-BT remote control starts to flash green, release the buttons and the M-BT remote control you have started to link will appear in the app.

Then click on this text and the linking process will continue. A screen will be displayed for entering a name and logo you wish to associate with the remote control being linked.

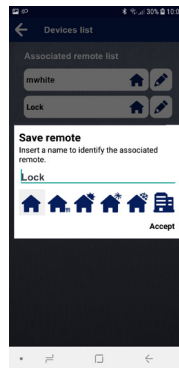

Once these have been entered, the new remote control will appear on the "List of Linked Remote Controls". The image below shows 2 linked remote controls with the names "mwhite" and "Lock", as well as the "Home" logo.

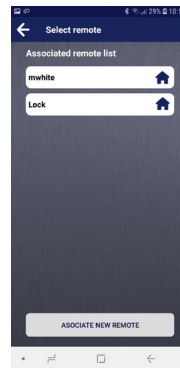

When clicking on one of them, the app will ask which physical button on the M-BT remote control you wish to activate when pressing the on-screen button.

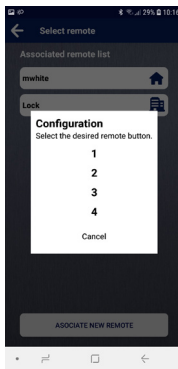

After selecting a button, this will appear configured on the home screen. The image below shows the physical buttons 1 and 2 from the linked remote controls "mwhite" and "Lock" configured on the home screen.



The buttons on the home screen can be edited at any time to link a different remote control or another button from a different M-BT remote control. Simply press "Edit Buttons" and press the one you wish to edit when they change to red. The list of linked remote controls will be displayed again and you can press any of them to change the button you wish to activate on the remote control.

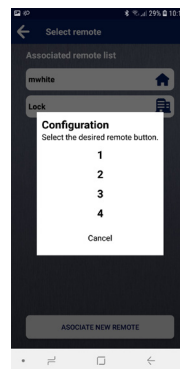
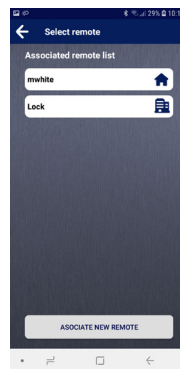

2.3 Sending Open Commands

Once the remote control has been linked and the open button configured on the home screen, the JMARemotesUSER app can now be used to send commands to the M-BT remote control connected to the BT Multiuser Box and activate the door opening mechanism. Make sure that the M-BT remote control is transmitting. To do this, hold buttons 2 and 3 until the green LED starts to flash.

As soon as the M-BT remote control starts to flash, release the buttons. The remote control will now be transmitting constantly and the app will be able to locate and activate the corresponding buttons.

Generally speaking, the app will take between 5 and 10 seconds to detect the remote control

that is transmitting provided that you are within Bluetooth range. Once detected, the buttons are activated and you will be able to press them from the app to send the opening command.

When the remote control receives the opening command and activates the RF connection, the button will be deactivated. Once the remote control has finished the RF transmission to the door receiver, the Bluetooth signal is reactivated and the app can detect it in order to reactivate the buttons.

Buttons from up to 4 physical M-BT remote controls can be active on the home screen if one button from each has been configured.



2.4 Settings Menu

The app has a settings menu with the following options:

1) List of remote controls

This option displays the remote controls linked to the app, allowing their name and logo to be changed or items to be removed from the list.

2) Consult, add or remove licences

See Section 3 of the LICENCES Manual

3) M-BT remote control reset

If, at any time, you see that the app detects a remote control and the buttons are active but the remote control or the door does not respond, this option can be used to fully reset the M-BT remote control.

4) Edit profile

This can be used to change the user password.

5) Change language

This can be used to select the language in which to use the app

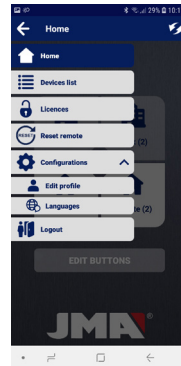

3 LICENCES

The BT Multiuser system is based on licences. A licence means a link between the account of a user and a remote control. A single M-BT remote control can be linked to as many users as licences it has.

When purchasing the BT Multiuser Pack, the remote control comes configured with 2 or 4 licences. Additional licence cards can be acquired subsequently at the points of sale where the product is sold.

When not purchasing the pack because the user already has an M-BT remote control, these cards must be purchased separately and as many licences as required inserted into the remote control.

These licences can be consulted, added or removed from the JMARemotesUSER app via the settings menu. The following

screen is displayed when selected "Licences" from the menu (see next page).

3.1 Add licence

Licence codes may contain 2, 4 or more licences, which will be installed in the M-BT remote control to which they are connected. After entering the code in the corresponding box and pressing "Send", the app will check whether the code is valid and how many licences it has.

When confirming the operation, you will need to select the remote control to which you wish to add the licences. Once selected, a confirmation message will be displayed showing the total licences for the remote control and the licences currently in use.

3.2 Remove licences

This option removes all the used licences from the remote control. The users that were linked to the remote control will need to complete the linking process again.

3.3 Consult licences

This option allows users to see how many licences the M-BT remote control has and how many of them are in use.

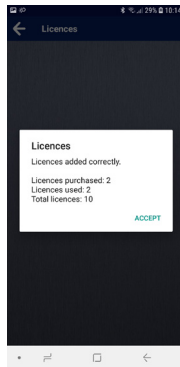
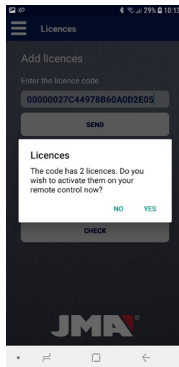
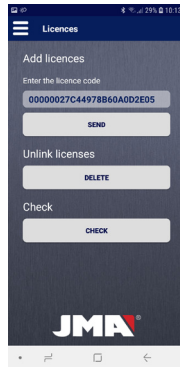

4 UPDATING THE FIRMWARE ON THE M-BT REMOTE CONTROL

For users who already have the M-BT remote control (black color)

Follow the steps below to update the M-BT remote control:

- Professional app for copying JMARemotesPro remote controls.
- The latest firmware version for the M-BT remote control can be found on the JMA website, in the M-BT remote control "Downloads" section. Use this QR code for direct access.

JMARemotesPro



After the update file has been downloaded onto the device with the JMARemotesPro app:

1. Open the app and select the "Update firmware" option from the "Settings" tab on the menu.

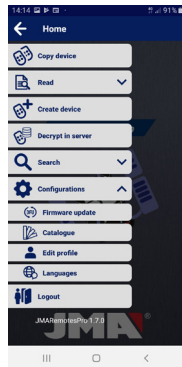

2. Press "Select file" on the "Update firmware" screen and, leaving the default "Distribution package (ZIP)" option, search the folders on your device (normally the Downloads folder) for the M-BT-TOTAL_Vx.zip file you downloaded.

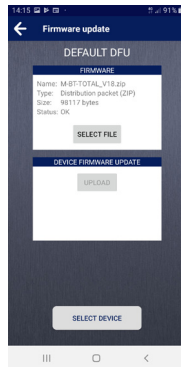
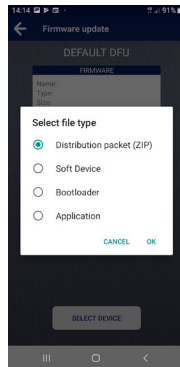

3. Hold buttons 2 and 4 on the M-BT remote control until the red LED starts to flash. The green LED will then remain lit.

4. In the app, press the "Select Device" button and search for the remote control called "M-BT-DFU".

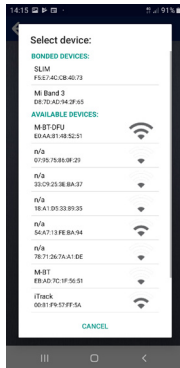

5. Press the Update button. The update will begin and the remote control will change to red and then switch off when the process is complete.

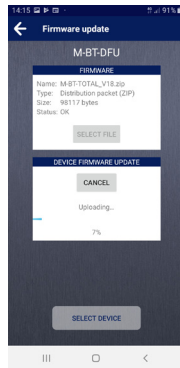

BT MULTIUSER - MANUEL D'UTILISATION

BT Multiuser est un système qui permet l'ouverture de portes de garage, de barrières ou d'accès depuis le téléphone portable d'un ou plusieurs utilisateurs via Bluetooth.

Le système est composé des éléments suivants :

- Télécommande M-BT avec licences utilisateurs.

La télécommande M-BT doit contenir au préalable une copie d'une télécommande originale. (Voir Manuel de copie de la télécommande M-BT).

Pour tout ce qui concerne les licences utilisateurs, veuillez vous reporter à la section LICENCES au point 3.

- BT Multiuser Box : bloc d'alimentation / adaptateur où la télécommande M-BT doit être logée.
- 4 piles AA qui doivent être insérées dans le BT Multiuser Box pour alimenter la télécommande M-BT en permanence. (Piles non fournies)
- Application mobile gratuite JMARemotesUSER.

Remarque : BT Multiuser est disponible en deux versions :

- 1) Pack BT Multiuser : comprend tous les éléments décrits ci-dessus, à l'exception des piles.
- 2) BT Multiuser Box : comprend uniquement la base pour les piles et la télécommande. Cette version est destinée aux utilisateurs qui disposent déjà d'une télécommande M-BT. Cette télécommande doit être associée à des licences utilisateurs, comme expliqué dans la section LICENCES de ce manuel.

JMA[®]

Tel +34 943 79 30 00

Fax +34 943 79 72 43

Bidekurtzeta, 6 P.O.Box - Apdo. 70

20500 Arrasate - Mondragón

Gipuzkoa – SPAIN

*www.**altuna**.com*

*www.**jma**.es*