

### Installation Guide

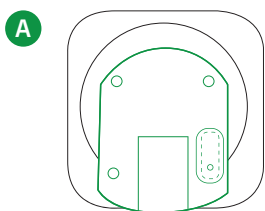

Remove Easy-fix mounting support back part.

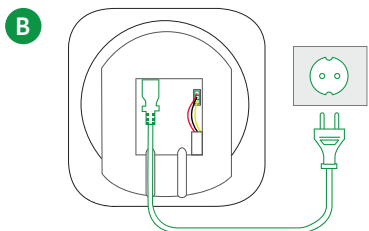

Connect the power to the Control Unit, using the power supplied.  
Connect the battery through the appropriate connector. Alternatively you can power the Central using a 12 V DC source through the supplied terminal block.

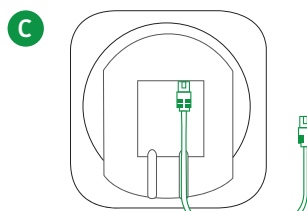

Connect the Ethernet cable to a router or internet outlet. The initial configuration of the operating parameters requires the use of an Ethernet connection with internet access.

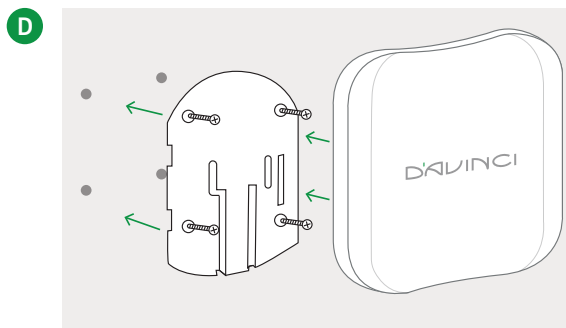

Fix the Lisa Panel Controll to the wall using the dowels and installation kit screws.

### Control panel configuration via App D'AVINCI

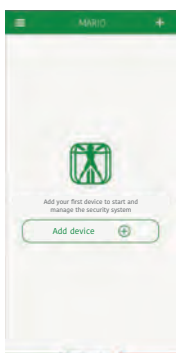

Run the app and add Lisa Control Panel.



Scan the QR code present on the Control Panel, Insert the name of the plant (e.g.: Office, Home, etc.).

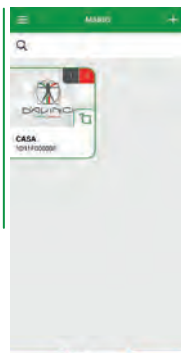

Verify that the device is been added correctly. Subsequently add environments and proceed with the parameter configuration. In case of addition of additional devices to the plant, follow the guide to the device to be associated.



download from  
Google Play



download from  
App Store

Install the **D'AVINCI application** on your smartphone (iOS / Android). As soon as you start the App, follow the procedure to register your account (email entry, number telephone) and wait for the request from the Cloud D'AVINCI. Connect to your e-mail and validate the registration using the code you received. Access the app to verify that the transaction has been successful.

### Gestione segnalazioni

The LED of the Control Panel characterizes the state of the system or the events that occur.  
The D'AVINCI logo on the front of the Central can light up in red, white, green depending on the state.

INDICAZIONE	EVENTO
The three D'AVINCI logo LEDs lit in fixed mode in the sequence green - white - red	Regular state and implant not inserted
The full D'AVINCI logo in fixed red mode	State implant inserted
The full D'AVINCI logo in fixed blue mode	State implant Stay mode
LED left green off	Panel Control not connected to the D'AVINCI Cloud
LED left green flashing light	Panel Control connected to the D'AVINCI Cloud
LED left green lit in fixed mode	Regular connection to the D'AVINCI Cloud
White central LED flashing light	LTE module anomaly (Sim not entered, network search)
White central LED in fixed mode	Regular cellular connection (regular LTE module)
Central yellow LED in fixed mode	Connection to the Cloud through the Carrier backup, LTE module
Flashing red LED on the right	Associated devices radio fault
Red LED on the right in fixed mode	Regular status of paired devices

### Technical specifications

Type	Wireless central unit 868 MHz;WiFi +Ethernet module and 4G LTE communicator	Installation	Indoor
Power supply	230 V AC / 12 V DC Built-in backup battery: Li-Ion 3000 mAh	Protection class	IP40
Radio range	Up to 2000 meters in open space	Operating temperatures	From -10°C a +40°C
Manageable wireless devices	Up to 200	Maximum allowable humidity	Up to 75%
Sirens	Max 6	Dimensions	170X165X50
Users allowed	Max 200	Weight	150 grams
Environments	Max 30		
Repeaters	Max 5		
Encryption	Proprietary protocol based on AES		
Anti-sabotage protection	- Antijammer - Anti-tampering (anti-tear) and anti-opening tamper		
Radio communication protocol	GENIO		
Operating frequencies	868.00 MHz, 868.20 MHz, 868.60 MHz, 868.95 MHz, 921.00 MHz, 921.20 MHz, 921.60MHz, 921.80 MHz. *based on the sales region.		
Communication channels	Ethernet; WiFi(802.11b/g/n); 4G LTE; 2G Voce		
Sim card supported	Micro SIM		