

HMVA-HV150H HAMMER VALVE Steel

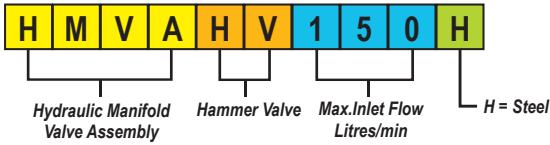

HMVA



Specifications	
Material :	Steel - S1214
Max. Working Pressure :	350 Bar
Surface Treatment :	Zinc Gold Passivation
Included Components	
Priority Flow Regulator :	1 each PFD-3
Priority Needle Valve :	1 each PFN-3
Solenoid Valve (S207V) & Coil :	12V(C13H12/22-12v) OR 24V(C13H24/22-24v)
Relief Valve :	1 each 1DR2P40S
Plugs :	4 each 5/16" UNF , 1 each 1/4" BSPP & 1 each 3/8" BSPP



Technical Details

OPERATION

Inlet flow passes through the adjustable orifice and the radial holes in the spool/sleeve assembly then out of the regulated port.

Regulated Flow 95 L/min



OPERATION

The adjustable relief valve vents the spring chamber at the pressure and diverts the flow to the bypass port. It may be necessary to fit a 10 bar check valve in the bypass or regulated line to ensure the valve switches fully.

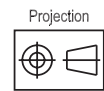
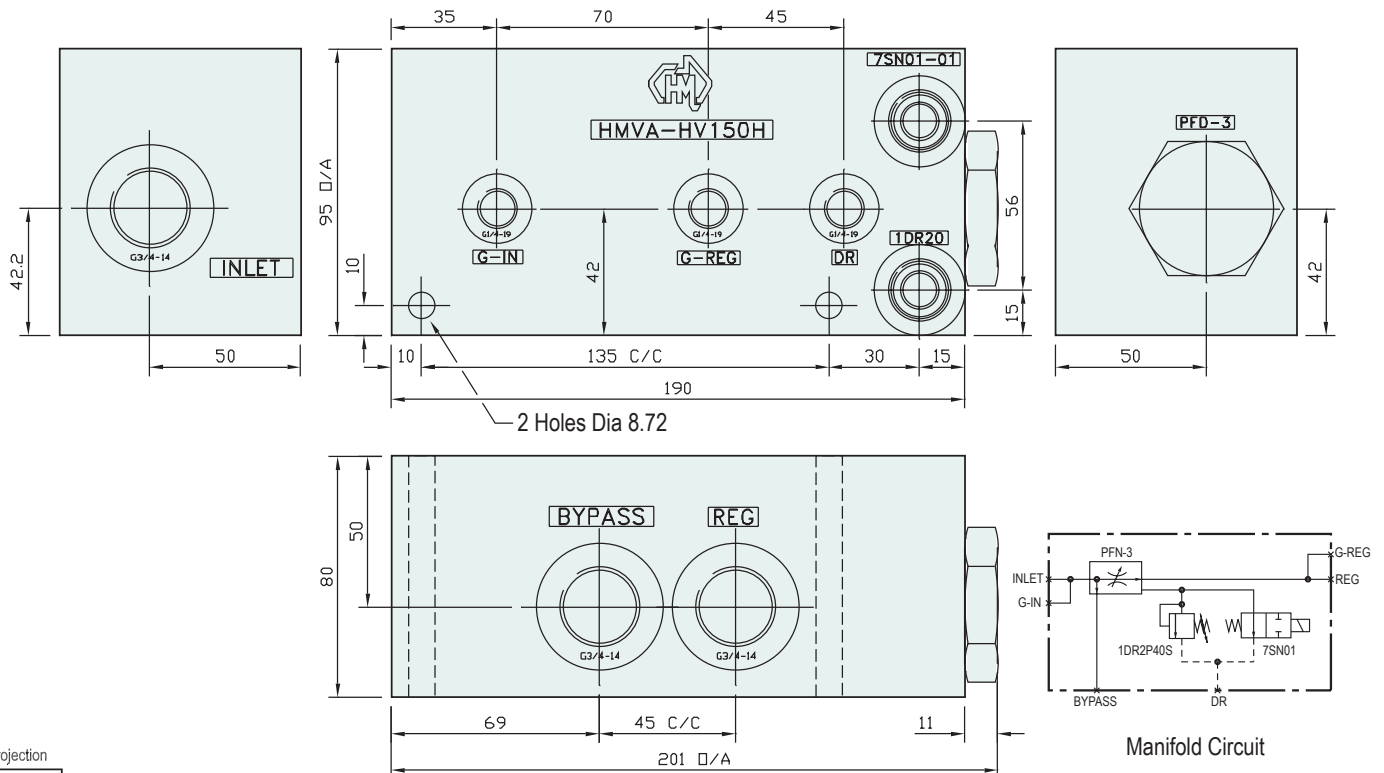

Part Number	Bypass Port	Reg Port	G-In Port	G-Reg Port	Inlet Port	Dr Port	Nominal Mass Kg
HMVA-HV150H	3/4" BSPP	3/4" BSPP	1/4" BSPP	1/4" BSPP	3/4" BSPP	1/4" BSPP	10.0