

Specifications	
Material :	Steel - S1214
Max. Working Pressure :	Steel - 250 Bar
Surface Treatment :	Steel - Zinc Gold Passivation
Port Sizes :	LS- 1/8" BSPP
Included Components	
O-Rings :	4 each station N9-012
CP-104 Load Sense Check Valves :	2 each station
Plugs :	1 each station 1/8" BSPP

Technical Details

Load Sense Check Valve

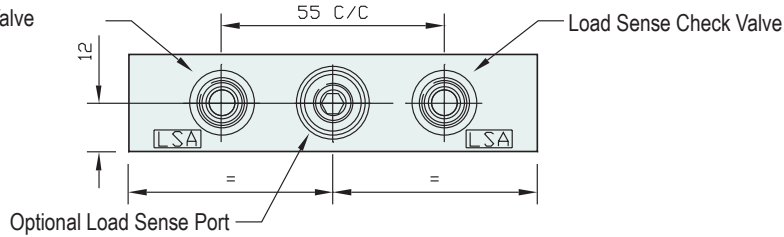

Load Sense Check Valve

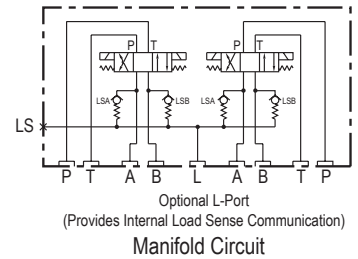
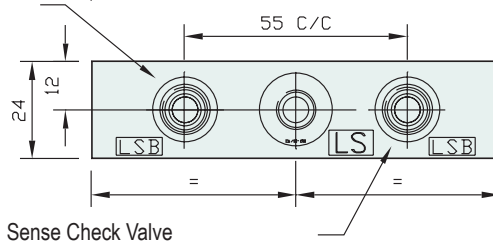
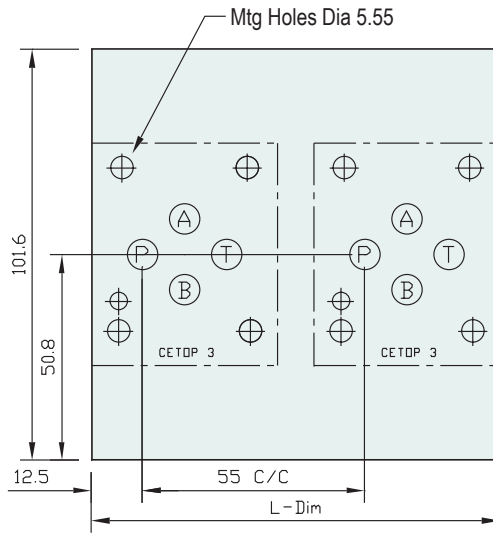

Part Number	L Dim	Nominal Mass Kg
HVSC3LS1H	46	0.8
HVSC3LS2H	101	1.8
HVSC3LS3H	156	2.8
HVSC3LS4H	211	3.8
2 OR MORE STATIONS MADE TO ORDER		



CP-104 - Load Sense Check Valves
Available Separately

Part Number	L Dim	Nominal Mass Kg
HVSC3LS5H	266	4.6
HVSC3LS6H	321	5.6
HVSC3LS7H	376	7.6
HVSC3LS8H	431	8.6