

SERIES 8

SPECIFICATIONS

Wattage: Nominally 16 watt at 68°F./20°C.

Duty Rating: Continuous up to 115% voltage.
Except **Conduit** which has an intermittent Duty Rating.

Ambient Operating Temperature: 212°F/100°C

Encapsulating Material: Thermoplastic Polyester (PET) (Rynite FR530).

A.C. Coils: Internally rectified with a full wave bridge (no inrush current).

Termination Options: See below and on the next page.

| VOLTS | 16 WATT | |
|--------|---------|-----------------------------|
| | OHMS | INITIAL CURRENT DRAW (AMPS) |
| 10 DC | 6.2 | 1.60 |
| 12 DC | 9.0 | 1.33 |
| 20 DC | 25.0 | .80 |
| 24 DC | 35.8 | .67 |
| 120 AC | Δ827 | .15 |
| 240 AC | Δ3306 | .07 |

ΔRESISTANCE CANNOT BE MEASURED ON AC COIL ASSEMBLIES

DUAL LEAD

CODE - **DS

| VOLTS | PART NO. | CODE | LEAD COLOR |
|--------|----------|-------|------------|
| 10 DC | 10205-94 | D10DS | GREEN |
| 12 DC | 10184-42 | D1DS | RED |
| 24 DC | 10184-37 | D2DS | BLUE |
| 120 AC | 10184-49 | A5DS | BLACK |
| 240 AC | 10184-53 | A6DS | YELLOW |

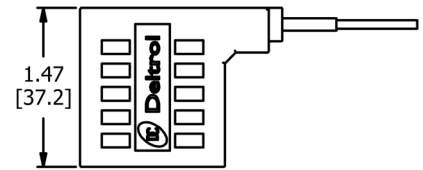
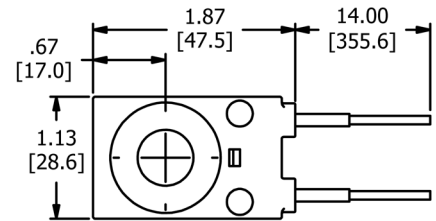

FOR INTERNAL DIODE – CONSULT FACTORY

SINGLE LEAD

CODE - **SS

| VOLTS | PART NO. | CODE | LEAD COLOR |
|-------|----------|-------|------------|
| 10 DC | 10194-19 | D10DS | GREEN |
| 12 DC | 10184-32 | D1DS | RED |
| 24 DC | 10190-44 | D2DS | BLUE |

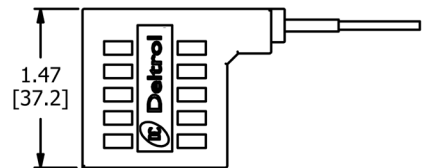
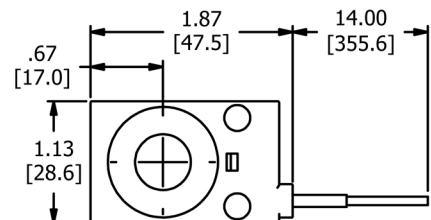

DUAL SPADE

CODE - **BS

| VOLTS | PART NO. | CODE |
|--------|----------|-------|
| 10 DC | 10221-46 | D10BS |
| 12 DC | 10216-12 | D1BS |
| 20 DC | 10222-51 | D20BS |
| 24 DC | 10216-11 | D2BS |
| 120 AC | 10222-49 | A5BS |
| 240 AC | 10222-50 | A6BS |

TERMINATION:
1/4" MALE QUICK-CONNECT
PER SAE J858A (TYPE 1B)

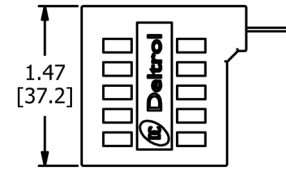
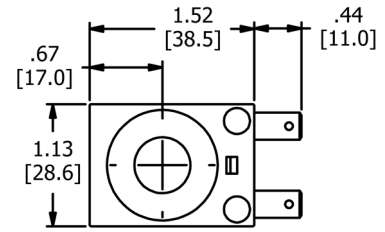

FOR INTERNAL DIODE – CONSULT FACTORY

SINGLE SPADE

CODE - **AS

| VOLTS | PART NO. | CODE |
|-------|----------|-------|
| 10 DC | 10222-46 | D10AS |
| 12 DC | 10221-30 | D1AS |
| 24 DC | 10221-47 | D2AS |

TERMINATION:
1/4" MALE QUICK-CONNECT
PER SAE J858A (TYPE 1B)

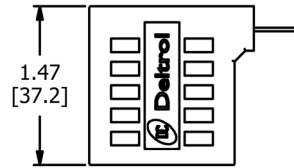
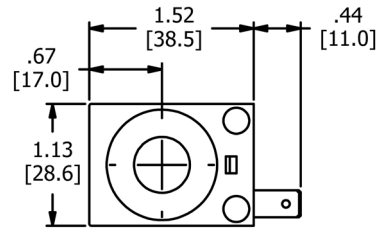

SINGLE STUD

CODE - **ES

| VOLTS | PART NO. | CODE |
|-------|----------|-------|
| 10 DC | 10196-60 | D10ES |
| 12 DC | 10196-61 | D1ES |
| 24 DC | 10196-62 | D2ES |

TERMINATION:
8-32 MALE STUD
WITH BRASS NUTS

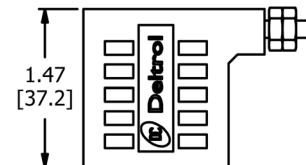
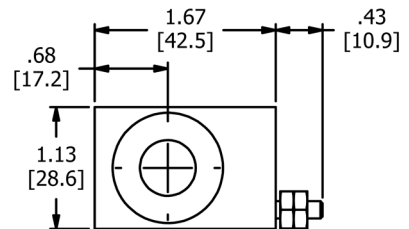

S-Coil, Series 8

Internal Frame (continued)

SERIES 8

DEUTSCH - IP67 rated

CODE - **US

| VOLTS | PART NO. | CODE |
|-------|----------|-------|
| 10 DC | 10210-13 | D10US |
| 12 DC | 10222-99 | D1US |
| 20 DC | 10228-95 | D20US |
| 24 DC | 10228-52 | D2US |

TERMINATION:
 INTEGRAL DEUTSCH CONNECTOR
 DT04-2P
 MATING CONNECTOR
 DT06-2S

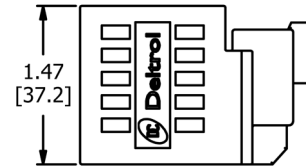
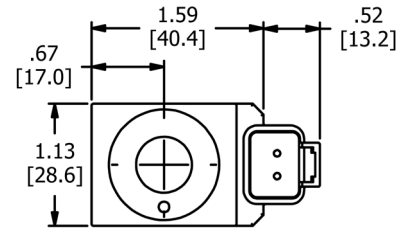

FOR INTERNAL DIODE – CONSULT FACTORY

DIN 43650 (HIRSCHMANN®)

CODE - **HS

| VOLTS | PART NO. | CODE |
|--------|----------|------|
| 12 DC | 10246-17 | D1HS |
| 24 DC | 10246-18 | D2HS |
| 120 AC | 10246-43 | A5HS |
| 240 AC | 10246-20 | A6HS |

TERMINATION:
 HIRSCHMANN GSR 200
 (2 POLE + GROUND APPLIANCE PLUG)
 MATING CONNECTOR 43650

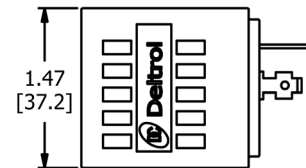
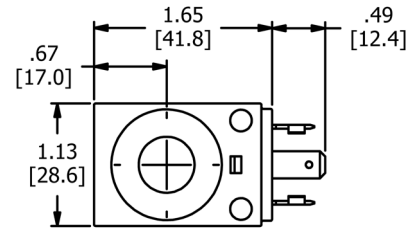

CONDUIT (FEMALE 1/2-14 NPT)

CODE - **C

| VOLTS | PART NO. | CODE | LEAD COLOR |
|--------|----------|------|------------|
| 120 AC | 10148-70 | A5C | BLACK |
| 240 AC | 10176-89 | A6C | YELLOW |

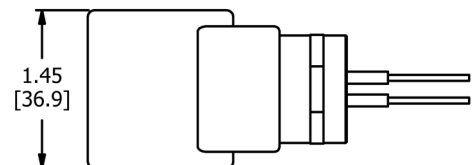
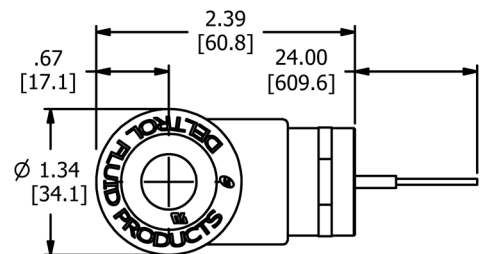

Duty Rating: Intermittent

LEAD WIRES: 18/20 GAUGE MEETS SAE J1128 XLPE, TYPE SXL.