

**Miles Nelson®**  
**Architectural Hardware** est. 1928

# Programming Instructions

The factory default access code is **123456**. For security reasons we recommend you program a **Master Code** straight after installation. This will delete the 123456 access code and allows you to program any of the following six functions. (The lock is in factory default mode when new, when reset or when all users are deleted).

All programming must be done when the unit is unlocked, and the door is open to prevent being locked out.

**In the programming menu there are six options, as listed below:**

1. Add a user. (Code, Remote, FOB)
2. Delete a user. (Code, Remote, FOB)
3. Language setting (toggles between English OR Mandarin).
4. Silent (MUTE) mode.
5. Vacation mode
6. Master code

## CODE SEQUENCE

All User codes entered are stored in a number sequence 001 to 050 so they can be deleted individually.

- 001 – 003 Master program codes (for programming).
- 004 – 050 User codes (for codes, remote, FOBs).

**Note:** Any programming changes or entries need to be completed within 12 seconds, for the changes to be accepted by the unit.

## Step 1 - Set Program Master code

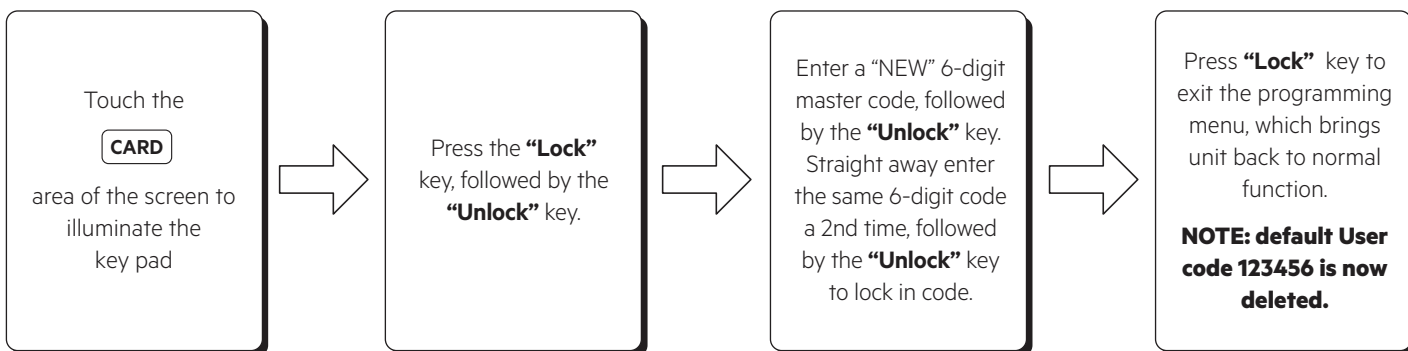

**Note:** You can now add another two master codes (see 6). Master codes can also be used to unlock the door.

Code Sequence	Name	Mastercode					
001							
002							
003							

## Programming Menu

### 1. ADD NEW USER CODE

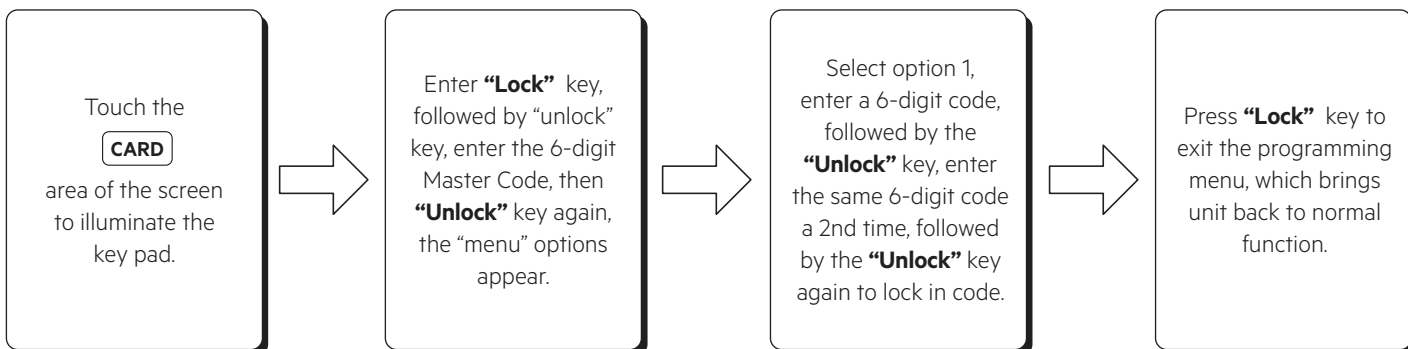

**Note:** Keep a record of the code sequence given to each user.

## 1.1 ADD NEW FOB

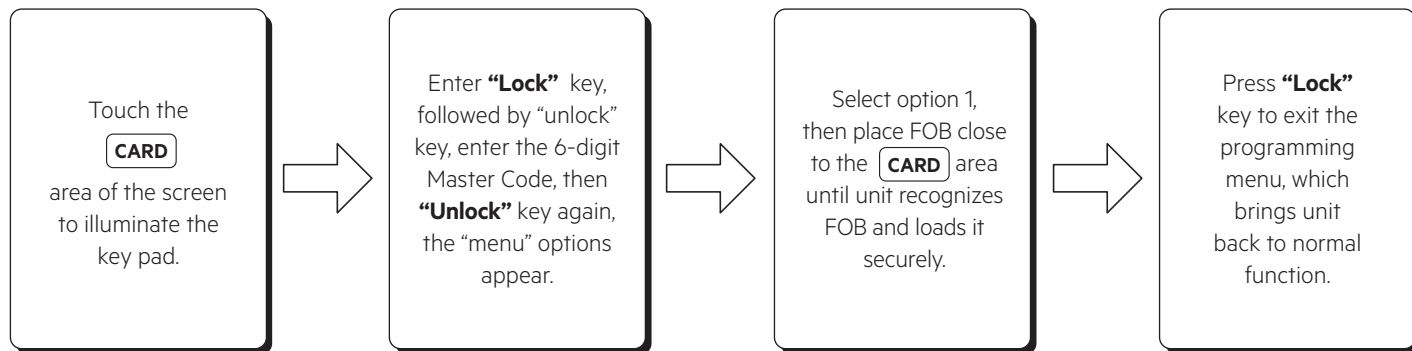

## 1.2 ADD NEW REMOTE

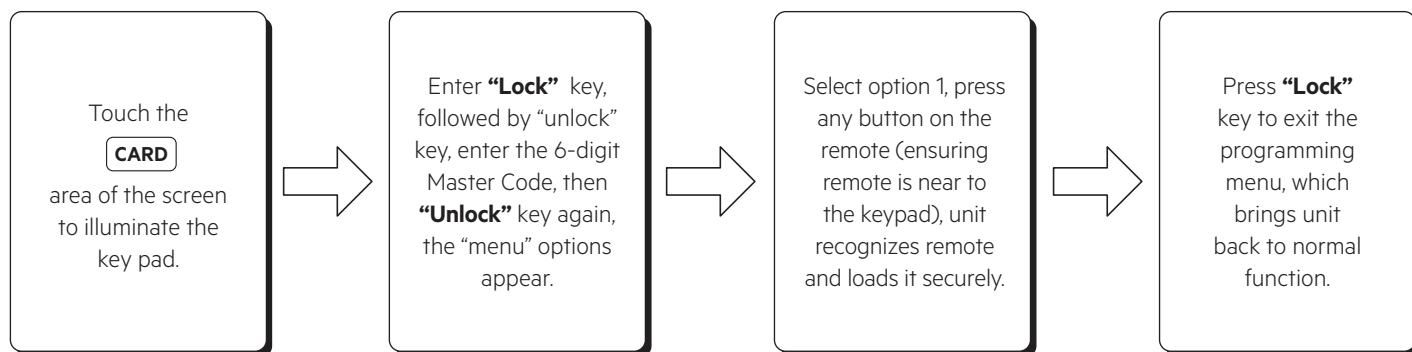

## 2. DELETE INDIVIDUAL MASTER CODES (001-003). USER CODES, REMOTES OR FOBS (USERS 004-050)

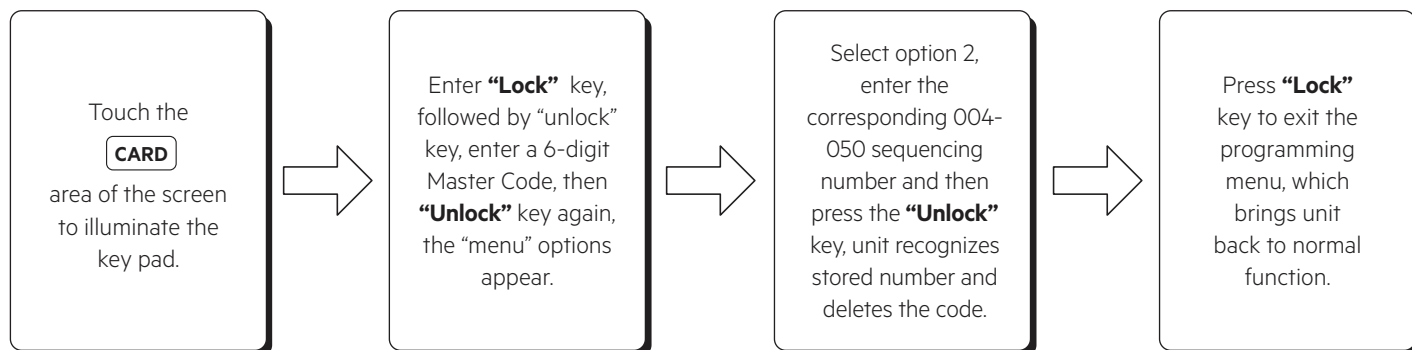

### 2.1. DELETE ALL MASTER CODES, USERS, REMOTES AND FOBS (Resets to factory default access code 123456)

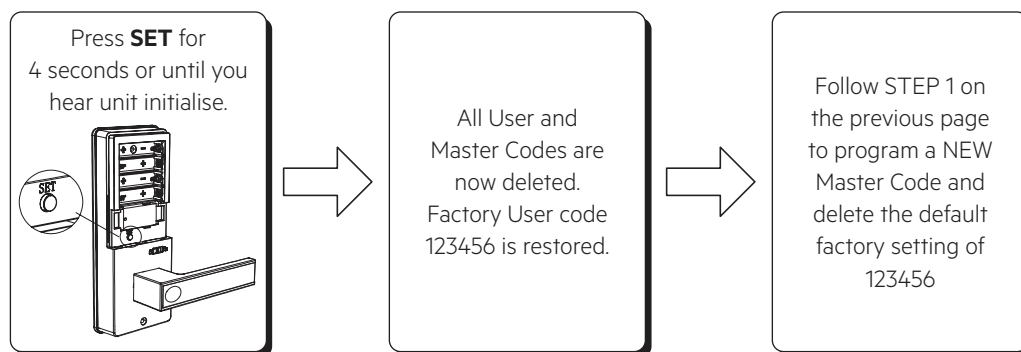

### 3. LANGUAGE SETTING

The default language setting is English, however the unit comes with a Mandarin Chinese language setting as well.

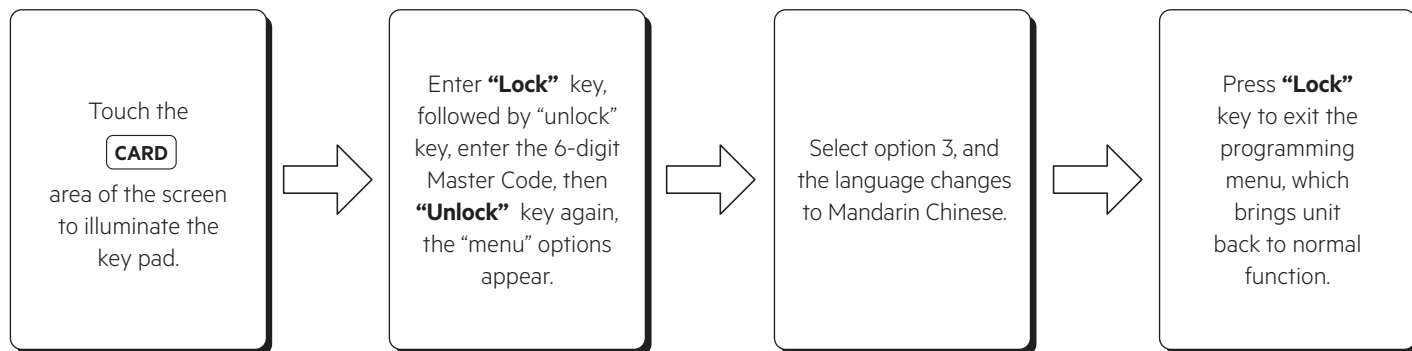

**NOTE:** To revert to English, repeat the above steps.

### 4. SILENT (MUTE) MODE

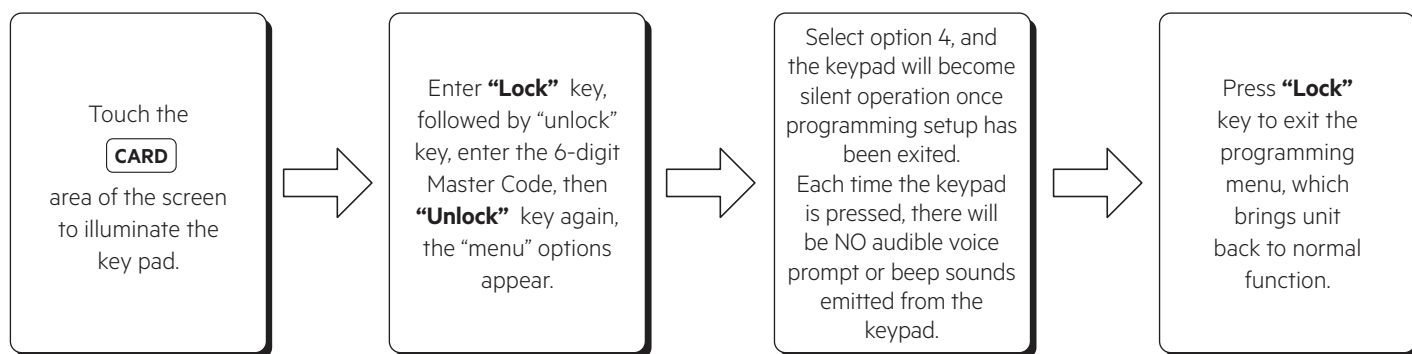

**NOTE:** To revert to sounded keypad, follow the above steps.

### 5. VACATION MODE

This feature offers increased security when the occupants have gone on vacation, and wouldn't want certain users to have access to the property.

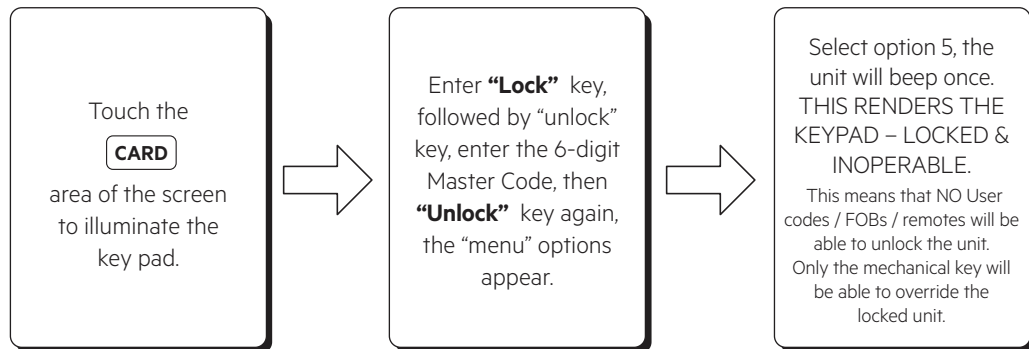

**NOTE:** To return the lock back to normal function: Enter Master Code then press the "Unlock" key for "3 SECONDS" to return lock back to normal function. You will hear one beep which cancels the vacation mode.

### 6. MASTER CODE

The system allows for upto three Master Codes

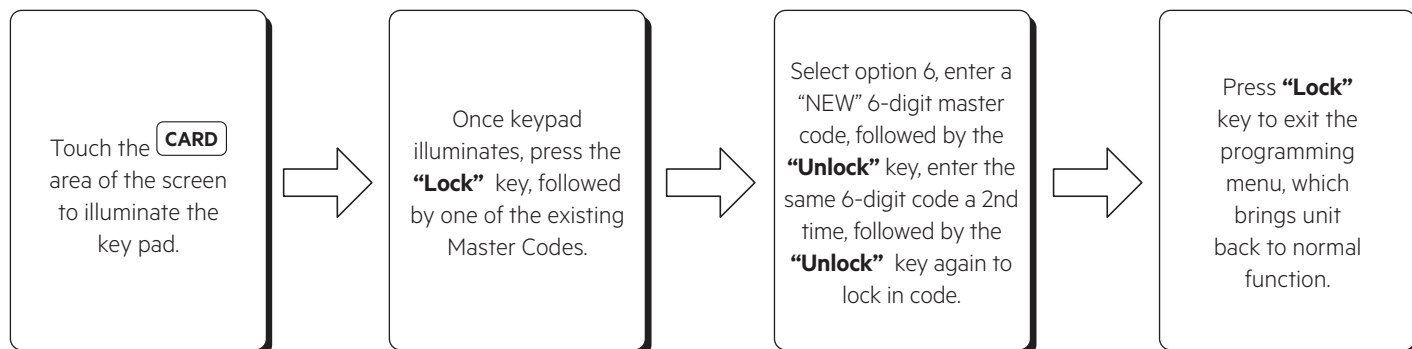

# Specifications and functions

## Exterior key pad

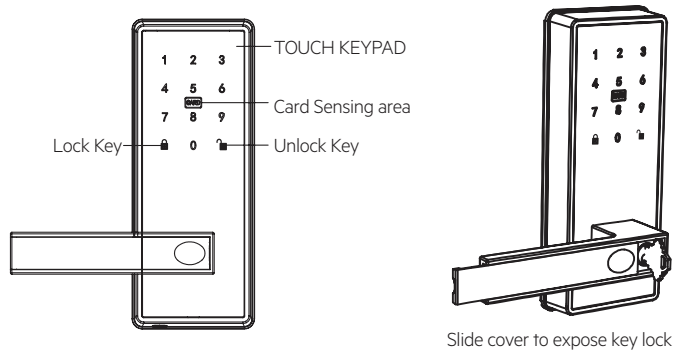

### Important notes:

The unit comes pre-set with User code: 123456 (6-digit) access code. Once installed for the first time, it is recommended to change the default User code to a new 6-digit User code prior to continuing with other programming.

### POWER SUPPLY:

4 x AA, 1.5V batteries (included).

### LOW VOLTAGE BATTERY FUNCTION:

- When battery is under low voltage, the unit will beep once during each operation to indicate low voltage.
- The unit will continue to operate for approximately 100 times after the first beep sounds, alerting occupants to replace the batteries.
- Locking and / or unlocking of the unit will be affected if the batteries are not replaced in a timely manner.
- The mechanical key is still able to unlock / lock the unit should the batteries fail at any time.

### ENTRY CODE DISGUISE FUNCTION:

- This function is an added security feature to prevent passcode theft.
- With passcode disguise function, extra digits can be entered into the keypad, provided the correct 6-digit User code is entered amongst the extra digits. Regardless of how many digits are entered before or after the correct 6-digit User code, the unit will unlock.
- For example, if your User code is 123456, you can successfully unlock the unit by entering "xxxxx123456xxxx"
- If the wrong User code is entered 6 times or more, the keypad is locked, and the unit enters sleep (lockout) mode for 1 min. After 1 min has lapsed, to exit sleep mode, enter the correct User code.

### PASSAGE / PRIVACY MODE SECURITY FEATURE

The passage / privacy button found on the inside unit above the lever handle, the toggle of this button allows the unit to seamlessly interchange from passage mode to privacy mode.

## Interior Unit

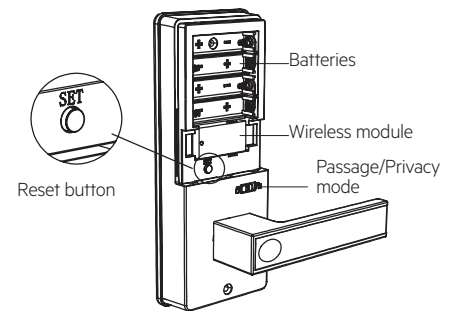

### Passage mode

the unit is always accessible from inside/outside.

### Privacy mode

the unit is always locked from the outside, so no unwanted entry will occur (this does not affect the keypad or any stored programmed codes). After code is entered, unit automatically relocks.

### MECHANICAL KEY (MASTER OVERRIDE)

- The mechanical key can be used any time to unlock the unit as an override, even when the batteries are flat.
- On external unit lever handle, slide back black strip to expose mechanical key cylinder.
- Holding lever handle, first turn key 90 degrees anti clockwise hold lever down, then a further 45 degrees anti clockwise (past resistance), while pulling lever handle down, pull door open to engage the key cylinder and manual override.

### MAINTENANCE

- To avoid damaging the unit and armor glass touch screen, do not use any chemicals or lubricants when cleaning the unit.
- You can wash the screen and deadbolt in the shade with a damp cloth and soapy detergent, rinse of detergent and dry with a soft cloth.

### WARRANTY

All electronic components used in Miles Nelson's range of products excluding batteries are guaranteed for a period of 3 years from the date of purchase. See [milesnelson.co.nz](https://milesnelson.co.nz) for full warranty terms and conditions.

### INSTALLATION INSTRUCTION VIDEOS



How to install the unit



Changing the handle direction  
left hand / right hand

# MN9000 Digital Lock Installation Instructions

## PACKAGE CONTENTS

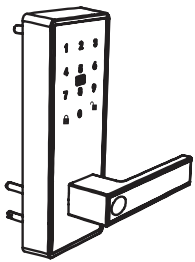

Exterior  
key pad

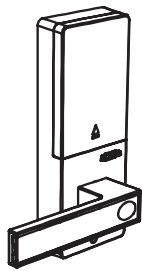

Interior unit



Rubber  
gaskets x 2



Latch



Strike plate



Dust box

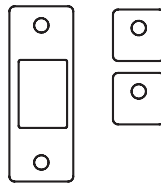

Long packer x 1  
Small square packer x 2



Remote x 2



FOBs x 3

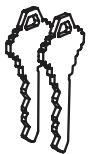

Keys x 2

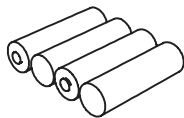

AA, 1.5V  
Batteries  
4 Pack



3/4" 19mm Screws  
4 each



19/16" 65mm Screws  
2 each

## IDENTIFYING YOUR DOOR HANDING

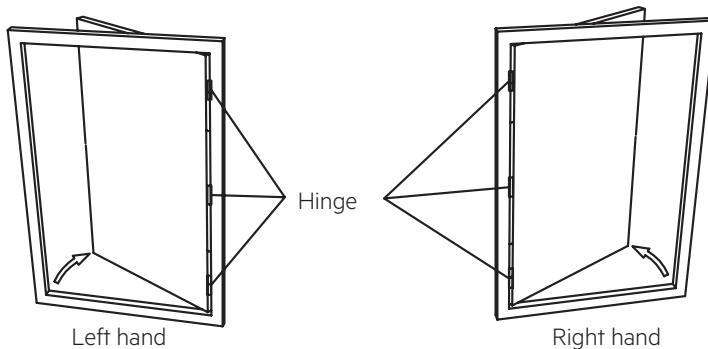

Stand on the secure side of the door, the outside (where you would insert your key, or to enter on the keypad).

- a. If the hinges are on the left your door is **right handed**
- b. If the hinges are on the right your door is **left handed**

Door opens inwards.

**NOTE:** If you purchased the wrong sided unit, no problem, just visit our website or YouTube channel for instructions on how to change the handle over.

# MN9000 Digital Lock Installation Steps

## 1 DOOR PREPERATION

1. Fold Template and place on door edge at desired height.
2. Mark square spindle height on middle of door edge (This will be the handle height).
3. Mark door face through holes on both sides of door.
4. We recommend you drill the face holes from each side, meeting in the middle.

## 2 INSTALL THE MORTISE LOCK FIRST

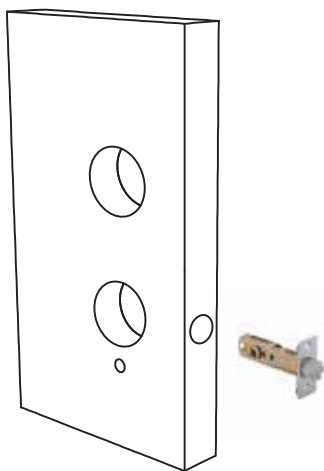

1. Use a 24mm drill bit to remove most of the door material before you chisel out the remaining material for the latch face.
2. Screw the latch in place

## 3 INSTALLING THE INTERIOR ASSEMBLY WORK WITH THE DOOR OPEN FOR EASY ACCESS

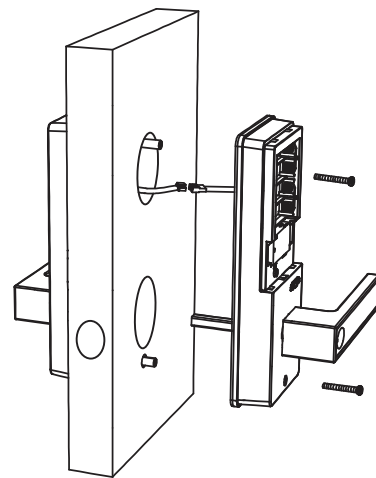

1. Unpack the interior unit first.
2. Remove the battery cover by sliding the cover upward.
3. Connect electronic cable between external and internal unit.
4. Ensure rubber gasket is aligned on interior / exterior units.
5. Fit the interior unit onto door and then fit exterior unit onto door. Make sure the spindle from the interior unit is sitting correctly in the cavity inside the exterior unit (to ensure the lock will operate correctly). To test spindle is correctly positioned, turn the inside handle downwards and both handles should turn downwards together.
6. Screw the interior and exterior units together with the supplied 19/16" screws, ensuring screws are tightened. DO NOT OVER TIGHTEN.
7. Check that vertical alignment of the lock is correct.

## 5 FIT BATTERIES SUPPLIED

Then follow programming instructions for lock operation

# MN9000 Digital Lock Installation Steps

## 6 MECHANICAL KEY

Slide cover and use mechanical key to open the lock.

Holding lever handle, first turn key 90 degrees anti clockwise, then a further 45 degrees anti clockwise, while pulling lever handle down to engage the key cylinder and manual override.

Slide cover

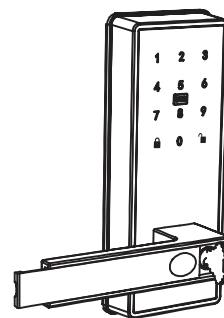

## 7 PASSAGE BUTTON

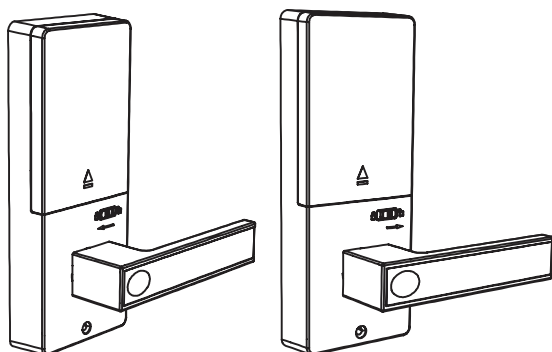

Privacy function

Passage function

**Passage mode** the unit is always accessible from inside/outside.

**Privacy mode** the unit is always locked from the outside, so no unwanted entry will occur (this does not affect the keypad or any stored programmed codes). After code is entered, unit automatically relocks.

## 8 RESTORE FACTORY SETTING

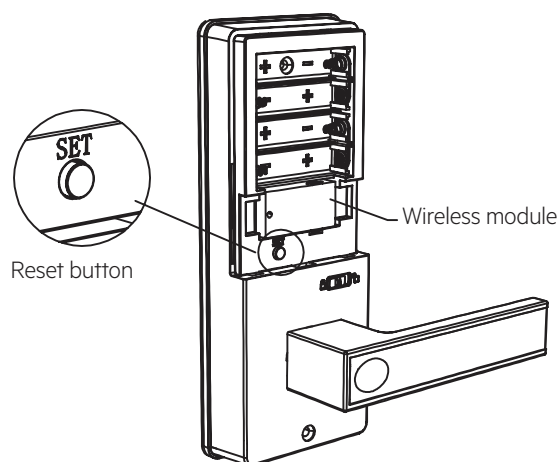

Reset button

Wireless module

Restore factory setting, press set button for 3 seconds to return lock to factory setting.

## 9

