

Brio

Pro Run

Top Hung Straight Sliding System



The Brio Pro Run is a professional range of top hung straight sliding system for panels weighing from 120kg to 400kg. The system offers many innovative features which make it versatile, easier and safer to install, smoother to operate and superior in performance.

Featuring stainless steel hanger body construction, stainless steel precision bearings and anodised aluminium tracks, this system is developed for both interior and exterior applications. The multiple bracket and guide options for timber and aluminium panels make Brio Pro Run a versatile solution.

Brio Pro Run systems are supplied with a dampener door stop which significantly reduces the risk of finger entrapment and improves longevity of the overall system. Soft close options are available in Brio Pro Run for panels as heavy as 300kg. Applications can use soft close on both ends or pair with a dampener stop.

End caps and fascia options for tracks complete the range and help blend the installation into the surrounding architecture.

Features

- Stainless steel bearings and hanger body construction for interior and exterior use
- Conical wheels with large, precision bearings for silent, finger-tip operation
- Additional side thrust bearings ensure straight sliding and smooth operation
- Stainless steel hanger bolt with anti-slip locking mechanism
- One hanger for all plates for convenient installation
- Innovative latching and locking mechanism on brackets for easy installation
- Surface or recessed mounted and corner brackets for timber installations
- Recess mounted and long bolt brackets for specific use in aluminium applications
- Dampener stop to smoothly and safely stop panels, offered as default door stop
- Robust soft closer design for high weight capacity up to 300kg panels
- Flexible trigger on soft close to eliminate the requirement of priming before installation
- End caps and fascia available for clean look
- Compatible with existing Brio floor guides and channels
- Tested to 100,000 cycles

Warranties

Mechanical	10 years
Finish	7 years

Specifications

Panel type	Timber, aluminium and steel frame panels
Panel height	Maximum 3000mm
Panel width	Minimum 700mm (higher if used with soft close)
Panel thickness	40mm to 60mm
Panel weight	120kg to 400kg
Tracks	
Weight capacity	Up to 200kg for 200F track Up to 400kg for 400F and 400E track
Material	Aluminium
Finish	Clear anodised
Standard lengths	2m, 3m, 4m and 6m
Hangers	
Weight capacity	Up to 400kg
Material	SS body, SS bearings and nylon tyres*
Dampener stop	
Weight capacity	Up to 200kg for 200-DS 201 to 400kg for 400-DS
Material	SS and polymer construction
Compression	Hydraulic with 20mm dampener compression
Soft close	
Weight capacity	Up to 200kg for 200-SC 201 to 300kg for 300-SC
Material	SS and polymer construction
Compression	Spring loaded with 70mm compression
Priming	Priming not required before installation
Guides	
Bottom guides	Multiple guide options for various applications available
Channels	
Material	Aluminium and aluminium with polypropylene lining channels available
Standard length	2m, 3m, 4m and 6m
Accessories	
Brackets	Face fitted and double face fitted SS brackets available
Door collectors	Available for stacked panel installations
Kits	Accessory kits available for simultaneous and telescopic operations for multiple panel installations
End caps	End caps available for all track options End caps available to use with fascia for 400E track
Fascia	Facia with end caps kits available for 400E track in standard lengths 2m, 3m, 4m and 6m

*Hangers supplied in pairs with timber screws, fixing plates and nylon tyre bearings. Nylon tyre wheels should not be used on installations involving temperatures exceeding 80degC

Product Codes

Tracks		
200kg clear anodised aluminium track	2 meters	200F-A20
	3 meters	200F-A30
	4 meters	200F-A40
	6 meters	200F-A60
400kg clear anodised aluminium track F type	2 meters	400F-A20
	3 meters	400F-A30
	4 meters	400F-A40
	6 meters	400F-A60
400kg clear anodised aluminium track E type	2 meters	400E-A20
	3 meters	400E-A30
	4 meters	400E-A40
	6 meters	400E-A60
Hangers		
Surface mount hanger pair		57SS/M
Recess mount hanger pair		58SS/M
Zero clearance hanger pair		61SS/M
Hanger pair with Single Run angle bracket		52SS/M
Hanger pair with Single Run long bolt		56SS/ML
Hanger pair with Single Run 57 plate		57SS/MN
Dampener Stops		
Dampener stop for panel weight up to 200kg		200-DS
Dampener stop for panel weight from 201kg to 400kg		400-DS
Soft Closers		
Soft close for panel weight up to 200kg		200-SC
Soft close for panel weight from 201kg to 300kg		300-SC
Guides		
SS plate with bearing		106RB/94
Adjustable guides for multiple panels T-slot		106AT
Adjustable guide for multiple panels with bearing		106A/94
Use with 52 type hangers		21RB/94
Adjustable guide for aluminium panels		105AA
Channels		
Aluminium mill finish	2 meters	94A-20
	3 meters	94A-30
	4 meters	94A-40
	6 meters	94A-60
Poly & aluminium mill finish	2 meters	94PPA-20
	3 meters	94PPA-30
	4 meters	94PPA-40
	6 meters	94PPA-60
Poly & aluminium anodised	2 meters	94PPA-A20
	3 meters	94PPA-A30
	4 meters	94PPA-A40
	6 meters	94PPA-A60
Accessories		
Single face fitted bracket		1SS/250
Double face fitted bracket		5SS/250
Door collector for multiple panels		924-DC
Telescopic accessory kit - 2 panels		TEL/2
Telescopic accessory kit - 3 panels		TEL/3
Simultaneous accessory kit - 2 panels		SIM/2
End caps pair		400F-EC
End caps pair with anodised aluminium fascia	2 meters	403E-20CA
	3 meters	403E-30CA
	4 meters	403E-40CA
	6 meters	403E-60CA



Diagrams

Tracks

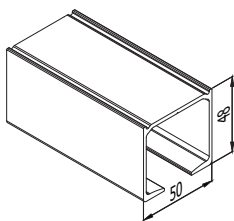

200 F

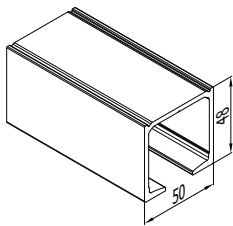

400 F

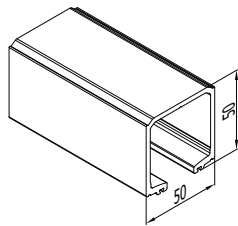

400 E

Hangers

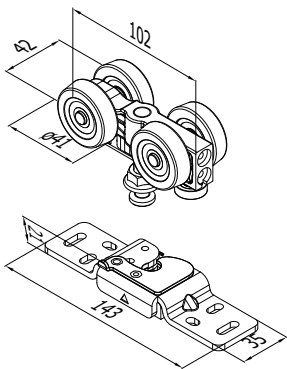

57SS/M

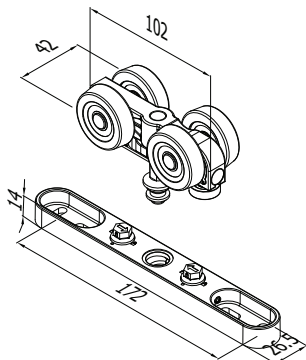

58SS/M

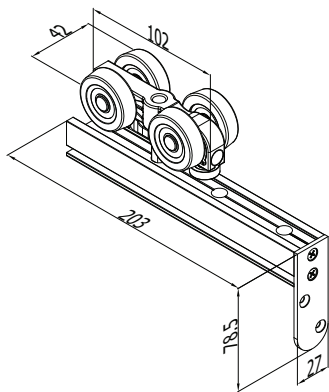

61SS/M

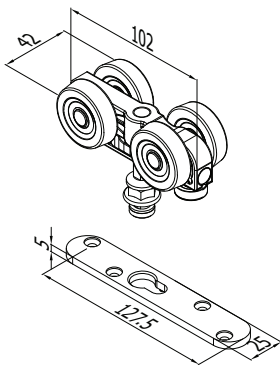

57SS/MN

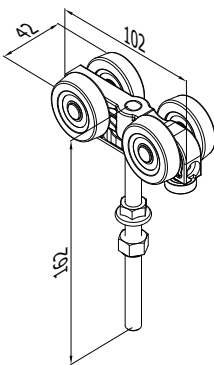

56SS/ML

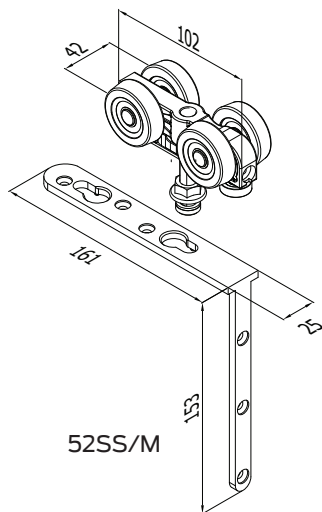

52SS/M

Dampener Stop

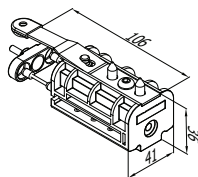

200-DS / 400-DS

Soft Close

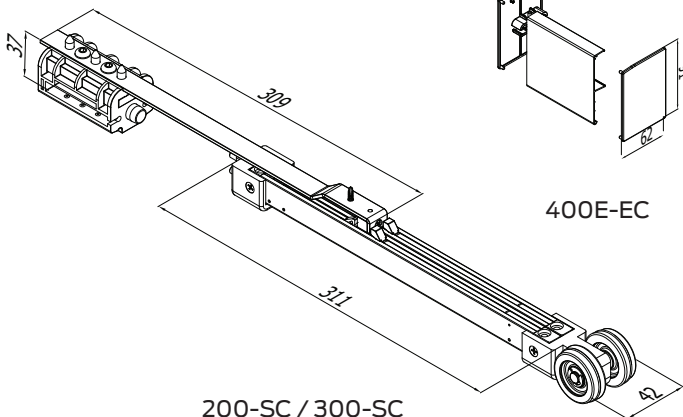

200-SC / 300-SC

End Caps

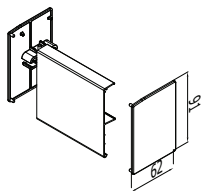

400E-EC

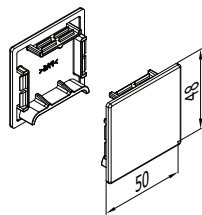

400F-EC

System Overview

For 57SS/M hanger

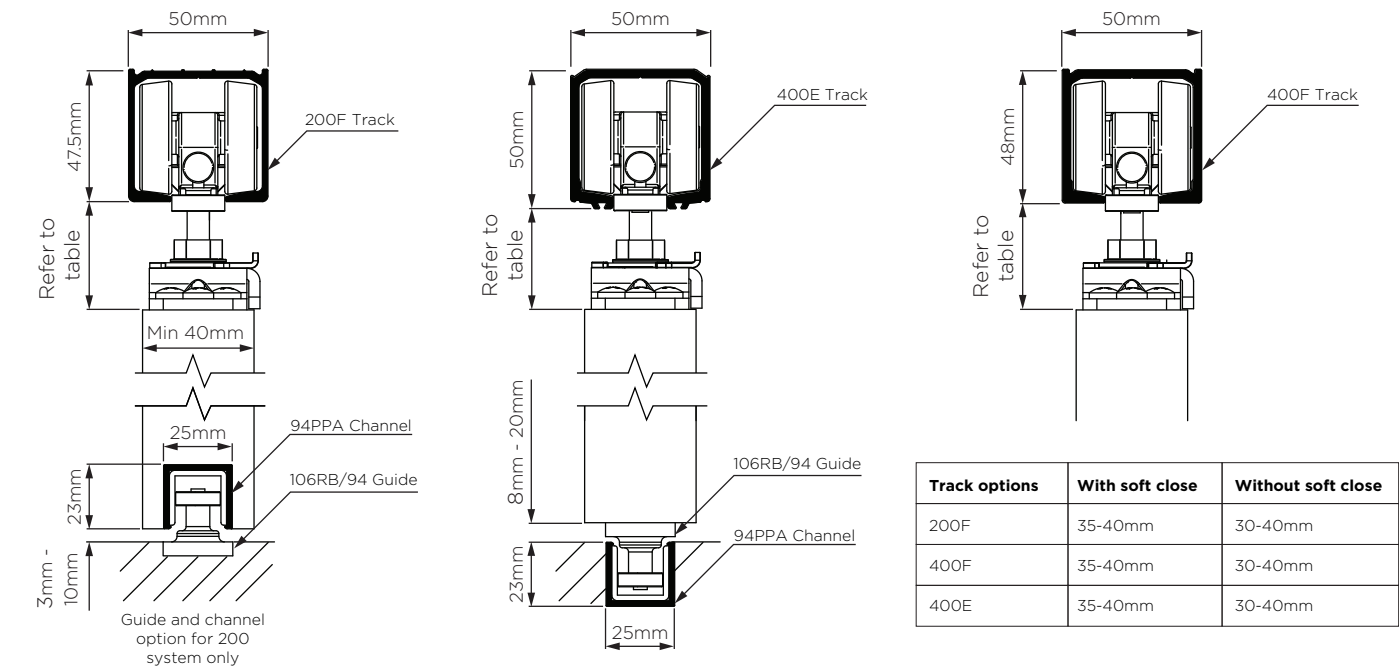

For 58SS/M hanger

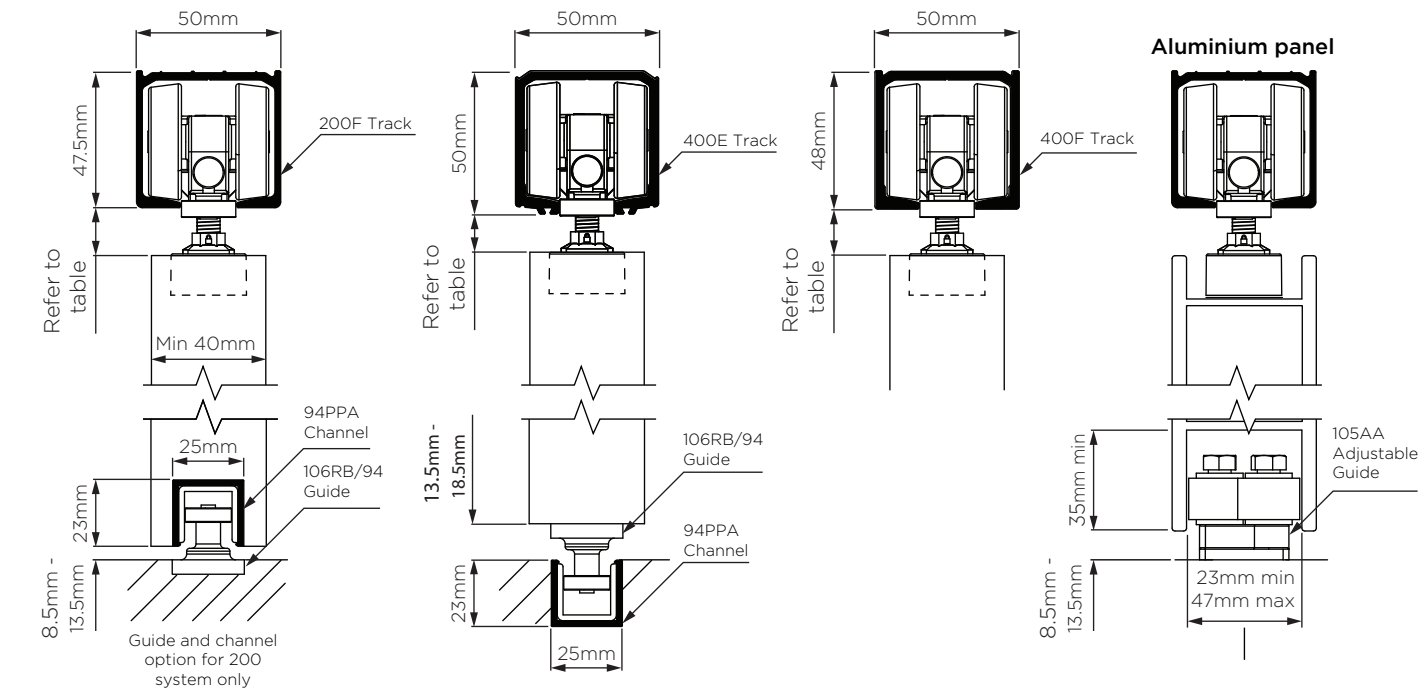

105AA guide installation positions

Track options	With soft close	Without soft close
200F	15-20mm	10-20mm
400F	15-20mm	10-20mm
400E	15-20mm	10-20mm

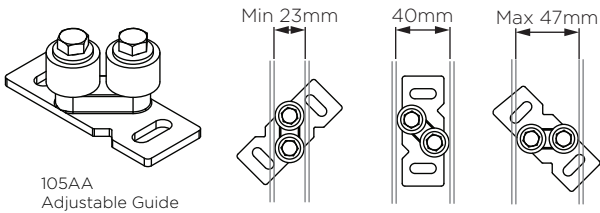

For 61SS/M hanger

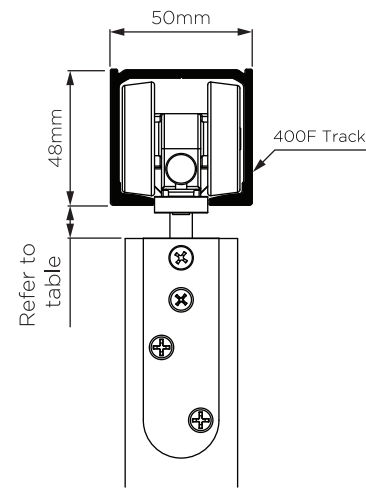
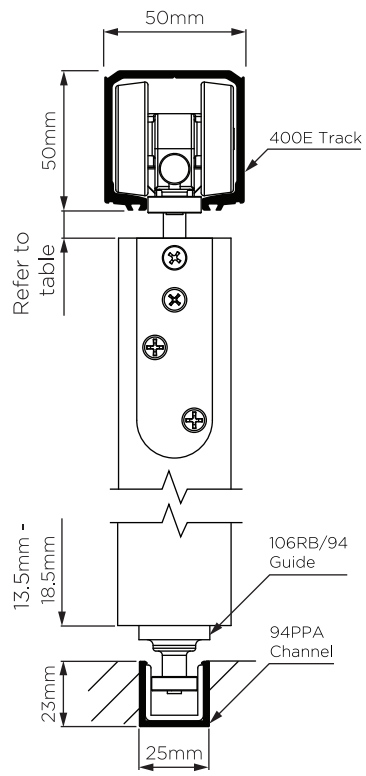
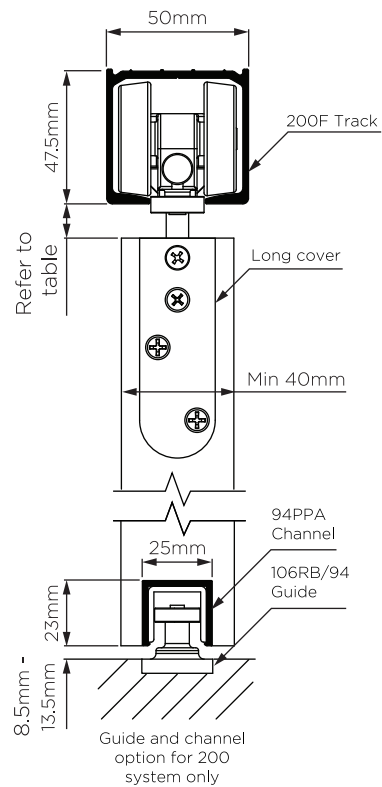

Track options	With soft close	Without soft close
200F	5-10mm	5-10mm
400F	5-10mm	5-10mm
400E	3-8mm	3-8mm

For 52SS/M hanger

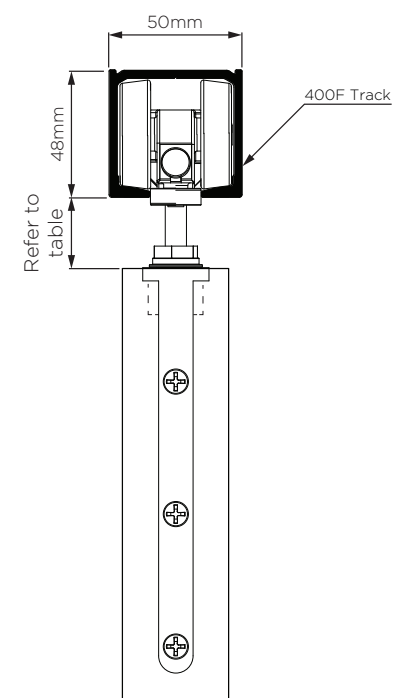
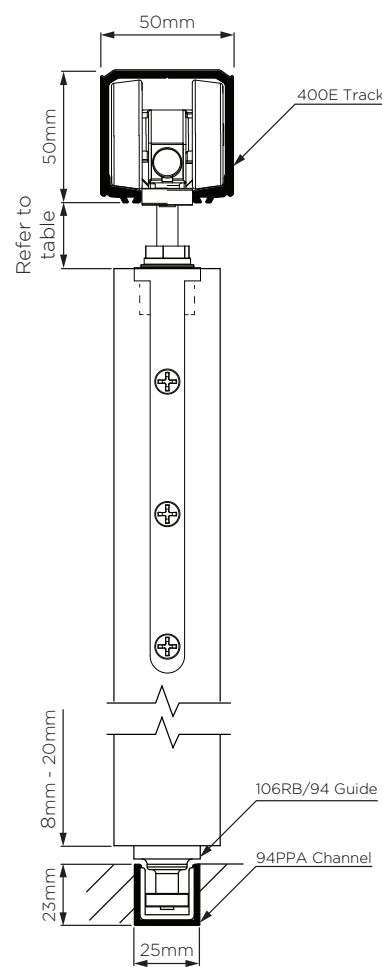
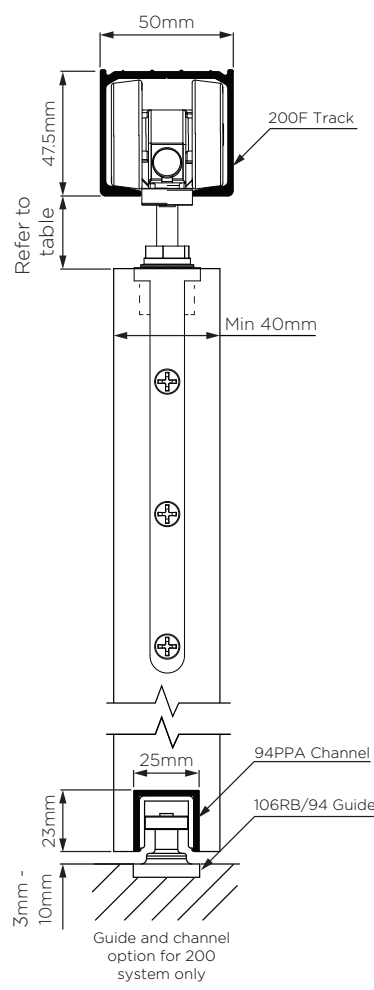

Track options	With soft close	Without soft close
200F	25-30mm	20-30mm
400F	25-30mm	20-30mm
400E	25-30mm	20-30mm

For 56SS/ML hanger

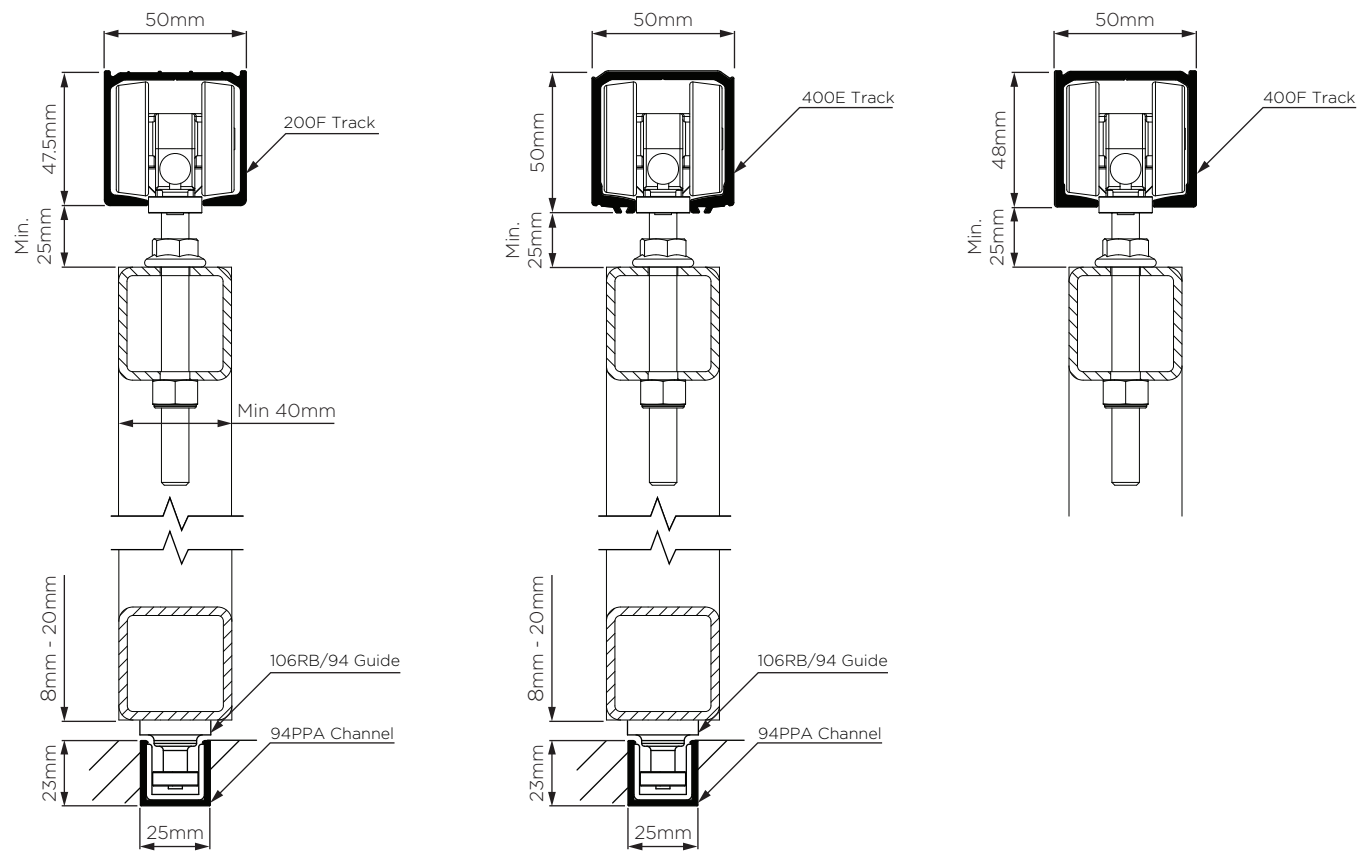

For 57SS/MN hanger

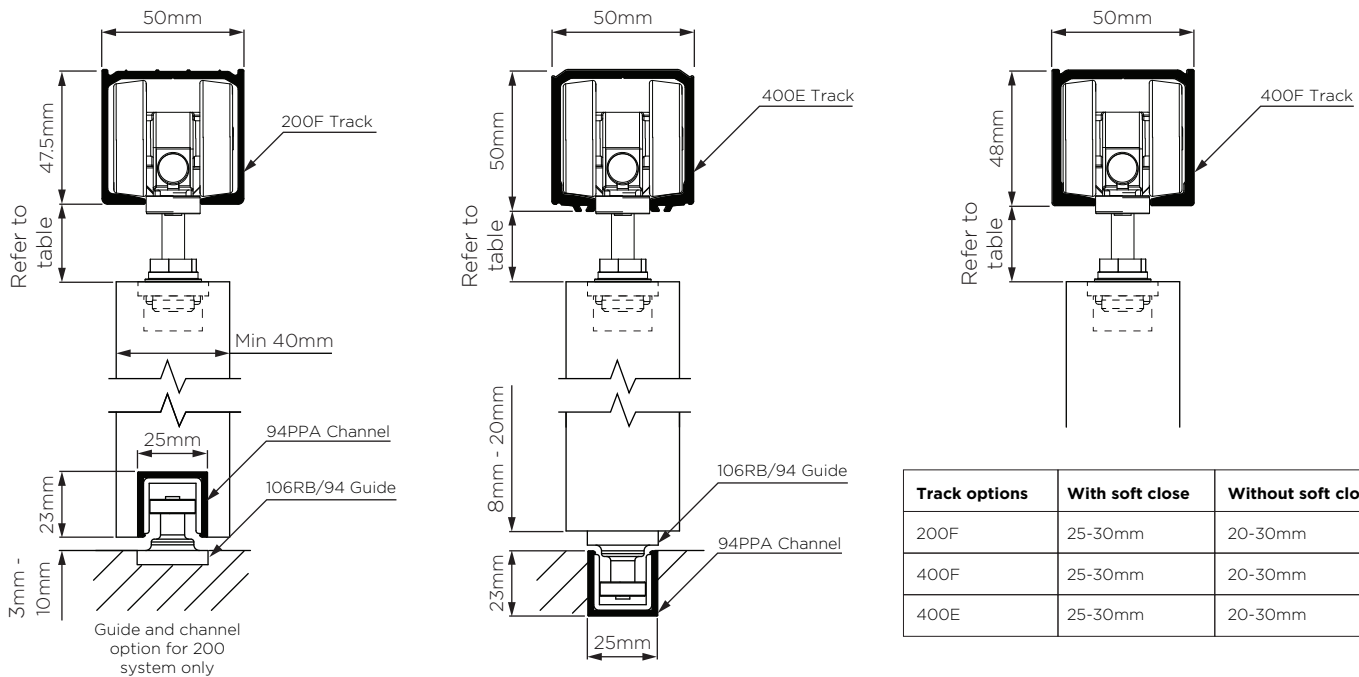

Track options	With soft close	Without soft close
200F	25-30mm	20-30mm
400F	25-30mm	20-30mm
400E	25-30mm	20-30mm

For Dampener Stops 200-DS or 400-DS

Below image is based on 57M hanger and bracket, for other bracket and soft close options, refer to their specific instructions

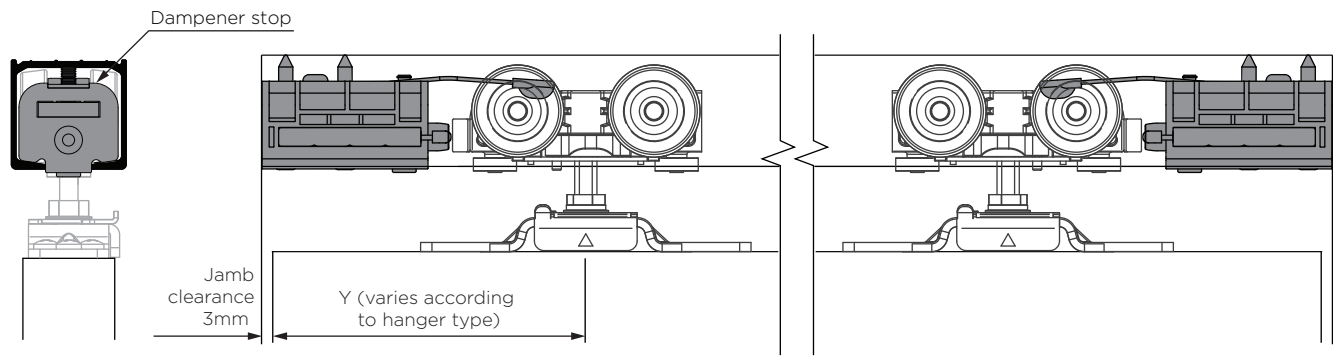

For Soft Close 200-SC or 300-SC

Below image is based on 57M hanger and bracket, for other bracket and dampener stop options, refer to their specific instructions

