



**AUSTRALIAN MANUFACTURER OF  
EARTHMOVING ATTACHMENTS**



**2022 CATALOGUE**

[WWW.NORMENG.COM.AU](http://WWW.NORMENG.COM.AU) 

[SALES@NORMENG.COM.AU](mailto:SALES@NORMENG.COM.AU) 

+61 7 3376 3177 (QLD) 



Since 1984 Norm Engineering, a 100% Australian family owned business, has designed and built earthmoving attachments for mini loaders, skid steers, track loaders, excavators, backhoes, telehandlers and tractors.

Our wide range of products includes buckets, road brooms, dozer blades, grass slashers, rock grabs and more.

Our highly motivated team and commitment to quality make Norm Engineering attachments highly sort after products; providing ideal solutions for the earthmoving, mining, construction, landscaping, councils and agricultural industries.

**MOVING**  
the earth for you

#### BEST SUITED TO:

- » Mini loaders
- » Skid steer loaders
- » Track loaders
- » Excavators
- » Backhoes
- » Telehandlers

## INDEX

### 4in1 BUCKETS

4in1 Buckets .....	2
4in1 Loader buckets .....	4
Tilting 4in1 Buckets.....	6
Tilting 4in1 Loader buckets .....	8
Tilting Couplers .....	10
4in1 Pro Series Loader Buckets.....	12

### BROOMS

Open Mouth Brooms.....	14
Enclosed Brooms .....	16
4in1 Bucket Brooms.....	18
Hydraulic Angle Brooms .....	20

### GRASS SLASHERS

Grass Slashers - 4ft .....	22
Grass Slashers - 5ft & 6ft.....	24
Grass Slashers - 7ft .....	26

### BUCKETS

Grapple Buckets .....	28
Root Grapple Buckets & Sieve Rake Grapple Buckets .....	30
Concrete Batching Buckets .....	32
Conveyor Buckets .....	34
GP Buckets .....	36
Sieve Rake & Skeleton Buckets .....	38
High Dump Buckets:.....	40
Side Tipping Buckets: .....	40
Stemming Buckets: .....	40
Funnel Buckets: .....	40
Stump Buckets.....	42

## CONTENTS



Over the past 37 years, Norm Engineering has established strong and long-lasting relationships with many of our customers.

If you're serious about increasing your machines capabilities, contact us on 07 3376 3177 or visit us at [www.normeng.com.au](http://www.normeng.com.au) to see the full range of Australian hand-built attachments.

**MOVING** the earth for you

PH: 07 3376 3177

EMAIL: [SALES@NORMENG.COM.AU](mailto:SALES@NORMENG.COM.AU)

[WWW.NORMENG.COM.AU](http://WWW.NORMENG.COM.AU)

787 BOUNDARY ROAD, DARRA QLD 4076

Excavator Tench Buckets.....	44
Log and Rock Grabs.....	46

#### **BACKHOE ARMS**

Fixed Backhoe arms.....	48
Slewing Swing Hoes.....	50

#### **DOZER BLADES & STICK RAKES**

Dozer Blade Stick Rakes .....	52
Angle & Tilt Dozer Blades.....	54
Stick Rakes.....	56

#### **RIPPERS**

Rear Rippers.....	58
Heavy Duty Front Rippers .....	59

#### **PALLET FORKS, SPREADER BARS, HAY BALE GRABS**

Pallet Forks (with Bale Spears) .....	60
Hay Bales.....	62
Spreader Bar.....	63

#### **RAMPS**

Ramps.....	64
------------	----

## **CONTENTS**





Norm Engineering 4-in-1 buckets have been built to withstand the tough Australian environment. An extra heavy-duty flat floor is used to give additional strength.

The closed bucket is used to scoop and carry sand, gravel, small rocks and debris. The load is easily dumped when the operator opens the jaws of the bucket to release the load.

The serrated edges on the jaws of the bucket allow a strong grip when clamping logs, small rocks and debris.

Once the bucket is open the back and middle edges are used to either back blade, grade or level the soil or debris.

Optional extras make this a versatile bucket to suit individual needs.

#### SUITABLE FOR:

- » Construction work
- » Asphalt contractors
- » General clean up
- » Landscaping
- » Agriculture

## 4 in 1 BUCKETS



#### OPTIONAL:

### FEATURES

#### BEST SUITED TO:

- » Mini loaders
- » Skid steer loaders
- » Track loaders
- » Wheel loaders
- » Backhoes
- » Telehandlers

- Standard widths from 915mm - 2400mm
- Serrated edges for stronger grip
- Wide opening jaws for easy dumping
- Reversible bolt on edges to extend life of the bucket
- Extra heavy duty flat floor for additional strength
- Includes hoses & standard couplings
- Tie down points for safe transporting
- Personalised load guard option



CHISEL STYLE TEETH



TIGER STYLE TEETH



SLIP ON TOOTH BAR



SLIP ON SMOOTH EDGE



SIDE CUTTERS



TIE DOWN POINT



REVERSIBLE BOLT ON CUTTING EDGE



LOAD GUARD OPTIONS



## SPECIFICATIONS

**MOVING** the earth for you

### 4in1 BUCKETS

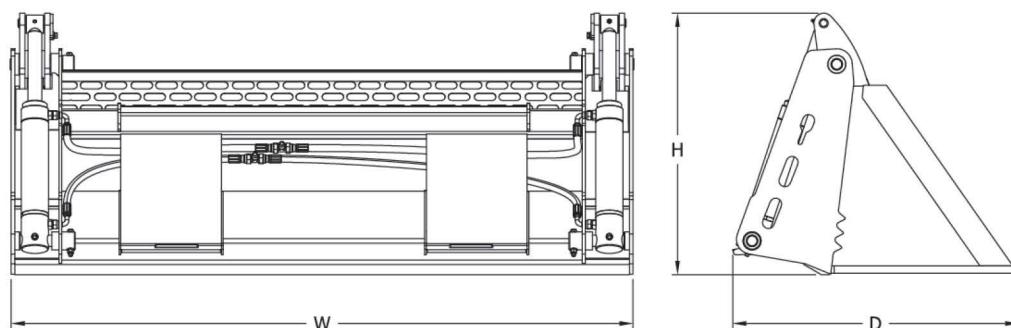

### DESCRIPTION

#### 4in1 BUCKETS

W	915mm - 2400mm
D	575mm - 866mm
H	478mm - 774mm

### PRODUCT NOTES

- Hydraulic Circuit: Standard auxiliary flow. Not suitable for high flow.

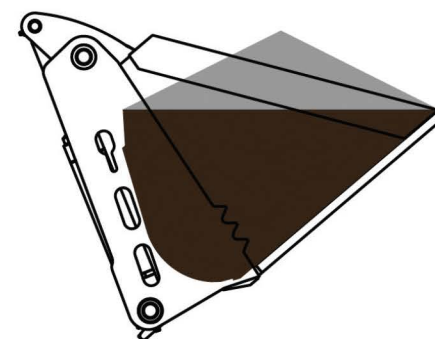

**Norm Engineering 4in1 buckets are designed to suit individual machine models.**  
Please contact the team at Norm Engineering or your closest dealer for the exact specifications to suit your machine.

- ISO 7546 :1983 - RATED CAPACITY
- ISO 7546 :1983 - STRUCK CAPACITY

Rated and struck capacity available on request.





Norm Engineering 4 in 1 loader style buckets are heavy duty buckets designed to withstand tough environments and conditions.

The loader style buckets are designed for larger machines with a higher horsepower, and the bucket capacity is larger than the standard 4 in 1 bucket.

High visibility is maintained through mesh windows.



## 4 in 1 LOADER BUCKETS

### SUITABLE FOR:

- » Construction work
- » Asphalt contractors
- » General clean up
- » Landscaping
- » Agriculture

### FEATURES

#### BEST SUITED TO:

- » Track loaders
- » Backhoes
- » Telehandlers

- Standard widths from 1880mm - 2150mm
- Serrated edges for stronger grip
- Wide opening jaws for easy dumping
- Reversible bolt on edges to extend life of the bucket
- Extra heavy duty flat floor for additional strength
- Includes hoses & standard couplings
- Tie down points for safe transporting

### OPTIONAL:



CHISEL STYLE TEETH



TIGER STYLE TEETH



SLIP ON TOOTH BAR



SLIP ON SMOOTH EDGE



SIDE CUTTERS



TIE DOWN  
POINT



REVERSIBLE BOLT ON  
CUTTING EDGE



LOAD GUARD  
OPTIONS



## SPECIFICATIONS

# 4 in 1 LOADER BUCKETS

**MOVING**  
the earth for you

### 4in1 LOADER BUCKETS

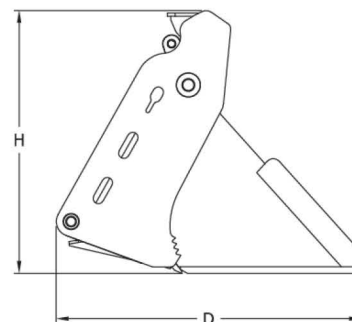
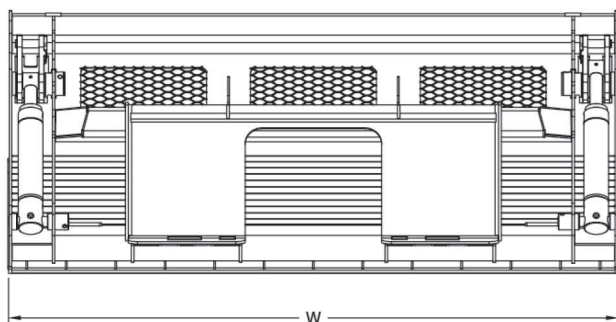

#### DESCRIPTION

##### 4in1 LOADER BUCKETS

W	1750mm - 2400mm
D	1040mm - 1090mm
H	805mm

#### PRODUCT NOTES

- Hydraulic Circuit: Standard auxiliary flow. Not suitable for high flow.

**Norm Engineering 4in1 loader buckets are designed to suit individual machine models.**  
Please contact the team at Norm Engineering or your closest dealer for the exact specifications to suit your machine.



KEECH STYLE TEETH



TIGER STYLE TEETH



ESCO STYLE TEETH



Norm Engineering 4 in 1 tilting buckets utilizes our industry leading 4 in 1 bucket design with a tilting rear pickup. The low maintenance and high strength design of the tilt control system is coupled with a simple 12 volt solenoid operation. This gives the operator full radial control of the cutting angle.

The unique design means it is possible to continuously vary the cutting edge relative to the inclination of the loaders front wheels. This is particularly useful when working on an incline whilst trying to perform a straight cut.



## TILTING 4 in 1 BUCKETS

### SUITABLE FOR:

- » Construction work
- » Asphalt contractors
- » General clean up
- » Landscaping
- » Agriculture

### OPTIONAL:

### FEATURES

#### BEST SUITED TO:

- » Mini loaders
- » Skid steer loaders
- » Track loaders
- » Wheel loaders
- » Backhoes
- » Telehandlers

- 16° in both directions
- Standard widths from 915mm - 2400mm
- Serrated edges for stronger grip
- Wide opening jaws for easy dumping
- Reversible bolt on edges to extend life of the bucket
- Extra heavy duty flat floor for additional strength
- Includes hoses & standard couplings
- Tie down points for safe transporting



CHISEL STYLE TEETH



TIGER STYLE TEETH



SLIP ON TOOTH BAR



SLIP ON SMOOTH EDGE



SIDE CUTTERS



TIE DOWN  
POINT



REVERSIBLE BOLT ON  
CUTTING EDGE



LOAD GUARD  
OPTIONS



## SPECIFICATIONS

## TILTING 4 in 1 BUCKETS

**MOVING** the earth for you

### TILTING 4in1 BUCKETS

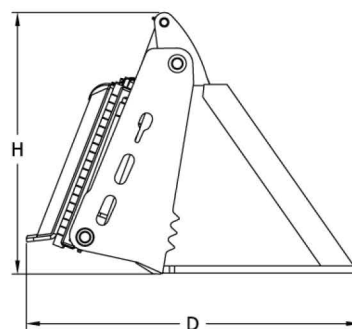
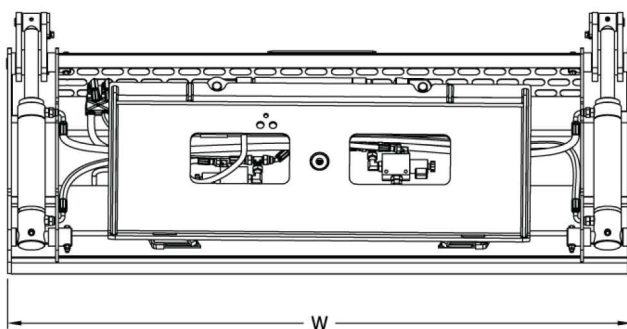

#### DESCRIPTION

##### TILTING 4in1 BUCKETS

W	915mm - 2400mm
D	700mm - 910mm
H	550mm - 775mm



### PRODUCT NOTES

- Tilt Angle: 16 Degrees both directions.
- Hydraulic Circuit: Standard auxiliary flow. Not suitable for high flow.
- Electrical Requirements: 12V signal is necessary to operate tilt function.
- Range of Motion: A tilt control 4-in-1 does increase the range of motion that can be achieved. Contact with the machine may be possible.

**Norm Engineering tilting 4in1 buckets are designed to suit individual machine models.**

Please contact the team at Norm Engineering or your closest dealer for the exact specifications to suit your machine.



Norm Engineering 4 in 1 tilting loader buckets utilizes our industry leading 4 in 1 bucket design with a tilting rear pickup. The low maintenance and high strength design of the tilt control system is coupled with a simple 12 volt solenoid operation. This gives the operator full radial control of the cutting angle.

The unique design means it is possible to continuously vary the cutting edge relative to the inclination of the loaders front wheels. This is particularly useful when working on an incline whilst trying to perform a straight cut.

**SUITABLE FOR:**

- » Construction work
- » Asphalt contractors
- » General clean up
- » Landscaping
- » Agriculture

**TILTING 4 in 1 LOADER BUCKETS**

**OPTIONAL:**

**FEATURES**

**BEST SUITED TO:**

- » Track loaders
- » Backhoes
- » Telehandlers

- 16° in both directions
- Standard widths from 1750mm - 2400mm
- Serrated edges for stronger grip
- Wide opening jaws for easy dumping
- Reversible bolt on edges to extend life of the bucket
- Extra heavy duty flat floor for additional strength
- Includes hoses & standard couplings
- Tie down points for safe transporting



CHISEL STYLE TEETH



TIGER STYLE TEETH



SLIP ON TOOTH BAR



SLIP ON SMOOTH EDGE



SIDE CUTTERS



TIE DOWN  
POINT

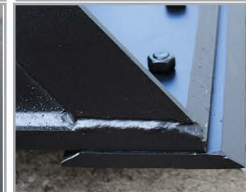

REVERSIBLE BOLT ON  
CUTTING EDGE



LOAD GUARD  
OPTIONS



## SPECIFICATIONS

# TILTING 4 in 1 LOADER BUCKETS

**MOVING**  
the earth for you

### TILTING 4in1 LOADER BUCKETS

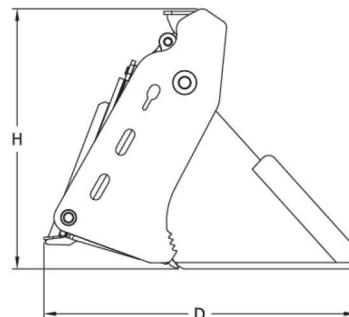
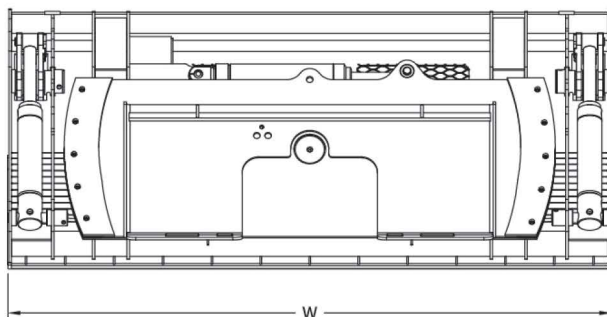

#### DESCRIPTION

##### TILTING 4in1 LOADER BUCKETS

W	1750mm - 2400mm
D	1040mm - 1090mm
H	805mm

#### PRODUCT NOTES

- Tilt Angle: 16 Degrees both directions.
- Hydraulic Circuit: Standard auxiliary flow. Not suitable for high flow.
- Electrical Requirements: 12V signal is necessary to operate tilt function.
- Range of Motion: A tilt control 4-in-1 does increase the range of motion that can be achieved. Contact with the machine may be possible.

**Norm Engineering tilting 4in1 loader buckets are designed to suit individual machine models.**

Please contact the team at Norm Engineering or your closest dealer for the exact specifications to suit your machine.





Norm Engineering's unique tilting coupler has a compact design that replaces the machine's standard quick attach frame. The tilting coupler has a 17° tilt in both directions and allows the operator to have radial control over any attachment that is placed on the machine.

The tilting coupler gives you the option to tilt any of your standard attachments.

Supplied standard with manual locking pins, or options are available for electric or hydraulic locking pins.

#### SUITABLE FOR:

- » Construction work
- » Asphalt contractors
- » General clean up
- » Landscaping
- » Agriculture

#### FEATURES

##### BEST SUITED TO:

- » Mini loaders
- » Skid steer loaders
- » Track loaders
- » Wheel loaders
- » Backhoes

- 17° in both directions
- Tilting coupler is fitted close to the machine to ensure that you minimise any loss of breakout force.
- Optional electric or hydraulic locking pins.



## TILTING COUPLER





## SPECIFICATIONS

**MOVING** the earth for you

### TILTING COUPLER

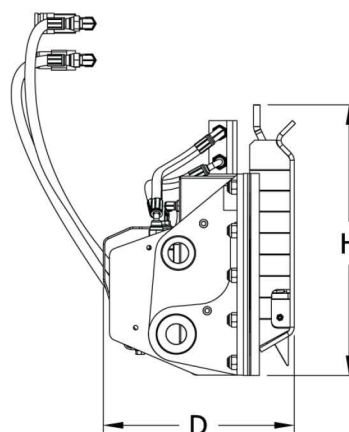
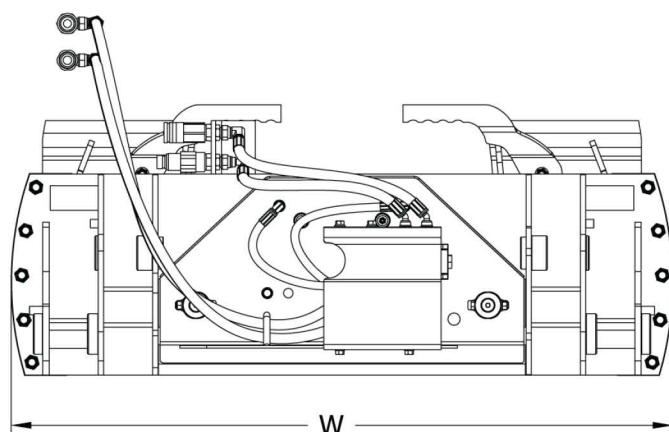

#### DESCRIPTION

##### TILTING COUPLER

W	1240mm
D	315mm
H	485mm

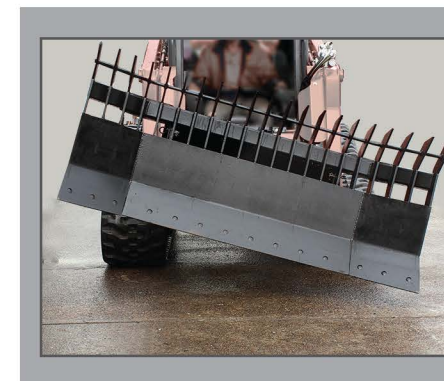

### PRODUCT NOTES

- Tilt Angle: 17 Degrees in both directions.
- Hydraulic Circuit: Standard auxiliary flow. Not suitable for high flow. Attachments that require more than 90 LPM continuous flow should not be run through the tilt coupler.
- Electrical Requirements: 12V signal is necessary to operate tilt function.
- Lifting Capacity: Fitting a tilt coupler will reduce the lifting capacity of the parent machine.
- Product Weight: Remember to deduct the weight of the OEM coupler when calculating the machines new lifting capacity.
- Range of Motion: A tilt coupler does increase the range of motion that can be achieved with any attachment. Contact with the machine may be possible.
- Coupler Standard: The coupler will pickup universal frames that comply with SAE J2513 JUN2000. There is no guarantee it will be able to pickup all attachments on the market.

**Norm Engineering tilting couplers are designed to suit individual machine models.**

Please contact the team at Norm Engineering or your closest dealer for the exact specifications to suit your machine.



Based on the 4in1 loader style heavy duty bucket, that was designed for larger machines with a higher horsepower, the pro series bucket has an extended heavy duty flat floor, increased side heights, and a higher load guard to increase the capacity.

The design incorporates wide opening jaws for easy discharge; and transforms the bucket into a dozer blade. The serrated edges on the jaws provide a strong grip for picking up logs, rocks, and debris.

Supplied with side cutters, and an option of 3 replaceable bolt on edges to extend the life of the bucket.

Three mesh windows allow excellent visibility.

#### SUITABLE FOR:

- » Construction work
- » Asphalt contractors
- » General clean up
- » Landscaping
- » Agriculture



## 4 in 1 PRO SERIES LOADER BUCKETS

#### OPTIONAL:

### FEATURES

#### BEST SUITED TO:

- » Track loaders
- » Backhoes
- » Telehandlers

- Extra heavy duty flat floor for additional strength
- Standard with side cutters
- High load guard
- Serrated edges for stronger grip
- Reversible bolt on edges to extend life of the bucket
- Wide opening jaws for easy dumping
- Includes hoses & standard couplings
- Tie down points for safe transporting



CHISEL STYLE TEETH



TIGER STYLE TEETH



SLIP ON TOOTH BAR



SLIP ON SMOOTH EDGE



SIDE CUTTERS



TIE DOWN POINT



REVERSIBLE BOLT ON CUTTING EDGE



## SPECIFICATIONS

## 4in1 PRO SERIES LOADER BUCKETS

**MOVING** the earth for you

### 4in1 PRO SERIES LOADERBUCKETS

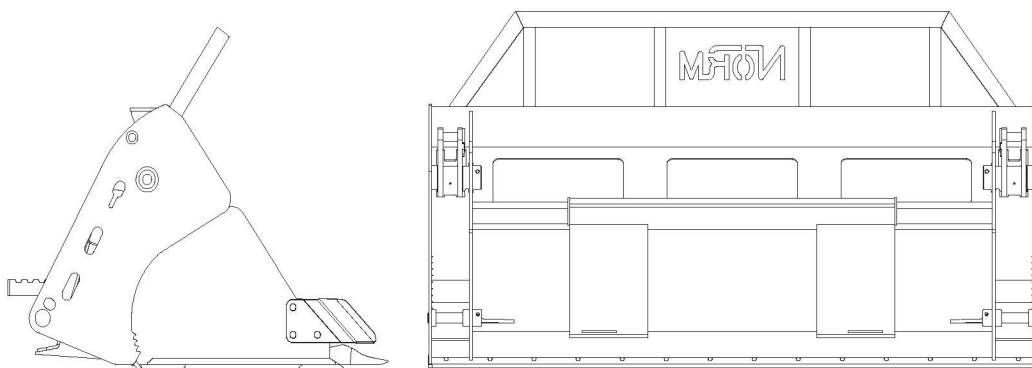

#### DESCRIPTION

##### 4in1 BUCKETS

W	1880mm - 2150mm
D	1085mm - 1245mm
H	1040mm

### PRODUCT NOTES

- Extension on the floor, increasing the side heights, and adding a higher load guard the capacity was increased dramatically. A heavy duty 20mm flat floor for additional strength.
- Wide opening jaws for easy discharge; and transforms the bucket into a dozer blade. The serrated edges on the jaws provide a strong grip for picking up logs, rocks, and debris.
- An option of 3 replaceable and reversible bolt on edges, and side cutters. Three mesh windows allow excellent visibility, while the extended load guard prevents soil from falling back on the machine.
- Dozer to clear and backfill, a blade to level, a bucket to lift and carry, and wide opening jaws with serrated edges to grip.

**Norm Engineering 4in1 pro series loader buckets are designed to suit individual machine models.**

Please contact the team at Norm Engineering or your closest dealer for the exact specifications to suit your machine.



A one piece poly brush is used to sweep the debris into the bucket section; by lifting the bucket/broom the hinge automatically opens allowing the debris to empty with ease.

The Norm Engineering's open mouth broom has a unique simple brush adjustment system that allows you to adjust the height of the brush as it wears down, giving your brush a longer life-span.

A gutter brush is optional and allows you to access hard to reach areas.



## OPEN MOUTH BROOMS

### SUITABLE FOR:

- » Construction work
- » Asphalt contractors
- » General site clean up
- » Road works
- » Driveways & car parks

## FEATURES

### BEST SUITED TO:

- » Mini loaders
- » Skid steer loaders
- » Track loaders
- » Wheel loaders
- » Backhoes
- » Telehandlers

- One-piece poly brush (segments available)
- 1 x Bolt on reversible cutting edge
- Easy hinged dump process
- Simple brush adjustment system
- Simple brush replacement
- No extra plumbing required
- Includes hoses & couplings
- Hitch options available

### OPTIONAL:



GUTTER  
BRUSH



SEGMENTED  
BRUSHES



POLYWIRE  
BRUSH



## SPECIFICATIONS

**MOVING** the earth for you

### OPEN MOUTH BROOMS

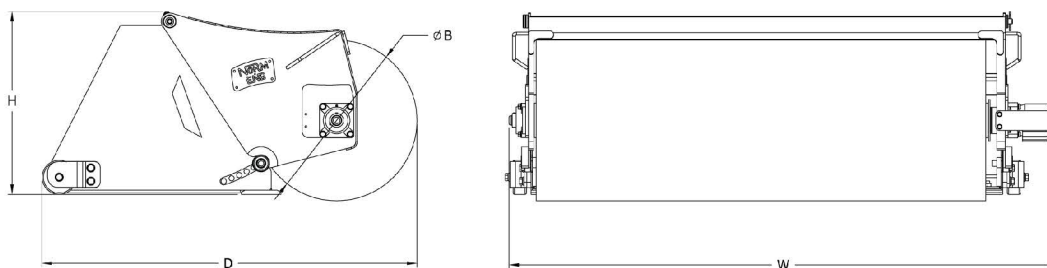

#### DESCRIPTION

##### OPEN MOUTH BROOMS

W	1200mm - 2100mm
D	800mm - 1420mm
H	410mm - 7200mm
Weight	205 - 530KG



### ONE PIECE POLY WIRE BRUSH



**Norm Engineering open mouth brooms are designed to suit individual machine models.**

Please contact the team at Norm Engineering or your closest dealer for the exact specifications to suit your machine.





The Norm Engineering enclosed broom is fitted with replaceable rubber skirts which limits dust and prevents debris from discharging. A one piece poly brush is used to sweep the debris into the bucket section; by lifting the bucket/ broom the hinge automatically opens allowing the debris to empty with ease.

The Norm Engineering's enclosed broom has a unique simple brush adjustment system allowing you to adjust the height of the brush as it wears down, giving your brush a longer life-span.

A gutter brush is optional and allows you to access hard to reach areas.



## ENCLOSED BROOMS

### SUITABLE FOR:

- » Construction work
- » Asphalt contractors
- » General site clean up
- » Road works
- » Driveways & carpark

## FEATURES

### BEST SUITED TO:

- » Mini loaders
- » Skid steer loaders
- » Track loaders
- » Wheel loaders
- » Backhoes
- » Telehandlers

- One-piece poly brush (segments available)
- 1 x Bolt on reversible cutting edge
- 3 x Replaceable rubber skirts
- Easy hinged dump process
- Simple brush adjustment system
- Simple brush replacement
- No extra plumbing required
- Includes hoses & couplings
- Hitch options available

### OPTIONAL:



CLEARANCE WHEELS



GUTTER  
BRUSH

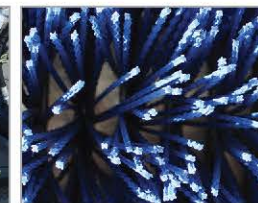

SEGMENTED  
BRUSHES



POLYWIRE  
BRUSH



## SPECIFICATIONS

**MOVING** the earth for you

### ENCLOSED BROOMS

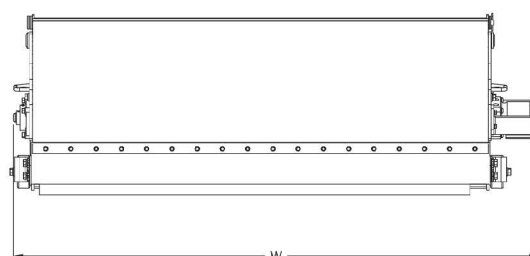
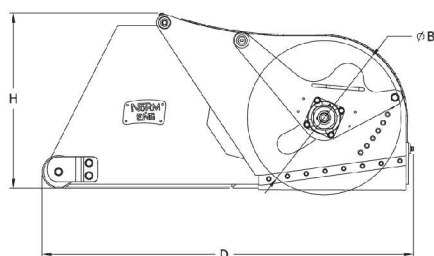

DESCRIPTION	
ENCLOSED BROOMS	
W	1200mm - 2100mm
D	740mm - 1460mm
H	400mm - 680mm
Weight	220 - 630KG



### ONE PIECE POLY BRUSH



**Norm Engineering enclosed brooms are designed to suit individual machine models.**  
Please contact the team at Norm Engineering or your closest dealer for the exact specifications to suit your machine.

DESCRIPTION	
GUTTER BRUSH	
W	600mm
D	600mm
H	400mm
Weight	220 - 630KG







A one piece poly brush is used to sweep the debris into the bucket section; by lifting the bucket/broom and hydraulically opening the jaws of the bucket the debris is emptied with ease.

It has a unique simple brush adjustment system allowing you to adjust the height of the brush as it wears down, giving your brush a longer life-span.

The option of a removable hood cover can be added transforming this attachment into an enclosed broom, limiting dust and preventing debris from discharging.

A gutter brush is optional and allows you to access hard to reach areas.



## 4 in 1 BUCKET BROOMS (COMES WITH REVOLVABLE HOOD)

### FEATURES

#### BEST SUITED TO:

- » Skid steer loaders
- » Track loaders
- » Wheel loaders
- » Backhoes
- » Telehandlers

- One-piece poly brush (segments available)
- 3 x Bolt on reversible cutting edge
- Hydraulic dump process
- Simple brush adjustment system
- Simple brush replacement
- No extra plumbing required
- Hoses and motor can be fitted either side
- Includes hoses & couplings
- Hitch options available

#### SUITABLE FOR:

- » Construction work
- » Asphalt contractors
- » General site clean up
- » Road works
- » Driveways & car parks

#### OPTIONAL:



GUTTER  
BRUSH



REMOVABLE  
HOOD



POLYWIRE  
BRUSH



## SPECIFICATIONS

## 4 in 1 BUCKET BROOMS

**MOVING** the earth for you

### 4in1 BUCKET BROOMS

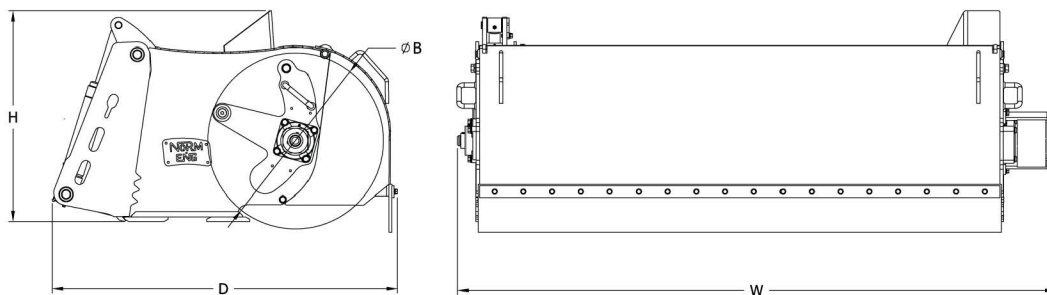

#### DESCRIPTION

##### 4in1 BUCKET BROOMS

W	1600mm - 2000mm
D	1200mm
H	760mm

### PRODUCT NOTES

- Electrical Requirements: 12V signal is necessary to operate the 4in1 function.

**Norm Engineering 4in1 bucket brooms are designed to suit individual machine models.**

Please contact the team at Norm Engineering or your closest dealer for the exact specifications to suit your machine.





The Norm Engineering angle broom is designed with a replaceable one-piece poly brush that is ideal for sweeping roadsides, sidewalks, factories, industrial areas and orchards.

From inside the cab, the operator can switch between a normal sweeping broom to an angle broom, depending on the task requirement. A 28° angle of the broom, either left or right, allows you to sweep dirt or debris off to the side.

The angle broom is easy to operate and can reach more difficult areas than the traditional brooms.



## HYDRAULIC ANGLE BROOM

### FEATURES

#### BEST SUITED TO:

- » Mini loaders
- » Skid steer loaders
- » Track loaders
- » Wheel loaders
- » Backhoes
- » Telehandlers

- One-piece poly brush (segments available)
- 28° Angle, left or right
- Simple brush replacement
- No extra plumbing required
- Motor can be on left or right side
- Stand for storage purposes
- Includes hoses & couplings
- Hitch options available

#### SUITABLE FOR:

- » Construction work
- » Asphalt contractors
- » General site clean up
- » Road works
- » Macadamia Farms
- » Driveways & car parks

#### OPTIONAL:



POLYWIRE  
BRUSH



## SPECIFICATIONS

**MOVING** the earth for you

### HYDRAULIC ANGLE BROOMS

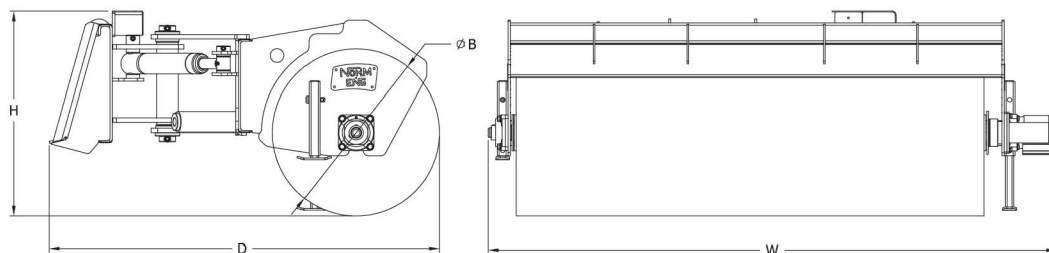

#### DESCRIPTION

##### HYDRAULIC ANGLE BROOMS

W	1200mm - 2500mm
D	1050mm - 1430mm
H	580mm - 750mm

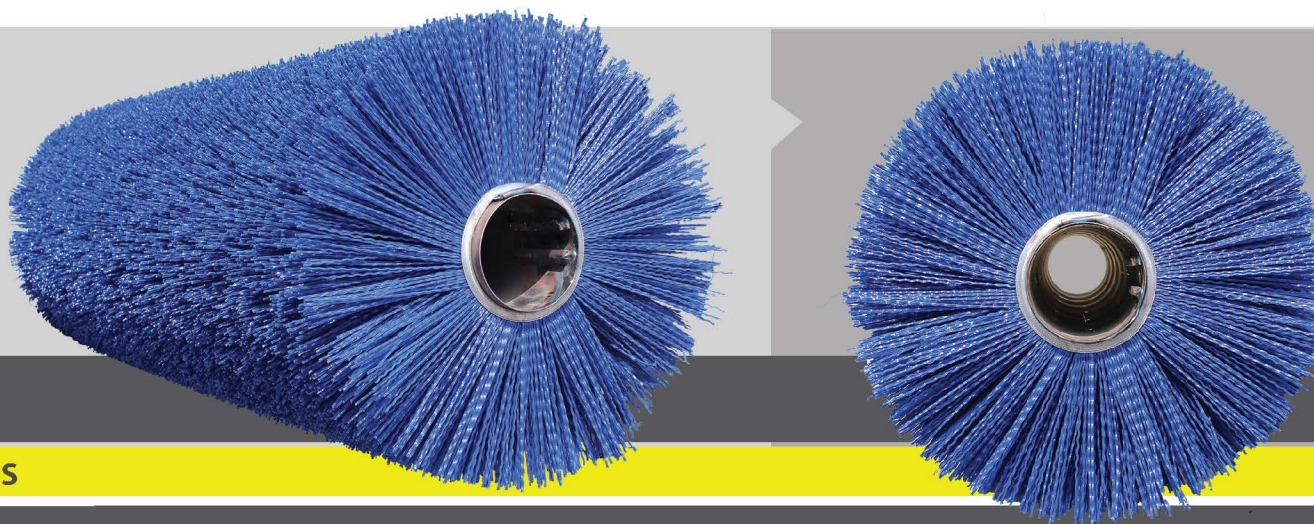

#### PRODUCT NOTES

- Electrical Requirements: 12V signal is necessary to operate angle function.

**Norm Engineering angle brooms are designed to suit individual machine models.**

Please contact the team at Norm Engineering or your closest dealer for the exact specifications to suit your machine.







The Norm Engineering 4ft grass slasher is designed with a floating frame and adjustable side skids. The floating frame allows the slasher to follow undulating terrain and the adjustable side skids determine the length of the grass cut.

The 4ft Grass Slasher is ideal for smaller machines, and perfect for landscaping and contract work.

Safety chains prevent grass, twigs and debris from causing damage.

A jockey wheel may be added as an optional extra to provide further stability to the slasher.



## GRASS SLASHERS - 4FT

### SUITABLE FOR:

- » Property management
- » Council work
- » Agricultural work
- » Road edges
- » Landscaping

### FEATURES

#### BEST SUITED TO:

- » Mini loaders
- » Excavators

- Floating frame to follow contours
- Maximum cutting torque and tip speed
- Chain protection : front and rear
- Optional jockey wheel
- 4ft has a unique 3 blade system
- Forklift lifting points
- Optional dual mount

### OPTIONAL:



DUAL MOUNT



JOCKEY WHEEL



# GRASS SLASHER 4FT

## SPECIFICATIONS

**MOVING** the earth for you

### 4FT GRASS SLASHERS

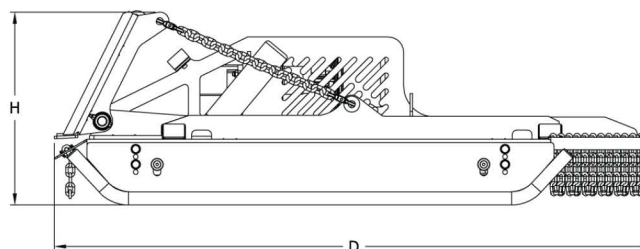
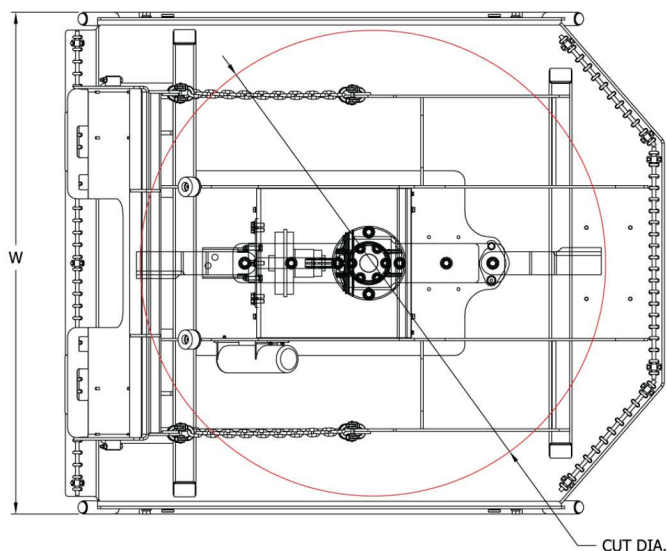

## PRODUCT NOTES

- Optional wheel

**Norm Engineering grass slashers are designed to suit individual machine models.**  
Please contact the team at Norm Engineering or your closest dealer for the exact specifications to suit your machine.

## DESCRIPTION

### GRASS SLASHERS 4FT

W	1350mm
D	1810mm
H	510mm - 680mm
Weight	280 - 380KG

### OPTIONAL JOCKEY

ADDITIONAL DEPTH	470mm
------------------	-------







The Norm Engineering grass slasher is designed with a floating frame and adjustable side skids. The floating frame allows the slasher to follow undulating terrain and the adjustable side skids determine the length of the grass cut.

This attachment is capable of mowing large open areas of grass, cutting high density grass areas, and small shrubs; making this an ideal attachment for property management, council work, and landscaping.

Safety chains prevent grass, twigs and debris from causing damage.

A jockey wheel may be added as an optional extra to provide further stability to the slasher.

#### SUITABLE FOR:

- » Property management
- » Council work
- » Agricultural work
- » Road edges
- » Landscaping

## GRASS SLASHER - 5FT & 6FT



#### OPTIONAL:



DUAL MOUNT



JOCKEY WHEEL

#### FEATURES

#### BEST SUITED TO:

- » Skid steer loaders
- » Track loaders
- » Backhoes
- » Telehandlers

- Floating frame to follow contours
- Adjustable and replaceable heavy duty side skids
- Maximum cutting torque and tip speed
- Chain protection : front and rear
- Optional jockey wheel - 5ft & 6ft
- 5ft & 6ft have a 2 blade system
- Forklift lifting points





## SPECIFICATIONS

# GRASS SLASHER 5FT & 6FT

**MOVING**  
the earth for you

### 5FT & 6FT GRASS SLASHERS

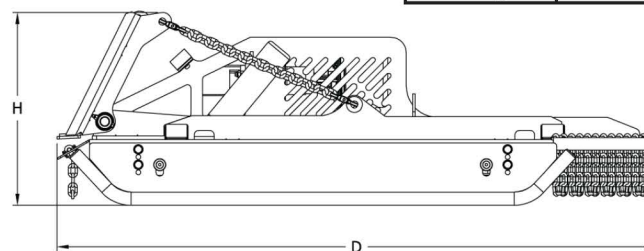
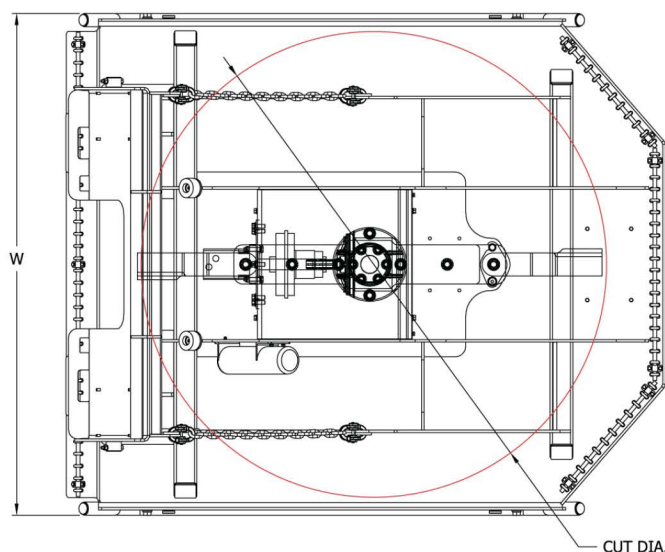

#### DESCRIPTION

##### GRASS SLASHERS 5FT EXCAVATOR & SKID STEER HITCH

W	1650mm
D	2000mm
H	720mm
Weight	570KG

#### PRODUCT NOTES

- Optional wheel to suit 5ft slasher - 47cm
- Optional wheel to suit 6ft slasher - 47cm

#### DESCRIPTION

##### GRASS SLASHERS 5FT & 6FT

W	1650mm
D	2000mm
H	560mm
Weight	490KG

**Norm Engineering grass slashers are designed to suit individual machine models.**

Please contact the team at Norm Engineering or your closest dealer for the exact specifications to suit your machine.

- Universal pickup comes with customised drop links to suit air-conditioned cabs





Available for high flow machines.

The Norm Engineering 7ft grass slasher has been designed to suit the larger machines and is supplied standard with dual jockey wheels to provide further stability.

The 7ft grass slasher has adjustable and replaceable heavy duty side skids, and a floating frame that allows the slasher to follow undulating terrain.

Safety chains prevent grass, twigs and debris from causing damage.

This is an ideal attachment for council work and landscaping.



## GRASS SLASHERS - 7FT (HIGH FLOW MACHINES)

### SUITABLE FOR:

- » Property management
- » Council work
- » Agricultural work
- » Road edges
- » Landscaping

### FEATURES

#### BEST SUITED TO:

- » Larger skid steer loaders
- » Larger track loaders
- » Backhoes
- » Telehandlers

- Floating mount frame to follow contours
- Adjustable and replaceable heavy duty side skids
- Maximum cutting torque and tip speed
- Meets Australian design requirements
- Chain protection : front and rear
- Standard with dual jockey wheels
- Unique dual head, 6 blade system
- Forklift lifting points





# GRASS SLASHER 7FT

## SPECIFICATIONS

**MOVING** the earth for you

### 7FT GRASS SLASHERS

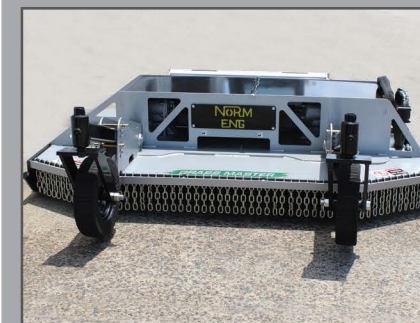
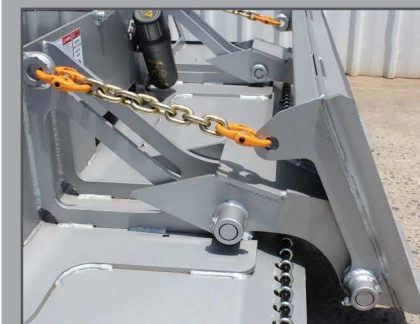
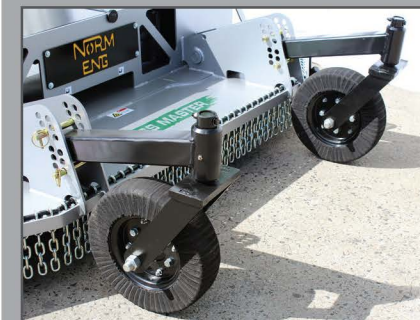
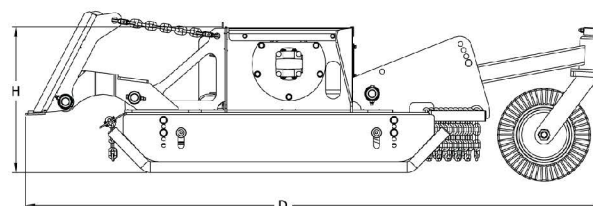
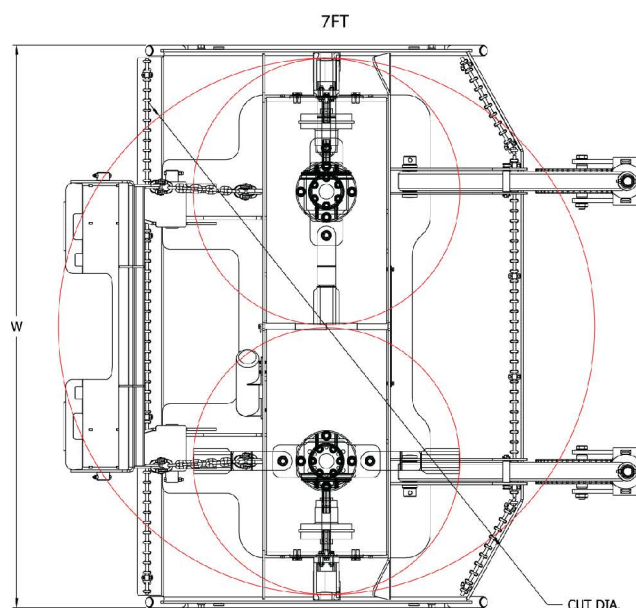

## PRODUCT NOTES

- Universal pickup comes with customised drop links to suit airconditioned cabs.

## DESCRIPTION

### GRASS SLASHERS 7FT

W	2240mm
D	1830mm
H	580mm
Weight	850KG

**Norm Engineering grass slashers are designed to suit individual machine models.**  
Please contact the team at Norm Engineering or your closest dealer for the exact specifications to suit your machine.





The Norm Engineering industrial strength grapple bucket has been designed with hydraulic operated grapple arms. These are a key feature as the two grapple arms operate independently to accommodate uneven loads.

The grapple bucket incorporates a low maintenance greaseable pivot system and rear-mounted cylinders for minimum exposure to damage.

Options are available on both the grapple arms and the flooring.

The grapple bucket is ideal for demolition work, recycling work, waste management, construction and property clearing.

Norm Engineering can build this bucket to suit your individual needs.



## GRAPPLE BUCKETS

### SUITABLE FOR:

- » Demolition work
- » Recycling work
- » Waste management
- » Property clearing
- » Construction work
- » Agricultural work
- » Arborist

### FEATURES

#### BEST SUITED TO:

- » Mini loaders
- » Skid steer loaders
- » Track loaders
- » Wheel loaders
- » Backhoes
- » Telehandlers

- Two grapple arms independently operated
- Solid or mesh grapple arm options
- Flat floor or sieve floor
- Low maintenance greaseable pivot system
- Rear mounted Cylinders
- Includes hoses & couplings
- Low maintenance
- No extra plumbing required

### OPTIONAL:



HAY BALE SPEARS



MESH GRAPPLE ARMS



SIEVE FLOOR



## SPECIFICATIONS

# GRAPPLE BUCKETS



### DEMOLITION GRAPPLE BUCKETS

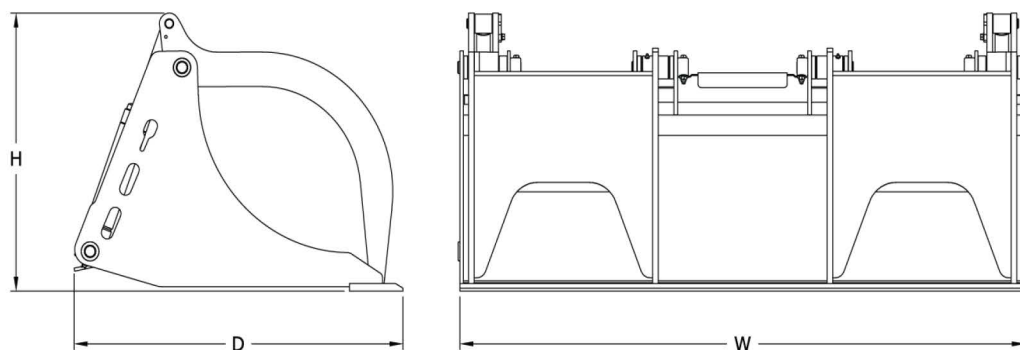

#### DESCRIPTION

##### DEMOLITION GRAPPLE BUCKETS

W	900mm - 2150mm
D	730mm - 850mm
H	60mm - 92mm
Weight	163 - 447KG

### SIEVE GRAPPLE BUCKETS

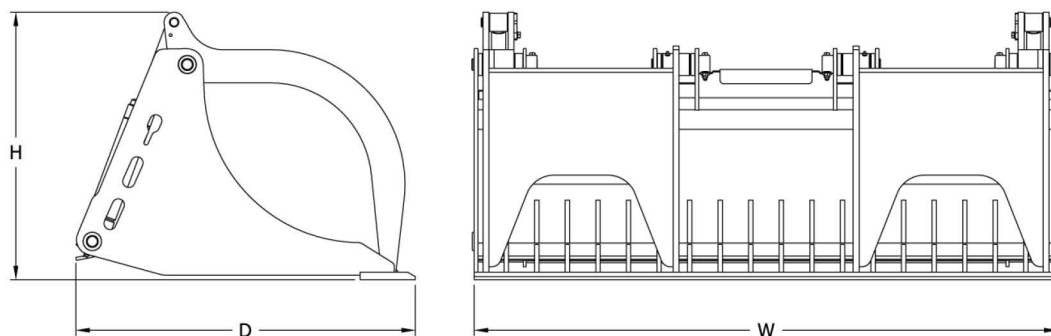

#### DESCRIPTION

##### SIEVE GRAPPLE BUCKETS

W	900mm - 2150mm
D	730mm - 850mm
H	60mm - 92mm
Weight	177 - 517KG

**Norm Engineering grapple buckets are designed to suit individual machine models.**

Please contact the team at Norm Engineering or your closest dealer for the exact specifications to suit your machine.







The Norm Engineering **root grapple bucket** flooring is designed to uplift roots.

The **sieve rake grapple bucket** flooring has extended tynes making it ideal for raking. The number of tynes are determined by the width of the bucket.

The spaced tynes allow loose gravel, small rocks and soil to fall through the floor, leaving behind the larger rocks and debris.

The hydraulic operated grapple arms operate independently to accommodate uneven loads.

The grapple bucket incorporates a low maintenance greaseable pivot system and rear-mounted cylinders for minimum exposure to damage.

Ideal for clearing areas.



## ROOT GRAPPLE BUCKETS & SIEVE RAKE GRAPPLE BUCKETS

### SUITABLE FOR:

- » Demolition work
- » Recycling work
- » Property Clearing
- » Forestry
- » Construction work
- » Agricultural work
- » Landscaping

### FEATURES

#### BEST SUITED TO:

- » Mini loaders
- » Skid steer loaders
- » Track loaders
- » Wheel loaders
- » Backhoes
- » Telehandlers

- Two grapple arms independently operated
- Solid or mesh grapple arm options
- Low maintenance greaseable pivot system
- Rear mounted Cylinders
- Includes hoses & couplings
- Low maintenance
- No extra plumbing required

### OPTIONAL:



MESH GRAPPLE ARMS



## SPECIFICATIONS

**MOVING** the earth for you

### SIEVE RAKE GRAPPLE BUCKETS

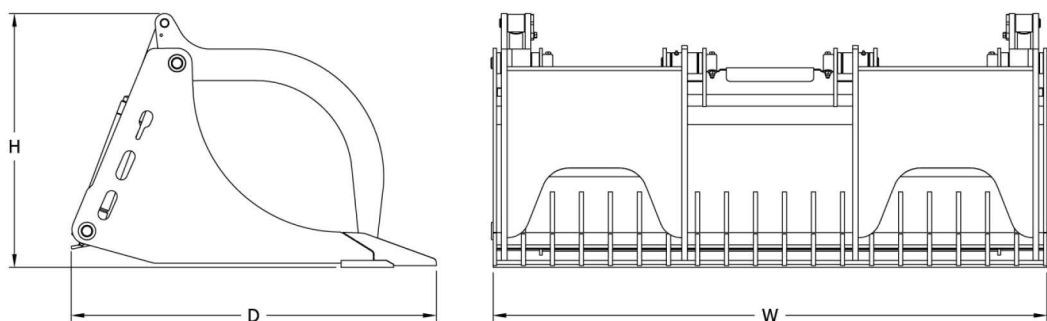

#### DESCRIPTION

##### SIEVE RAKE GRAPPLE BUCKETS

W	900mm - 2150mm
D	730mm - 910mm
H	590mm - 1040mm
Weight	189 - 570KG



SIEVE GRAPPLE RAKE BUCKET

### ROOT GRAPPLE BUCKETS

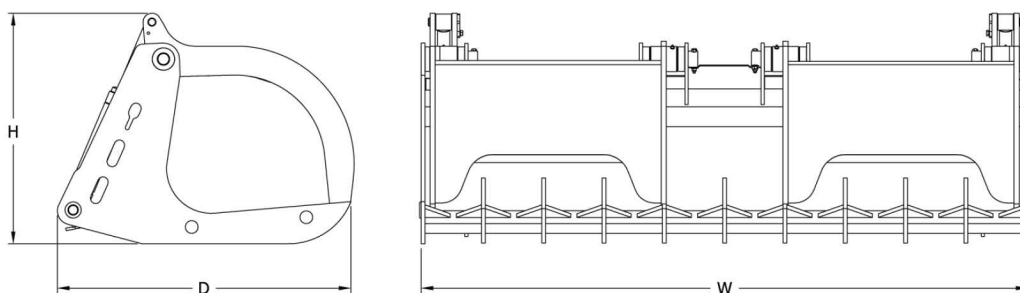

#### DESCRIPTION

##### ROOT GRAPPLE BUCKETS

W	900mm - 2150mm
D	720mm - 820mm
H	590mm - 880mm
Weight	130 - 437KG



ROOT GRAPPLE BUCKET

**Norm Engineering grapple buckets are designed to suit individual machine models.**

Please contact the team at Norm Engineering or your closest dealer for the exact specifications to suit your machine.





The Norm Engineering concrete bucket scoops concrete blend; the cement bags are then split using a spike on the top of the bucket.

A strong custom mixing system rotates the concrete mix, which can be viewed through the open heavy duty caged front. Once the concrete mixture is ready, the chute is opened and the flight rotation is reversed with a flick of a switch, this action will direct the concrete mixture out of the side chute making it easy to fill holes.

Concrete buckets have side and front discharge. The operator has a good view of the side chute.

The chutes are manual or there is a hydraulic opening option.



## CONCRETE BATCHING BUCKETS

### FEATURES

#### BEST SUITED TO:

- » Skid steer loaders
- » Track loaders
- » Backhoes

- Capacity ranges from 0.5m<sup>3</sup> - 0.8m<sup>3</sup>
- Unique mixing system
- Bag splitter spike
- Removable side extension chute
- Side or front discharge
- Optional hydraulic opening

#### SUITABLE FOR:

- » Construction work
- » Agricultural work
- » Landscaping

#### OPTIONAL:



HYDRAULIC OPENING



## SPECIFICATIONS



Removable chute.

### KIBBLE BUCKET

The kibble bucket is designed to carry loose material and kibble. Material can be discharged through the front chute.

This bucket is able to reach more confined areas and removes the need for a wheelbarrow.

**MOVING** the earth for you

## CONCRETE BATCHING BUCKETS (MANUAL OPENING)

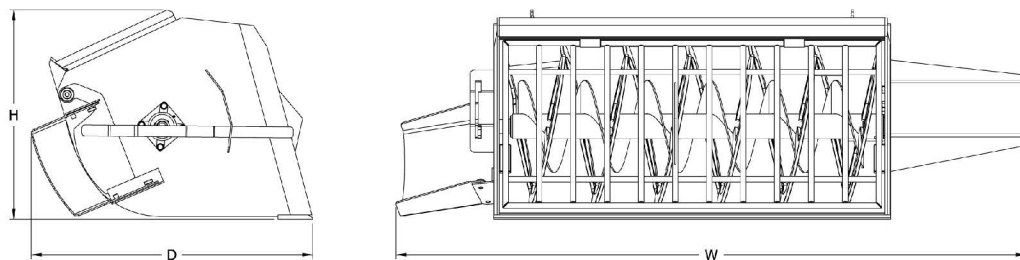

**Norm Engineering buckets are designed to suit individual machine models.**

Please contact the team at Norm Engineering or your closest dealer for the exact specifications to suit your machine.

### DESCRIPTION

#### CONCRETE BATCHING BUCKETS

W	2260mm
D	1010mm
H	750mm
Weight	480KG

## CONCRETE KIBBLE BUCKETS

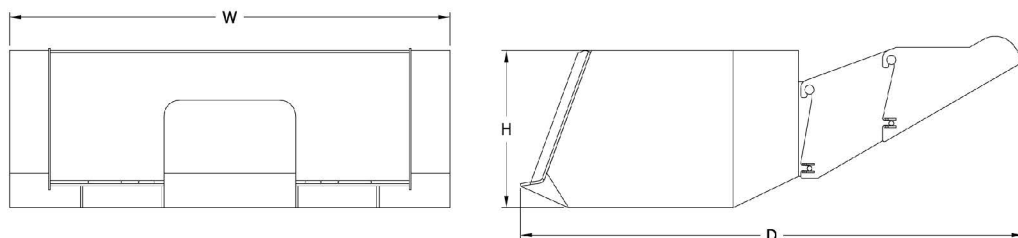

### DESCRIPTION

#### CONCRETE KIBBLE BUCKETS

W	1400mm - 1600mm
D	1670mm - 1700mm
H	500mm - 630mm
Weight	225-270KG





The conveyor bucket has been designed for back filling trenches, filling feedlots, blast holes and other hard to reach places. The conveyor bucket is able to scoop raw materials such as dirt, rocks, gravel, mulch and poultry feed etc. There are adjustable shutters on either side of the bucket which control the outflow of material. The hydraulic flow determines the speed of the conveyor belt and the distance of the material spread.

The conveyor bucket is ideal for spreading chicken feed, or dry material like mulch and fine bark.



## CONVEYOR BUCKETS

### SUITABLE FOR:

- |                     |             |
|---------------------|-------------|
| » Construction work | » Plumbing  |
| » Agricultural work | » Pipelines |
| » Landscaping       | » Mining    |
|                     | » Feedlots  |

## FEATURES

### BEST SUITED TO:

- |                      |  |
|----------------------|--|
| » Skid steer loaders | • Either side has an adjustable side chute |
| » Track loaders      | • Heavy duty track system                  |
| » Wheel loaders      | • Central greasing & tension system        |
|                      | • Replaceable bolt on edge                 |







CONVEYOR BUCKETS

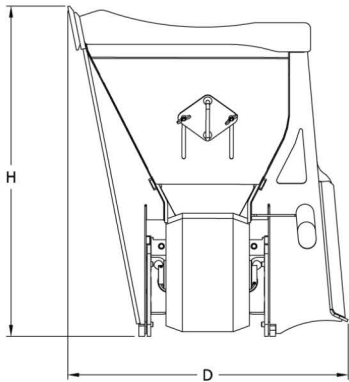
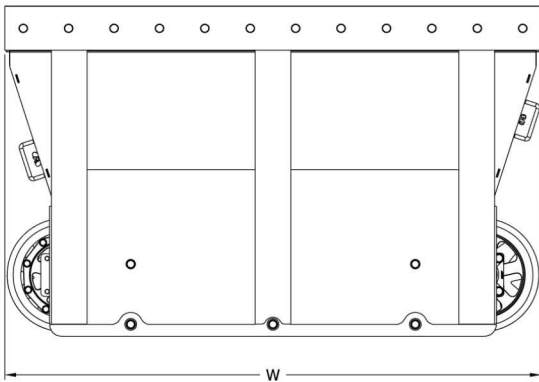

DESCRIPTION	
4in1 BUCKETS	
W	1600mm - 1800mm
D	860mm - 940mm
H	990mm - 1110mm
Weight	480 - 590KG

SCOOP



CARRY



DISCHARGE



**Norm Engineering conveyor buckets are designed to suit individual machine models.**  
Please contact the team at Norm Engineering or your closest dealer  
for the exact specifications to suit your machine.

\* Images may contain optional extras. All images shown are for illustration purposes only. Actual product may vary.





The Norm Engineering General Purpose Buckets are built to suit your specific needs.

These buckets are ideal for scooping, carrying and dumping material.

Material that is sold by volume requires the volume (Capacity) of the bucket to be verified. Norm Engineering offers an option for the GP Bucket to be verified in accordance with National Measuring Institute. Most GP buckets manufactured by Norm Engineering can be verified at the time of manufacture.



## GENERAL PURPOSE BUCKETS & LIGHT MATERIAL BUCKETS

### FEATURES

#### BEST SUITED TO:

- » Mini loaders
- » Skid steer loaders
- » Track loaders
- » Wheel Loaders
- » Backhoes
- » Telehandlers

- Purpose built to suit specific applications
- Option of bolt on edge
- Width can be customised
- Flat bottom

#### SUITABLE FOR:

- » Construction work
- » Asphalt contractors
- » General clean up
- » Landscape yards
- » Agriculture

#### OPTIONAL:



BOLT ON EDGE



# SPECIFICATIONS

# GENERAL PURPOSE BUCKETS

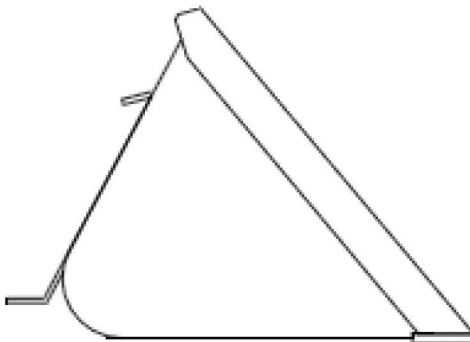
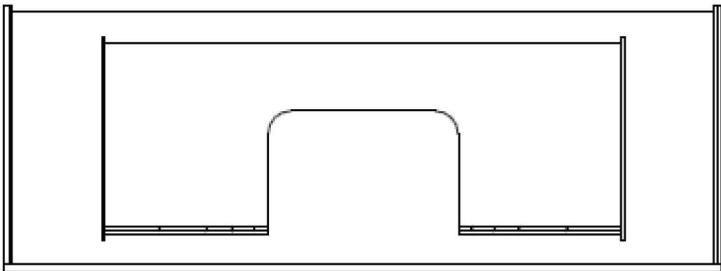

**Norm Engineering buckets are designed to suit individual machine models.**  
Please contact the team at Norm Engineering or your closest dealer for the exact specifications to suit your machine.

DESCRIPTION	
GENERAL PURPOSE BUCKETS	
W	915mm - 2400mm
D	700mm - 1330mm
H	460mm - 720mm
Weight	90 - 414KG

\* Images may contain optional extras. All images shown are for illustration purposes only. Actual product may vary.





The Norm Engineering skeleton and sieve rake buckets are used to filter material.

The bucket scoops debris and rubble; by shaking the bucket all the loose soil and small stones escapes through the sieve tynes leaving you with only the larger rubbish/rubble in the bucket.

This bucket allows you to reduce the weight of your load, therefore reducing your costs for waste disposal charges.

The sieve rake bucket has tynes that extend beyond the bucket edge.

Ideal for clearing land, sorting through debris and beach clean ups.



## SIEVE RAKE BUCKETS

### SUITABLE FOR:

- |                     |                              |
|---------------------|------------------------------|
| » Council work      | » Land clearing              |
| » Construction work | » Waste & recycle management |
| » Agricultural work | » Firewood collection        |
| » Landscaping       | » Beach clean up             |

## FEATURES

### BEST SUITED TO:

- |                      |  |
|----------------------|--|
| » Mini loaders       | • 70mm is the standard tyne spacing                              |
| » Skid steer loaders | • Tyne spacing can be customised to accommodate individual needs |
| » Track loaders      | • Tynes are 12-16mm thick  |
| » Wheel loaders      | • Tynes are 500 grade quench and tempered plate                  |
| » Backhoes           | • Sides can be raised to carry a larger load                     |
| » Telehandlers       |  |



## SKELETON BUCKETS





SKELETON BUCKETS

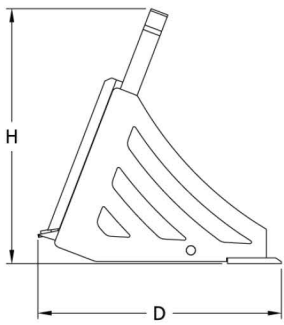
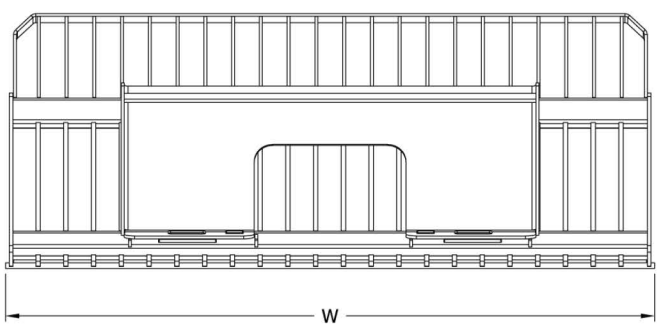

DESCRIPTION	
SKELETON BUCKETS	
W	915mm - 2150mm
D	680mm - 810mm
H	550mm - 710mm
Weight	133 - 264KG



SIEVE RAKE BUCKETS

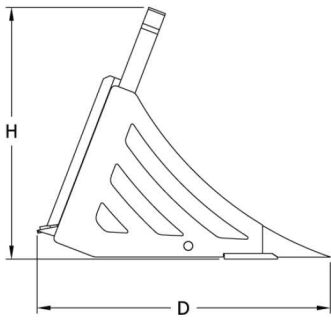
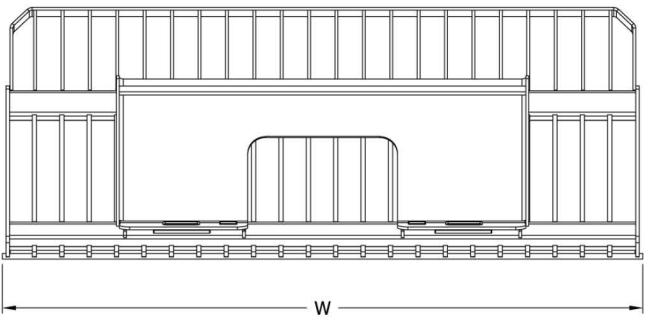

DESCRIPTION	
SIEVE RAKE BUCKETS	
W	915mm - 2150mm
D	820mm - 890mm
H	550mm - 710mm
Weight	137 - 278KG



Norm Engineering buckets are designed to suit individual machine models.  
Please contact the team at Norm Engineering or your closest dealer  
for the exact specifications to suit your machine.



## SPECIFICATIONS

### HIGH DUMP BUCKETS:

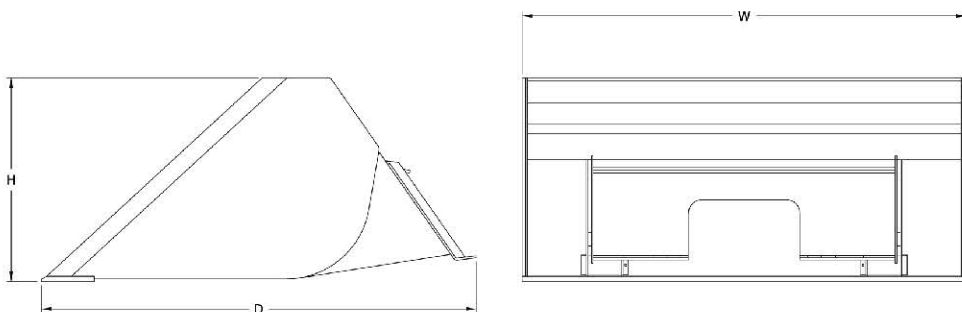

#### SUITABLE FOR:

- » Construction work
- » Land management
- » Waste & recycling yards
- » Agricultural work
- » Landscaping

**MOVING** the earth for you

**Norm Engineering buckets are designed to suit individual machine models.**

Please contact the team at Norm Engineering or your closest dealer for the exact specifications to suit your machine.

#### DESCRIPTION

##### HIGH DUMP BUCKETS

W	1730mm - 2100mm
D	1570mm
H	660mm
Weight	478 - 520KG

### SIDE TIPPING BUCKETS:

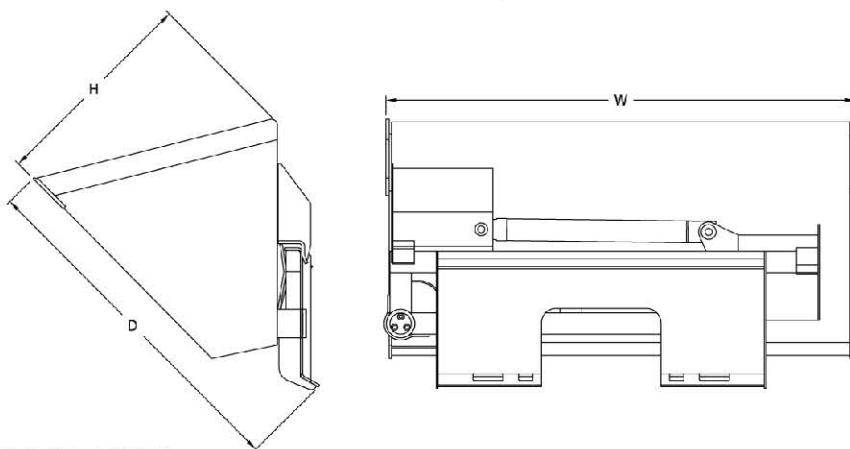

#### SUITABLE FOR:

- » Mining
- » Pipelines
- » Construction work
- » Agricultural work
- » Landscaping

#### DESCRIPTION

##### SIDE TIPPING BUCKETS

W	1650mm - 2200mm
D	1150mm
H	750mm
Weight	460 - 520KG

## BUCKETS



#### BEST SUITED TO:

- » Mini loaders
- » Skid steer loaders
- » Track loaders
- » Wheel loaders
- » Backhoes





## SPECIFICATIONS

## BUCKETS

### STEMMING BUCKETS:

**MOVING** the earth for you

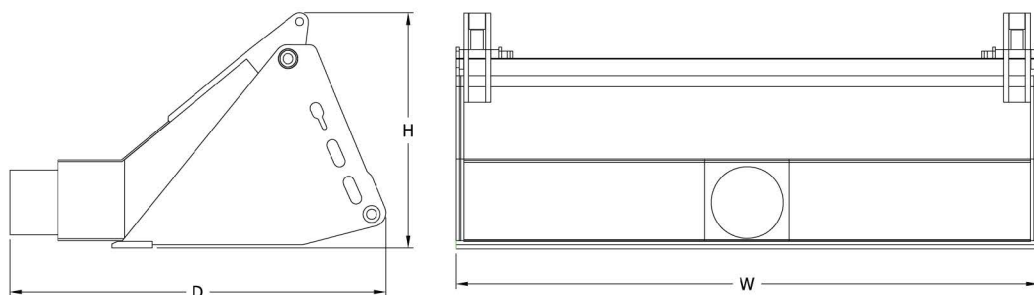

#### SUITABLE FOR:

- » Mining
- » Construction work
- » Landscaping
- » Pipelines
- » Agricultural work

#### DESCRIPTION

##### STEMMING BUCKETS

W	1880mm - 2150mm
D	1000mm
H	720mm
Weight	390 - 420KG

### FUNNEL BUCKETS:

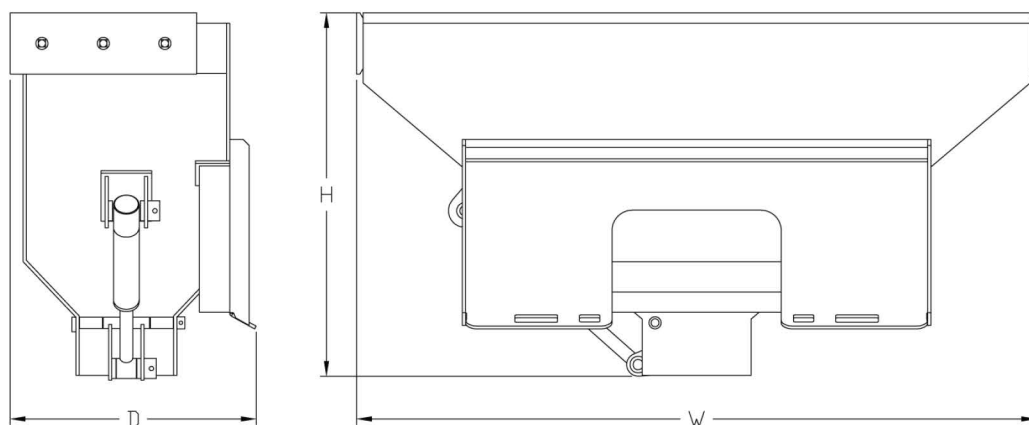

#### SUITABLE FOR:

- » Mining
- » Construction work
- » Landscaping
- » Pipelines
- » Agricultural work

#### DESCRIPTION

##### FUNNEL BUCKETS

W	1685mm
D	610mm
H	900mm
Weight	325KG



#### BEST SUITED TO:

- » Mini loaders
- » Skid steer loaders
- » Track loaders
- » Wheel loaders
- » Backhoes







The Norm Engineering stump bucket is the perfect solution for removing stumps. It consists of 3 replaceable teeth, angled serrated edges on both sides of the bucket, and a 300mm wide floor.

The stump bucket is used to dig underneath the stump and leverage the stump out of the ground by pulling back and allowing the angled serrated edges to grip and pull up the roots, lifting the stump out of the ground.

The length and curved floor provides more leverage.

The teeth dig and loosen any hard ground.

The stump bucket is ideal for lifting and removing stumps, small trees, shrubs, rocks, posts and turf.



## STUMP BUCKET

### SUITABLE FOR:

- » Agricultural work
- » Landscaping

## FEATURES

### BEST SUITED TO:

- » Mini loaders
- » Skid steer loaders
- » Track loaders
- » Wheel loaders
- » Backhoes
- » Telehandlers

- Angled serrated edges
- 3 replaceable teeth
- 300mm wide floor

## SPECIFICATIONS

**MOVING**  
the earth for you

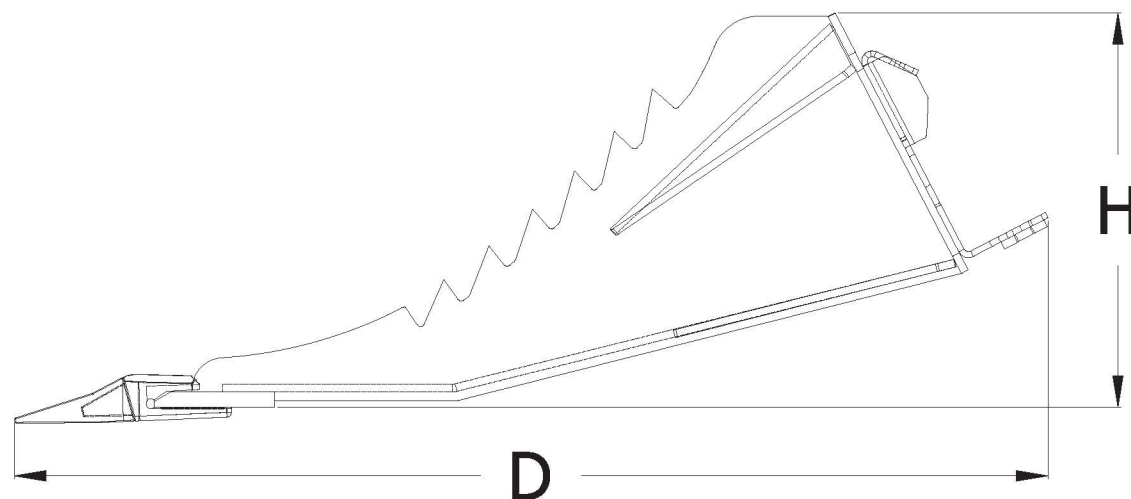
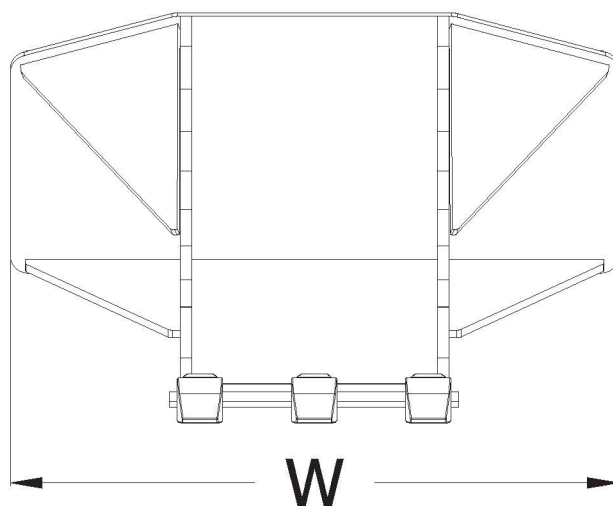

DESCRIPTION	
STUMP BUCKET	
W	500mm - 1200mm
D	1070mm - 1335mm
H	425mm - 615mm

**Norm Engineering buckets are designed to suit individual machine models.**  
Please contact the team at Norm Engineering or your closest dealer for the exact specifications to suit your machine.





Norm Engineering excavator trench and mud buckets are designed with a flat bottom to leave a cleaner trench.

Wear strips are added to give extra strength and protects the bucket giving it a longer life span.

There is an option of bolt on side cutters which increases the bucket size width by 50mm.

Mud buckets have an optional tilt.

Excavator attachment packages are available.



## EXCAVATOR TRENCH BUCKETS

### SUITABLE FOR:

- » Construction work
- » Agriculture
- » Landscaping

### FEATURES

#### BEST SUITED TO:

- » Excavators
- » Backhoes
- » Telehandlers

- Suit machines 0.8 - 14 tonnes
- Flat bottom
- Wear strips for extra strength
- Pre-drilled side walls to accommodate for optional side cutters
- Smooth edges available

### OPTIONAL:



CHISEL STYLE TEETH



TIGER STYLE TEETH



BATTER BLADE



SIDE CUTTERS



SLIP ON SMOOTH EDGE



REVERSIBLE BOLT ON CUTTING EDGE



# EXCAVATOR TRENCH BUCKETS

## SPECIFICATIONS

**MOVING** the earth for you

**MUD BUCKET**

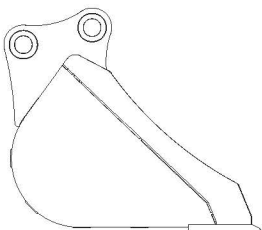

**TRENCH BUCKETS**

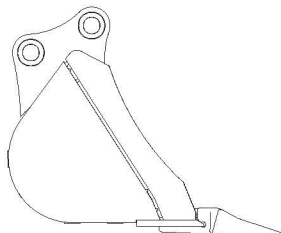

**RIPPER**

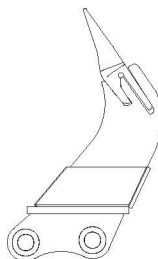

40° in both directions

**TILTING MUD BUCKETS**

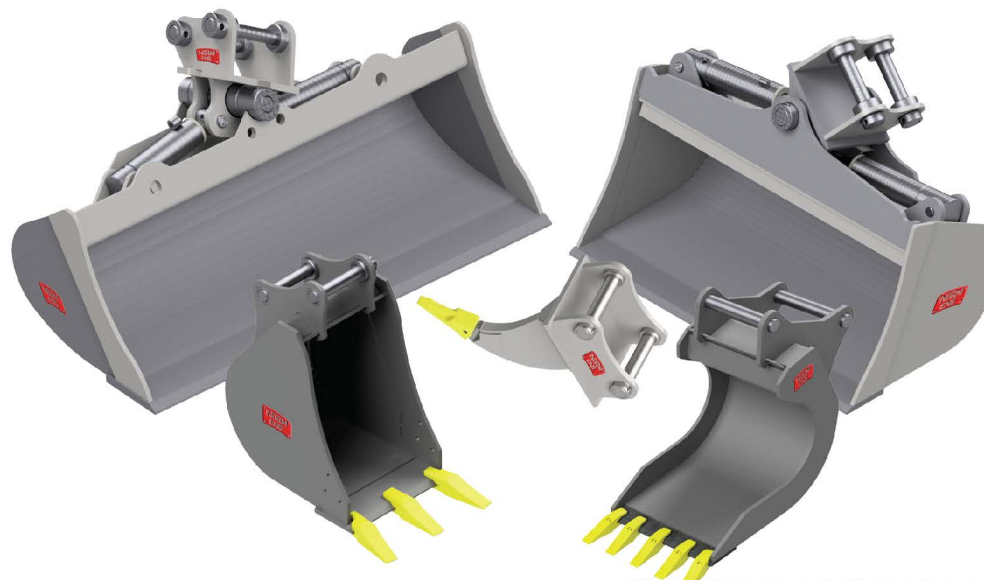
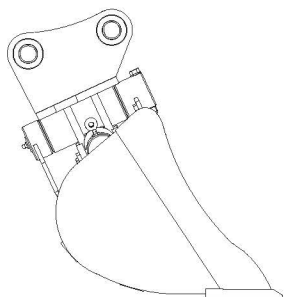

**EXCAVATOR PACKAGES AVAILABLE**

DESCRIPTION	0.8 TONNE	1.5 TONNE	3 TONNE	3.5 TONNE	4.5 TONNE	5.5 TONNE	8 TONNE	12 TONNE
	Width in mm							
Trench Buckets	150 - 900	200 - 900	200 - 900	200 - 900	300 - 900	300 - 900	300 - 900	300-1200
Banana Buckets	150	150	150-200	150-200	150 - 200	150 - 200	200	200 - 250
Sieve Buckets	1000	1000	1000	1000	1200 - 1500	1200 - 1500	1500	1500
Mud Buckets	600 - 900	600 - 900	1000	1000	1200 - 1500	1200 - 1500	1200 - 1500	1500 - 1800
Tilting Mud Buckets	900	900	1000	1000	1200	1200 - 1500	1200 - 1500	1500





The Norm Engineering log and rock grabs are designed to have the strength to work in the roughest environments; they suit all excavators ranging from 1.5 tonne through to 25 tonne.

The log and rock grabs are available with 5 tynes. The grab can either be fully hydraulic or they can be static.

Cylinders are enclosed for ultimate protection whilst working in harsh environments.

Batter blades come standard with 3½ tonne and smaller machines. By adding a batter blade you minimise damage when picking up sandstone blocks, pavers etc.

## SUITABLE FOR:

- » Construction
- » Recycling yards
- » Waste management
- » Landscaping
- » General cleanup
- » Forestry
- » Pipe work

3½ Tonne and smaller come standard with a batter blade.

## OPTIONAL:



BATTER BLADE

## LOG AND ROCK GRABS



## FEATURES

### BEST SUITED TO:

- » Excavator
- » Backhoes

- Ranging from 1.5 - 25 tonne
- Cylinders enclosed for protection
- One or two cylinders depending on machine
- Five tynes
- Serrated edges for stronger grip
- Wide opening jaws
- Hydraulic or static option
- Hydraulic option Includes hoses & couplings
- Low maintenance
- No extra plumbing required





## SPECIFICATIONS

## LOG AND ROCK GRABS

**MOVING** the **earth** for **you**

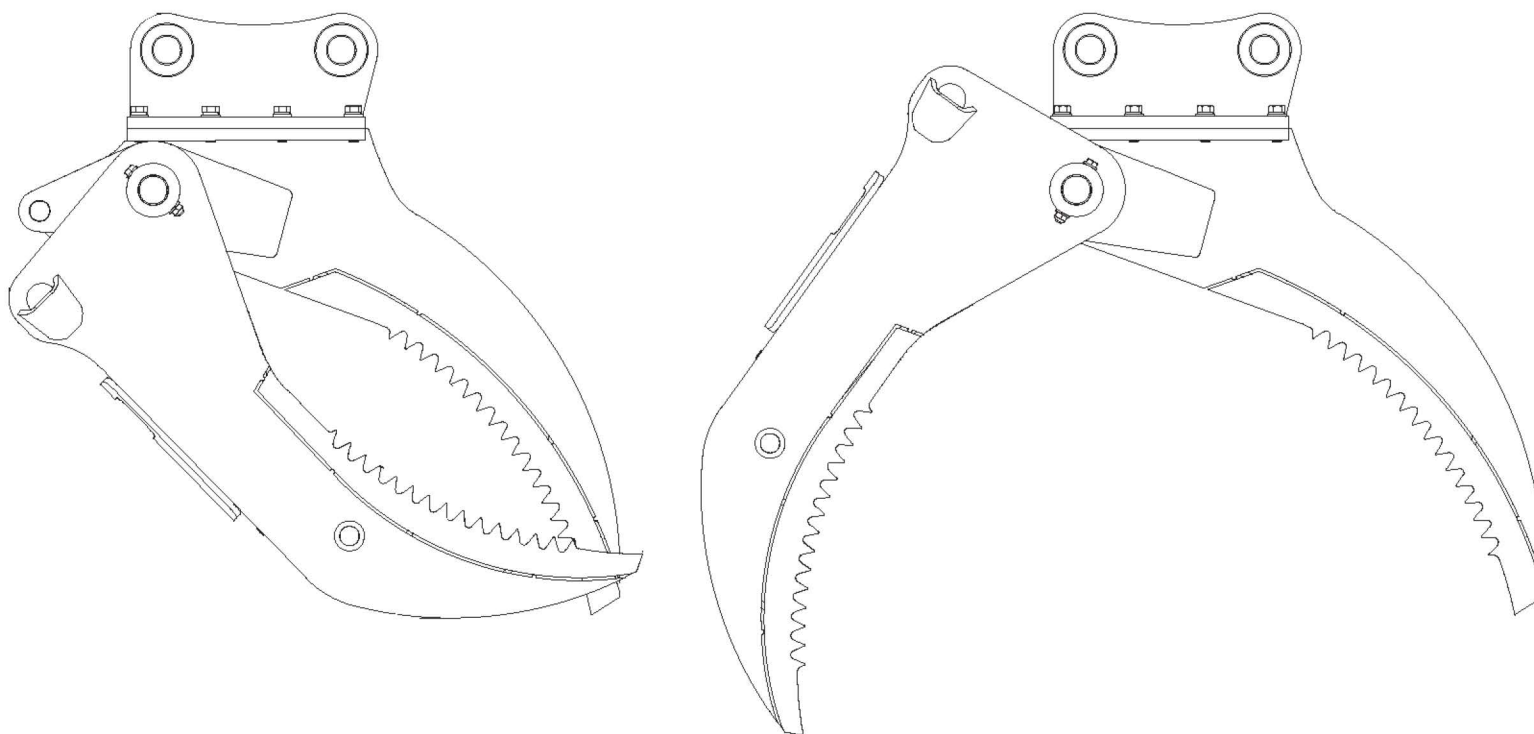





The Norm Engineering fixed backhoe arm has a trench bucket attached to a dipper arm.

The fixed backhoe arm comes standard with a 300mm trench bucket with teeth, other size buckets are available. The teeth are used for more aggressive digging.

Maximum digging depth approximately 2metres.

This is ideal for digging trenches for laying pipes, electrical conduit, water drainage and fence lines.



## FIXED BACKHOE ARMS

### FEATURES

#### BEST SUITED TO:

- » Mini loaders
- » Skid steer loaders
- » Track loaders

- 300mm trench bucket supplied as standard (other sizes available)
- Maximum digging depth approximately 1.5 metres
- Replaceable chisel teeth

- Includes hoses & couplings
- Low maintenance
- No extra plumbing required
- Hitch options available

#### SUITABLE FOR:

- » Digging trenches
- » Construction work
- » Agricultural work
- » Plumbing
- » Landscaping
- » Fencing

#### OPTIONAL:



TIGER TEETH

## SPECIFICATIONS

## FIXED BACKHOE ARMS

**MOVING** the earth for you

### SPECIFICATIONS

#### FIXED BACKHOE ARMS

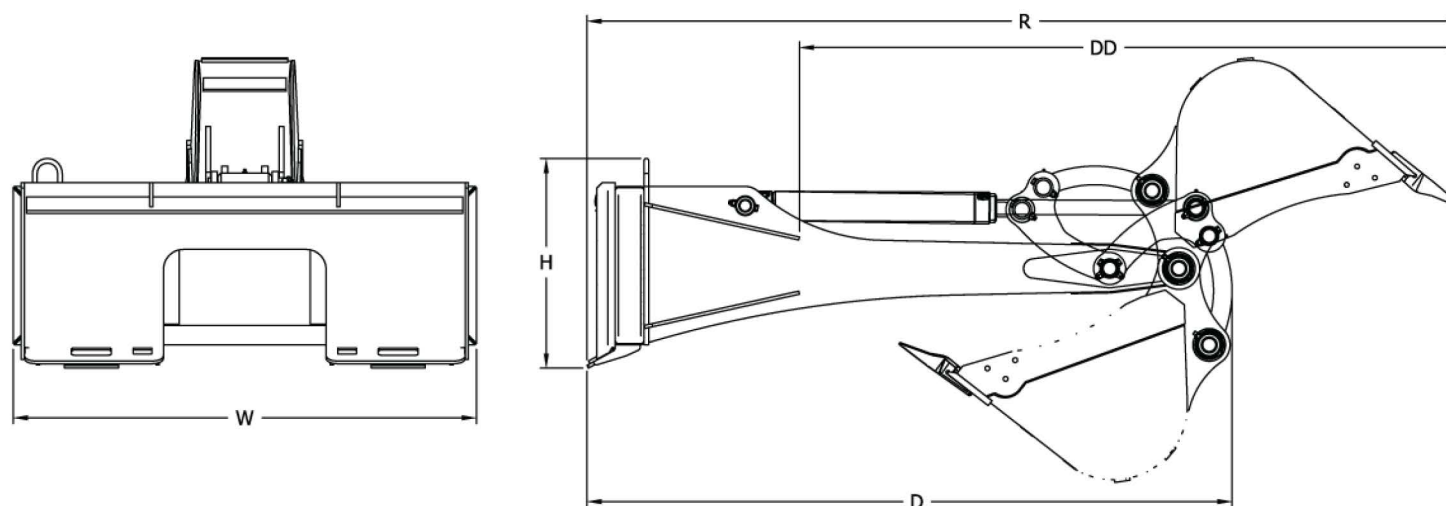

#### PRODUCT NOTES

DESCRIPTION	REACH [R] [CM]	DIG DEPTH [DD] [CM]
Mini	140	111
Regular	227	172

#### DESCRIPTION

##### FIXED BACKHOE ARMS

W	700mm - 1200mm
D	1020mm - 1690mm
H	350mm - 540mm
Weight	120 - 260KG

**Norm Engineering fixed backhoe arms are designed to suit individual machine models.**

Please contact the team at Norm Engineering or your closest dealer for the exact specifications to suit your machine.







The Norm Engineering slewing backhoe arm increases the flexibility of your skid steer loader machine with a trench bucket attached to a hydraulically operated dipper arm.

With a 70° swing each way, the slew or "swing" design eliminates the need to move the machine to empty the bucket, this is ideal when working on lawns or other surfaces that can be ruined by skid steer and track machine movement.

Maximum digging depth approximately 1.5 metres.

You can dig, slew and dump material with a smooth operation from inside the cab.

This is ideal for digging trenches for laying pipes, electrical conduit, water drainage and fence lines.

#### SUITABLE FOR:

- » Digging trenches
- » Construction work
- » Agricultural work

- » Plumbing
- » Landscaping
- » Fencing

#### OPTIONAL:



TIGER TEETH

## SLEWING BACKHOE ARMS



### FEATURES

#### BEST SUITED TO:

- » Mini loaders
- » Skid steer loaders
- » Track loaders

- 300mm trench bucket supplied as standard (other sizes available)
- 70° Swing left or right
- Maximum digging depth approximately 1.5 metres

- Replaceable chisel teeth
- Includes hoses & couplings
- Low maintenance
- No extra plumbing required
- Hitch options available







SLEWING BACKHOE ARMS

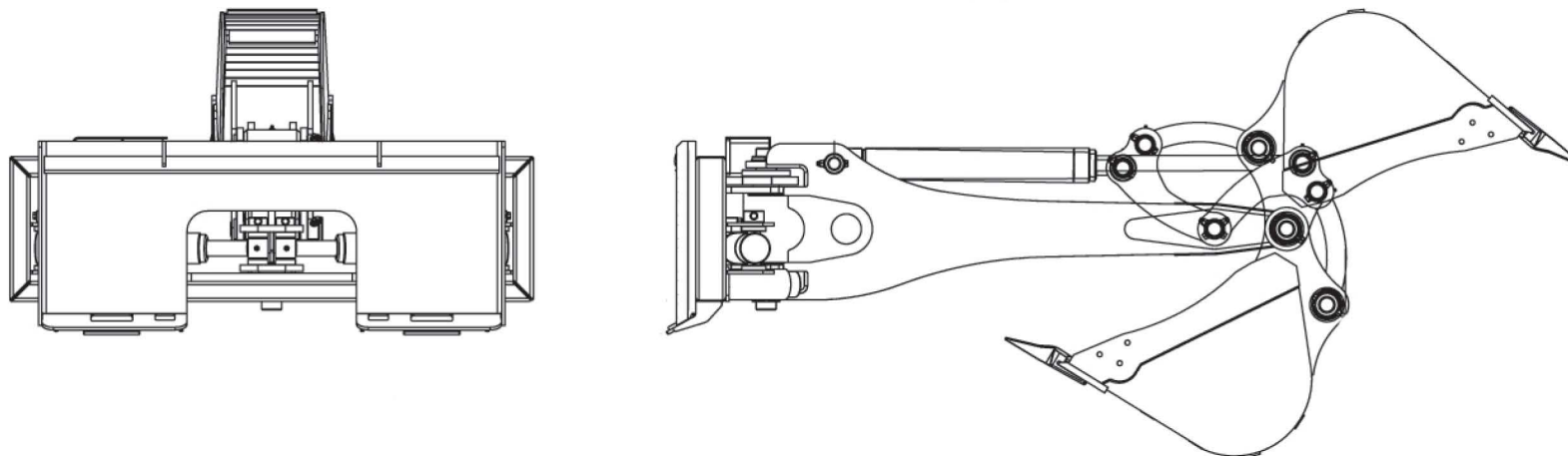

PRODUCT NOTES

- Electrical Requirements: 12V signal is necessary to operate slew function.

DESCRIPTION	REACH [R] [CM]	DIG DEPTH [DD] [CM]
Mini	160	123
Regular	227	185

DESCRIPTION	
SLEWING BACKHOE ARMS	
W	1300mm
D	1240mm - 1690mm
H	320mm - 490mm
Weight	165 - 310KG



**Norm Engineering slewing backhoe arms are designed to suit individual machine models.**  
Please contact the team at Norm Engineering or your closest dealer for the exact specifications to suit your machine.





The Norm Engineering dozer blade stick rake is a dual-purpose attachment that consists of a heavy duty dozer blade and a stick rake.

The dozer blade includes a standard replaceable bolt on edge and is ideal for moving large amounts of sand, soil and debris.

The heavy duty stick rake tynes are ideal for clearing and raking. The number of heavy duty tynes depends on the width of the attachment.

Best suited for construction, farming, forestry and mining environments.

Supplied with skids. Skids provide a height guide and prevent the tynes from digging in.



## DOZER BLADE STICK RAKES

### SUITABLE FOR:

- » Council work
- » Construction work
- » Agricultural work
- » Landscaping
- » Land management
- » Waste & recycling yards
- » Mining

### FEATURES

#### BEST SUITED TO:

- » Mini loaders
- » Skid steer loaders
- » Track loaders
- » Backhoes
- » Telehandlers
- » Tractors

- Reversible attachment
- Dozer blade one side
- Stick rake one side
- Number of tynes depends on the width of the attachment

- Dozer comes with reversible bolt on cutting edge
- Tynes are 12-16mm thick
- Tynes are 500 grade quench and tempered plate

### STANDARD:



REMOVABLE SKID

## DOZER BLADE STICK RAKE

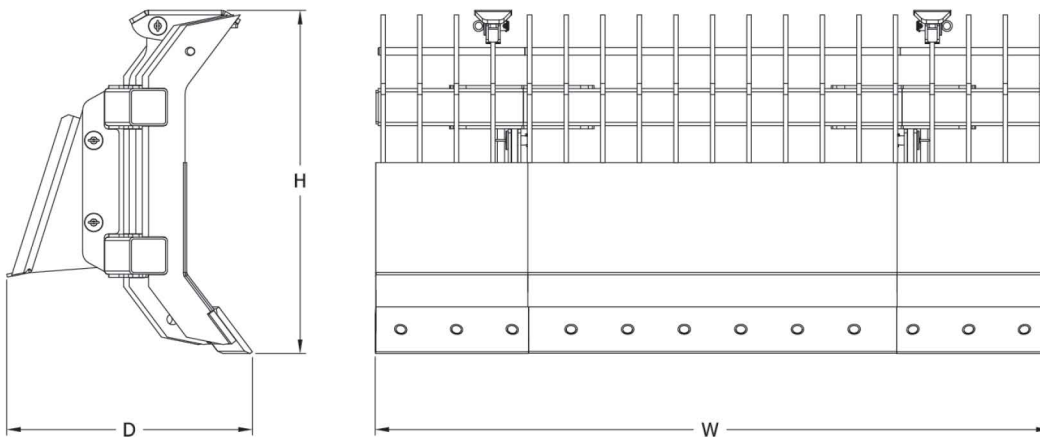

### DESCRIPTION

#### DOZER BLADE STICK RAKE

W	900mm - 3000mm
D	675mm - 565mm
H	925mm - 740mm

### REVERSE ATTACHMENT:

It is a simple process to flip your attachment to make use of either edge:

- » Remove the four retaining pins
- » Manoeuvre your machine to the opposite side of the attachment
- » Realign your machine with your attachment and replace the retaining pins.

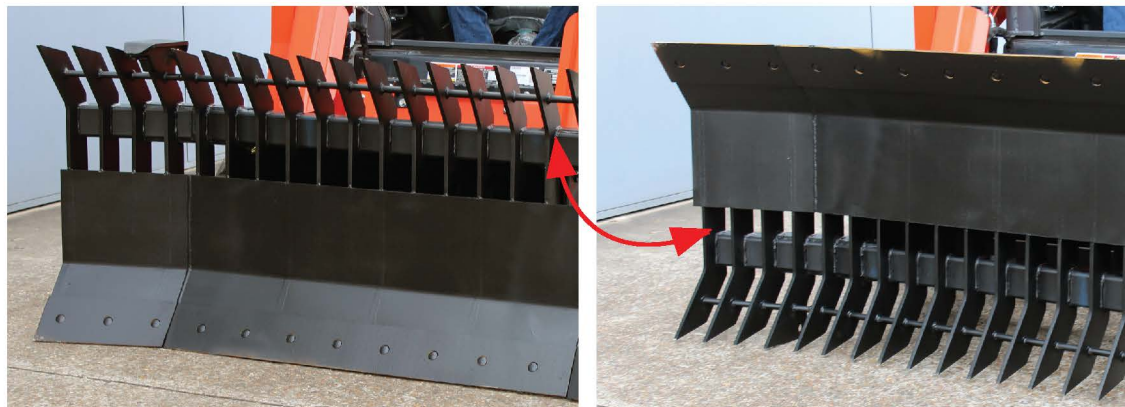

**Norm Engineering dozer blade stick rakes are designed to suit individual machine models.**

Please contact the team at Norm Engineering or your closest dealer for the exact specifications to suit your machine.







Available as an angle only or angle and tilt, the Norm Engineering heavy duty dozer blade is the ideal attachment for precise trimming, grading and backfilling.

With an angle function of 28° each way and a tilt function of 17° each way this attachment provides the ultimate level of control.

Angle and tilt blades are available as a plug and play option for most machines and require no additional hydraulics to be fitted.



## ANGLE DOZER BLADES | ANGLE & TILT DOZER BLADES

### FEATURES

#### BEST SUITED TO:

- » Mini loaders
- » Skid steer loaders
- » Track loaders
- » Wheel loaders

- Dozer blade
- Supplied standard with a replaceable bolt on edge
- 28° angle function each way
- Angle & tilt dozer blade - 17° tilt function each way

#### SUITABLE FOR:

- » Council work
- » Construction work
- » Agricultural work
- » Landscaping
- » Road maintenance
- » Waste & recycle management

## SPECIFICATIONS

## ANGLE & TILT DOZER BLADES

**MOVING**  
the **earth** for you

### ANGLE DOZER BLADE

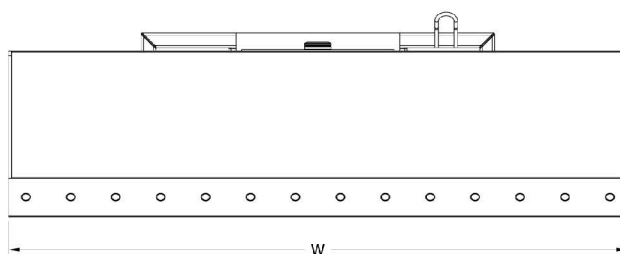
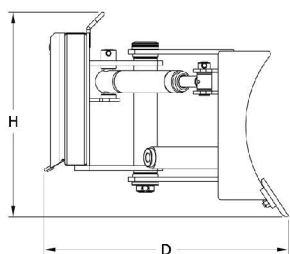

#### DESCRIPTION

##### ANGLE DOZER BLADE

W	1400mm - 2500mm
D	470mm - 690mm
H	460mm - 830mm
Weight	93-450KG

### ANGLE & TILT DOZER BLADE

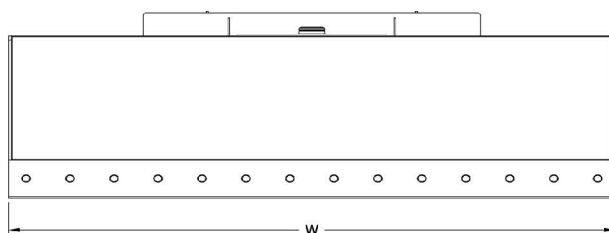
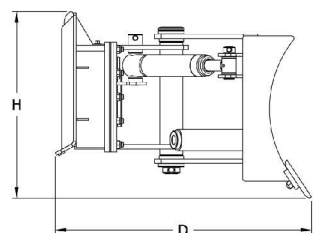

#### DESCRIPTION

##### ANGLE & TILT DOZER BLADE

W	1400mm - 2500mm
D	520mm - 740mm
H	460mm - 830mm

## PRODUCT NOTES

- Electrical Requirements: 12V signal is necessary to operate slew function.

**Norm Engineering dozer blades are designed to suit individual machine models.**

Please contact the team at Norm Engineering or your closest dealer for the exact specifications to suit your machine.

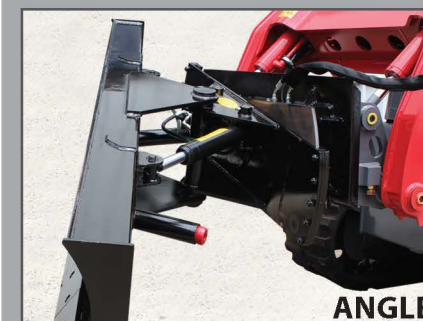



The stick rake design includes dual rakes, each having a different tyne spacing.

One rake section is designed with the tynes spaced wider apart to allow for quick raking over a large surface area, while the other rake section is designed with the tynes closer together to handle finer raking.

The stick rake is ideal for clearing areas, moving rubble and debris.

Supplied with skids. Skids provide a height guide and prevent the tynes from digging in.



## STICK RAKES

### SUITABLE FOR:

- » Council work
- » Construction work
- » Agricultural work
- » Landscaping
- » Land management
- » Waste & recycling yards
- » Mining

## FEATURES

### BEST SUITED TO:

- » Mini loaders
- » Skid steer loaders
- » Track loaders
- » Telehandlers
- » Tractors

- Reversible attachment
- Wider tyne spacing on one side
- Number of tynes depends on the width of the attachment
- Tynes are 12-16mm thick
- Tynes are 500 grade quench and tempered plate

### STANDARD:

Removable skid is used as a height guide that stops the tynes from digging into the ground.



REMOVABLE SKID



## SPECIFICATIONS

# REVERSIBLE STICK RAKES

**MOVING** the earth for you

### REVERSIBLE STICK RAKES

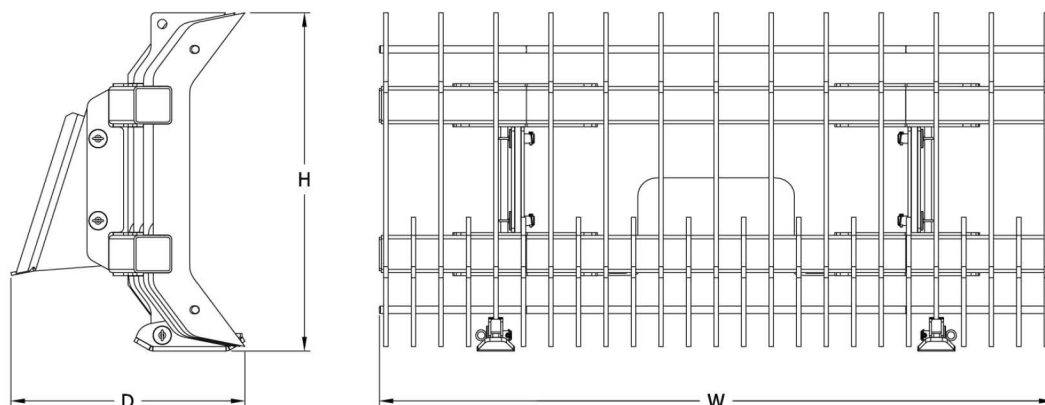

DESCRIPTION	
REVERSIBLE STICK RAKES	
W	900mm - 3000mm
D	645 mm - 565mm
H	910mm - 740mm

### REVERSE ATTACHMENT:

It is a simple process to flip your attachment to make use of either edge:

- » Remove the four retaining pins
- » Manoeuvre your machine to the opposite side of the attachment
- » Realign your machine with your attachment and replace the retaining pins.

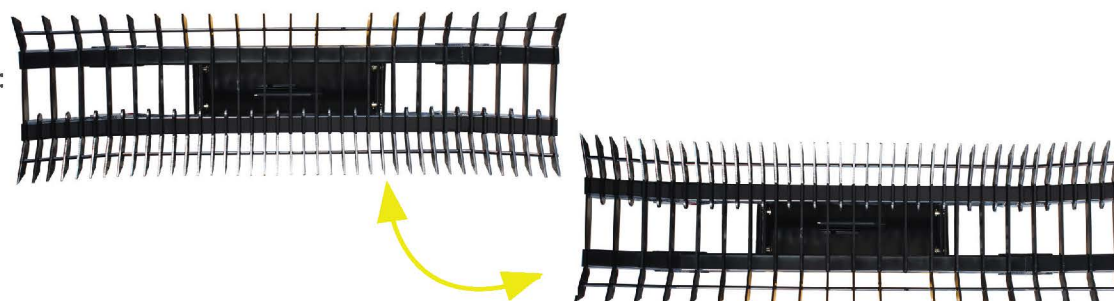

### PRODUCT NOTES

- Custom stick rake sizes and designs can be arranged.
- Hydraulic tilt control can be added to any stick rake upon request.

**Norm Engineering stick rakes are designed to suit individual machine models.**

Please contact the team at Norm Engineering or your closest dealer for the exact specifications to suit your machine.







Norm Engineering manufactures front rippers and rear hydraulic rippers.

Hydraulic rippers are designed to excavate the toughest material.

Rear rippers are custom made to suit different machines.

Easily replaceable tynes are fitted with heavy duty ripper teeth.

Tynes can be removed to suit individual tasks and requirements.

Available in kit form or can be custom fit to your machine.



## REAR HYDRAULIC RIPPERS

### SUITABLE FOR:

- » Council work
- » Construction work
- » Agricultural work
- » Landscaping

## FEATURES

### BEST SUITED TO: (FRONT RIPPERS)

- » Mini loaders
  - » Skid steer loaders
  - » Track loaders
- ### (REAR RIPPERS)
- » Track loaders

- Standard with 5 tynes (removable) - other options available
- Heavy duty tynes with replaceable teeth
- Can be custom fitted to your machine
- Kits are available for domestic and international orders



## HEAVY DUTY FRONT RIPPERS





REAR RIPPERS

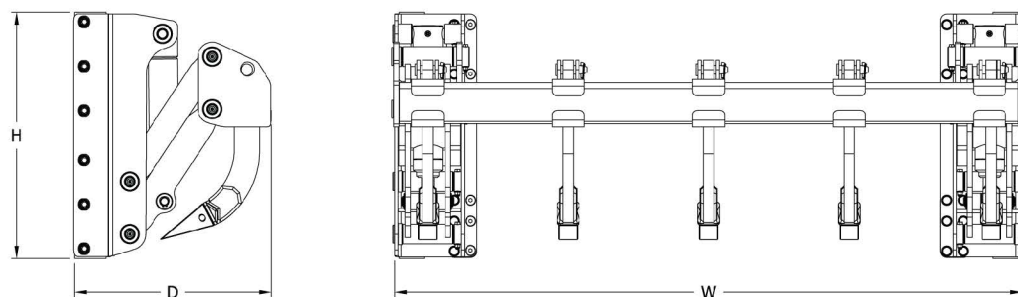

DESCRIPTION

REAR RIPPERS

The weight, width, length, height, number of tynes, ripping depth etc. all depends on the machine that the rippers are being fitted to. Please contact the team at Norm Engineering for the correct specifications for your machine.

FRONT RIPPERS

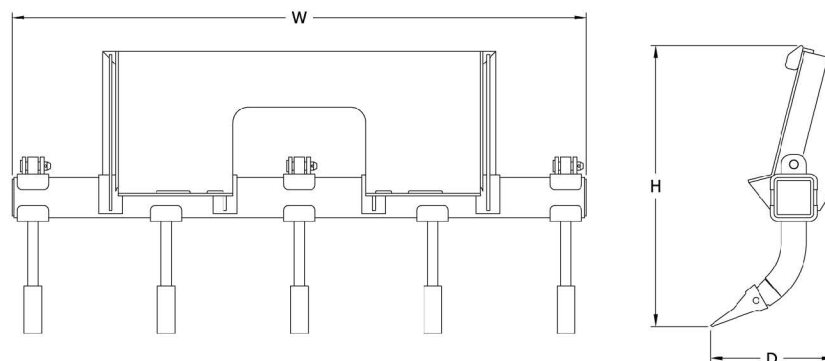

DESCRIPTION

FRONT RIPPERS

W	1000mm - 1800mm
D	390mm - 405mm
H	860mm - 915mm

**Norm Engineering rippers are designed to suit individual machine models.**

Please contact the team at Norm Engineering or your closest dealer for the exact specifications to suit your machine.





The **PIN EYE STYLE** pallet fork system has a backing plate with a round bar incorporated into the design. The tynes are placed onto the bar, once the bar has been secured with bolts, the tynes can move up and down, or sideways. The tynes move independently making them ideal for undulating surfaces. The tynes can be slid across the bar to alter the distance apart, allowing you to choose a suitable width depending on your load requirements.

The **CARRIAGE STYLE** Pallet Forks system has a backing plate with a notched bar incorporated into the design. The notches allow the tynes to lock into a fixed position before being secured with a clip. The tynes can be slid along the bar sideways to determine the correct width required. The carriage style pallet forks are unable to move up and down. The Fixed tynes are best suited to flat surfaces.



## PALLET FORKS (WITH BALE SPEARS)

### SUITABLE FOR:

- » Construction work
- » Residential work
- » Agricultural work
- » Factories/warehousing
- » Landscape yards

### FEATURES

#### BEST SUITED TO:

- » Mini loaders
- » Skid steer loaders
- » Track loaders
- » Wheel loaders
- » Backhoes
- » Telehandlers
- » Tractors
- Fork load capacity ranges from 800 - 4000kgs
- A reinforced load guard is designed to protect the operator from falling material.

### OPTIONAL:

Pallet Fork and Hay Spear Combo available.



HAY BALE SPEARS



SPECIFICATIONS



PALLET FORKS (PIN EYE STYLE)

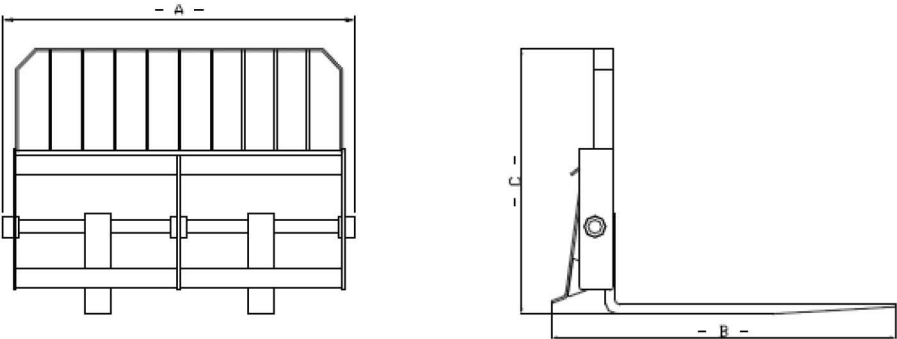

DESCRIPTION	
PALLET FORKS	
W	850mm - 2000mm
D	1300mm - 1600mm
H	730mm - 780mm

For more information on the pallet forks with a tilt coupler, speak to the team at Norm Engineering.



**Norm Engineering pallet forks are designed to suit individual machine models.**  
Please contact the team at Norm Engineering or your closest dealer for the exact specifications to suit your machine.

PALLET FORKS WITH TILT COUPLER





The Norm Engineering hay bale grab is designed to lift and transport 4ft, and 6ft hay bales.



**SUITABLE FOR:**  
» Agriculture industry

## FEATURES

### BEST SUITED TO:

- » Skid steer loaders
- » Track loaders
- » Wheel loaders
- » Backhoes
- » Telehandlers
- » Tractors

- Handle 4ft & 6ft hay bales
- Hydraulic operation
- Optional tilt



## HAY BALE GRABS

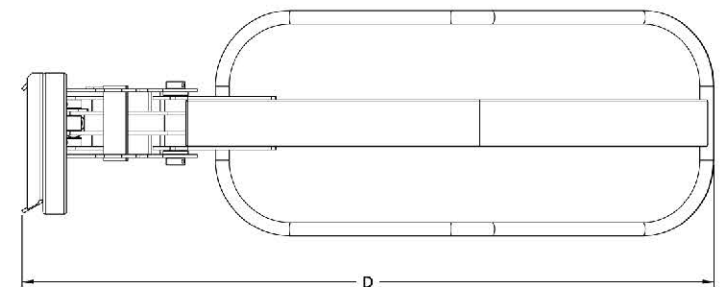
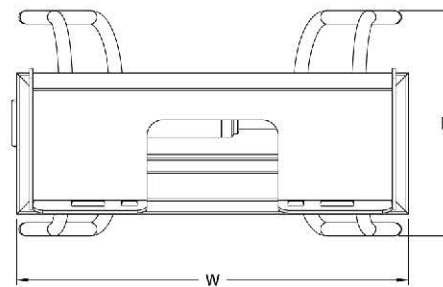

**Norm Engineering hay bale grabs are designed to suit individual machine models.**

Please contact the team at Norm Engineering or your closest dealer for the exact specifications to suit your machine.

### DESCRIPTION

#### HAY BALES

W	1250mm
D	2140mm - 2345mm
H	720 mm



The Norm Engineering spreader bar is either attached to a 4-in-1 bucket or direct mounted to the quick coupler. The spreader bar is used to level areas of gravel, sand, dirt and rubble etc. The pick-up points are designed to reduce stress on the bucket.

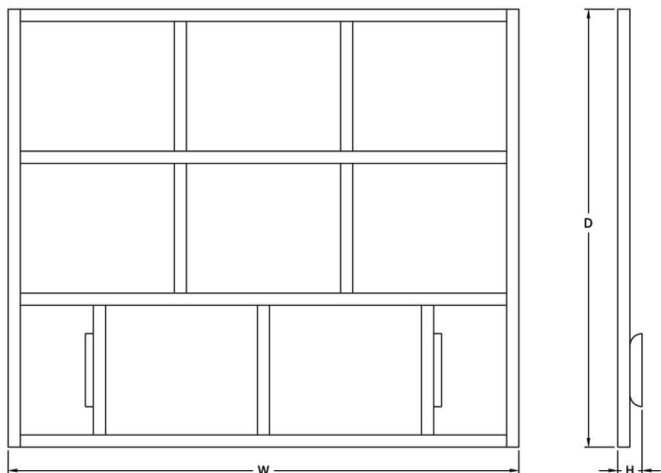

## FEATURES

### BEST SUITED TO:

- » Mini loaders
- » Skid steer loaders
- » Track loaders
- » Wheel loaders
- » Backhoes
- » Telehandlers

- Heavy duty rectangular hollow section
- Standard 12-16mm wear strips



## SPREADER BAR

### SUITABLE FOR:

- » Construction work
- » Agricultural work
- » Landscaping
- » Land management

Custom spreader bar sizes and designs are available upon request.

### CARRY-ALL



**Norm Engineering spreader bars are designed to suit individual machine models.**

Please contact the team at Norm Engineering or your closest dealer for the exact specifications to suit your machine.

### DESCRIPTION

#### Spreader Bars

W	1000mm - 3000mm
D	1000mm - 3000mm
H	100mm - 300mm



The Norm Engineering aluminium ramps are best suited to machines from 3-8 tonne.

Designed for rubber tracks.



## FEATURES

### BEST SUITED TO:

- » Skid steer loaders
- » Track loaders
- » Wheel loaders

- Aluminium Ramps



## RAMPS

### SUITABLE FOR:

- » Loading & unloading

PART NUMBER	LENGTH	WEIGHT [KG]	DIMENSIONS [CM] [WxDxH]
<b>RAMPS</b>			
RAMP R/T 3T [3.5m x 325mm Internal Width]	3500mm	60	350 x 43 x 21
RAMP R/T 4T [3.5m x 350mm Internal Width]	3500mm	72	350 x 45 x 25
RAMP R/T 4.5 -5T [3.5m x 470mm Internal Width]	3500mm	80	350 x 53 x 25
RAMP R/T 5T [3.5m x 450mm Internal Width]	3500mm	99	350 x 55 x 30
RAMP R/T 6T [3.5m x 480mm Internal Width]	3500mm	110	350 x 60 x 32
RAMP R/T 8T [3.5m x 480mm Internal Width]	3500mm	136	350 x 60 x 32



**CUSTOM SPECIALS**

For any of your custom specials, please feel free to call Norm Engineering on 07 3376 3177 to discuss your needs.

**MOVING**  
the **earth** for **you**





## **BRISBANE**

PH: +61 7 3376 3177

FAX: +61 7 3376 3201

787 BOUNDARY ROAD

DARRA QLD 4076

SALES@NORMENG.COM.AU

## **MELBOURNE**

PH: +61 3 9775 1965

FAX: +61 3 9770 8054

2/45 FRANKSTON GARDENS DRIVE

CARRUM DOWNS VIC 3201

VICADMIN@NORMENG.COM.AU

## **NEW ZEALAND**

PH: +64 7 889 7080

SALES@NORMENG.CO.NZ

@NORM\_ENGINEERING  
FACEBOOK.COM/NORMENG  
WWW.NORMENG.COM