

## PRODUCT VE1260

HIGH SECURITY MOTORISED DROP BOLT WITH PRE-LOAD CAPABILITY EcoLock™



VE1260

### PRODUCT DESCRIPTION

The patented EcoLock VE1260 is a high torque motor driven Drop Bolt with up to 35kg pre-load/side load tolerance. It can be installed vertically in the door frame (lock style) or horizontally in the frame header and has a symmetric dead-bolt mechanism to allow to be used on 180 degree swing through doors.

The VE1260 is considered a "Green Product" as it consumes an inrush current of 290mA @ 12VDC **only** during locking and unlocking action (Active Mode), then in the locked or unlocked state (Sleep-Mode), the Drop Bolt consumes current less than 15mA @ 12VDC.

A series of additional Strike Plates allow for door misalignment of up to  $\pm 12$ mm and a retrofit version of the FSH Eco Lock is available to suit the PADDE/ TRIMEC ES8000 drop bolt footprint.

An optional LED red/green indicator unit is available.

### TECHNICAL DETAILS

PART NO.	VE1260
FUNCTION	Mortice Mount, power-to-lock/power-to-release field interchangeable, up to 35kg of Pre-Load capability, unlocking and up to 6.5kg locking
HOLDING STRENGTH	Up to 1000kg
VOLTAGE/CURRENT	Multi Voltage 12-30VDC Active Mode: Locking/Unlocking cycle current is 0.29A to 0.85A depending on the side load. More side load = more current. See preload vs. current graph. Sleep-Mode: After locking/unlocking the current drops down to ~0.015A (15mA)
APPROVALS	CE C-Tick Fire rated in accordance with AS1905.1.2005 Part 1 to up to 4 hours on fire door assemblies
MONITORING	Lock Status Sensor of the internal locking mechanism Door Status Sensor Built-in Reed Switch, monitoring the door position
ENVIRONMENTAL	Operational Temperature Range -20 to +60C
DURABILITY	Exceeding Australian Standard AS4145.2-2008 400,000 operating cycles • Durability D7
STRENGTH	Meeting Australian Standard AS4145.2-2008 • Static Strength S8 • Impact Strength S8
MAXIMUM DOOR GAP	8mm
DOOR MISALIGNMENT	Standard Strike Plate $\pm 4$ mm Special Strike Plate up to $\pm 12$ mm

### PRODUCT FEATURES

- Releases with up to 35kg of Pre-Load/Side Load
- Motorised locking device
- Durability tested to 400,000 cycles
- Multi voltage from 12 to 30VDC
- Sleep-Mode Current less than 15mA@12VDC
- Fully monitored including Reed Switch for door position
- Up to 1000kg Holding Strength
- 5 year warranty
- Retrofit version for Trimec/PADDE ES8000 (VE1260S Square Edge Version)

Technical drawing of a door assembly showing dimensions and components:

- LINE 1** (HALF THICKNESS OF DOOR)
- LINE 3**
- 27.0**
- 7.0**
- 53.0**
- 28.0**
- 242.0**
- 132.0**
- 256.0**
- Ø22.0 x 20 DEEP**
- DOOR**
- STRIKE PLATE**  
3mm THICK

## PRODUCT DIMENSIONS AND INSTALLATION

Glass Door Box **VE1260R-GL**

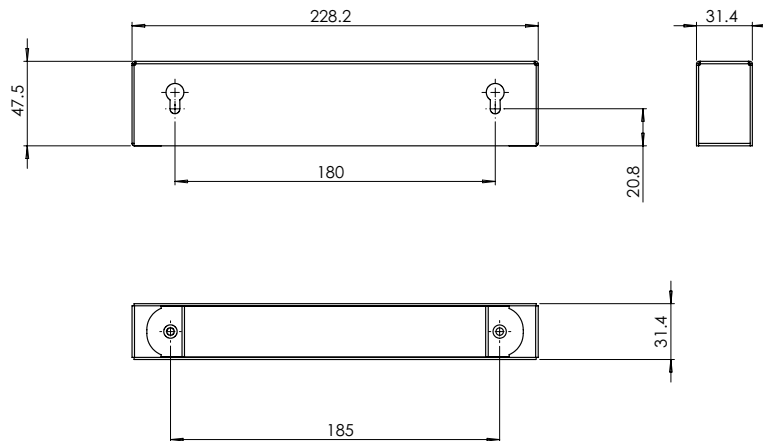

Accessory Strike Plate **VE1260S-ST6**

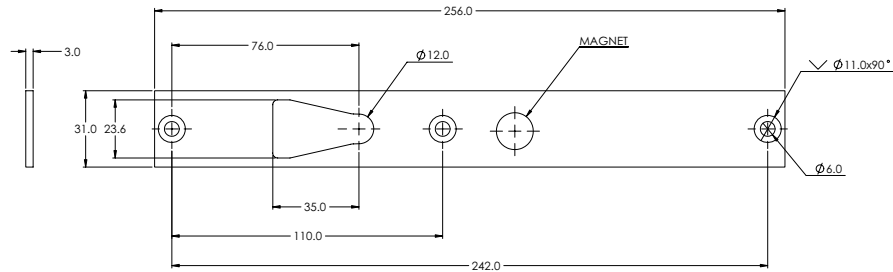

Accessory Strike Plate **VE1260S-ST9**

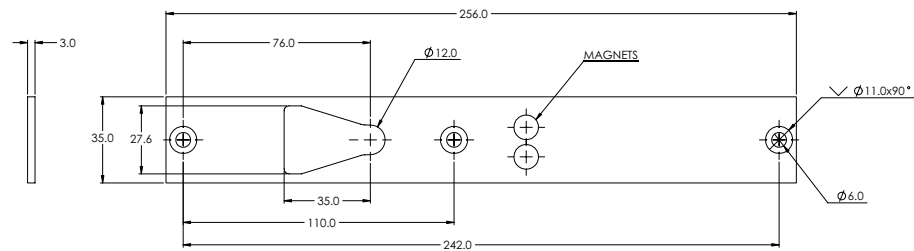

Accessory Strike Plate **VE1260S-ST12**

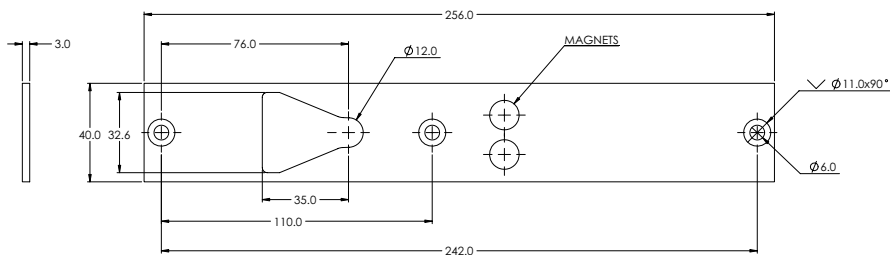

## ORDER DETAILS

PART NO.	PRODUCT DESCRIPTION
----------	---------------------

## ECOLOCK VE1260 SERIES

VE1260R	EcoLock Pre-Load Drop Bolt 25mm Face Plate including 27mm Strike Plate ROUND EDGE to cater for +4mm door misalignment
VE1260S	EcoLock Pre-Load Drop Bolt 30mm Face Plate including 27mm Strike Plate SQUARE EDGE to cater for +4mm door misalignment (PADDE ES8000 Replacement)

## ACCESSORIES VE1260 SERIES

VE1260R-GL	Glass Door Box for VE1260R Lock or VE1260R-ST4 Strike Plate ROUND EDGE
VE1260LED-BOX	LED Monitor Box for Lock-Status Monitoring Indication (Red/Green)
VE1260R-SCEC	Security Bracket for VE1260R
VE1260S-ST6	Strike Plate 31mm for VE1260 Series to cater for +6mm door misalignment minimum Door Thickness 35mm SQUARE EDGE
VE1260S-ST9	Strike Plate 35mm for VE1260 Series to cater for +9mm door misalignment minimum Door Thickness 40mm SQUARE EDGE
VE1260S-ST12	Strike Plate 40mm for VE1260 Series to cater for +12mm door misalignment minimum Door Thickness 50mm SQUARE EDGE

## CURRENT VS. PRELOAD GRAPH

