



Secure I/O 2

Compact Secure Single Door I/O Module

The Suprema Secure I/O 2 provides secure door control via encrypted communication when combined with other Suprema devices. Its ultra-compact form factor allows for use in a variety of installation environments.

The Secure I/O 2 is an easy to install, cost-effective solution for enhanced security via encrypted communication.

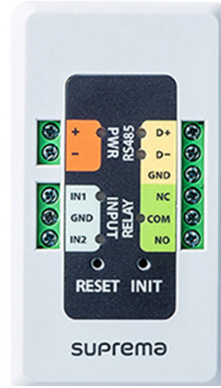

Specifications:

Part #: SI02

- RS-485 communication
- 2x TTL inputs
- 1x Form C relay
- 12V DC (100mA)
- -20°C to 60°C operating temp.
- 36(W) x 65(H) x 18(D)mm

Configuration:

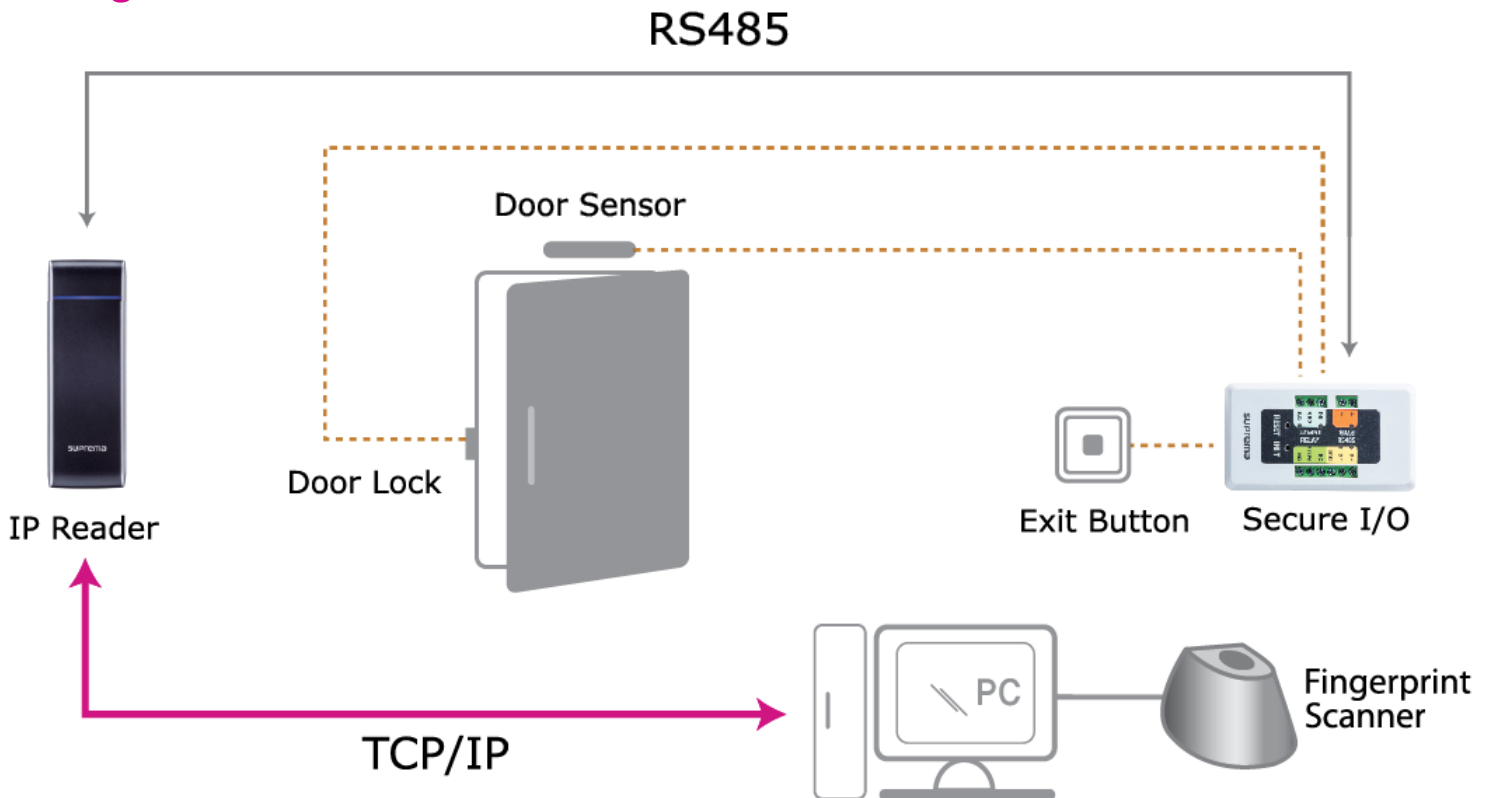

Compatible Devices:

