

KONEC T01 PRO ZIGBEE SMART LOCK

USER MANUAL

KLL-T01P-BL-Z-KC [6068]

SKU: KSL00229

Update version: 01/03/2026

CONTENTS

1. Notice	
Disclaimers.....	01
Important Safety Instructions.....	01
2. Product Overview	
Product Description.....	02
Features.....	02
Certification.....	02
Specifications.....	03
Exploded View.....	04
Dimensions.....	05
3. Set Up	
What's Included.....	06
Pre-Installation.....	07
Reversible Latch.....	08
Installation.....	09
4. Configuration Guide	
Download the App.....	12
Add product to Arks.....	12
Device Control Page.....	14
Remove from Arks.....	21
5. Scene	22
6. Contact Us	24

1. NOTICE

DISCLAIMERS

- This User Manual is designed to help you get the most out of your Konec T01 Pro ZigBee Smart Lock. Please read it carefully before use. For your safety and the best experience, we recommend that installation and maintenance be carried out by a qualified professional.
- The information provided in this manual is for general guidance and reference purposes only. Konec Solutions Pty Ltd makes no representations or warranties, express or implied, regarding the completeness, accuracy, or suitability of the content. Product specifications, features, and visuals are subject to change without notice.
- This product must be installed, repaired, and maintained in accordance with AS/NZS 3000 and applicable local laws. Improper installation, use, or unauthorised modification may void the warranty and pose safety risks.
- To the extent permitted by law, Konec Solutions disclaims any liability for direct, indirect, incidental, or consequential damages arising from the use of this manual or the product itself.
- This disclaimer does not affect your rights under the Australian Consumer Law or the New Zealand Consumer Guarantees Act 1993.
- All content in this document—including text, images, and graphics—is the property of Konec Solutions. No part may be reproduced, translated, or modified without prior written permission.
- For the latest version of this manual, please visit www.konechome.com.au.

IMPORTANT SAFETY INSTRUCTIONS

To ensure a safe and compliant installation, please follow these precautions:

- This product is designed for professional installation.
- Disconnect power before starting installation or maintenance.
- Installation must comply with AS/NZS 3000 and all relevant local electrical and building regulations.
- Do not exceed the product's rated electrical capacity.
- Avoid using power tools unless explicitly specified.
- Do not install in areas exposed to water or high humidity unless rated for such conditions.
- Use appropriate personal protective equipment (e.g., gloves, safety glasses).

For product usage and maintenance safety, please refer to the User Manual.

2. PRODUCT OVERVIEW

PRODUCT DESCRIPTION

The Konec T01 Pro Zigbee Smart Lock redefines home security with its advanced technology and elegant design. Supporting Zigbee connectivity, it seamlessly integrates with your smart home system, offering multiple unlocking methods including fingerprint recognition, password, access fob, and smartphone app.



*** This smart lock must be paired to a compatible Konec Zigbee hub.** Without configuring with the hub, the device will stay in **Demo mode** and will not be securely locked when powered. Additionally, it can function as a traditional lock (using only a physical key) with the lithium battery removed.

FEATURES



APP CONTROL

Unlock the door remotely for someone, even if you are not at home.



MULTIPLE UNLOCKING

Many ways to unlock: Fingerprint, Passcode, Access fob, Key and App control.



TEMPORARY PASSWORD

Generate a temporary password on the Arks App for visitors to unlock the door, expiring after a set time for convenience and security.



RECHARGEABLE BATTERY

Long-lasting, rechargeable 5000 mAh lithium battery that can last up to 6 to 10 months.



EMERGENCY POWER SUPPLY

In-built Type-C port included for emergency low battery situations.



SCENE CONTROL

Unlocking the door activates lights, curtains, security, and more via the Konec smart home system.

CERTIFICATION



This product is RCM certified, ensuring compliance with Australian safety and regulatory standards.



2. PRODUCT OVERVIEW

SPECIFICATIONS

Materials	6 Series Aviation Grade Aluminium Alloy	Low Battery Alarm	Alert last up to 100 door openings
Colour	Black	Data Capacity	≤ 300 (total), Fingerprint ≤ 100, Password ≤ 100, Access Fob ≤ 100
Door Thickness to Fit	35 - 65mm	Battery	5000mAh Lithium Rechargeable Battery, 7.4V
Compatible Door Type	Aluminium Door Wooden Door	Fingerprint Recognition Speed	≤ 0.5s
Mortise Type	6068	Alarm Type	Incorrect Entry Alarm Low Battery Alarm
IP Rating	Front Panel: IP55 Rear Panel: IP52	False Accept Rate (FAR)	< 0.001%
Connection Type	Zigbee	False Reject Rate (FRR)	< 1.5%
Battery Life	Approx. 6 Months *Battery Life duration will vary depending on usage	Unlocking Methods*	Mechanical Key Fingerprint Password Access Fob App Control
Weight	5.6kg	Operating Temperature	-25°C ~ 70°C
Dimensions	Front: 413 x 79 x 56.3mm Back: 413 x 79 x 73mm	Operating Humidity	0% ~ 93% ± 3%RH (Non-Condensing)



Unlocking methods (such as fingerprint, password, and access fob) need a compatible Konec gateway for initial setup and any additional features. Additionally, for app control, continuous use of the gateway is required.

2. PRODUCT OVERVIEW

EXPLODED VIEW

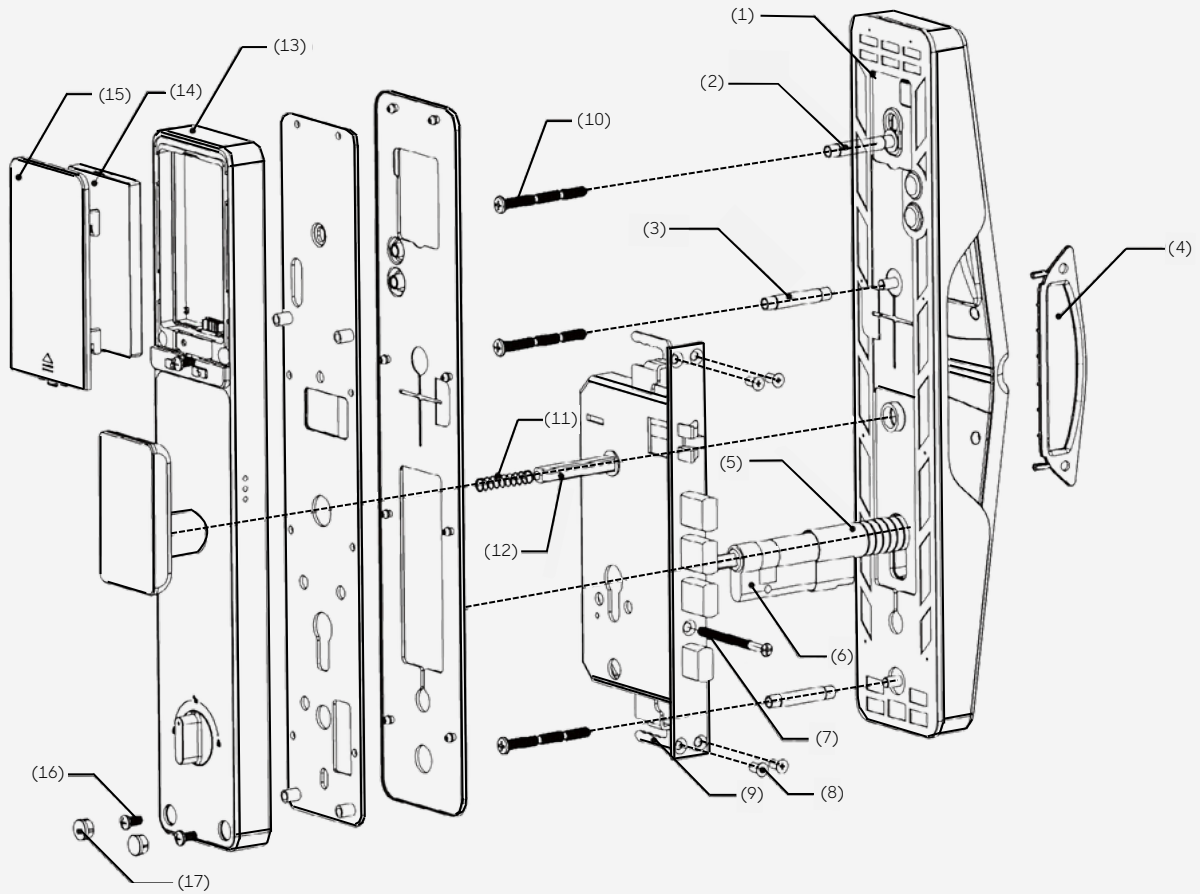

1.Door outer lock assembly(1 set)

2.Carriage screw assembly(1 pcs)

3. Connecting studs (2 pcs)

4. Anti-pinch hand stop(2 pcs)

5. Lock cylinder positioning sleeve(1)

6. Lock cylinder (1)

7.Lock cylinder fixing screw (1 pcs)

8. Lock body fixing screws (4 pcs)

9.Lock body(1)

10.Connecting screw(2)

11. Square spindle spring (1 pcs)

12.Square spindle(1)

13.Door lock assembly(1 set)

14. Lithium battery(1)

15.Battery cover(1)

16. Door inner lock fixing screws (4 pcs)

17.Silicone stopper (2 pcs)

2. PRODUCT OVERVIEW

DIMENSIONS

FRONT PANEL DIMENSIONS

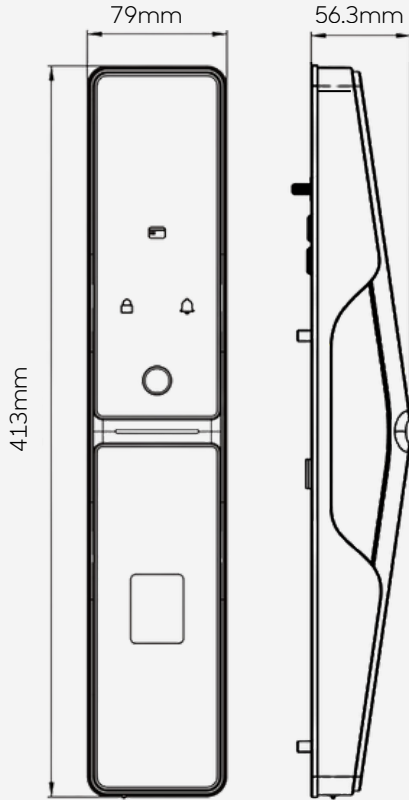

BACK PANEL DIMENSIONS

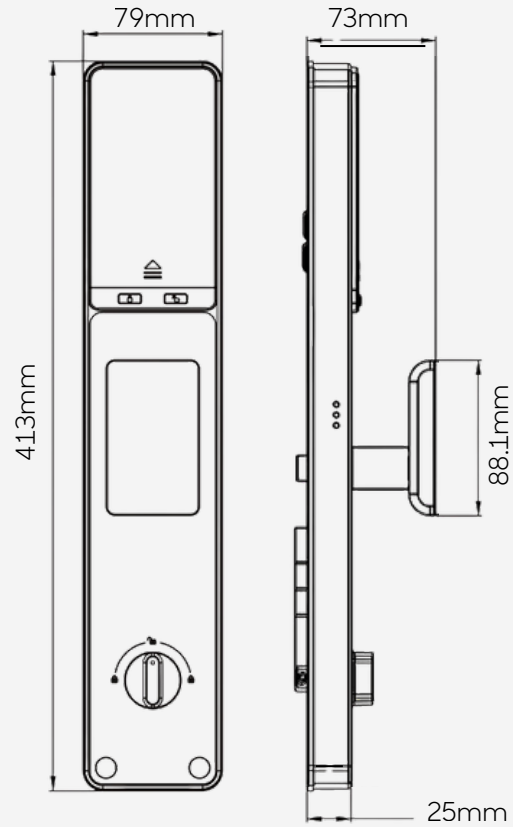

LOCK BODY DIMENSIONS

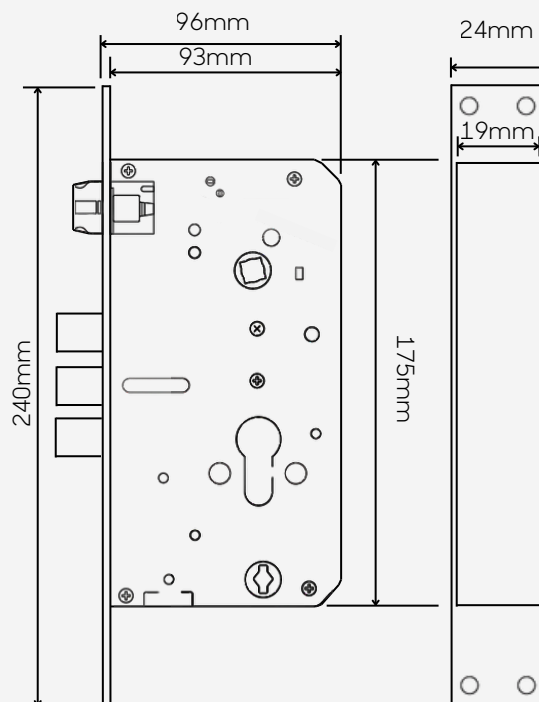

Disclaimer: Lock body hole depth refer to the drilling template

3. SETUP

WHAT'S INCLUDED

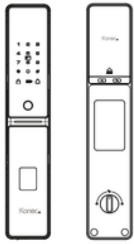

FRONT & BACK PANEL * 1

(Rubber plates included)

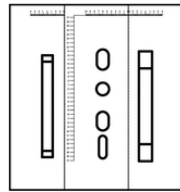

DRILLING TEMPLATE * 1

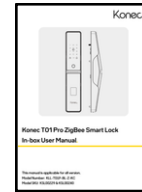

IN-BOX USER MANUAL * 1

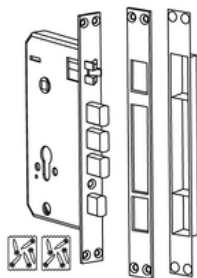

LOCK BODY KIT * 1

M4 x 25mm Screw * 10 Included

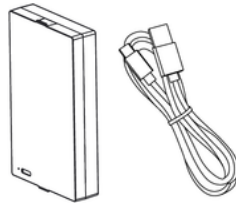

5000MAH BATTERY & TYPE-C CABLE * 1

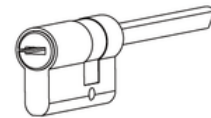

LOCK CYLINDER * 1

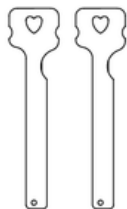

MECHANICAL KEY * 2



ACCESS FOB * 3

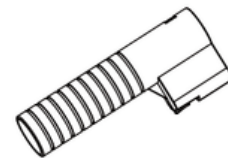

LOCK CYLINDER POSITIONING SLEEVE * 1



ACCESSORIES BAG

M6 x 30mm Threaded Sleeve * 3

M5 x 70mm Screw * 1

M6 x 45mm Screw * 3

M6 x 25mm Screw * 3

M5 x 10mm Screw * 4

M5 x 11mm Sliding Screw * 1

65mm Square Spindle * 1

90mm Square Spindle * 1

M6 Flat Washer * 1

Screw Cover * 2

Spring * 1

3. SETUP

PRE-INSTALLATION

Prepare for the door

Refer to the drilling template (included in the box) and drill the door accordingly. Ensure the lock body and latch are properly aligned.

Adjust door opening direction

Change the door lock opening direction according to the door swing (left-hand or right-hand).

Refer to Pg.8 to reverse to latch bolt direction.

Left Swing Set Up (Default)

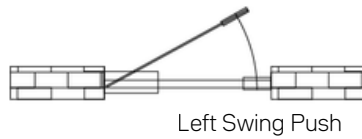
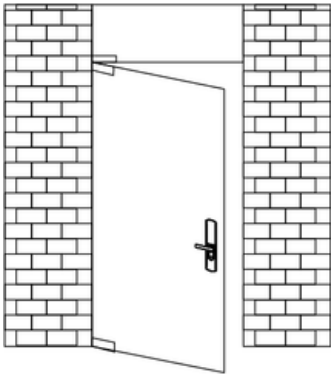

Left Swing Push

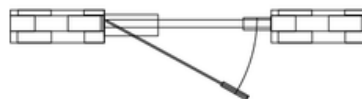

Left Swing Pull

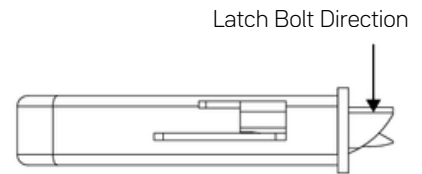

Latch Bolt Direction

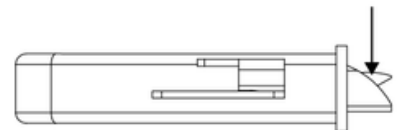

Unlock buttons set up:

Reset the device and enter [888#2]

Right Swing Set Up

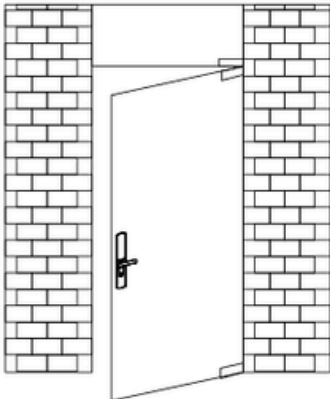

Right Swing Push

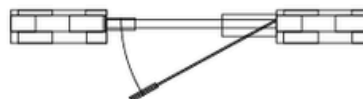

Right Swing Pull



Latch Bolt Direction

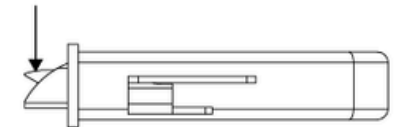

Latch Bolt Direction

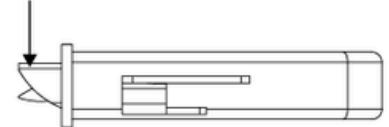

Unlock buttons set up:

Reset the device and enter [888#1]

If the lock and unlock buttons are reversed, follow the steps below to correct the issue:

1. Reset the device.
2. Wake up the screen and enter [888#].
3. Tap [1] for **Right Swing Set Up**, tap [2] for **Left Swing Set Up**.



Note: Once you have paired with the app, you won't be able to change the unlocking direction.

To revert to the default mode (Left swing), you'll need to reset your smart lock. Please refer to Pg.11 for the reset instructions.

To reverse the motor turning direction to match the unlocking button, you would need to power on and reset the smart lock.

3. SETUP

REVERSIBLE LATCH

To change the opening direction (Push/Pull) the lock body latch needs to be adjusted before installation. The specific method is as follows:

1. Use a screw driver push the **reverse pin** up and hold. Please hold until you have completed step 3.
2. Push the **latch bolt** into the lock body.
3. Rotate the **latch bolt** 180 degrees and then release it to eject it from the lock body.
4. Release the **reverse pin** down to lock the latch into position.

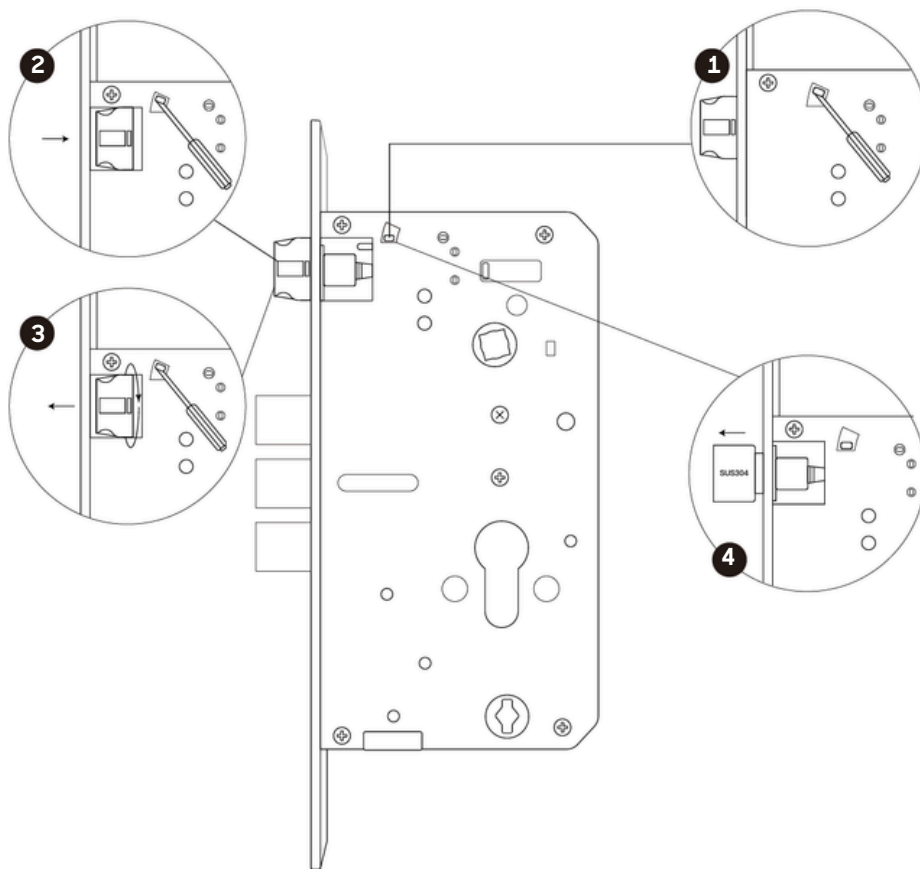

3. SET UP

INSTALLATION



The lock cylinder paddle, back panel paddle, and lock cylinder sleeve must be measured and cut according to the door thickness.

DO NOT cut them too short, as overcutting may impair the lock's functionality. Cut gradually and adjust as needed for the best fit.

How to Measure and Cut the Paddle and Sleeve

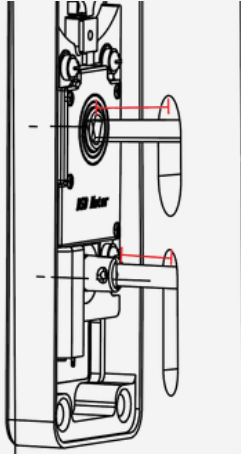

Fig.A Back Panel paddle placement

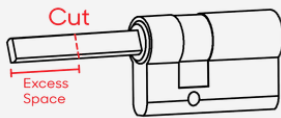

Fig.B Lock Cylinder Paddle

1. Insert the lock cylinder and connect the paddle to the back panel.
2. Insert the back panel paddle into the door.
3. Measure the spacing between the paddles and the surface of the door (Fig.A).
4. Based on the measurement, remove and cut the paddles. Measure the cutting space starting from the tip of the paddle (Fig.B & Fig.C).
5. Insert the paddles again and check the spacing. Repeat steps if there is still excess space.

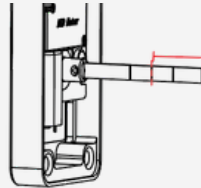

Fig.C Back Panel Paddle

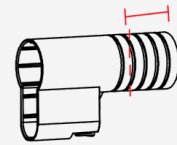
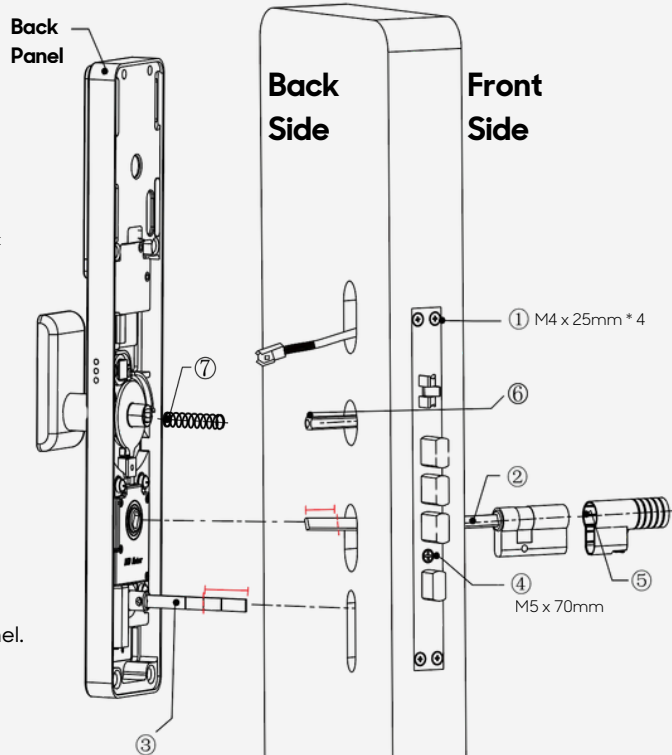

Fig.D Lock Cylinder Sleeve

Step 1:

1. Screw the lock body onto the door.
 2. Insert the lock cylinder from the front side of the door, ensure the paddle can rotate. Measure and cut the paddle.
- Note:** For further instructions on this, refer to "How to Measure and Cut the Paddle and Sleeve" section above.
3. Measure and cut the paddle on the back panel.
 4. Screw the lock core screw.
 5. Attach the lock cylinder sleeve and measure the spacing with the front panel. Cut the sleeve similar to the lock cylinder paddle (refer to above).
 6. Insert the square spindle.
Shaft: 65mm or 90mm
Depending on door thickness
 7. Insert the square spindle spring onto the back panel.



3. SET UP

Step 2:

1. Insert the threaded sleeves (2 pcs).
2. Fix the silicone pad and front panel onto the door.

Note: The marked end should **face away** from the front panel.

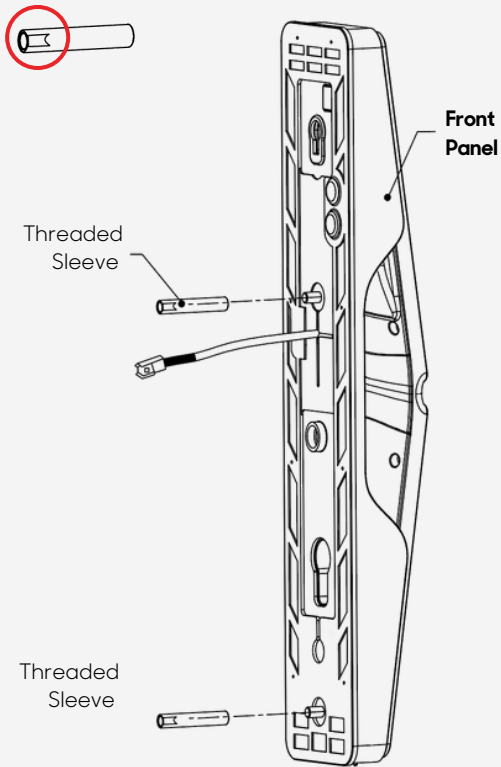

Step 3:

1. Fix the silicone pad and back panel board onto the door.
2. Screw the two connecting screws to the threaded sleeves. Use either the 65mm or 90mm spindle depending on the thickness of your door.

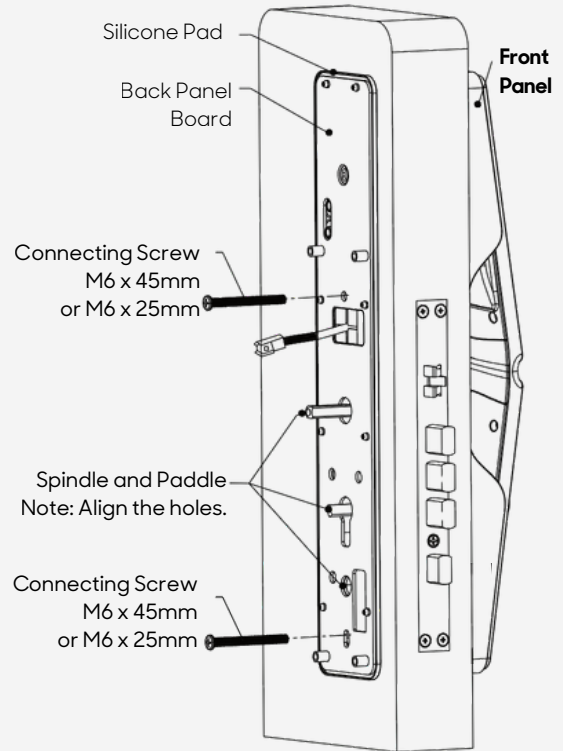

Step 4:

1. Connect the wire from the front panel to the back panel.

⚠ Note: Align the back panel hole with the spindle and paddles.

2. Install the back panel onto the door.

⚠ Note: Make sure the deadbolt lock knob is facing up.

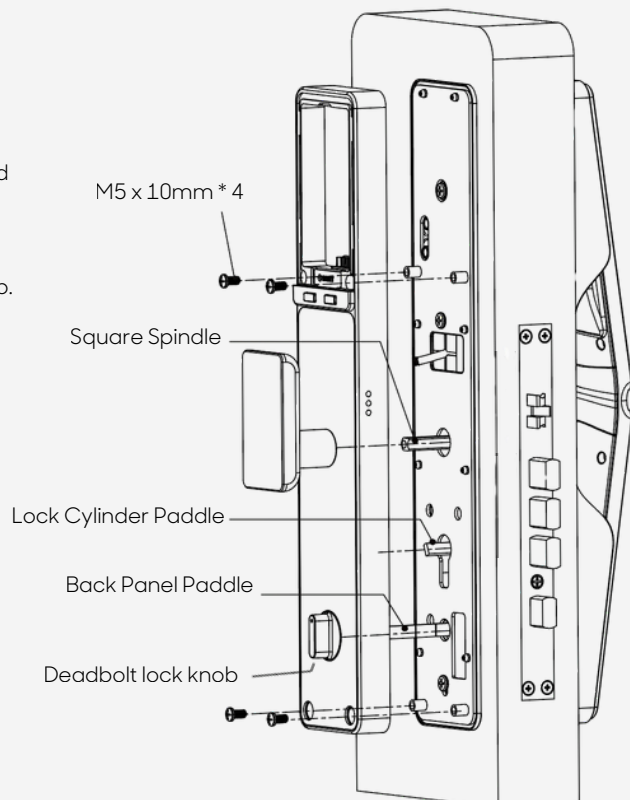

3. SET UP

Step 5:

1. Insert the battery and battery cover. (Fully charge the battery before installing).
2. Cover the bottom screws with the screw covers * 2.
3. Screw the strike box and strike panel with M4 x 25mm * 4.

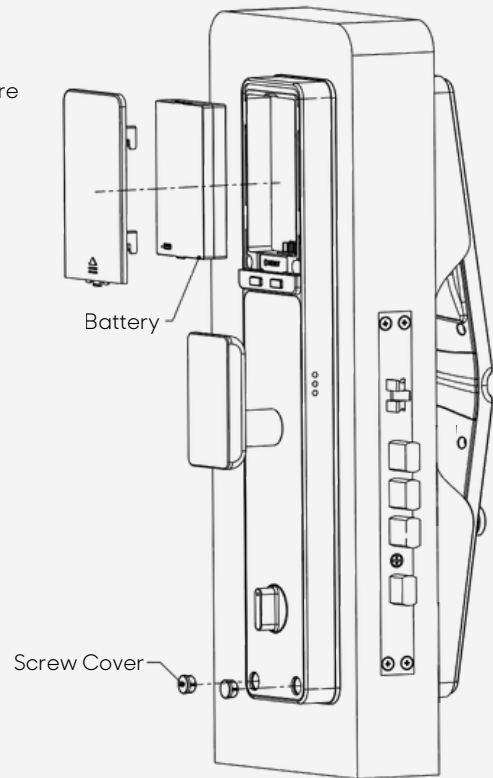
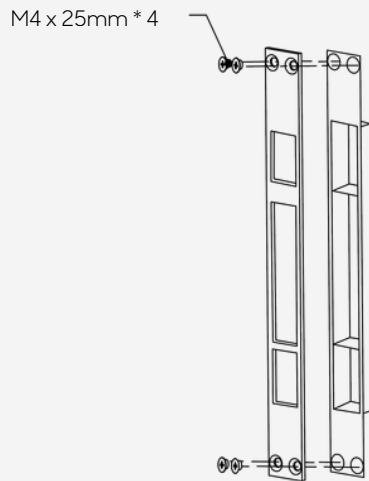

RESET DEVICE

1. Remove the battery cover.
2. Press and hold [**Reset**] for 6s.

 "To restore back to factory settings, please press again".

3. Press [**Reset**].

 "Operation Successful".

4. CONFIGURATION



Disclaimer: All images and text provided below are intended for reference purposes only. Please note that this content is subject to updates, and both the text and images may change over time.

4.1 DOWNLOAD THE APP



iOS



Android

Scan the QR Code to download Arks by Konec Solutions App.

4.2 ADD PRODUCT TO ARKS

- 1.1 After powering on, press and hold the [**Reset**] for 1s until the voice prompt and the dial pad lights appear.

Voice Prompt: "Network configuration, Press 1..."

- 1.2 Tap [**1**] on the dial pad to enter pairing mode.

Voice Prompt: "Enter Network Configuration".

✘ If the lock is unable to enter pairing mode, please reset the device.

Press and hold [**Reset**] until you hear > Voice prompt "To restore back to factory settings, please press again" > Press [**Reset**] > Voice prompt "Operation Successful".



- 2 On the app, tap on the home list and select the home you wish to pair with the lock.

✘ If you want to add it in a new home, please reference to the "Konec Arks APP User Guide" to create a new home.

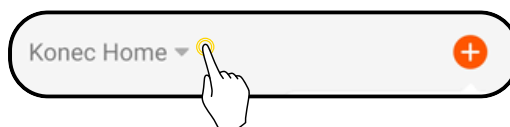

✘ Ensure that a gateway is installed properly and added to the Arks App.

Please refer to the User Manual for the corresponding gateway installation and pairing.

4. CONFIGURATION

- 3 Tap on the "+" icon and then tap **[Add Device]**.

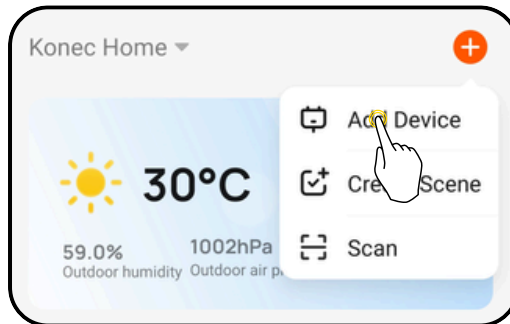

- 4 Under the **[Locks/Cameras]** section, tap **[T01 Pro Zigbee Smart Lock]**. Choose the gateway you wish to pair with the lock.

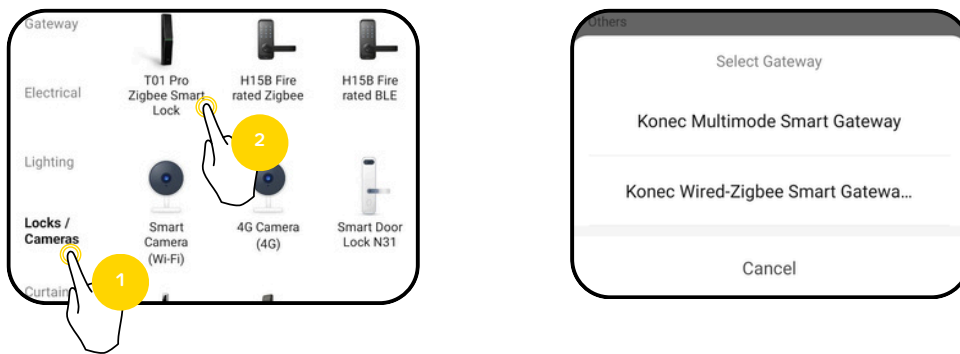

- 5 Tap the reset status confirmation and tap **[Next]**. The app will scan for the device.

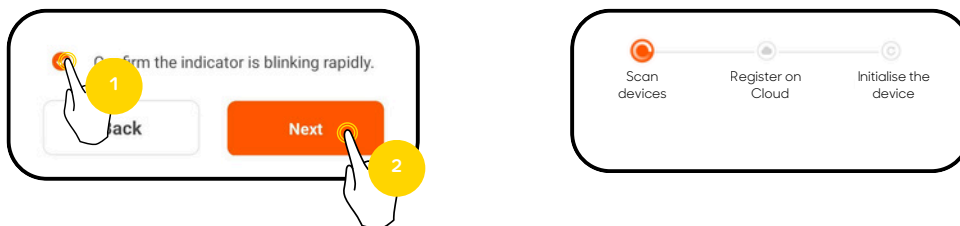

- 6 Device will be automatically detected and appear once the Pairing Operation is successful. Tap **[Done]** to complete.
The lock should appear on the Dashboard.



* **Note:** After configuring the smart lock, please wait 3 minutes before adding the unlocking methods.

4. CONFIGURATION

4.3 DEVICE CONTROL PAGE

Directly access and control the settings and functionalities of the Konec T01 Pro ZigBee Smart Lock. Special features include adjusting settings, viewing status, or performing setup configurations.

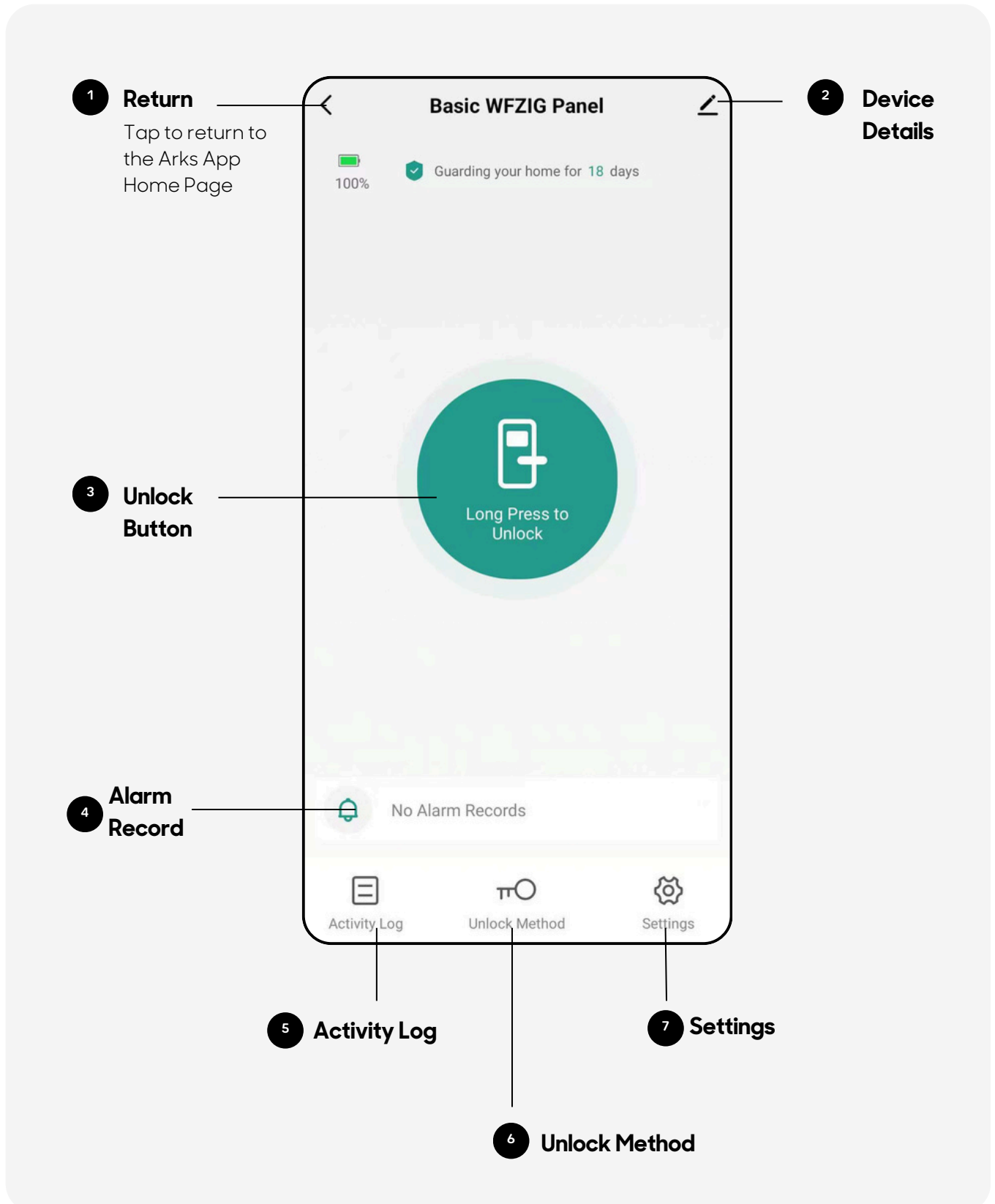

4. CONFIGURATION

1 RETURN

Tap the Return icon "◀" to go back to the Home Screen.

2 DEVICE DETAILS

Access the Device information and other information.

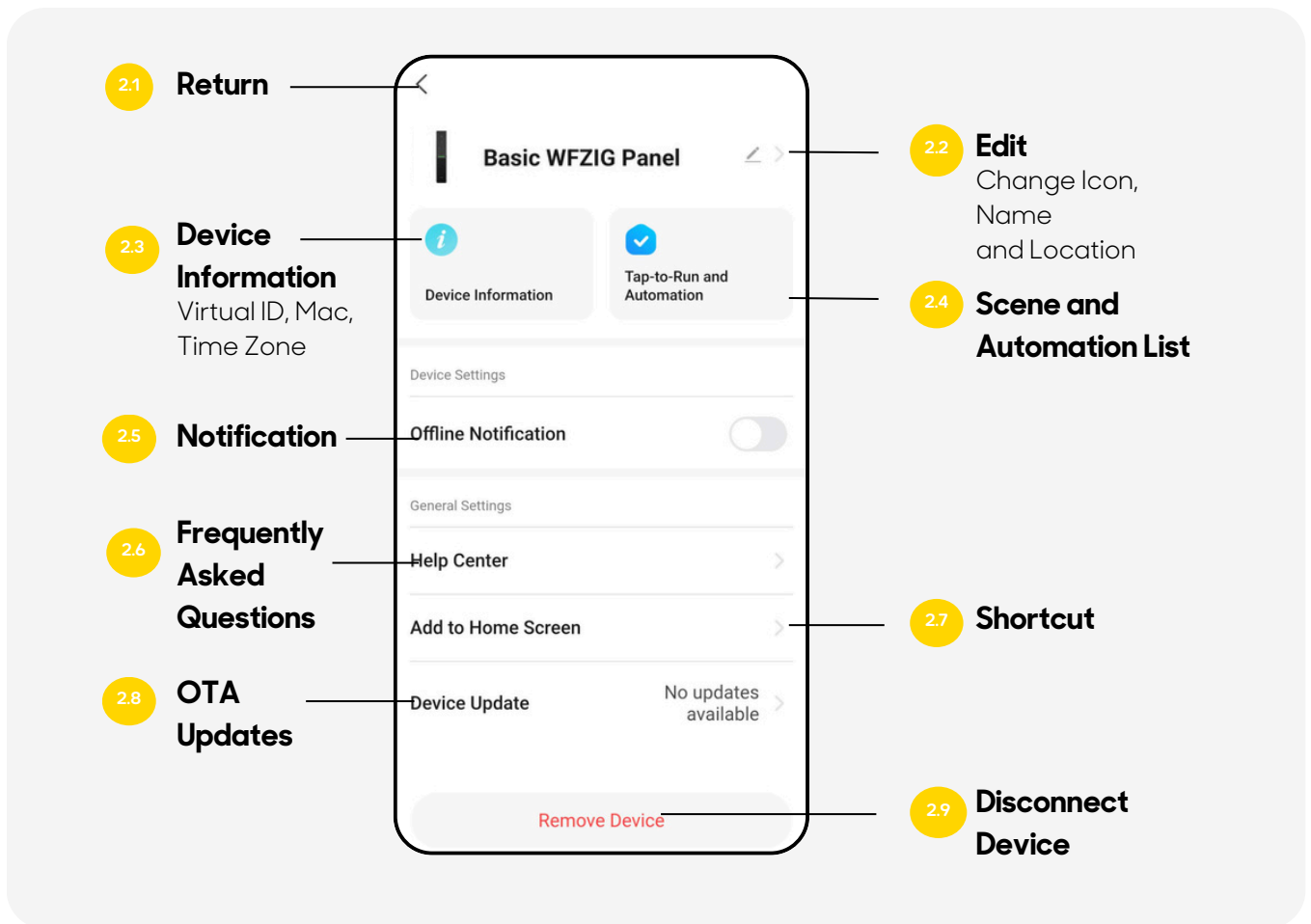

2.1 Return

Tap the Return icon "◀" to go back to the Device Interface.

2.2 Edit

Tap the Signature icon "✎" to change Icon, Name and Location of the device.

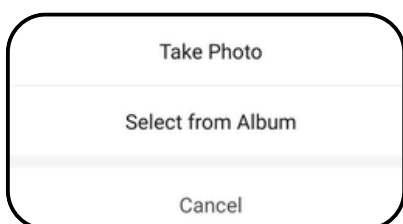

Icon

Update the display icon.

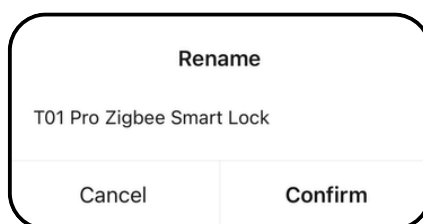

Name

Change the display name.

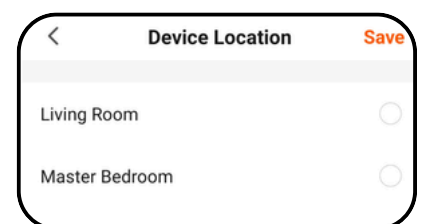

Location

Select where the device is located.

4. CONFIGURATION

2.3

Device Information

Obtain the information about Virtual ID, Mac, and Time Zone.

2.4

Scene and Automation List

View the list of Scenes and Automations that this device is included in.

You can tap [**Tap-to-Run and Automation**] to view the list of Scenes and Automation.

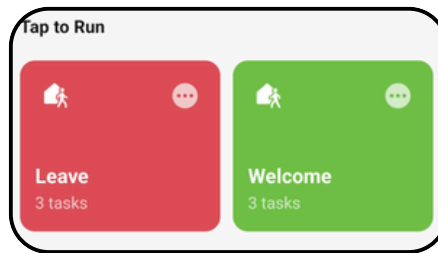

2.5

Notifications

Receive phone notifications when this device's status changes to offline.

To turn on this function, under "**Device Offline Notification**" toggle [**Offline Notification**] ON.

2.6

FAQ Access a list of questions that are related to this product.

Tap [**More**] to access the general FAQ.

2.7

Shortcut

Add a shortcut onto your phone home screen for easier access.

1. Tap [**Add to Home Screen**].
2. Tap [**Go**].
3. Tap [**Add**].

2.8

OTA Updates

Check for the latest firmware updates.

Toggle ON [**Auto Upgrade**], if you wish to automatically update the device when a new update is detected.

2.9

Disconnect Device

Remove and disconnect the device from your app.

Disconnect: You will remove the device and all related automation settings will be deleted. Tap [**Disconnect**] > [**Confirm**].

Disconnect & Wipe Data: You will remove the device and all related data will be deleted. Tap [**Disconnect and wipe data**] > [**Confirm**].

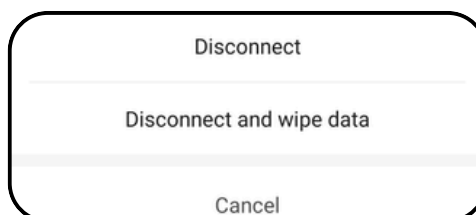

4. CONFIGURATION

3 UNLOCK BUTTON

Long press and hold the switch icon to lock/unlock the lock.

4 ALARM RECORD

Tap the Alarm icon "🔔" to check the alarm history.

5 ACTIVITY LOG

Tap the [Activity Log] to check the open history.

6 UNLOCK METHOD

Tap the [Unlock Method] to set the unlock method.

 **Note:** After configuring the smart lock, please wait 3 minutes before adding the unlocking methods.

• Add Member

1. Tap the [+] to select unlock method.
2. Tap [family unlock] to add members.

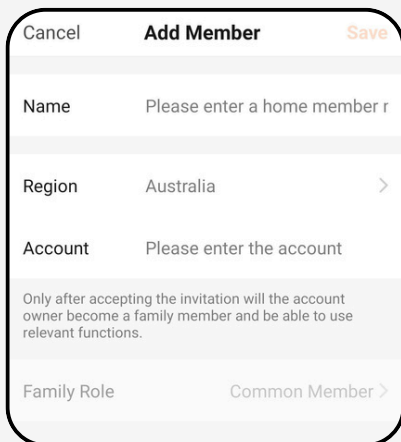
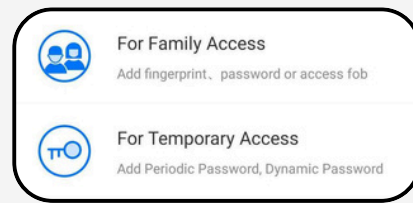
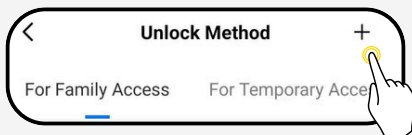

3. On the Add Member Page, input:
 - Name: The new member's nickname
 - Region: Select **Australia**
 - Account: Either the **Email Address** or **Mobile Number** listed on the New member's Account and Security section
 - Family Role: Select the Access type (Administrator or Common Member)
4. Tap [Save].

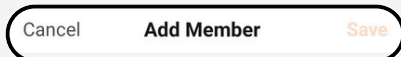

• For Family Access

1. Click the member's name to add the unlock method for the member.
2. Tap the add icon "⊕" to choose unlock method need to be added.
3. Follow the add instruction to finish the setting.

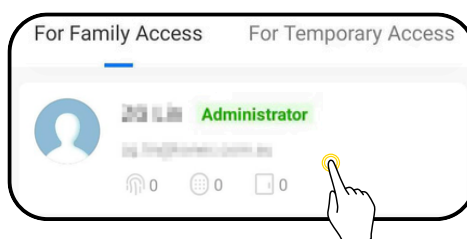

4. CONFIGURATION

• Fingerprint

1. Tap "+" > [**Start**].
2. Follow the voice prompt put the finger on the scan area for several times to finish the fingerprint record.
3. Tap [**Done**].

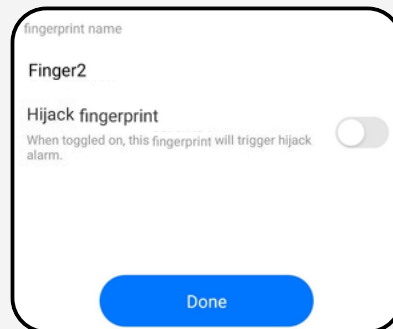
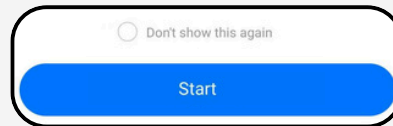
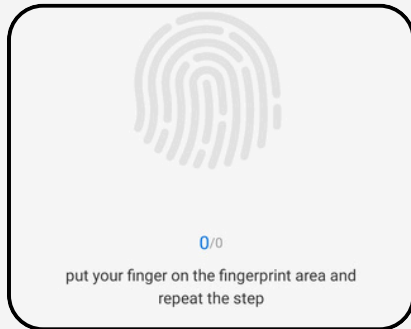
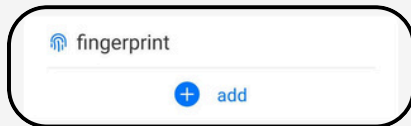

• Password

1. Tap "+" > [**Start**].
2. Input your own password > [#], after hearing the voice prompt "Please enter your password again" input your own password > [#] again to confirm.

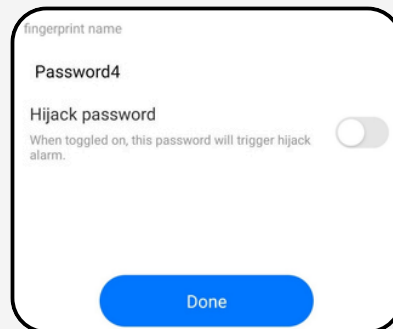
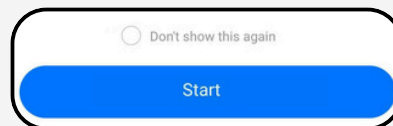
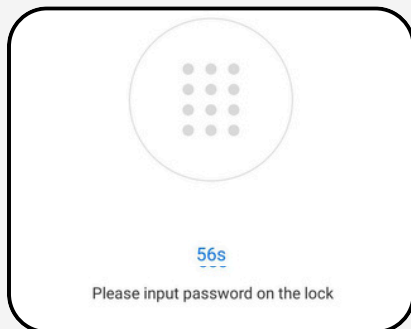
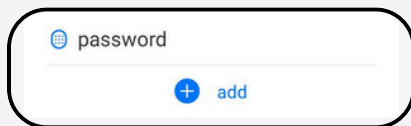

• Card

1. Tap "+" > [**Start**].
2. Place the swipe card on the scan area to add the card.

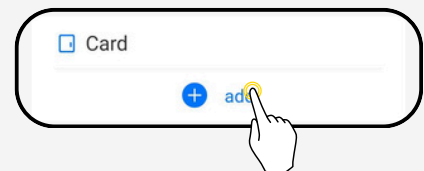

• Hijack

Toggle ON the unlock method hijack to receive alerts when specific unlocking methods are used.

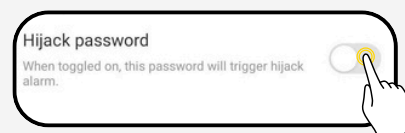

4. CONFIGURATION

• For Temporary Access

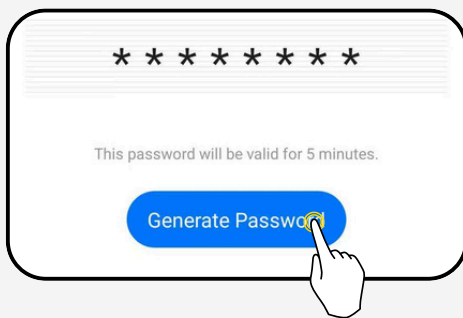
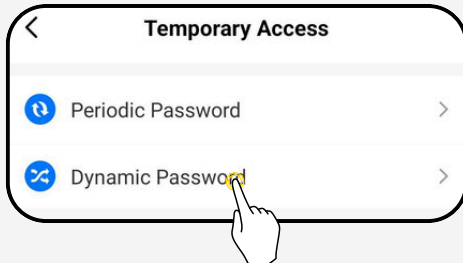
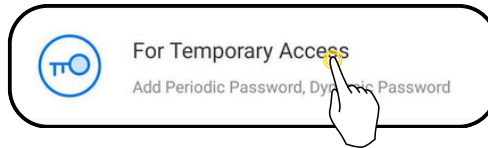

Dynamic Password

1. Tap the [+] to choose unlock method.
2. Select [**Temporary Access**].
3. Select [**Dynamic Password**] and tap [**Generate Password**] to generate a one-time password, which will be expired after using.

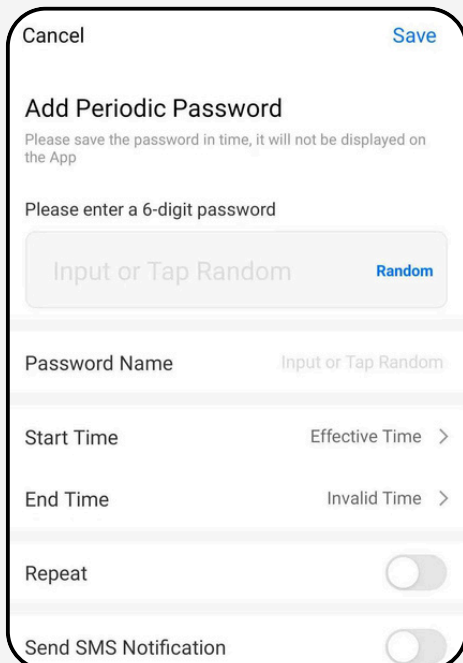
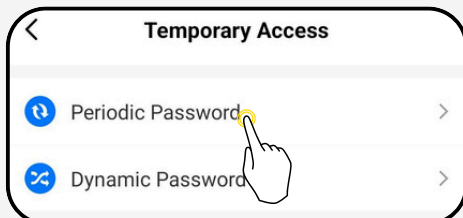

Periodic Password

1. Tap the [+] to select unlock method.
2. Tap [**Temporary Access**].
3. Tap [**Periodic Password**] to generate a temporary password.
4. Tap [**Random**] to generate a 6-digit password.
5. Set the time duration, repeat and notification.
6. Tap [**save**].

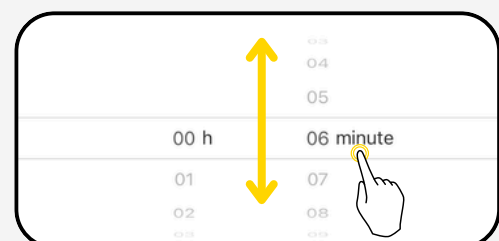

4. CONFIGURATION

8 SETTINGS

Set up the devices with "⚙️".

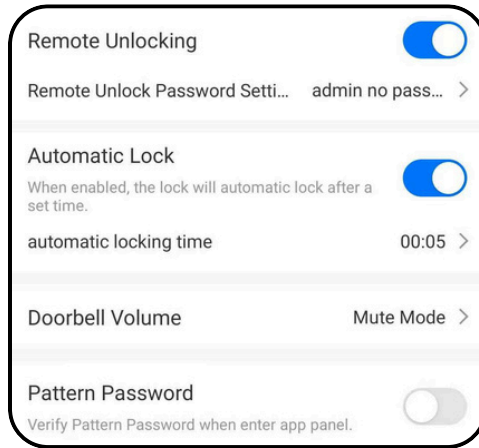

- **Remote Operation**

Toggle on "Remote Unlocking" to set member permissions for remote control.

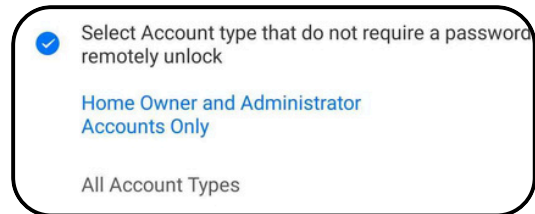

- **Automatic Lock**

Toggle on "Automatic Lock" and scroll to set the automatic locking time.

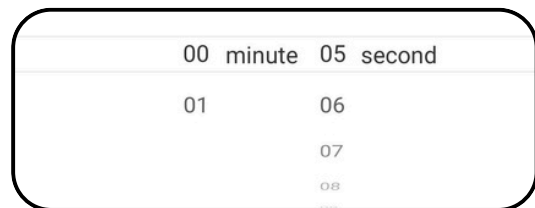

- **Doorbell Volume**

Set the doorbell buzzer mode.

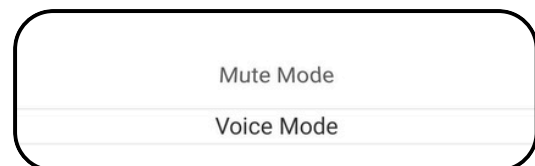

- **Pattern Password**

You can toggle on "Pattern Password" to set or change the pattern password, used to access the device interface.

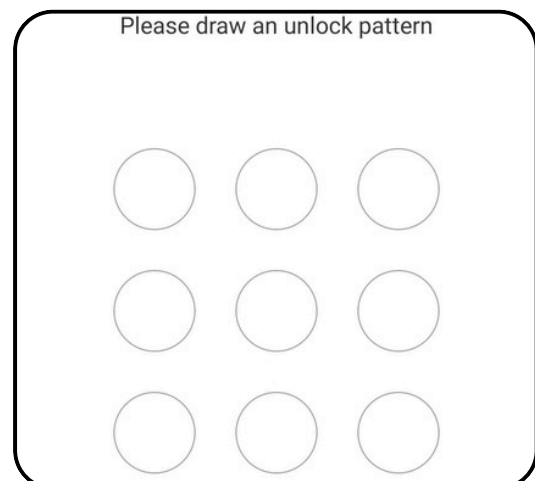

4. CONFIGURATION

4.4 REMOVE FROM ARKS

Remove and disconnect the device from your app.

1. On the Home screen, select the switch and tap on the **Device Details** icon "⌵".

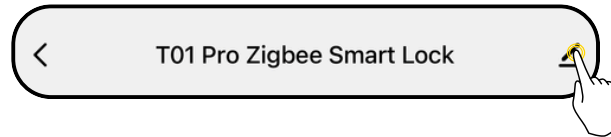

2. Tap on [**Remove Device**].
3. Select which method you wish to remove the device:

- **Disconnect:** You will remove the device and all related automation settings will be deleted. Tap [**Disconnect**] > [**Confirm**].
- **Disconnect & Wipe Data:** You will remove the device and all related data will be deleted. Tap [**Disconnect and wipe data**] > [**Confirm**].

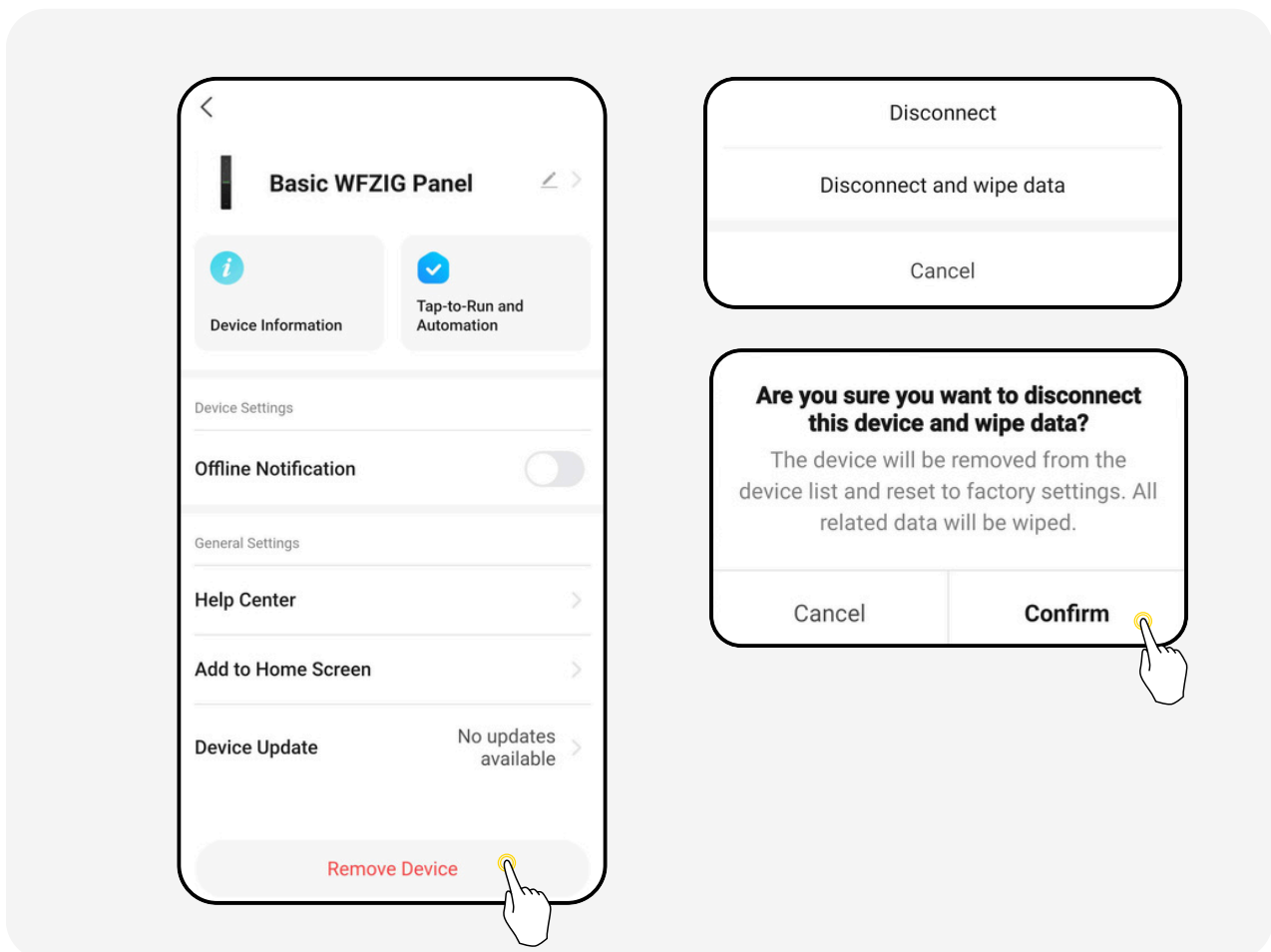

Disclaimer: Hard resetting the device will also remove the device from the Arks app.

5. SCENE

SCENE SETTING

1. On the Home Page, tap the [**Scene**] tab or [**+**] icon to access your **Automation** and **Tap-to-Run** List.
2. Tap [**Create Scene**].

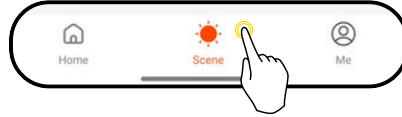

- **Condition:** If this device is used as a condition.
Tap [**When device status changes**], then tap this device in the list.

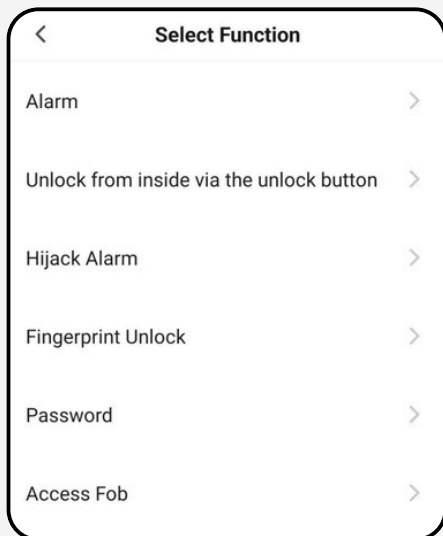
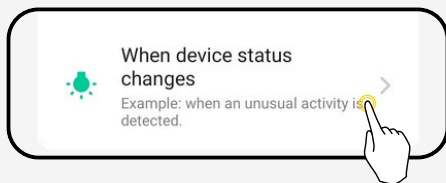

- [**Alarm**]: Wrong unlock method & Low battery alarm.
- [**Unlock from inside via the unlock button**]: Set unlock from inside via the unlock button as the condition.
- [**Hijack Alarm**]: Triggering the Hijack unlock method will be set as the condition.
- [**Fingerprint Unlock**]: The ID associated with the unlocking fingerprint matches the specified ID as the condition.
- [**Password**]: The ID associated with the entered passcode matches the specified ID as the condition.
- [**Access Fob**]: The ID associated with the unlocking Access Fob matches the specified ID as the condition.

5. SCENE

- [Add Task]:



Select which device you want to activate when the scene is triggered.

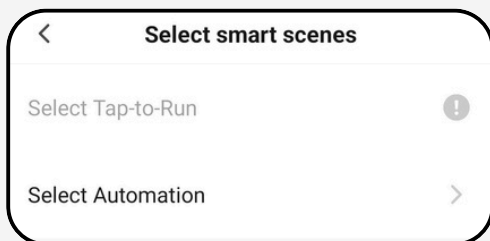
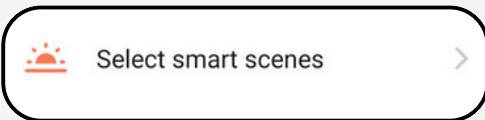

Link to another Smart scene to be activated when this scene is triggered.

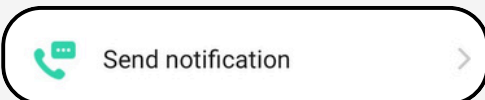

Receive phone notifications when this device's status changes.

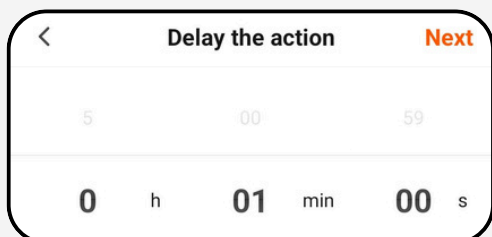
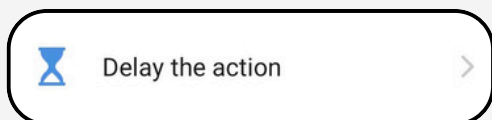
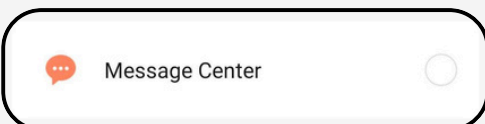

Set a delayed response where the selected devices will trigger after the set time.

6. CONTACT US

Search for "Arks" in the App Store or Google Play, or scan the QR code below to download and install the App. Click "Register" to register a new account if this is your first time to use; if you already have an account, click "Login"

Scan the QR Code to download Arks by Konec Solutions App.



IOS



Android

Konec Solutions Pty Ltd

Please do not hesitate to contact us if you have any questions.



Konec Official Web

<http://www.konec.com.au>



Hotline

1300 2 56632 (1300 2 KONEC)



Sales & Partnership

sales@konec.com.au



Customer Support

support@konec.com.au



Address

L3 5 Talavera Road Macquarie Park NSW 2113
