

KONEC SMART LOCK H15B BT BLACK(FIRE RATING)

USER MANUAL

KLI-H15B-YB-AP(NDIS)

SKU: KSL00222

Update version: 01/03/2026

CONTENTS

1. Notice	
Disclaimers.....	01
Important Safety Instructions.....	01
2. Product Overview	
Product Description.....	02
Features.....	02
Certification.....	02
Specifications.....	03
Dimensions.....	03
3. Set Up	
Function Diagram.....	04
What's Included.....	04
Pre-Installation.....	05
Installation.....	06
Local Mode.....	08
4. Configuration Guide	
Download the App.....	10
Add product to Arks.....	10
Device Control Page.....	12
Remove from Arks.....	20
5. Firmware Update	21
6. Scene	22
7. Contact Us	24

1. NOTICE

DISCLAIMERS

- This User Manual is designed to help you get the most out of your Konec Smart Lock H15B BT Black(Fire Rating) . Please read it carefully before use. For your safety and the best experience, we recommend that installation and maintenance be carried out by a qualified professional.
- The information provided in this manual is for general guidance and reference purposes only. Konec Solutions Pty Ltd makes no representations or warranties, express or implied, regarding the completeness, accuracy, or suitability of the content. Product specifications, features, and visuals are subject to change without notice .
- This product must be installed, repaired, and maintained in accordance with AS/NZS 3000 and applicable local laws . Improper installation, use, or unauthorised modification may void the warranty and pose safety risks.
- To the extent permitted by law, Konec Solutions disclaims any liability for direct, indirect, incidental, or consequential damages arising from the use of this manual or the product itself.
- This disclaimer does not affect your rights under the Australian Consumer Law or the New Zealand Consumer Guarantees Act 1993 .
- All content in this document—including text, images, and graphics—is the property of Konec Solutions. No part may be reproduced, translated, or modified without prior written permission.
- For the latest version of this manual, please visit www.konechome.com.au.

IMPORTANT SAFETY INSTRUCTIONS

To ensure a safe and compliant installation, please follow these precautions:

- This product is designed for professional installation.
- Disconnect power before starting installation or maintenance.
- Installation must comply with AS/NZS 3000 and all relevant local electrical and building regulations.
- Do not exceed the product's rated electrical capacity.
- Avoid using power tools unless explicitly specified.
- Do not install in areas exposed to water or high humidity unless rated for such conditions.
- Use appropriate personal protective equipment (e.g., gloves, safety glasses).

For product usage and maintenance safety, please refer to the User Manual.

2. PRODUCT OVERVIEW

PRODUCT DESCRIPTION

This fire-rated smart lock is compact and ideal for indoor use, offering a seamless blend of safety, convenience, and intelligent features tailored for modern living. This product's door handle and design comply with AS 1428.1 standards, ensuring accessibility for people with disabilities and making it a smart, inclusive solution for any interior space.

*The Zigbee version can work as a standalone lock, allowing password setup, fingerprint registration, and access fob configuration, but a gateway is needed for smart features.



FEATURES



FIRE-RATED

Fire Resistance Rating 120M/30M.



TEMPORARY PASSWORD

Generate a temporary passwords on the Arks App for visitors to unlock the door, expiring after a set time for convenience and security.



APP CONTROL

Unlock the door remotely for someone, even if you are not at home.



EMERGENCY POWER SUPPLY

In-built Type-C port included for emergency low battery situations.



MULTIPLE UNLOCKING

Many ways to unlock: Fingerprint, Passcode, Access fob, Key and App control.



SCENE CONTROL

Unlocking the door activates lights, curtains, security, and more via the Konec smart home system.

CERTIFICATION



This product is RCM certified, ensuring compliance with Australian safety and regulatory standards.

2. PRODUCT OVERVIEW

SPECIFICATIONS

Housing Material	Aluminium Alloy	Low Battery Alarm	Less than 4.8V
Colour	Black	Data Capacity	Fingerprint + Password + Access Fob \leq 100
Door Thickness to Fit	35 - 65mm	Battery Duration	Up to 10 Months
Compatible Door Material	Aluminium Door Wooden Door	Fingerprint Recognition Speed	\leq 0.5s
Lock Body	60/70 Adjustable Latchbolt	Alarm Type	Incorrect Entry Alarm Low Battery Alarm
Fire Resistance*	Integrity: 120 Min Insulation: 30 Min	False Acceptance Rate (FAR)	$<$ 0.001%
IP Rating	IP55	False Rejection Rate (FRR)	$<$ 1%
Connection Type	Zigbee	Unlocking Methods	Fingerprint, Password, Access Fob , Mechanical Key, App Control
Battery	6V/AA x 4	Operating Temperature	-10 °C ~ 55 °C
Weight	2kg	Operating Humidity	10% ~ 90% RH (Non-Condensing)
Dimensions	192 x 143 x 74mm		

*For additional information regarding the fire testing results, please reach out to the Konec Project Management team.

DIMENSIONS

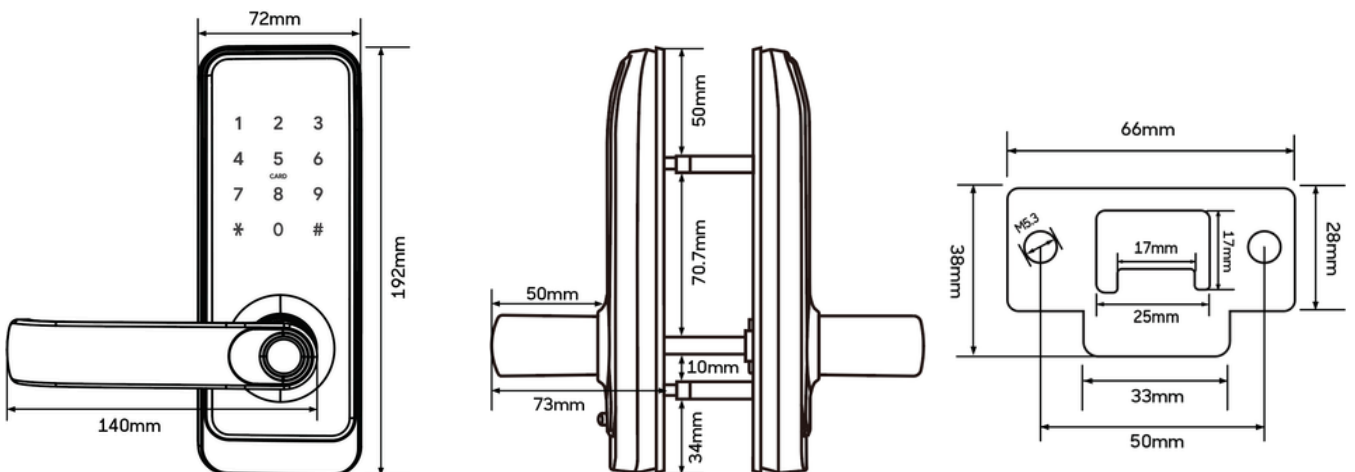

3. SETUP

FUNCTION DIAGRAM

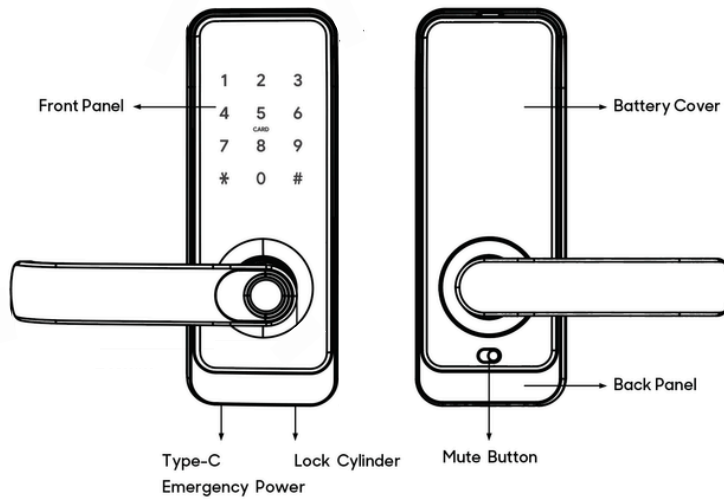

WHAT'S INCLUDED

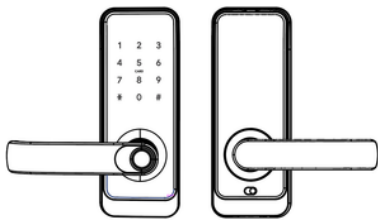

FRONT & BACK PANEL * 1

(Rubber plates included)

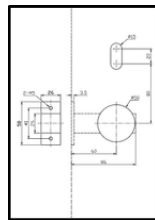

DRILLING TEMPLATE * 1

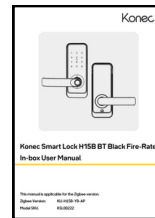

IN-BOX USER MANUAL * 1

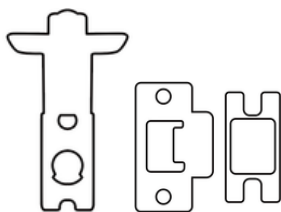

LATCH & STRIKE PLATE * 1

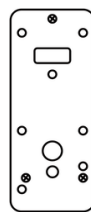

BACK GASKET * 1

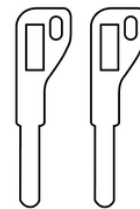

MECHANICAL KEY * 2



ACCESS FOB * 3

ACCESSORIES BAG

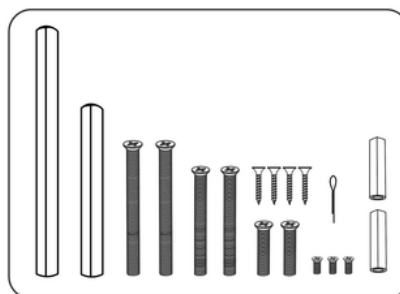

- Square Spindle * 2
- Screw Casing M5 x 35mm * 2
- U-Clip * 1**
- M3 x 10mm * 3
- M4 x 20mm * 4
- M5 x 25mm * 2
- M5 x 35mm * 2
- M5 x 45mm * 2



Before installing the product, please carefully read the installation guide.
 The U-clip must be fixed onto the spindle and the front panel.
 Failure to fix the U-clip will affect the lock function and **void the warranty**.

3. SETUP

Pre-Installation

3.1 Adjust Handle Placement

Follow these steps to match the desired door orientation.
(e.g., left-hand or right-hand configuration).

Front Panel:

- 1 Loosen the screw (Sticker indicated).

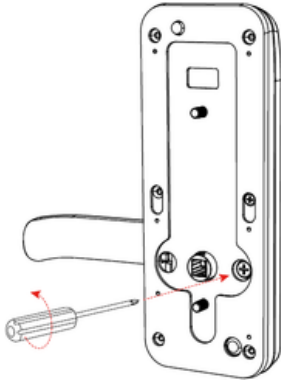

- 2 Rotate the handle left or right, depending on your desired orientation.

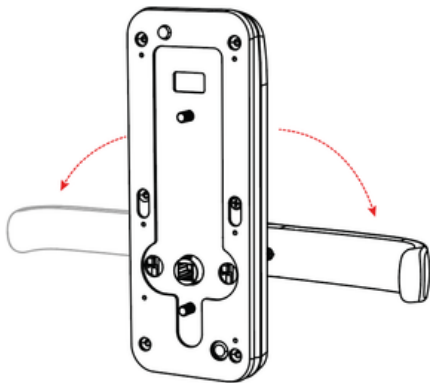

- 3 Place and tighten the screw into the hole furthest from the handle.

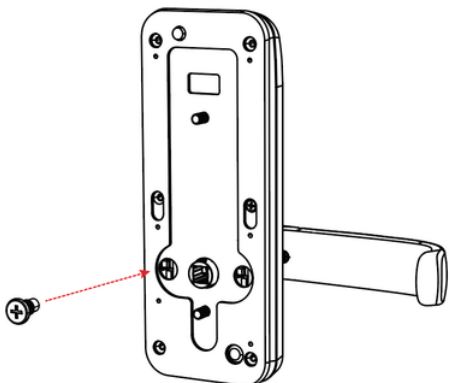

Back Panel:

- 1 Lift the back plate and loosen the screw.

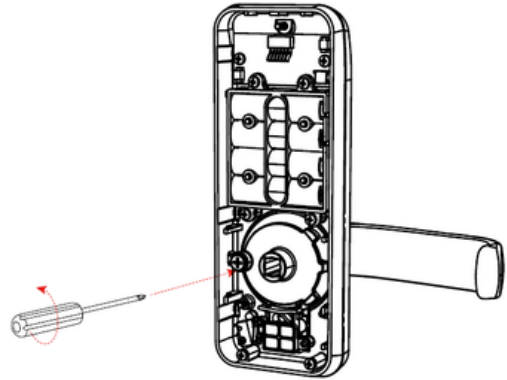

- 2 Rotate the handle left or right to achieve the desired orientation

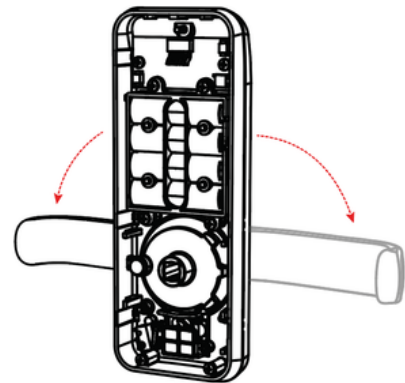

- 3 Place and tighten the screw into the hole furthest from the handle.

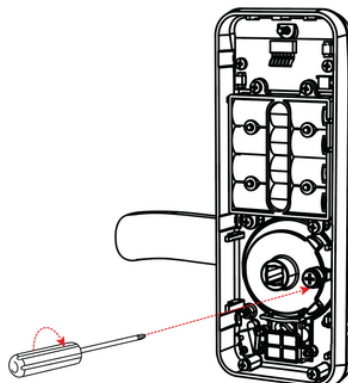

3. SETUP

3.2 Prepare the door

The requirement thickness of the door is 35 – 65mm.
Refer to the drilling template (included in the box) and drill the door accordingly.
Ensure the lock body and latch are properly aligned.



The included drilling template is **ONLY** for the **60mm backset setup**.
If you wish to use the 70mm backset, please adjust the measurements accordingly.

Installation

1

- 1.1 Adjust the Latch - 60mm (default) or 70mm.
- 1.2 Screw the Latch onto the door (M5 x 25mm).

1.1 Adjust the Latch:



If you have a pre-existing 70mm backset, you cannot use the 60mm latch. Please adjust the latch.

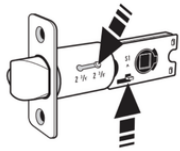

1. Locate the tab and push down.

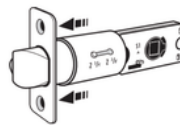

2. Push the tab up and hold.

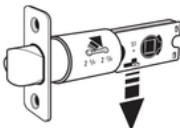

3. Extend and pull until it clicks.

4. Release and move the tab down.

1.2 Install the Latch:

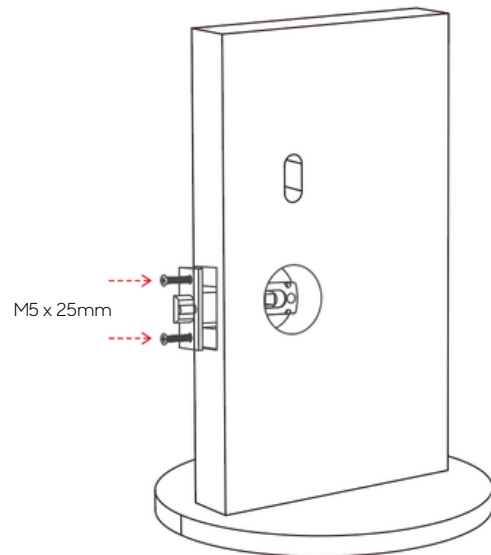

2

- 2.1 Connect the rubber gasket to the front panel.
- 2.2 Screw and tighten the screw casing * 2 (M5 x 30mm).

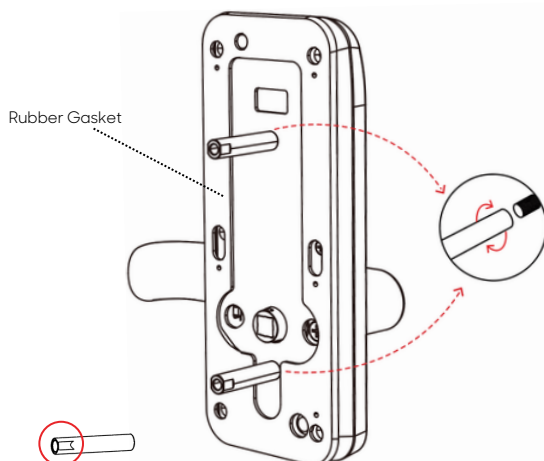

Note: The marked end should **face away** from the front panel.

IMPORTANT

- 2.3 Insert the square spindle.
- 2.4 **Insert the U-clip and bend the ends to fix the spindle.**
Incorrect installation will void the warranty.

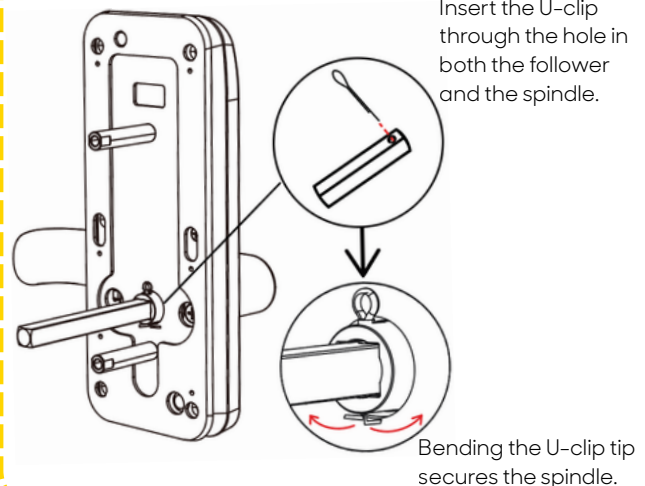

Insert the U-clip through the hole in both the follower and the spindle.

Bending the U-clip tip secures the spindle.

3. SETUP

3

Install the rubber gasket back plate.
Use the screw to connect with the screw casing.

Note: Screw size is dependent on the square spindle.
Square Spindle 60mm = M5 x 35mm Screw
Square Spindle 80mm = M5 x 45mm Screw

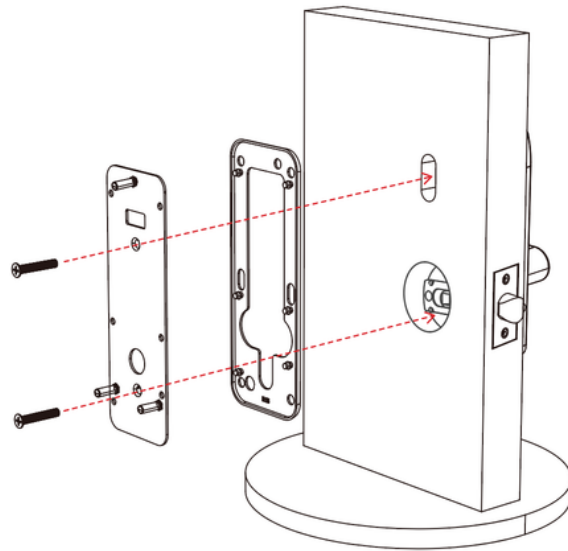

4

4.1 Connect the wire from the front panel to the back panel.
4.2 Screw the back panel onto the back plate.

M3 x 10mm

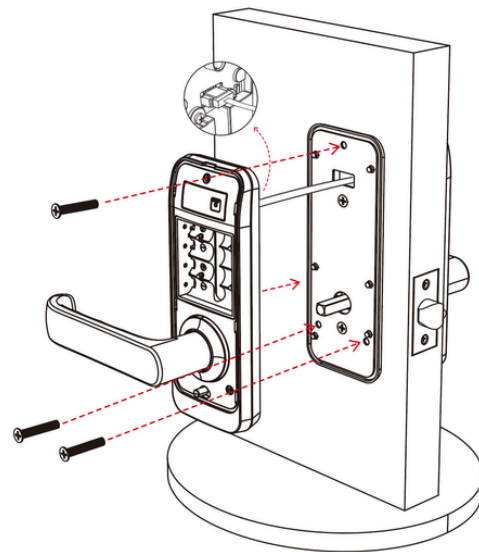

5

5.1 Insert AA batteries * 4 and close the back cover.
5.2 Install the Strike and Strike box with M4 x 20mm screws.

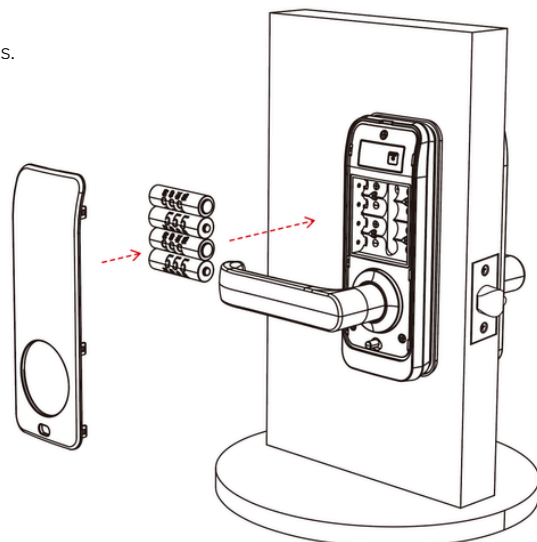

3. SETUP

LOCAL MODE

1. Overview

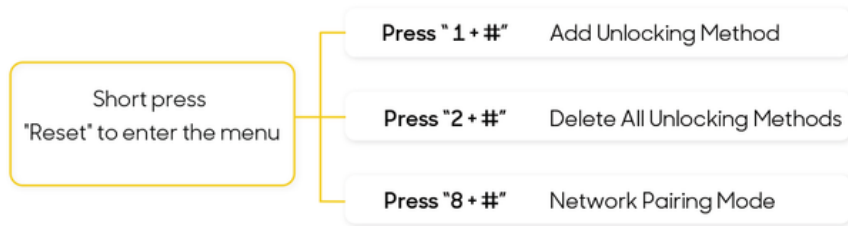

2. Add unlocking method

This method is for installation and set-up that does not require smart home configuration.

※ Local Mode is only available on the **Non-SaaS Zigbee** versions.

1. Short press [Reset] > [1] > [#].

 "Please place your finger or swipe your card or enter your password".

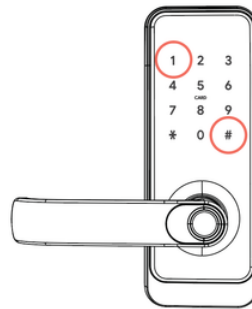

2. Register the Unlock Method.

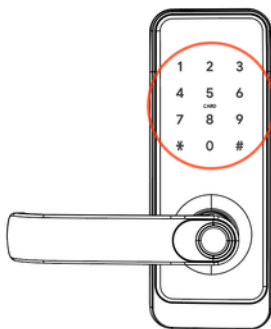

Password:

Enter the password (6 digits) and press [#].
Re-enter the password and [#] to confirm.

 "Entry Passed".

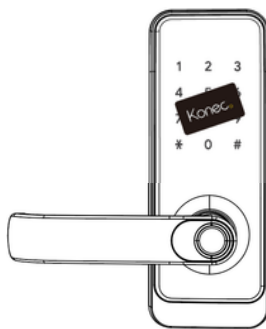

Access fob:

Place the fob onto the card scanning area until you hear a beep.

 "Entry Passed".

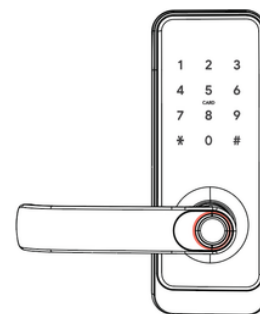

Fingerprint: Place your finger onto the fingerprint scanner. Remove your finger and wait for the voice prompt.

 "Please place your finger again".

Repeat the steps again until you hear the voice prompt.

 "Entry Passed".

※ This Mode will automatically exit after 20s without any operation.

3. SETUP

3. Delete Unlocking Method

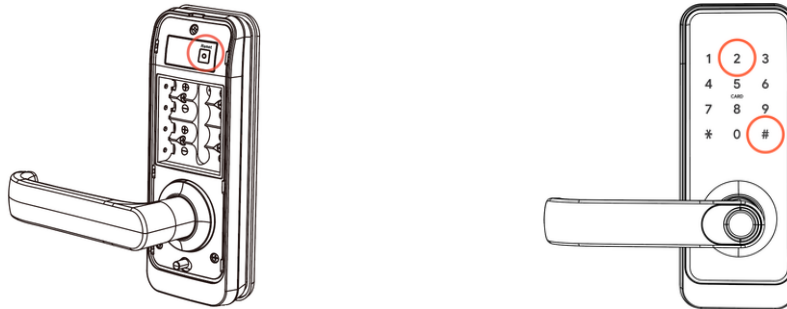

Short press [**Reset**] > [**2**] > [**#**].

 "Deleted Successfully".

✘ Note:

Once the device is connected to the network, this method can no longer be used to delete open permission.

If needed, you may delete them via the Arks App.

4. Local Password Link to Arks

After adding the local unlock method, then connect the device to Arks. At this point, need to connect the unlocking method to the corresponding family members. The step refer to Pg.17.

RESTORE TO FACTORY SETTINGS

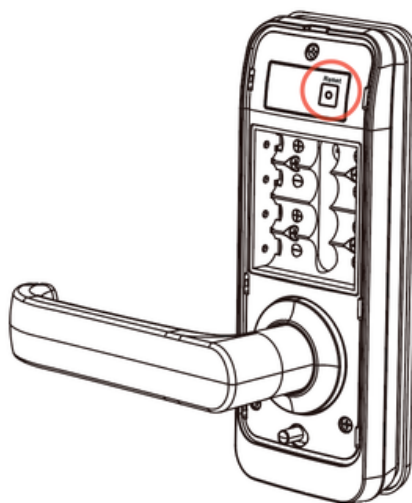

Press and hold the [**Reset**] button for 10 seconds, until you hear the following voice prompt below.

 "Configuring Network, please wait".

4. CONFIGURATION

* **Disclaimer:** All images and text provided below are intended for reference purposes only. Please note that this content is subject to updates, and both the text and images may change over time.

4.1 DOWNLOAD THE APP



iOS



Android

Scan the QR Code to download Arks by Konec Solutions App.

4.2 ADD PRODUCT TO ARKS

- 1 Power on the device and then press [**Reset**] > [**8**] > [**#**].
[**5**] and [*****] will flash to indicate it is in Pairing Mode.
✦ If this step fails to enter the pairing mode, follow the above steps, please hard reset the device (Pg.9), and repeat the pairing operation.

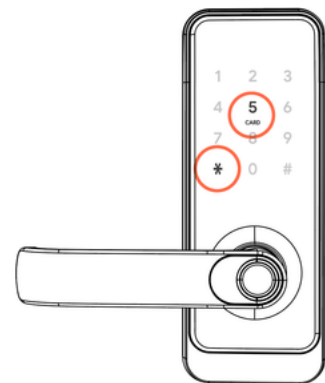
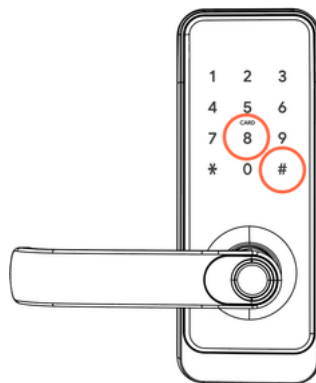
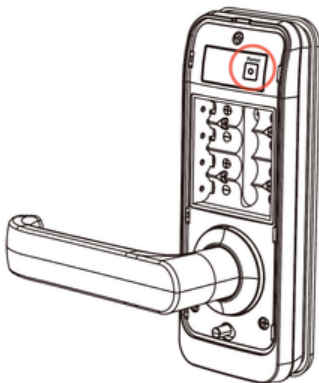

* If the lock is paired with a new account, the previous account will still show the device on the homepage but it will not be able to control the lock.

- 2 On the app, tap on the home select list to choose the home where you want to add the device.
✦ If you want to add it in a new home, please reference to the "Konec Arks APP User Guide" to create a new home.



✦ Ensure that a gateway is installed properly and added to the Arks App. Please refer to the User Manual for the corresponding gateway installation and pairing.

4. CONFIGURATION

- 3 Tap on the "+" icon and then tap **[Add Device]**.

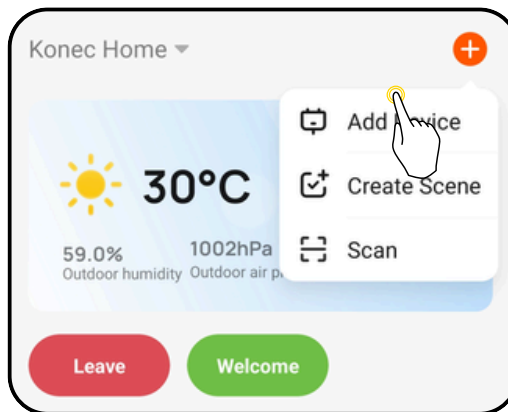

- 4 Tap on **[Locks/Cameras]**, and then tap **[Smart Lock H15B Zigbee]**. Choose the gateway you wish to pair with the lock.

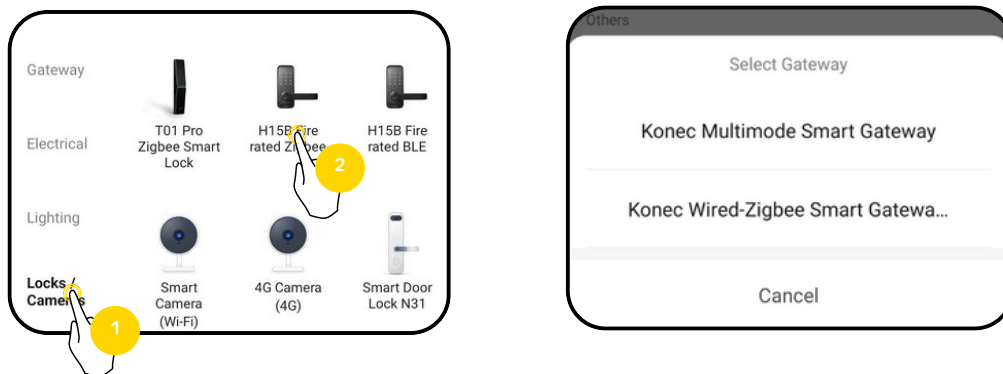

- 5 Tap the reset status confirmation and tap **[Next]**. The app will scan for the device.

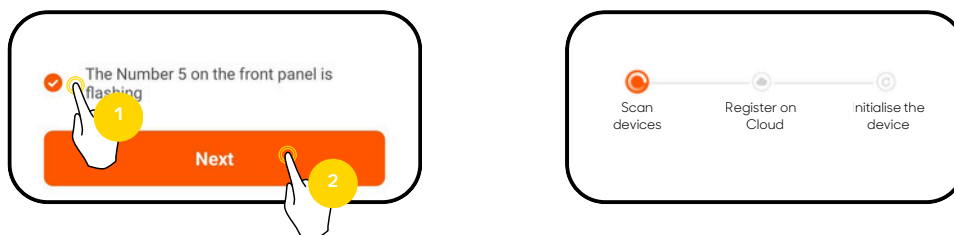

- 6 Device will be automatically detected and pair. A voice prompt from the device will say "Operation Successful" once complete. Tap **[Done]** to return to the dashboard. The lock should appear on the Dashboard.



4. CONFIGURATION

4.3 DEVICE CONTROL PAGE

Directly access and control the settings and functionalities of the Konec Smart Lock H15B BT Black (Fire-Rated) - Zigbee. Special features include adjusting settings, viewing status, or performing setup configurations.

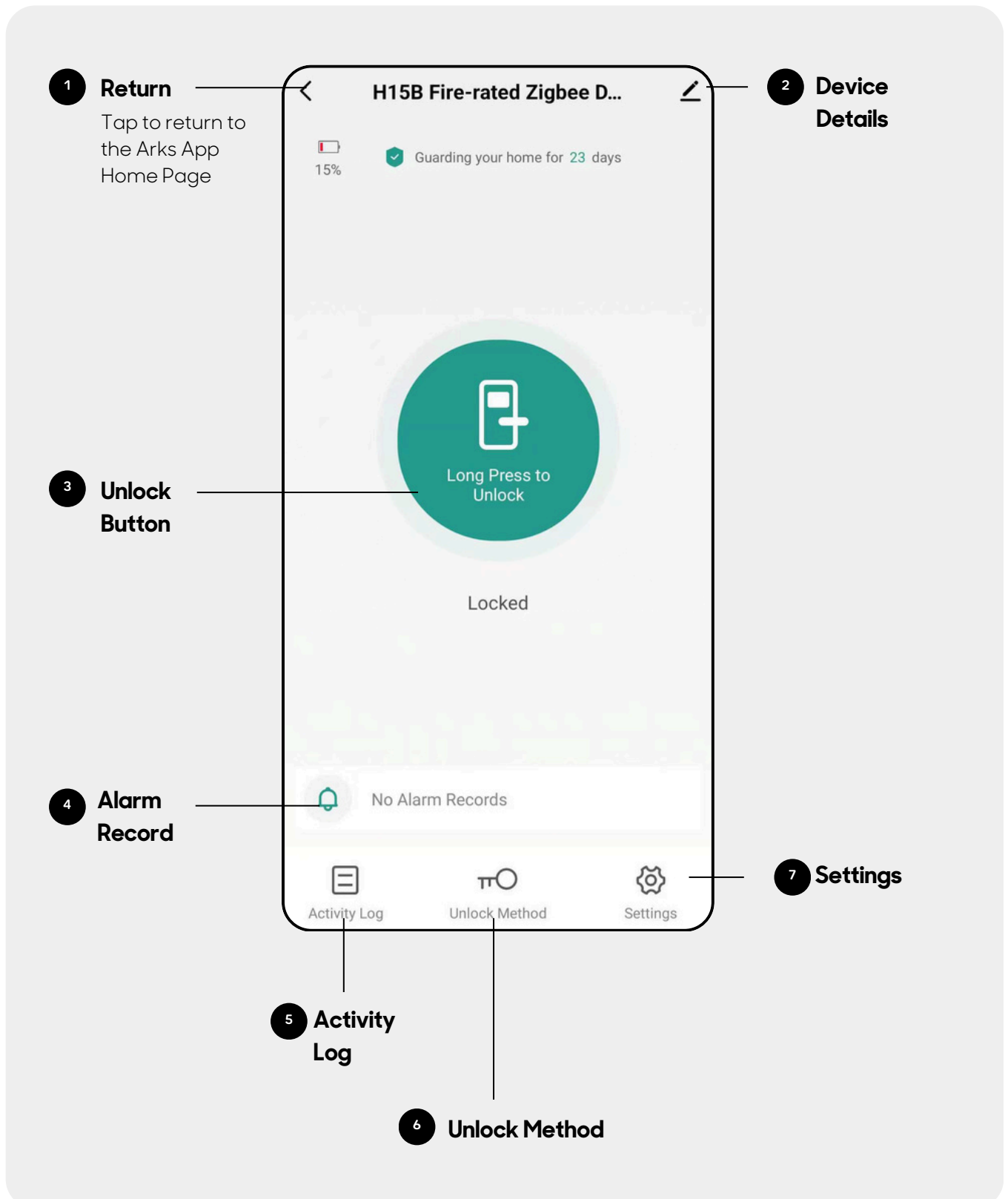

4. CONFIGURATION

1 RETURN

Tap the Return icon "◀" to go back to the Home Screen.

2 DEVICE DETAILS

Access the Device information and other information.

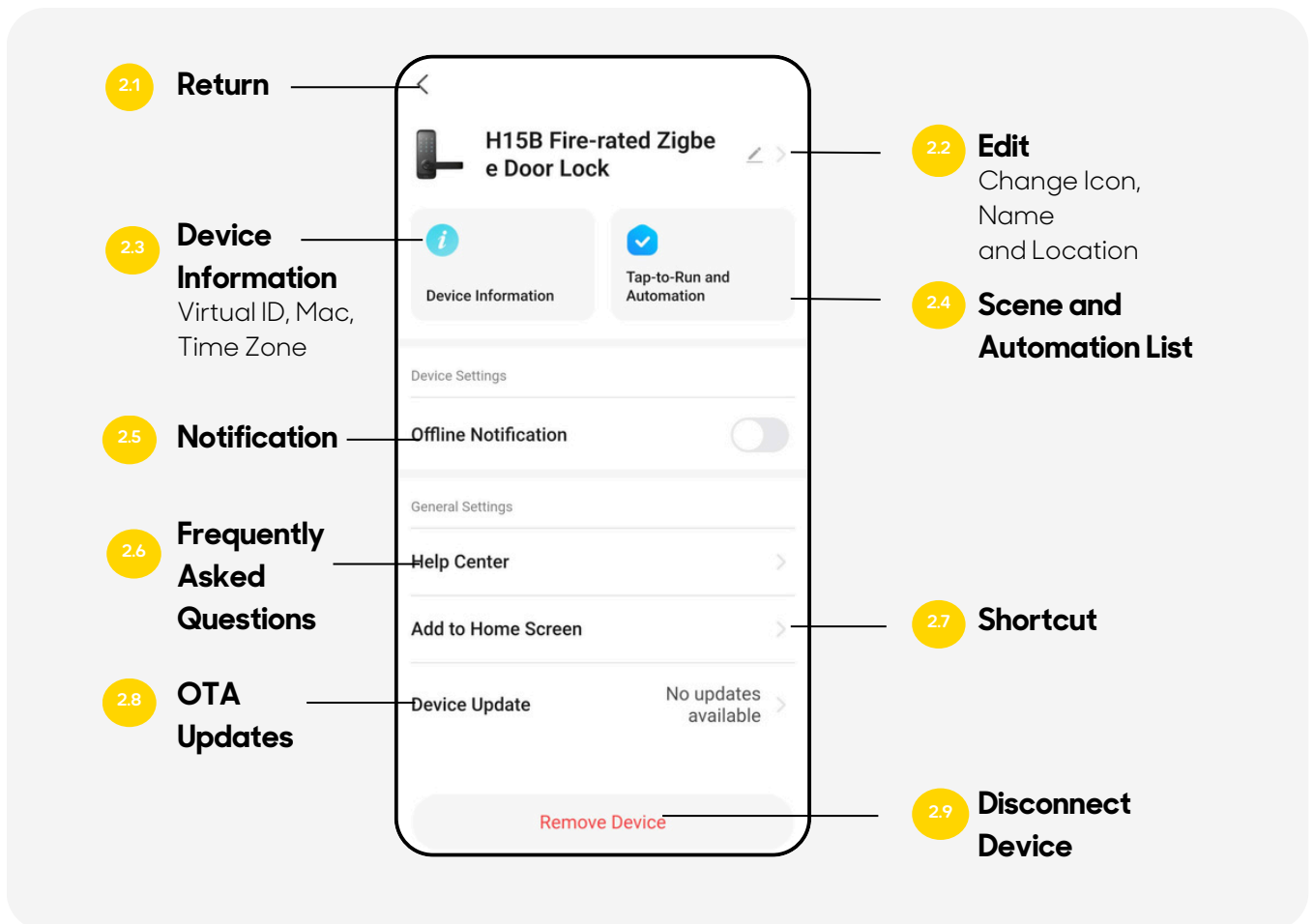

2.1 Return

Tap the Return icon "◀" to go back to the Device Interface.

2.2 Edit

Tap the Signature icon "✎" to change Icon, Name and Location of the device.

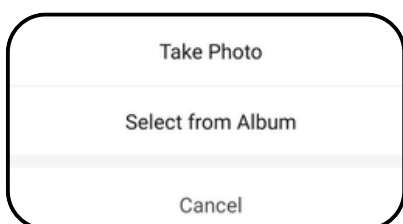

Icon

Update the display icon.

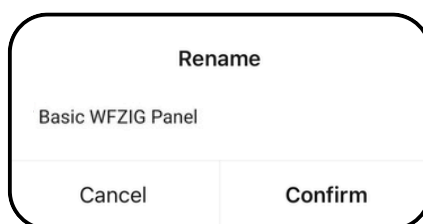

Name

Change the display name.

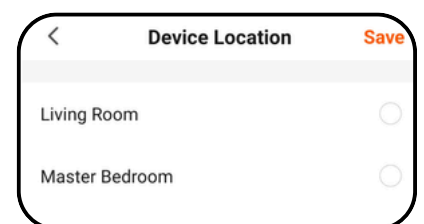

Location

Select where the device is located.

4. CONFIGURATION

2.3

Device Information

Obtain the information about Virtual ID, Mac, and Time Zone.

2.4

Scene and Automation List

View the list of Scenes and Automations that this device is included in.

You can tap [**Tap-to-Run and Automation**] to view the list of Scenes and Automation.

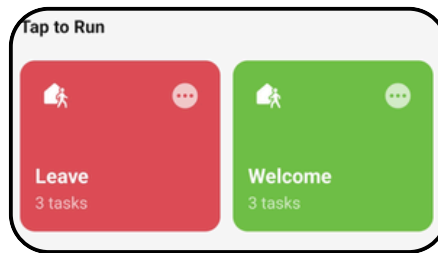

2.5

Notifications

Receive phone notifications when this device's status changes to offline.

To turn on this function, under "**Device Offline Notification**" toggle [**Offline Notification**] ON.

2.6

FAQ Access a list of questions that are related to this product.

Tap [**More**] to access the general FAQ.

2.7

Shortcut

Add a shortcut onto your phone home screen for easier access.

1. Tap [**Add to Home Screen**].
2. Tap [**Go**].
3. Tap [**Add**].

2.8

OTA Updates

Check for the latest firmware updates.

Toggle ON [**Auto Upgrade**], if you wish to automatically update the device when a new update is detected.

2.9

Disconnect Device

Remove and disconnect the device from your app.

Disconnect: You will remove the device and all related automation settings will be deleted. Tap [**Disconnect**] > [**Confirm**].

Disconnect & Wipe Data: You will remove the device and all related data will be deleted. Tap [**Disconnect and wipe data**] > [**Confirm**].

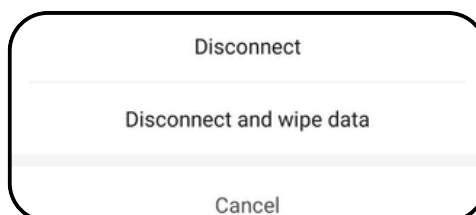

4. CONFIGURATION

3 UNLOCK BUTTON

Long press and hold the switch icon to lock/unlock the lock.

4 ALARM RECORD

Tap the Alarm icon "🔔" to check the alarm history.

5 ACTIVITY LOG

Tap the [Activity Log] to check the open history.

6 UNLOCK METHOD

Tap the [Unlock Method] to set the unlock method.

 **Note:** After configuring the smart lock, please wait 3 minutes before adding the unlocking methods.

• Add Member

1. Tap the [+] to select unlock method.
2. Tap [family unlock] to add members.

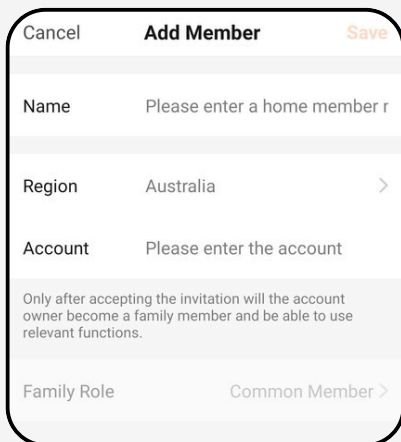
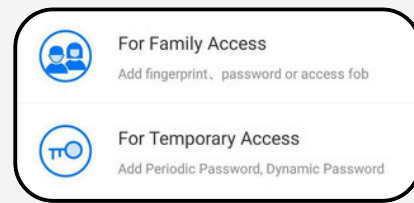
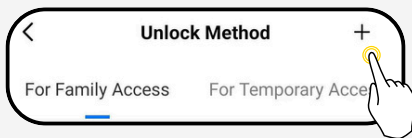

3. On the Add Member Page, input:
 - Name: The new member's nickname
 - Region: Select **Australia**
 - Account: Either the **Email Address** or **Mobile Number** listed on the New member's Account and Security section
 - Family Role: Select the Access type (Administrator or Common Member)
4. Tap [Save].

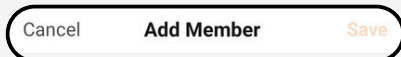

• For Family Access

1. Click the member's name to add the unlock method for the member.
2. Tap the add icon "⊕" to choose unlock method need to be added.
3. Follow the add instruction to finish the setting.

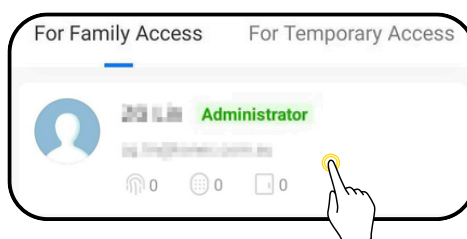

4. CONFIGURATION

• Fingerprint

1. Tap "+" > [**Start**].
2. Follow the voice prompt put the finger on the scan area for several times to finish the fingerprint record.
3. Tap [**Done**].

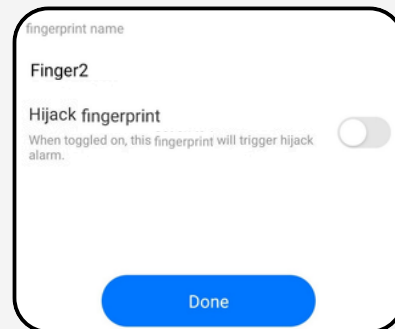
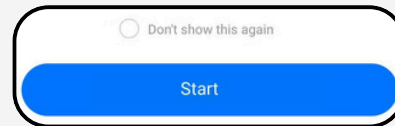
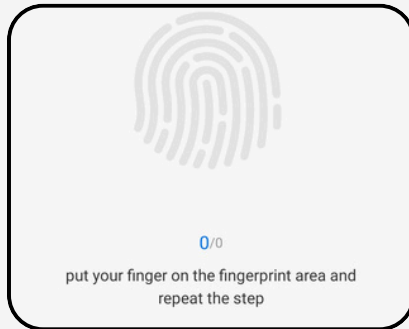
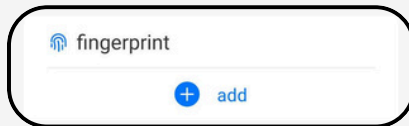

• Password

1. Tap "+" > [**Start**].
2. Input your own password > [#], after hearing the voice prompt "Please enter your password again" input your own password > [#] again to confirm.

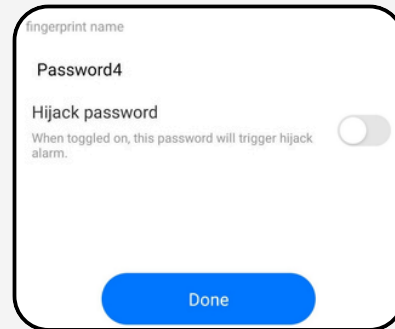
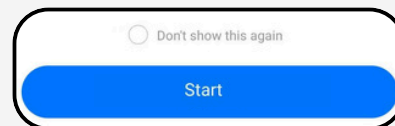
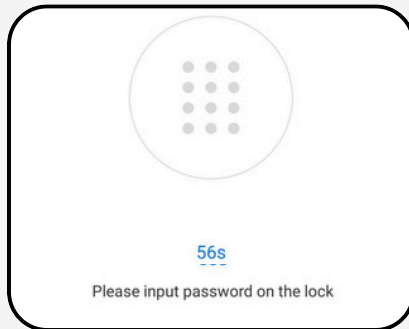
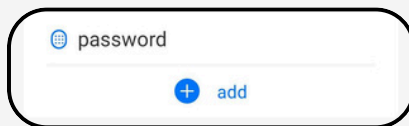

• Card

1. Tap "+" > [**Start**].
2. Place the swipe card on the scan area to add the card.

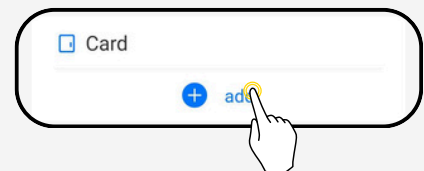

• Hijack

Toggle ON the unlock method hijack to receive alerts when specific unlocking methods are used.

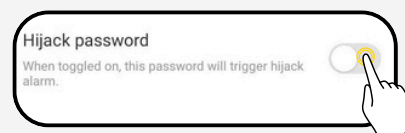

4. CONFIGURATION

• For Temporary Access

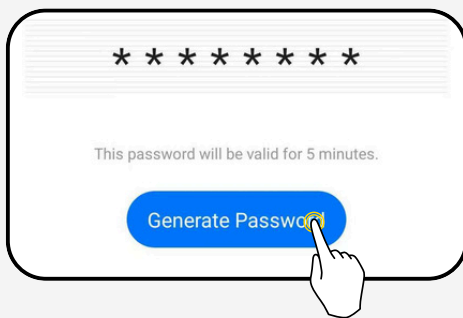
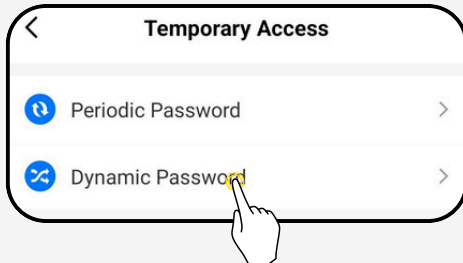
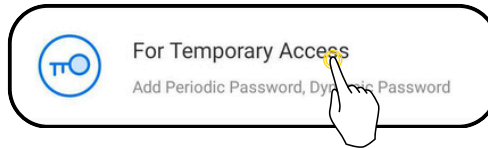

Dynamic Password

1. Tap the [+] to choose unlock method.
2. Select [**Temporary Access**].
3. Select [**Dynamic Password**] and tap [**Generate Password**] to generate a one-time password, which will be expired after using.

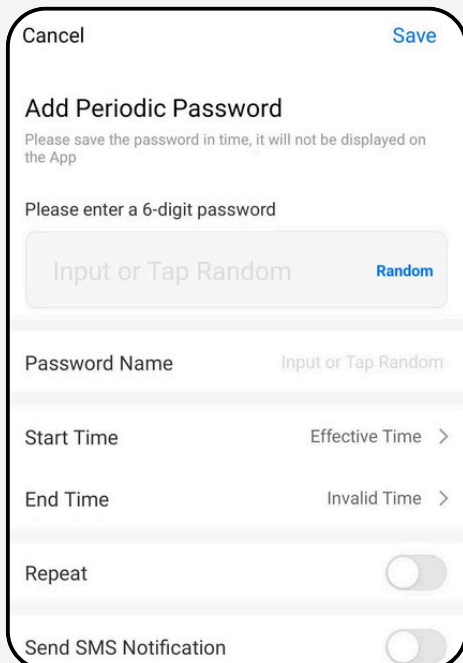
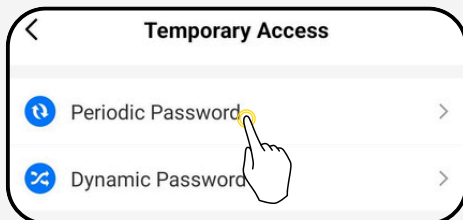

Periodic Password

1. Tap the [+] to select unlock method.
2. Tap [**Temporary Access**].
3. Tap [**Periodic Password**] to generate a temporary password.
4. Tap [**Random**] to generate a 6-digit password.
5. Set the time duration, repeat and notification.
6. Tap [**save**].

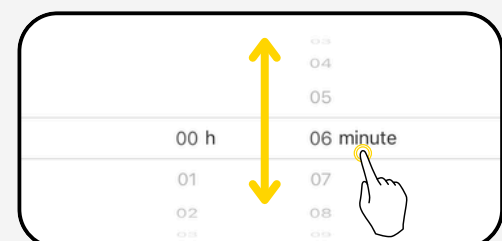

4. CONFIGURATION

• Link unbound unlocking method

After adding the local unlock method, then connect the device to Arks. At this point, need to connect the unlocking method to the corresponding family members. The steps are as follows:

1. Use the corresponding unlocking method to unlock.
2. Tap on "**Activity Log**" to see unlock histories for unassigned unlocking methods.
3. Tap "**Link User**" to enter the member selection interface, select member and tap "**Confirm**".
4. You can see that the unlocking history interface has assigned members to the corresponding unlocking methods.

Or in the unlock ways, tap "There are unbind unlocking ways, go to bind" to find the unbind unlock method.

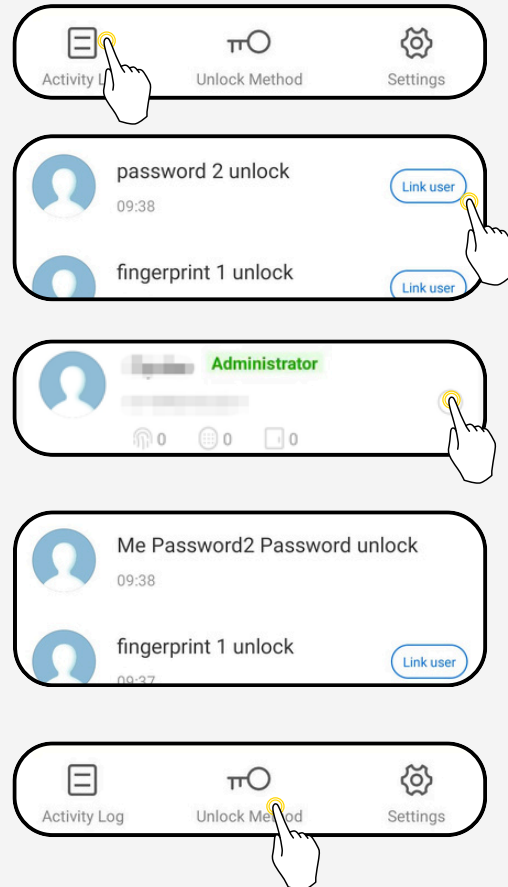

4. CONFIGURATION

8 SETTINGS

Set up the devices with "⚙️".

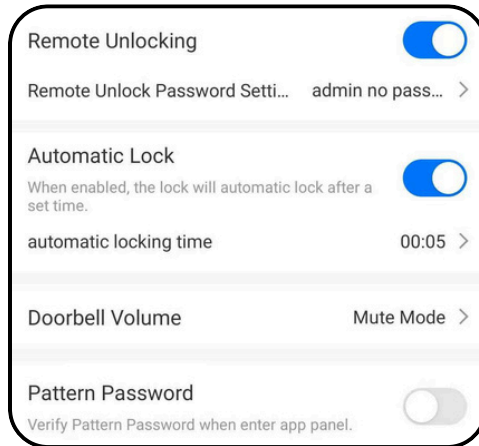

- **Remote Operation**

Toggle on "Remote Unlocking" to set member permissions for remote control.

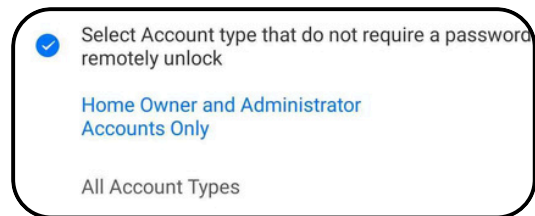

- **Automatic Lock**

Toggle on "Automatic Lock" and scroll to set the automatic locking time.

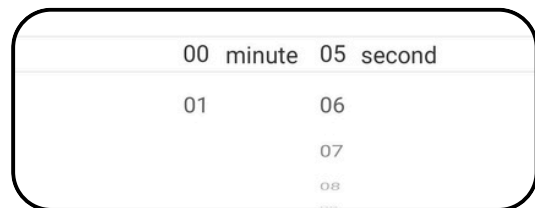

- **Doorbell Volume**

Set the doorbell buzzer mode.

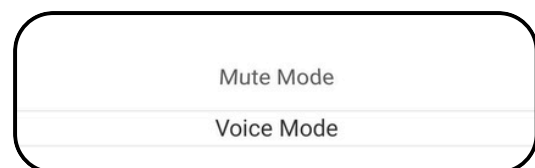

- **Pattern Password**

You can toggle on "Pattern Password" to set or change the pattern password, used to access the device interface.

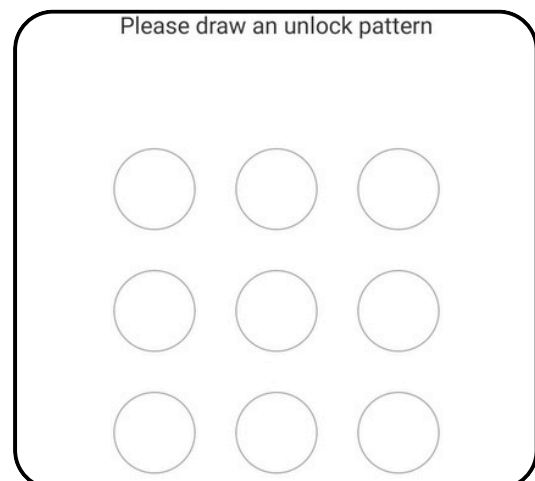

4. CONFIGURATION

4.4 REMOVE FROM ARKS

Remove and disconnect the device from your app.

1. On the Home screen, select the switch and tap on the **Edit** icon "✎".



2. Tap on [**Remove Device**].

3. Select which method you wish to remove the device:

- **Disconnect:** You will remove the device and all related automation settings will be deleted. Tap [**Disconnect**] > [**Confirm**].
- **Disconnect & Wipe Data:** You will remove the device and all related data will be deleted. Tap [**Disconnect and wipe data**] > [**Confirm**].

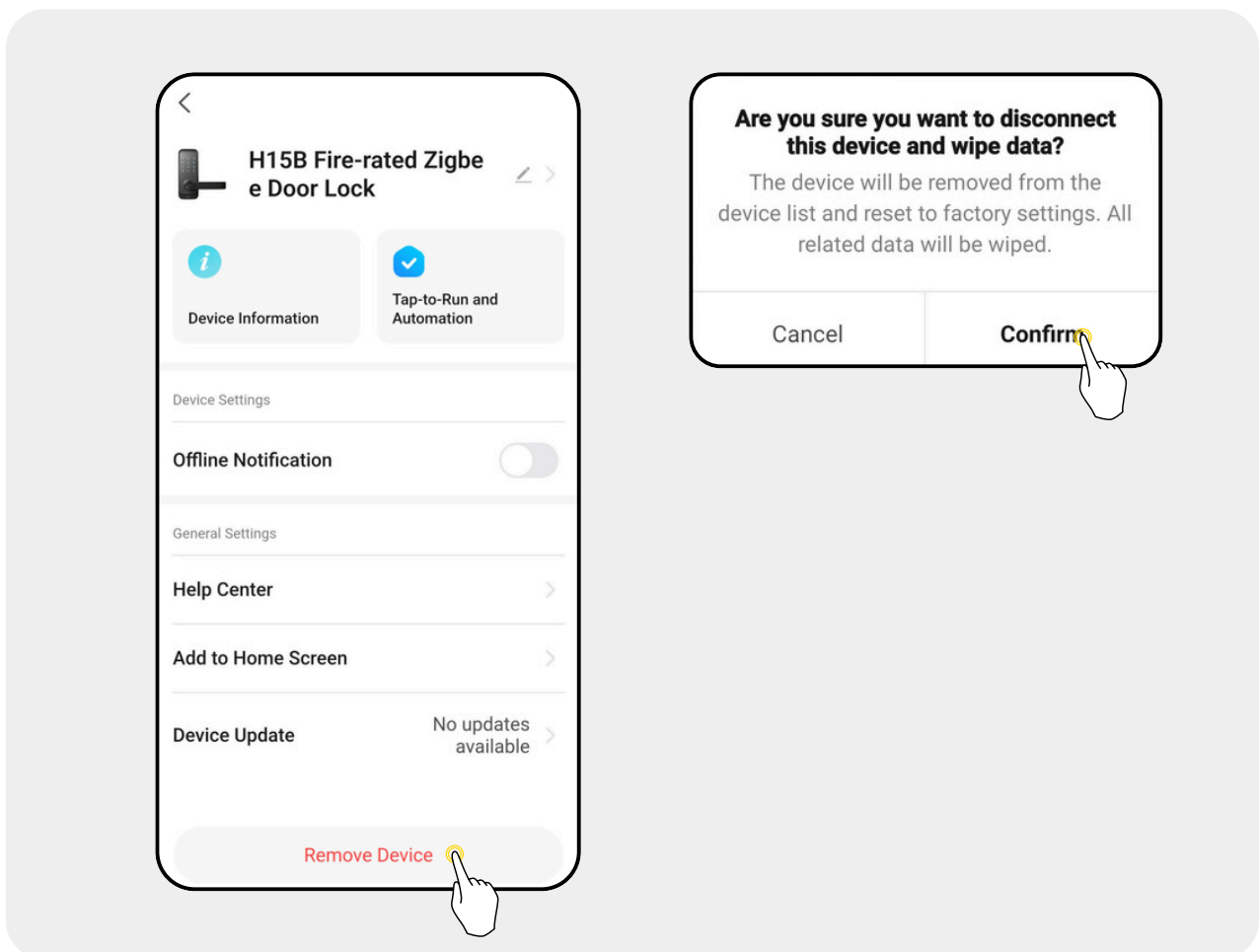

Disclaimer: Hard resetting the device will also remove the device from the Arks app.

5. UPDATE

FIRMWARE UPDATE

When the device first connects to the Arks app, an automatic update will pop up for device upgrade.

1. Tap [**Update Now**] > [**Update**] > [**Start Update**].
2. Wait for the update to be complete.

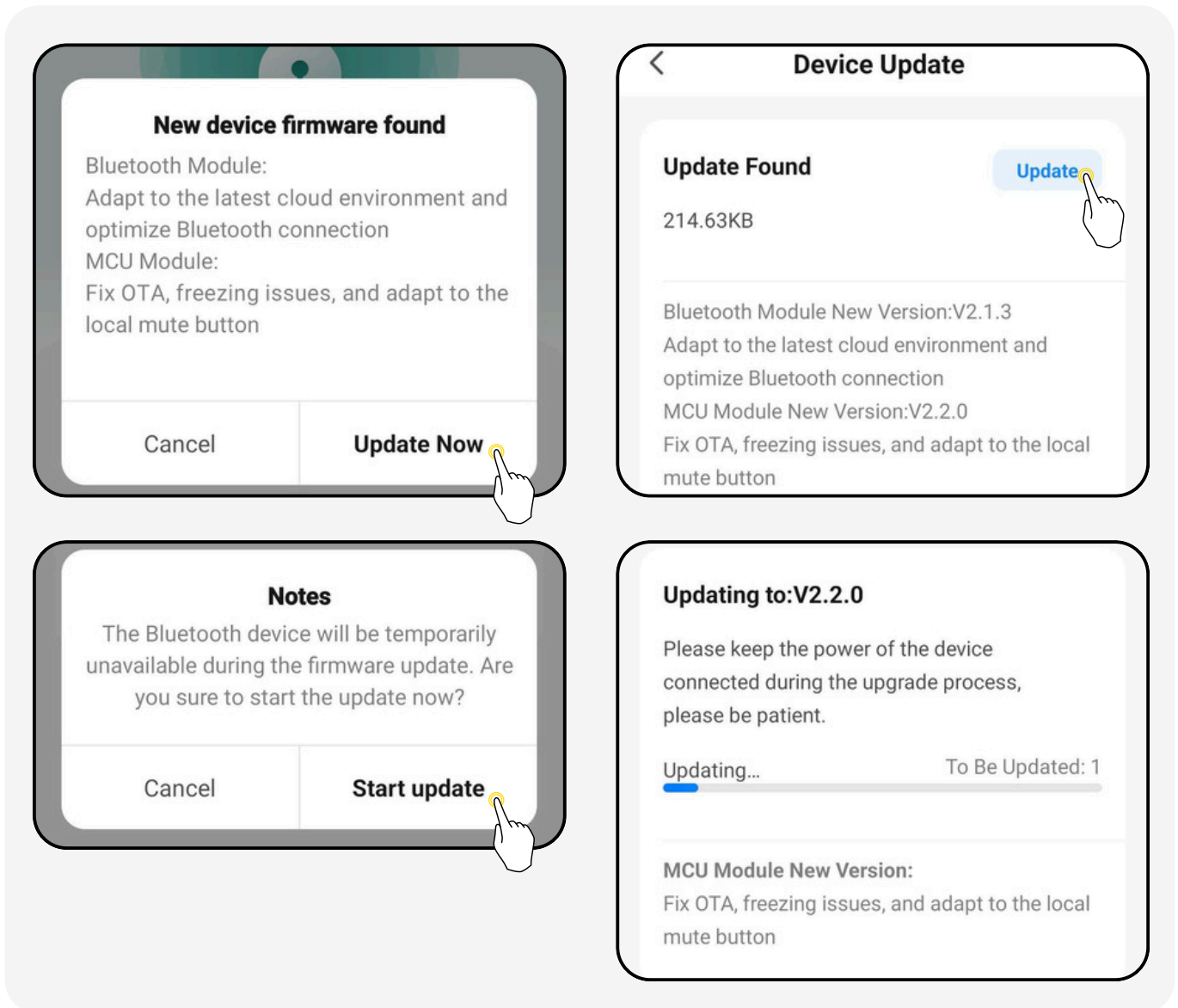

6. SCENE

SCENE SETTING

1. On the Home Page, tap the [**Scene**] tab or [**+**] icon to access your **Automation** and **Tap-to-Run** List.
2. Tap [**Create Scene**].

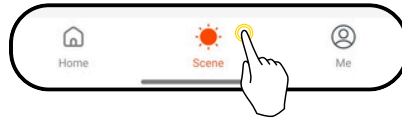

- **Condition:** If this device is used as a condition.
Tap [**When device status changes**], then tap this device in the list.

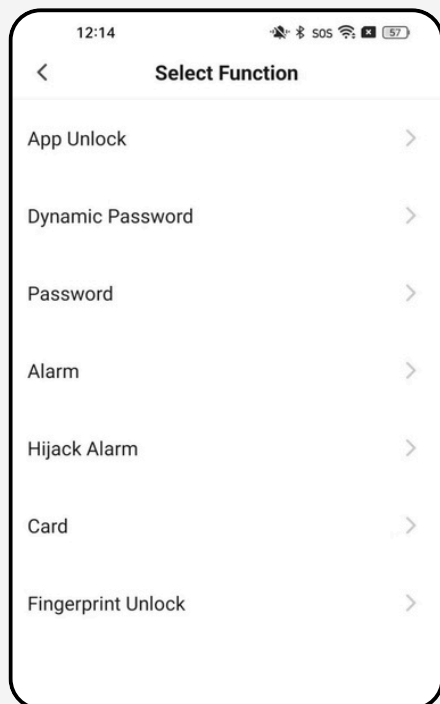
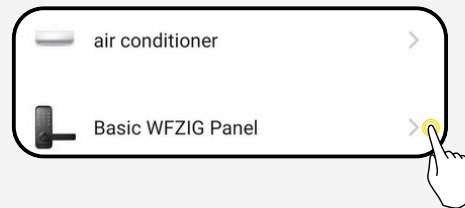
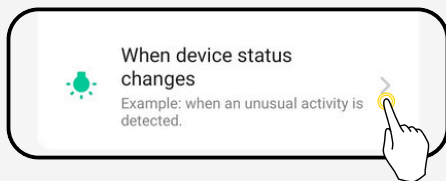

- [**App Unlock**]: Set the App unlock number of times as the condition.
- [**Dynamic Password**]: Set the dynamic code unlock number of times as the condition.
- [**Password**]: The ID associated with the entered passcode matches the specified ID as the condition.
- [**Alarm**]: When the alarm is triggered.
- [**Hijack Alarm**]: When the Hijack unlock method used.
- [**Card**]: The ID associated with the unlocking card matches the specified ID as the condition.
- [**Fingerprint Unlock**]: The ID associated with the unlocking fingerprint matches the specified ID as the condition.

6. SCENE

- [Add Task]:



Select which device you want to activate when the scene is triggered.

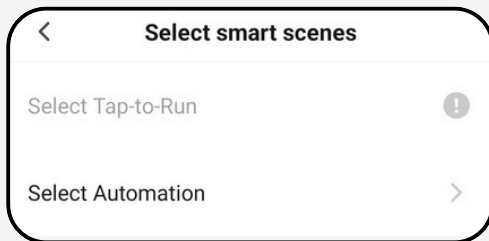
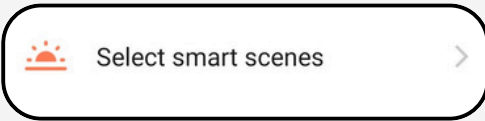

Link to another Smart scene to be activated when this scene is triggered.

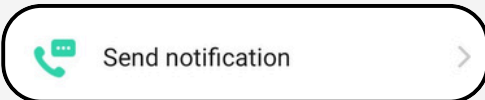

Receive phone notifications when this device's status changes.

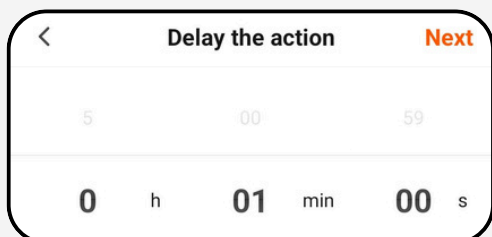
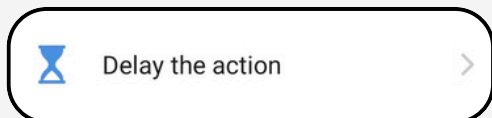
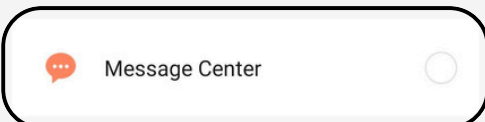

Set a delayed response where the selected devices will trigger after the set time.

7. CONTACT US

Search for "Arks" in the App Store or Google Play, or scan the QR code below to download and install the App. Click "Register" to register a new account if this is your first time to use; if you already have an account, click "Login"

Scan the QR Code to download Arks by Konec Solutions App.



IOS



Android

Konec Solutions Pty Ltd

Please do not hesitate to contact us if you have any questions.



Konec Official Web

<http://www.konec.com.au>



Hotline

1300 2 56632 (1300 2 KONEC)



Sales & Partnership

sales@konec.com.au



Customer Support

support@konec.com.au



Address

L3 5 Talavera Road Macquarie Park NSW 2113
