

**Item No.: DES-700 / DC-500**

## Applications

- Garage Door
- Overhead Door
- Entrance
- Super Market, Restaurant, Warehouse

## Features

- Retro-Reflection Type
- Sensing Range: 0.5~6 meters (18 feet)
- Volume Of Speaker: adjustable
- Sounding Time: 3~30 seconds adjustable

**DES-700 Including:** Sensor / Reflector / Speaker / Adapter / Mounting bracket / screw / Manual and Mini screwdriver for speaker

## Specification

<b>Sensing Type</b>	Retro-Reflection Type Door Entry Alarm System
<b>Sensing Range</b>	0.5~6 meters ( 18 feet)
<b>Input Voltage</b>	DC 9~15V
<b>Consumption Current</b>	130mA
<b>Standby Current</b>	25 mA max.
<b>Light Source</b>	IR LED
<b>Ambient Temperature</b>	-20°C~50°C (-4°F~122°F)
<b>Response time of Speaker</b>	Chime: 1 sec. Alarm: 30 sec.
<b>Volume of Speaker</b>	0~max. (Adjustable)
<b>Alarm Time</b>	30 sec max. (Adjustable)
<b>External Chime Output</b>	NPN Output
<b>Speaker Output</b>	Chime / Off / Alarm (Selected by Slide Switch)
<b>Mounting Bracket and Screw</b>	Included

## Connection Diagram 1

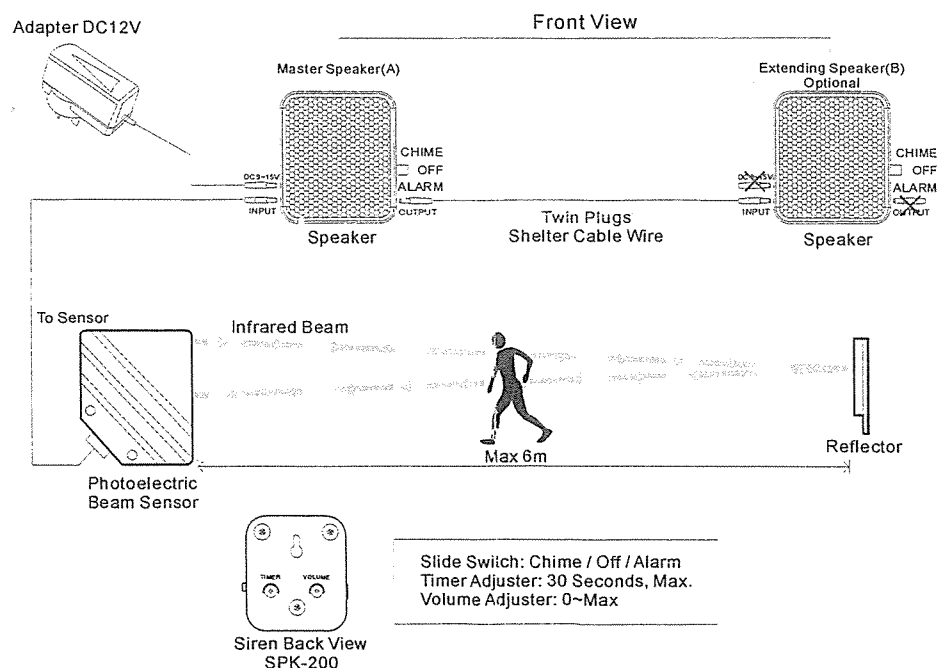

## Connection Diagram 2

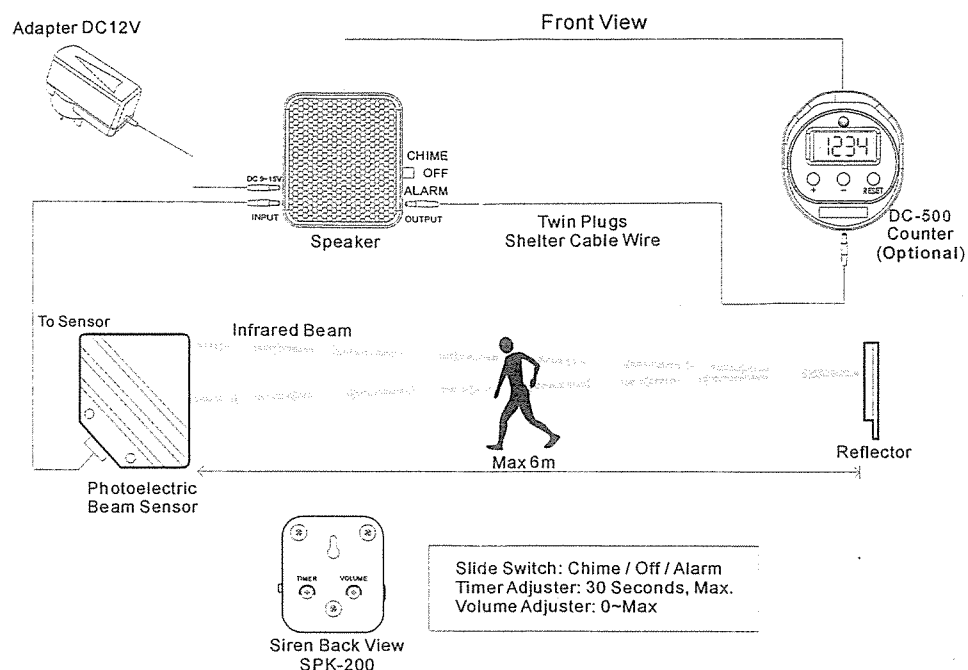

## Connection Diagram 3

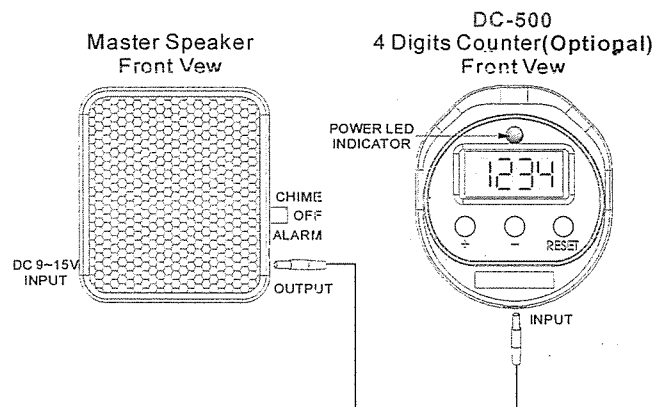

## Standard Installation

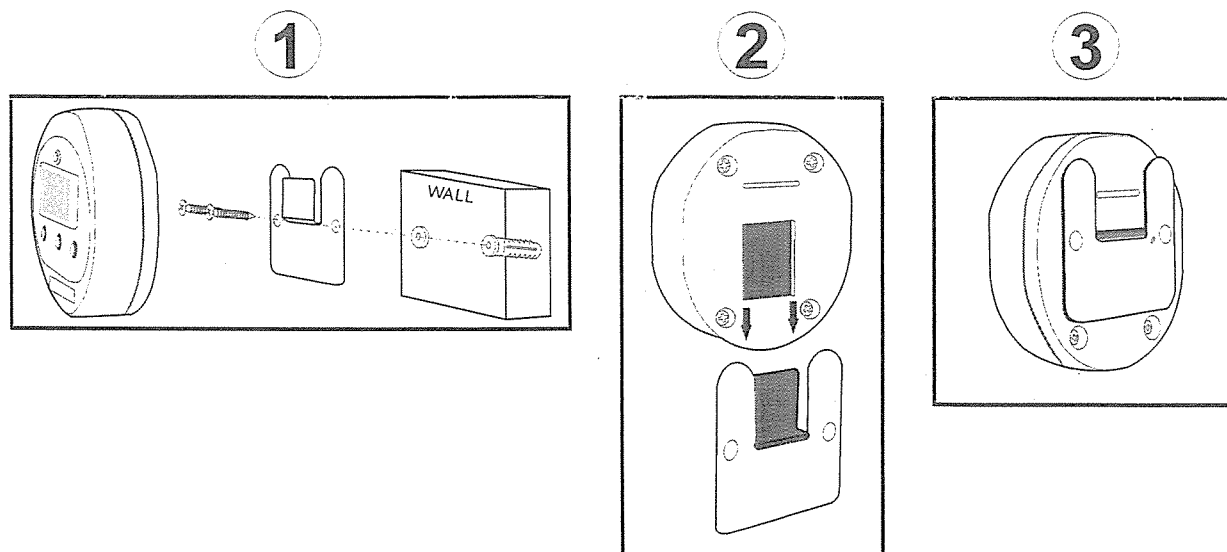

# Trouble Shooting Guide

1. Please check that the speaker is switched to the "Chime" or "Alarm" position. (Off=Silent)

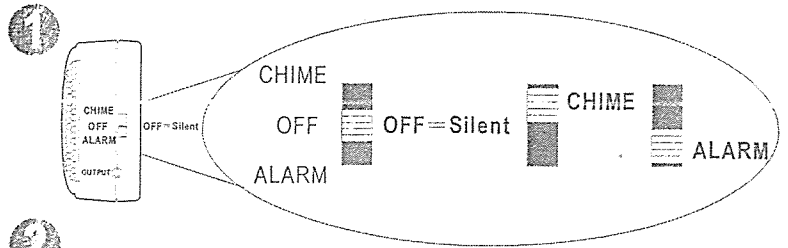

2. Please check that the timer and volume potentiometers are NOT in their min. Position.

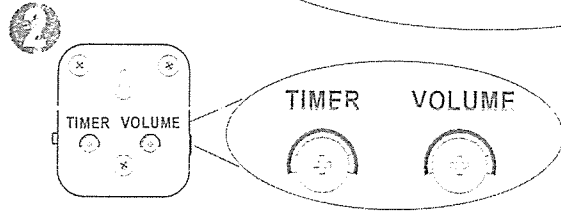

3. The red LED will illuminate when the beam is properly aligned, if the LED is not on please realign the beam.



4. The reflector should be mounted a minimum of 50 cm from the sensor otherwise it will be impossible to align the beam properly.

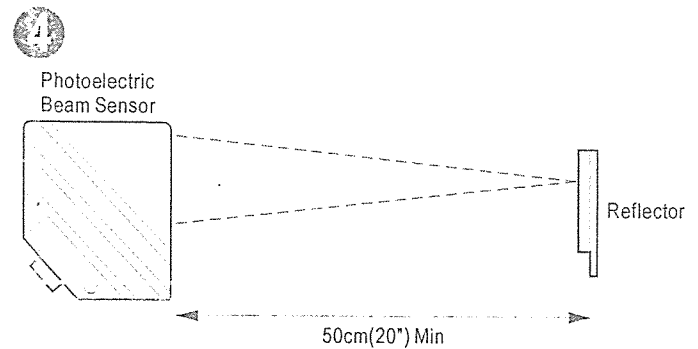

5. Make sure the plug of AC/DC adaptor is inserted into the DC9~15V socket of the speaker

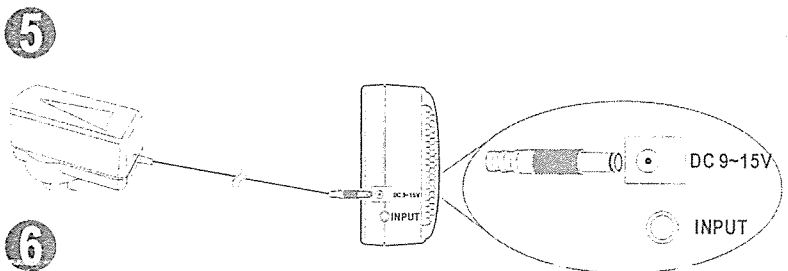

6. Make sure the infrared sensor is plugged into the "INPUT" of the speaker and not the "OUTPUT"

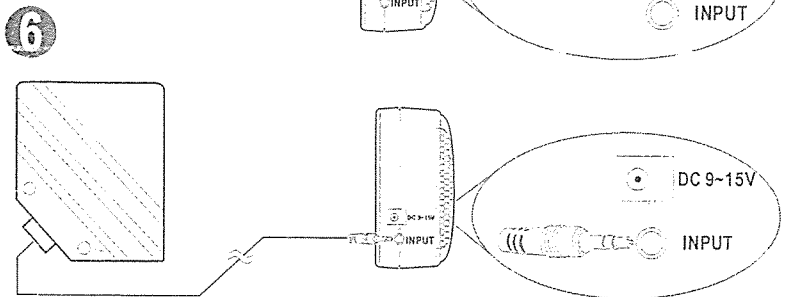

7. If you have purchased the 4 digits counter (optional), it should be connected to the "OUTPUT" of the speaker via the included 10 m cable

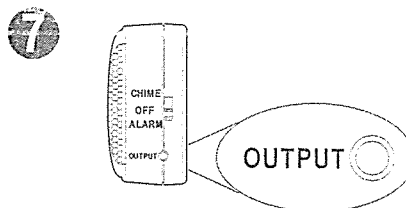

8. Please use the attached screwdriver in the inner box, Don't use any other size.

