

Catalogue number: **LSBS□P□□-□**

Miniature Circuit Breaker 1-63A C,D curve 10kA



Miniature circuit breaker

- Overload and short circuit protection
- 18mm Pitch
- Easy Mounting on 35mm DIN rail
- 1 Pole, 2 Pole & 3 Pole
- Breaking Capacity 10kA
- C, D curve option
- Thermal Magnetic release
- Standards: Conforming to AS/NZS 60895.1
- Approval: RCM, RoHS

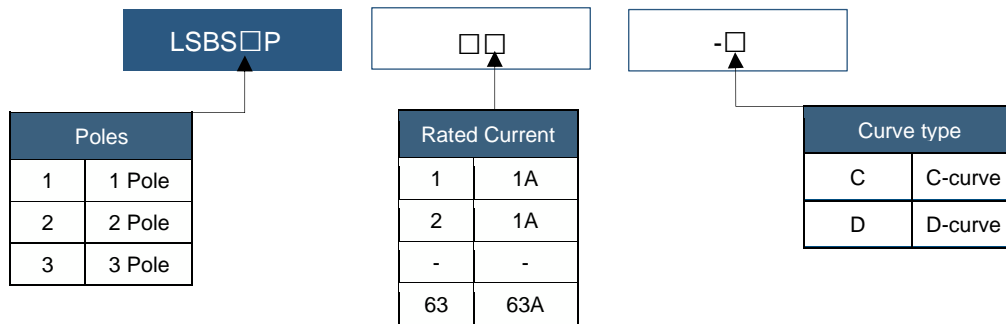

Technical Data

Characteristics	
Product Range	Eureka Miniature Circuit Breaker
Protection	Overload and short circuit
Number of poles	1P, 2P, 3P
Rated Current (A)	1, 2, 3, 4, 6, 10, 16, 20, 25, 32, 40, 50, 63
Rated Voltage	1 Pole: 230/240VAC 50/60Hz 2,3,4 Pole: 400/415VAC 50/60Hz
Characteristic	C, D curve
Breaking Capacity	10kA
Rated Impulse Withstand Voltage	4kV
Type of trip	Thermal magnetic release
Terminal	Pillar
Terminal capacity	Cables up to 25mm <sup>2</sup>
Installation	Mounting on 35mm DIN rail
Width	17.8mm per pole
Endurance Electrical	10,000 operations
Endurance Mechanical	20,000 operations
IP degree	IP20
Standard	Conforming to AS/NZS 60895.1



Catalogue number: **LSBS□P□□-□**

Miniature Circuit Breaker 1-63A C,D curve 10kA



### Characteristic Curve

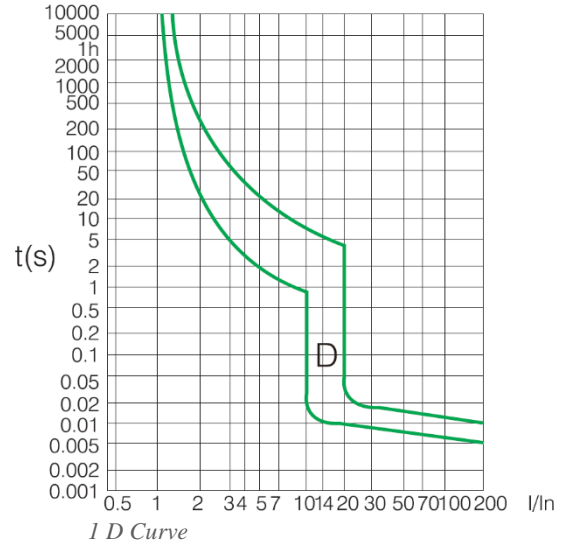
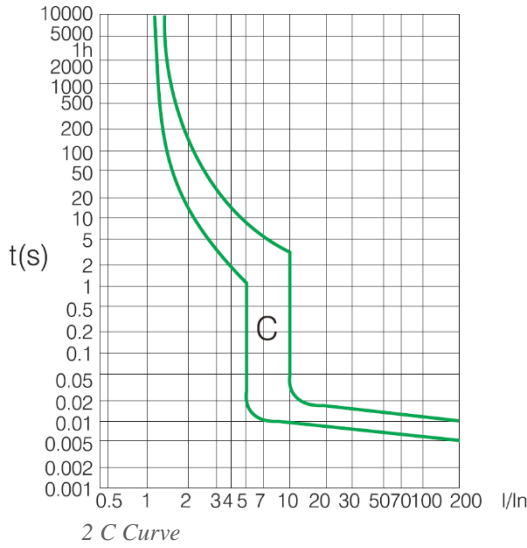

### Temperature Compensation Table

In(A)	-40	-30	-20	-10	0	10	20	30	40	50	60
1	1.22	0.20	1.18	1.15	1.12	1.09	1.05	1.00	0.94	0.88	0.82
2	2.44	2.40	2.36	2.30	2.24	2.18	2.10	2.00	1.88	1.77	1.65
4	4.88	4.80	4.72	4.61	4.49	4.36	4.20	4.00	3.77	3.55	3.29
6	7.32	7.20	7.09	6.91	6.73	6.54	6.31	6.00	5.66	5.33	4.94
10	12.20	12.00	11.80	11.50	11.20	10.90	10.50	10.00	9.40	8.89	8.23
16	19.50	19.20	18.90	18.40	17.90	17.40	16.80	16.00	15.10	14.20	13.20
20	24.40	24.00	23.60	23.00	22.40	21.80	21.00	21.00	18.80	17.70	16.50
25	30.50	30.00	2.50	28.80	28.00	27.20	26.30	25.00	23.60	22.20	20.60
32	39.00	38.40	37.80	36.90	35.90	34.90	33.60	32.00	30.20	28.40	26.30
40	48.80	48.00	47.80	46.10	44.90	43.60	42.00	40.00	37.70	35.50	32.90
50	61.00	60.00	59.10	57.60	56.10	54.50	52.60	50.00	47.20	44.40	41.20
63	76.90	75.60	74.40	72.60	70.70	68.70	66.20	63.00	59.40	56.00	51.90

### Short-Circuit Let-through current I<sup>2</sup>t (kA<sup>2</sup>s)

C-Curve

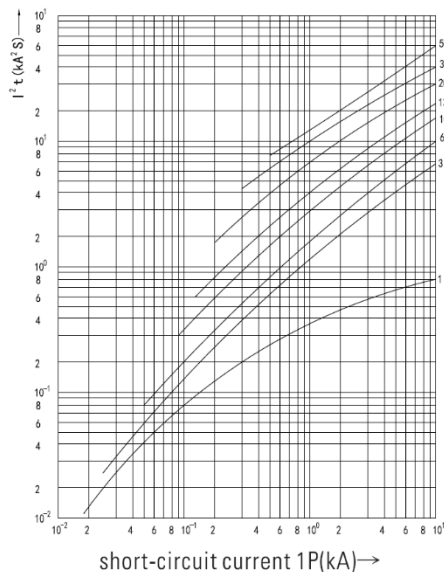

D-Curve

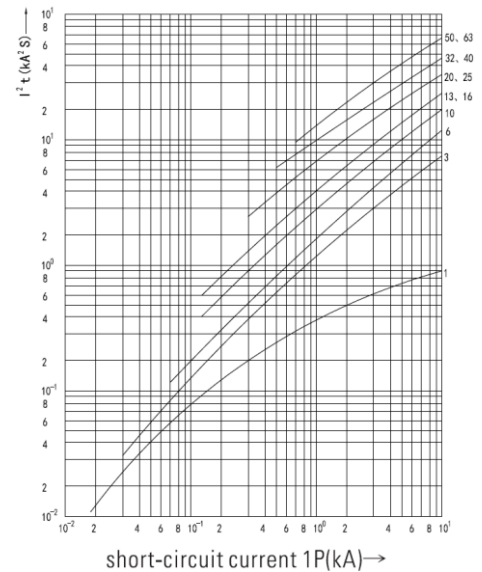

Catalogue number: **LSBS□P□□-□**

Miniature Circuit Breaker 1-63A C,D curve 10kA



## Dimensions

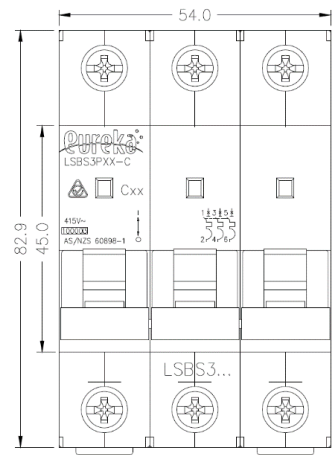
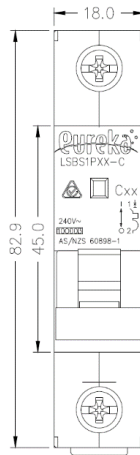
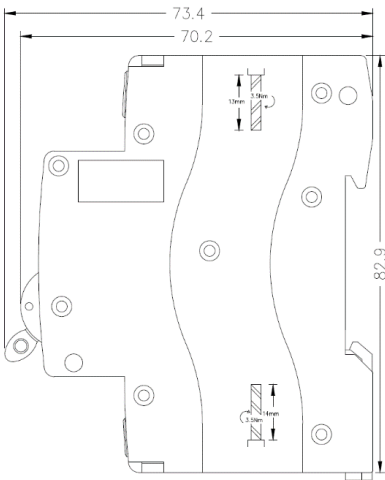

## Accessories

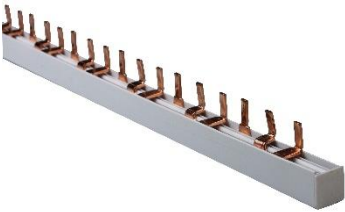

**BB101**  
1m length commoning bar 1 phase



**BB301**  
1m length commoning bar 3 phase

**MCBLDOG**  
Lock dog to suit all miniature circuit breaker



**EUR-PF6**  
6 Pole pole filler

**\*\*All accessories must be ordered separately; they do not come with the product.**

Catalogue number: **LSBE□P□□-□**

Miniature Circuit Breaker 1-63A C,D curve 6kA



## Auxiliaries

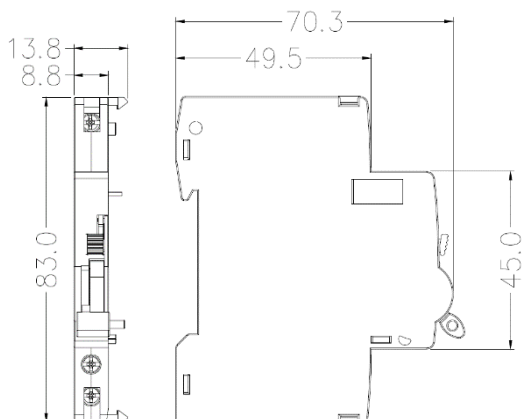

### LS-AX-6A Auxiliary Contacts

Characteristics	
Rated Current	6A (240VAC)
Terminal	0.5-4mm <sup>2</sup>
Dielectric strength:	2000V/1 min
Electro-mechanical Endurance	5000 Operations

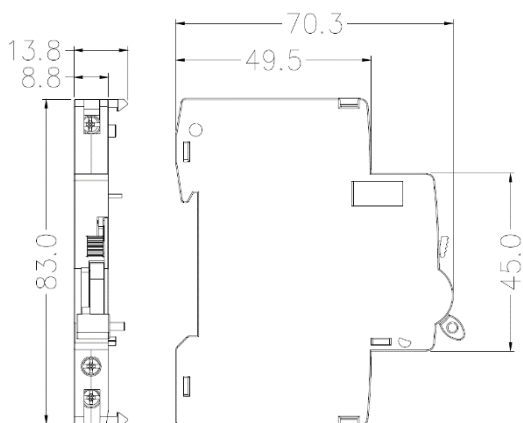

### LS-AL-6A Alarm Switch

Characteristics	
Rated Current	6A (240VAC)
Rated Voltage	230V
Voltage operation range	70-100%Us
Dielectric Strength	2000V/1 min
Rated insulation Voltage (Ui)	500V
Electro-mechanical Endurance	4000 Operations

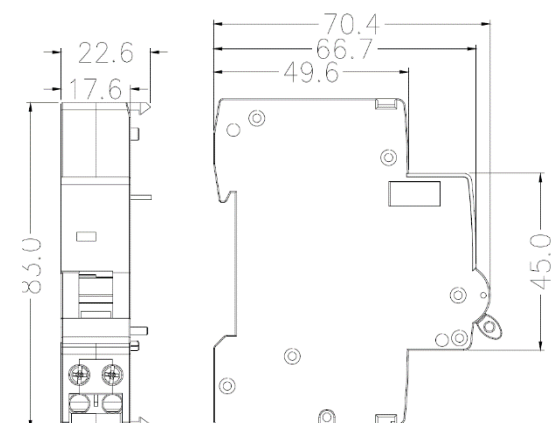

### LS-ST

Characteristics	
Nominal Voltage (Us):	110-415 VAC
Max. Inrush Current	In= 6A (230VAC)
Dielectric Strength:	2000V/1min
Electro-mechanical Endurance	4000 Operations
Release Range	1000-415 VAC

**\*\*All Auxiliaries must be ordered separately; they do not come with the product.**