



Current induction switch

- Passive self-power supply technology
- Switch output for detection, monitoring and protection
- The piercing hole is designed to allow current flow only from the same phase and in the same direction as load supply.
- Indicator Lights
- IP30

Properties

Parameters	EURG30NO	EURA200KNO
Trigger Current	0.2-30A 40~400Hz	0.5-200A, 40~400Hz
Start-up Time	within 0.1 seconds	within 0.1 seconds
Switch contact Capacity	MAX: 0.5A@240Vac/dc	MAX: 0.5A@240Vac/dc
Overload Capacity	+100% @ 30A	+100% @ 200A
Dimensions (H×W1/W2×T)	53×45/69×25mm	70×50/80×26mm
Piercing hole diameter	8mm	19.5mm
Indicator lights	Red & Green	Red & Green
Shell Material	Fireproof 94V-0	Fireproof 94V-0
Operating temperature	- 10 ~ 55 °C	- 10 ~ 55 °C
Storage temperature	- 20 ~ 65 °C	- 20 ~ 65 °C
Operating humidity	0 ~ 95%, no condensation	0 ~ 95%, no condensation
IP Level	IP30	IP30
DIN Rail Type	35mm	N/A

Dimensions

EURG30NO

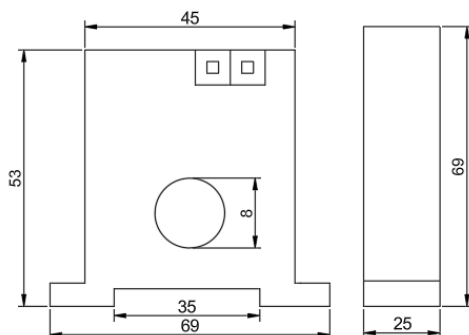

EURA200KNO

