

Catalogue number: **EUR-MDB**□□□□□□□□

Eureka MDB IP42/IP56 Distribution Board 750-1800mm



Eureka MDB IP42/IP56 Distribution board

- AS/NZS 61439-3
- Colour Options: N42 grey, X15 Orange
- Available in IP42/IP56
- Wide range of Enclosure heights
- Rigid Construction
- Complete with DIN rail, mounting brackets & Escutcheon
- Distribution board comes with MCCB or Switch Disconnecter as Main switch

EUR-MDB		□□□
No. of Pole		
12	12 Poles	
18	18 Poles	
24	24 Poles	
30	30 Poles	
36	36 Poles	
42	42 Poles	
48	48 Poles	
60	60 Poles	
72	72 Poles	
84	84 Poles	
96	96 Poles	
		IP42 Distribution board with 250A Non-auto Main Switch
		G N42 Grey
		OR X15 Orange
		IP42 Distribution board with 400A Non-auto Main Switch
		G4NA N42 Grey
		O4NA X15 Orange
		IP42 Distribution board with 250A MCCB
		G2MC N42 Grey
		O2MC X15 Orange
		IP42 Distribution board with 400A MCCB
		G4MC N42 Grey
		O4MC X15 Orange
		IP56 Distribution board with 250A Non-auto Main switch
		G/WP N42 Grey
		OR/WP X15 Orange
		IP56 Distribution board with 400A Non-auto Main Switch
		G4NAWP N42 Grey
		O4NAWP X15 Orange
		IP56 Distribution board with 250A MCCB
		G2MCWP N42 Grey
		O2MCWP X15 Orange
		IP56 Distribution board with 400A MCCB
		G4MCWP N42 Grey
		O4MCWP X15 Orange



Catalogue number: **EUR-MDB**□□□□□□□□



Eureka MDB IP42/IP56 Distribution Board 750-1800mm

## Properties

Properties																	
Manufacturer	Eureka																
Product Range	MDB IP42/IP56 Distribution Boards																
IP rating	<table border="0"> <tr> <td>EUR-MDB□□□□</td> <td>IP42</td> </tr> <tr> <td>EUR-MDB□□□□4NA</td> <td>IP42</td> </tr> <tr> <td>EUR-MDB□□□□2MC</td> <td>IP42</td> </tr> <tr> <td>EUR-MDB□□□□4MC</td> <td>IP42</td> </tr> <tr> <td>EUR-MDB□□□□/WP</td> <td>IP56</td> </tr> <tr> <td>EUR-MDB□□□□4NAWP</td> <td>IP56</td> </tr> <tr> <td>EUR-MDB□□□□2MCWP</td> <td>IP56</td> </tr> <tr> <td>EUR-MDB□□□□4MCWP</td> <td>IP56</td> </tr> </table>	EUR-MDB□□□□	IP42	EUR-MDB□□□□4NA	IP42	EUR-MDB□□□□2MC	IP42	EUR-MDB□□□□4MC	IP42	EUR-MDB□□□□/WP	IP56	EUR-MDB□□□□4NAWP	IP56	EUR-MDB□□□□2MCWP	IP56	EUR-MDB□□□□4MCWP	IP56
EUR-MDB□□□□	IP42																
EUR-MDB□□□□4NA	IP42																
EUR-MDB□□□□2MC	IP42																
EUR-MDB□□□□4MC	IP42																
EUR-MDB□□□□/WP	IP56																
EUR-MDB□□□□4NAWP	IP56																
EUR-MDB□□□□2MCWP	IP56																
EUR-MDB□□□□4MCWP	IP56																
Form Rating	Form 1																
Color Options	N42 Grey, X15 Orange																
Enclosure Material	<table border="0"> <tr> <td>IP42 Enclosures</td> <td>Mild Steel</td> </tr> <tr> <td>IP56 Enclosures</td> <td>Zincseal</td> </tr> </table>	IP42 Enclosures	Mild Steel	IP56 Enclosures	Zincseal												
IP42 Enclosures	Mild Steel																
IP56 Enclosures	Zincseal																
Enclosure Thickness	1.6mm																
Earthing	Easy Earthing																
Escutcheon	Hinged removable Escutcheon made from 1.2mm Mild Steel																
Width	600mm																
Depth	230mm																
Cable Entry	Top or Bottom 1.6mm Mild Steel Gland Plate (Customer to Drill)																
Main Switch	<table border="0"> <tr> <td>EUR-3-250: 3 Pole 250A Non Auto Main Switch</td> </tr> <tr> <td>TS250NETS250: 3 Pole 250A Electronic MCCB</td> </tr> <tr> <td>TS400DSU400: 3 Pole 400A Non-auto MCCB</td> </tr> <tr> <td>TS400NETS400: 3 Pole 400A Electronic MCCB</td> </tr> </table>	EUR-3-250: 3 Pole 250A Non Auto Main Switch	TS250NETS250: 3 Pole 250A Electronic MCCB	TS400DSU400: 3 Pole 400A Non-auto MCCB	TS400NETS400: 3 Pole 400A Electronic MCCB												
EUR-3-250: 3 Pole 250A Non Auto Main Switch																	
TS250NETS250: 3 Pole 250A Electronic MCCB																	
TS400DSU400: 3 Pole 400A Non-auto MCCB																	
TS400NETS400: 3 Pole 400A Electronic MCCB																	
Chassis	<table border="0"> <tr> <td>250A encapsulated 18mm pitch chassis 25kA @ 0.1 sec</td> </tr> <tr> <td>400A encapsulated 18mm pitch chassis 30kA @ 0.1 sec</td> </tr> </table>	250A encapsulated 18mm pitch chassis 25kA @ 0.1 sec	400A encapsulated 18mm pitch chassis 30kA @ 0.1 sec														
250A encapsulated 18mm pitch chassis 25kA @ 0.1 sec																	
400A encapsulated 18mm pitch chassis 30kA @ 0.1 sec																	
Earth and Neutral Bars	<table border="0"> <tr> <td>250A Earth and Neutral bars</td> </tr> <tr> <td>400A Earth and Neutral bars</td> </tr> </table>	250A Earth and Neutral bars	400A Earth and Neutral bars														
250A Earth and Neutral bars																	
400A Earth and Neutral bars																	
DIN Module space	DIN space available next to the main switch																
Compatible Breakers	Suits the Eureka range of Miniature Circuit Breakers and RCBO's																
Door	Lockable door, can be made left or right hand hinged in the field																
Labels	Circuit identification labels and legend card holders supplied																



Catalogue number: **EUR-MDB**□□□□□□□□

Eureka MDB IP42/IP56 Distribution Board 750-1800mm



### Overall Dimensions for IP42 Distribution board with 250A Non-auto Main Switch

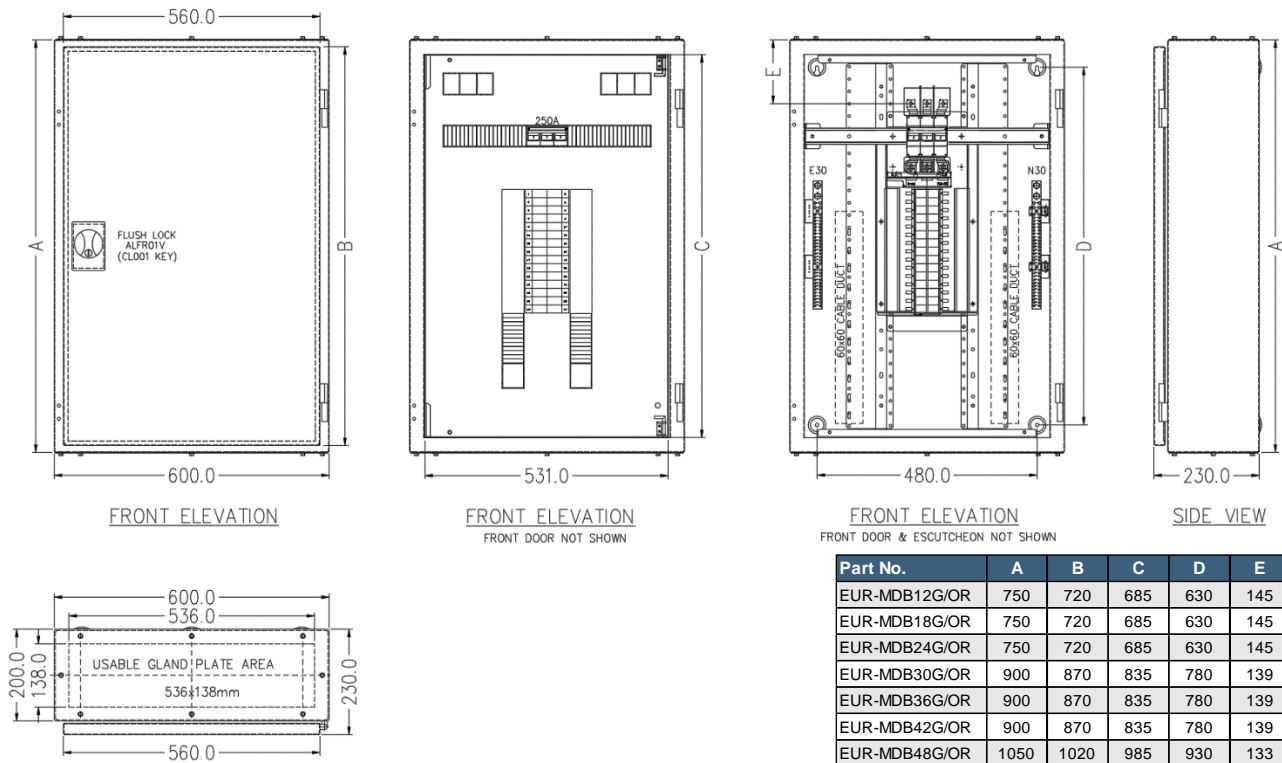

Part No.	A	B	C	D	E
EUR-MDB12G/OR	750	720	685	630	145
EUR-MDB18G/OR	750	720	685	630	145
EUR-MDB24G/OR	750	720	685	630	145
EUR-MDB30G/OR	900	870	835	780	139
EUR-MDB36G/OR	900	870	835	780	139
EUR-MDB42G/OR	900	870	835	780	139
EUR-MDB48G/OR	1050	1020	985	930	133
EUR-MDB60G/OR	1050	1020	985	930	133
EUR-MDB72G/OR	1200	1170	1135	1080	127
EUR-MDB84G/OR	1500	1470	1435	1380	142
EUR-MDB96G/OR	1500	1470	1435	1380	142

### Overall Dimensions for IP42 Distribution board with 250A MCCB Main switch

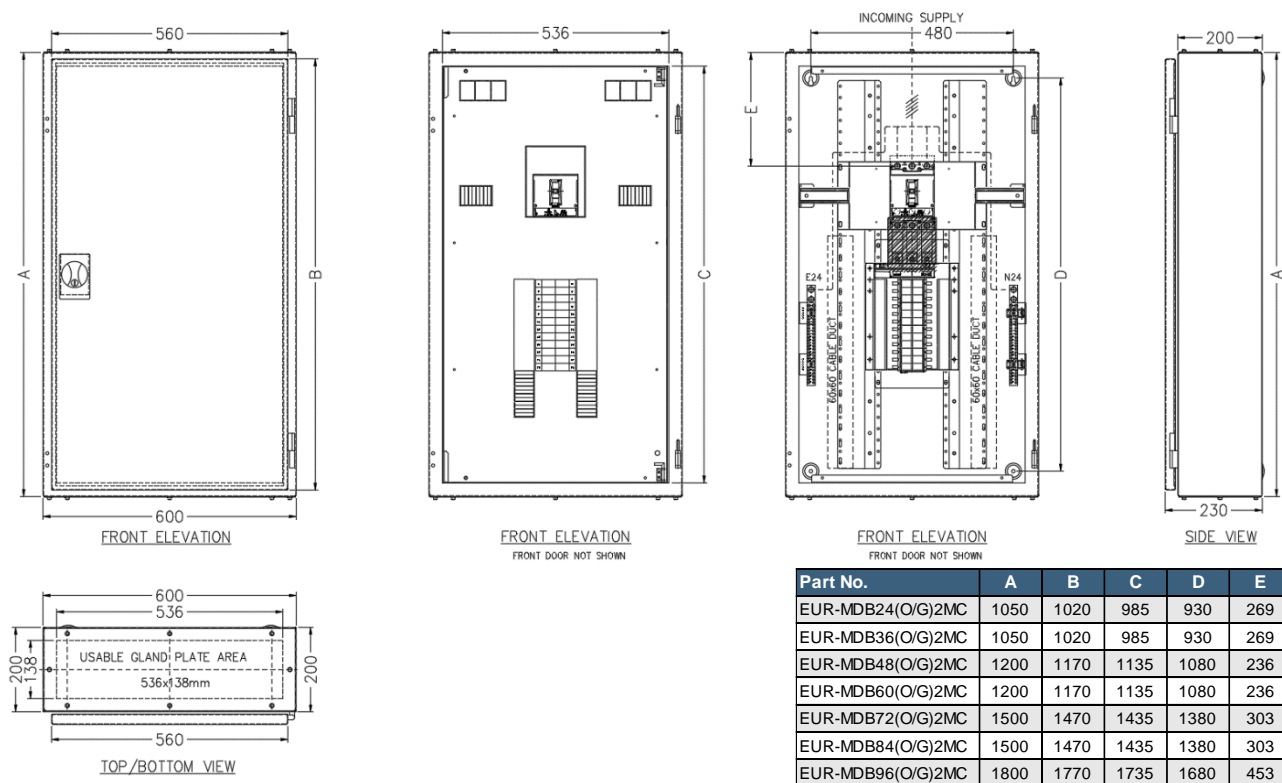

Part No.	A	B	C	D	E
EUR-MDB24(O/G)2MC	1050	1020	985	930	269
EUR-MDB36(O/G)2MC	1050	1020	985	930	269
EUR-MDB48(O/G)2MC	1200	1170	1135	1080	236
EUR-MDB60(O/G)2MC	1200	1170	1135	1080	236
EUR-MDB72(O/G)2MC	1500	1470	1435	1380	303
EUR-MDB84(O/G)2MC	1500	1470	1435	1380	303
EUR-MDB96(O/G)2MC	1800	1770	1735	1680	453



N.A.W. Controls Pty. Ltd.  
 Telephone: (03) 9464 6555  
[www.nawcontrols.com.au](http://www.nawcontrols.com.au)

Eureka MDB DB range  
 April 2021

### Overall Dimensions for IP42 Distribution board with 400A Non-auto/400A MCCB Main Switch

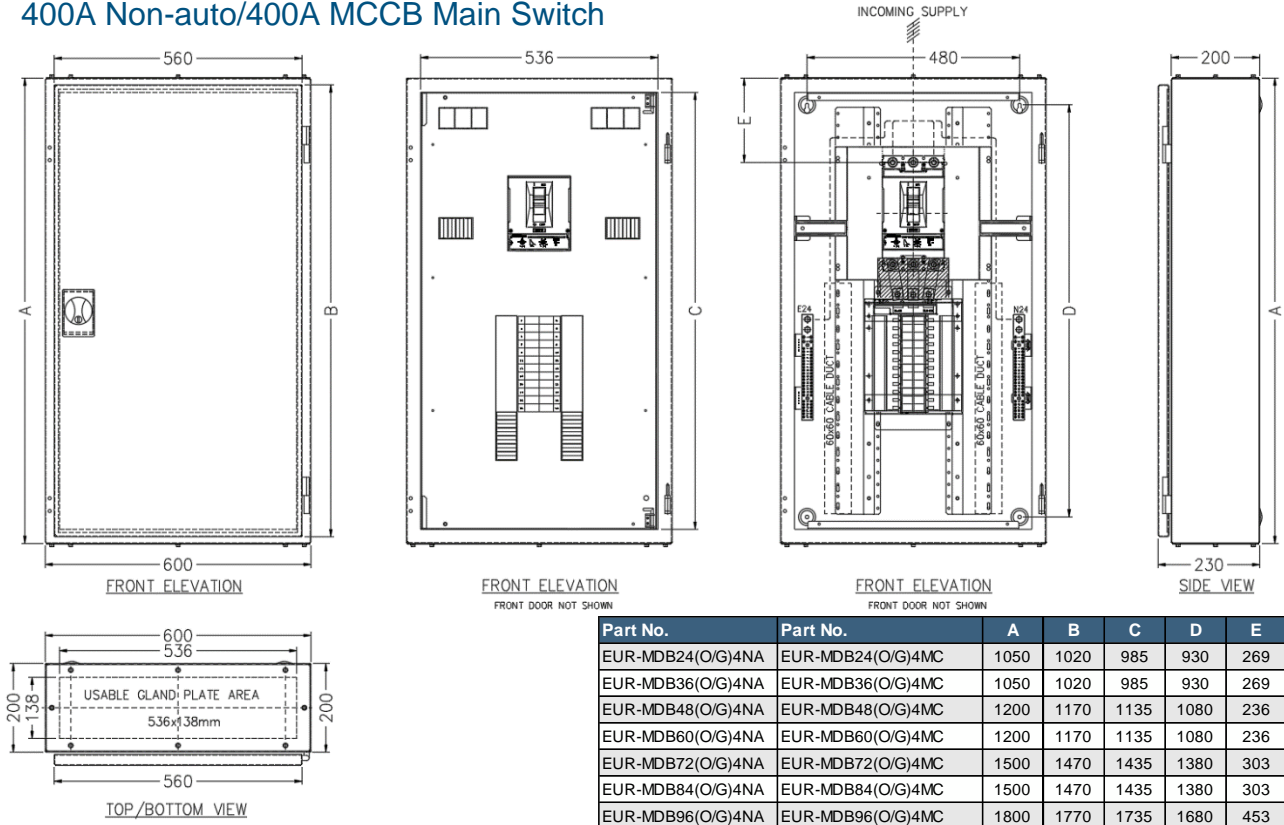

### Overall Dimensions for IP56 Distribution board with 250A Non-auto Main Switch

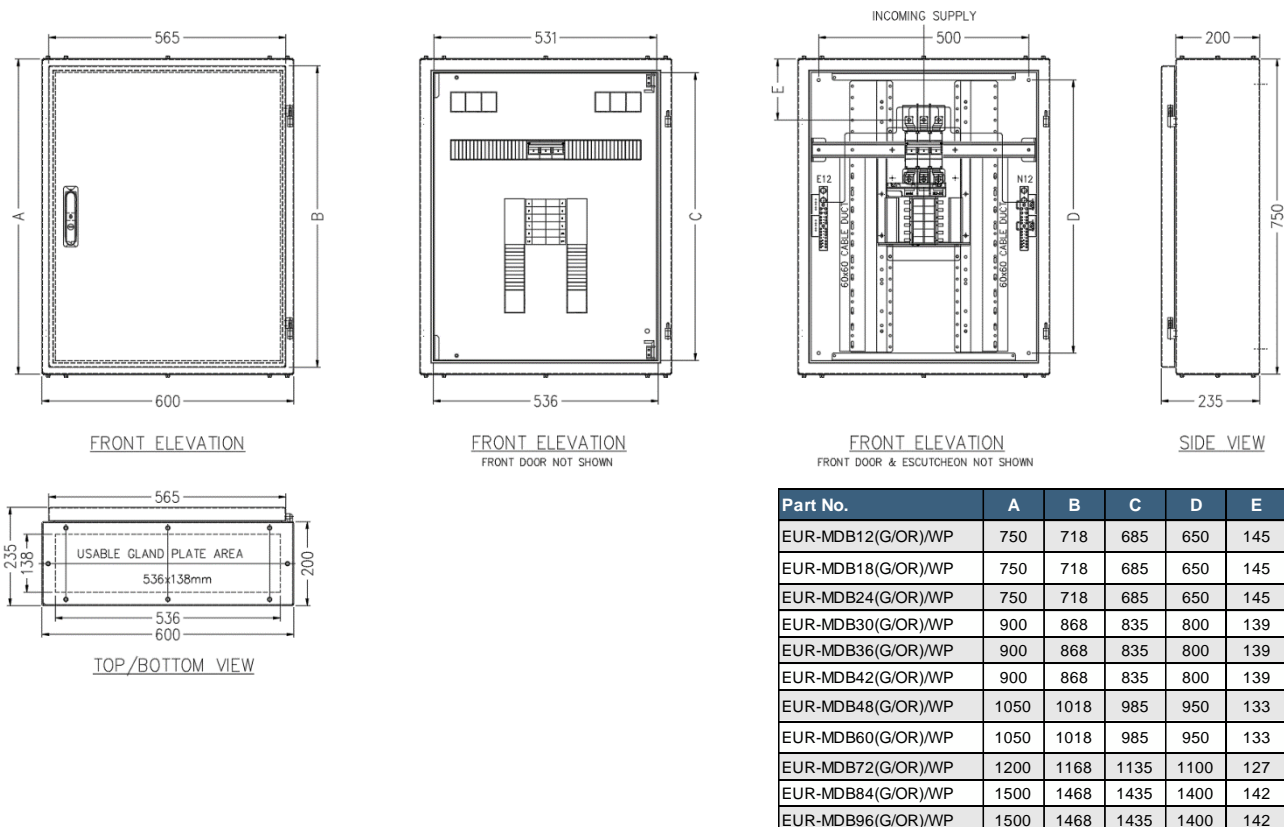

### Overall Dimensions for IP56 Distribution board with 250A MCCB Main Switch

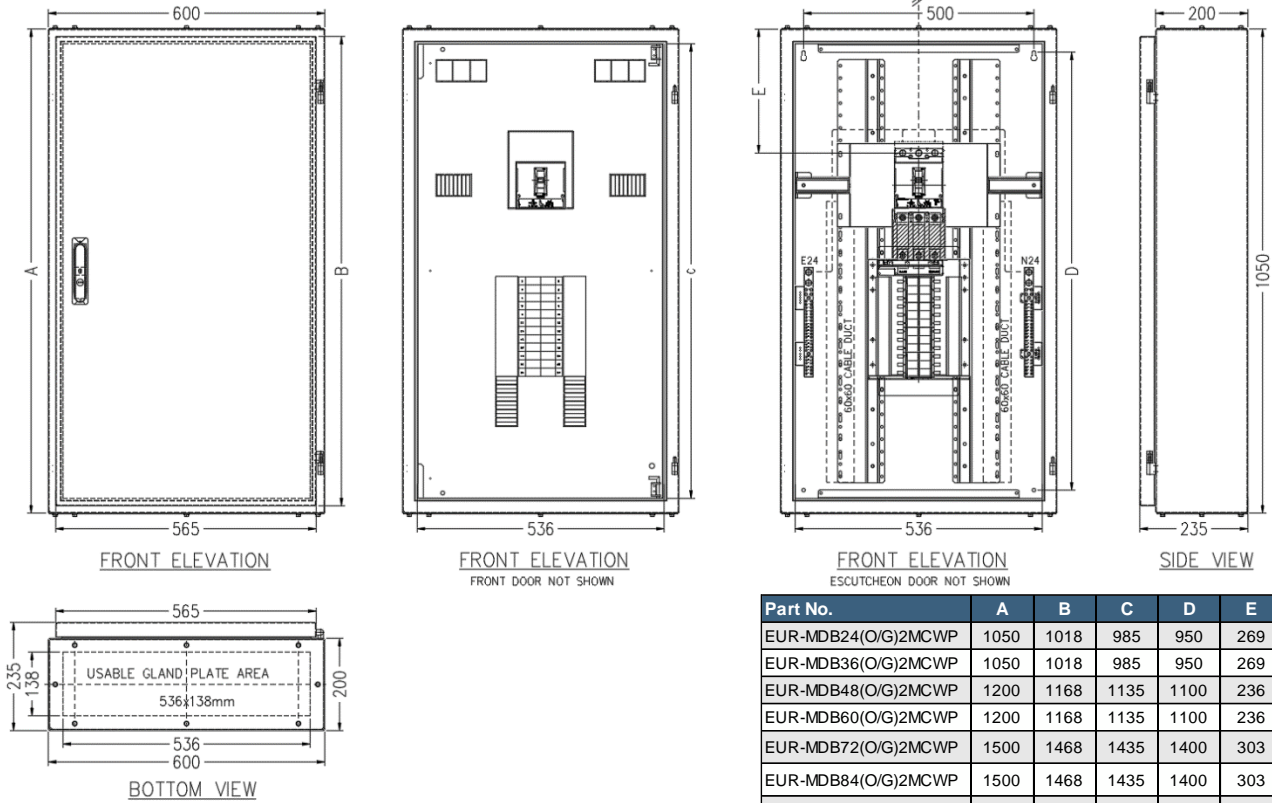

### Overall Dimensions for IP56 Distribution board with 400A Non-auto/400A MCCB Main Switch

