

BC- SP- M | NYLON SCREW PLUG

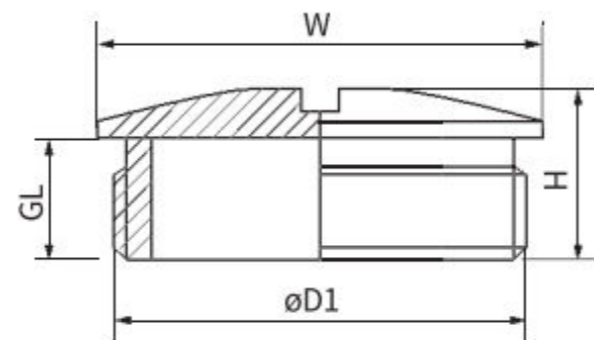

FEATURE | 특성 | 特征

- Material / 재질 / 材质 | PA
- Color / 색상 / 颜色 | Grey

Model No.	Thread	H (mm)	GL (mm)	Wrench (mm)	AG (mm)
BC- SP- M12	M12	12	9	16	12
BC- SP- M16	M16	12	9	20	16
BC- SP- M18	M18	13	9	22	17.7
BC- SP- M20	M20	14.5	11	25	20
BC- SP- M22	M22	15	10.5	27	21.5
BC- SP- M24	M24	14.5	11	30	24
BC- SP- M25	M25	14.5	11	30	25
BC- SP- M27	M27	15.5	10.5	33	27
BC- SP- M32	M32	15	11	38	32
BC- SP- M40	M40	16	12	46	40
BC- SP- M50	M50	18	13.5	56	49.8
BC- SP- M63	M63	17	12	69	63