

9000 SERIES LARGE FRAME SPRING REELS

APPLICATION

The 9000 Series base design offers stability in any application. The range is suitable for high volume air, water, fuel and petroleum applications. The unique footed design makes the 9000 Series ideal for service vehicles, permanent service or plant work areas. With reels to suit low pressures (air and water), medium pressures (air, water and oil) and high pressures (grease), the 9000 Series is an ideal solution for workshop or service truck hose management.

- HOSE TYPE** Supplied with or without hose
- MEDIA** Air, water, oil, grease (refer to table below)
- CONSTRUCTION MATERIAL** Steel
- FINISH** Powder Coated
- FITTING TYPE** NPT
- FEATURES**



D9300 OLPBW
SHOWN WITH HOSE

DIMENSIONS

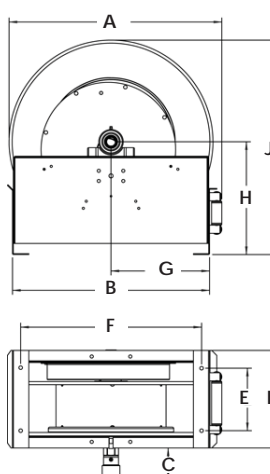

| | 9000 | FF9000 |
|---|------|--------|
| A | 667 | 667 |
| B | 613 | 613 |
| C | 121 | 98 |
| D | 305 | 449 |
| E | 195 | 341 |
| F | 556 | 556 |
| G | 311 | 311 |
| H | 352 | 352 |
| J | 670 | 670 |

9000 SERIES LOW PRESSURE AIR & WATER

| Model | Hose ID Capacity (mm) | Hose Length Capacity (m) | Max PSI | Inlet fitting | Outlet fitting | Weight (kg) |
|--------------------|-----------------------|--------------------------|---------|---------------|----------------|-------------|
| D9200 OLP BW 106 | 12 | 31 | 500 | 1/2" | 1/2" | 52 |
| D9300 OLP BW 106 | 19 | 15 | 500 | 3/4" | 3/4" | 52 |
| D9305 OLP BW 106 | 19 | 31 | 500 | 3/4" | 3/4" | 52 |
| D9400 OLP BW 106 | 25 | 15 | 500 | 1" | 1" | 52 |
| D9700 OLP BW 106 | 19 | 30 | 500 | 3/4" | 3/4" | 64 |
| D9800 OLP BW 106 | 25 | 30 | 500 | 1" | 1" | 64 |
| FF9500 OLP BW 106* | 32 | 15 | 600 | 1 1/4" | 1 1/4" | 57 |
| FF9600 OLP BW 106* | 38 | 15 | 600 | 1 1/2" | 1 1/2" | 57 |

9000 SERIES MEDIUM PRESSURE OIL

| | | | | | | |
|------------------|----|----|------|------|------|----|
| D9200 OMP BW 106 | 12 | 23 | 3000 | 1/2" | 1/2" | 52 |
| D9300 OMP BW 106 | 19 | 15 | 3000 | 3/4" | 3/4" | 52 |

9000 SERIES HIGH PRESSURE GREASE

| | | | | | | |
|------------------|----|----|------|------|------|----|
| D9100 OHP BW 106 | 10 | 23 | 5000 | 3/8" | 1/2" | 52 |
|------------------|----|----|------|------|------|----|