

# Velocity® Series Small Rose Door Handles



The Velocity 55mm Series is a stylish range of door furniture suitable for both residential and semi commercial applications. Designed primarily for new installation on timber doors, the range incorporates functionality for use with Mortice Locks in addition to Passage, Privacy and Dummy Levers.

## Installation

Suits door preparations up to 45mm.

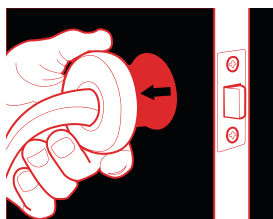

1 **Align**    2 **Twist**    3 **Tighten**



## Features and Specifications

- All fixings are concealed beneath a removable rose trim providing an aesthetically appealing installation.
- Simple twist and tighten fixing method and pre-assembled lever sets allow for super easy and fast installation.
- Lever range includes two AS1428.1 compliant levers and six designer levers.
- Accessories include AS1428.1 compliant turn, standard turn and privacy indicating emergency turns.
- The 55mm rose suits up to 45mm door preparations commonly used with mortice locks or latches.
- Designed in Australia for the specific needs of the Australian market.

## Product Details

<b>Rose Dimensions</b>	55mm by 12.5mm - Round Rose 58mm by 12.5mm - Square Rose
<b>Materials</b>	All Velocity 55mm levers and roses are made from solid zinc die-cast.
<b>Latches</b>	Passage sets are available with a 60mm backset tubular latch. Privacy sets are supplied with a 60mm backset privacy latch which includes a locking pin for the inside of the door and an external emergency release function. The latch is automatically released when the internal handle is operated and is easily adapted for both open in and open out applications. All latches are supplied with industry standard "D" strikes.
<b>Door Thickness</b>	32mm to 45mm hinged doors
<b>Finishes</b>	Satin Chrome Brushed (SC) Chrome Plate (CP) Satin Pearl (SP) Display Pack Range Only

## Standards and Compliance



Successfully tested up to 2 hours on fire door assemblies in accordance with the Australian Standard AS1905.1 2005 - Part 1: Fire Resistant Doorsets

**D8**

VEL Series lever sets have been successfully tested to conform with Level D8 (500,000 cycles) under Australian Standard AS4145.2-2008, Locksets and hardware for doors and windows.



VEL Series in brushed satin chrome finish has been successfully tested to conform with Level C10 (1000 hours) under Australian Standard AS4145.2-2008, Locksets and hardware for doors and windows.



AS1428.1 Compliance. The range includes AS1428.1 compliant levers and turns as shown.

# Velocity® Series Small Rose Door Handles

## AS1428.1 Compliant Levers

### Accession® - Lever 5

**Length** 121mm

**Projection** 56.5mm

**Finger Clearance** 38.4mm



Disabled Accessible  
AS1428.1

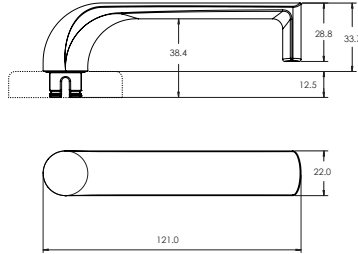

### Dianella™ - Lever 8

**Length** 121mm

**Projection** 51mm

**Finger Clearance** 38mm



Disabled Accessible  
AS1428.1

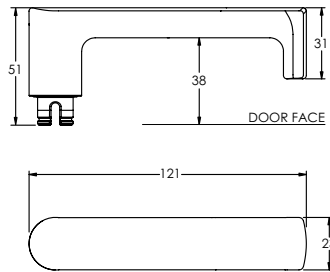

### Gidgee® - Lever 37

**Length** 120mm

**Projection** 64mm

**Finger Clearance** 38.5mm



Disabled Accessible  
AS1428.1

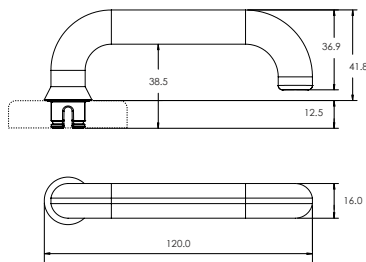

## Standard Levers

### Element™ - Lever 3

**Length** 122mm

**Projection** 54.5mm

**Finger Clearance** 47.5mm

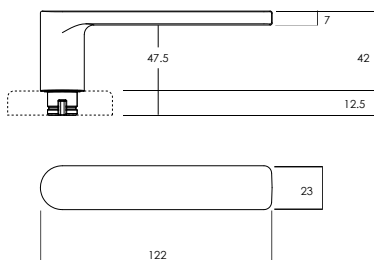

# Velocity® Series Small Rose Door Handles

## Standard Levers

### Hakea® - Lever 28

<b>Length</b>	121mm
<b>Projection</b>	63mm
<b>Finger Clearance</b>	43mm

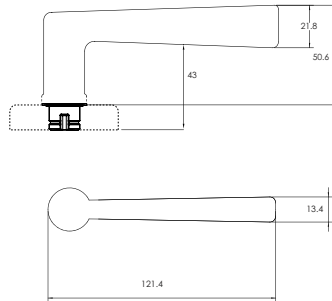

### Acacia® - Lever 29A

<b>Length</b>	120mm
<b>Projection</b>	64mm
<b>Finger Clearance</b>	41.5mm

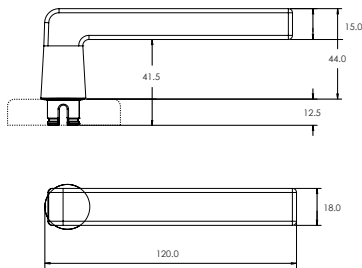

### Saltbush® - Lever 34

<b>Length</b>	120mm
<b>Projection</b>	64mm
<b>Finger Clearance</b>	43.5mm

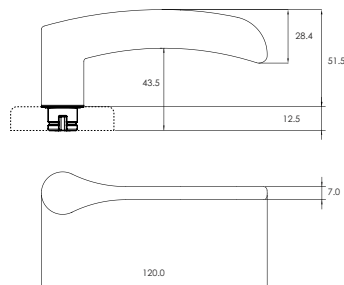

# Velocity® Series Small Round Rose Accessories

## Euro Cylinder Escutcheon

<b>Part Number</b>	VSR5
<b>Height</b>	55mm
<b>Depth</b>	12.5mm

**Supplied with**  
2x Wood Screws

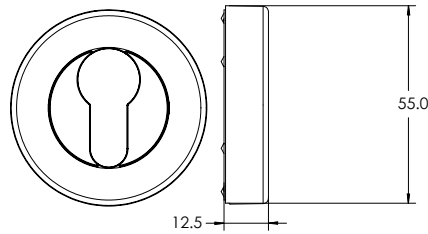

## Oval Cylinder Escutcheon

<b>Part Number</b>	VSR6
<b>Height</b>	55mm
<b>Depth</b>	12.5mm

**Supplied with**  
2x Wood Screws

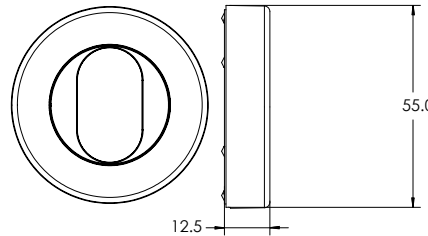

## Standard Turnknob

<b>Part Number</b>	VSR7
<b>Height</b>	55mm
<b>Depth</b>	12.5mm
<b>Handing</b>	Not required

**Supplied with**  
2x Wood Screws  
1x Short Tail Bar  
1x Medium Tail Bar  
1x Tail Bar Spring  
1x Instructions (1220-321)

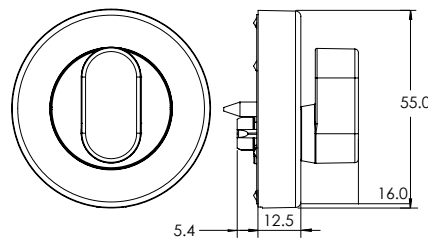

## Privacy Indicating Emergency Turn

<b>Part Number</b>	VSR8
<b>Height</b>	55mm
<b>Depth</b>	12.5mm

**Supplied with**  
2x Wood Screws  
1x Emergency Tail Bar  
1x Instructions (1220-321)

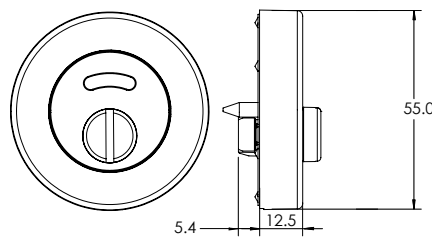

# Velocity® Series Small Round Rose Accessories

## Disabled Accessible Turnknob

<b>Part Number</b>	VSR9
<b>Height</b>	55mm
<b>Depth</b>	12.5mm
<b>Turn Snib Length</b>	52mm
<b>Handing</b>	Site handable

### Supplied with

- 2x Wood Screws
- 1x Tail Bar (short)
- 1x Tail Bar (medium)
- 1x Tail Bar Spring
- 1x Instructions (1220-321)

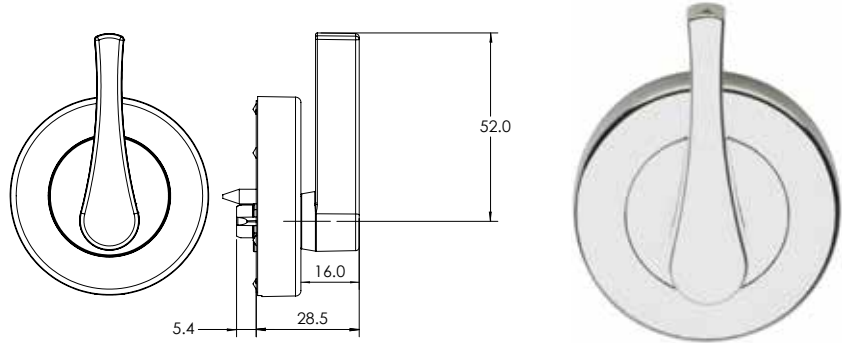

\*VSR9 is not compatible with Selector series mortice locks.

## Round Rose Passage Trim

<b>Part Number</b>	VSR1-TRIM
<b>Height</b>	55mm
<b>Depth</b>	12.5mm
<b>Quantity</b>	Pack of 2

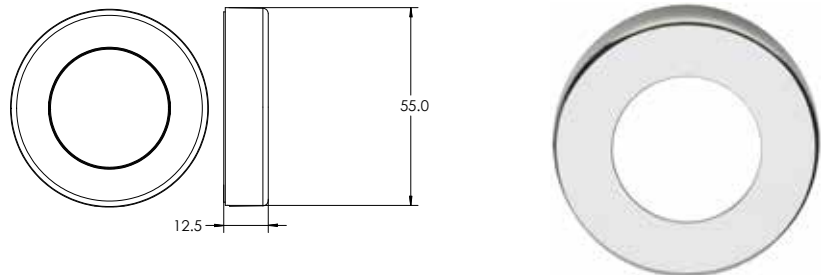

## Round Rose Privacy Trim

<b>Part Number</b>	VSR2-TRIM
<b>Height</b>	55mm
<b>Depth</b>	12.5mm
<b>Quantity</b>	Pack of 2

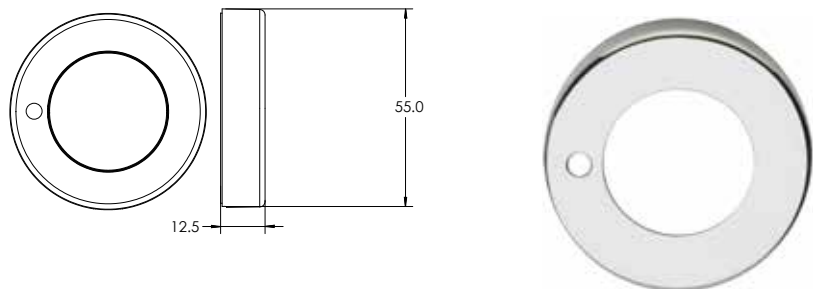

# Velocity® Series Small Square Rose Accessories

## Euro Cylinder Escutcheon

<b>Part Number</b>	VSS5
<b>Height</b>	58mm
<b>Depth</b>	12.5mm

**Supplied with**  
2x Wood Screws

**Note:** Please ensure clearance between lever trim and escutcheons when used with European Mortice Locks.

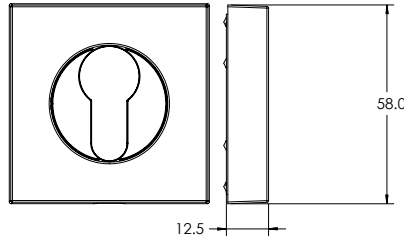

## Oval Cylinder Escutcheon

<b>Part Number</b>	VSS6
<b>Height</b>	58mm
<b>Depth</b>	12.5mm

**Supplied with**  
2x Wood Screws

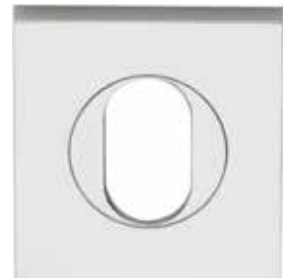
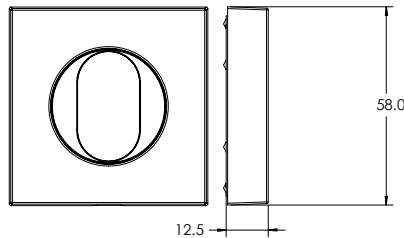

## Standard Turn Snib

<b>Part Number</b>	VSS7
<b>Height</b>	58mm
<b>Depth</b>	12.5mm
<b>Handing</b>	Not required

**Supplied with**  
2x Wood Screws  
1x Short Tail Bar  
1x Medium Tail Bar  
1x Tail Bar Spring  
1x Instructions (1220-321)

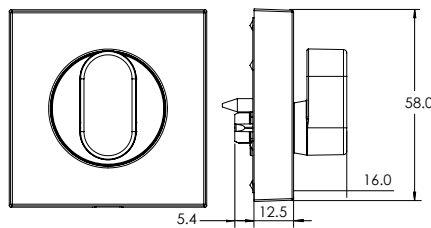

## Emergency Indicating Turn

<b>Part Number</b>	VSS8
<b>Height</b>	58mm
<b>Depth</b>	12.5mm
<b>Handing</b>	Not required

**Supplied with**  
2x Wood Screws  
1x Emergency Tail Bar  
1x Instructions (1220-321)

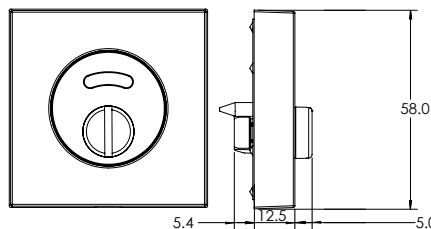

# Velocity® Series Small Square Rose Accessories

## Disabled Accessible Turn Snib

<b>Part Number</b>	VSS9
<b>Height</b>	58mm
<b>Depth</b>	12.5mm
<b>Turn Snib Length</b>	52mm
<b>Handing</b>	Site handable

### Supplied with

- 2x Wood Screws
- 1x Tail Bar (short)
- 1x Tail Bar (medium)
- 1x Tail Bar Spring
- 1x Instructions (1220-321)

\*VSS9 is not compatible with Selector series mortice locks.

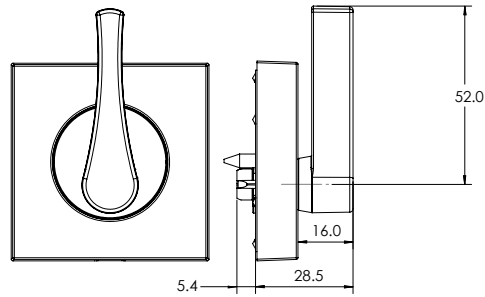

## Square Rose Passage Trim

<b>Part Number</b>	VSS1-TRIM
<b>Height</b>	58mm
<b>Depth</b>	12.5mm
<b>Quantity</b>	Pack of 2

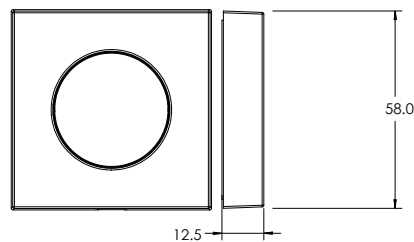

## Square Rose Privacy Trim

<b>Part Number</b>	VSS2-TRIM
<b>Height</b>	58mm
<b>Depth</b>	12.5mm
<b>Quantity</b>	Pack of 2

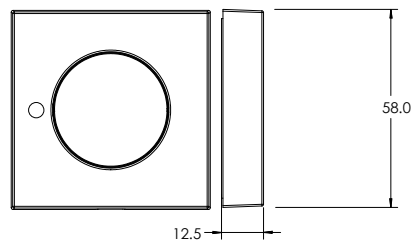

# Velocity® Series Rose Door Handles

Sample part number VSR1/L3SC is made up of several sections. Choose your product by selecting an option from each section.

## Velocity® Small Rose Series - Trade Pack Range

Exterior Rose	Function	Lever Types	Finish
VSR	1	L3	SC

Rose Type	Function	Levers	Finish	Packaging
Velocity 55mm Round Rose <span style="float: right;">VSR</span>	Mortice 0	Summit® L1	Satin Chrome Brushed SC	Trade Pack
Velocity 58mm Square Rose <span style="float: right;">VSS</span>	Passage 1	Element™ L3	Chrome Plate CP	
	Privacy 2	Glide™ L4	Matt Black MBK	
	Dummy Half 3	Hakea® 28		
	Euro Escutcheon 5	Acacia® 29A		
	Oval Escutcheon 6	Saltbush® 34		
	Standard Turnknob 7	<b>AS1428.1 Compliant Levers</b>		
	Privacy Indicating Emergency Turn 8	Accession® L5		
	Disabled Accessible Turnknob 9	Dianella™ L8		
		Gidgee® 37		

## Velocity® Small Rose Series - Display Pack Range

Rose Type	Function	Lever Types	Finish	Packaging
VSR	1	L3	SC	DP

Rose Type	Function	Levers	Finish	Packaging
Velocity 55mm Round Rose <span style="float: right;">VSR</span>	Passage 1	Summit® L1	Satin Chrome Pearl SP	Display DP
	Privacy 2	Spire® L2	Chrome Plate CP	
		Element™ L3	Satin Chrome Brushed SC	
		Glide™ L4		

### Square Rose Ordering Procedure

Function	Satin Chrome Finish	Chrome Plate Finish	Satin Pearl Finish	Matt Black Finish
Mortice Lever Set				
Passage Lever Set	VSS1-TRIMSC	VSS1-TRIMCP	VSS1-TRIMSP	VSS1-TRIMMBK
Dummy Half Set				
Privacy Lever Set	VSS2-TRIMSC	VSS2-TRIMCP	VSS2-TRIMSP	VSS2-TRIMMBK

Square Rose Lever Sets are ordered in the same manner as Round Rose Lever Sets above with the addition of a Square Rose Trim Pack. For example a Mortice Lever Set, Lever 5 in Satin Chrome will require both VSR0/L5SC and VSS1-TRIMSC.



# Metal Finishes

For Metal Finish sample refer to code under each image.



Antique Copper (AC)  
Sample Code: FIN-SAMPLEAC\*



Architectural Bronze Unlacquered (AU)  
Sample Code: FIN-SAMPLEAU\*



Oil Rubbed Bronze (ORB)  
Sample Code: FIN-SAMPLEORB\*



Aged Brass (AG)  
Sample Code: FIN-SAMPLEAG\*



Architectural Bronze (AZ)  
Sample Code: FIN-SAMPLEAZ\*\*



Polished Brass (PB)  
Sample Code: FIN-SAMPLEPB\*\*



Satin Brass (SB)  
Sample Code: FIN-SAMPLESB\*\*



Polished Brass Unlacquered (BU)  
Sample Code: FIN-SAMPLEBU\*



Satin Brass Unlacquered (SBU)  
Sample Code: FIN-SAMPLESBU\*



Satin Chrome Plating (SC)  
Sample Code: FIN-SAMPLESC



Chrome Plating (CP)  
Sample Code: FIN-SAMPLECP



Stainless Steel (SS)  
Sample Code: FIN-SAMPLESS



Polished Stainless Steel (PS)  
Sample Code: FIN-SAMPLEPS



Natural Anodized Aluminium (NT)  
Sample Code: FIN-SAMPLENT

**NOTE:** Not all decorative finishes apply to every Lockwood product. Refer to the table at the end of this document for specific decorative finishes applicable per series.

\*Unlacquered Metal Finish. This finish will naturally age and its appearance will change over time according to the environment and use it is exposed to. For more information on the aging effect of a particular finish contact your ASSA ABLOY representative.

\*\*Finish is protected by a top clear lacquer.

**Disclaimer:** Product Colours displayed in this catalogue have been matched to indoor viewing and colour appearance may vary according to light source and medium and as such should be used as indicative only. As actual colour on the end product may vary, always confirm your colour choice with production line prepared samples from your ASSA ABLOY representative for final colour approval. For warranty terms and conditions on Lockwood Products and its finishes, please visit [www.lockweb.com.au](http://www.lockweb.com.au) or call 1300WARRANTY

# Dulux Powdercoat Finishes

For Powdercoat Finish sample order code:

**FIN-SAMPLEPC** specify the desired color from the images below when placing order.



Dulux Duratec Eternity  
Eternity Charcoal Pearl  
Satin



Dulux Electro  
Black Ace  
Flat



Dulux Electro  
Dark Bronze  
Flat



Dulux Electro  
Medium Bronze  
Flat

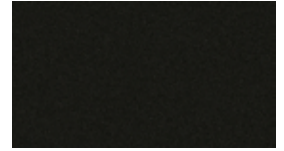

Dulux Precious  
Charcoal Metallic Pearl  
Gloss



Dulux Precious  
Citi Pearl  
Matt



Dulux Precious  
Natural Pearl  
Matt



Dulux Precious  
Nickel Pearl  
Matt



Dulux Precious  
Sharp Silver Kinetic® Pearl  
Satin



Dulux Precious  
Silver Kinetic® Pearl  
Satin

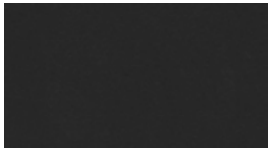

Dulux Surreal Effects Mannex  
Mannex Black  
Effect



Dulux Surreal Effects Scylla  
Red Brown Scylla  
Effect

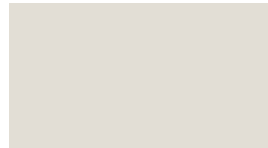

Dulux Duralloy  
Shoji White  
Satin

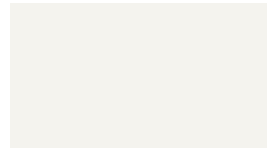

Dulux Alphatec  
White  
Matt

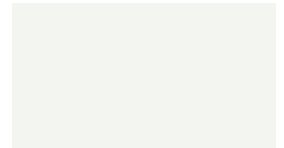

Dulux Duralloy  
White  
Satin



Dulux Duralloy  
Black  
Gloss



Dulux Duralloy  
Monument®  
Satin

CB

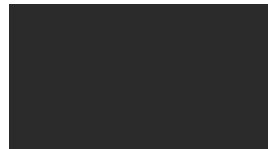

Dulux Duralloy  
Black (C/B Night Sky®)  
Satin

CB



Dulux Duralloy  
Dune®  
Satin

CB



Dulux Duralloy  
Woodland Grey®  
Satin

CB

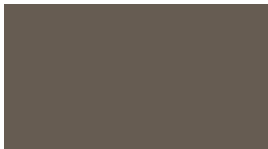

Dulux Duralloy  
Jasper®  
Satin

CB



Dulux Duralloy  
Monument®  
Matt

CB



Dulux Duralloy  
Deep Ocean®  
Satin

CB



Dulux Duralloy  
Woodland Grey®  
Matt

CB



Dulux Duralloy  
APO Grey  
Satin

**NOTE:** Not all Powdercoat Finishes apply to every Lockwood product. Refer to the notes at the end of this document for specific decorative finishes applicable per series.

**CB** Colorbond and the Colorbond colour names are registered trademarks of Bluescope Steel Limited



We recommend and use Dulux Powders

**Disclaimer:** Dulux, Duralloy, Anotec, Silver Kinetic, are registered trade marks of DuluxGroup (Australia) Pty Ltd. Monument, Night Sky, Dune, Woodland Grey, Jasper, Deep Ocean, Surfist, Pale Eucalypt, Paperbark, are registered trademarks of Bluescope Steel Limited. Product Colours displayed in this catalogue have been matched to indoor viewing and colour appearance may vary according to light source and medium and as such should be used as indicative only. As actual colour on the end product may vary, always confirm your colour choice with production line prepared samples from your ASSA ABLOY representative for final colour approval. For warranty terms and conditions on Lockwood Products and its finishes, please visit [www.lockweb.com.au](http://www.lockweb.com.au) or call 1300WARRANTY



# Dulux Powdercoat Finishes

For Powdercoat Finish sample order code:

**FIN-SAMPLEPC** specify the desired color from the images below when placing order.

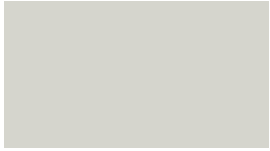

Dulux Duralloy  
Surfmist®  
Matt

CB

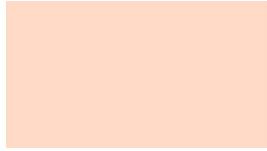

Dulux Duralloy  
Anotec® Off White  
Matt



Dulux Duralloy  
Anotec® Mid Bronze  
Matt



Dulux Duralloy  
Dune®  
Matt

CB

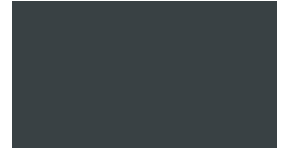

Dulux Duralloy  
Anotec® Dark Grey  
Matt

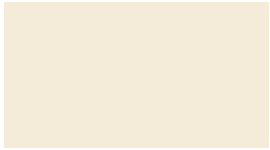

Dulux Duralloy  
White Birch  
Gloss



Dulux Duralloy  
Stone Beige  
Matt



Dulux Duralloy  
Notre Dame  
Gloss



Dulux Duralloy  
Pale Eucalypt®  
Satin

CB



Dulux Duralloy  
Magnolia  
Gloss



Dulux Duralloy  
Doeskin  
Satin



Dulux Duralloy  
Paperbark®  
Satin

CB



Dulux Duralloy  
Classic Hawthorn Green  
Gloss



Dulux Duralloy  
Primrose  
Gloss



Dulux Duralloy  
Black (C/B Night Sky®)  
Matt

CB

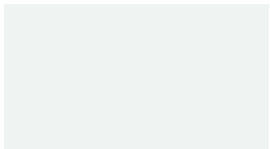

Dulux Duralloy  
Pearl White  
Gloss

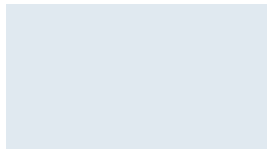

Dulux Duralloy  
Bright White  
Gloss

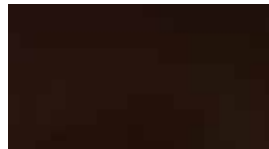

Dulux Precious  
Mahogany Gloss Pearl



Dulux Surreal Effects  
Black Gold  
Gloss



Dulux Duralloy  
Charcoal Lustre  
Matt

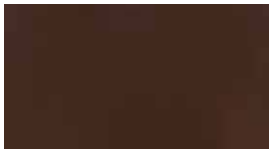

Dulux Alphatec  
Ranch Brown  
Satin

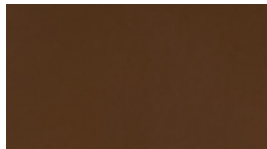

Dulux Duralloy  
Coffee  
Satin

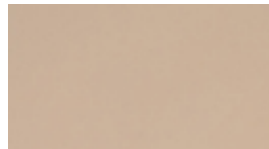

Dulux Duralloy  
Pottery  
Satin

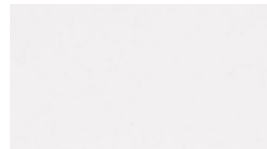

Dulux Duralloy  
White Lustre  
Matt

**NOTE:** Not all Powdercoat Finishes apply to every Lockwood product. Refer to the notes at the end of this document for specific decorative finishes applicable per series.

CB Colorbond and the Colorbond colour names are registered trademarks of Bluescope Steel Limited



We recommend and use Dulux Powders

**Disclaimer:** Dulux, Duralloy, Anotec, Silver Kinetic, are registered trade marks of DuluxGroup (Australia) Pty Ltd. Monument, Night Sky, Dune, Woodland Grey, Jasper, Deep Ocean, Surfist, Pale Eucalypt, Paperbark, are registered trademarks of Bluescope Steel Limited. Product Colours displayed in this catalogue have been matched to indoor viewing and colour appearance may vary according to light source and medium and as such should be used as indicative only. As actual colour on the end product may vary, always confirm your colour choice with production line prepared samples from your ASSA ABLOY representative for final colour approval. For warranty terms and conditions on Lockwood Products and its finishes, please visit [www.lockweb.com.au](http://www.lockweb.com.au) or call 1300WARRANTY

# Decorative Finishes Per Series

## Powdercoat Finishes

**Rose Door Handles:** Robert Watson, 1220, 1420, 1360, 1370, 260, 260SQ

**Plate Door Handles:** 1800, 2800, 4800, 5800, 200, 202, 212, 224

**Push/Pull Plates:** 218/219, 206/207, 208/209, 214/215, 216/217, 184, 185

## Metal Finishes

Use table below as a reference for the applicable finish to each Lockwood Series.

Refer to the series catalogue for specific detailed information.

Reference Table									
	Brass Series Rose Door Handles 1220, 1420, 1360, 1370	Brass Series Plate Door Handles 1800, 2800, 4800, 5800	Artefact Series Rose Door Handles 260	Artefact Series Rose Door Handles 260SQ	Artefact Series Plate Door Handles 200, 202,	Artefact Series Plate Door Handles 212, 224	Push/Pull Plate Series 184, 185	Push/Pull Plate Series 214/215, 216/217, 218/219	Push/Pull Plate Series 206/207, 208/209
Antique Copper (AC)	✓	✓	✓	✗	✓	✗	✓	✓	✗
Architectural Bronze Unlacquered (AU)	✓	✓	✓	✗	✓	✗	✓	✓	✗
Oil Rubbed Bronze (ORB)	✓	✓	✓	✗	✓	✗	✓	✓	✗
Aged Brass (AG)	✓	✓	✓	✗	✓	✗	✓	✓	✗
Architectural Bronze (AZ)	✓	✓	✓	✗	✓	✗	✓	✓	✗
Polished Brass (PB)	✓	✓	✓	✗	✓	✗	✓	✓	✗
Satin Brass (SB)	✓	✓	✓	✗	✓	✗	✓	✓	✗
Polished Brass Unlacquered (BU)	✓	✓	✓	✗	✓	✗	✓	✓	✗
Satin Brass Unlacquered (SBU)	✓	✓	✓	✗	✓	✗	✓	✓	✗
Satin Chrome Plating (SC)	✓	✓	✗	✗	✗	✗	✓	✗	✗
Chrome Plating (CP)	✓	✓	✗	✗	✗	✗	✓	✗	✗
Stainless Steel (SS)	✗	✗	✓	✓	✓	✓	✗	✓	✓
Polished Stainless Steel (PS)	✗	✗	✓	✗	✓	✓	✗	✓	✓
Marine Grade Stainless Steel (MG)	✗	✗	✓	✗	✓	✓	✗	✓	✓
Natural Anodised Aluminium (NT)	✗	✗	✓	✗	✓	✓	✗	✗	✗

**Disclaimer:** Product Colours displayed in this catalogue have been matched to indoor viewing and colour appearance may vary according to light source and medium and as such should be used as indicative only. As actual colour on the end product may vary, always confirm your colour choice with production line prepared samples from your ASSA ABLOY representative for final colour approval. For warranty terms and conditions on Lockwood Products and its finishes, please visit [www.lockweb.com.au](http://www.lockweb.com.au) or call 1300WARRANTY



**ASSA ABLOY**

**Lockwood** is the leading brand in the Australian locking industry. With an established reputation for high quality products, this iconic brand provides a wide range of locking solutions to residential housing, commercial, semi-commercial, building and industrial application markets. Lockwood is supported by an extensive distribution and after-sales support network. Our customers include retailers, architects, trade and industrial personnel, locksmiths and security dealers.

**ASSA ABLOY** is the global leader in door opening solutions, dedicated to satisfying end-user needs for security, safety and convenience.

**ASSA ABLOY** is represented in all major regions, in both mature and emerging markets, with leading positions in Australia, Europe and North America.

**25YEAR  
MECHANICAL  
WARRANTY**

### **The Lockwood 25 Year Mechanical Warranty**

Our belief that we manufacture the finest premium products available in today's market place is backed by the Lockwood 25 Year Mechanical Warranty, ensuring that Lockwood continues to keep Australians safe by delivering security and peace of mind.

For warranty terms and conditions, please visit [www.lockweb.com.au](http://www.lockweb.com.au) or call **1300WARRANTY**

**ASSA ABLOY Opening Solutions Australia**  
235 Huntingdale Road  
Oakleigh, Victoria, 3166  
Australia

**1300 LOCK UP (1300 562 587)**  
[lockweb.com.au](http://lockweb.com.au)

**ASSA ABLOY New Zealand Ltd**  
6 Armstrong Road  
Albany, Auckland, 0632  
New Zealand

[nzsales@assaabloy.com](mailto:nzsales@assaabloy.com)  
Telephone +64 9415 7111  
[assaabloyopeningsolutions.nz](http://assaabloyopeningsolutions.nz)

#### **Disclaimer**

Whilst every effort has been made to ensure that the information (including product images and drawings) contained in this brochure is accurate at the time of publication, ASSA ABLOY Australia Pty Limited ("ASSA ABLOY") recommends that you consult ASSA ABLOY or its agents prior to placing an order to ascertain current information on specific products, as ASSA ABLOY reserves the right to make changes without notice. ASSA ABLOY will not be liable for any injury, loss or damage whatsoever, arising from any errors or omissions in the information contained in the brochure or arising from the use or application of the information contained herein. © 2019 copyright by ASSA ABLOY All rights reserved

