

RP98

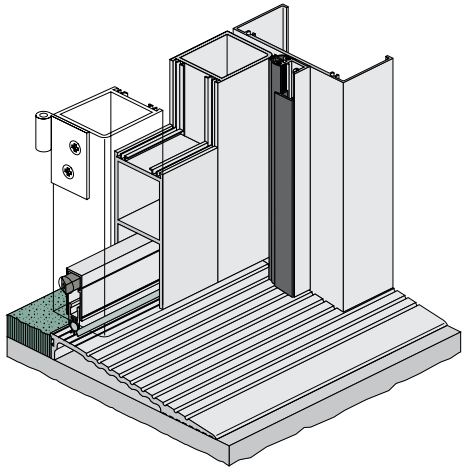

FITTING INSTRUCTIONS

Threshold Ramp

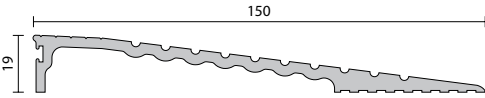

R37913

Category J gaskets for use with Listed steel frames and/or Classified steel covered composite, hollow metal doors rated up to 3 hrs; wood and plastic covered composite doors rated up to 1-1/2 hrs; and wood core doors rated for 20 minutes.

DETAILS

LOCATION

Door sill or used to provide a ramp frame for internal door mats.

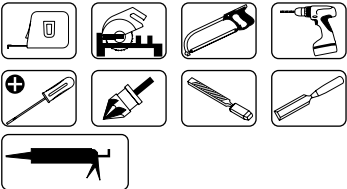
TOOLS

FIXING METHOD

Zinc plated, cross recess head CSK S.T. screws of the appropriate size and colour are supplied, or it can be fastened with adhesive (by others).

USED IN CONJUNCTION

Raven door bottom seals and door frame seals.

DESCRIPTION

A heavy duty threshold ramp with a ribbed design which can be positioned back-to-back to form a two-way threshold ramp conforming to NCC D3D16 (b) (FIG.4) PAGE 2.

Can be used in conjunction with Raven door bottom seals to prevent rain, draughts, noise and smoke infiltration. Suitable for use with most floor pivots.

Ideal for commercial shop fronts providing a neat ramp detail between carpets or tiles at door ways.

Can also be used to provide a ramped frame for internal door mats.

Note: when ordering, specify longer length than doorway to allow for neat installation around door frame.

RAVEN PRODUCTS PTY. LTD.
18-22 Aldershot Rd,
Lonsdale SA 5160 Australia
T +61 8 8384 5455
raven.com.au

Raven Products is an
ISO9001 QMS company
certified by SGS

Designed and produced by
Raven Products Pty Ltd
(Australia)

Made in P.R.C. by Raven

Copyright: 03/25 (F)

Part No. ZSDSRP98

NOTES

- » If installing a door bottom seal, refer to door bottom seal instructions for correct fitting location of the threshold ramp (user determined).
- » It may be necessary to check out the threshold ramp ends to allow for the door jambs/stops. Where the threshold ramp meets the door jamb/stop, sealant may be applied (user determined).
- » If threshold ramp protrudes from doorway, it may be necessary to provide a side return to comply with ASI428.1 Part 7.5. Cut ends at 45° to create a mitre join, or a cement/grout ramp can be made (user determined) (FIG.5).
- » Can be fixed with high strength, multipurpose polyurethane adhesive such as Sikaflex I IFC or equivalent.

STEP 1 Machine cut threshold ramp to required length to suit application (FIG.1 & FIG.3).
Note: Use a length wider than door opening to provide a side return for a neat detail at door frame (user determined) (FIG.5).

STEP 2 Check out threshold ramp ends to allow for door jambs/stops (user determined) (FIG.1 & FIG.3).

SCREW FIXING

STEP 3 If screw fixing, drill and countersink threshold ramp to suit screws supplied.

STEP 4 Position threshold ramp to suit application (FIG.1 & FIG.3).

STEP 5 Drill pilot holes to suit (drill and plug for concrete). Drive screws in firmly but do not overtighten.

Note: If screw fixing in exposed external coastal areas, substitute the supplied fixing screws with equivalent stainless steel screws.

STEP 6 Apply silicon sealant to seal at sill (by others) (FIG.2).

ADHESIVE FIXING

STEP 7 If adhesive fixing, apply builders adhesive to ribbed underside of threshold ramp (refer notes) (FIG.2).

STEP 8 Adhesive fix threshold ramp in position to suit application.

FIG.1

PLAN VIEWS

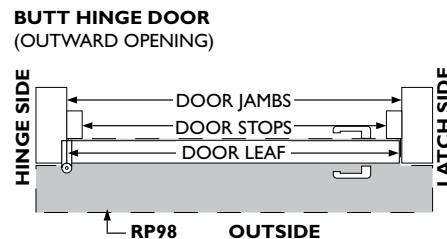
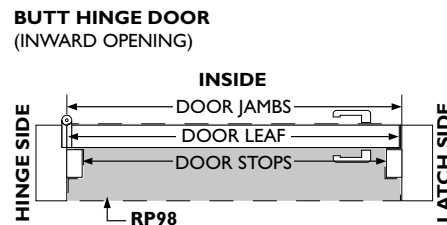
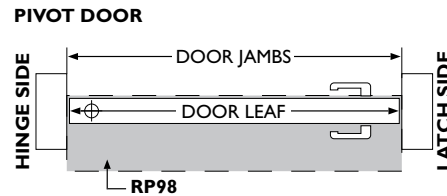

FIG.2

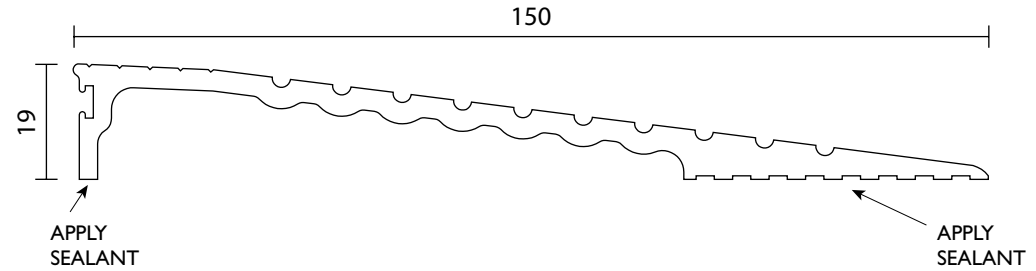

FIG.3

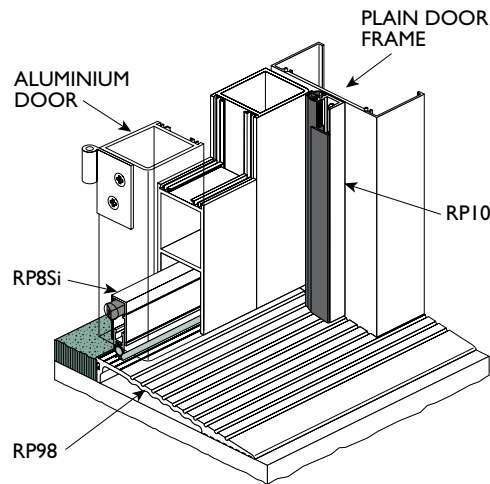
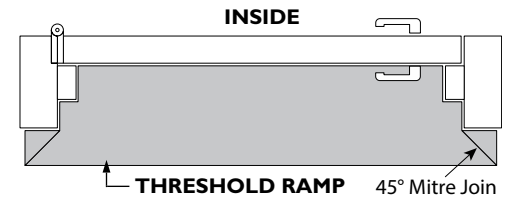

FIG.5

SIDE RETURN DETAIL PLAN VIEW

BUTT HINGE DOOR (INWARD OPENING)



BUTT HINGE DOOR (OUTWARD OPENING)

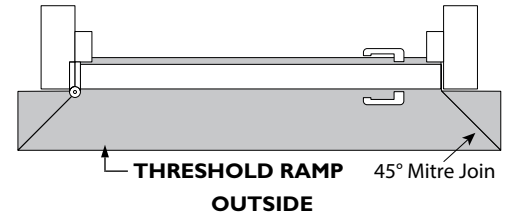

FIG.4

Position back-to-back to provide a two-way threshold ramp.

