

RP87Si

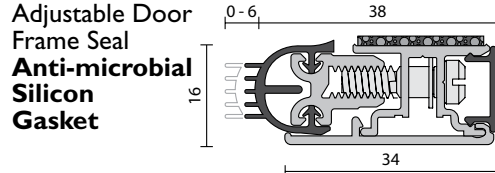

FITTING INSTRUCTIONS



CLASSIFIED
 UL R37913 Category J gaskets for use with Listed steel frames and/or Classified steel covered composite, hollow metal doors rated up to 2 hrs; wood and plastic covered composite doors rated up to 1-1/2 hrs; and wood core doors rated for 20 minutes.

DETAILS

LOCATION

Head and jambs of single and double butt hinged doors.

MIN/MAX GAP

0mm to 6mm.

SEAL MATERIAL

Silicon Rubber (SE).

FIXING METHOD

Zinc plated, cross recess head S.T. screws of the appropriate size are supplied.

ADDITIONAL DETAILS

REPLACEMENT SEAL

RP310Si.

ADJUSTMENT

Can be adjusted 6mm independently of the fixing screws.

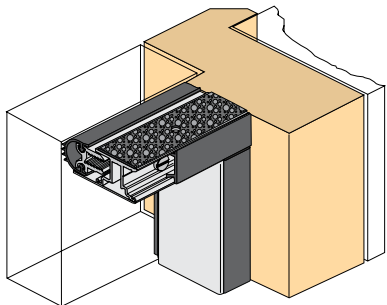

DESCRIPTION

RP87Si is an effective door stop seal for noise, light and smoke. It can be butt jointed for a neatly finished continuous seal, replacing the conventional doorstop on metal or timber framed doors. With tamper proof concealed fixings, the RP87Si utilises independently adjustable screws to achieve up to 6mm sealing adjustment for maximum noise control. The silicon rubber seal only requires normal door closing force.

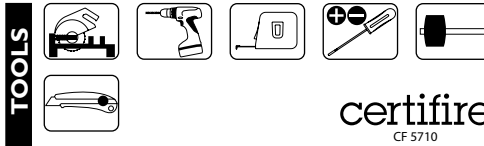

certifire
CF 5710

RAVEN PRODUCTS PTY. LTD. Designed and produced by
 18-22 Aldershot Rd, Raven Products Pty Ltd
 Lonsdale SA 5160 Australia (Australia)
 T +61 8 8384 5455
 raven.com.au Made in P.R.C. by Raven

Raven Products is an
 ISO9001 QMS company
 certified by SGS

Copyright: 08/24 (F)

Part No. ZSDSRP87Si

FIG. 1

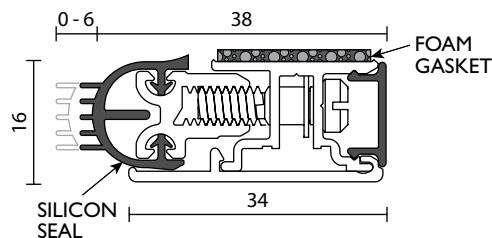

INSTALLATION

NOTES

- » Paint frame first before fitting the RP87Si door seal.
- » If a face mounted door bottom seal is to be fitted, fit the RP87Si door seal to the door frame first.
- » The RP87Si door seal joints should be butt jointed. If fitting to steel door jambs use 1" x 8 gauge self drilling pan head screws (not supplied) as mortar behind jambs may cause difficulties with long screws.

STEP 1 Slide off the **aluminium** cover strip. **(FIG.2)** Measure the required seal assembly length. Machine cut the seal assembly to length being careful to miss adjustment screws. Cut silicon seal and foam gasket with a sharp utility knife. **(FIG.1)**

STEP 2 With the door closed, position the seal at the head of the door. **Note:** Adjustable inner section will take up any door inaccuracies **(STEP 4)**. The door should rest against the RP87Si gasket lightly. **(FIG.3)** Screw fix squarely to frame in every hole. **Note:** Screw fix firmly but do not over tighten. For best results use the minimum torque setting to seat screw all the way home. Overtightening may make the cover strip difficult to fit.

STEP 3 Proceed to fit vertical seal assemblies. Remove the **black plastic** cover strips.

STEP 4 Measure the required length of the **aluminium** cover strips. Machine cut to length. Fit head aluminium cover strip and then vertical aluminium cover strips. Make sure hook of cover strip is firmly seated before snapping other end.

STEP 5 Test the RP87Si for correct fitment by inserting this sheet of paper between the door and the door seal. The seal should just hold the paper firmly. To adjust seal turn adjusting screw anti-clockwise to increase seal pressure and clockwise to decrease seal pressure.

STEP 6 Open and shut the door to check for correct latching. Snap in black plastic cover strips by hand or lightly with a rubber mallet.

FIG. 2

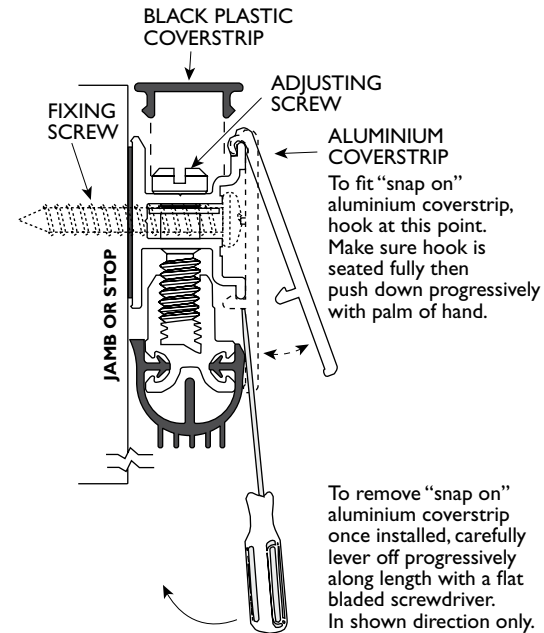
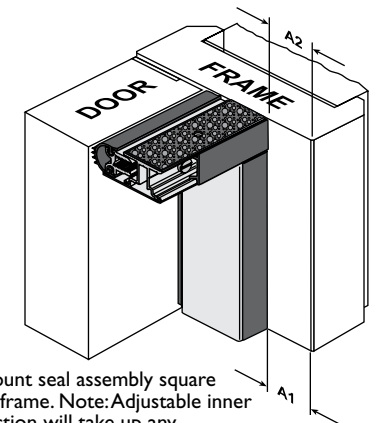

FIG. 3



Mount seal assembly square to frame. **Note:** Adjustable inner section will take up any door inaccuracies up to 6mm. Dim A1 = dim A2