

RPI21

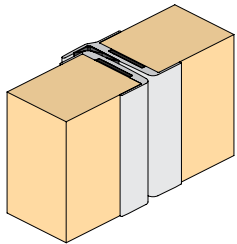

## FITTING INSTRUCTIONS

### T-Bar Fire and Smoke Seal

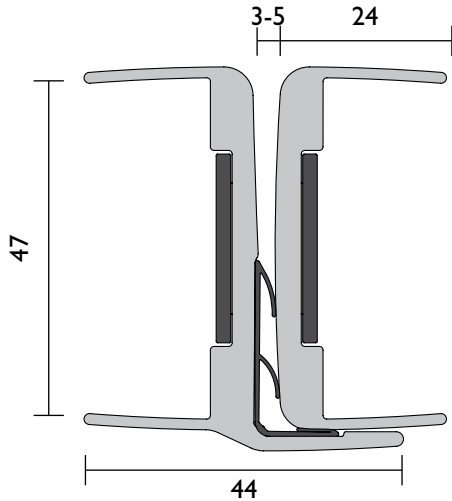

## DETAILS

### LOCATION

Plain meeting stiles of single action fire doors.

### MIN/MAX GAP

3mm to 5mm when fitted.

### SEAL MATERIAL

Intumescent infill and silicon sealing fin.

## TOOLS



## DESCRIPTION

An effective fire, smoke and acoustic seal for single action fire doors. RPI21 is a twin section bullnose T bar aluminium astragal with an intumescent infill and smoke seal. RPI21 is fitted to the meeting stiles of pairs of 47mm nominal thickness fire doors. When fitted correctly with proprietary fire door assemblies it complies with AS 1530.4 and conforms to NCC S12C4.

## ADDITIONAL DETAILS

### REPLACEMENT SEAL

RPI24

### FIXING METHOD

Zinc plated, cross recess head S.T. screws of the appropriate size and colour are supplied.

RAVEN PRODUCTS PTY. LTD.  
18-22 Aldershot Rd,  
Lonsdale SA 5160 Australia  
T +61 8 8384 5455  
raven.com.au

Raven Products is an  
ISO9001 QMS company  
certified by SGS

Designed and produced by  
Raven Products Pty Ltd  
(Australia)

Made in P.R.C. by Raven

Copyright: 08/24 (E)

Part No. ZSDSRPI21

## INSTALLATION

- STEP 1** Prepare doors to allow for gaps as shown. (FIG.1) (User determined)
- STEP 2** Measure door meeting edges to determine seal lengths required. (FIG.2)
- STEP 3** Measure and cut aluminium astragal extrusions to length. (FIG.2)
- STEP 4** Measure and mark screw clearance hole positions along the centreline at 50mm from the bottom and 50mm from the top. Also at lock height, avoiding strike and lock plates. Ensure screws will engage with doors internal reinforcing plates. (FIG.3) (User Determined)
- STEP 5** Starting with Inactive Leaf, drill screw clearance and countersink holes in aluminium astragal extrusion. Check screw heads sit just below surface. (FIG.3)
- STEP 6** Measure, mark and check out aluminium astragal extrusion to accommodate latching hardware.
- STEP 7** Place aluminium extrusion on door stile ensuring alignment at both top and bottom of door. Mark hole centres, remove aluminium extrusion and drill pilot holes through both door stile and internal reinforcing plate. (FIG.2 & FIG.3)
- STEP 8** Refit aluminium astragal extrusion to door stile and screw fix firmly. Do not overtighten. (FIG.3)

- STEP 9** Repeat STEPS 5 to 8 on active leaf.
- STEP 10** Open and shut door to check for correct latching.
- STEP 11** Measure and cut RPI24 Self Adhesive Seal to length required using scissors or utility knife. (FIG.2)
- STEP 12** Measure, mark and check out RPI24 Seal to accommodate latching hardware.
- STEP 13** Ensure adhering surface on Aluminium Astragal Extrusion (Inactive Leaf) (FIG.3 & FIG.4) is smooth, clean and if painted, well cured. Methylated Spirit or Alcohol is ideal for cleaning. Do not use an oil based solvent.
- STEP 14** Starting from the top, remove about 150mm of the self adhesive backing strip from one end of the seal to expose the adhesive.  
**Tip:** It is easier to fix the short leg of the seal first.
- STEP 15** Place RPI24 Seal flush with the top of the Aluminium Astragal Extrusion. Lightly press seal into place using finger or blunt tool.
- STEP 16** Progressively remove backing strip from seal and firmly run finger or blunt tool along the length of the seal.
- STEP 17** Check door for correct closing and latching.

FIG. 1

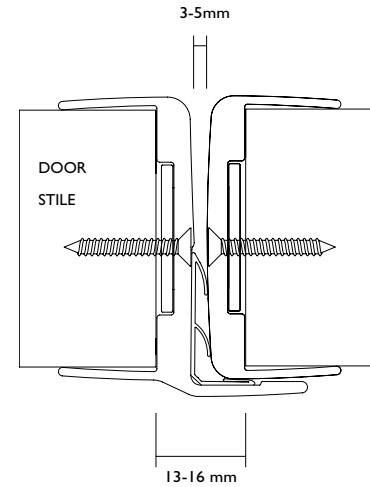

FIG. 2

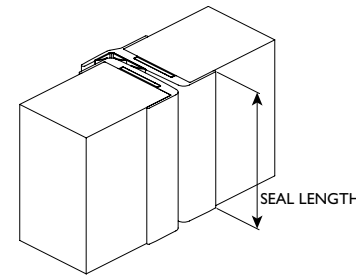

FIG. 3

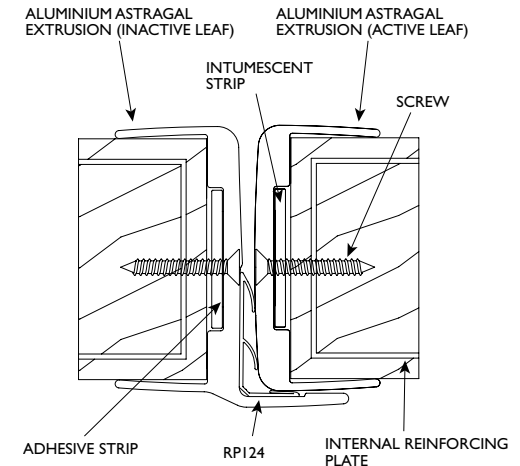

FIG. 4

