

Bradley

MODELS 9572-MB BACKREST FOR ACCESSIBLE TOILET

Option:
9572 Satin Finish

PRODUCT FEATURES:

- Ergonomically designed
40mm thick backrest
- 32mm diameter stainless steel tubing
- Matte Black Finish
- Concealed fixing
- Easy to install
- Adjustable depth to suit AS 1428.1
- Surface mounted

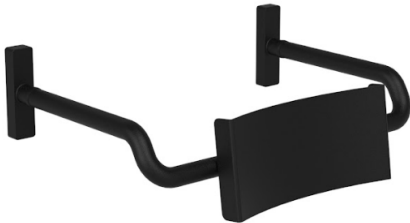

PRODUCT DATA:

CONSTRUCTION:

FLANGES: Fabricated of type 304 stainless steel.

ESCUTCHEONS: Fabricated of type 304 stainless steel. One-piece drawn construction with exposed surfaces in architectural satin finish. Concealed mounting.

TUBING: Fabricated of type 304 stainless steel, seamless construction with exposed surfaces in architectural satin finish. Bent ends of tubing pass through the flanges and are heliarc welded into a single structural unit for maximum strength. Intermediate supports are contour cut and joined by heliarc welding to form an integral part of the tubing. All welds ground and polished to blend. Mandrel bending process maintains uniform tubing diameter.

STRENGTH

When properly mounted, all Bradley heavy duty systems meet or exceed the requirements of Australian Standard AS 1428.1

INSTALLATION:

Secure to wall where adequate in-wall backing exists. Use wall fixing plate as a template to locate mounting holes. Drill holes and set anchors as appropriate.

Mount backrest and secure mounting screws.

GUIDE SPECIFICATION:

Unit shall be fabricated of type 304 satin finish stainless steel with concealed mounting flanges in sizes and configurations as indicated.

Padded white polyurethane backrest.

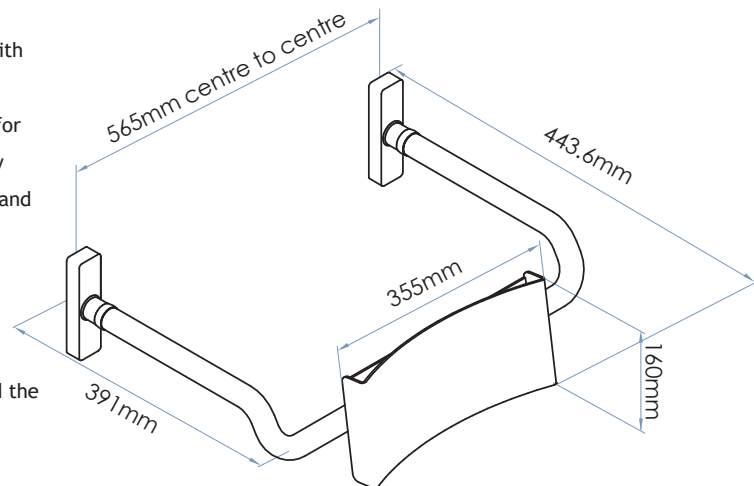

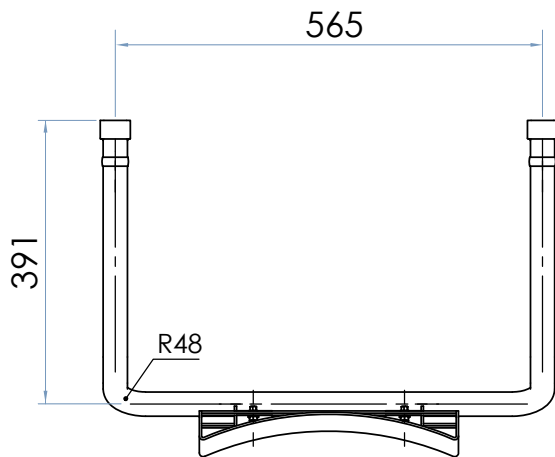
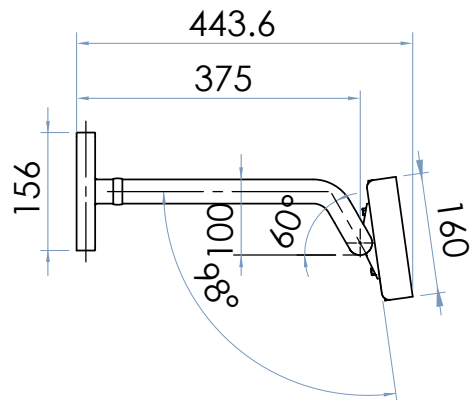
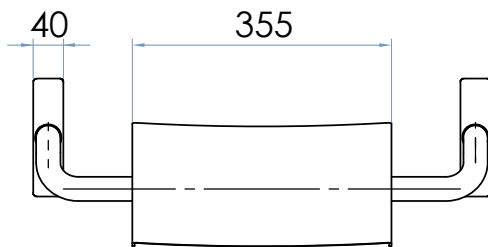
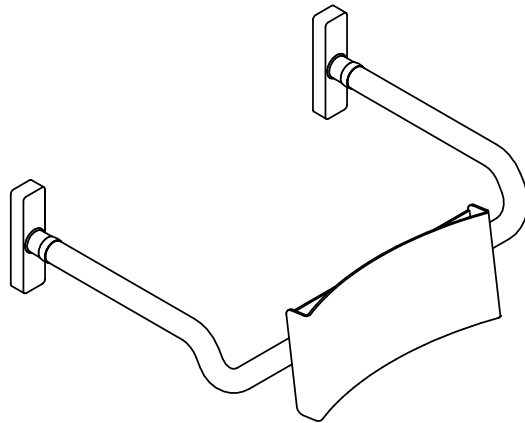

Bradley

DWG NO. 9572-MB

APPROVED BY:

Proudly customised design please approve SCALE:1:10