

Cavity Sliding Door Locks



Lockwood's sliding door lock range is possibly the most innovative and aesthetically pleasing lock for a cavity sliding door in Australia. Combining elegance and ease of use, the Lockwood Cavity Sliding Door Lock range is ideal for any home décor and security solution.

Not only will the internal bathroom or lounge room sliding door have a contemporary look, but the interconnecting door from the garage to the laundry can be fitted with a key lockable entrance-set for security.

Features and Specifications

- Fitted flush against the panel of the sliding door for full recess into the door cavity
- Entrance, Privacy, Passage and Passage Latch models available for the complete residential solution

Retractable door pull

Designed after extensive research, the sliding cavity door lock features an innovative retractable door pull which combines style with functionality.

Key lockable solution

The key lockable Entrance Set model protects sliding perimeter doors with the added confidence of Australian Standard compliance for AS4145.2-2008: Tested to exceed 30,000 turn cycles withstanding 3 kN of pull force.

Product Details

Cross Drill	25mm
Door Thickness	32* to 40mm for timber doors *Requires spacer ring (included)
Finishes	Chrome Plate (CP) Satin Chrome Pearl (SP)
Latch Backset	60mm
Prep Hole	54mm
Strike	Box strike or pip strike (passage)
Materials	Furniture plate: Zinc Alloy Bolt: Nickel Plated Zinc (12.4mm projection) Bolt Beak: Stainless Steel Front End Plate: Stainless Steel Retractable Door Pull: Zinc Plated Strike Plate: Stainless Steel Strike Box: Zinc Plated Keys: Brass

Cavity Sliding Door Locks

7444 Entrance Set

Part Number	Finish
7444CPDP	Chrome Plate
7444SPDP	Satin Chrome Pearl

Outside

Locked or unlocked by key

Inside

Locked or unlocked by turn-plate



Kinetic Defence®
Bump and pick resistant.

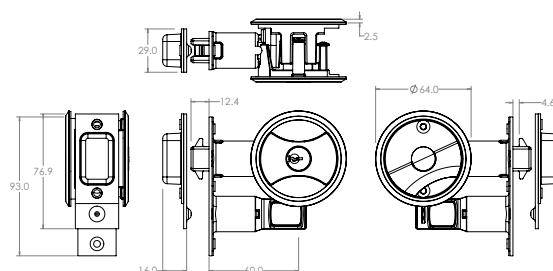

Exterior

Interior

7400 Privacy Set

Part Number	Finish
7400CPDP	Chrome Plate
7400SPDP	Satin Chrome Pearl

Outside

Emergency release button opened by coin or screwdriver

Inside

Locked or unlocked by turn-plate

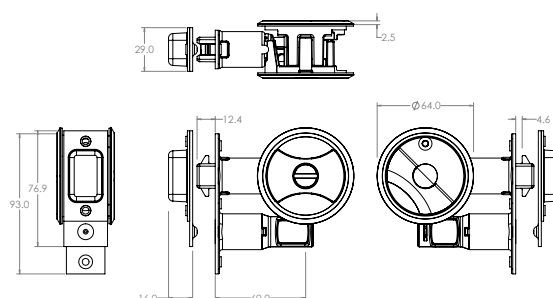

Exterior

Interior

Cavity Sliding Door Locks

7410 Passage Latch Set

Part Number	Finish
7410CPDP	Chrome Plate
7410SPDP	Satin Chrome Pearl

Outside

Locked or unlocked by turn-plate

Inside

Locked or unlocked by turn-plate

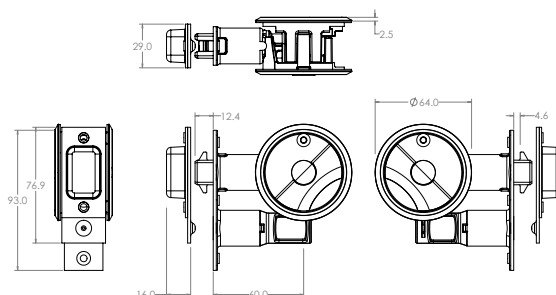

Exterior

Interior

7450 Passage Set

Part Number	Finish
7450CPDP	Chrome Plate
7450SPDP	Satin Chrome Pearl

Outside

Free to slide door at all times

Inside

Free to slide door at all times

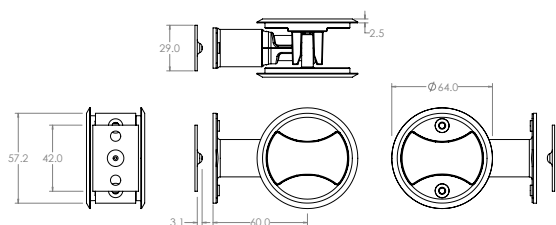

Exterior

Interior



Lockwood is the leading brand in the Australian locking industry. With an established reputation for high quality products, this iconic brand provides a wide range of locking solutions to residential housing, commercial, semi-commercial, building and industrial application markets. Lockwood is supported by an extensive distribution and after-sales support network. Our customers include retailers, architects, trade and industrial personnel, locksmiths and security dealers.

ASSA ABLOY is the global leader in door opening solutions, dedicated to satisfying end-user needs for security, safety and convenience.

ASSA ABLOY is represented in all major regions, in both mature and emerging markets, with leading positions in Australia, Europe and North America.



The Lockwood 25 Year Mechanical Warranty

Our belief that we manufacture the finest premium products available in today's market place is backed by the Lockwood 25 Year Mechanical Warranty, ensuring that Lockwood continues to keep Australians safe by delivering security and peace of mind.

For warranty terms and conditions, please visit www.lockweb.com.au or call **1300WARRANTY**

ASSA ABLOY Australia Pty Ltd
235 Huntingdale Road
Oakleigh, Victoria, 3166
Australia

1300 LOCK UP (1300 562 587)
lockweb.com.au

ASSA ABLOY New Zealand Ltd
6 Armstrong Road
Albany, Auckland, 0632
New Zealand

info.nz@assaabloy.com
Telephone +64 9415 7111
assaabloy.co.nz

Disclaimer

Whilst every effort has been made to ensure that the information (including product images and drawings) contained in this brochure is accurate at the time of publication, ASSA ABLOY Australia Pty Limited ("ASSA ABLOY") recommends that you consult ASSA ABLOY or its agents prior to placing an order to ascertain current information on specific products, as ASSA ABLOY reserves the right to make changes without notice. ASSA ABLOY will not be liable for any injury, loss or damage whatsoever, arising from any errors or omissions in the information contained in the brochure or arising from the use or application of the information contained herein. © 2016 copyright by ASSA ABLOY All rights reserved

