



SPECIFICATION

Rear Mounted Security Clothes Hook Shall be fabricated of type 304 stainless steel alloy 18-8. Hook shall be solid bar 10mm diameter of one-piece construction with 25mm diameter swivel trip-ball and wall plate shall be 14 gauge. Wall plate shall have four (4) welded-on rear mounted 1/4-20 internally-threaded posts that shall receive 1/4-20 threaded zinc-plated steel studs (supplied) of length specified to suit field conditions and shall include washers and nuts. Safety hook shall snap down when load exceeds 16 kg limit. Trip-ball socket housing shall prevent hook from being set in vertical-up position. All exposed surfaces shall have No 4 satin finish.

INSTALLATION

Unit is rear mounted to wall or partition using four (4) 1/4-20 threaded studs, washers and nuts (supplied). Unit is supplied as standard with threaded studs suitable for mounting on walls up to 152mm thick. Other wall thickness over 152mm must be specified in chart for fabrication of adequate length studs. Locate and drill 10mm to 11mm diameter holes through wall or partition to install threaded studs from rear.

Indicate thickness of wall with check mark "✓" and specify length if over 203mm

Up to 152mm	203mm	Over 203mm	Specify W = ____ inches
-------------	-------	------------	-------------------------

WARRANTY

One year.

Surface Clothes Hook shall be Model No 10-122 as supplied by ASI JD MacDonald.

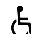
 All ASI JD MacDonald disabled compliant products when installed must be in accordance with AS1428 to ensure the specified product is complying with all washroom specification requirements.

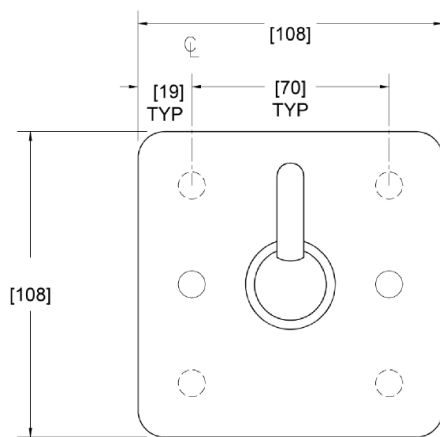

ELEVATION

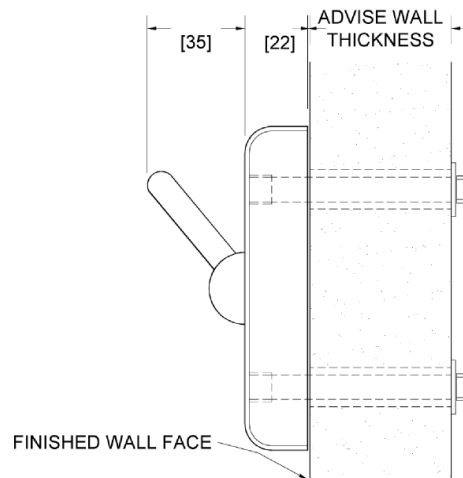

FINISHED WALL FACE

NOTE: DIM'S ARE IN [MM]

SIDE VIEW