



R&T Delta Floorstanding Inwall Cistern

Product Code IS22

Dimensions

505-563 x 470 x 147.5mm

Features

Suitable with Floorstanding Pan

Includes:- InWall Cistern for floorstanding pan.

- Push Plate Buttons - Works with Delta Button selection
- Operating pressure 10-1000kpa
- Fits 90mm stud wall

WELS 4 Star rated

4.7L/3.2L (3.5L average flush)

Warranty

Domestic -

3 Years Replacement Parts

1 Year Labour for Manufacturing Faults

1 Year Replacement Buttons

Commercial -

1 Years Replacement Parts

1 Year Labour for Manufacturing Faults

1 Year Replacement Buttons

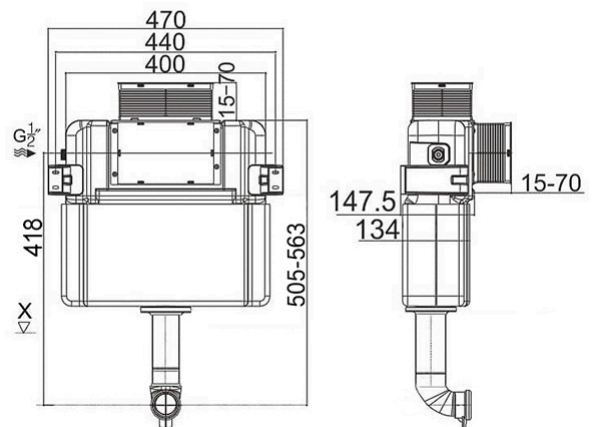

All installations should be carried out by a qualified tradesman in compliance with the National Plumbing & Drainage Code and any State or Local Authority Regulations, in accordance with AS/NZS 3500 series of standards and AS/NZS 6400. All measurements are in millimetres and are subject to change without notice. For ceramic products, please allow +/- 5mm tolerance for manufacturing variance.