

Levelling Feet

BOLT DOWN & FIXED - RUBBER BASE



BOLT DOWN

Part Number	Size	Base Diameter (A)	Thread Height (B)	Base Thread Height (C)	Base Height (D)	Thread (E)	Hole Centres (F)	Hole Diameter (G)	Load Capacity
LVR8008100B	80 x M8	80mm	100mm	35mm	18mm	M8	56mm	10mm	350kg
LVR8010100B	80 x M10	80mm	100mm	32mm	18mm	M10	56mm	10mm	500kg
LVR8012100B*	80 x M12	80mm	100mm	33mm	18mm	M12	56mm	10mm	800kg
LVR8012150B	80 x M12	80mm	150mm	35mm	18mm	M12	56mm	10mm	800kg
LVR10012100B	100 x M12	100mm	100mm	41mm	29mm	M12	73mm	13mm	800kg
LVR10012150B	100 x M12	100mm	150mm	44mm	29mm	M12	73mm	13mm	800kg
LVR10016150B	100 x M16	100mm	150mm	45mm	28mm	M16	73mm	13mm	1000kg
LVR12716150B	127 x M16	127mm	150mm	47mm	29mm	M16	102mm	13mm	1000kg
LVR12720150B	127 x M20	127mm	150mm	47mm	30mm	M20	102mm	13mm	1000kg

For stainless steel option add SS to the part number, eg. LVR8008100BSS. Models marked * not available in stainless steel

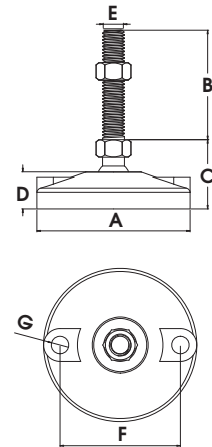

FIXED

Part Number	Size	Base Diameter (A)	Thread Height (B)	Base Thread Height (C)	Base Height (D)	Thread (E)	Load Capacity
LVR500850F	50 x M8	50mm	50mm	31mm	23mm	M8	350kg
LVR501050F	50 x M10	50mm	50mm	31mm	23mm	M10	500kg
LVR601250F	60 x M12	60mm	50mm	33mm	25mm	M12	800kg
LVR6012100F	60 x M12	60mm	100mm	33mm	25mm	M12	800kg
LVR6016150F	60 x M16	60mm	150mm	35mm	25mm	M16	1000kg
LVR6020150F	60 x M20	60mm	150mm	35mm	25mm	M20	1000kg
LVR8012100F *	80 x M12	80mm	100mm	40mm	30mm	M12	500kg
LVR8012150F	80 x M12	80mm	150mm	40mm	30mm	M12	500kg
LVR8016150F *	80 x M16	80mm	150mm	40mm	30mm	M16	800kg
LVR8020150F	80 x M20	80mm	150mm	40mm	30mm	M20	1000kg

For stainless steel option add SS to the part number, eg. LVR500850FSS. Models marked * not available in stainless steel

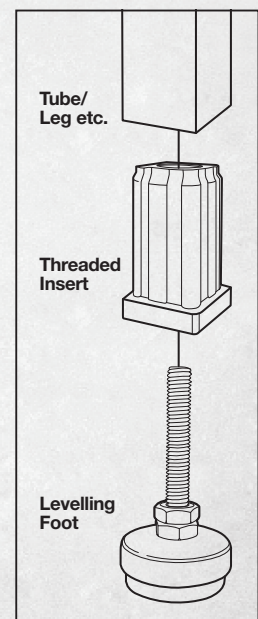
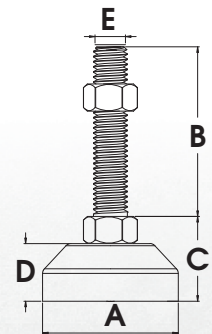

Fixed Foot
LVR500850F



Fixed Foot
LVR8020150F

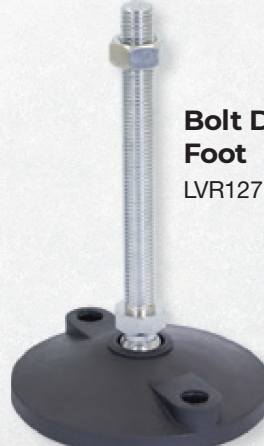

Bolt Down Foot
LVR12716150B