

KINCROME

PROFESSIONAL QUALITY TOOLS

500MM INDUSTRIAL INTERNAL ORBIT ACTION PEDESTAL FAN

3

SPEED

HIGH
VELOCITY
AIR FLOW

INTERNAL
ORBIT
ACTION

5
BLADE
CONSTRUCTION

INCLUDES
ANTI-TRIP
BASE

ENERGY
EFFICIENT
MOTOR



KP1014

ED1 (JULY 15)

Table of Contents

Know Your Product 2
 Fan Safety Instructions 3
 Fan Assembly..... 4
 Fan Operation 5-6
 Maintenance & Spare Parts..... 6-7
 Warranty..... 7

Know Your Product

1. Locking & Tilt Nut- Left
2. Front Safety Grill
3. Rear Safety Grill
4. Fan Drum Body
5. 3 Speed Switch (On Rear of Fan)
6. Internal Orbit Oscillation Switch (On Rear of Fan)
7. Fan Blade
8. Locking & Tilt Nut- Right
9. Pedestal Mounting Bracket
10. Telescopic Height Locking Ring
11. Telescopic Pedestal Stand
12. Anti-Trip Base
13. Pedestal Fan Head Locking Knob (On Rear of Fan)
14. Fan Motor (On Rear of Fan)

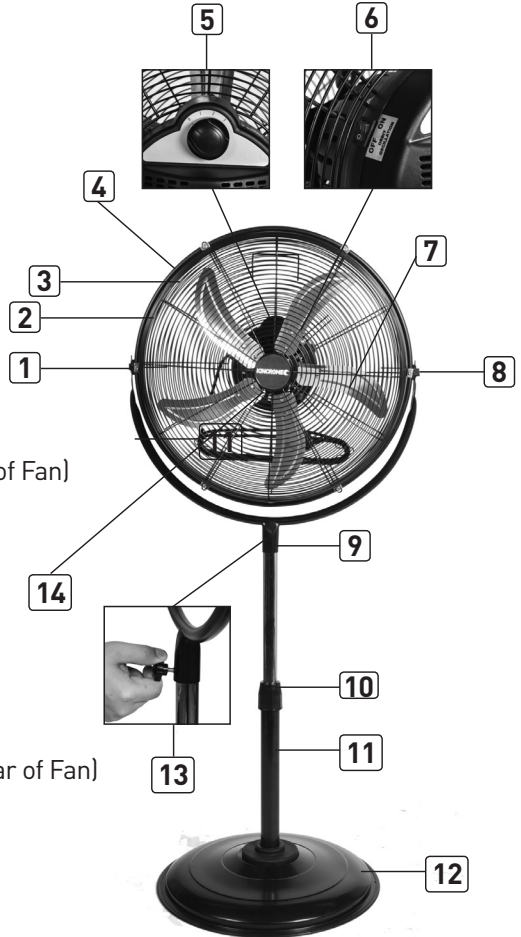

Specifications

Power.....	78W
Max. Motor Speed.....	1300/min
Diameter.....	500mm (20")
Speed Selection.....	3
Air Velocity.....	82m ³ /min
Blades.....	5 X Aluminium
Head action.....	Tilttable & Internal Orbit Action
Pedestal Height (Centre of blade to floor):.....	870mm - 1160mm
Climate Class.....	T
Approvals.....	AS/NZS Compliant
Weight.....	9.53kgs

General Power Tools Safety Warnings



Save all warnings and instructions for future reference.

WARNING! Read all safety warnings and all instructions. Failure to follow the warnings and instructions may result in electric shock, fire and/or serious injury.

1) Electrical Safety

- a) **Power lead plugs must match the outlet.** Never modify the plug in any way. Do not use any adapter plugs with earthed (grounded) power tools. Unmodified plugs and matching outlets will reduce risk of electric shock.
- b) **Avoid body contact with earthed or grounded surfaces, such as pipes, radiators, ranges and refrigerators.**
There is an increased risk of electric shock if your body is earthed or grounded.
- c) **Do not expose power tools to rain or wet conditions.** Water entering a power tool will increase the risk of electric shock.
- d) **Do not abuse the cord.** Never use the cord for carrying, pulling or unplugging the power tool. Keep cord away from heat, oil, sharp edges or moving parts. Damaged or entangled cords increase the risk of electric shock.
- e) **If operating a power tool in a damp location is unavoidable, use a residual current device (RCD) protected supply.**
Use of an RCD reduces the risk of electric shock.
- f) **Do not operate powered products in explosive atmospheres, such as in the presence of flammable liquids, gases or dust.** Powered products create sparks which may ignite the dust or fumes.
- g) **Keep children and bystanders away while operating any powered products.** Distractions can cause you to lose control.

2) Service

- a) **Have your power tool serviced by a qualified repair person using only identical replacement parts.** This will ensure that the safety of the power tool is maintained.

3) Fan Additional Safety Instructions

- a) **This Fan is not intended for use by persons (including children) with physical, sensory or mental capabilities, or lack of experience and knowledge, unless they have been given supervision or instruction concerning use of the Fan by a person responsible for their safety.**
- b) **Children should be supervised to ensure that they do not play with the Fan.**
- c) **Carefully read all instructions before operating the fan for the first time and save for future reference.**
- d) **Do not use this Fan for anything other than its intended use. Do not use outdoors.** Misuse may cause injury.
- e) **The installation of a residual current device (safety switch) is recommended to provide additional safety protection when using electrical Fans.** It is advisable that a safety switch with a rated residual operating current not exceeding 30mA.
- f) **To protect against electric shock, do not immerse the fan, cord or plug in water or any other liquid.**
- g) **Disconnect the power plug before dismantling, assembling or before cleaning and when the fan is not in use.**
- h) **Avoid touching the moving parts of the fan.**
- i) **Ensure the fan is on a dry and even surface.**
- j) **Never insert fingers, pencils or any other objects through the guards.**
- k) **The fan must have all guards assembled/fastened correctly, according to these instructions before use.**
- l) **Do not operate in the presence of explosives and/or flammable fumes or liquids.**
- m) **Never leave the fan running unattended.**
- n) **Never carry the fan by the cord or pull the cord to disconnect from an outlet; instead, grasp the plug and pull to disconnect.**
- o) **It is recommended to regularly inspect the Fan.** To avoid a hazard do not use the fan if power cord, power plug or Fan becomes damaged in any way. Return the fan to the nearest authorised Service Centre for examination and/or repair.

4) Risk of Electric Shock

- a) **Never touch the mains plug and the socket with wet hands.**
- b) **Do not pull the plug from the socket by pulling on the power cable.**
- c) **Check the power cord and mains plug for damage before every use.**
- d) **To avoid accidents due to electrical faults we recommend the use of sockets with a line-side current-limiting circuit breaker (max. 30 mA nominal tripping current).**
- e) **Check the appliance and the power cord regularly for any possible damage.** Don't use damaged appliances.
- f) **If the supply cord is damaged, it must be replaced by the manufacturer, its service agent or similarly qualified persons in order to avoid a hazard.**

5) Labels On Product

The following symbols are shown on the tool:



The pedestal fan is intended for indoor use only.



Read the instruction manual before use.



Warning



Electromagnetic compliance (C-Tick)

6) Unpacking

Unpack all the components from the box.

When unpacking the KP1014 500mm Industrial Internal Orbit Pedestal Fan, carefully inspect for any damage that may have occurred during transit.

Check for loose parts, missing parts or damaged parts.

1. Ensure all packaging materials are disposed of as per your local council guide lines.

7) Assembling The Anti-Trip Base To The Telescopic Stand

1. Place the anti-trip base [12] on the floor, with the screws facing upwards [Fig.1a]; and remove the 4 inner screws located on the anti-trip base [12] with a phillips head screw driver (not provided) [Fig.1b].
2. Once they have been removed, align the telescopic stand [11] collar (square base) with the 4 screws you removed in step 1, and then reinstall the 4 screws to secure the telescopic stand [11] to the anti-trip base [9] [Fig.1c].
3. Once the telescopic stand [11] has been secured to the anti trip base [12], pull down the shroud cover, to hide the screws [Fig.1d].



[Fig.1a]

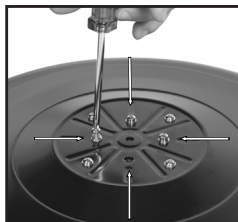

[Fig.1b]



[Fig.1c]

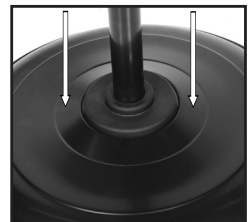

[Fig.1d]

8) Assembling the Fan Motor to the Telescopic Stand

1. Align the assembled pedestal drum fan head onto the telescopic pedestal stand [11] by sliding the pedestal mounting bracket [9] onto the top of the telescopic pedestal stand [11] inner tube [Fig.2a]. Align the fixing holes on the pedestal mounting bracket [9] and pedestal fan stand [11] inner tube [Fig.2b].
2. Secure the assembled pedestal drum fan head located on the telescopic stand [11] by screwing the pedestal fan head locking knob [13] into the back of the pedestal mounting bracket [9] and through the hole in the inner tube of the telescopic stand [11] [Fig.2c].

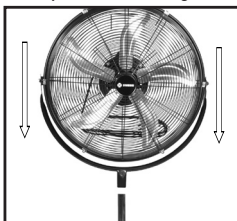

[Fig.2a]

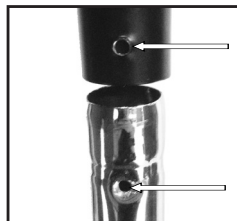

[Fig.2b]



[Fig.2c]

9) Operation

Caution: Prior to plugging in the unit ensure the switch is in the OFF (0) position.

1. Located at the rear of the fan motor (14) unit is the 3 speed switch (5) (Fig. 3).
2. Plug the unit into a wall socket and switch the socket ON.
3. Rotate the 3 speed switch (5) to the desired speed 0 – OFF, 1 – LOW, 2 – MEDIUM, 3 – HIGH.
4. To turn the unit OFF rotate the 3 speed switch (5) to the OFF position (0).



(Fig.3)

10) Fan Body Tilt Adjustment

Caution: Ensure the unit is turned OFF and unplugged, and the blades are stationary prior to making any adjustments.

1. To adjust the fan Tilt; loosen both locking/tilt nuts (1 & 8) located either side of the fan drum body (4) with a 13mm spanner (not provided) in an anti-clockwise direction (Fig.4a);
2. Tilt the fan to the desired position (Fig.4b);
3. Re-tighten the fastening/locking nuts (1 & 8) with a 13mm spanner (not provided) in a clockwise direction;
4. Plug the unit back in and turn ON to the desired speed (Fig.4c).

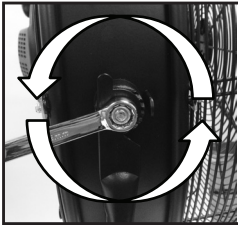

(Fig.4a)

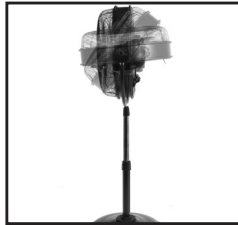

(Fig.4b)

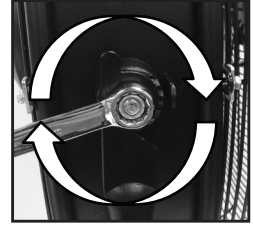

(Fig.4c)

11) Internal Orbit Oscillation Action

Caution: Ensure the unit is turned OFF and unplugged, and the blades are stationary prior to making any adjustments.

The KP1014 pedestal fan has an internal orbit oscillation action. This means the fan blade oscillates within the fan drum body (4) instead of the standard style oscillation, where the entire fan head rotates.

1. To turn ON the internal orbit oscillation action of the pedestal fan, simply press the Internal Orbit Oscillation Switch (6) to the ON (-) position (Fig.5).
2. To turn OFF the internal orbit oscillation, simply press the Internal Orbit Oscillation Switch (6) to the OFF (0) position (Fig.5).

Note: You can turn ON the internal orbit oscillation feature to direct the air flow of the fan to your desired location and then turn the internal orbit oscillation feature OFF to lock/hold the air direction as required.

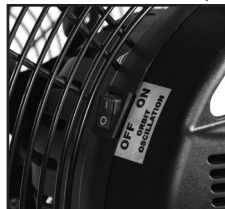

(Fig.5)

12) 360° Fan Body Rotation

Caution: Ensure the unit is turned OFF and unplugged, and the blades are stationary prior to making any adjustments.

The KP1014 can be rotated into any direction desired.

Simply turn the fan by rotating the fan head/base in any direction until the fan head is pointing into the direction where you require the fan to ventilate (Fig.6).

Note: Take care when rotating the fan, turn the fan slowly to avoid potential accidental tipping.

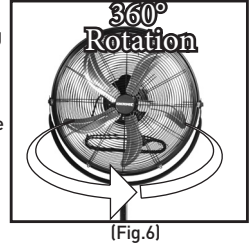

13) Height Adjustment

Caution: Ensure the unit is turned OFF and unplugged, and the fan blades are stationary prior to making any adjustments.

1. To adjust the fan Height; rotate the telescopic height locking ring (10) on the telescopic stand (11) anti-clockwise (Fig.7a), this will allow you to move the head up and down to the desired height (Fig.7b).
2. Once you have the fan at the desired height, rotate the telescopic height locking ring (10) in a clockwise direction and firmly tighten (Fig.7c).
3. Plug the unit back in and turn ON to the desired speed.

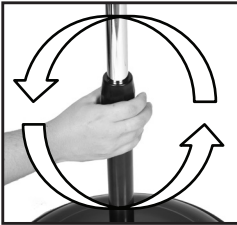

(Fig.7a)

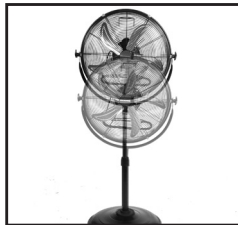

(Fig.7b)

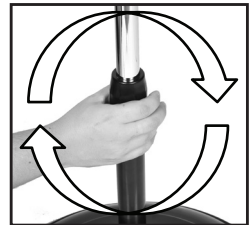

(Fig.7c)

14) Care & Maintenance

Caution: Prior to making any adjustments ensure the unit is turned off and unplugged, and the blades are stationary.

1. Disconnect the unit from the wall socket prior to cleaning the unit.
2. Remove the front and rear safety grills (2 & 3) by removing the 12 securing bolts (6 each side) located on the outer edges of the front and rear heavy duty safety grills (2 & 3) (Fig. 8a).
3. Clean the fan only with a slightly damp, soapy cloth, but ensure it is not too wet. After wiping down the unit with the soapy cloth, dry any wet spots with a dry paper towel or dry clean cloth.
4. Do not spray or rinse with any form of liquid and/or detergents.
5. Leave the fan to dry, and remount the front and rear safety grills (2 & 3) back onto the fan, by securing the bolts removed in step 2.
5. Store the fan in a clean dry area when not in use.
5. To prevent excessive build up of dust and debris on the fan blades and grills when not in use, purchase the optional KP1001 500mm fan cover from your local retailer (Fig.8b). Purchasing and using the optional KP1001 fan cover when the fan is not in use will assist in the prevention of unwanted dust and debris for accumulating on the fans components and will help reduce unwanted dust practicals from being blown into your work environment when switched ON for the first time the following season.

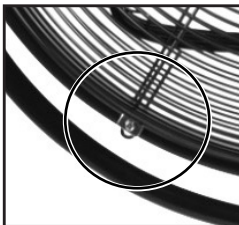

(Fig.8a)



(Fig.8b)

15) Spare Parts

For a full list of available spare parts for this item visit the Kincrome website kincrome.com.au or alternatively contact Kincrome Customer Service.

16) Office Contact Details:



Phone: 1300 657 528



Fax: 1300 556 005



Email: enquiries@kincrome.com.au



Website: www.kincrome.com.au

17) Caring for the Environment



When a tool is no longer usable it should not be disposed of with household waste, but in an environmentally friendly way. Please recycle where facilities exist. Check with your local council authority for recycling advice.



Recycling packaging reduces the need for landfill and raw materials. Reuse of recycled material decreases pollution in the environment. Please recycle packaging where facilities exist. Check with your local council authority for recycling advice.

Notes:

18) Warranty

12
MONTH
WARRANTY

Warranty given by Kincrome Australia Pty Ltd of 3 Lakeview Drive, Caribbean Park, Scoresby, Victoria (Tel 1300 657 528). The applicable warranty period (12 months) commences on the date that the product is purchased. If this product has materials or workmanship defects (other than defects caused by abnormal or non warranted use) you can, at your cost, send the product to place of purchase, an authorised Kincrome service agent or one of Kincromes addresses for repair or replacement. Your rights under this warranty are in addition to any other rights you have under the Australian Consumer Law or other applicable laws. Our goods come with guarantees that cannot be excluded under the Australian Consumer Law. You are entitled to a replacement or refund for a major failure and compensation for any other reasonably foreseeable loss or damage. You are also entitled to have the goods repaired or replaced if the goods fail to be of acceptable quality and the failure does not amount to a major failure. For further details please visit www.kincrome.com.au or call us. Due to minor changes in design or manufacture, the product you purchase may sometimes differ from the one shown on the packaging.

KINCROME 
PROFESSIONAL QUALITY TOOLS

www.kincrome.com.au