

BS SPROCKETS - TAPERLOCK

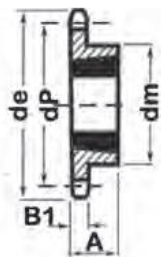

06B-1-2 TAPER LOCK		TEETH	de	dp	SIMPLEX					DUPLEX					
					dm	A	Bush	Type	App Kg	dm	A	Bush	Type	App Kg	
		17	55.5	51.83	45	22.23	1008	1	0.14	41	22	1008	2	0.5	
		18	58.6	54.85	45	22.23	1008	1	0.18	43	22	1008	2	1.08	
		19	61.6	57.87	45	22.23	1008	1	0.23	46	22	1008	2	0.6	
		20	64.6	60.89	45	22.23	1008	1	0.27	48	22	1008	2	1.23	
		21	67.6	63.91	45	22.23	1008	1	0.32	49	22	1008	2	1.4	
		22	70.6	66.93	45	22.23	1108	1	0.36	52	22	1008	2	1.39	
		23	73.7	69.95	63	25.4	1210	1	0.41	59	25	1210	2	1.8	
		24	76.7	72.97	63	25.4	1210	1	0.45	61	25	1210	2	1.55	
	PINIONS	mm	25	79.7	76	63	25.4	1210	1	0.54	64	25	1210	2	1.9
			26	83	79.02	63	25.4	1210	1	0.53	64	25	1210	2	1.95
	Tooth Radius r3		27	85.7	82.04	63	25.4	1210	1	0.52	70	25	1210	2	2
	Radius Width C		28	89	85.07	63	25.4	1210	1	0.53	70	25	1210	2	1.86
	Tooth Width B1	5.3	29	92	88.09	63	25.4	1210	1	0.53	70	25	1210	2	1.94
			30	94.8	91.12	63	25.4	1210	1	0.54	75	25	1210	2	2.1
Chain	mm	36	113.4	109.3	-	-	-	-	-	75	25	1210	2	2.48	
Pitch	9.53	38	116	115.3	70	25.4	1210	1	0.68	80	25	1610	2	2.5	
Inside	5.72	45	118.6	114.7	70	25.4	1210	1	0.95	-	-	-	-	-	
Roller ø	6.35	57	149.3	145.2	83	25.4	1210	1	1.25	80	25	1610	2	4.1	
		76	197.9	193.6	83	25.4	1210	1	1.82	80	25	1615	2	5.8	
		95	246.3	242	83	25.4	1210	1	2.28	90	25	1615	2	6.9	
		114	294.8	290.3	83	38	1210	1	2.8	-	-	-	-	-	



Type 1

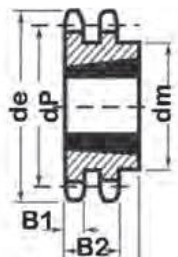

Type 2

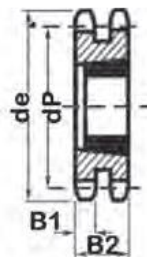

Type 3

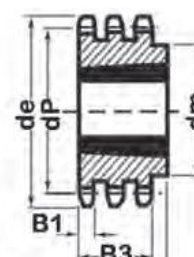

Type 4

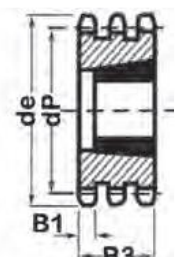

Type 5

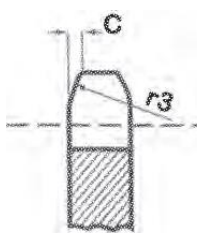
08B-1-2 TAPERLOCK		TEETH	de	dp	SIMPLEX				DUPLEX					
					dm	A	Bush	Type	App Kg	dm	A	Bush	Type	App Kg
		14	61.9	57.07	45	22.23	1008	1	0.18	-	-	-	-	-
		15	65.9	61.09	45	22.23	1008	1	0.18	46	22.23	1008	2	0.18
		16	69.9	65.1	45	22.23	1008/1108	1	0.23	50	22.23	1008	2	0.24
		17	74	69.11	60	25.4	1108/1210	1	0.23	56	25.4	1210	2	0.27
		18	78	73.14	62	25.4	1210	1	0.27	60	25.4	1210	2	0.28
		19	82	77.16	63	25.4	1210	1	0.32	62	25.4	1210	2	0.36
		20	86	81.19	71	25.4	1210/1610	1	0.41	66	25.4	1610	2	0.37
		21	90.1	85.22	71	25.4	1610	1	0.45	70	25.4	1610	2	0.46
		22	94.1	89.24	71	25.4	1610	1	0.5	76	25.4	1610	2	0.51
		23	98.1	93.27	76	25.4	1610	1	0.59	79	25.4	1610	2	0.59
	24	102.1	97.29	76	25.4	1610	1	0.73	84	25.4	2012	2	0.69	
	25	106.2	101.3	76	25.4	1610	1	0.74	87	31.75	2012	2	0.77	
	26	110.2	105.4	76	25.4	1610	1	0.76	87	31.75	2012	2	0.93	
	27	114.2	109.4	76	25.4	1610	1	0.78	87	31.75	2012	2	0.95	
	28	118.3	113.4	76	25.4	2012	1	0.8	87	31.75	2012	2	1.21	
	29	112.3	117.5	76	25.4	2012	1	0.81	87	31.75	2012	2	1.37	
	30	126.3	121.5	90	31.75	2012	1	0.82	87	31.75	2012	2	1.59	
	32	134.4	129.6	90	31.75	2012	1	0.87	-	-	-	-	-	
	35	146.5	141.7	90	31.75	2012	1	0.95	-	-	-	-	-	
	37	151	145.7	-	-	-	-	-	87	31.75	2012	2	2.85	
	38	158.6	153.8	90	31.75	2012	1	1.23	100	31.75	2012	2	3.18	
	45	188.6	182.1	100	31.75	2012	1	1.46	100	31.75	2012	2	3.95	
	48	200.7	194.2	100	31.75	2012	1	1.55	-	-	-	-	-	
	50	208.8	202.3	110	31.75	2012	1	2.01	-	-	-	-	-	
	57	233.1	230.5	110	31.75	2012	1	2.6	110	31.75	2012	2	7.56	
	76	313.9	307.3	110	31.75	2012	1	4.27	110	31.75	2012	2	15.26	
	95	390.7	384.1	110	31.75	2012	1	6.88	110	31.75	2012	2	19.08	
	114	467.4	460.9	110	44.45	2012/2517	1	10.44	110	31.75	2517	2	22.9	
PINIONS	mm													
Tooth Radius r3														
Radius Width C														
Tooth Width B1	7.2													
Chain	mm													
Pitch	12.7													
Inside	7.75													
Roller ø	8.51													

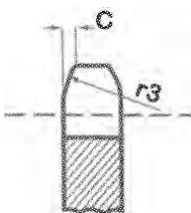

10B-1-2 TAPERLOCK		TEETH	de	dp	SIMPLEX				DUPLEX					
					dm	A	Bush	Type	App Kg	dm	A	Bush	Type	App Kg
		12	68.2	61.34	47	22.23	1008	1	0.2	-	-	-	-	-
		13	73.2	66.32	47	22.23	1008	1	0.23	-	-	-	-	-
		14	78	71.34	52	22.23	1108	1	0.32	-	-	-	-	-
		15	83.2	76.36	60	25.4	1210	1	0.32	60	25.4	1210	3	0.48
		16	88.3	81.37	71	25.4	1210/1610	1	0.37	76	25.4	1610	3	0.51
		17	93.3	86.39	71	25.4	1610	1	0.41	76	25.4	1610	3	0.57
		18	98.3	91.42	75	25.4	1610	1	0.51	76	25.4	1610	3	0.63
		19	103.3	96.45	75	25.4	1610	1	0.64	76	25.4	1610	3	0.71
		20	108.4	101.5	75	25.4	1610	1	0.68	76	25.4	1610	3	0.76
		21	113.4	106.5	76	25.4	1610	1	0.73	76	25.4	1610	3	0.86
		22	118.4	111.6	76	25.4	1610	1	0.78	76	25.4	1610	3	0.89
		23	123.5	116.6	76	25.4	1610	1	0.82	76	25.4	1610	3	0.98
		24	128.5	121.6	90	31.75	1610/2012	1	0.91	90	31.75	2012	2	3.31
		25	133.6	126.7	90	31.75	2012	1	1.069	90	31.75	2012	2	3.4
		26	138.6	131.7	90	31.75	2012	1	1.14	90	31.75	2012	2	3.42
		27	143.6	136.8	90	31.75	2012	1	1.18	90	31.75	2012	2	3.5
		28	148.7	141.8	90	31.75	2012	1	1.29	90	31.75	2012	2	3.6
		29	153.8	146.8	90	31.75	2012	1	1.26	90	31.75	2012	2	3.72
		30	158.8	151.9	90	31.75	2012	1	1.41	90	31.75	2012	2	3.92
		32	168.9	162	90	31.75	2012	1	1.63	-	-	-	-	-
33	174.5	167	90	31.75	2012	1	1.61	-	-	-	-	-		
35	184.1	177.1	90	31.75	2012	1	1.8	-	-	-	-	-		
36	189.1	182.2	90	31.75	2012	1	1.9	-	-	-	-	-		
38	199.1	192.2	90	31.75	2012	1	2.22	90	31.75	2012	2	5.68		
40	209.3	202.3	90	31.75	2012	1	2.32	-	-	-	-	-		
45	236	227.6	90	31.75	2012	1	2.95	-	-	-	-	-		
48	251.1	242.7	90	31.75	2012	1	3.25	-	-	-	-	-		
57	296.6	288.2	90	31.75	2012	1	4.59	110	44	2517/3020	2	14.45		
76	392.5	384.2	110	31.75	2012	1	8.31	110	44	2517/3020	2	29.85		
95	488.5	480.1	110	44.45	2517	1	12.76	-	-	-	-	-		
114	584.5	576.1	110	44.45	2517	1	17.63	-	-	-	-	-		

PINIONS	mm
Tooth Radius r3	
Radius Width C	
Tooth Width B1	9.1
Chain	mm
Pitch	15.88
Inside	9.65
Roller ø	10.2

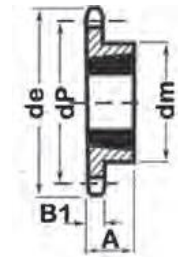

Type 1

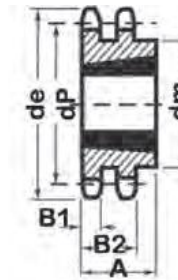

Type 2

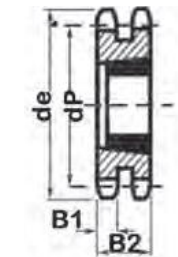

Type 3

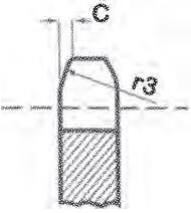
12B-1-2-3 TAPERLOCK		TEETH	de	dp	SIMPLEX				DUPLEX					TRIPLEX							
					dm	A	Bush	Type	App Kg	dm	A	Bush	Type	App Kg	dm	A	Bush	Type			
		12	81.5	73.6	60	25.4	1210	1	0.35	-	-	-	-	-	-	-	-	-			
		13	87.8	79.59	60	25.4	1210	1	0.41	60	25.4	1210	3	0.6	-	-	-	-			
		14	93.6	85.61	70	25.4	1610	1	0.5	-	-	-	-	-	-	-	-	-			
		15	99.8	91.63	70	25.4	1610	1	0.54	75	30.1	1610	3	0.9	-	49.8	1615	5			
		16	105.5	97.65	75	25.4	1610	1	0.67	75	30.1	1610	3	1.16	-	-	-	-			
		17	111.9	103.7	76	25.4	1610	1	0.82	75	30.1	1610/1615	3	1.25	-	49.8	1615/2017	5			
		18	117.9	109.7	90	31.75	1610/2012	1	0.91	90	31.75	2012	2	1.6	-	-	-	-			
		19	123.9	115.8	90	31.75	2012	1	1	90	31.75	2012	2	1.81	-	49.8	2012	5			
		PINIONS		mm	20	130	121.8	90	44.45	2012	1	1.1	108	44.45	2517	2	2.07	-	-	-	
		Tooth Radius r3			21	136	127.8	102	44.45	2517	1	1.18	108	44.45	2517	2	2.5	-	49.8	2517	5
		Radius Width C			22	142	133.9	102	44.45	2517	1	1.27	108	44.45	2517	2	2.6	-	-	-	-
		Tooth Width B1		11.1	23	148.1	139.9	108	44.45	2517	1	1.37	108	44.45	2517	2	3.07	-	49.8	2517	5
					24	154.1	145.9	108	44.45	2517	1	1.5	108	44.45	2517	2	3.17	-	-	-	-
					25	160.2	152	108	44.45	2517	1	1.64	108	44.45	2517	2	3.63	-	49.8	2517	5
		Chain		mm	26	165.9	158	108	44.45	2517	1	1.72	108	44.45	2517	2	3.78	-	-	-	-
		Pitch		19.05	27	172.3	164.1	108	44.45	2517	1	1.8	108	44.45	2517	2	4.2	140	50.8	3020	4
		Inside		11.68	28	178	170	108	44.45	2517	1	1.92	108	44.45	2517	2	4.45	-	-	-	-
		Roller ø		12.07	29	184.1	176.2	108	44.45	2517	1	2.12	108	50.8	2517	2	4.8	-	-	-	-
					30	190.4	182.3	108	44.45	2517	1	2.32	140	50.8	2517	2	5.04	140	50.8	3020	4
			32	202.5	194.4	108	44.45	2517	1	2.48	140	50.8	2517	2	5.91	-	-	-	-		
			34	214.6	206.5	108	44.45	2517	1	2.73	-	-	-	-	-	-	-	-	-		
			35	221	212.5	108	44.45	2517	1	2.85	-	-	-	-	-	-	-	-	-		
			36	226.8	218.6	108	44.45	2517	1	2.97	-	-	-	-	-	-	-	-	-		
			38	238.9	230.1	108	44.45	2517	1	3.36	140	50.8	3020	2	8.4	140	50.8	3020	4		
			45	283.2	273.1	108	44.45	2517	1	3.98	140	50.8	3020	2	-	-	-	-	-		
			57	355.9	345.8	108	44.45	2517	1	8.76	140	50.8	3020	2	19.48	160	50.8	3020	4		
			76	471.1	461	108	44.45	2517	1	11.68	140	50.8	3020	2	29.52	160	50.8	3020	4		
			95	586.2	576.2	108	44.45	2517	1	14.36	140	50.8	3020	2	34.4	-	-	-	-		
			114	701.4	691.4	140	50.8	3020	1	17.52	140	76.2	3030	2	39.28	-	-	-	-		

Every effort has been taken to ensure that the data listed in this catalogue is correct.
Industrial World will not accept liability for any damage or loss caused as a result of the data in this catalogue.

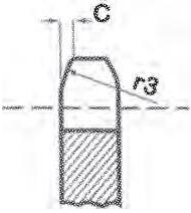
16B-1-2-3 TAPERLOCK		TEETH	de	dp	SIMPLEX				DUPLEX					TRIPLEX				
					dm	A	Bush	Type	App Kg	dm	A	Bush	Type	App Kg	dm	A	Bush	Type
		12	109	98.14	73	25.4	1610	1	1.15	-	-	-	-	-	-	-	-	-
		13	117.7	106.1	73	38.1	1610/1615	1	1.27	-	47.7	2012	-	-	-	-	-	-
		14	125	114	76	38.1	1610	1	1.34	-	-	-	-	-	-	-	-	-
		15	133.7	122.2	78	38.1	1610/1615	1	1.45	-	47.7	2012	3	2.04	-	47.7	2012	5
		16	141.8	130.2	78	38.1	1615/2012	1	1.55	-	47.7	2517	3	2.11	-	-	-	-
		17	149.8	138.2	90	32	2012/2517	1	1.69	-	47.7	2517	3	2.5	-	79.6	2517	5
		18	157.8	146.3	108	44.45	2517	1	1.46	-	47.7	2517	3	2.81	-	-	-	-
		19	165.9	154.4	108	44.45	2517	1	2.14	-	47.7	2517	3	3.18	-	79.6	3030	5
		20	173.9	162.4	108	44.45	2517	1	2.72	-	47.7	2517	3	3.78	-	-	-	-
		PINIONS		mm														
Tooth Radius r3																		
Radius Width C																		
Tooth Width B1		16.2																
Chain		mm																
Pitch		25.4																
Inside		17.02																
Roller ø		15.88																
		21	182	170.4	110	44.45	2517	1	2.95	140	50.8	3020	2	3.95	79.6	3030/3535	5	
		22	190.1	178.5	110	44.45	2517	1	3.18	140	50.8	3020	2	5.04	-	-	-	
		23	198.1	186.5	110	44.45	2517	1	3.4	140	50.8	3020	2	5.48	89	3525/3535	5	
		24	206.2	194.6	110	44.45	2517	1	3.63	140	50.8	3020	2	6.56	-	-	-	
		25	214.2	202.7	110	44.45	2517	1	3.9	140	50.8	3020	2	7.72	89	3535	5	
		26	221.6	210.7	110	44.45	2517	1	4.2	140	50.8	3020	2	8.37	-	-	-	
		27	230.4	218.8	110	44.45	2517	1	4.31	140	50.8	3020	2	9.32	89	3535	5	
		28	237.7	226.8	110	44.45	2517	1	4.71	140	50.8	3020	2	10.45	-	-	-	
		29	245.8	234.9	120	44.45	2517/3020	1	5.15	140	50.8	3020	2	11.59	-	-	-	
		30	254.6	243	120	44.45	2517/3020	1	5.44	140	50.8/76.2	3020/3030	2	12.35	175	89	3525/3535	4
		32	20.7	259.1	140	50.8	3020	1	5.91	-	-	-	-	-	-	-	-	
		33	278.5	267.2	140	50.8	3020	1	6.52	-	-	-	-	-	-	-	-	
		35	294.9	283.4	140	50.8	3020	1	7.12	-	-	-	-	-	-	-	-	
		38	319.2	307.6	140	50.8	3020	1	8.85	160	76.2	3020/3030	2	21.79	178	89	3535	4
		45	377.9	364.1	140	50.8	2517/3020	1	12.25	-	76.2	3020	-	-	-	-	-	
		57	474.9	461.1	140	50.8	3020	1	19.16	175	86.9	3525	2	27.24	216	102	4040	4
		76	628.4	614.7	140	50.8	3020	1	28.55	175	86.9	3535	2	37.68	216	102	4030/4040	4
		95	782	768.2	140	50.8	3020	1	41.58	-	-	-	-	-	-	-	-	
		114	935.6	921.8	140	50.8	3020	1	56.15	-	-	-	-	-	-	-	-	

Every effort has been taken to ensure that the data listed in this catalogue is correct.
Industrial World will not accept liability for any damage or loss caused as a result of the data in this catalogue.

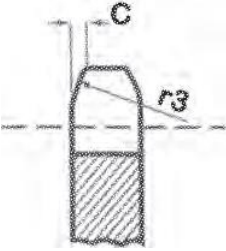
20B-1 TAPERLOCK		TEETH	de	dp	SIMPLEX			
					dm	A	Bush	Type
		9	106.5	92.84	63	40	2012	1
		10	117	102.7	70	40	2012	1
		11	127	112.7	77	45	2517	1
		12	137	122.7	88	45	2517	1
		13	147.5	132.7	98	45	2517	1
		14	157.6	142.7	108	45	2517	1
		15	167.6	152.7	118	45	2517	1
		16	177.7	162.8	120	50	2517	1
		17	187.8	172.8	120	50	2517	1
		18	197.8	182.9	120	50	2517	1
		19	207.9	192.9	120	50	2517	1
		20	217.9	203	120	50	2517	1
		21	228	213	140	55	2517	1
		22	238.1	223.1	140	55	2517	1
		23	248.2	233.2	140	55	2517	1
		24	258.3	243.2	140	55	2517	1
		25	268.4	253.3	140	55	2517	1
		26	278.4	263.4	150	55	2517	1
		27	288.5	273.5	150	55	3020	1
		28	299	283.6	150	55	3020	1
		29	308.8	293.6	150	55	3020	1
30	319	303.8	150	55	3020	1		
38	399.6	384.5	160	55	3020	1		
PINIONS		mm						
Tooth Radius r3								
Radius Width C								
Tooth Width B1		18.5						
Chain		mm						
Pitch		31.75						
Inside		19.56						
Roller ø		19.05						

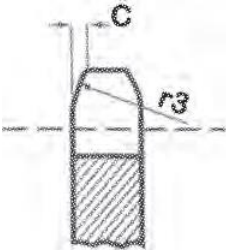
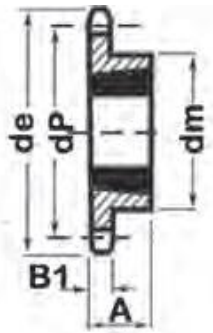
24B-1 TAPERLOCK		TEETH	de	dp	SIMPLEX			
					dm	A	Bush	Type
		19	246.5	231.5	133	50.8	3020	1
		23	294.8	279.8	133	50.8	3020	1
PINIONS		mm						
Tooth Radius r3								
Radius Width C								
Tooth Width B1		18.5						
Chain		mm						
Pitch		31.75						
Inside		19.56						
Roller ø		19.05						
		 <p style="text-align: center;">Type 1</p>						