



OWNER'S MANUAL

HOSE REELS

REWINDA

April 2025



AR1220CWB



AR1225GWG



AR1217HWR



AR1020WPR



AR1215OB



AR1020HPWR



AR615OAR



AR615OPR



AR1220CAWB



AR1020CAWB



AR620OAR



AR620OPR

NSW/ACT (02) 9677 1555
WA (08) 9302 4199

QLD/PNG (07) 3491 2600
SA/NT (08) 8241 7111

VIC/TAS (03) 8787 8288
NZ (09) 447 1007

www.alemlube.com.au
www.alemlube.co.nz





OWNER'S MANUAL

HOSE REELS

REWINDA

Alemlube is pleased to announce the release of our new Rewinda Series of hose, cable & barrier reels.

The range has been researched, designed & engineered in conjunction with our long-standing, industry leading plastic covered hose reel partner with the result being an exciting range of innovative, safe, ergonomic, durable and aesthetically pleasing hose reels.

Replacing the S Series as released in 2008, this new versatile & complete range meets market needs and is set to exceed industry expectations.

The patented speed rewind control system, as included on all models, ensures that the hose retracts at a safe & steady speed, resulting in a safe operating environment, minimising the chance of damage to workshop equipment, and in some instances, customers' vehicles.

The unique, & also patented, stop-at-any-point latching system secures the hose at the exact desired length each and every time, the sliding guide system ensures that the hose returns neatly and evenly onto the barrel assembly, and the next level UV stabilised covers won't fade over time.

The Gen3 hybrid polymer hose & hose bend restrictors (the latter on all models) ensure a long service life for your hose assemblies.

With a 10 year warranty on materials & workmanship and a no exclusions 2 year warranty on wearing parts such as o'rings, seals, hose assemblies, springs and bushes, the new Rewinda Series of hose reels is set to be the new on-point hose storage and retrieval solution in mining, construction, Ag, transport and automotive sectors in Australia, New Zealand and Papua New Guinea.



OWNER'S MANUAL

HOSE REELS

REWINDA

READ INSTRUCTIONS BEFORE OPERATING

GENERAL SAFETY REGULATIONS



WARNING: The warnings, cautions, and instructions discussed in this instruction manual cannot cover all possible conditions or situations that could occur. It must be understood by the operator that common sense and caution are factors that cannot be built into this product, but must be supplied by the operator.

1. Keep the work area clean and dry. Damp or wet work areas can result in injury.
2. Keep children away from work area. Do not allow children to handle this product.
3. Use the right tool for the job. Do not attempt to force small equipment to do the work of larger industrial equipment. There are certain applications for which this equipment was designed. It will do the job better and more safely at the capacity for which it was intended. Do not modify this equipment, and do not use this equipment for a purpose for which it was not intended.
4. Check for damaged parts. Before using this product, carefully check that it will operate properly and perform its intended function.
Check for damaged parts and any other conditions that may affect the operation of this product. Replace damaged or worn parts immediately.
5. Do not overreach. Keep proper footing and balance at all times to prevent tripping, falling, back injury, etc.
6. DO NOT use the equipment when tired or under the influence of drugs, alcohol, or medication. A moment of inattention while operating this equipment may result in serious personal injury.



OWNER'S MANUAL

HOSE REELS

REWINDA

1. DISCLAIMER

Before operation, please read and understand all instructions carefully. The operation is allowed only under strict compliance with safety precautions and other basic safety measures. The company is not responsible for any personal injury or property damage caused by human factors or abnormal use.

2. TECHNICAL DETAILS

LOW PRESSURE HOSE REEL

Item No.	Hose Reel Type	Max. Pressure	Hose Working Temperature	Hose Capacity			Inlet	Outlet
				Material	I.D.	Length		
AR1020CAWB	Air/Water	300psi/20bar	0°C~60°C	PVC	3/8"	20m	3/8" BSPT (M)	3/8" BSPT (M)
ALE01.04	Air/Water	300psi/20bar	0°C~60°C	PVC	1/2"	20m	1/2" BSPT (M)	1/2" BSPT (M)
AR1220CWB	Cold Water	300psi/20bar	-20°C~60°C	PU	1/2"	20m	1/2" BSPT (M)	1/2" BSPT (M)
AR1225GWG	Cold Water	150psi/10bar	0°C~60°C	PVC	12mm	25m	3/4" BSP (F)	Quick Connector (F)
AR1217HWR	Hot Water	300psi/20bar	-40°C~90°C	EPDM	1/2"	17m	3/4" BSP (F)	1/2" BSPT (M)
AR1020WPR	Weedcide/Pesticide	300psi/20bar	0°C~60°C	PVC	3/8"	20m	3/8" BSPT (M)	1/4" BSPT (M)

MEDIUM PRESSURE HOSE REEL

Item No.	Hose Reel Type	Max. Pressure	Hose Working Temperature	Hose Capacity			Inlet	Outlet
				Material	I.D.	Length		
AR1215OB	Oil	2320psi/160bar	-40°C~100°C	S.A.E.100R1AT Wire Braid	1/2"	15m	1/2" BSP (F)	1/2" BSPT (M)
AR1020HPWR	High Pressure Washer	3000psi/206bar	-40°C~120°C	S.A.E.100R2AT Wire Braid	3/8"	20m	3/8" BSP (F)	3/8" BSPT (M)

HIGH PRESSURE HOSE REEL

Item No.	Hose Reel Type	Max. Pressure	Hose Working Temperature	Hose Capacity			Inlet	Outlet
				Material	I.D.	Length		
AR615GB	Grease	5800psi/400bar	-40°C~100°C	S.A.E.100R2AT Wire Braid	1/4"	15m	1/4" BSP (F)	1/4" BSPT (M)

DOUBLE WELDING HOSE REEL

Item No.	Hose Reel Type	Max. Pressure	Hose Working Temperature	Hose Capacity			Inlet	Outlet
				Material	I.D.	Length		
AR615OAR	OXY/Acetylene	300psi/20bar	-30°C~60°C	Rubber	1/4"	15m	5/8" UNF (F) / 5/8" UNF (F) -L	5/8" UNF (F) / 5/8" UNF (F) -L
AR615OPR	OXY/Propane (OXY/LPG)	300psi/20bar	-30°C~60°C	Rubber	1/4"	20m	5/8" UNF (F) / 5/8" UNF (F) -L	5/8" UNF (F) / 5/8" UNF (F) -L

SINGLE WELDING HOSE REEL

Item No.	Hose Reel Type	Max. Pressure	Hose Working Temperature	Hose Capacity			Inlet	Outlet
				Material	I.D.	Length		
AR620AR	Argon	300psi/20bar	-30°C~60°C	Rubber	1/4"	15m	5/8" UNF (F)	5/8" UNF (F)
AR620PR	Propane (LPG)	300psi/20bar	-30°C~60°C	Rubber	1/4"	15m	5/8" UNF (F) -L	5/8" UNF (F) -L



OWNER'S MANUAL

HOSE REELS

REWINDA

3. INSTALLATION INSTRUCTIONS

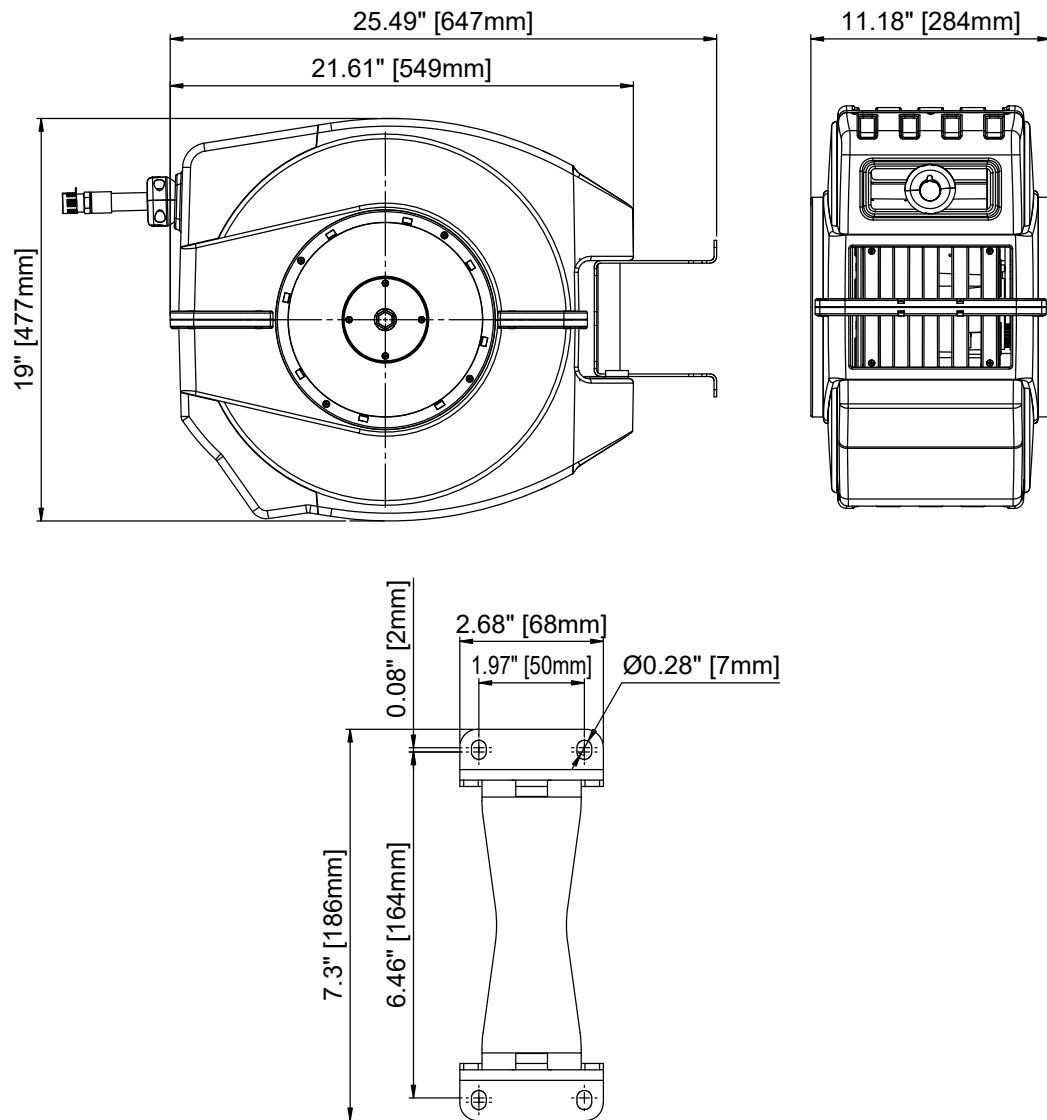

Fig.01



OWNER'S MANUAL

HOSE REELS

REWINDA

4. SAFETY PRECAUTIONS

1. Use proper eye protection when assembling and using the hose reel.
2. Keep children away from the work area.
3. Personal injury and/or equipment damage may result if proper safety precautions are not observed.
4. Ensure that reel is properly installed before connecting input and output hoses.
5. Bleed fluid/gas pressure from system before servicing reel.
6. Before connecting reel to supply line ensure that pressure does not exceed maximum working pressure rating of reel.
7. Remember, even low pressure is very dangerous and can cause personal injury or death.
8. If a leak occurs in the hose or reel, remove system pressure immediately.
9. Ensure that reel, hose, and equipment being service are properly grounded.
10. If reel ceases to unwind or rewind, remove system pressure immediately.
11. Do not pull or jerk on hose.
12. When recycling the product, please do not release the hose by hand.

⚠ WARNING

Exposure of skin directly to pressurized air, or fluids could result in severe bodily injury.

5. INSTALLATION

Installation of Reel (Fig.02)

1. For overhead ceiling mounting: install reel at most, 3m above the floor.
2. You will need to purchase appropriate hardware for the mounting of your new reel.
3. The reel base has four 7mm (9/32") drilled holes for mounting on a suitable flat surface. Figure 2 is a template showing the correct location of the 4 mounting holes in the base.
4. Using the four holes in the base, mount the reel in the desired location. Be sure to use appropriate hardware and to tighten the reel securely to the mounting location.
5. Apply Teflon tape or pipe sealant to the outlet fitting on the hose & then attach to desired tool or nozzle. Check connection for any leakage & check the reel for correct operation. See operation section. If hose stop adjustment is required, pull hose from reel and allow the reel to latch at the desired length. Loosen hose stop bolts and slide hose stop to a position close to the hose guide. Tighten hose stop bolts and unlatch the reel.

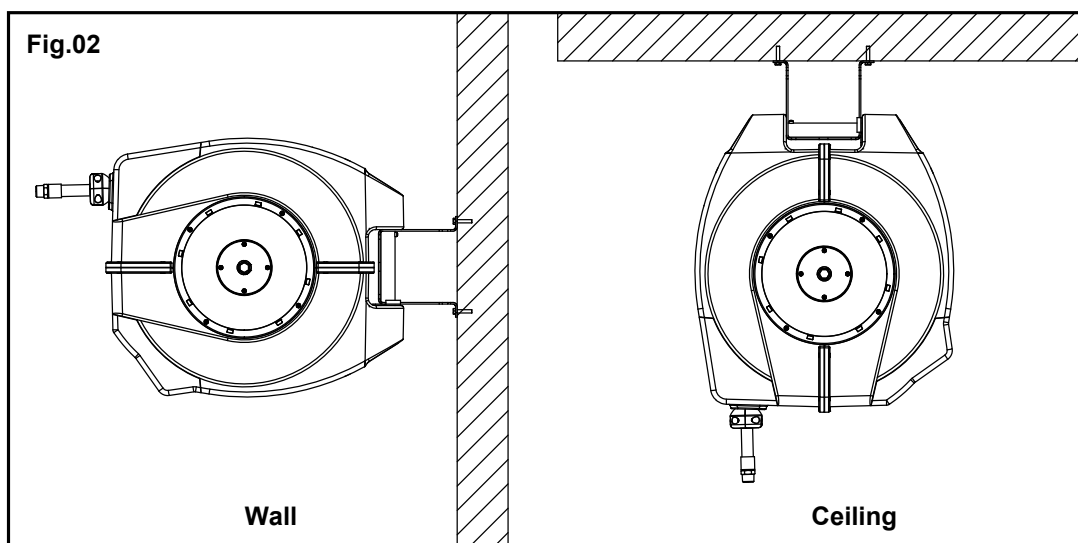

6. The installation of the fixing plate shown in the diagram is optional. Once installed, the cable/cord reel body is fixed and cannot be rotated.
7. If not installed, the cable/cord reel could be swivel up to 180°. (**Fig.03**)

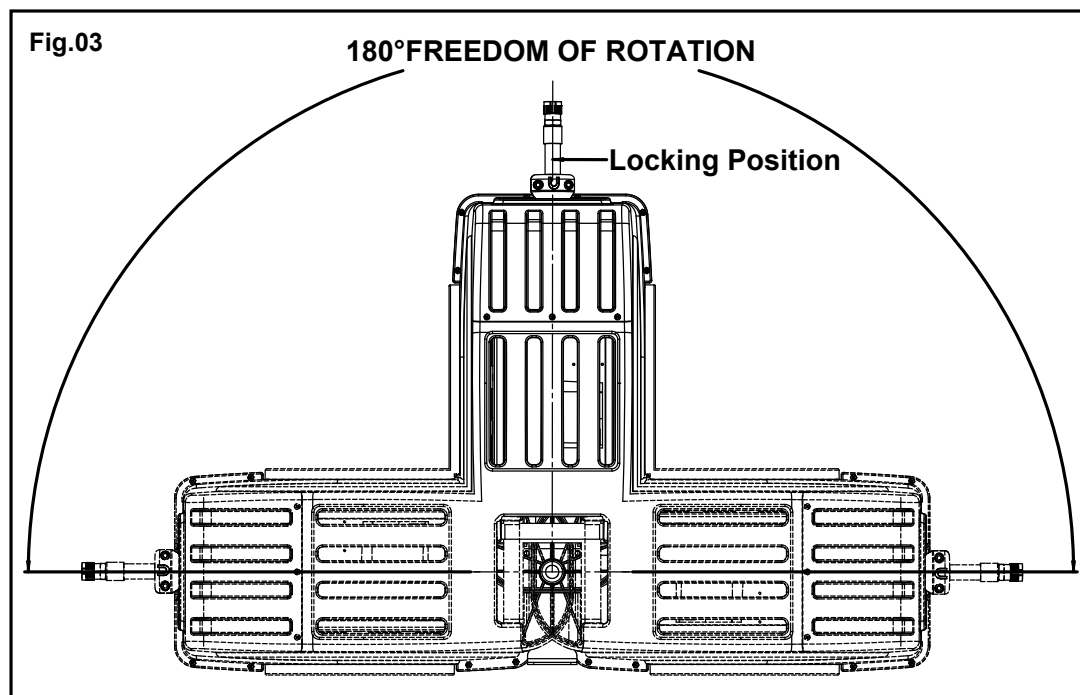

8. Ensure the elastic clip is installed properly, and is located at the lower end of the handle on the housing. (**Fig.04**)

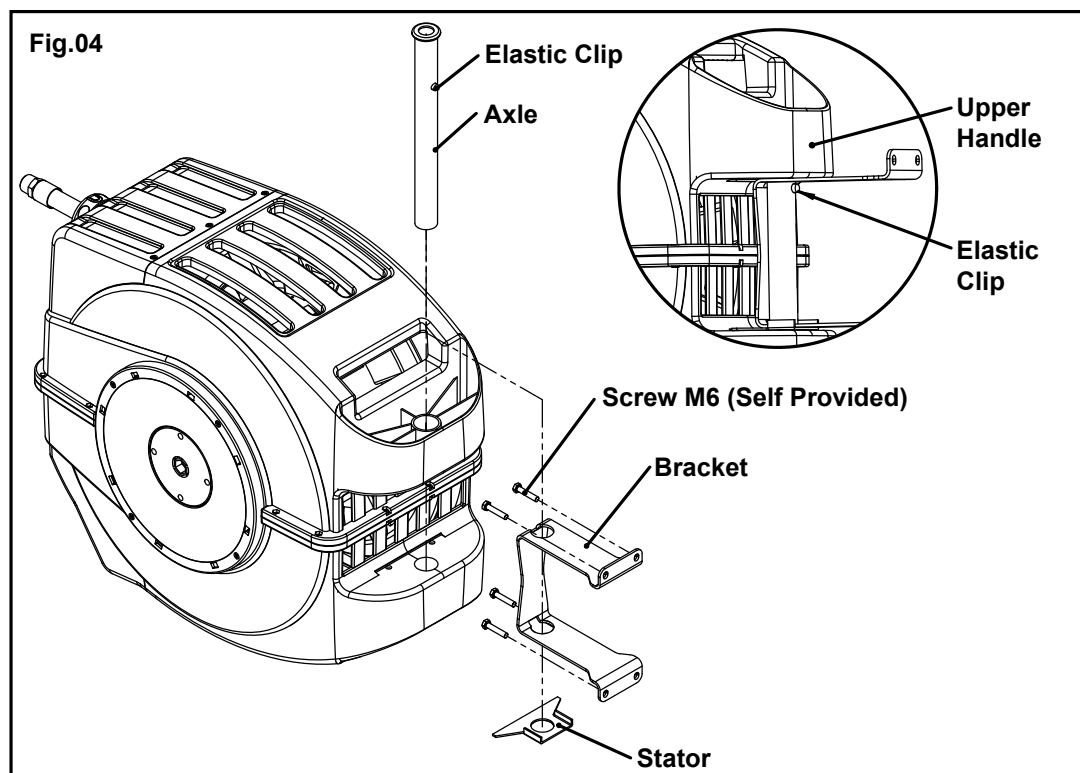

6. OPERATION

1. Check reel for correct operation by slowly pulling out the hose.
2. To latch the reel, slowly pull out the hose to any point, Relax the hose to stop. Note: it can not exceed the back end mark When the hose is pulled out.
3. To unlatch the reel, slowly pull the hose after relax, and then let the hose retract until the hose stop rests against the hose guide.
Note: To avoid damage to the reel, always hold on to the hose while it is rewinding.
4. Periodically check the hose condition for wear or damage, and check the swivel fitting for leakage. Replace any worn, damaged, or leaking parts.

⚠ WARNING

Do not open the cover at will. It is very dangerous and can cause personal injury or death. (Fig.05)

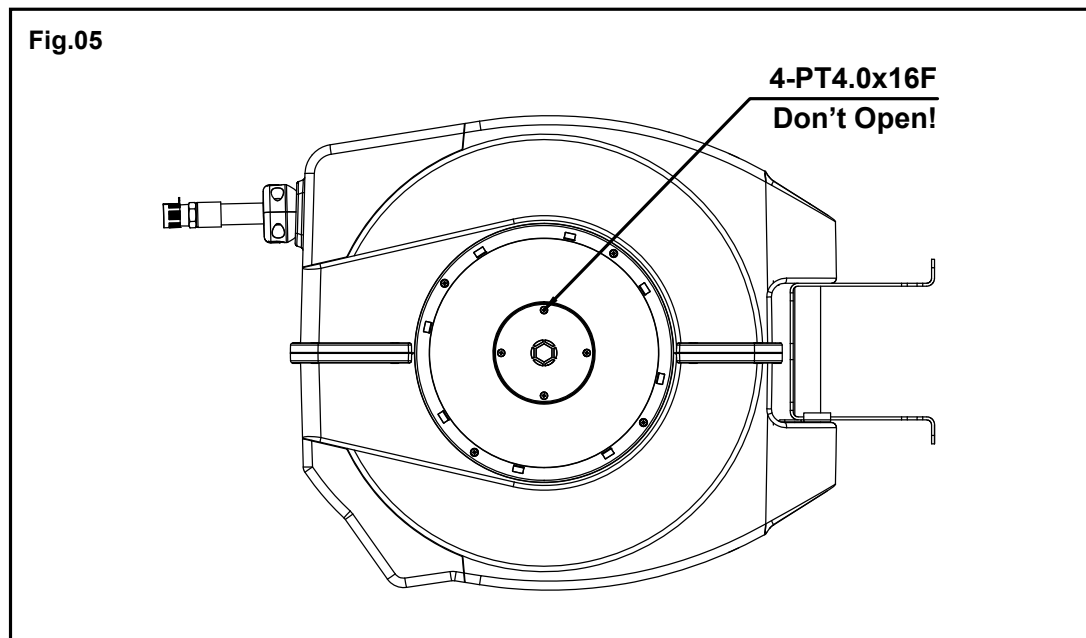

7. MAINTENANCE

1. Make sure the hose is in proper working order.
2. Clean the hose with a cloth dipped in warm water to remove dirt or deposits and ensure correct rewinding.
3. Do not use detergents or solvents which could prove incompatible with cable-winder materials.
4. If the event of having to perform maintenance on the electrical, mechanical parts or replace the cable, contact an authorized after-sale service center.
5. Dismantling of the unit by unskilled personal could prove hazardous; the risk involved mainly concern the preloaded springs.



OWNER'S MANUAL

HOSE REELS

REWINDA

8. ASSEMBLY

CAUTION

Remove all tension before servicing. Hazards or unsafe practices **MAY** result in minor personal injury, product or property damage.

WARNING

Before performing any service, always disconnect and lock out compressed air or fluid, and remove all spring tension.

Hazards or unsafe practices **COULD** result in severe personal injury or death.

8.1 Adjusting the Spring Force Steps

1. Secure the reel on a flat surface to prevent it from rotating.
2. Insert your hex key tool into the central groove of the pre-tensioned end cap.
3. Press down on the hex key handle, applying a clockwise force, and then proceed to unscrew the 4 screws on the pre-tensioned end cap one by one (after removing the screws, do not release the hex key which should be slowly rotated in sync with the pre-tensioned end cap).
4. Firmly grip the hex key and rotate clockwise to increase the spring pre-tension force; rotate counterclockwise to decrease the spring pre-tension force.
5. As the hex key turns the pre-tensioned end cap counterclockwise several times, the spring pre-tension force will gradually be released until all the pre-tension force is released, at which point the hex key will no longer be under tension to rotate.

CAUTION

When adding wraps of hose, be careful not to exceed the winding mechanism's spring capacity. Add just enough wraps of hose to achieve the desired tension.

Damage to the winding mechanism will result if spring is over-tensioned.

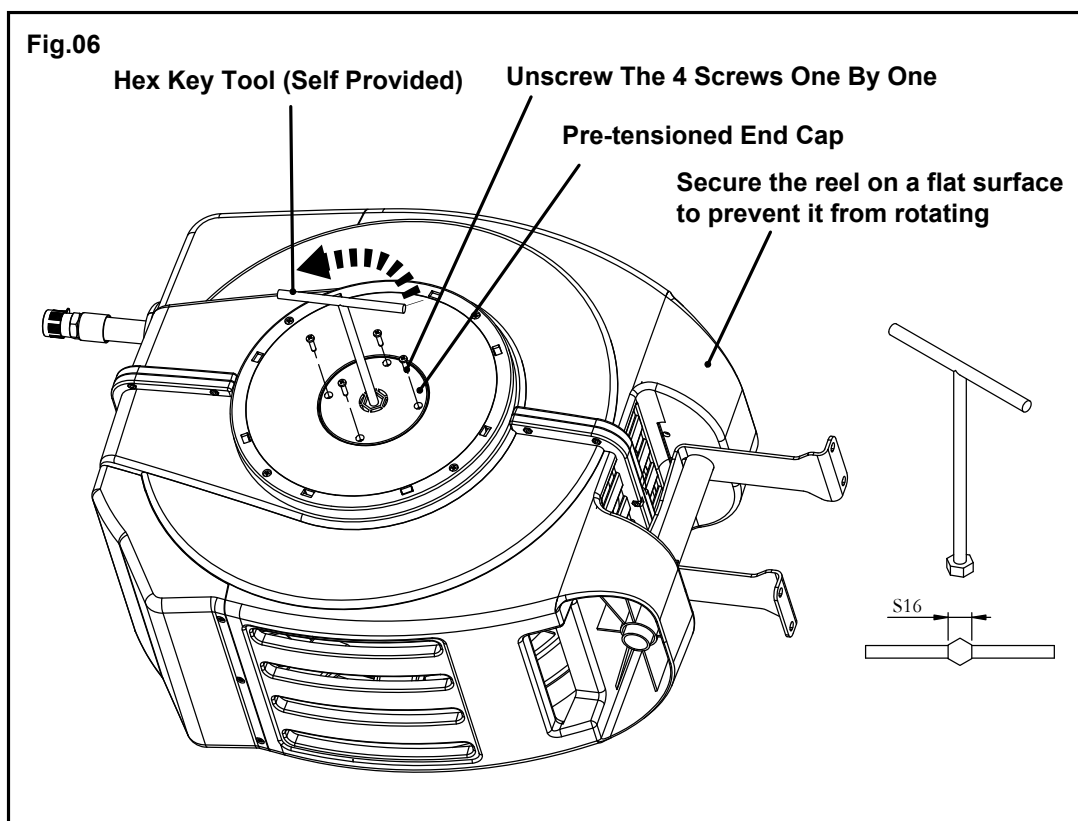

8.2 Replace the Guiding System Assembly

1. Remove the 4 screws on the tensioning end cap, release all spring force (refer to the spring force adjustment steps), and take out the tensioning end cap. **(Fig.07-1)**
2. Remove the 4 screws on the side cover, rotate the side cover counterclockwise, and remove the side cover. **(Fig.07-2)**

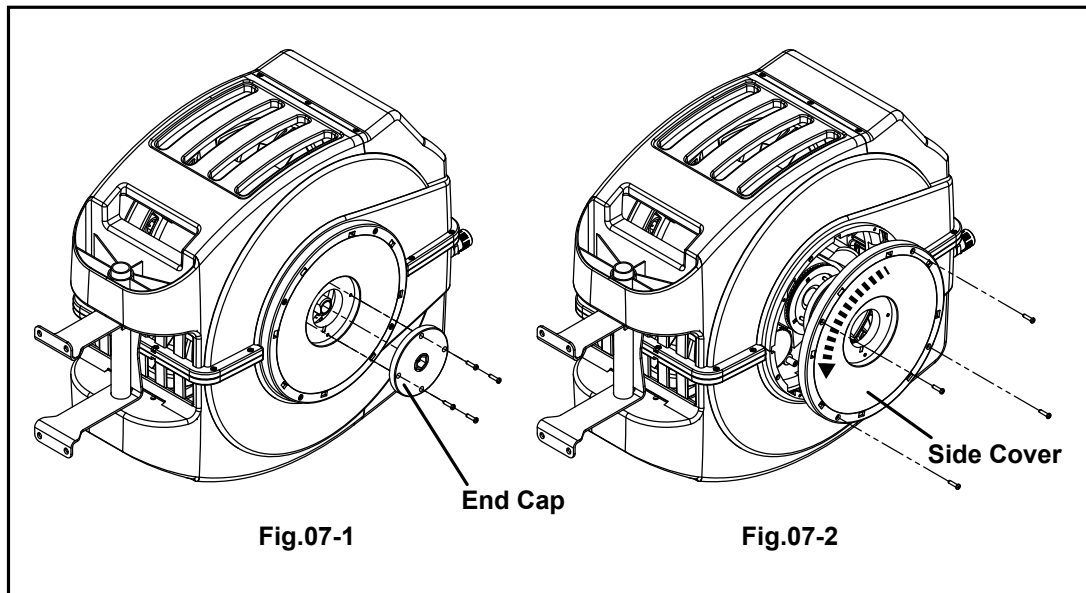

3. Remove the synchronous belt from the large synchronous wheel. **(Fig.08)**

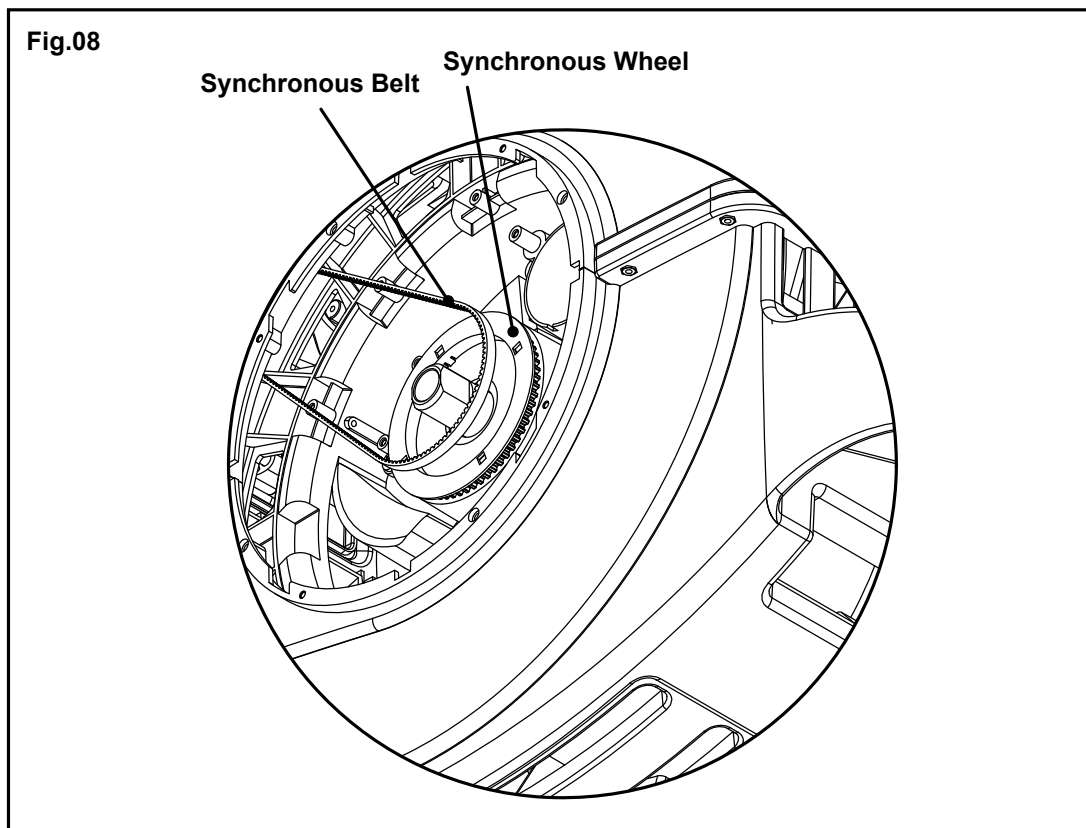

4. Remove the screws and nuts on the pipe stop block, and at the same time, remove the 5 screws on the upper outlet cover.
5. Lift the upper outlet cover upward and remove it along the direction of the pipe. **(Fig.09)**

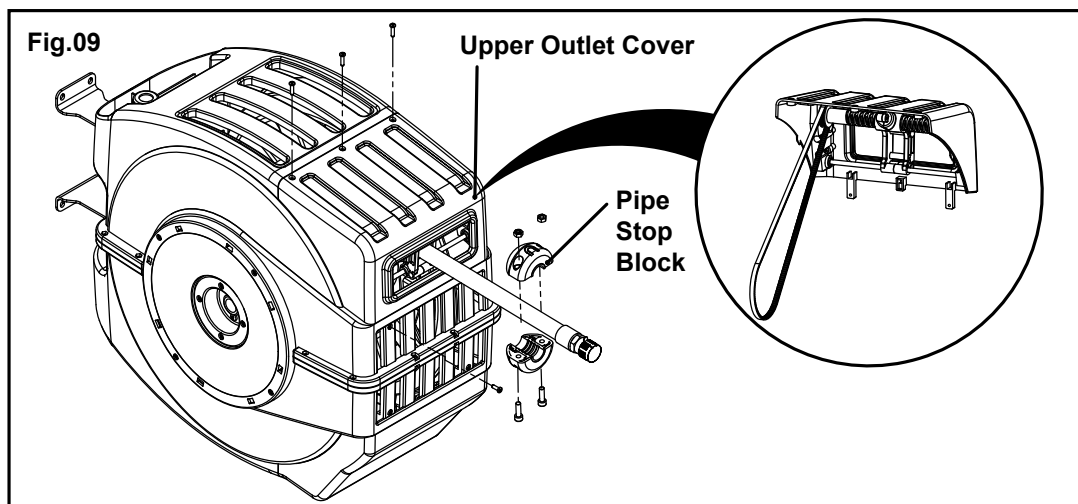

6. Remove the 6 screws on the outlet side plate, take out the synchronous belt, remove the guiding assembly along the sorting rod, and replace it with a new guiding assembly. **(Fig.10-1)**

⚠ WARNING

1. It is essential to ensure that the position of the new hose guiding system bracket matches the position of the old guiding system bracket, and that the movement direction of the bracket is consistent when the sorting shaft rotates (as shown in the figure). If they differ, adjustments must be made to align them. **(Fig.10-2)**
2. Before and after disassembling the upper outlet cover, the relative distance to the hose should not change. You can make markings on the hose before disassembly. **(Fig.10-3)**

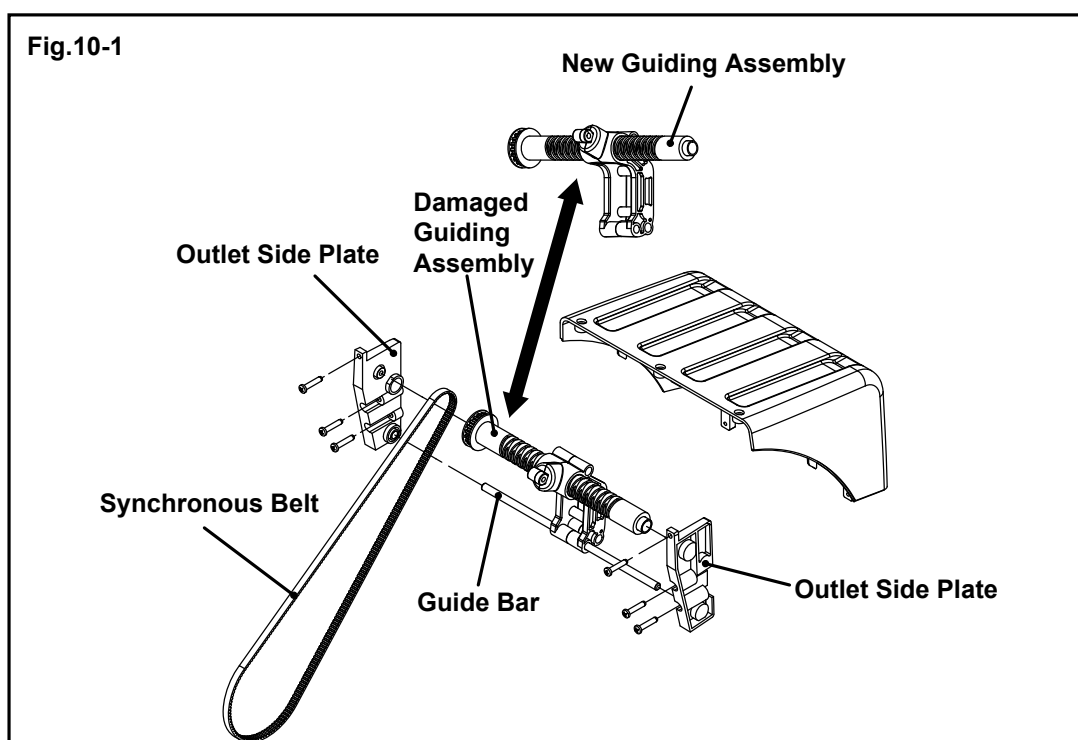

Fig.10-2

Ex:

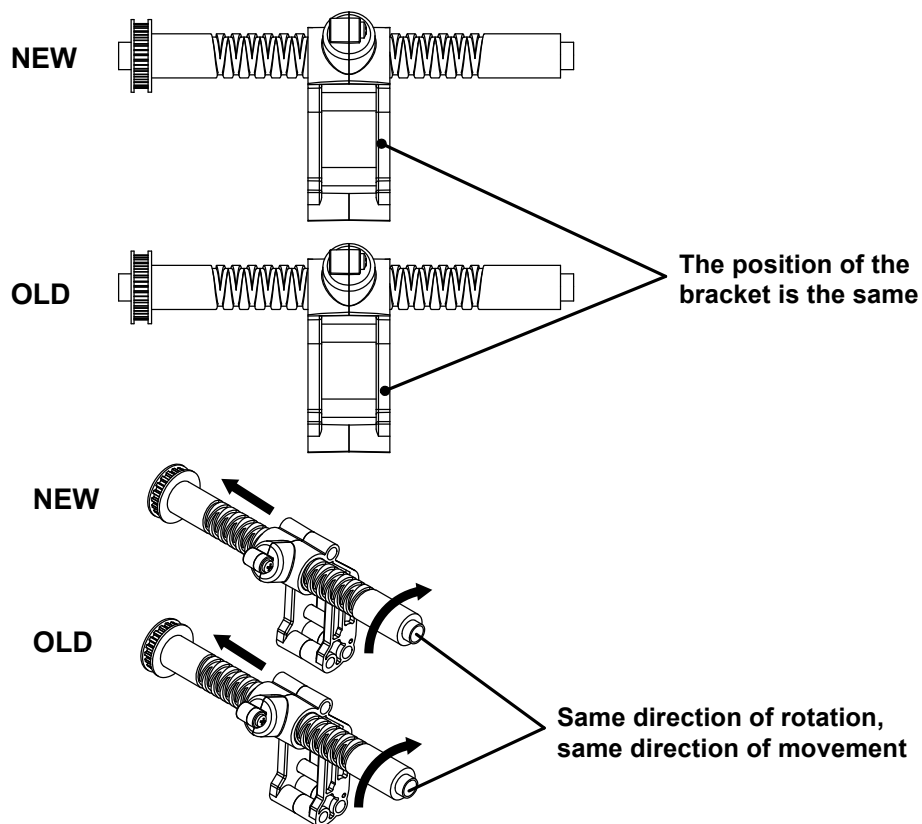
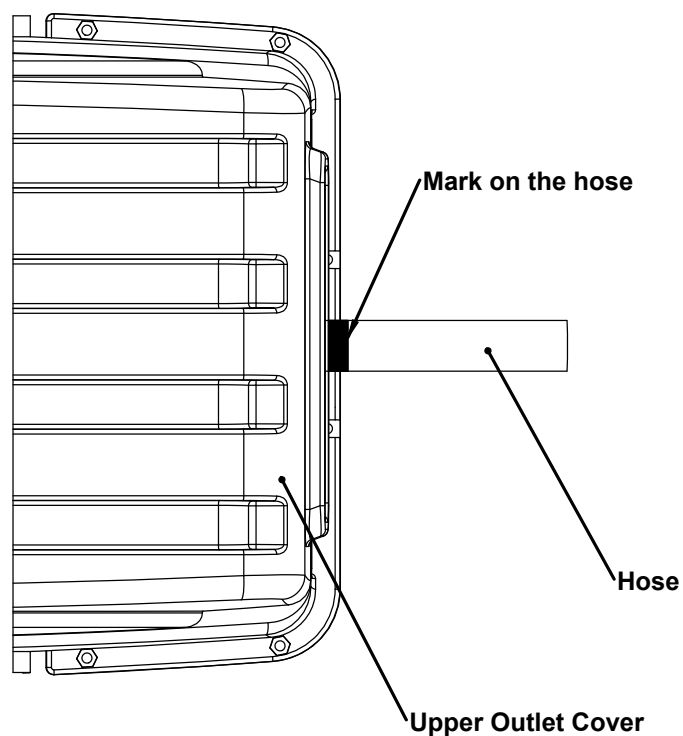
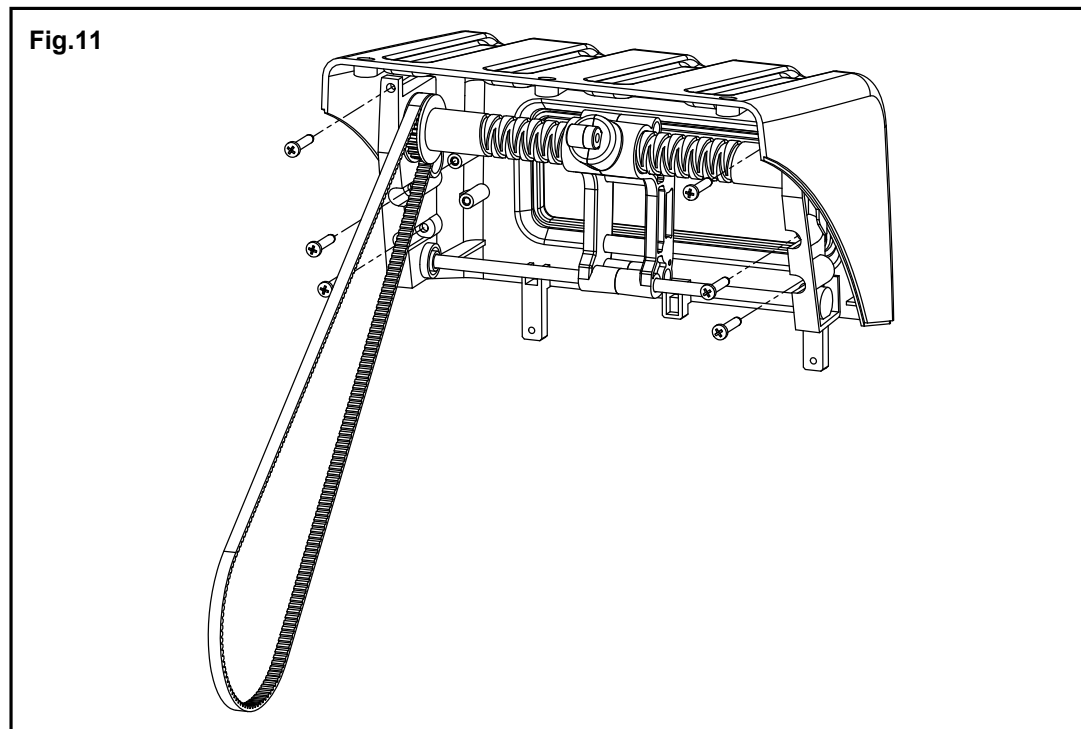

Fig.10-3



7. Insert the side plate into the corresponding slot on the upper outlet cover, and tighten the 6 screws on the side plate. **(Fig.11)**



8. After the upper outlet cover passes through the pipe, insert the latch into the slot on the housing. **(Fig.12)**

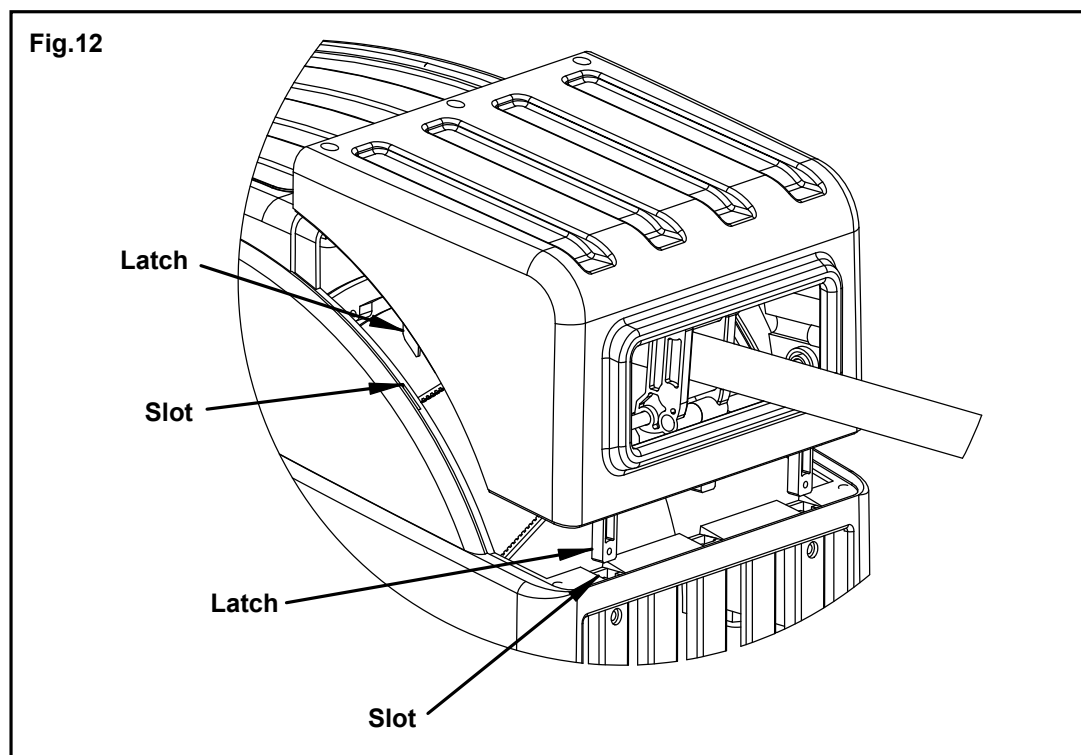

9. Tighten the 5 connecting screws between the outlet cover and the housing, and tighten the screws and nuts on the stop block. **(Fig.13)**

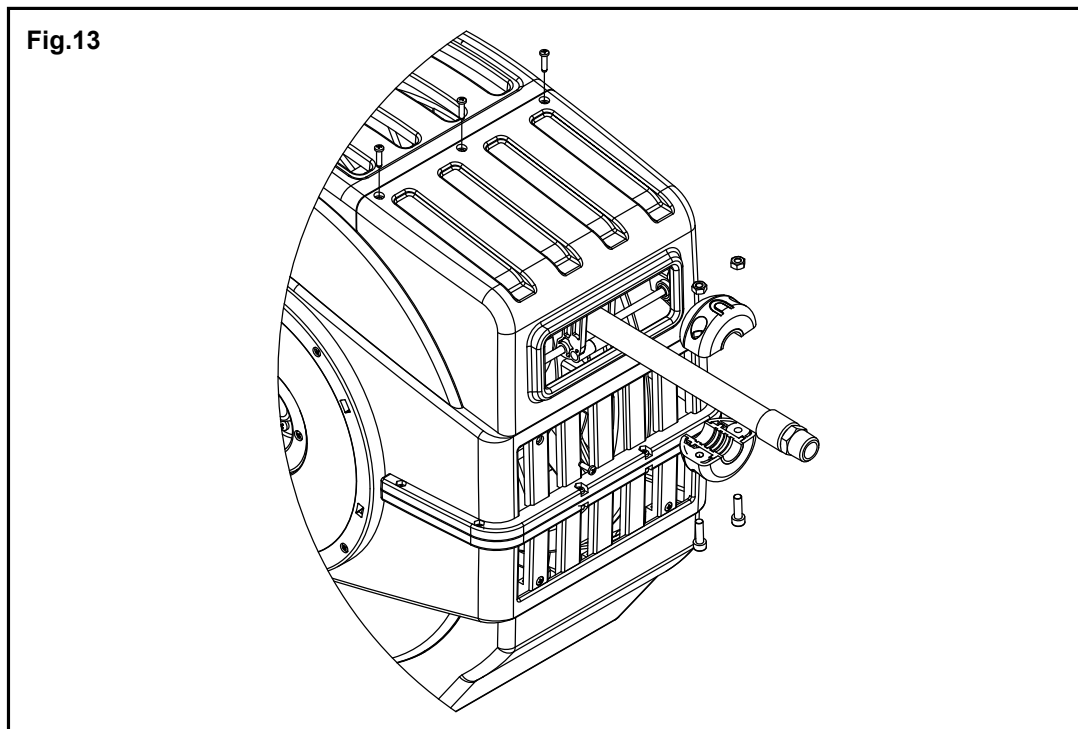

10. The synchronous belt wraps around the large synchronous wheel. **(See Fig.14)**

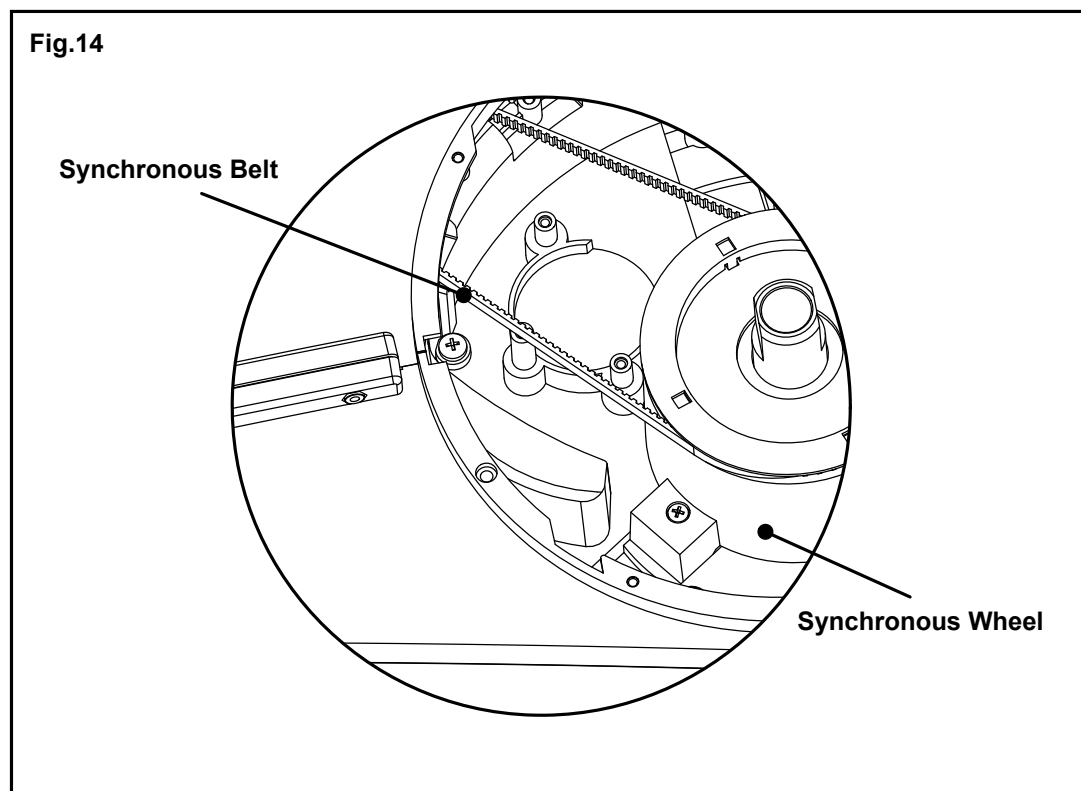

11. Align the identification mark on the side cover upward with the top of the housing, insert it into the housing slot, and ensure that the tensioning column is on the outside of the synchronous belt.
12. Rotate the side cover clockwise, align the screws on the top of the housing, and tighten the screws. (See Fig.15)

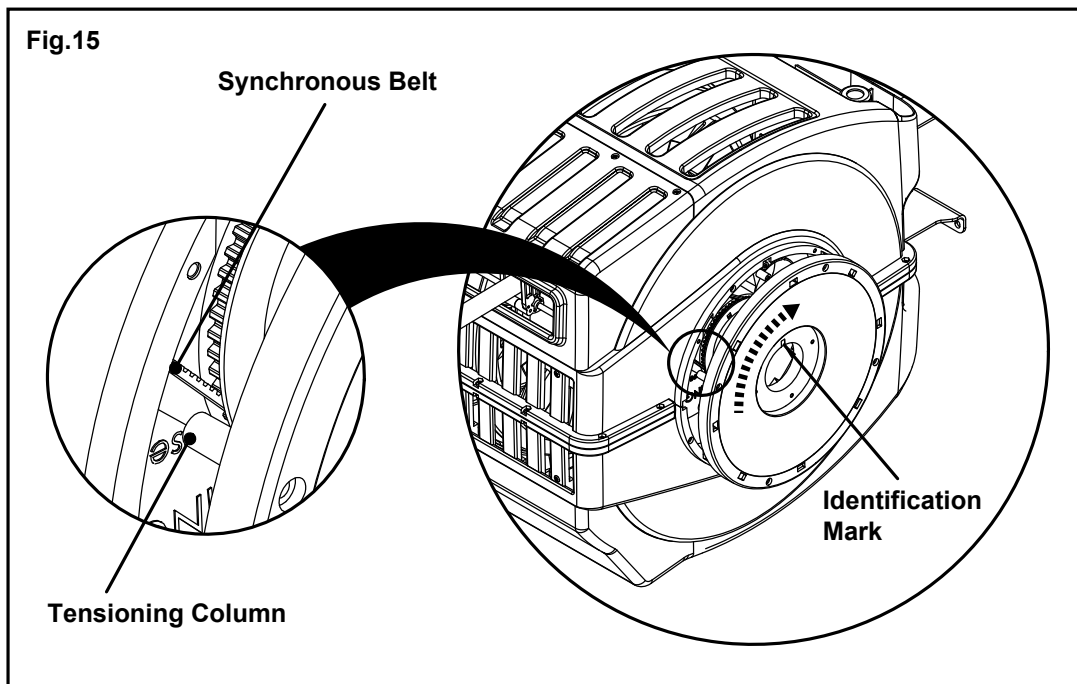

13. After aligning the flat slot in the tensioning end cap with the central metal shaft, press it down.
14. Fix the reel on a flat surface, insert a hex wrench into the center slot of the tensioning end cap, press down, rotate clockwise for 3-5 turns, align with the screw hole on the side cover, tighten the screws to complete the tensioning. (Fig.16)

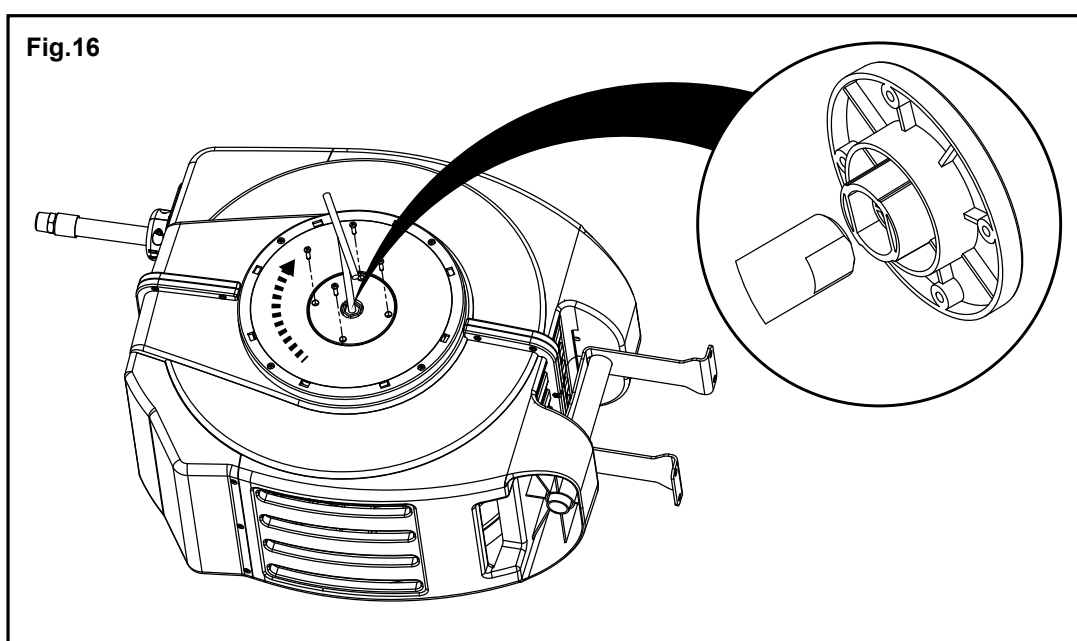

8.3 Replace the Stop-at-any-point/Slow Retraction Assembly

⚠ WARNING

Ensure the importing pipe is removed before replacing.

Tip: No need to release spring force before replacing.

1. Remove the screws on the end cap and take out the end cap.
2. Remove the 4 screws on the side cover, rotate the side cover counterclockwise, and remove the side cover (Fig.17). High pressure hose reel (Fig.17-2).

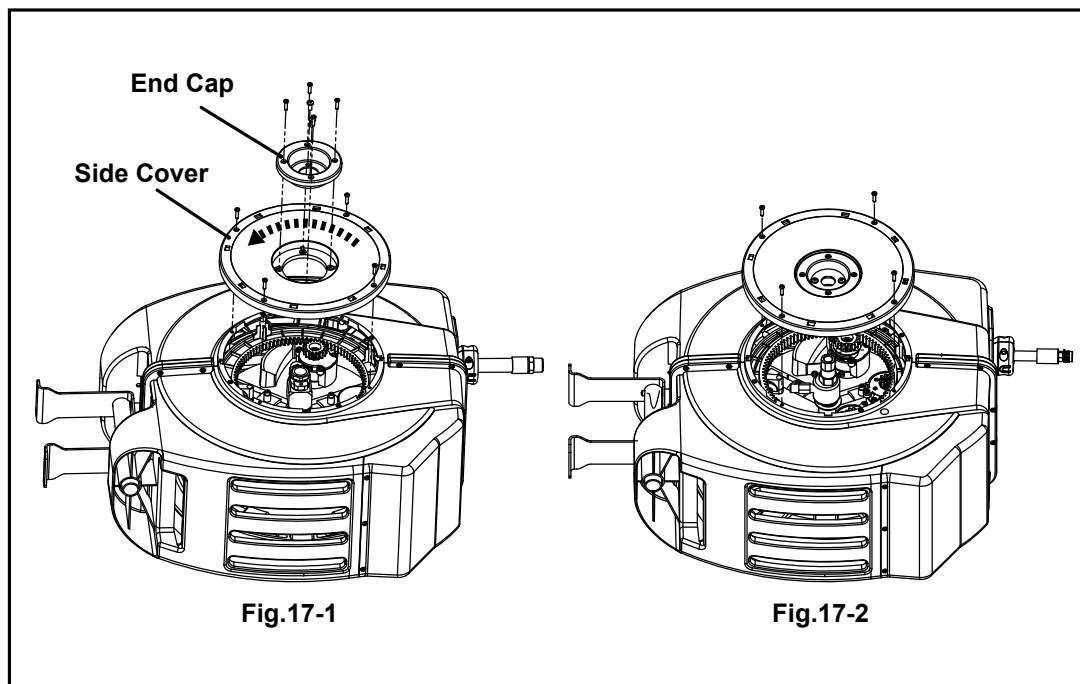

3. Remove the 4 screws of the large gear ring. (Fig.18)

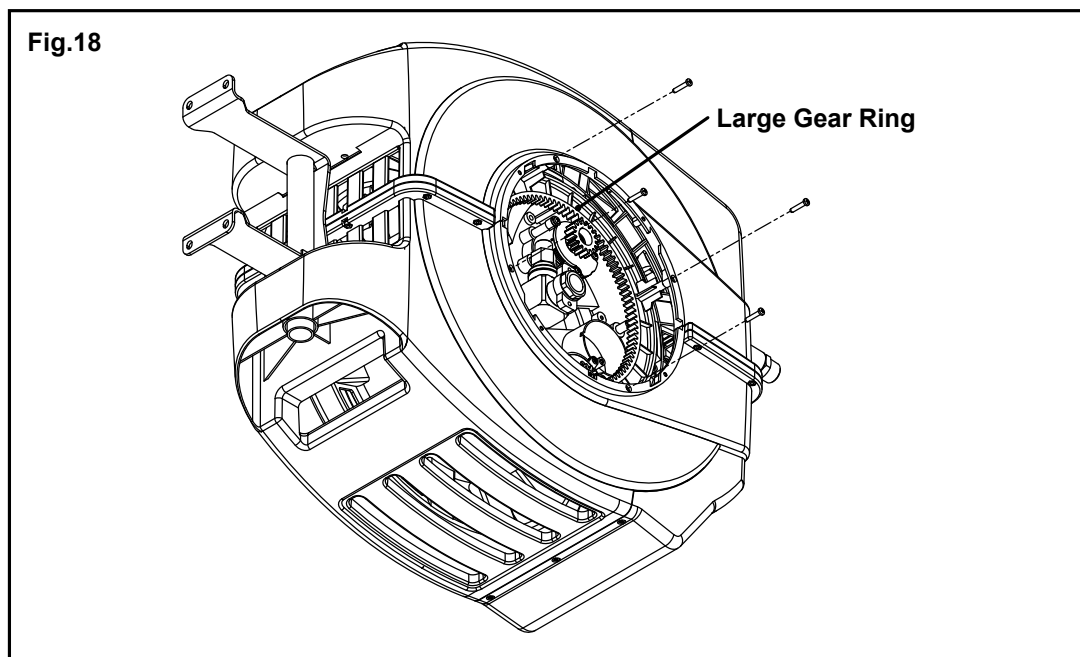

4. Move the large gear ring to the side to give adequate space, making it easier to remove the stop-at-any-point/slow retraction assembly and the reel body connection screws. (Fig.19)

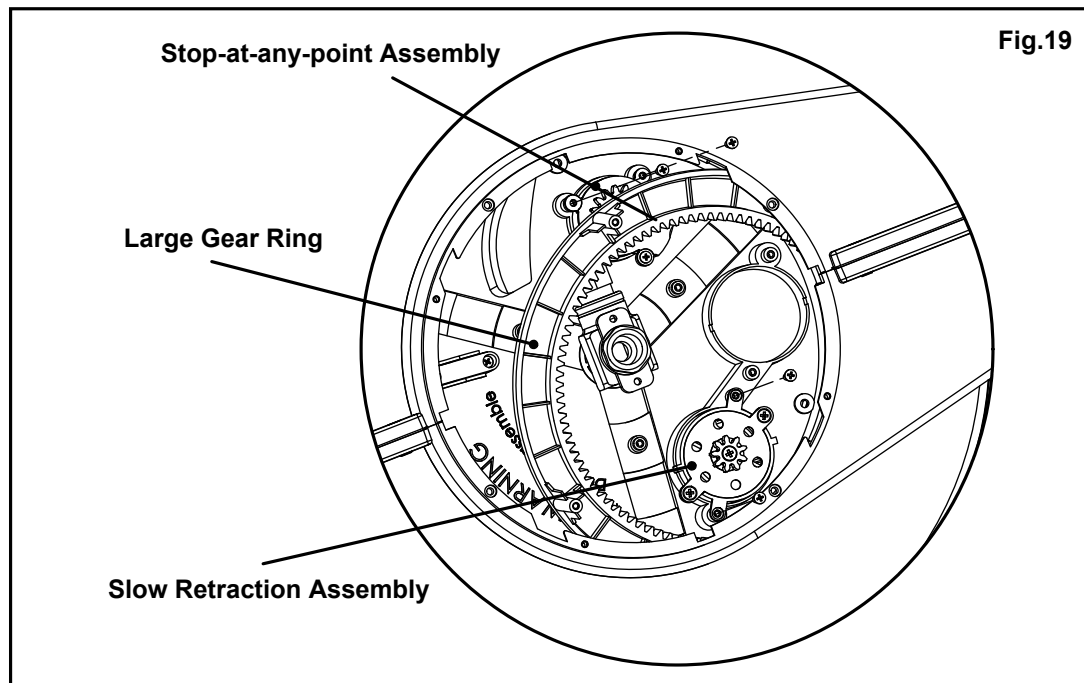

5. Install the new stop-at-any-point/slow retraction assembly and screw it on. (Fig.20)

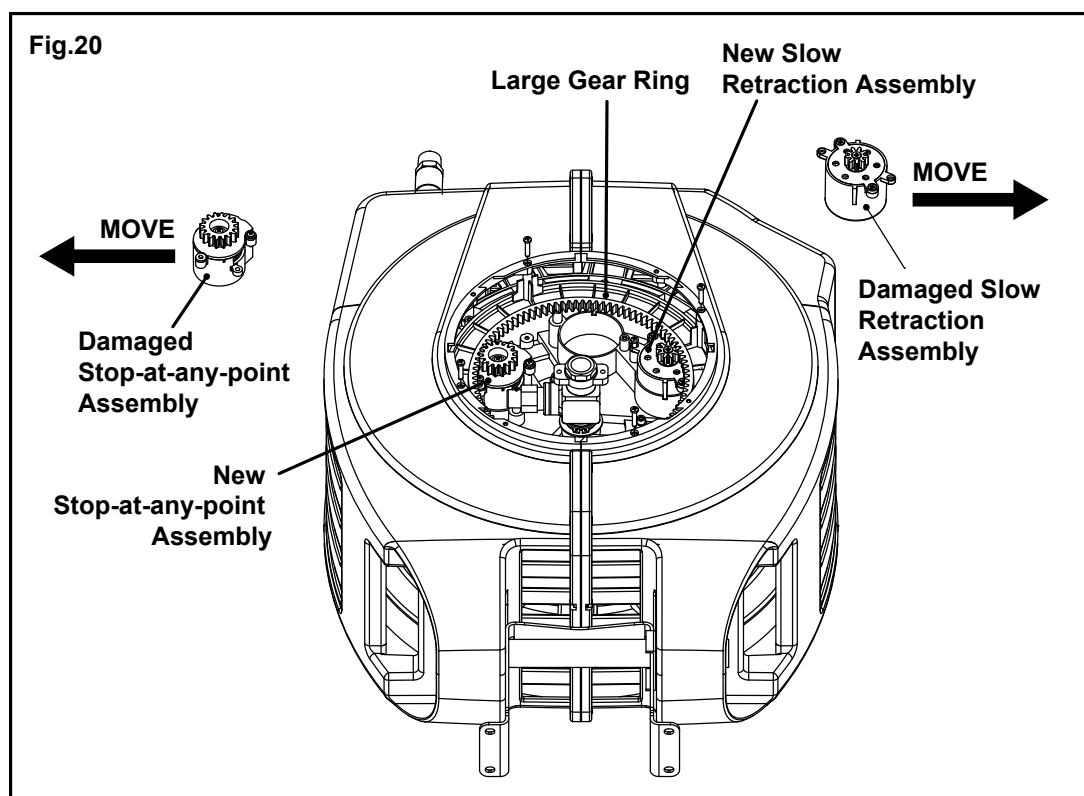

6. Install the screws on the large gear ring. (The large gear ring could be replaced if there is a need). **(Fig.21)**

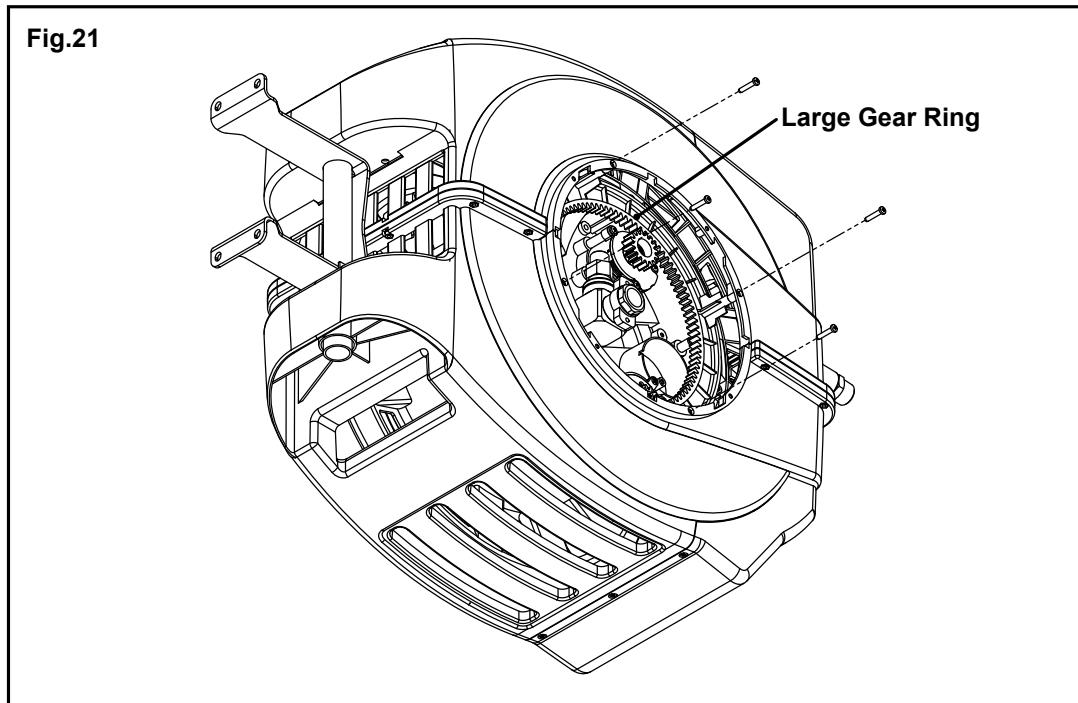

7. Insert the protrusion of the side cover into the slot on the housing (see figure), rotate clockwise, and install the screws.
8. Install the end cap on the side cover, align the back slot with the valve flange edge, screw it on, and complete the assembly (**Fig.22-1**). High pressure hose reel (**Fig.22-2**).

Fig.22

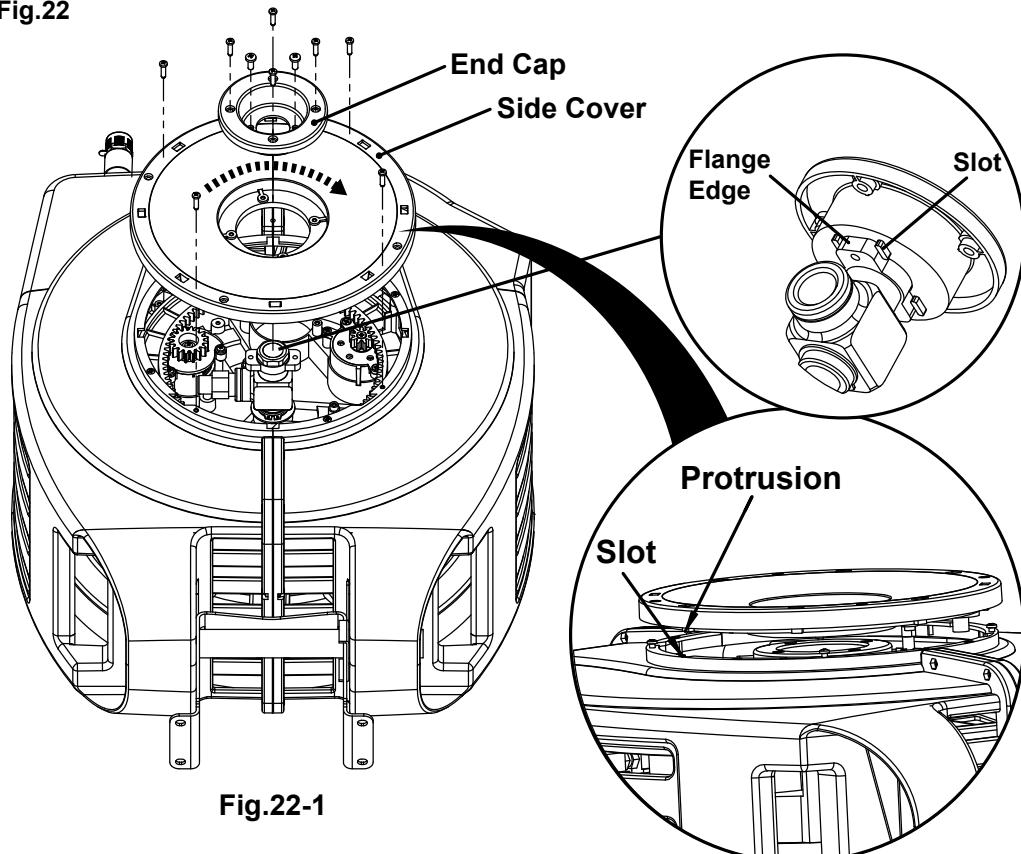

Fig.22-1

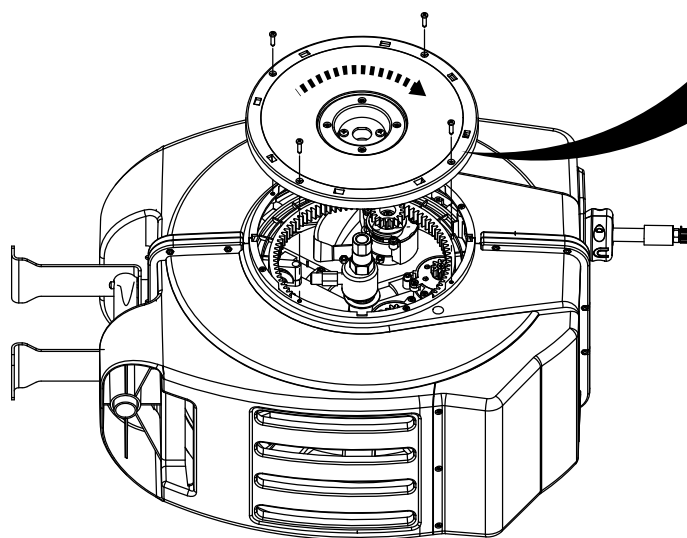

Fig.22-2

8.4 Replace Valve Seals

Warning: Make sure there is no inlet pipe before replacing.

Tip: No need to release spring force before replacing.

1. Remove the screws on the end cap and take out the end cap.
2. Remove the 4 screws on the side cover, rotate the side cover counterclockwise, and take out the side cover (**Fig.23**). High pressure hose reel (**Fig.23-2**).

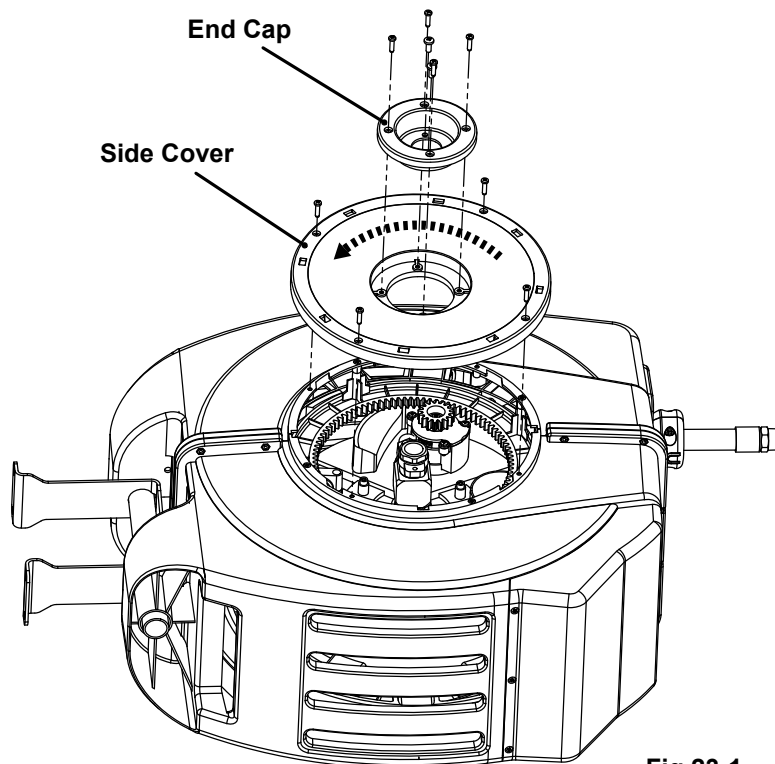

Fig.23-1

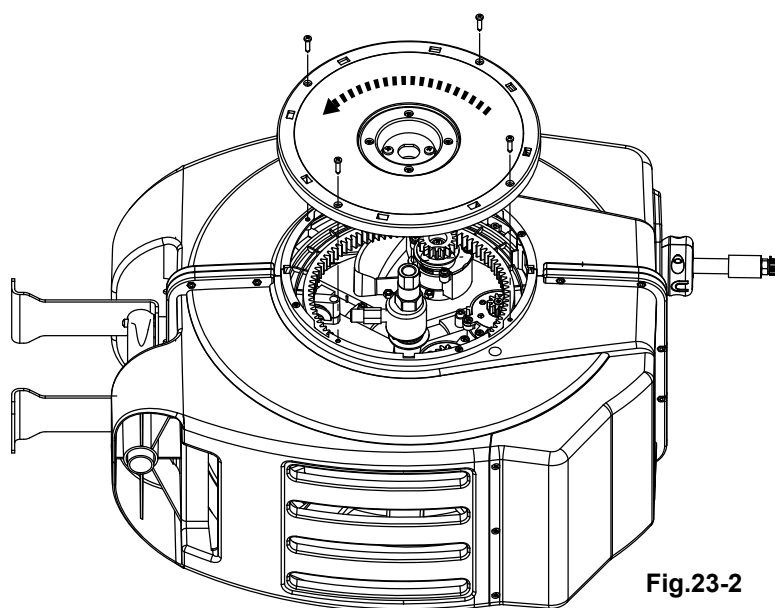
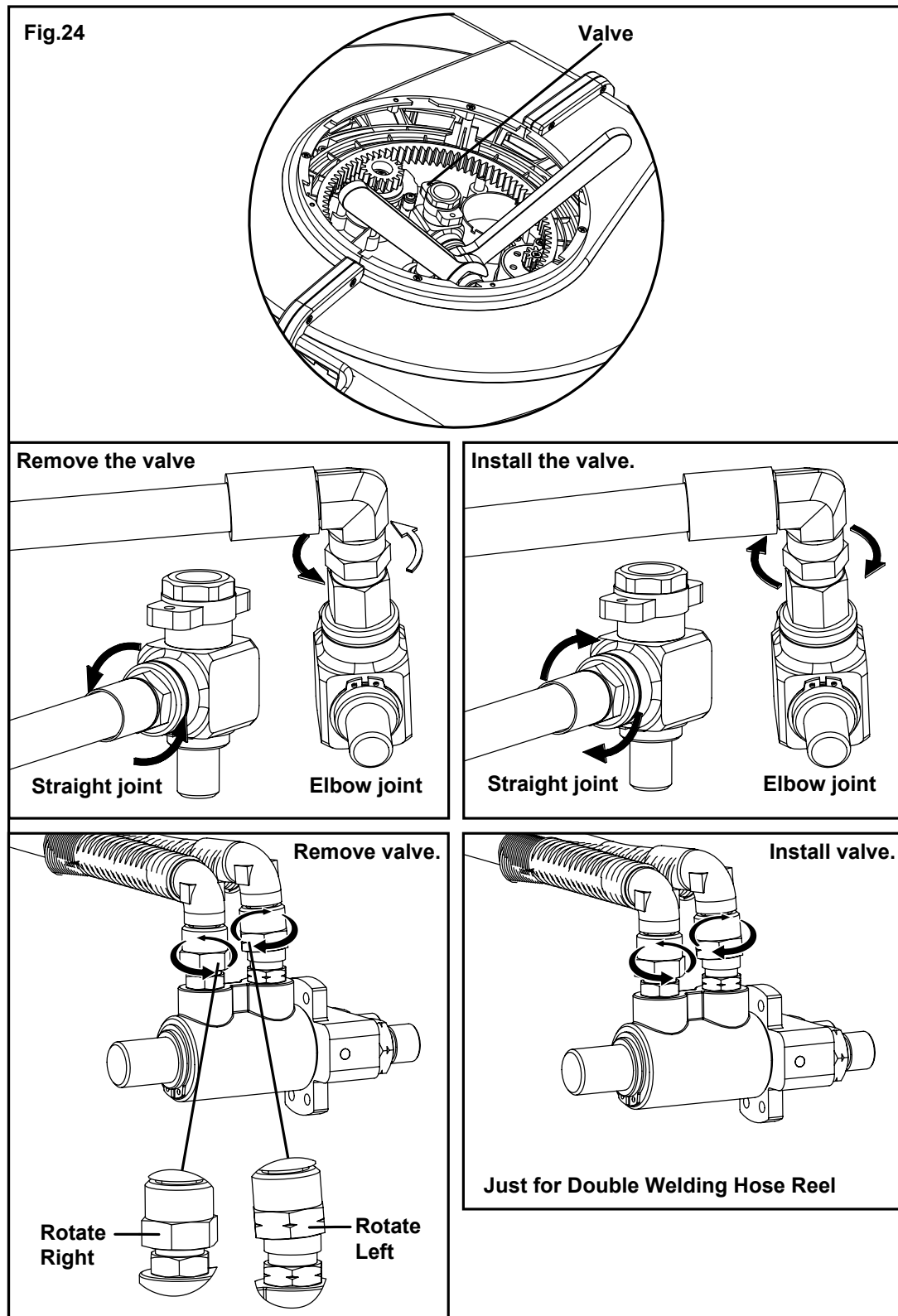
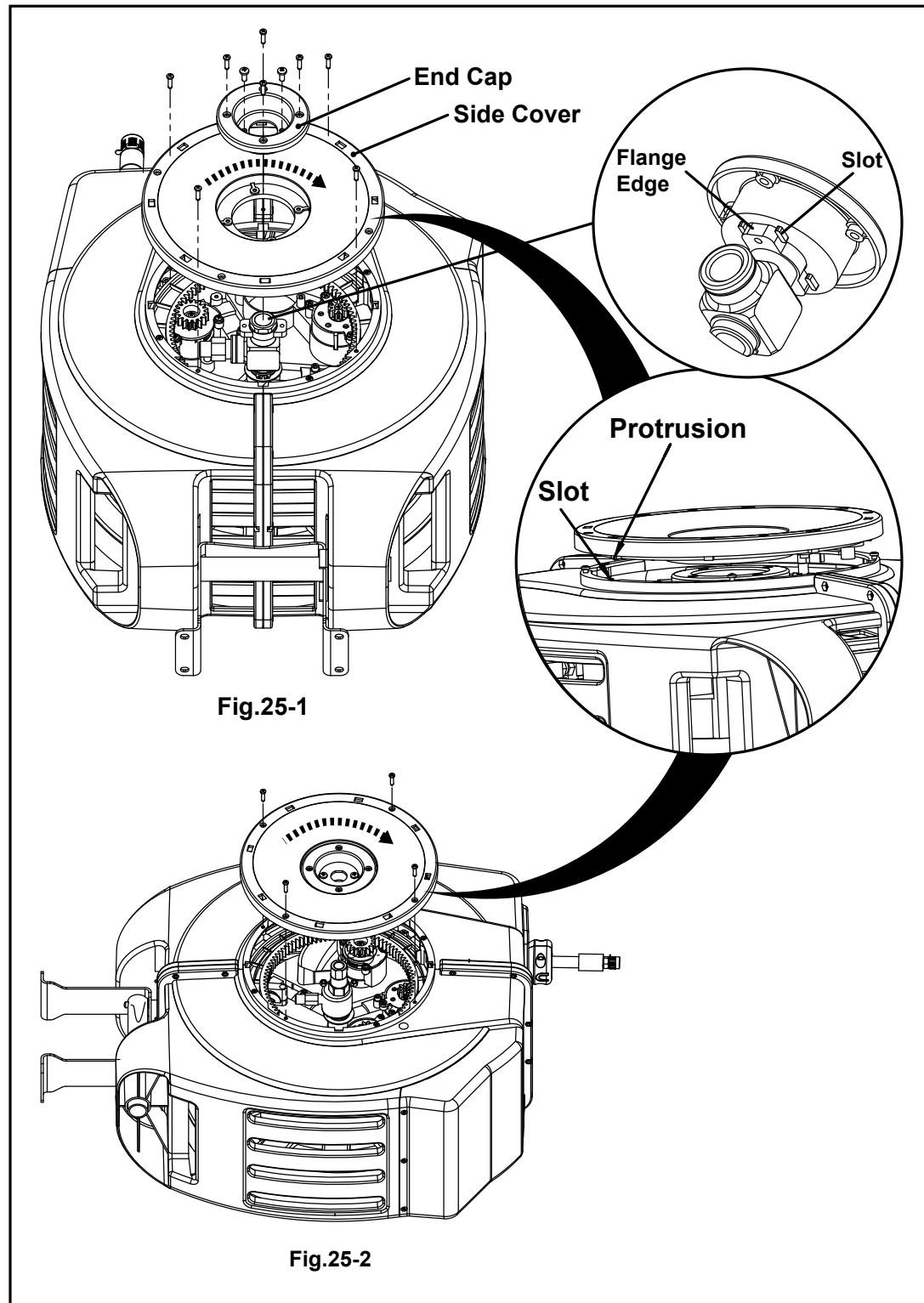

Fig.23-2

3. Remove the valve, adjust to the appropriate angle, use tools to replace the old valve, and install the new one. **(Fig.24)**



5. Insert the protrusion of the side cover into the slot on the housing (see figure), rotate clockwise, and install the screws.
6. Install the end cap on the side cover, align the back slot with the valve flange edge, screw it on, and complete the replacement (**Fig.25-1**). High pressure hose reel (**Fig.25-2**).



9. REPLACEMENT HOSE ASSEMBLY

⚠ WARNING

Before performing maintenance on the hose, close the supply media valve and relieve line pressure.

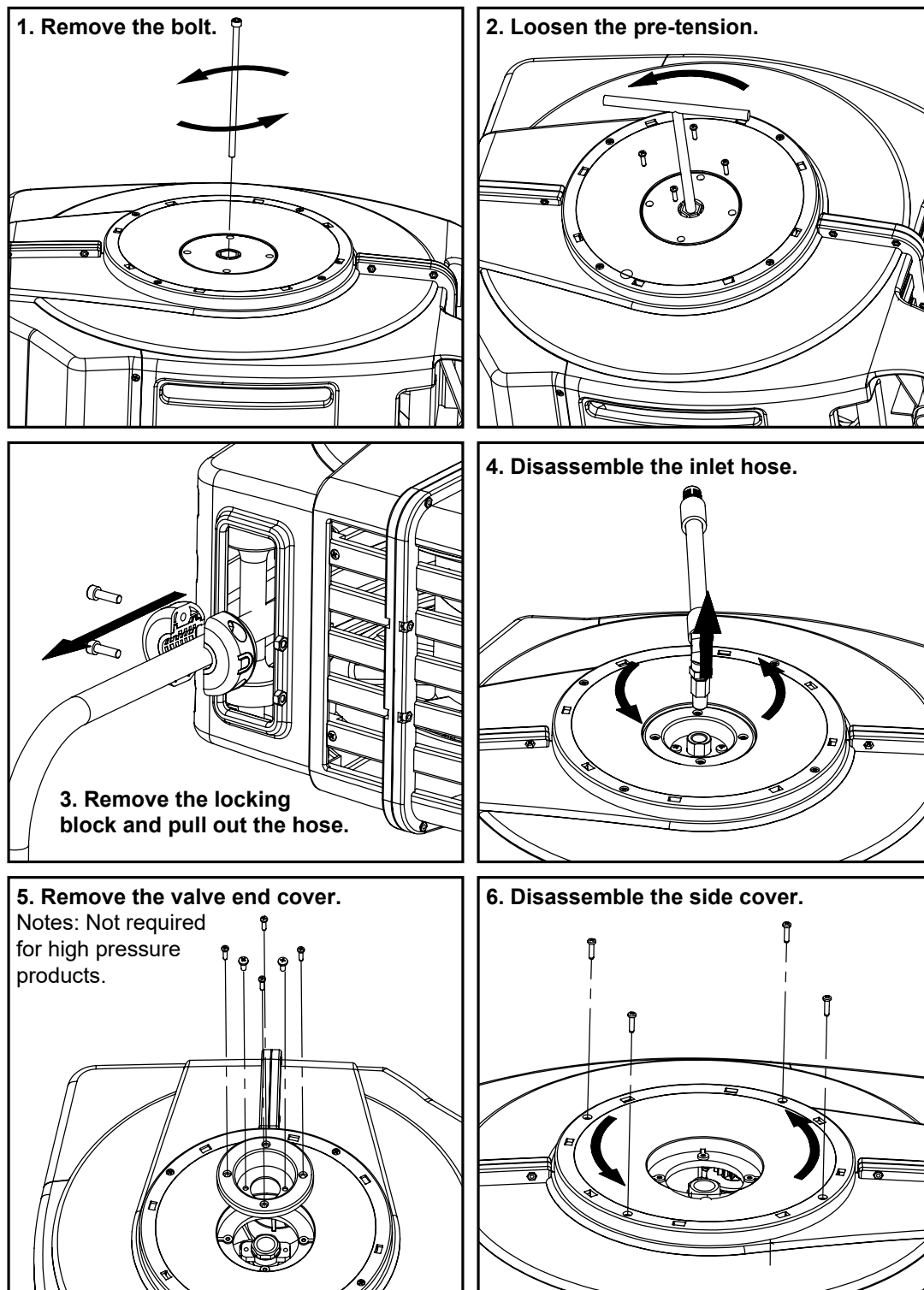

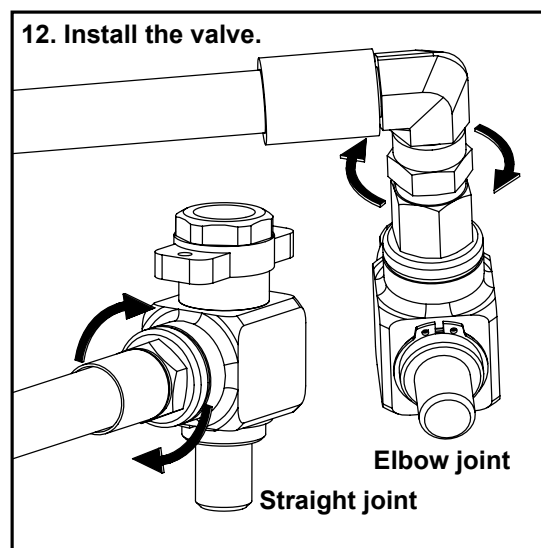
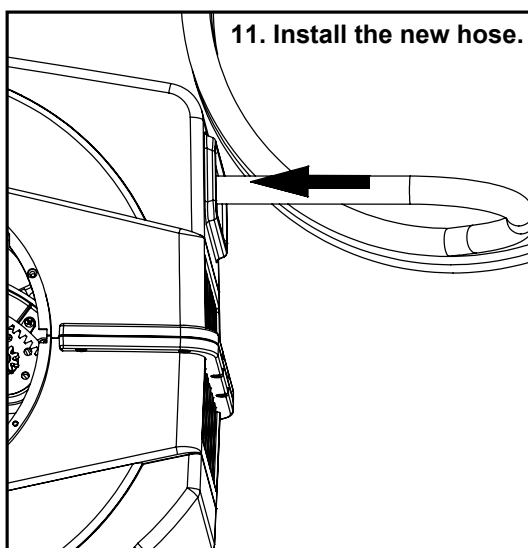
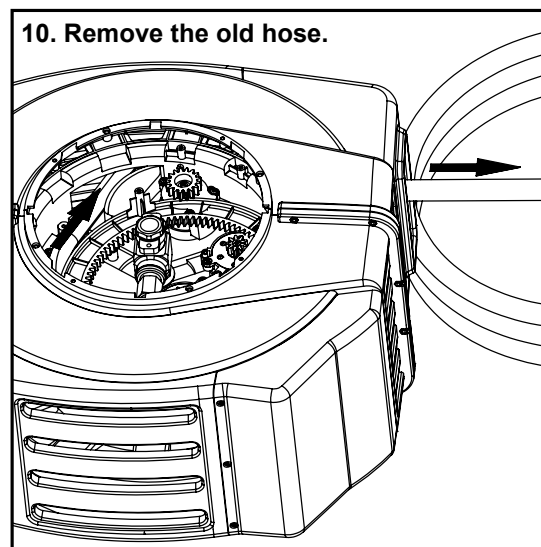
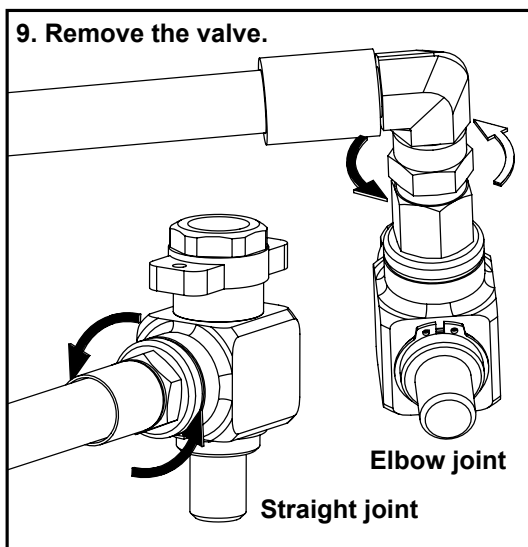
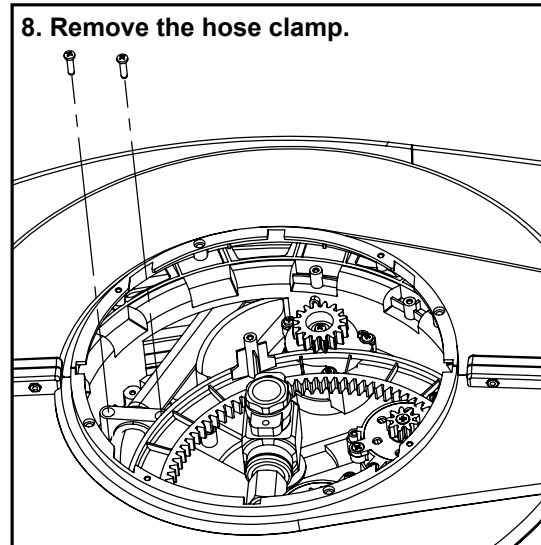
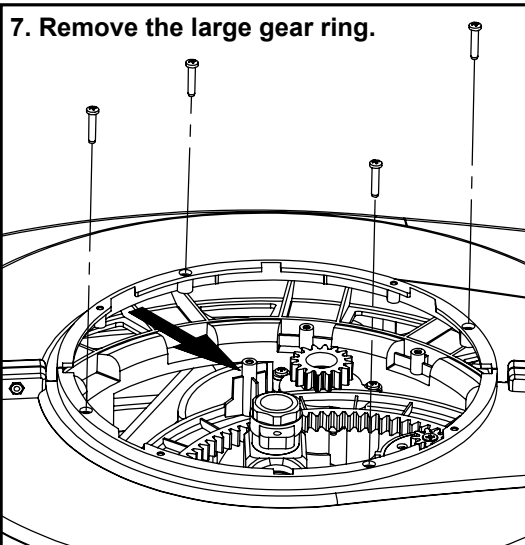

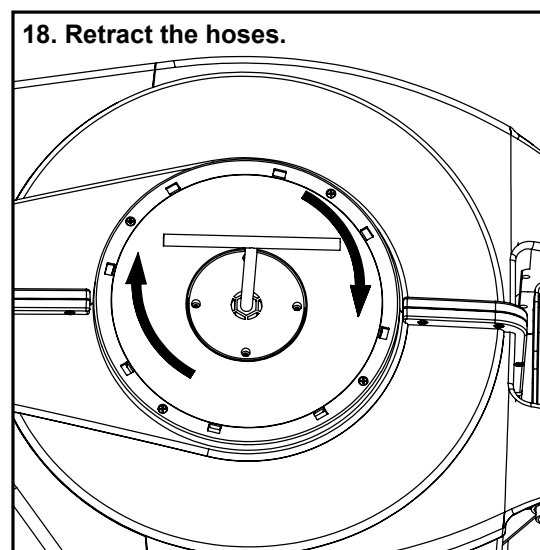
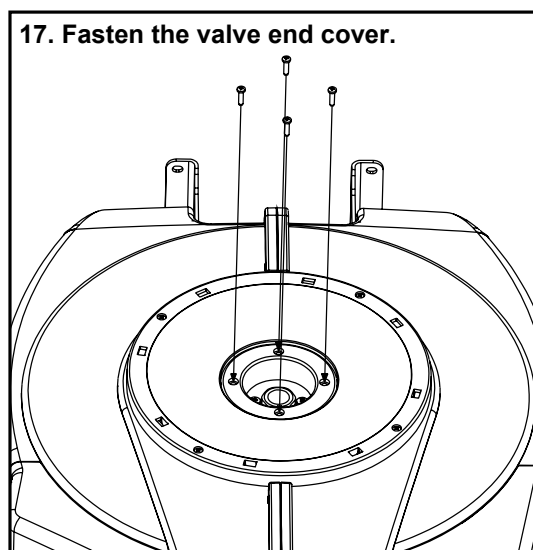
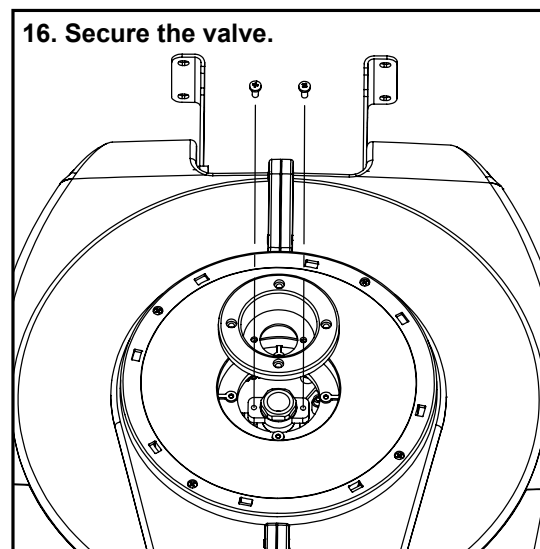
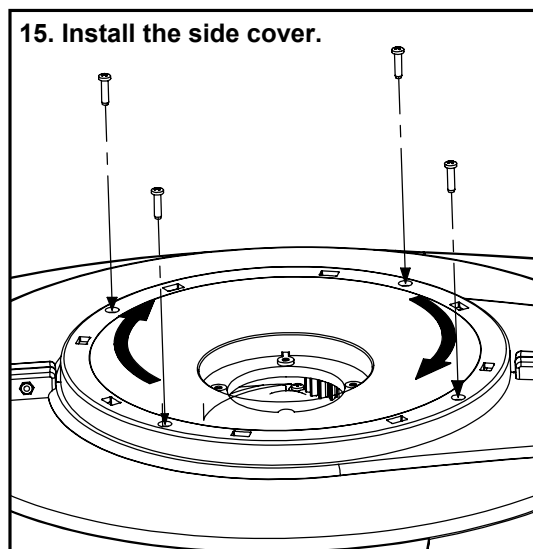
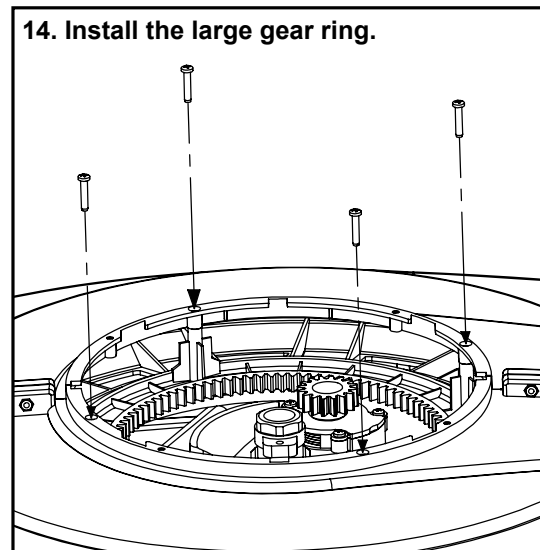
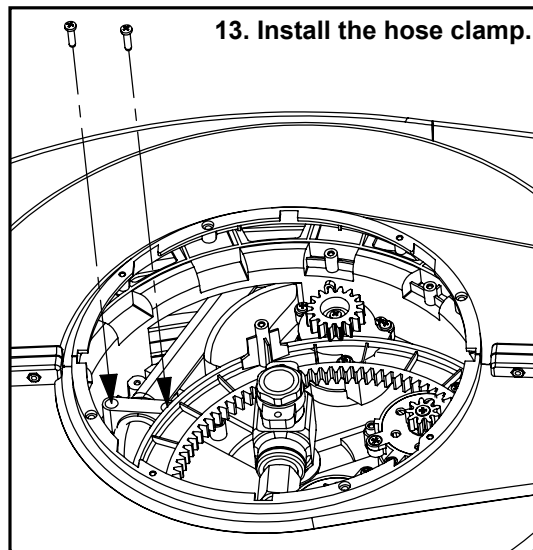



OWNER'S MANUAL

HOSE REELS

REWINDA

19. Pre-tension the spring.

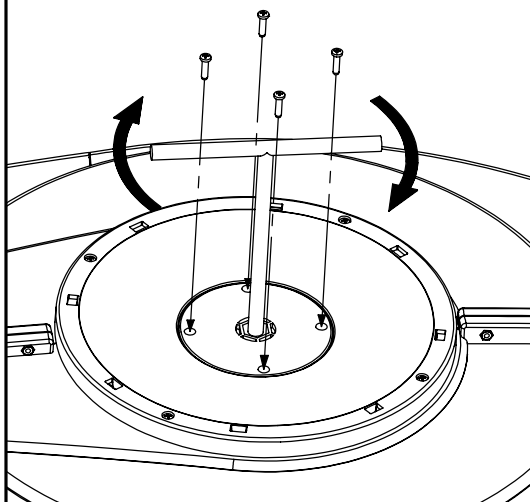

20. Install the inlet hose.

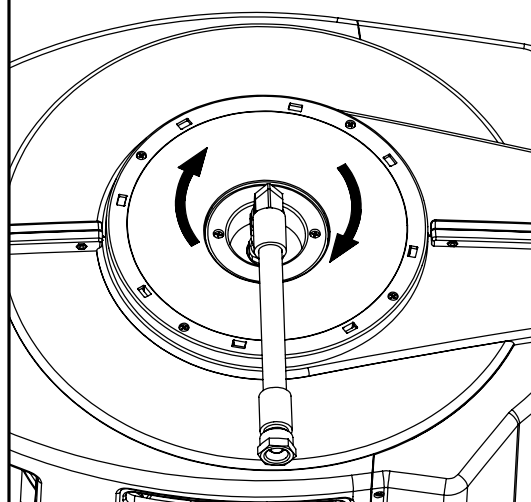

21. Install the bolts.

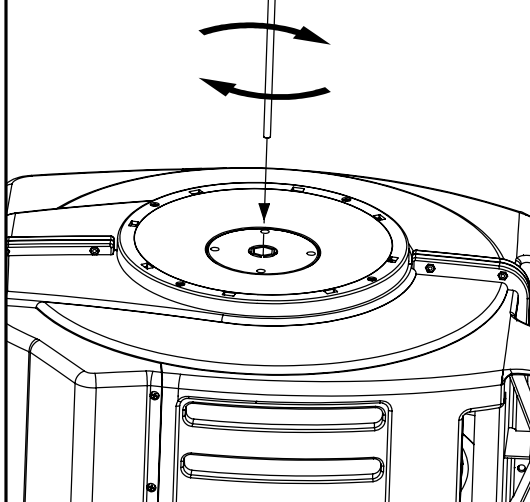

10. REPLACEMENT HOSE ASSEMBLY - DOUBLE WELDING HOSE

⚠ WARNING

Before performing maintenance on the hose, close the supply media valve and relieve line pressure.

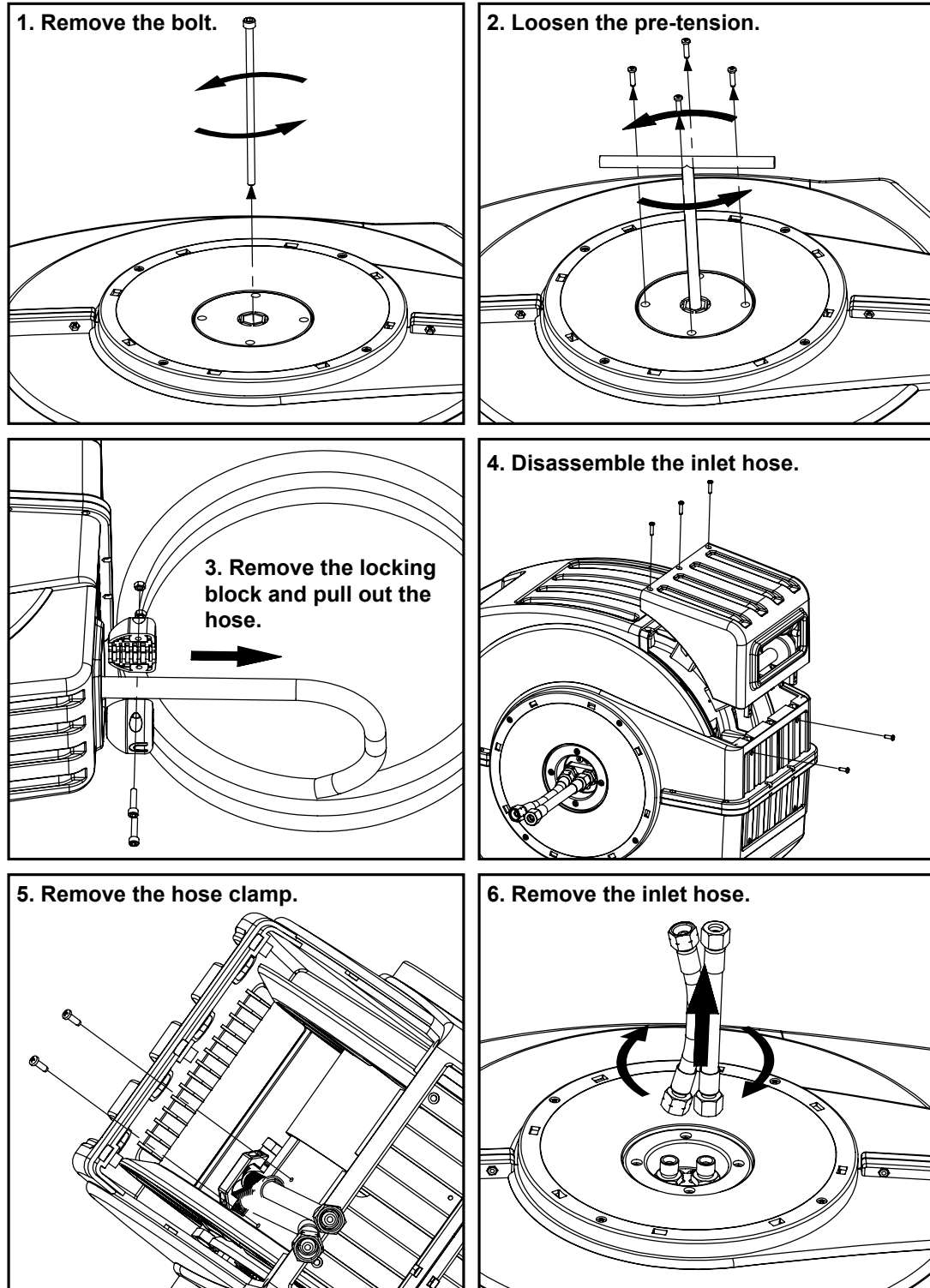

7. Remove the valve end cap.

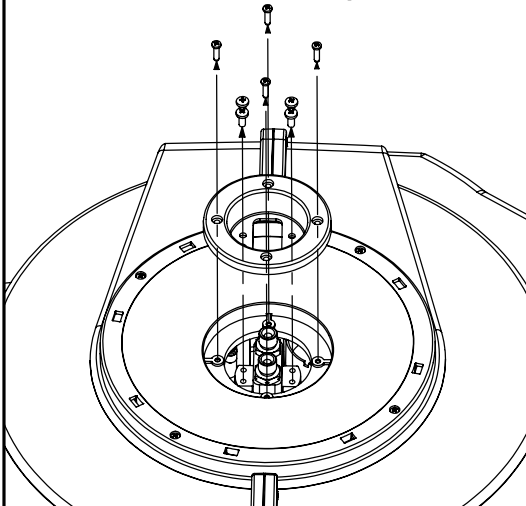

8. Remove side cover.

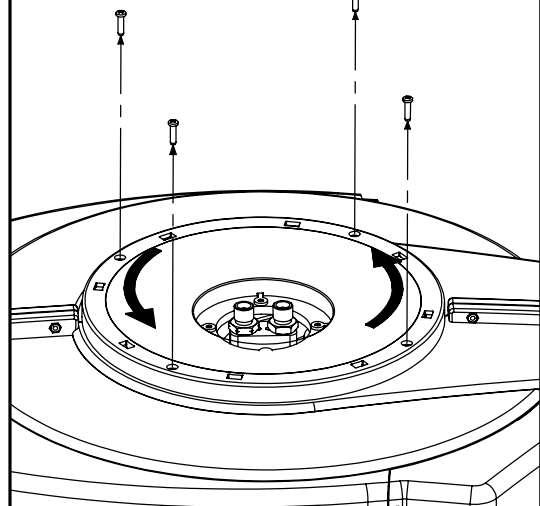

9. Remove valve.

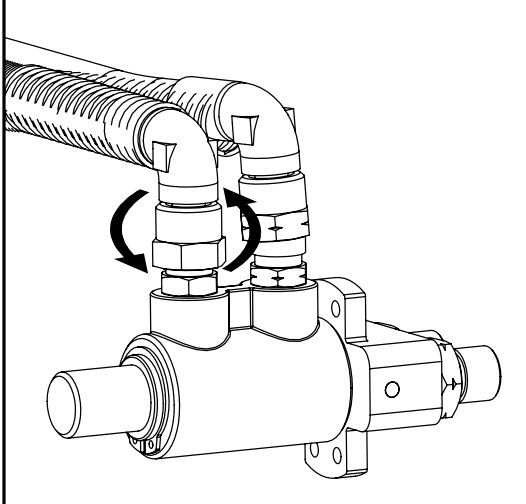

10. Remove old hose.

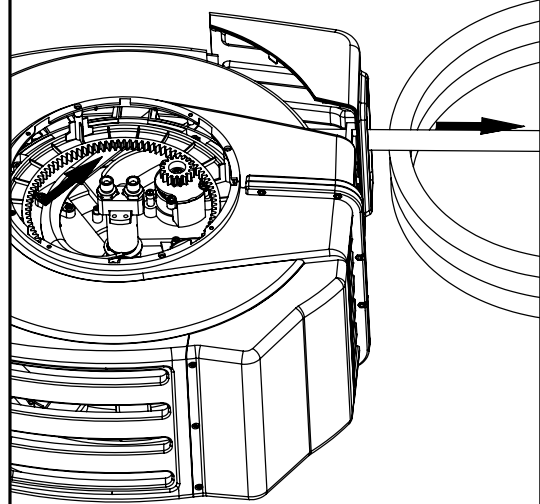

11. Install new hose.

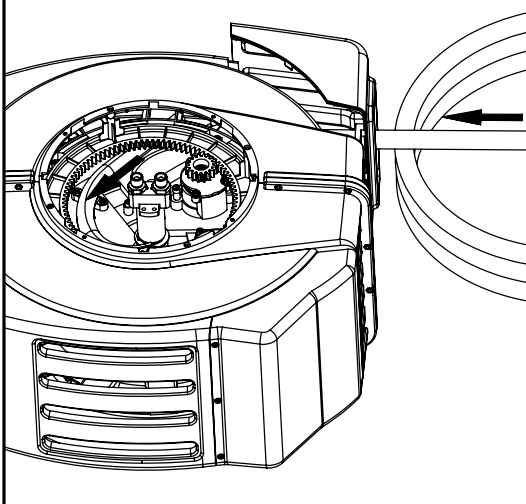

12. Install valve.

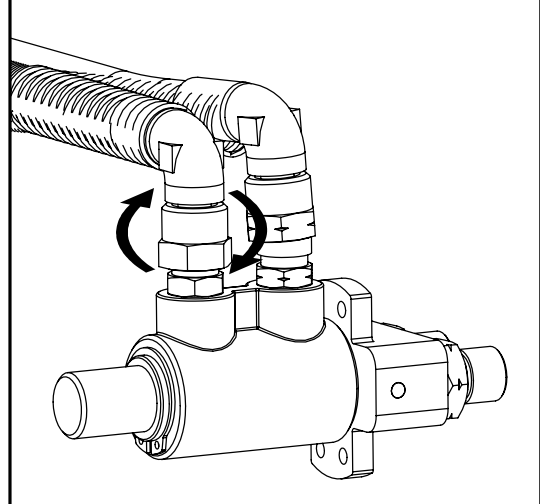

13. Fit valve assembly.

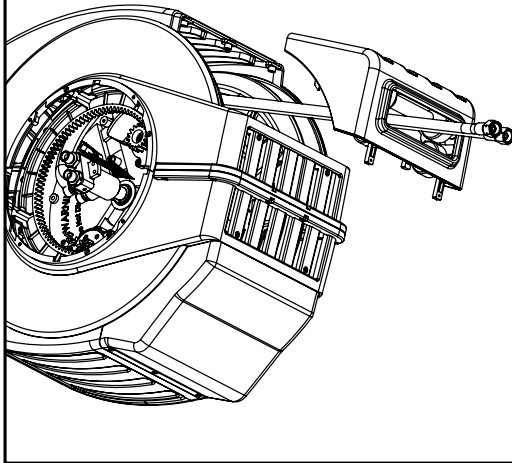

14. Fit hose clamps.

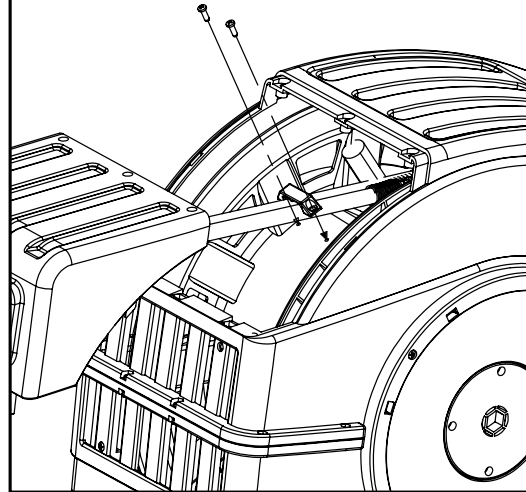

15. Install upper outlet cover.

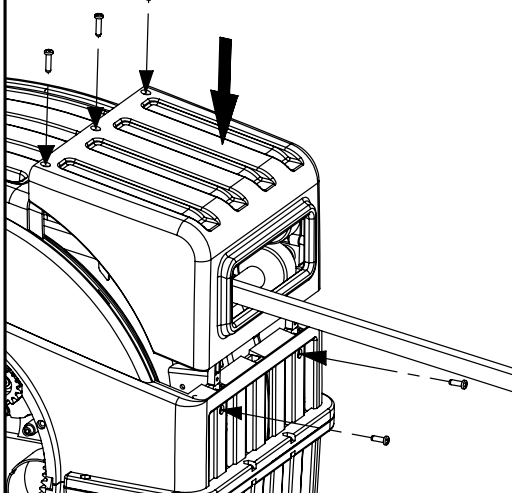

16. Install side cover.

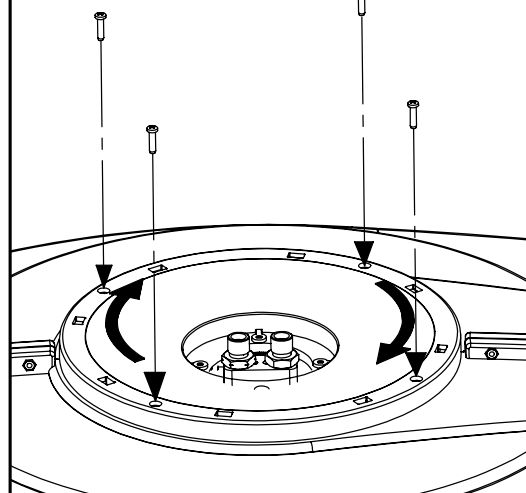

17. Fix the valve.

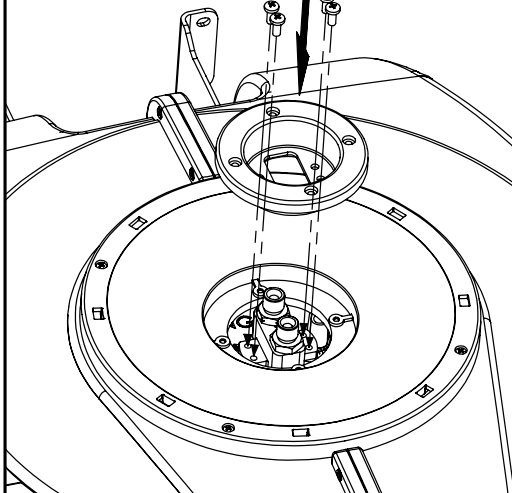

18. Fix the valve end cover.

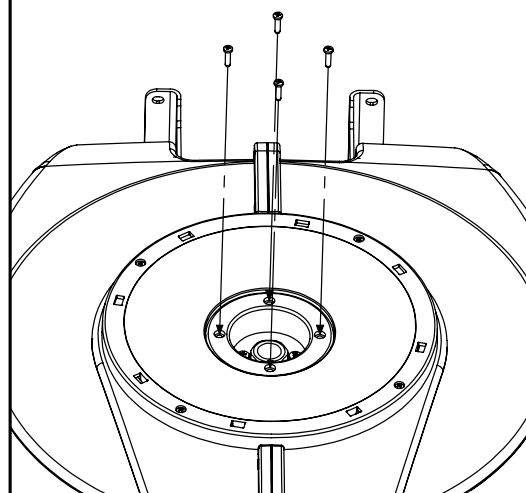

F26

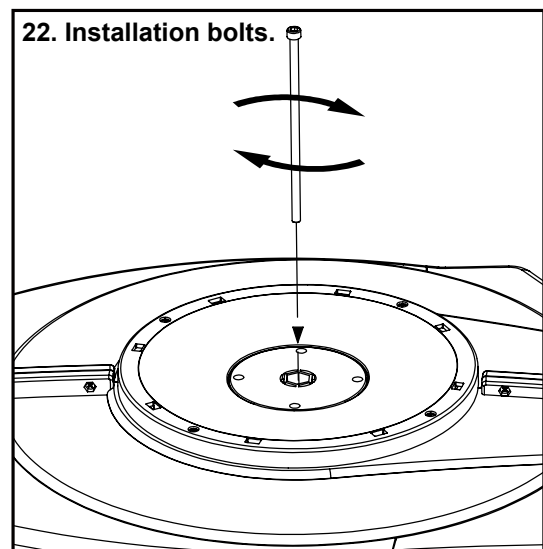
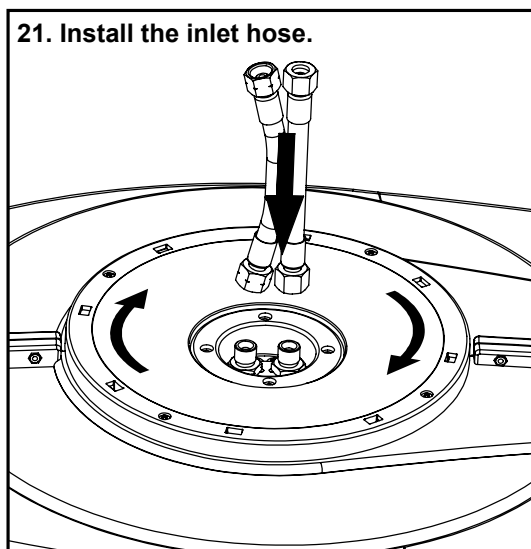
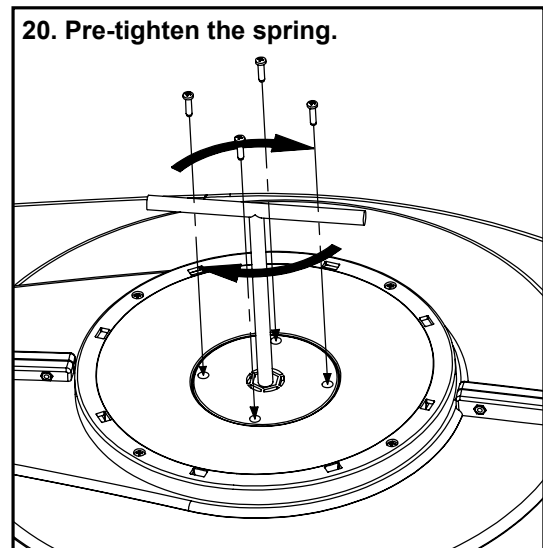
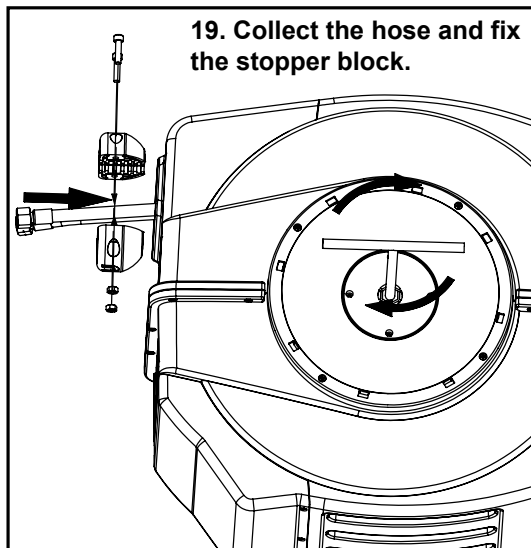

11. LIMITED WARRANTY

1. The manufacturer warrants this hose reel against defects in material and craftsmanship, for a period of 60 months from date of purchase, but not including hose and Seals and wearing parts.
2. Manufacturer's liability is limited to replacement or repair of defective material within the warranty period, when returned freight prepaid to the distributor or their designated service depot.
3. The warranty does not cover damage caused by accident, misuse or faulty installation.
4. The reel must be installed and maintained in compliance with the instructions.



WARNING: Your risk from these exposures varies, depending on how often you do this type of work. To reduce your exposure to these chemicals: work in a well ventilated area, and work with approved safety equipment, such as those dust masks that are specially designed to filter out microscopic particles.

12. STORAGE CONDITIONS

Please store the hose reel in a dry and well-ventilated environment.



OWNER'S MANUAL

HOSE REELS

REWINDA

13. TROUBLE SHOOTING

Problem(s)	Possible Cause	Corrective Action
Fluid path (plumbing and/or Swivel) is leaking or damaged.	a) Maximum pressure rating for reel has been exceeded. b) Application is not compatible with plumbing and/or swivel seal materials.	a) Replace or repair damaged components. Consult factory. Check maximum pressure rating of reel. b) Contact factory to determine chemical compatibility or environmental issues(i.e. temperature rating).
Hose will not fully retract.	a) Outlet nozzle, gun or tool is too heavy. b) Spring is fatigued. c) Field installed hose is too long. d) If the guiding assembly is damaged and there is accumulation in the hose.	a) Add spring tension. See "Spring Tension Adjustment". b) Add spring tension. See "Spring Tension Adjustment". Replace Spring Canister if required. c) Call local distributor for correct specified hose length. d) Refer to the guiding assembly replacement steps.
Hose will not retract at all.	Spring has lost all tension or has possibly broken.	Reinstall Spring Tension.
Reel will not latch.	a) The large gear ring is damaged. b) The stop-at-any-point assembly is damaged	a) Refer to the steps of replacing the large gear ring in the stop-at-any point and slow retraction modules procedure. b) See "Replace the stop-at-any-point assembly".
Fluid leaks from swivel.	a) Swivel seals are damaged or worn. b) Inlet hose is not flexible.	Replace swivel seals. See "Swivel Seal Replacement". Caution: Be sure leak is not at Hose Fitting!



OWNER'S MANUAL

HOSE REELS

REWINDA

Parts & Drawing Breakdown for AR1220CWB / AR1225GWG / AR1217HWR / AR1020WPR

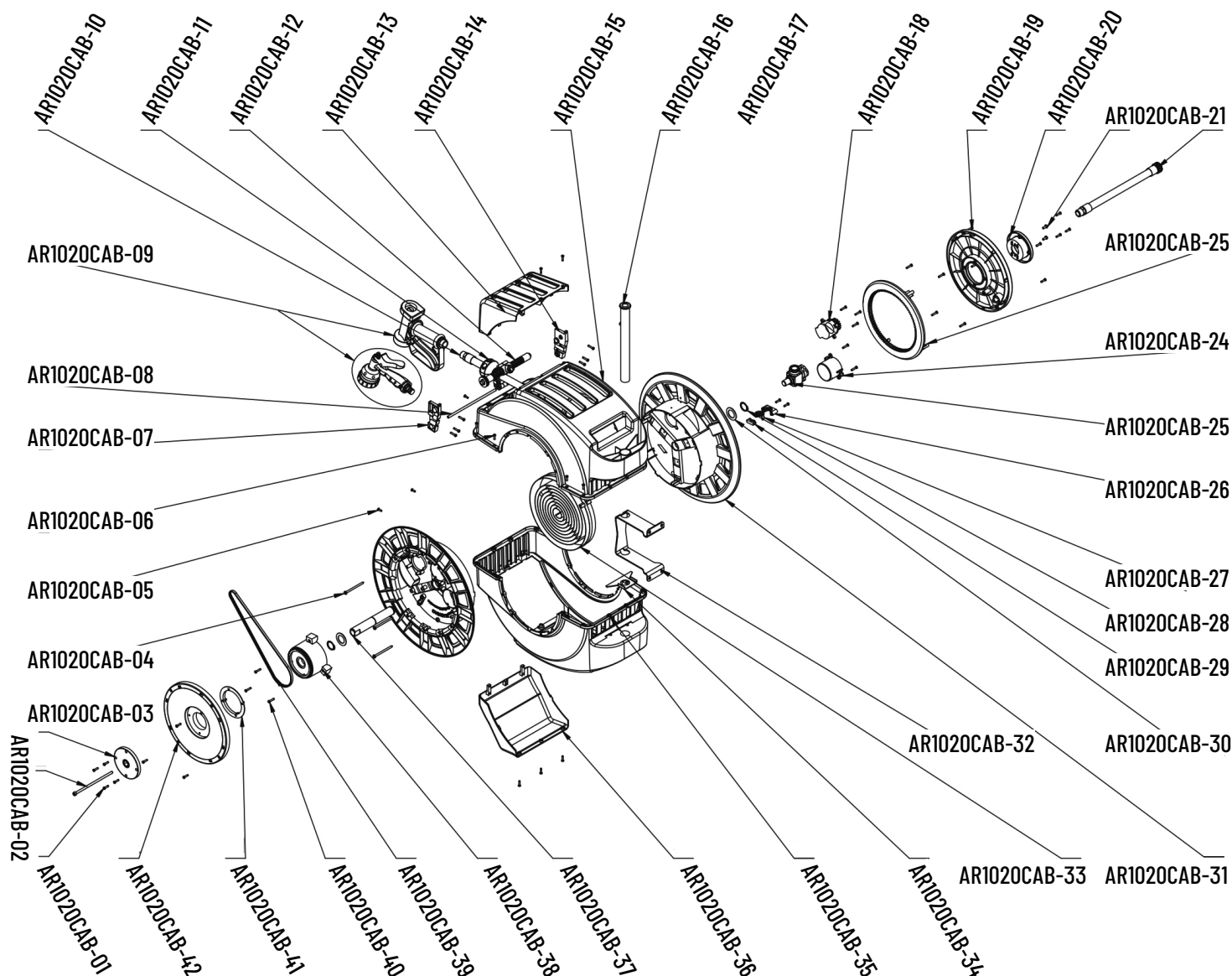

NSW/ACT (02) 9677 1555
WA (08) 9302 4199

QLD/PNG (07) 3491 2600
SA/NT (08) 8241 7111

VIC/TAS (03) 8787 8288
NZ (09) 447 1007

www.alemlube.com.au
www.alemlube.co.nz





OWNER'S MANUAL

HOSE REELS

REWINDA

Ordering Spare Parts

Parts List – Model AR1220CWB / AR1225GWG / AR1217HWR / AR1020WPR

Part Number	Product Description	Qty
AR1020CAB-01	Screw PT4.0x16F	24
AR1020CAB-02	Screw	1
AR1020CAB-03	Pre-tensioned End Cap	1
AR1020CAB-04	Screw ST4.8x75C	3
AR1020CAB-05	Screw PT4.0x12F	4
AR1020CAB-06	Screw M4x14	12
AR1020CAB-07	Left Outlet Side Plate	1
AR1020CAB-08	Guide Bar	1
AR1020CAB-09	▲Hot Water Gun/Hand Shower	1
AR1020CAB-10	Inlet Hose Assembly	1
AR1020CAB-11	Bumper Block Assembly	1
AR1020CAB-12	* Hose Compositor Assembly	1
AR1020CAB-13	Upper Outlet Cover	1
AR1020CAB-14	Right Outlet Side Plate	1
AR1020CAB-15	Case	2
AR1020CAB-16	Axle	1
AR1020CAB-17	▲Joint	1
AR1020CAB-18	*Stop At Any Point Assembly	1
AR1020CAB-19	Right Cover	1
AR1020CAB-20	End Cap	1
AR1020CAB-21	Screw M5x12	2

Part Number	Product Description	Qty
AR1020CAB-22	Hose Assembly	1
AR1020CAB-23	*Large Gear Ring	1
AR1020CAB-24	* Slow Retraction Assembly	1
AR1020CAB-25	Swivel Assembly	1
AR1020CAB-26	Clamp Seat	1
AR1020CAB-27	Clamp	1
AR1020CAB-28	Shaft Ring	2
AR1020CAB-29	▲Rubber Base	1
AR1020CAB-30	Washer	2
AR1020CAB-31	Drum	2
AR1020CAB-32	Bracket	1
AR1020CAB-33	Main Spring	1
AR1020CAB-34	Stator	1
AR1020CAB-35	Nut M4	12
AR1020CAB-36	Lower Outlet Cover	1
AR1020CAB-37	Main Axle	1
AR1020CAB-38	Synchronous Wheel	1
AR1020CAB-39	Synchronous Belt	1
AR1020CAB-40	Screw PT4.0x20F	18
AR1020CAB-41	Baffle	1
AR1020CAB-42	Left Cover	1

*: Wearing Parts

▲8: Hot water gun only for ALE.07

Hand shower only for ALE.06

▲16: Joint only for ALE.07

▲29: Rubber base only for ALE.02

NSW/ACT (02) 9677 1555

WA (08) 9302 4199

QLD/PNG (07) 3491 2600

SA/NT (08) 8241 7111

VIC/TAS (03) 8787 8288

NZ (09) 447 1007

www.alemlube.com.au

www.alemlube.co.nz





OWNER'S MANUAL

HOSE REELS

REWINDA

Parts & Drawing Breakdown for AR12150B / AR1020HPWR

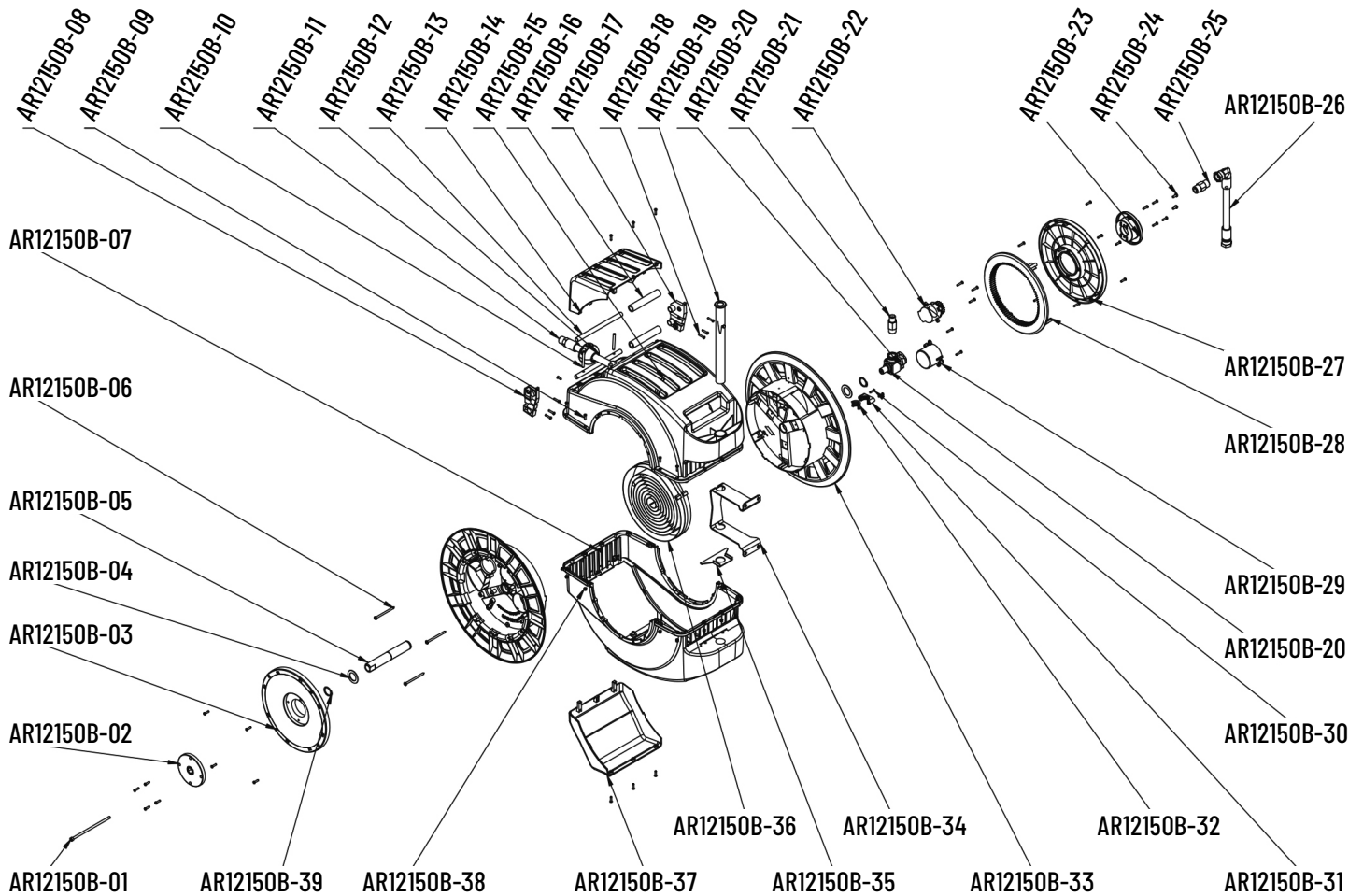

NSW/ACT (02) 9677 1555
WA (08) 9302 4199

QLD/PNG (07) 3491 2600
SA/NT (08) 8241 7111

VIC/TAS (03) 8787 8288
NZ (09) 447 1007

www.alemlube.com.au
www.alemlube.co.nz





OWNER'S MANUAL

HOSE REELS

REWINDA

Ordering Spare Parts

Parts List – Model AR1215OB / AR1020HOWR

Part Number	Product Description	Qty
AR1215OB-01	Screw M6x150	1
AR1215OB-02	Pre-tensioned End Cap	1
AR1215OB-03	Left Cover	1
AR1215OB-04	Washer	2
AR1215OB-05	Main Axle	1
AR1215OB-06	Screw ST4.8x75C	3
AR1215OB-07	Screw PT4.0x12F	4
AR1215OB-08	Left Outlet Side Plate	1
AR1215OB-09	Screw M4x14	12
AR1215OB-10	Short Shaft	2
AR1215OB-11	Hose Assembly	1
AR1215OB-12	Bumper Block assembly	1
AR1215OB-13	Shaft	2
AR1215OB-14	Upper Outlet Cover	1
AR1215OB-15	Case	2
AR1215OB-16	Guide Wheel	2
AR1215OB-17	Right Outlet Side Plate	1
AR1215OB-18	Screw PT4.0x20F	15
AR1215OB-19	Axle	1
AR1215OB-20	* Swivel Assembly	1

Part Number	Product Description	Qty
AR1215OB-21	Joint	1
AR1215OB-22	* Stop at any point Assembly	1
AR1215OB-23	End Cap	1
AR1215OB-24	Screw M5x12	2
AR1215OB-25	Joint	1
AR1215OB-26	Inlet Hose Assembly	1
AR1215OB-27	Right Cover	1
AR1215OB-28	* Large Gear Ring	1
AR1215OB-29	* Slow Retraction assembly	1
AR1215OB-30	Screw PT4.0x16F	24
AR1215OB-31	Clamp Seat	1
AR1215OB-32	Clamp	1
AR1215OB-33	Drum	2
AR1215OB-34	Bracket	1
AR1215OB-35	Stator	1
AR1215OB-36	Main Spring	1
AR1215OB-37	Lower Outlet Cover	1
AR1215OB-38	Nut M4	12
AR1215OB-39	Shaft Ring	2

**Wearing Parts*

Parts & Drawing Breakdown for AR615GB

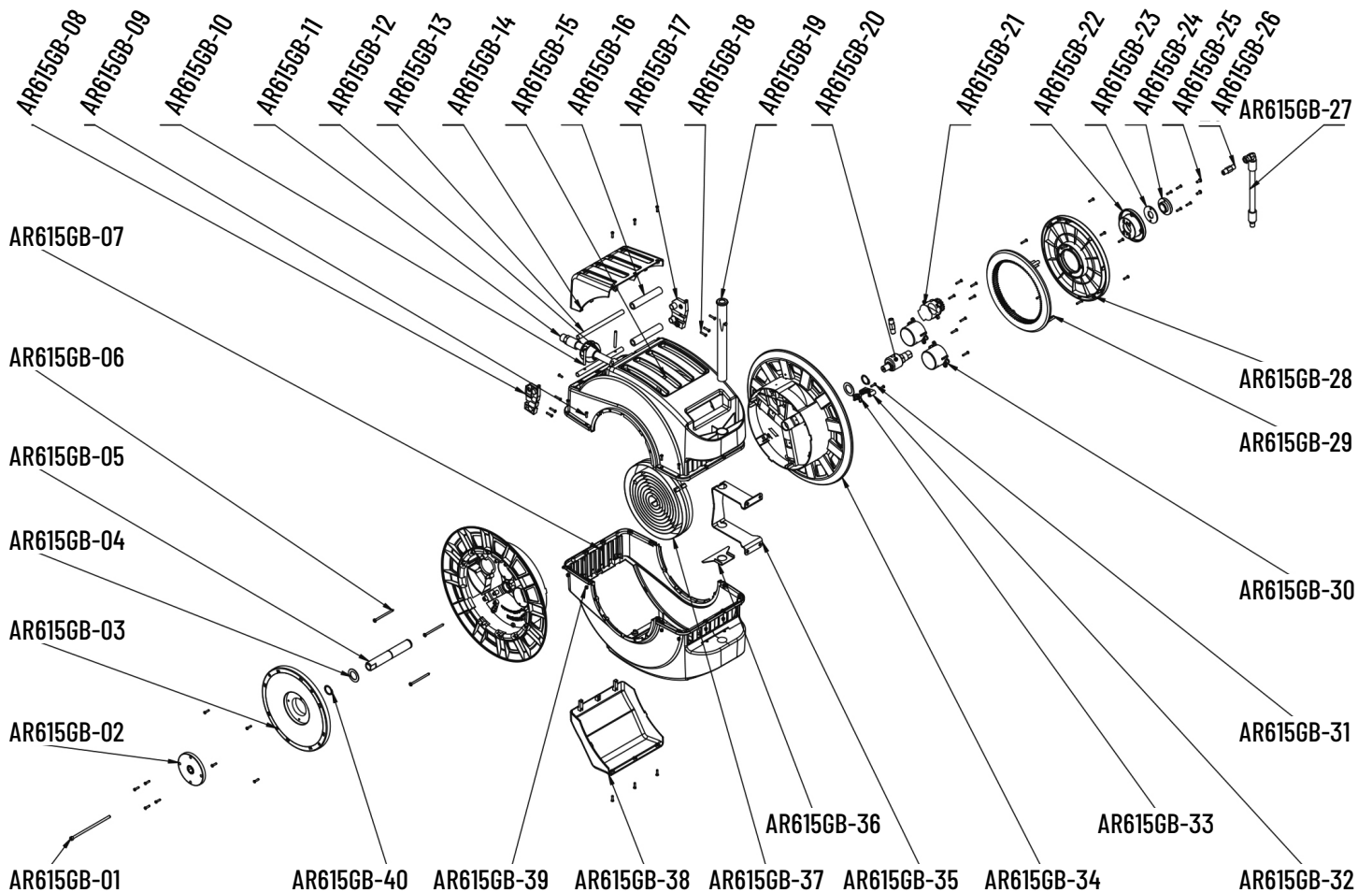



OWNER'S MANUAL

HOSE REELS

REWINDA

Ordering Spare Parts

Parts List – Model AR615GB

Part Number	Product Description	Qty
AR615GB-01	Screw M6x150	1
AR615GB-02	Pre-tensioned End Cap	1
AR615GB-03	Left Cover	1
AR615GB-04	Washer	2
AR615GB-05	Main Axle	1
AR615GB-06	Screw ST4.8x75C	3
AR615GB-07	Screw PT4.0x12F	4
AR615GB-08	Left Outlet Sside Plate	1
AR615GB-09	Screw M4x14	12
AR615GB-10	Short Shaft	2
AR615GB-11	Hose Assembly	1
AR615GB-12	Bumper Block assembly	1
AR615GB-13	Shaft	2
AR615GB-14	Upper Outlet Cover	1
AR615GB-15	Case	2
AR615GB-16	Guide Wheel	2
AR615GB-17	Right Outlet Sside Plate	1
AR615GB-18	Screw PT4.0x20F	15
AR615GB-19	Axle	1
AR615GB-20	* Swivel Assembly	1

Part Number	Product Description	Qty
AR615GB-21	* Stop at any point Assembly	2
AR615GB-22	End Cap	1
AR615GB-23	Blocking Plate	1
AR615GB-24	End Cap	1
AR615GB-25	Screw M5x12	2
AR615GB-26	Joint	1
AR615GB-27	Inlet Hose Assembly	1
AR615GB-28	Right Cover	1
AR615GB-29	* Large Gear Ring	1
AR615GB-30	* Slow Retraction assembly	1
AR615GB-31	Screw PT4.0x16F	24
AR615GB-32	Clamp Seat	1
AR615GB-33	Clamp	1
AR615GB-34	Drum	2
AR615GB-35	Bracket	1
AR615GB-36	Stator	1
AR615GB-37	Main Spring	1
AR615GB-38	Lower Outlet Cover	1
AR615GB-39	Nut M4	12
AR615GB-40	Shaft Ring	2

*Wearing Parts

Parts & Drawing Breakdown for AR6150AR/ AR6150PR

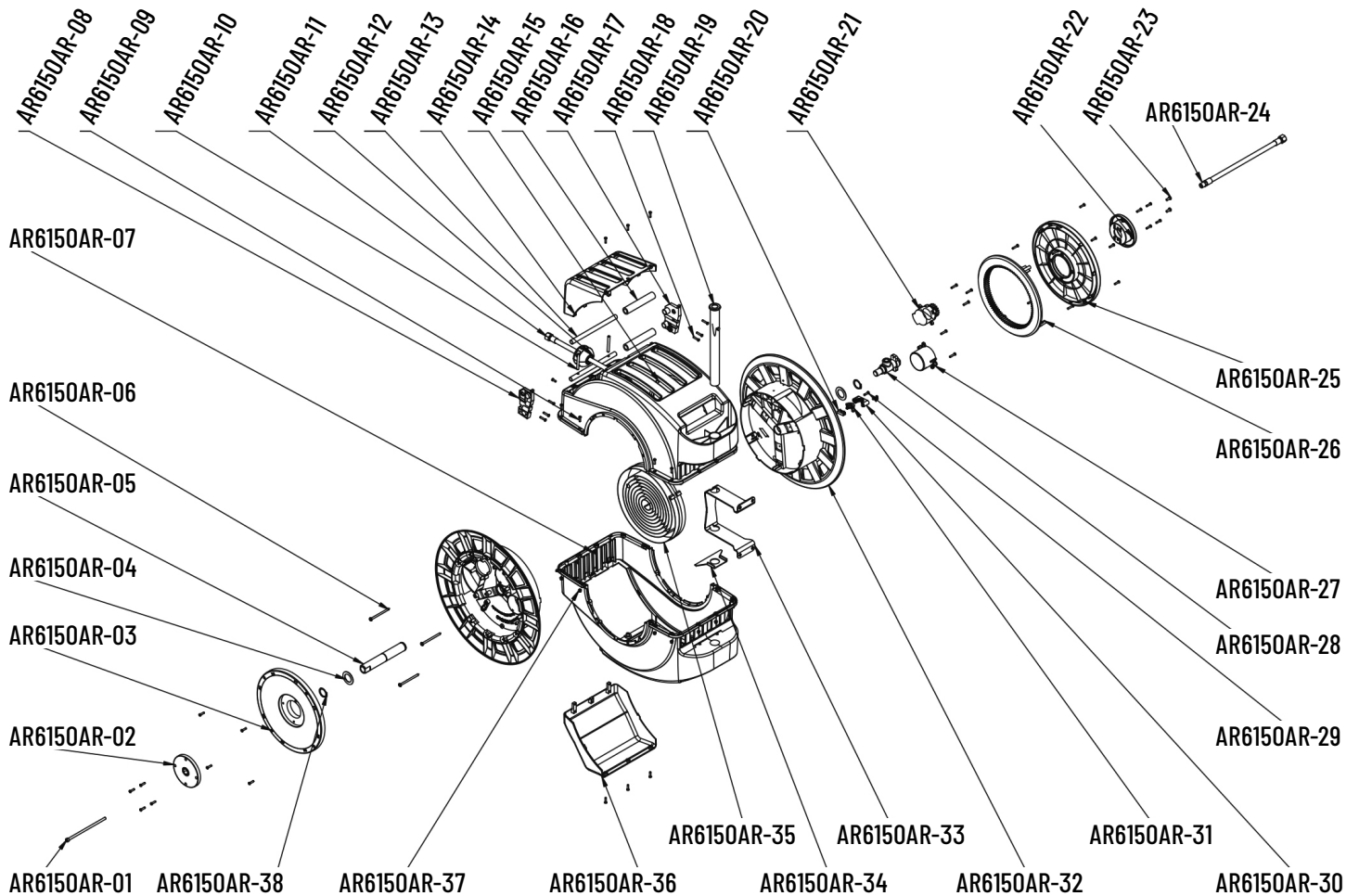



OWNER'S MANUAL

HOSE REELS

REWINDA

Ordering Spare Parts

Parts List – Model AR615OAR / AR615OPR

Part Number	Product Description	Qty
AR615OAR-01	Screw M6x150	1
AR615OAR-02	Pre-tensioned End Cap	1
AR615OAR-03	Left Cover	1
AR615OAR-04	Washer	2
AR615OAR-05	Main Axle	1
AR615OAR-06	Screw ST4.8x75C	3
AR615OAR-07	Screw PT4.0x12F	6
AR615OAR-08	Left Outlet Sside Plate	1
AR615OAR-09	Screw M4x14	12
AR615OAR-10	Short Shaft	2
AR615OAR-11	Hose Assembly	1
AR615OAR-12	Bumper Block assembly	1
AR615OAR-13	Shaft	2
AR615OAR-14	Upper Outlet Cover	1
AR615OAR-15	Case	2
AR615OAR-16	Guide Wheel	2
AR615OAR-17	Right Outlet Sside Plate	1
AR615OAR-18	Screw PT4.0x20F	15
AR615OAR-19	Axle	1
AR615OAR-20	Clamp Seat	1

Part Number	Product Description	Qty
AR615OAR-21	* Swivel Assembly	1
AR615OAR-22	* Stop at any point Assembly	1
AR615OAR-23	End Cap	1
AR615OAR-24	Screw M5x12	4
AR615OAR-25	Inlet Hose Assembly	1
AR615OAR-26	Right Cover	1
AR615OAR-27	* Large Gear Ring	1
AR615OAR-28	* Slow Retraction assembly	1
AR615OAR-29	Drum	2
AR615OAR-30	Bracket	1
AR615OAR-31	Stator	1
AR615OAR-32	Main Spring	1
AR615OAR-33	Lower Outlet Cover	1
AR615OAR-34	Nut M4	12
AR615OAR-35	Shaft Ring	2
AR615OAR-36	Main Spring	1
AR615OAR-37	Lower Outlet Cover	1
AR615OAR-38	Nut M4	12
AR615OAR-39	Screw PT4.0x16F	22

*Wearing Parts

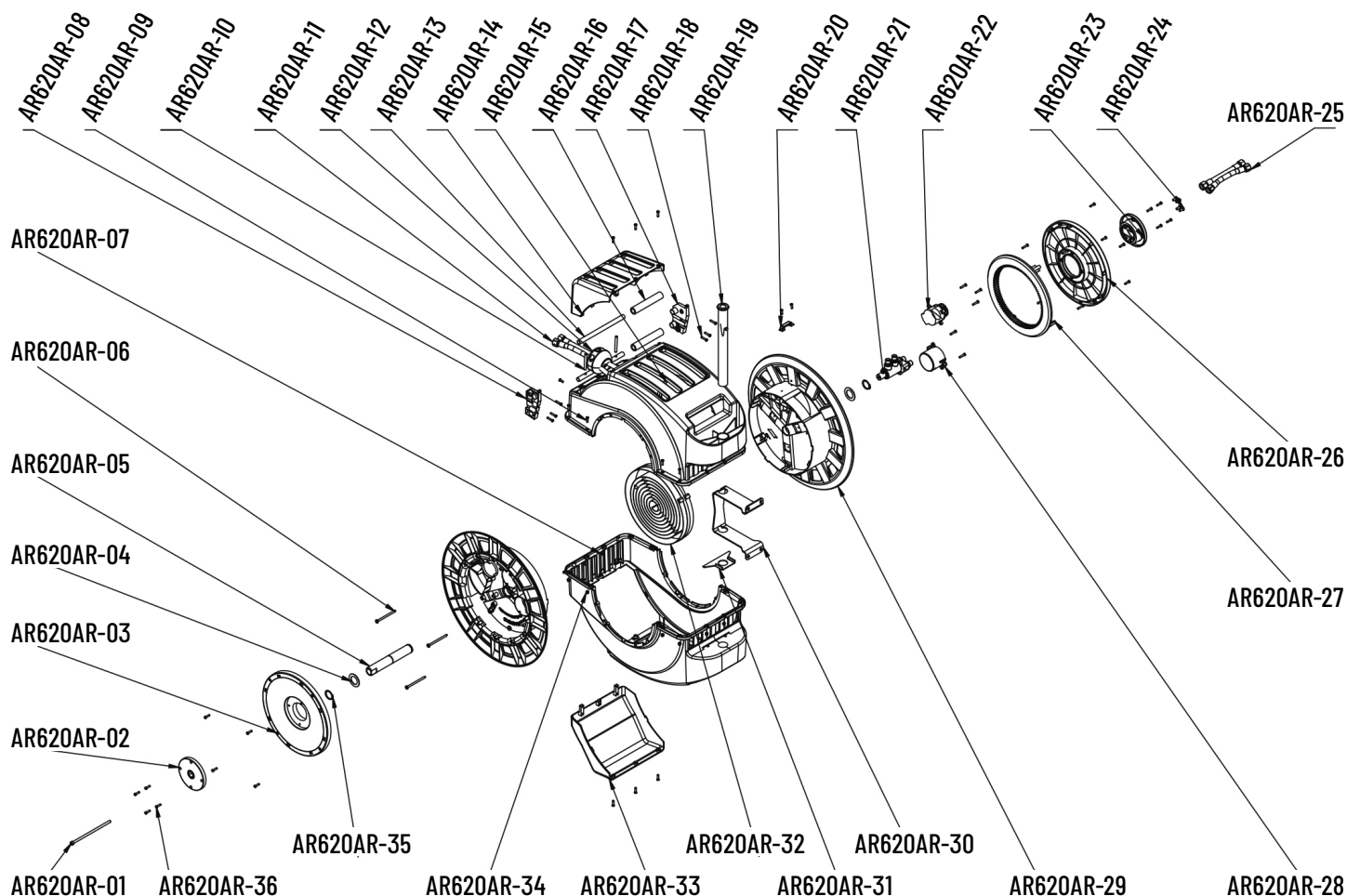



OWNER'S MANUAL

HOSE REELS

REWINDA

Ordering Spare Parts

Parts List – Model AR620AR / AR620PR

Part Number	Product Description	Qty
AR620AR-01	Screw M6x150	1
AR620AR-02	Pre-tensioned End Cap	1
AR620AR-03	Left Cover	1
AR620AR-04	Washer	2
AR620AR-05	Main Axle	1
AR620AR-06	Screw ST4.8x75C	3
AR620AR-07	Screw PT4.0x12F	4
AR620AR-08	Left Outlet Sside Plate	1
AR620AR-09	Screw M4x14	12
AR620AR-10	Short Shaft	2
AR620AR-11	Hose Assembly	1
AR620AR-12	Bumper Block assembly	1
AR620AR-13	Shaft	2
AR620AR-14	Upper Outlet Cover	1
AR620AR-15	Case	2
AR620AR-16	Guide Wheel	2
AR620AR-17	Right Outlet Sside Plate	1
AR620AR-18	Screw PT4.0x20F	15
AR620AR-19	Axle	1

Part Number	Product Description	Qty
AR620AR-20	Rubber Base	1
AR620AR-21	* Stop at any point Assembly	1
AR620AR-22	End Cap	1
AR620AR-23	Screw M5x12	1
AR620AR-24	Inlet Hose Assembly	2
AR620AR-25	Right Cover	1
AR620AR-26	* Large Gear Ring	1
AR620AR-27	* Slow Retraction assembly	1
AR620AR-28	* Swivel Assembly	1
AR620AR-29	Screw PT4.0x16F	24
AR620AR-30	Clamp Seat	1
AR620AR-31	Clamp	1
AR620AR-32	Drum	2
AR620AR-33	Bracket	1
AR620AR-34	Stator	1
AR620AR-35	Main Spring	1
AR620AR-36	Lower Outlet Cover	1
AR620AR-37	Nut M4	12
AR620AR-38	Shaft Ring	2

**Wearing Parts*

NSW/ACT (02) 9677 1555
WA (08) 9302 4199

QLD/PNG (07) 3491 2600
SA/NT (08) 8241 7111

VIC/TAS (03) 8787 8288
NZ (09) 447 1007

www.alemlube.com.au
www.alemlube.co.nz

