

Shower base installation instructions

(Please read carefully as not all shower base instructions are the same)

IMPORTANT SHOWER BASE MUST BE STORED FLAT (not leaning on outlet) AND KEPT DRY AND AWAY FROM DIRECT SUNLIGHT PRIOR TO INSTALLATION

Prior to installation , the shower base must be checked thoroughly for defects .

- ✓ Ensure that the product has no chips and is not cracked , this includes the waste outlet
- ✓ Ensure that all visible surfaces are free from scratches.
- ✓ Ensure that there is no twisting or distorting of the product
- ✓ Ensure the shower base suitably drains water when levelled

The above checks are essential prior to installation as the manufacturer has no control over storage , transportation and delivery once it leaves the Oceano warehouse.

The manufacturer will not be held responsible for removal or replacement cost of a shower base as a result of the shower base having a defect, if said defect was identifiable prior to installation.

INSTALLATION OF THE SHOWER BASE WILL BE TREATED AS ACCEPTANCE OF QUALITY

Method 1 – non check in

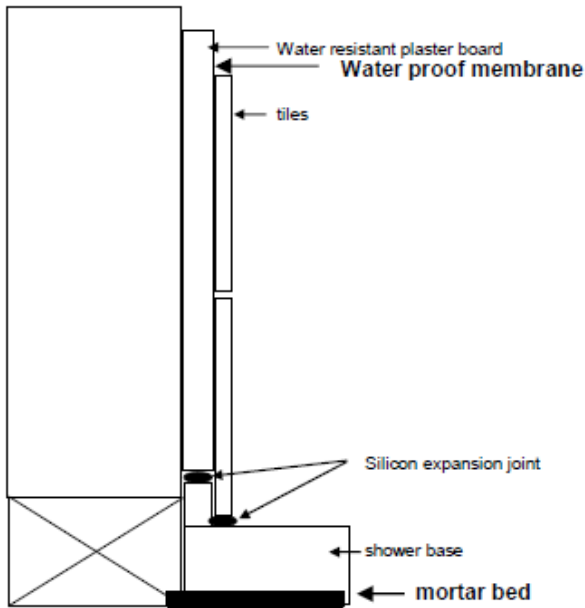

Method 2 - check-in

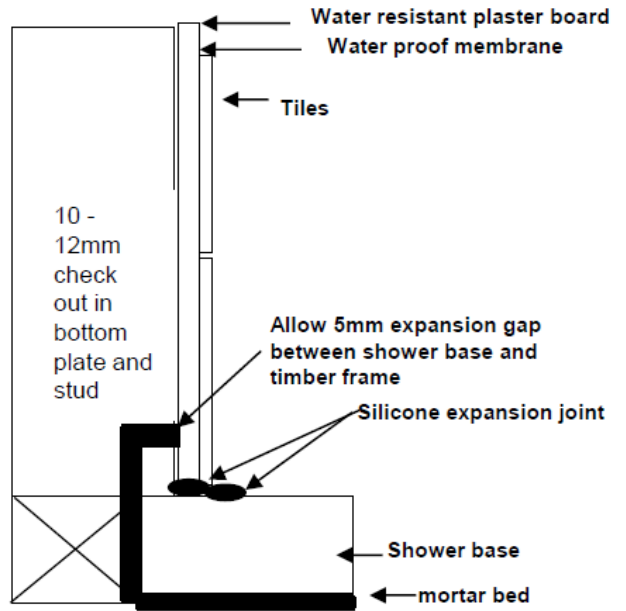

Timber floor installation

Check floor for soundness ensure there is no rot and all joists are solid enough to support the new base.

Measure supporting ring on underside of base , cut hole in floor 15mm bigger to allow for adjustment of base if required.

Base can be installed using a cement base tile adhesive and a 12mm notched trowel, a 10mm 4: 1 mortar mix or silicone. The underside of the base must be fully supported over the entire surface area (Excluding waste)

Once the base is in position , level and water test the base. Due to surface tension, large droplets of water will remain on the surface however large pools should not be evident.

Water test shower base once level by pouring a bucket of water onto the base .

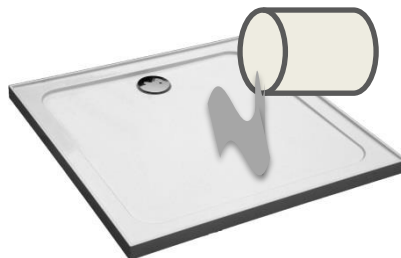

Shower base installation instructions

(Please read carefully as not all shower base instructions are the same)

Concrete floor installation

Void area in slab **MUST** not exceed 300mm x 300mm .

Support ring span is 300mm maximum ,150mm from center of outlet in all directions.

Base can sit directly over a smart pan .

Base can be installed using a cement base tile adhesive and a 12mm notched trowel, a 10mm 4: 1 mortar mix or silicone. The underside of the base must be fully supported over the entire surface area (Excluding waste)

Once the base is in position , level and water test the base. Due to surface tension, large droplets of water will remain on the surface however large pools should not be evident.

Flush to floor installation instructions can be downloaded from www.oceano.com.au

WASTE OUTLET – If the shower base you have purchased requires the outlet to be installed, run a generous amount of silicone to the underside of the outlet flange and position in base. **Place black rubber ring up against underside of the base and tighten nut into position.**

Clean off any excess silicone from around the outlet flange and the shower base surface.

Installation on silicone

If using silicone for installation ensure the area where the base is to sit is flat and level. Silicone should be place 100mm apart in all directions (see below) to ensure full support of the shower base is achieved.

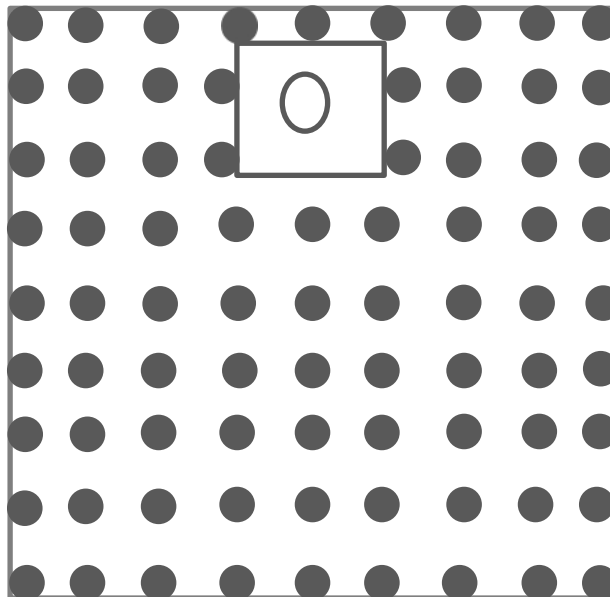

Water test shower base once level by pouring a bucket of water onto the base .



Cleaning – Use a soft cloth with warm soapy water or general household detergent , DO NOT use bleach, abrasives such as steel wool or abrasive cloths as they can damage the surface.

Installer - Please leave a copy of the installation instructions for the end user.