

Savanna

Wall Top Assemblies



www.harpersbathroom.com.au

VIVIANCLIVE

Savanna Wall Top Assemblies

Modern square design with sharp lines and simplistic edging that blends effortlessly with modern furniture and fittings.



- Ceramic Disc $\frac{1}{4}$ Turn
- Solid Brass with Chrome Finish

Product Code: 93123430039

Warranty

15 Year Replacement Warranty

For Full Terms & Conditions see Warranty Information Form

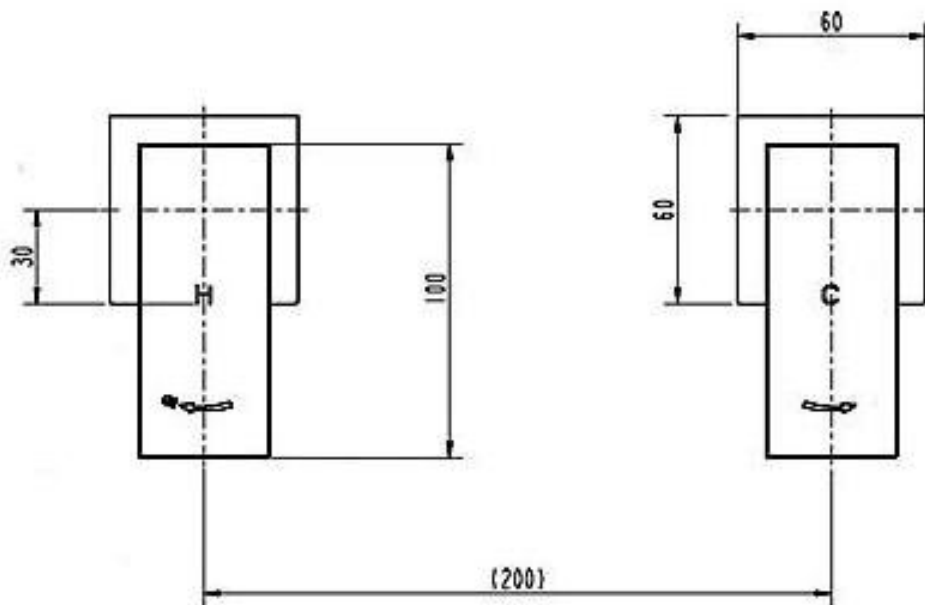

Size and description are correct to the best of our ability, however, variations can occur and changes may be made without notice.

In some cases, slight variations of colour and/or size may be inherent in the material used or manufacturing process. Harper's Bathroom always recommends that the actual product be on site prior to start of job, so as to best gauge fit for installation and purpose. E&OE.