





Elgin Sink Mixer II

Finish & SKU

	Chrome NR231406CH		Brushed Nickel NR231406BN
	Matte Black NR231406MB		Brushed Gold NR231406BG
	Gun Metal NR231406GM		



Specifications

Watermark License

WM-060073

Temperature Rating

Min 1°C-Max 75°C

Pressure Rating

Min 150kpa-Max 500kpa



Features

- 25mm ceramic disc cartridge can be adjusted to control water temperature and flow control settings, saving energy
- NEOPERL aerator with slim stream flow director
- Polyamide PEX flexible hose - 1/2 BSP female
- Suitable for mains pressure installation

Maintenance And Care

- Regularly check the mixer and connections for signs of wear or leaks.
- Clean the tap with mild soapy water to maintain its appearance, avoiding harsh chemicals and abrasive materials that may damage the finish.

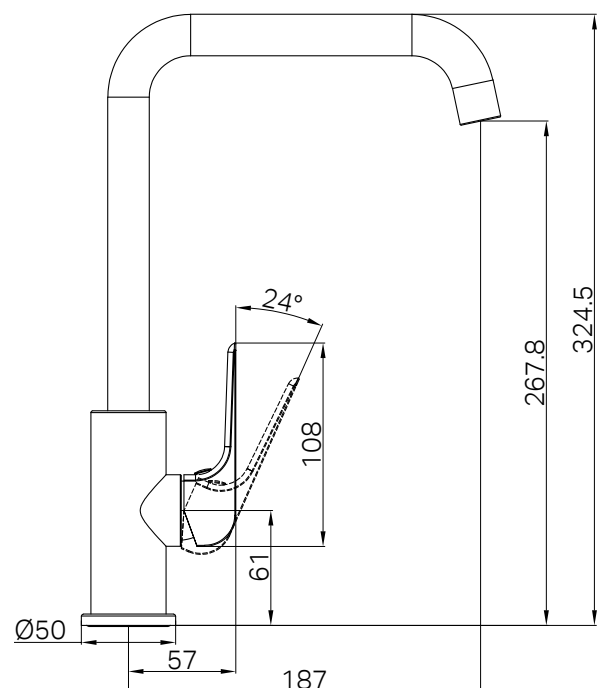

- Dimensions are nominal measurements only.