

# Dolce II Twin Shower

# Nero

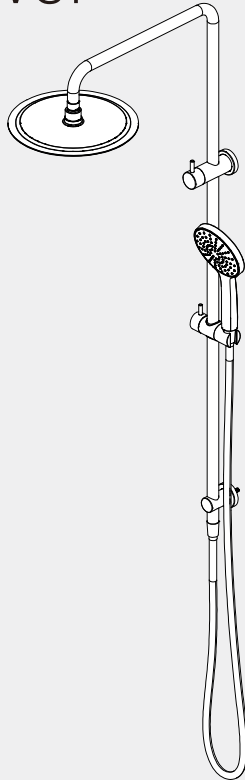

Version : 202510



## Drawing

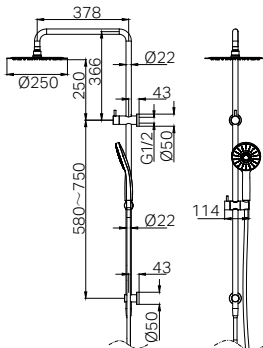

## Specifications

### Watermark License

WM-060093

### Temperature Rating

Min 1°C–Max 75°C

### Pressure Rating

Min 150kpa - Max 500kpa

## Package Includes

- 1 x Hand Shower
- 1 x Shower Head
- 1 x Shower Rail  
(Built-in Dual-Check Valve)
- 1 x 1.5m Shower Hose

## Finish & SKU

-  **Chrome**  
NR232105gCH
-  **Matte Black**  
NR232105gMB
-  **Gun Metal**  
NR232105gGM
-  **Brushed Gold**  
NR232105gBG
-  **Brushed Nickel**  
NR232105gBN

\*Dimensions are nominal measurements only.

## INSTALLATION INSTRUCTIONS

### GENERAL INSTRUCTIONS:

- This product must be installed by a licensed plumber. Ensure that your plumbing installation complies with the Australian/New Zealand Standard AS/NZS 3500.
- All pipework must be thoroughly flushed prior to the installation of the shower. In-line filters must be fitted on both hot and cold supplies to prevent foreign particles from damaging the shower components.
- Ensure that all outlets used for personal hygiene deliver water at a safe temperature in accordance with regional regulations.
- Verify that the water pressure is within the recommended range for the shower to function properly.

### PARTS NAME

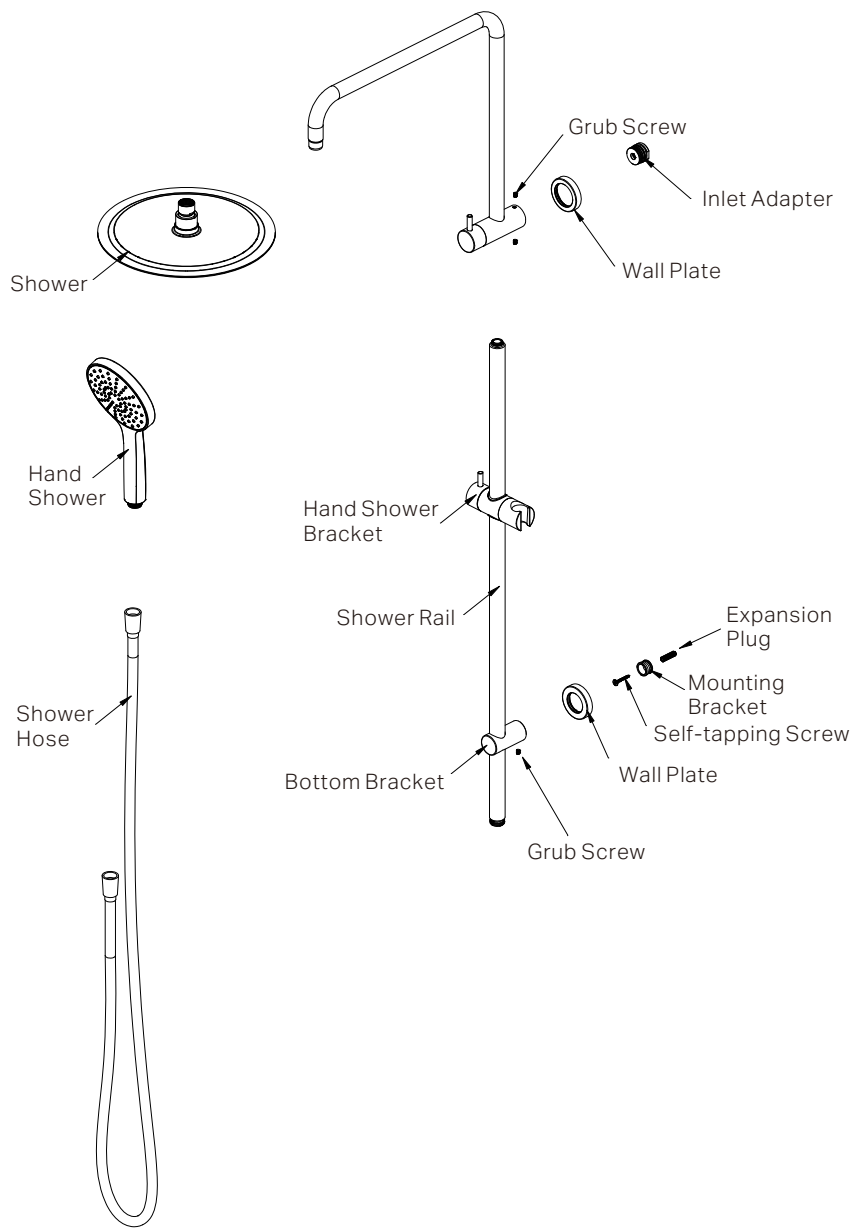

# INSTALLTION STEPS

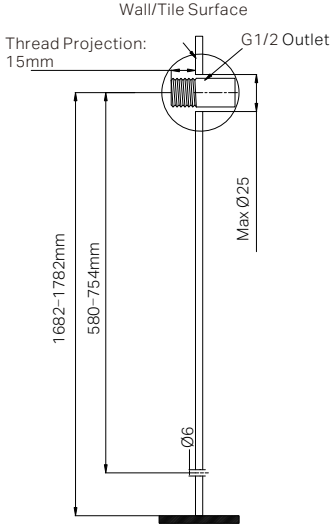

1. Drill a Ø6mm mounting hole 580-754 mm directly below the outlet connector.

Apply PTFE tape



2. Apply PTFE tape to the outlet thread to ensure a watertight seal. Screw the inlet adapter onto the outlet, and secure the mounting bracket to the wall using expansion plug and screw.

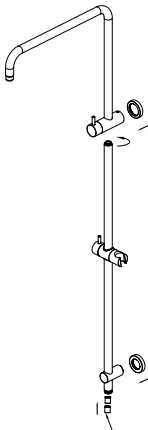

Dual-Check Valve Built in

3. Screw the shower rail into the diverter bracket. Slide back plates into diverter bracket and the bottom bracket.

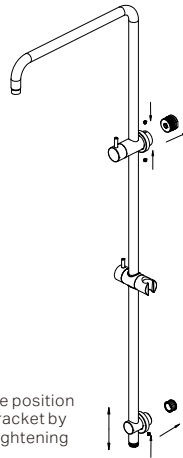

NOTE: Adjust the position of the bottom bracket by loosening and tightening the grub screw.

4. Align the diverter with the inlet adapter and the bottom bracket with the mounting bracket, then secure the shower rail to the wall using grub screws.

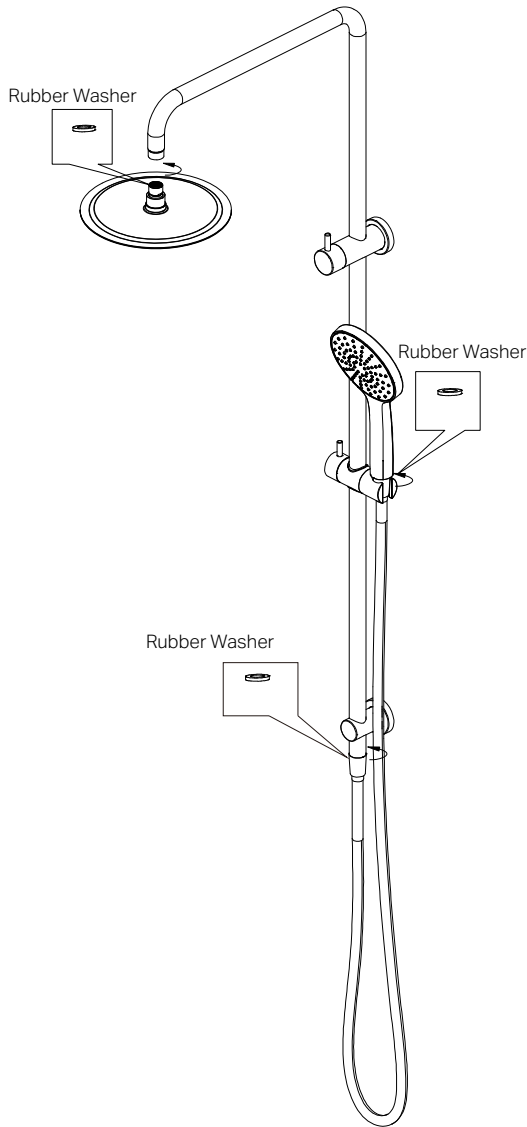

5. Screw the overhead shower into the shower arm, ensuring a rubber washer is in place for watertight seal.

6. Connect one end of the hose to the bottom of the shower rail and the other end to the hand shower.

Ensure the rubber washers at both ends are not lost during installation.

### FINAL INSPECTION

Switch on the water supply and check for any leakage at the joints.

# Nero

