







## Bianca Shower Mixer With Divertor Separate Back Plate Trim Kits Only

### Finish & SKU

 <b>Chrome</b> NR321511gtCH	 <b>Brushed Nickel</b> NR321511gtBN
 <b>Matte Black</b> NR321511gtMB	 <b>Brushed Gold</b> NR321511gtBG
 <b>Brushed Bronze</b> NR321511gtBZ	 <b>Gun Metal</b> NR321511gtGM

### Specifications

#### Watermark License

WM-060073

#### Temperature Rating

Min 1°C-Max 75°C

#### Pressure Rating

Min 150kpa-Max 500kpa

### Features

- Metal wall plate construction for longevity
- Compatible with premium 35mm universal shower mixer with divertor body

### Maintenance And Care

- Regularly check the mixer and connections for signs of wear or leaks.
- Clean the tap with mild soapy water to maintain its appearance, avoiding harsh chemicals and abrasive materials that may damage the finish.

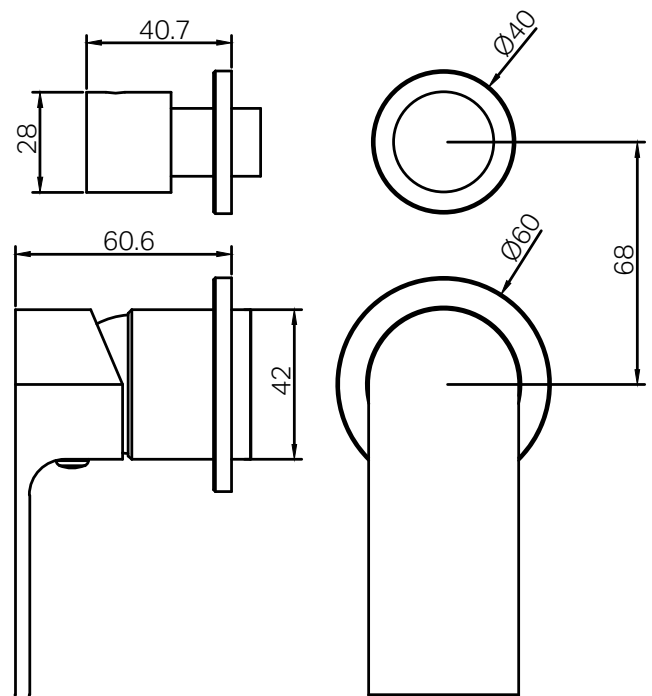
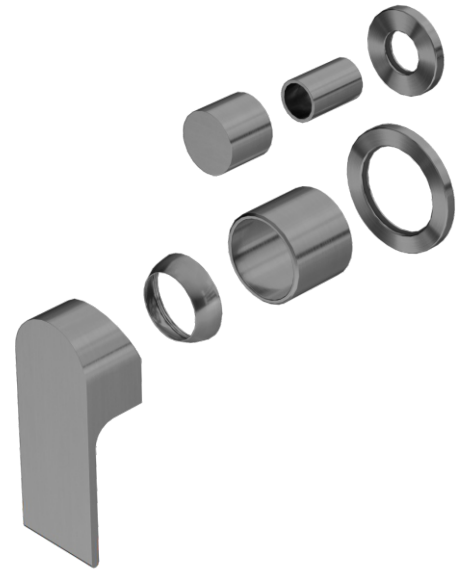

- Dimensions are nominal measurements only.