

Opal Progressive Shower System Separate Plate Trim Kits Only

Nero

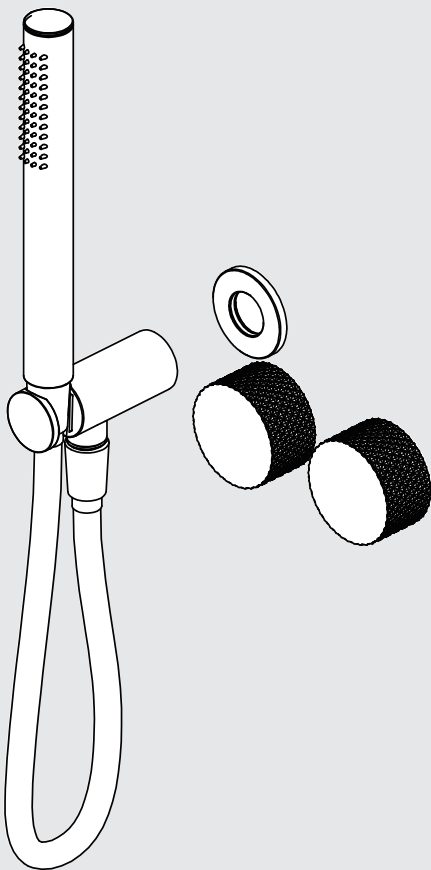

Lead Free



Versions:202506



Drawing	Specifications	Packaging Includes				
<p>Technical drawing of the shower system. The left view shows a side profile with dimensions: 84.3 (height of the shower head), 238 (height of the main body), 170 (width of the main body), 85 (width of the diverter knob), 51 (width of the hand shower), 32 (width of the diverter knob), and 98 (width of the hand shower). The right view shows a top-down view with dimensions: Ø26 (diameter of the main body), Ø50 (diameter of the diverter knob), Ø60 (diameter of the hand shower), and Ø50 (diameter of the diverter knob).</p>	<p>Watermark License WM-060073</p> <p>Temperature Rating Min 1°C-Max 75°C</p> <p>Pressure Rating Min 150kpa - Max 500kpa</p> <p>Finish & SKU</p> <table><tr><td> Graphite NR252003dtGR</td><td> Brushed Bronze NR252003dtBZ</td></tr><tr><td> Brushed Gold NR252003dtBG</td><td> Brushed Nickel NR252003dtBN</td></tr></table>	Graphite NR252003dtGR	Brushed Bronze NR252003dtBZ	Brushed Gold NR252003dtBG	Brushed Nickel NR252003dtBN	<p>1x Plate 1x Hand- Wheel 1x Diverter Knob 1x Hand Shower(Within Check- Valve) 1x 1m PVC Hose 1x Shower Bracket</p>
Graphite NR252003dtGR	Brushed Bronze NR252003dtBZ					
Brushed Gold NR252003dtBG	Brushed Nickel NR252003dtBN					

*Dimensions are nominal measurements only.

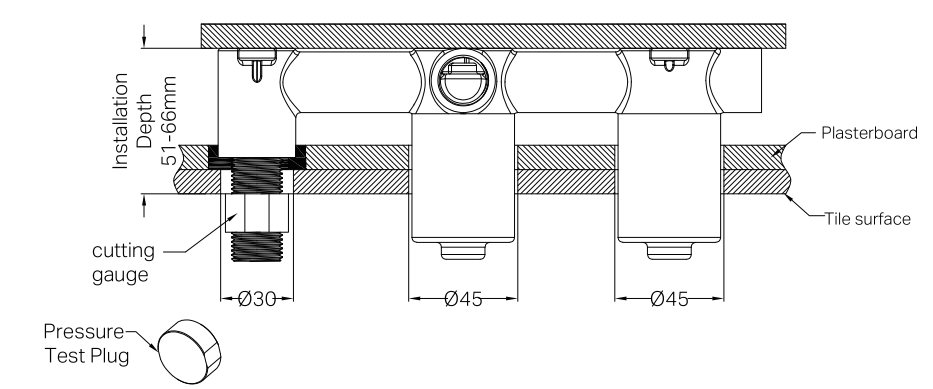

- 1. Install tiles and drill holes with diameters of Ø30, Ø45, Ø45.
- 2. Remove the pressure test plug.
- 3. Assemble the cutting gauge onto the mixer body, make it flush with the tile surface, and trim off any excess part after assembly.

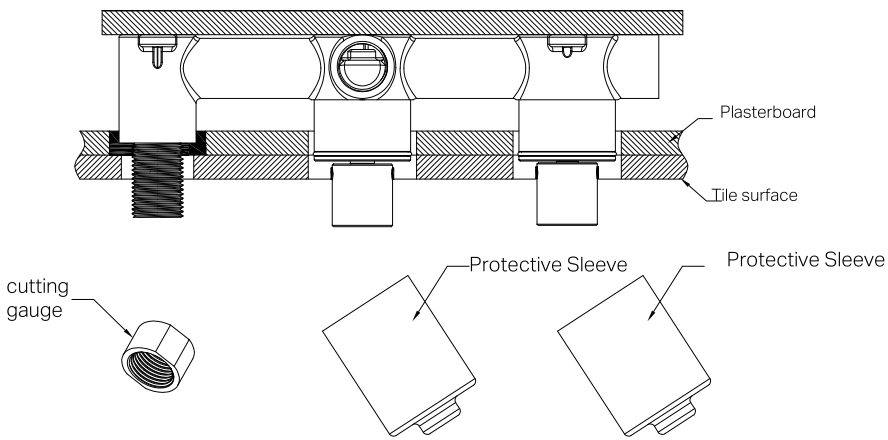

- 4. Remove the cutting gauge and protective sleeve.

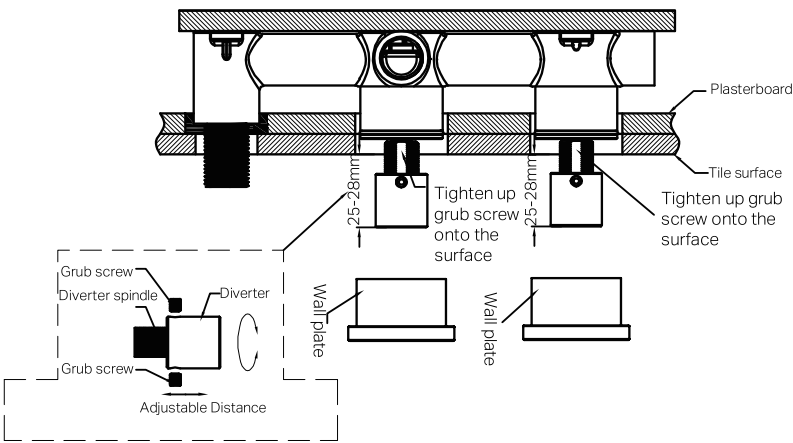

- 5. Adjust the distance between the Diverter knob and the tile surface to 25-28MM as shown in the diagram.
- 6. Place the wall plate onto the mixer body.

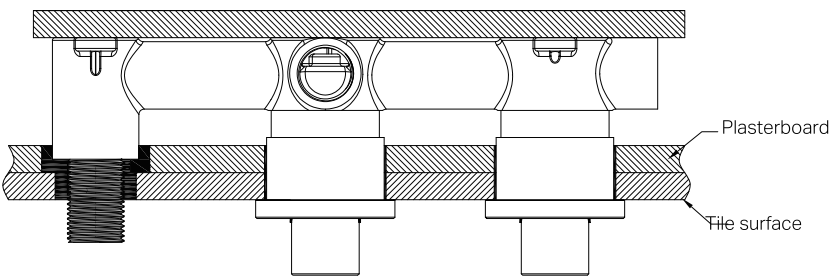

- 7. Apply waterproofing in the gap between the ceramic tile and the water outlet.

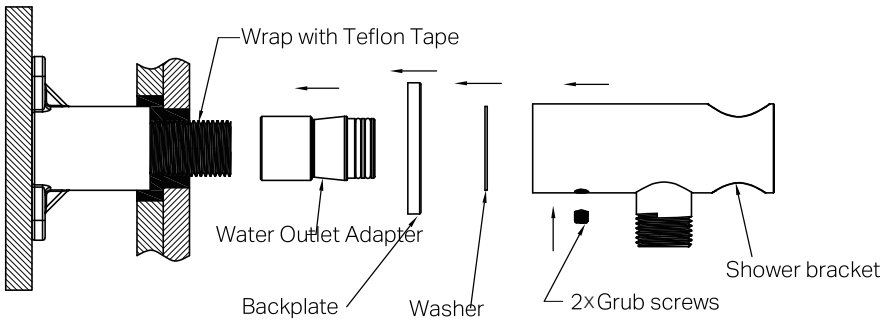

- 8. Thread the water outlet adapter onto the in-wall body, and seal with Teflon tape.
- 9. Assemble the Backplate, washer, and shower bracket onto the main body, then secure with screws.

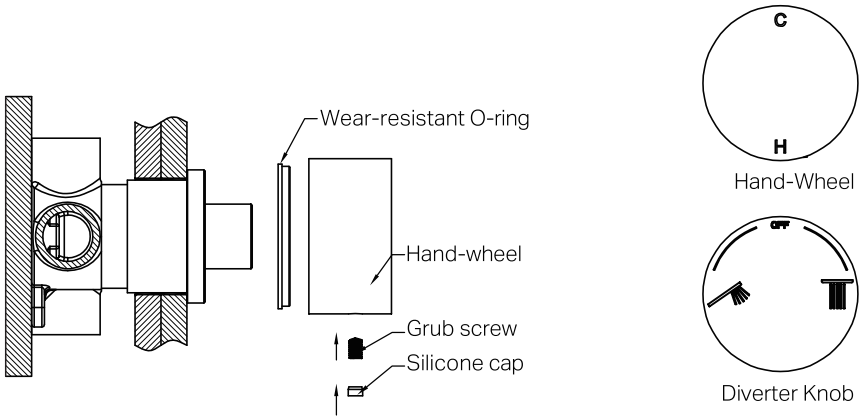

- Follow step 10 to install the Hand-wheel and the Diverter Knob
- 10. Attach the wear-resistant O-ring, hand-wheel/ Diverter knob, grub screw, and silicone cap, securing them in place.

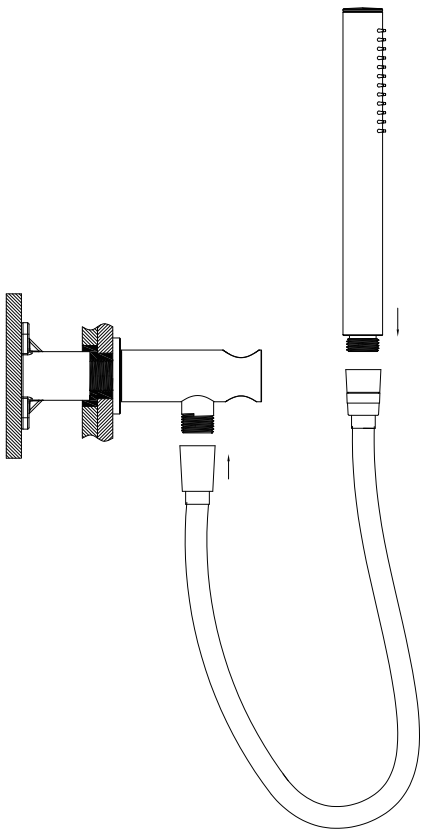

- 11. Attach the shower hose and hand shower, securing them in place.

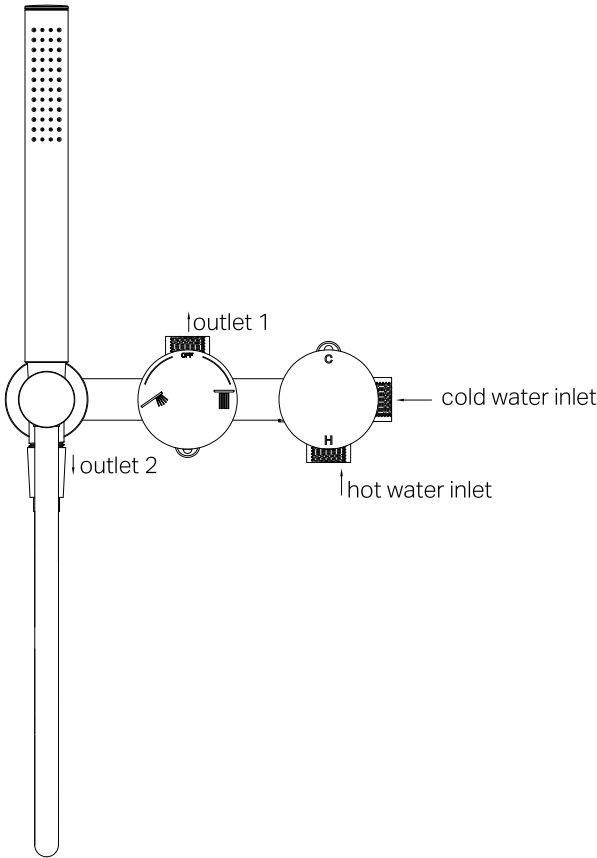

- 12. Installation is now complete. Test for leaks.

Nero

