

Mecca

Wall Basin/Bath Mixer

Swivel Spout Handle Up

Trim Kits Only

Nero

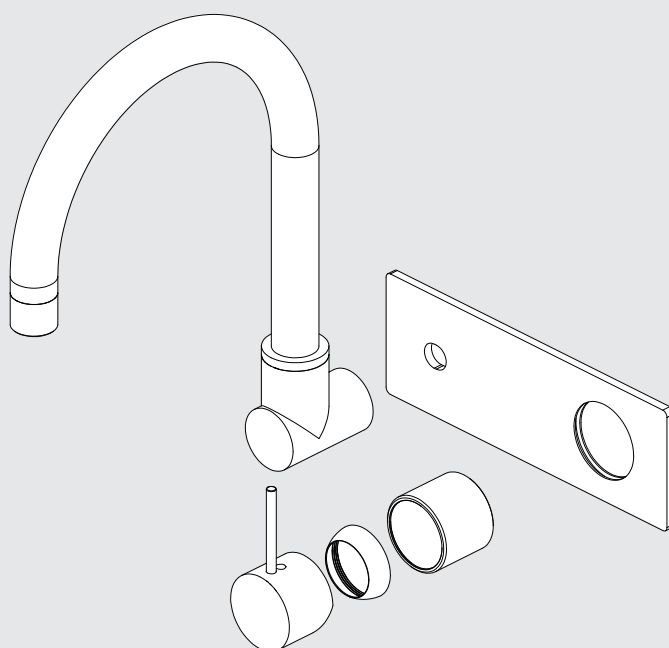

Versions:202506



Drawing

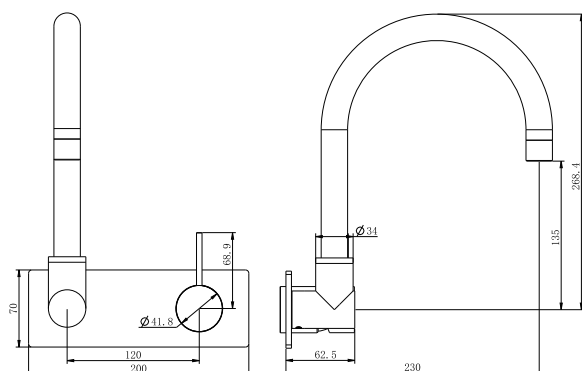

Specifications

Watermark License

WM-060073

Temperature Rating

Min 1°C-Max 75°C

Pressure Rating

Min 150kpa - Max 500kpa

Packaging Includes

- 1x Spout
- 1x Plate
- 1x Handle
- 1x Cartridge Bell
- 1x Dressing Ring
- 1x Non-Restricting Aerator

Finish & SKU

- | | | | |
|---|--|--|--|
|  Chrome
NR221910ptCH |  Gun Metal
NR221910ptGM |  Brushed Bronze
NR221910ptBZ |  Brushed Nickel
NR221910ptBN |
|  Matte Black
NR221910ptMB |  Brushed Gold
NR221910ptBG |  Matte White
NR221910ptMW | |

*Dimensions are nominal measurements only

**Includes an additional non-restricting aerator for bath use

Installation Instruction For Trim Kits Only

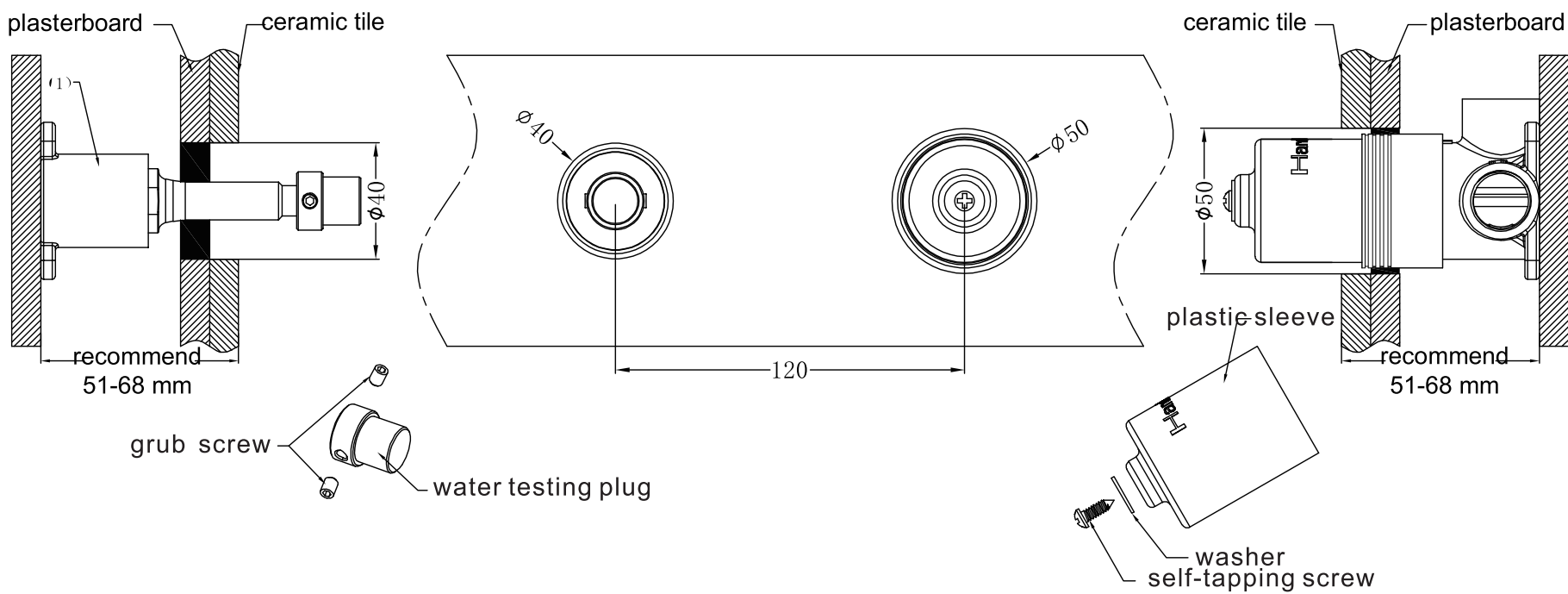

- 1. Drill a $\phi 50\text{mm}$ and a $\phi 40\text{mm}$ hole in the ceramic tile, then position it as shown in the above diagram.
- 2. Undo the self-taping screw to remove the plastic sleeve, and release the grub screws to remove the water testing.

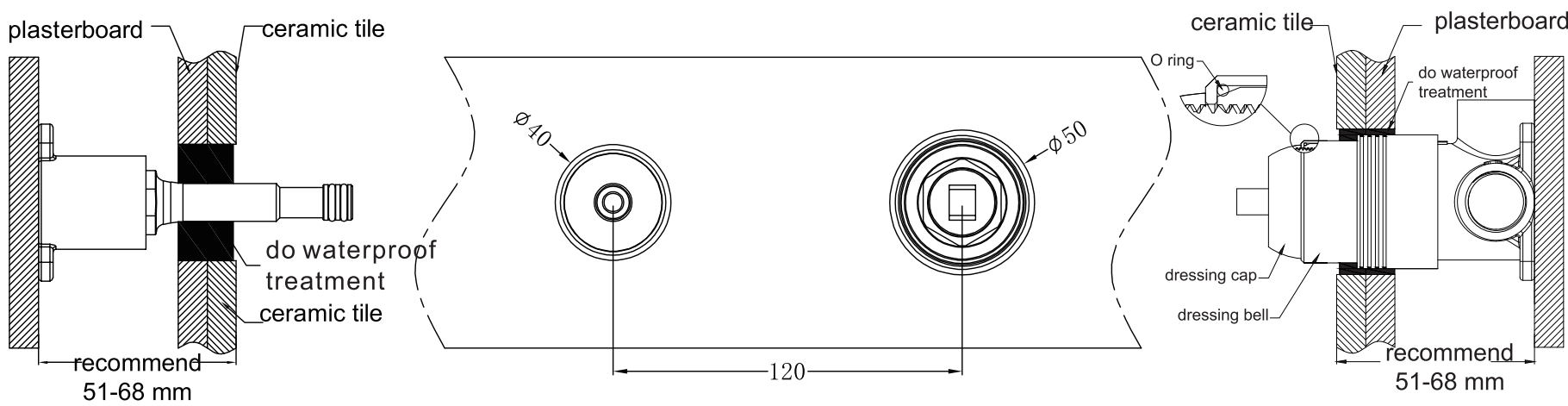

- 3. Insert the O ring to the dressing bell groove, and slide the dressing bell onto cartridge.
- 4. Apply waterproof treatment to the area indicated in the diagram above.
- 5. Tighten up the dressing ring on the cartridge bell.

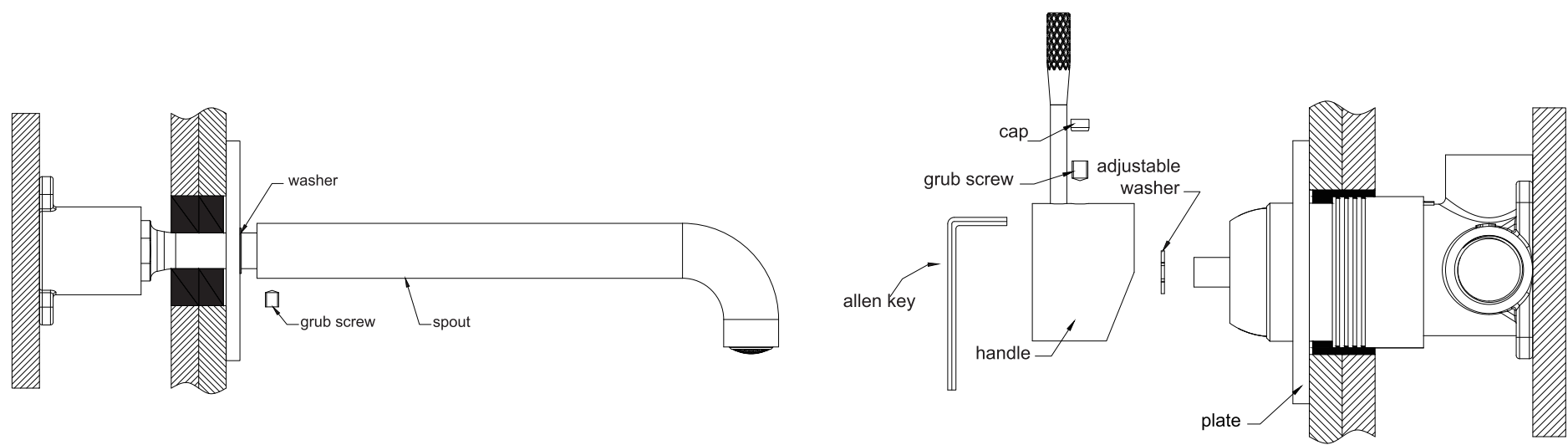

- 6. Slide the backplate and washer onto the wall, set the spout in place, and secure it tightly using the grub screw.
- 7. Attach the washer to the cartridge rod, position the handle, tighten it with a grub screw using an Allen key, and cap the grub screw hole.

Please note: there is a washer between backplate and the spout.

Nero

