

# Mecca

## Wall Basin/Bath Mixer

### Trim Kits Only

Nero



Lead Free

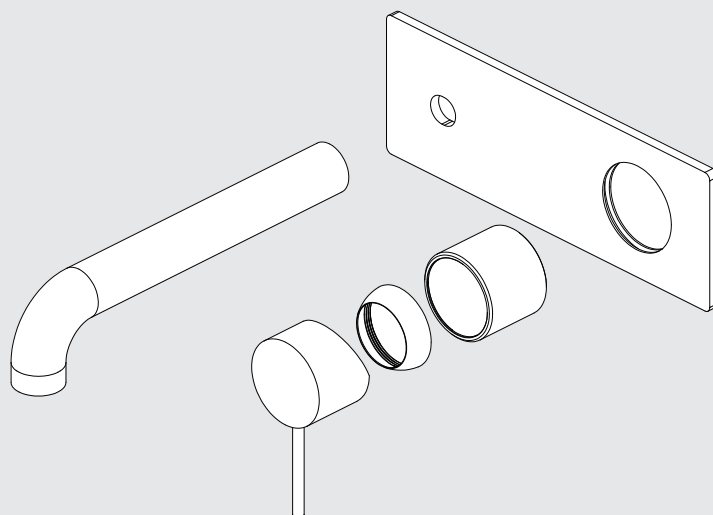

Versions:202506



#### Drawing

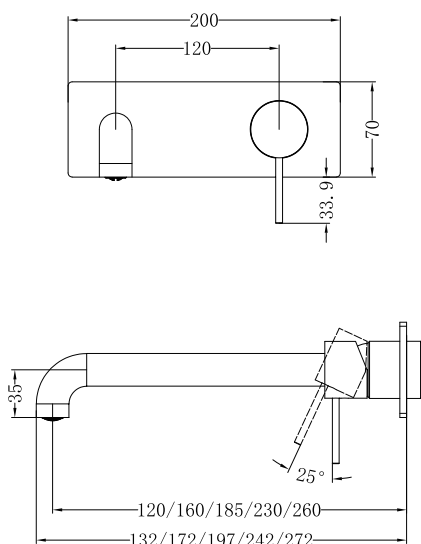

#### Specifications

##### Watermark License

WM-060073

##### Temperature Rating

Min 1°C-Max 75°C







##### Pressure Rating

Min 150kpa - Max 500kpa

#### Packaging Includes

- 1x Spout
- 1x Plate
- 1x Handle
- 1x Cartridge Bell
- 1x Dressing Ring
- 1x Non-Restricting Aerator

#### Finish & SKU

- |  |  |
|--|--|
|  <b>Chrome</b><br>NR221910a(120/160/185/230/260)tCH         |  <b>Gun Metal</b><br>NR221910a(120/160/185/230/260)tGM      |
|  <b>Matte Black</b><br>NR221910a(120/160/185/230/260)tMB    |  <b>Brushed Gold</b><br>NR221910a(120/160/185/230/260)tBG   |
|  <b>Brushed Bronze</b><br>NR221910a(120/160/185/230/260)tBZ |  <b>Brushed Nickel</b><br>NR221910a(120/160/185/230/260)tBN |
|  <b>Matte White</b><br>NR221910a(120/160/185/230/260)tMW    |  |

\*Dimensions are nominal measurements only

\*\*Includes an additional non-restricting aerator for bath use

# Installation Instruction For Trim Kits Only

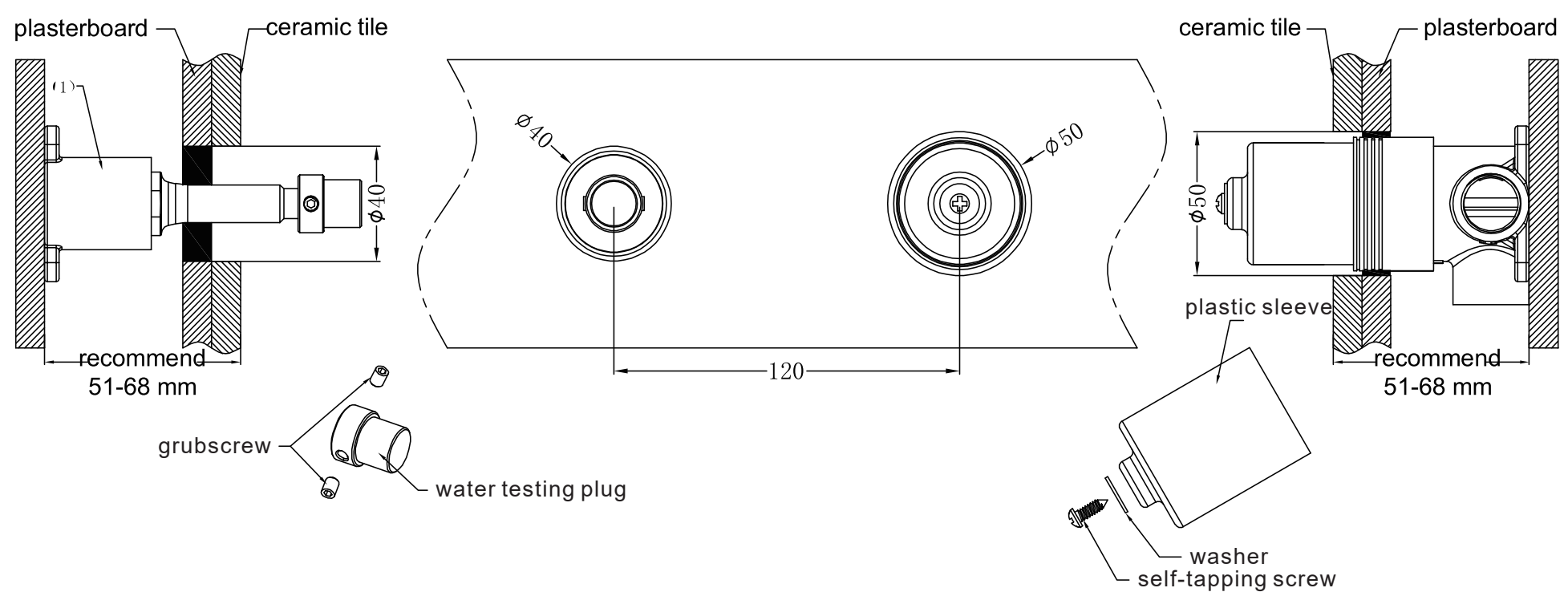

1. Drill a 50mm and a 40mm hole in the ceramic tile, then position it as shown in the above diagram.
2. Undo the self-taping screw to remove the plastic sleeve, and release the grub screws to remove the water testing plug.

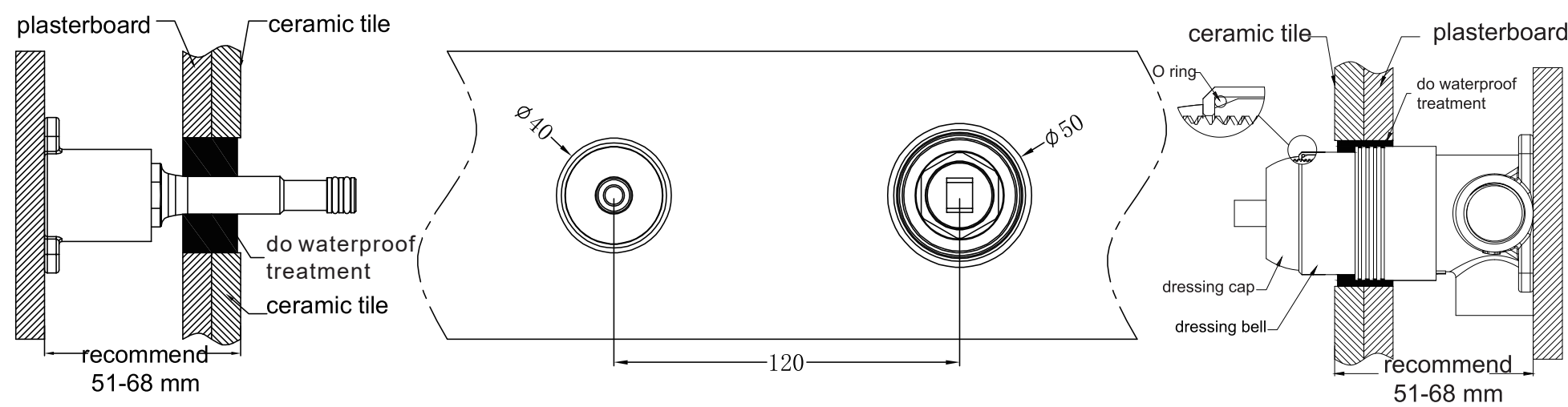

3. Insert the O ring to the dressing bell groove, and slide the dressing bell onto cartridge.
4. Apply waterproof treatment to the area indicated in the diagram above.
5. Tighten up the dressing ring on the cartridge bell.

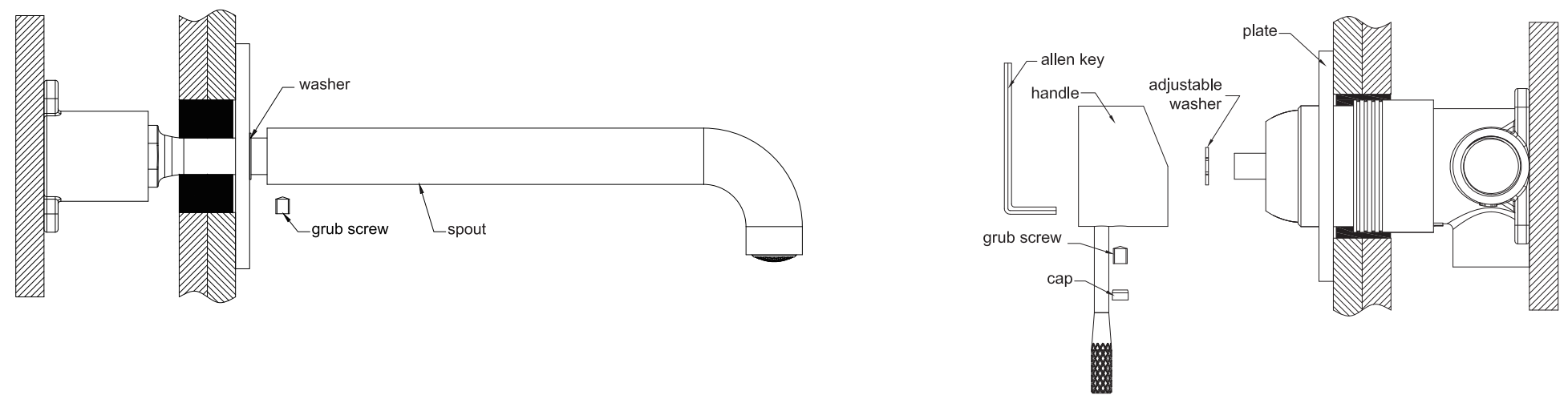

6. Slide the backplate and washer onto the wall, set the spout in place, and secure it tightly using the grub screw.
7. Attach the washer to the cartridge rod, position the handle, tighten it with a grub screw using an Allen key, and cap the grub screw hole.

Please note: there is a washer between backplate and the spout.

Nero

