

TOP VIEW

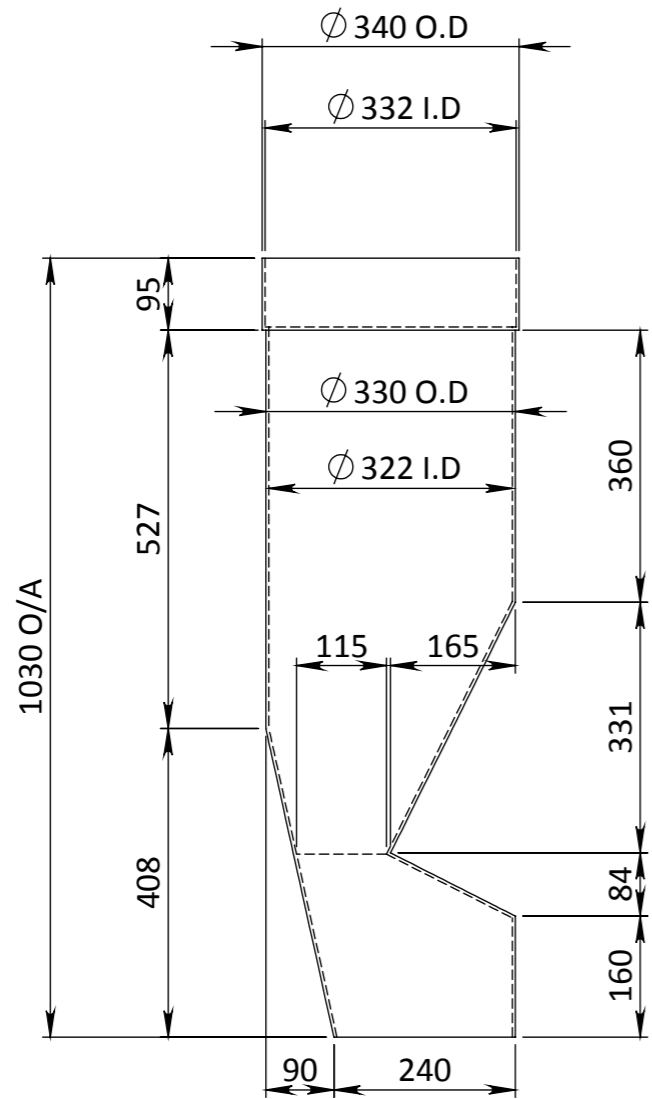

SIDE VIEW

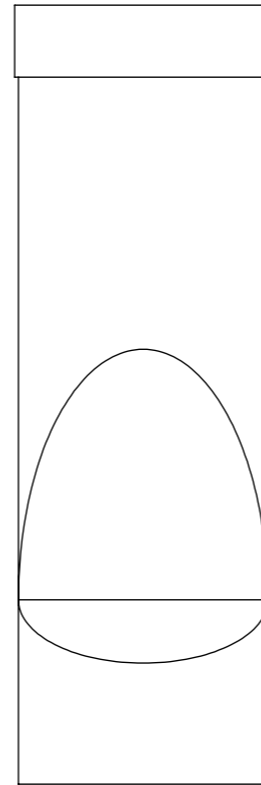

FRONT VIEW

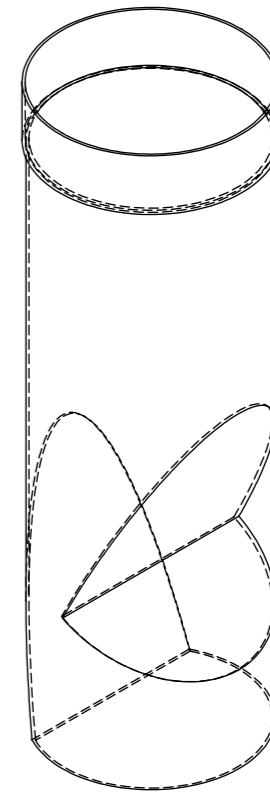

*NOTE: DROPPER CAN BE CUT TO SUIT ONSITE

MATERIAL: BLACK LOWDENSITY
POLYETHYLENE

REV	DATE	BY	DESCRIPTION	APPROV.
A	09.04.15	DH	FIRST ISSUE	GOUGH
REVISION				APPROV.



A.C.N. 010 028 547
Gough Industries Pty. Ltd.
833 Ingham Road
Bohle, Townsville
P.O. Box 7570, Garbutt BC, Qld. 4814.
Telephone 07 47747606
Facsimile 07 47747608

HTS DROPPER TUBE

DRAWN	Signature D.HOLLIER	Date 09.04.15	SCALE 1:10	A3	Gough Plastics Drg. No. HTS900.6005-04	A	REV
DRN. CHK			S:\Products\Environmental\Hybrid Toilet System\Drawings\Components\Dropper Tube\				