

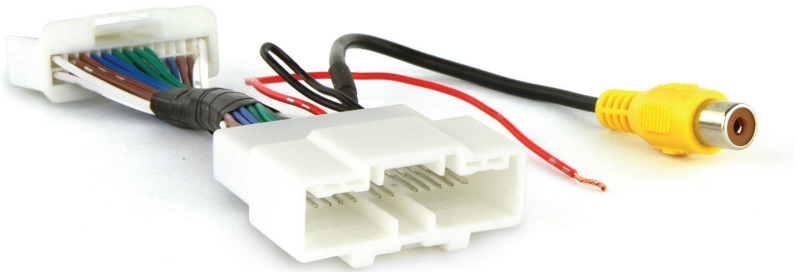

Instruction Manual

Video Camera Retention Harness
To Suit Toyota Hilux Vehicles 2020 Onwards



VRTY20

video retention
harness



Img ref: Toyota Hilux (From June 2020 Onwards)

This harness will only work with this model of Toyota head unit.

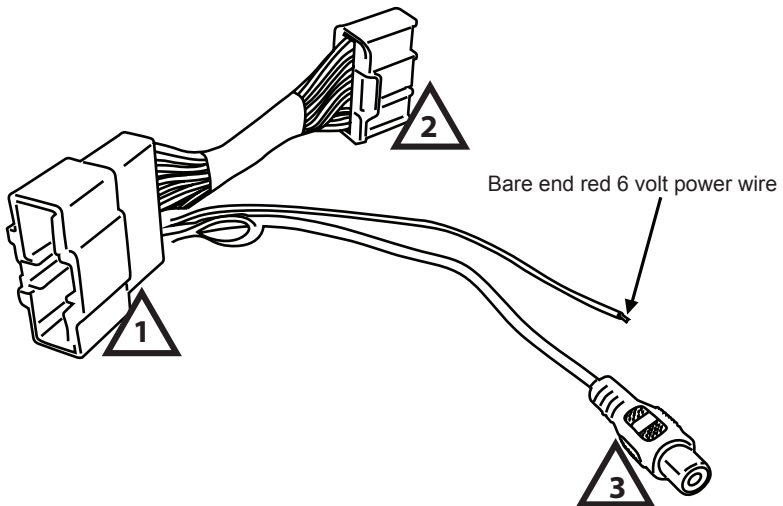

WIRING OF CAMERA TO BE SET AS NTSC IMAGE FOR THIS VEHICLE

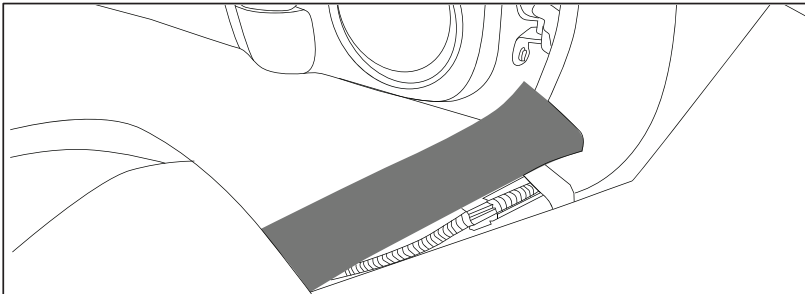
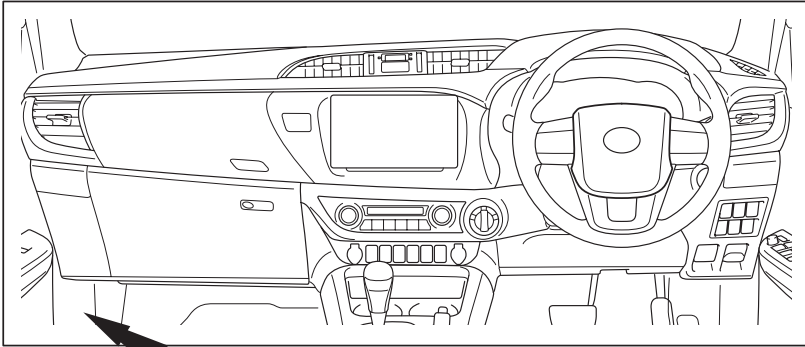

Lift up and remove the passenger side door sill plate.

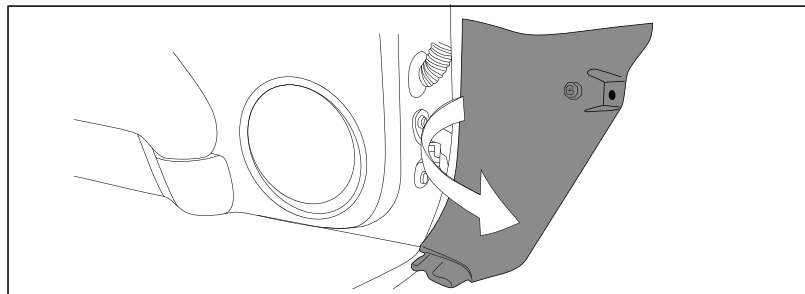

Remove the passenger side footwell kick panel.

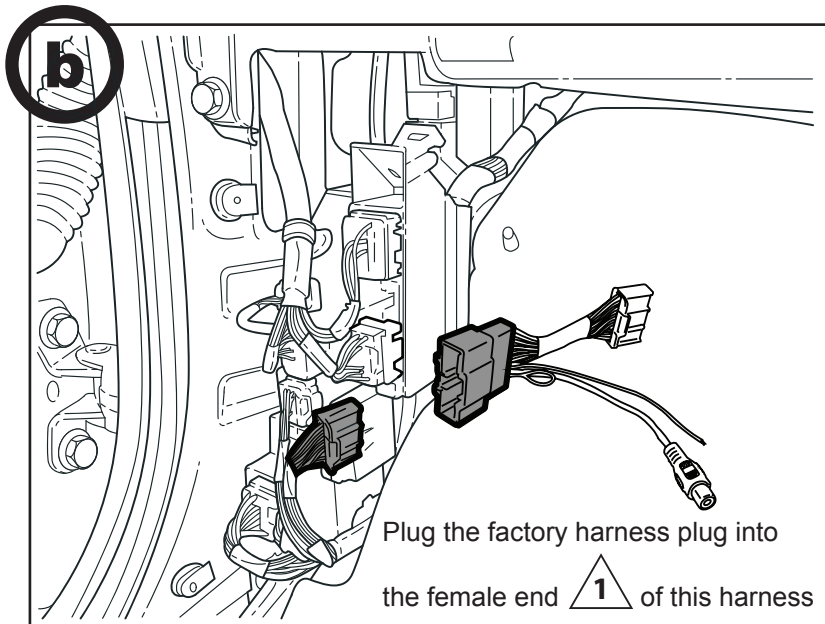
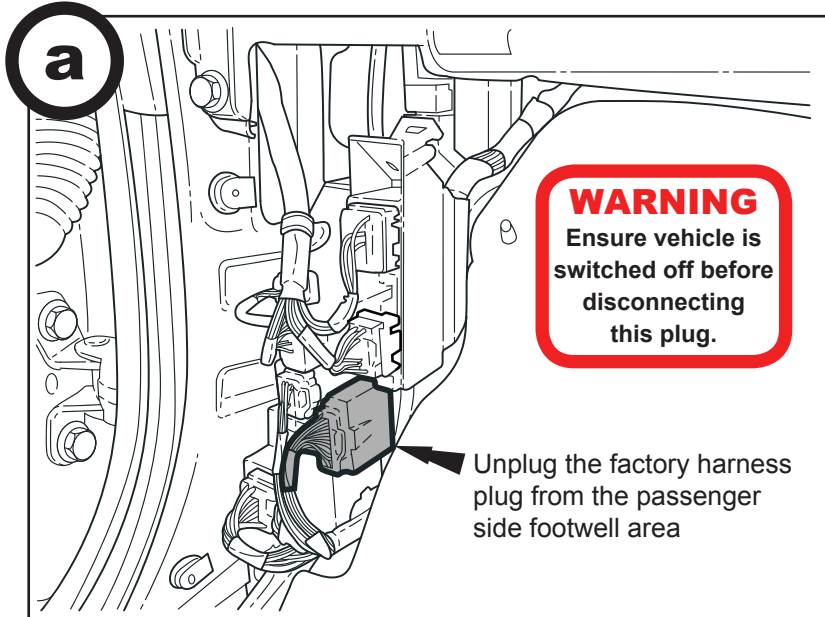

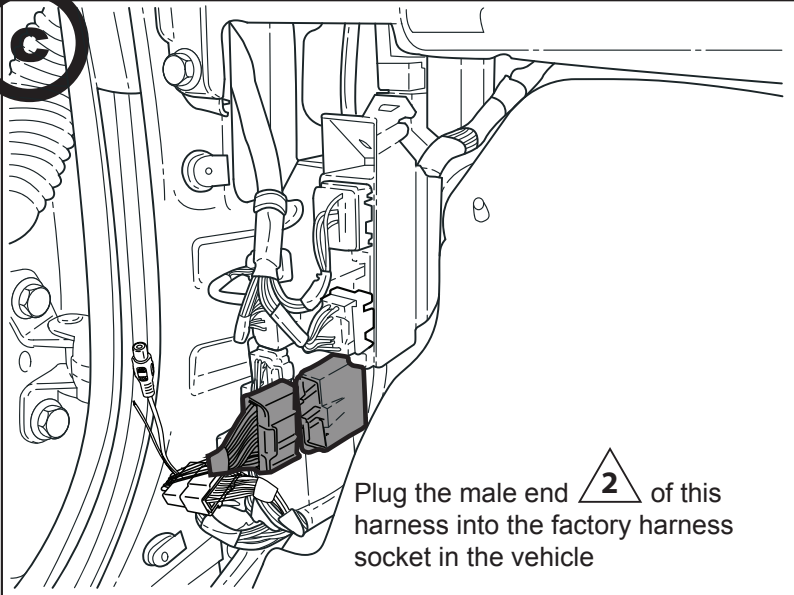
c

Plug the male end **2** of this harness into the factory harness socket in the vehicle

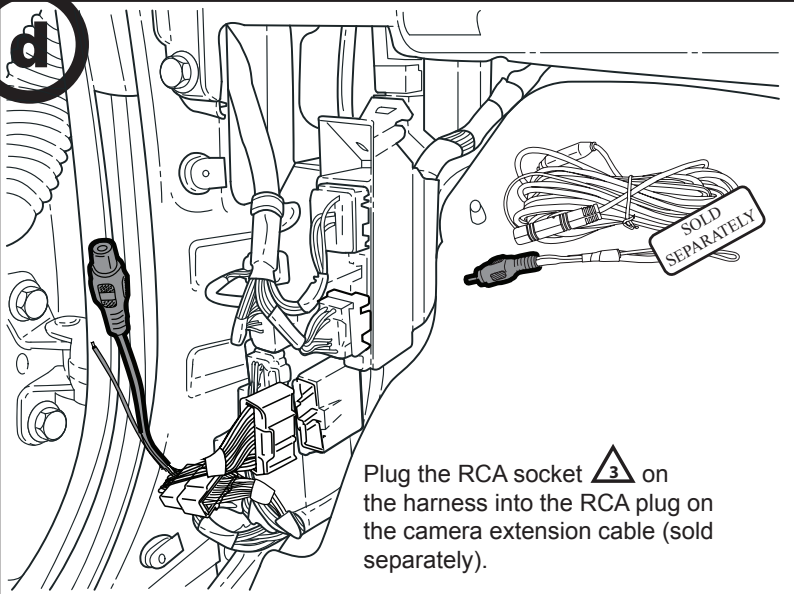
d

Plug the RCA socket **3** on the harness into the RCA plug on the camera extension cable (sold separately).

RCB170 - Small Butterfly / Flush Camera:

SOLD
SEPARATELY

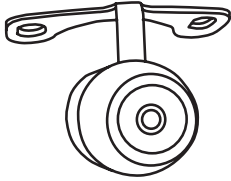

1x Camera



1x Flush Mount
Converter



2 x Flat Washers



2 x Split Washers



2 x Screws



1 x 18.5mm Hole Saw

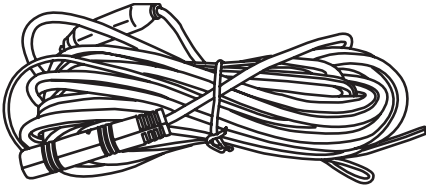

1x Wiring Loom

RCL170 - Heavy Duty Large Butterfly Camera:

SOLD
SEPARATELY



1x Camera



2 x Flat Washers



2 x Split Washers



2 x Screws

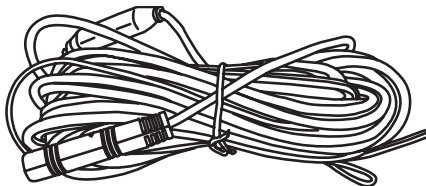

1x Wiring Loom

RCO170 - OEM Stalk Camera:

SOLD SEPARATELY

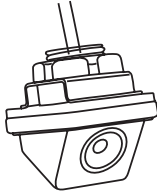

1x Camera

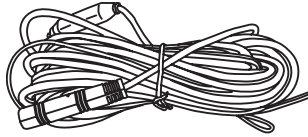

1x Wiring Loom

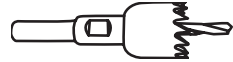

1 x 18.5mm Hole Saw



1 x Self Locking Plate

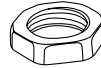

1 x Nut

RCP170 - Flush Pivot Mount Camera:

SOLD SEPARATELY

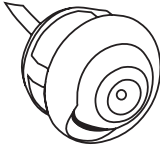

1x Camera

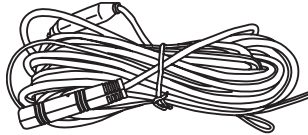

1x Wiring Loom



1 x 22.5mm Hole Saw

RCS170 - Stalk Camera:

SOLD SEPARATELY

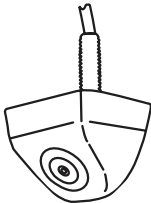

1x Camera

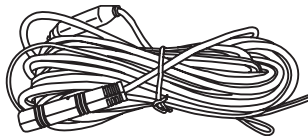

1x Wiring Loom



1 x Flat Washers



1 x Split Washers



1 x Nut

Note: All fittings are stainless steel



www.dnaaudio.com.au