



# UCG165A GOURMET SERIES UNDERCOUNTER

Distributor:



**Chefs Hat Australia Pty. Ltd**  
131 Cecil St  
South Melbourne, VIC 3205  
p: +61 3 9682 1441  
e: sales@chefshat.com.au



UCG165A

## Features

- Produces clear, long-lasting gourmet cubes.
- Space-saving 532 mm wide under-counter design.
- Produces up to 73 kg of ice per day.
- Constructed from sturdy, corrosion-resistant stainless steel and fingerprint-proof plastic.
- Ideal for any under-counter or bar application.
- Contemporary, elegant design.
- Environmentally friendly R134A refrigerant.
- Easily adjust the thickness of your ice from the front of the machine!

## Space-Saving Solutions

- Front air discharge design for compact spaces.
- Low profile top saves counter space.
- Stores up to 40 kg of ice.
- Easy front access to ice.
- Removable Air Filter.

## Options & Accessories

| WATER FILTERS     |          |             |
|-------------------|----------|-------------|
| Ice Machine Model | Manifold |             |
|                   | System   | Replacement |
| UCG165            | CD10B    | CD100B      |

## Ice Maker Warranty

*Every Ice-O-Matic ice maker is backed by a warranty that provides both parts and labor coverage.*

- Two years Parts and Labour

## Ice Form



GOURMET ICE

| GOURMET ICE DIMENSIONS |          |
|------------------------|----------|
| Height                 | 30.5 mm  |
| Diameter               | 34.25 mm |

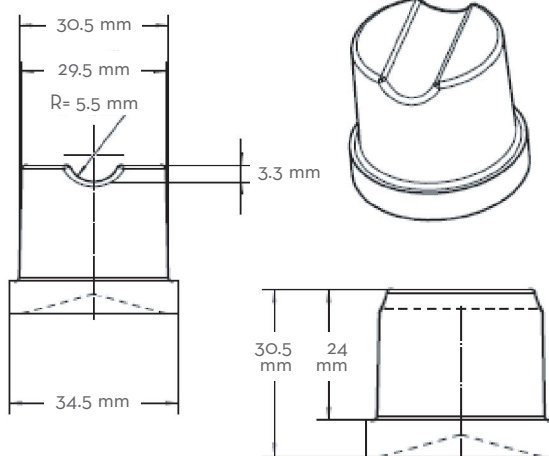



# UCG165A GOURMET SERIES UNDERCOUNTER

UCG165A GOURMET SERIES UNDERCOUNTER

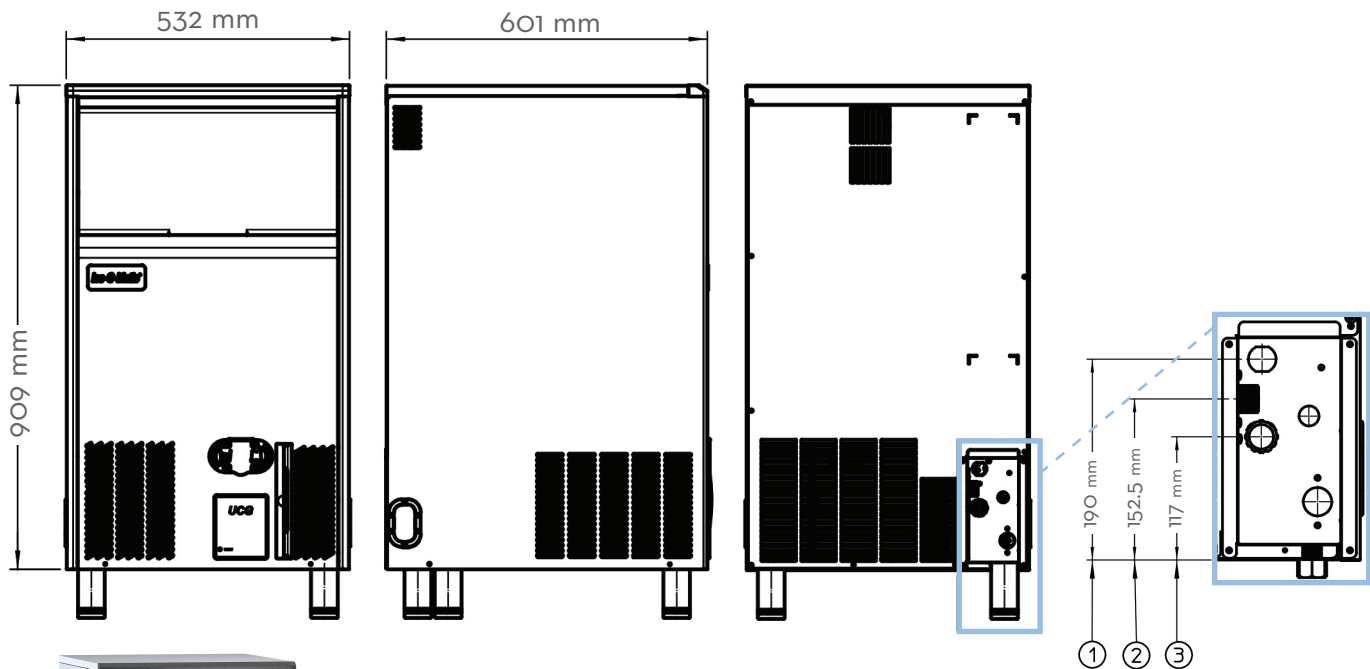

## LEGS INCLUDED

Extends from  
107 mm to 150 mm



107 mm

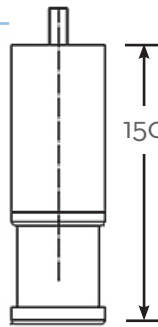
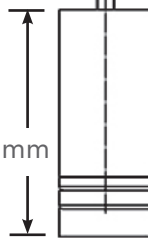

150 mm

- 1 - Power Cord
- 2 - 19 mm Water Inlet
- 3 - 20 mm Water Drain

## Operating Requirements

|                         | MINIMUM       | MAXIMUM |
|-------------------------|---------------|---------|
|                         | 50 Hz         |         |
| Ambient Temp. Range Air | 10°C          | 43°C    |
| Water Temp.             | 5°C           | 38°C    |
| Water Pressure          | 1 BAR         | 5 BAR   |
| Electrical Voltage      | 230V/50Hz/1ph |         |

## Dimensions

| ALL MODELS     |                                 |
|----------------|---------------------------------|
| W x D x H (mm) | 532 x 601 x 1016 - 1059 on legs |

## Specifications

| Model Number | Cond. Unit | Ice Production<br>per 24hrs | Ice Production<br>per 24hrs | Ice Production<br>per 24hrs | Storage Capacity<br>(kg) | Water Consumption<br>(ltr/hr) | kWH Used<br>per 45 kg of<br>Ice @ 32°C air/<br>21°C water | Voltage<br>Characteristics |
|--------------|------------|-----------------------------|-----------------------------|-----------------------------|--------------------------|-------------------------------|---|----------------------------|
|              |            | 21°C air/10°C water<br>(kg) | 32°C air/21°C water<br>(kg) | 10°C air/10°C water<br>(kg) |                          |                               |   |                            |
| UCG165A      | Air        | 69                          | 63                          | 73                          | 40                       | 8                             | 9   | 230/50/1                   |

NOTES:  
Approx. Shipping Weight (kg): UCG165A (37)  
Refrigerant Type: R134A  
All specifications and performance data are subject to normal manufacturing variances.

Ice-O-Matic reserves the right to change the specifications at any time without obligation. Certifications may vary depending on country of origin.