

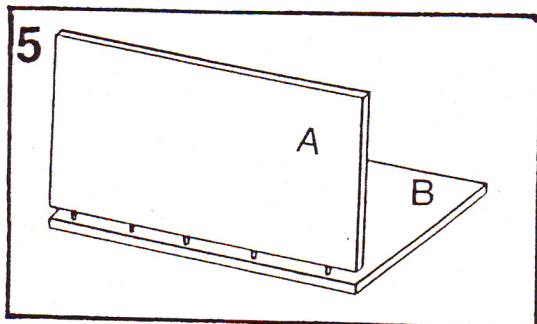

INSTRUCTIONS FOR  
HARON  
3 IN 1 DOWELLING JIG  
NO.H6500

FOR INSTALLATION OF 6, 8, OR 10mm DOWELS

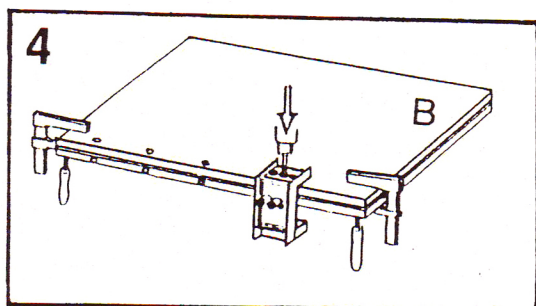
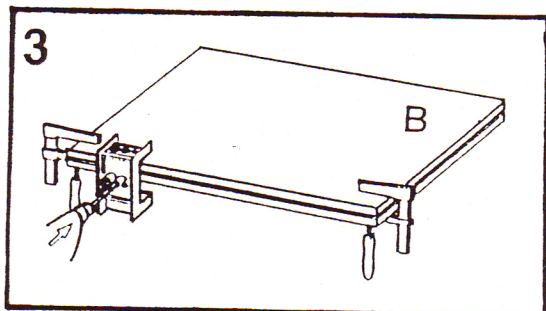
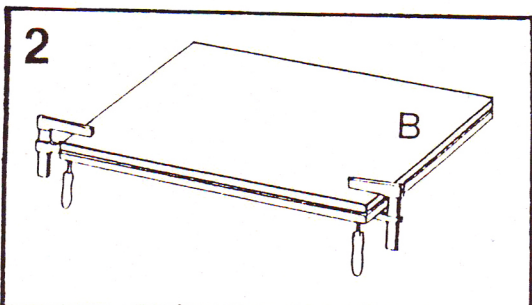
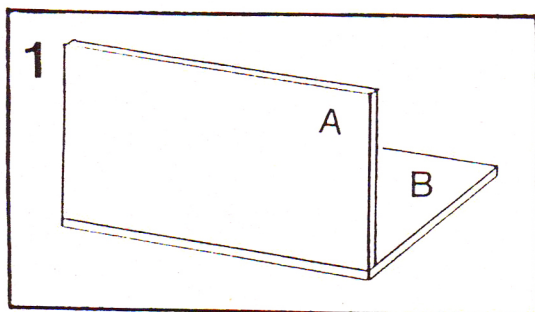

1.
  - a) Position boards as you wish to joint them.
  - b) After positioning, identify the boards with:
 

A For the vertical board.  
B For the horizontal board.
2.
  - a) Re-position board so that both are horizontal with B on top, ensuring that edges to be dowelled are together and squared up.
  - b) Use the spacers provided to separate the boards and clamp together. Spacers should be located near clamps.
  - c) A normal vice with jaws protected could be used on small jobs, in this case both boards are held vertically.
3.
  - a) Position the Dowelling Jig at one end of the boards to be joined and tighten built-in clamp until boards are firmly held. Do not over-tighten the screw clamp, as board surface could be damaged.
  - b) Having selected the appropriate size of Drill and Dowel to suit thickness of material, drill through the vertical and horizontal holes of Jig in your selected Dowel size. Use a Depth Stop to ensure you do not drill right through the board when drilling the face of the board.
4.
  - a) Release Jig Clamp and reposition Jig for the next set of holes, then repeat operation.
  - b) When all holes have been completed, release the Clamps and Jig.
5.
  - a) Place Dowels in edge of timber, position the boards and tap together using a wooden block or similar to avoid damage to the work.
  - b) The use of PVA Glue when fixing Dowels is recommended for stronger joints. **HARON** Dowels are multi-fluted to ensure even flow of adhesive.

**Haron International Pty Ltd**

P.O. Box 999 Ringwood Vic 3134 Australia

Email: [sales@haron.com.au](mailto:sales@haron.com.au) Web: [www.haron.com.au](http://www.haron.com.au)

Phone: +61 3 9870 9966 Fax: +61 3 9870 9366