

LEORA COLLEZIONE

Wall Mixer with Diverter & Hand Shower

Product Specifications

LUCENT[®]

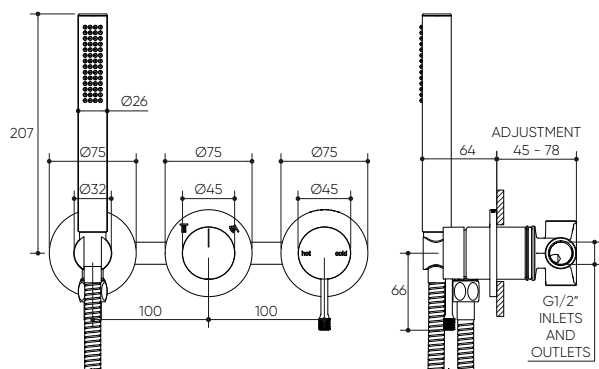

Specifications

Temperature Rating: 1-75°C

Pressure Rating: 150 - 1000kPa

Features

Complete Kit Includes Rough-In Kit and Trim Kit

Includes Water-Proof Flange Patented Design

Easily Update Mixer Design and/or Finish with any Style Switch Mixer Collection

Ceramic 90° Rotary Diverter to switch between Hand-piece and a Second Connected Outlet

High Quality, Solid Brass Backplates

Designed in Australia

Complete Kit Code	Finish	Trim Kit Code
18011PBG	Brushed Gold	10005PBG
18011CP	Chrome	10005CP
18011PBN	Brushed Nickel	10005PBN
18011PGM	Gun Metal	10005PGM
18011PCB	Chocolate Bronze	10005PCB
18011PMB	Matte Black	10005PMB



In-Wall Body Code
9936



For more information, contact:
P. 1300 474 714 E. info@lucentdesigns.com.au
Lucent, 15 Activity Crescent, Molendinar, Queensland 4214 Australia

All rights reserved 2024 Lucent. The images shown are for illustration purposes only and may not be an exact representation of the product. Modifications and adjustments may occur over time and the product should be used to confirm marking out and/or rough in as line drawings shown may vary from the item supplied over time. All measurements are in Millimetres and Colours are indicative and may vary from the images shown. Commercial and residential warranties may differ. Please refer to our website for full terms and conditions. <https://lucentdesigns.com.au/pages/warranty>

